



NOTICE OF PUBLIC HEARING

NEW RESIDENTIAL STREET LIGHTING ASSESSMENT AREAS FOR FISCAL YEAR 2024/2025 CITY COUNCIL MEETING SEPTEMBER 23, 2024, AT 6:00 PM

CITY HALL—COUNCIL CHAMBERS, 121 SW PORT ST. LUCIE BOULEVARD, PORT ST. LUCIE, FLORIDA

THE LOTS LISTED BELOW ARE IN AREAS BALLOTTED AND PASSED BY MAJORITY OF THE PROPERTY OWNERS RETURNED BALLOTS. THE CITY CONTEMPLATES LEVYING AN ASSESSMENT ESTIMATED AT \$26.00 PER LOT. PAYMENT WILL BE ON A YEARLY BASIS AND COLLECTED BY THE ST. LUCIE COUNTY TAX COLLECTOR. THIS ASSESSMENT WILL BE INCLUDED IN YOUR NOVEMBER 2025 TAX BILL ON THE NON-AD VALOREM PORTION OF YOUR TAX BILL. A DESCRIPTION OF THE PROPERTIES SPECIALLY BENEFITED (BY SECTION, BLOCK AND LOT) AND A MAP SHOWING THE PROPOSED LOCATION OF THE STREET LIGHTING IS AS FOLLOWS:

STREET LIGHTING ASSESSMENT AREA BOUNDARY #664 SE DAMASK AVENUE – SECTION 10

BLOCK 447	LOTS 1	Through	12
BLOCK 448	LOTS 10	And	11
BLOCK 486	LOTS 20	Through	36
BLOCK 486	LOTS 36A	Through	38



STREET LIGHTING ASSESSMENT AREA BOUNDARY #666 SW ALVATON AVENUE – SECTION 07

BLOCK 1833	LOTS 1	Through	11
BLOCK 1834	LOTS 1	Through	6
BLOCK 1847	LOTS 1	Through	3

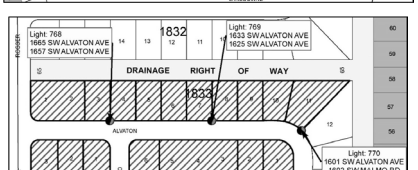

STREET LIGHTING ASSESSMENT AREA BOUNDARY #668 SE ATLANTUS AVENUE – SECTION 03

BLOCK 420	LOTS 1	Through	7
BLOCK 420	LOTS 7A	Through	19
BLOCK 421	LOTS 20	Through	38



STREET LIGHTING ASSESSMENT AREA BOUNDARY #669 SW INGRASSINA AVENUE – SECTION 19

BLOCK 1927	LOTS 26	Through	47
BLOCK 1931	LOTS 1	Through	8
BLOCK 1934	LOTS 14	Through	17
BLOCK 1932	LOT 1		
BLOCK 1933	LOT 29		

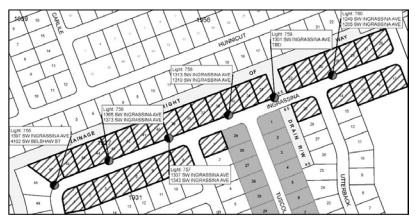

STREET LIGHTING ASSESSMENT AREA BOUNDARY #670 NW NORTH LOVETT CIRCLE – SECTION 47

BLOCK 3179	LOTS 1	Through	17
BLOCK 3180	LOTS 1	Through	4
BLOCK 3181	LOTS 1	Through	16



STREET LIGHTING ASSESSMENT AREA BOUNDARY #672 SE WELSH STREET – SECTION 18

BLOCK 723	LOTS 4	Through	8
BLOCK 792	LOTS 1	Through	8

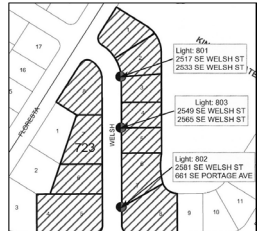

STREET LIGHTING ASSESSMENT AREA BOUNDARY #673 SW MORELIA LANE – SECTION 09

BLOCK 1129	LOTS 15	Through	28
BLOCK 1130	LOTS 1	Through	14

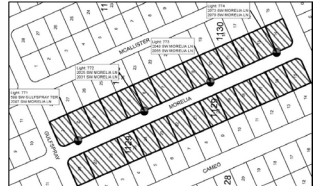

STREET LIGHTING ASSESSMENT AREA BOUNDARY #674 SE BYWOOD AVENUE – SECTION 03 & 10

BLOCK 441	LOTS 15	Through	31
BLOCK 451	LOTS 12	Through	15
BLOCK 454	LOTS 13	And	14
BLOCK 455	LOTS 14	And	15
BLOCK 456	LOTS 15	And	16
BLOCK 457	LOT 1		

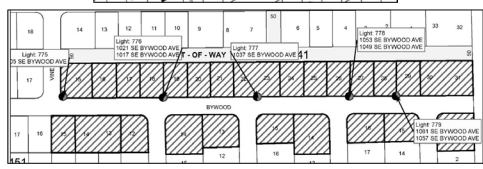

STREET LIGHTING ASSESSMENT AREA BOUNDARY #675 SE QUAY STREET – SECTION 39

BLOCK 2659	LOTS 73	Through	93
BLOCK 2681	LOTS 1	Through	15
BLOCK 2681	LOTS 24	And	25
BLOCK 2681	LOT 30		

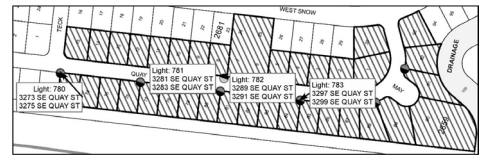

STREET LIGHTING ASSESSMENT AREA BOUNDARY #678 SW DAEMON STREET – SECTION 33

BLOCK 2195	LOTS 1	Through	7
BLOCK 2198	LOTS 1	Through	7



STREET LIGHTING ASSESSMENT AREA BOUNDARY #681 SW BRIGGS STREET – SECTION 16

BLOCK 1484	LOT 21		
BLOCK 1485	LOTS 20	And	21
BLOCK 1486	LOTS 3	Through	16
BLOCK 1487	LOTS 14	Through	24

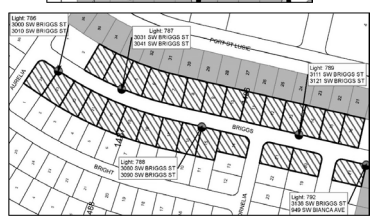

STREET LIGHTING ASSESSMENT AREA BOUNDARY #682 SW VICTOR LANE – SECTION 13

BLOCK 650	LOTS 13	Through	20
BLOCK 651	LOTS 2	Through	17
BLOCK 667	LOTS 8	Through	11

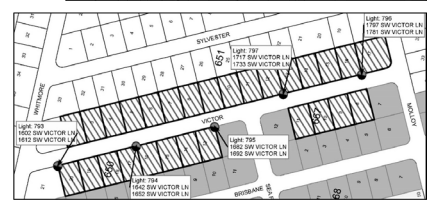

The public hearing will be held in the City Council Chambers at 6:00 p.m. on September 23, 2024, or as soon thereafter as the matter may be heard, located at the City of Port St. Lucie Municipal Complex (City Hall—Council Chambers), 121 S.W. Port St. Lucie Blvd., Port St. Lucie, Florida 34984 for receiving public comment on the proposed collection of the assessments. All affected property owners have a right to appear at the hearing and may file written objections with the Council in care of the City Clerk prior to the meeting. Written objections may also be filed with the City Clerk at the hearing any time before the adjournment of the hearing. If a person decides to appeal any decision made by the Council with respect to any matter considered at the hearing, such person will need a record of the proceedings and may need to arrange for a court reporter to ensure that a verbatim record is made. In accordance with the Americans with Disabilities Act, persons needing special accommodations or an interpreter to participate in this proceeding should contact the City Clerk's office at 772-871-5157, at least seven days prior to the date of the hearing. Copies of the assessment roll, showing the amount of the assessment to be imposed against each parcel of property, and the legal documentation relating to the assessment will be available for inspection in 2025 when the assessment roll is prepared. They can be reviewed in the office of the City Clerk, located on the Third Floor of City Hall, 121 S.W. Port St. Lucie Blvd., Port St. Lucie, Florida. The assessments will be collected on the non-ad valorem portion of the tax bill to be mailed in November 2025 by the St. Lucie County Tax Collector. Failure to pay the assessment will cause a tax certificate to be issued against the property, which may result in a loss of title to your property. If you have any questions, please contact City of Port St. Lucie City Attorney's Office at 772-871-5294, Monday through Friday between 8:00 a.m. and 5:00 p.m.

Sally Walsh, City Clerk
Publish: September 11, 2024