















c:\projects\890-004 (esplanade at tradition) phase 1 to service\drawings\exhibits\890-004-01 code min landscape phase 2 layout\document\plan\89000401L-108.dwg  
 4/29/2023 3:28:29 PM

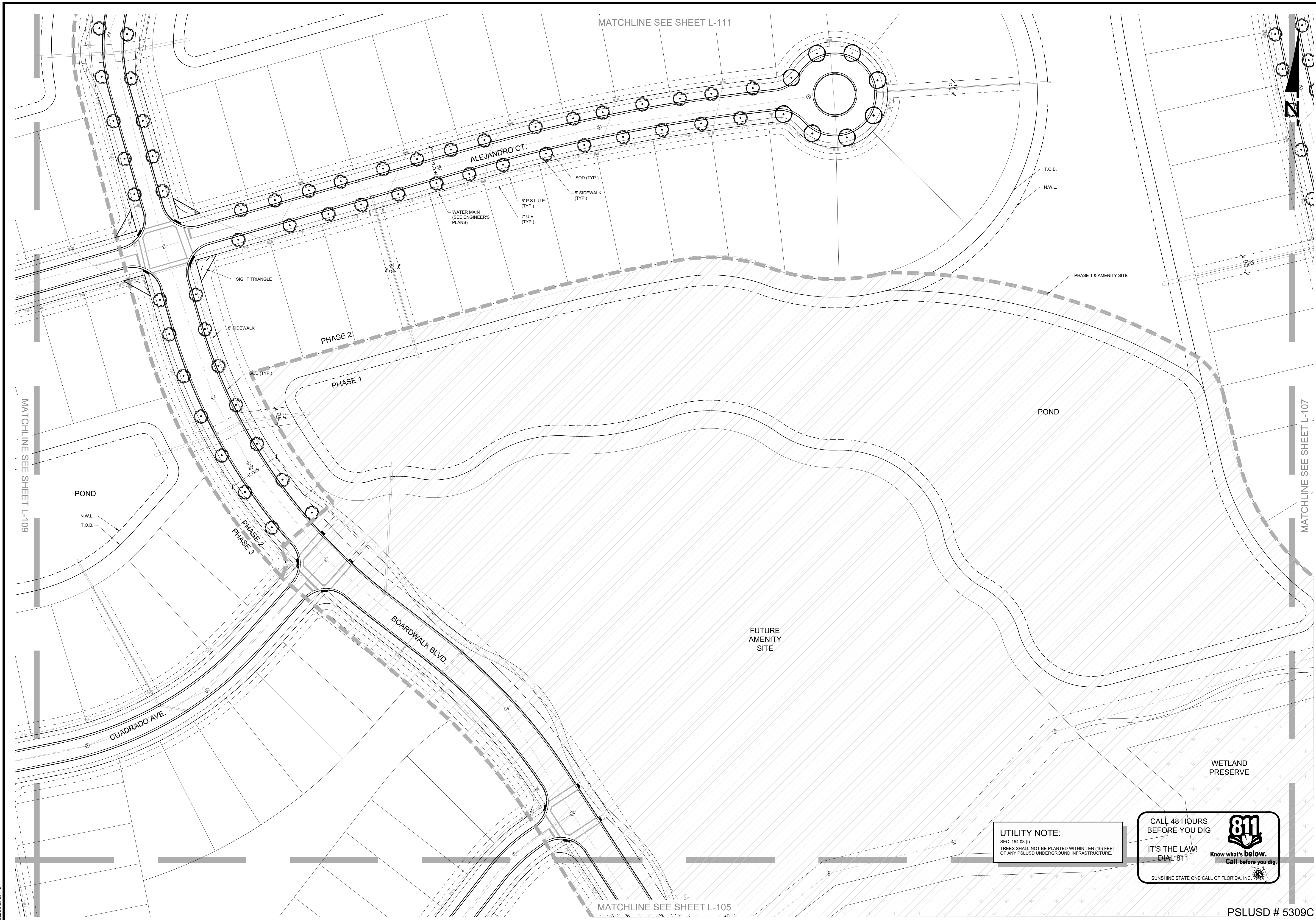

MATCHLINE SEE SHEET L-111

MATCHLINE SEE SHEET L-109

MATCHLINE SEE SHEET L-107

MATCHLINE SEE SHEET L-105

**UTILITY NOTE:**  
 SEC. 154.03 (f)  
 TREES SHALL NOT BE PLANTED WITHIN TEN (10) FEET  
 OF ANY PSLUSD UNDERGROUND INFRASTRUCTURE.

CALL 48 HOURS  
BEFORE YOU DIG

IT'S THE LAW!  
DIAL 811

Know what's below.  
Call before you dig.

SUNSHINE STATE ONE CALL OF FLORIDA, INC.

**WALDROP  
ENGINEERING**

CIVIL ENGINEERING &  
LAND DEVELOPMENT CONSULTANTS

2600 MAITLAND CENTER PARKWAY - SUITE 262 MAITLAND, FL 32751  
 P. 407-775-6500 F. 407-775-6599 EMAIL: info@waldropengineering.com

CODE MINIMUM LANDSCAPE PLANS  
**ESPLANADE AT  
TRADITION**  
 CLIENT: TAYLOR MORRISON OF FLORIDA, INC.  
 LANDSCAPE SITE PLAN

NO.	DATE	REVISIONS
1	04/29/23	REVISED PER CITY REVIEW COMMENTS
2	04/29/23	REVISED PER CITY REVIEW COMMENTS
3	04/29/23	REVISED PER CITY REVIEW COMMENTS
4	04/29/23	REVISED PER CITY REVIEW COMMENTS
5	04/29/23	REVISED PER CITY REVIEW COMMENTS
6	04/29/23	REVISED PER CITY REVIEW COMMENTS
7	04/29/23	REVISED PER CITY REVIEW COMMENTS
8	04/29/23	REVISED PER CITY REVIEW COMMENTS
9	04/29/23	REVISED PER CITY REVIEW COMMENTS
10	04/29/23	REVISED PER CITY REVIEW COMMENTS
11	04/29/23	REVISED PER CITY REVIEW COMMENTS
12	04/29/23	REVISED PER CITY REVIEW COMMENTS
13	04/29/23	REVISED PER CITY REVIEW COMMENTS
14	04/29/23	REVISED PER CITY REVIEW COMMENTS
15	04/29/23	REVISED PER CITY REVIEW COMMENTS
16	04/29/23	REVISED PER CITY REVIEW COMMENTS
17	04/29/23	REVISED PER CITY REVIEW COMMENTS
18	04/29/23	REVISED PER CITY REVIEW COMMENTS
19	04/29/23	REVISED PER CITY REVIEW COMMENTS
20	04/29/23	REVISED PER CITY REVIEW COMMENTS
21	04/29/23	REVISED PER CITY REVIEW COMMENTS
22	04/29/23	REVISED PER CITY REVIEW COMMENTS
23	04/29/23	REVISED PER CITY REVIEW COMMENTS
24	04/29/23	REVISED PER CITY REVIEW COMMENTS
25	04/29/23	REVISED PER CITY REVIEW COMMENTS
26	04/29/23	REVISED PER CITY REVIEW COMMENTS
27	04/29/23	REVISED PER CITY REVIEW COMMENTS
28	04/29/23	REVISED PER CITY REVIEW COMMENTS
29	04/29/23	REVISED PER CITY REVIEW COMMENTS
30	04/29/23	REVISED PER CITY REVIEW COMMENTS
31	04/29/23	REVISED PER CITY REVIEW COMMENTS
32	04/29/23	REVISED PER CITY REVIEW COMMENTS
33	04/29/23	REVISED PER CITY REVIEW COMMENTS
34	04/29/23	REVISED PER CITY REVIEW COMMENTS
35	04/29/23	REVISED PER CITY REVIEW COMMENTS
36	04/29/23	REVISED PER CITY REVIEW COMMENTS
37	04/29/23	REVISED PER CITY REVIEW COMMENTS
38	04/29/23	REVISED PER CITY REVIEW COMMENTS
39	04/29/23	REVISED PER CITY REVIEW COMMENTS
40	04/29/23	REVISED PER CITY REVIEW COMMENTS
41	04/29/23	REVISED PER CITY REVIEW COMMENTS
42	04/29/23	REVISED PER CITY REVIEW COMMENTS
43	04/29/23	REVISED PER CITY REVIEW COMMENTS
44	04/29/23	REVISED PER CITY REVIEW COMMENTS
45	04/29/23	REVISED PER CITY REVIEW COMMENTS
46	04/29/23	REVISED PER CITY REVIEW COMMENTS
47	04/29/23	REVISED PER CITY REVIEW COMMENTS
48	04/29/23	REVISED PER CITY REVIEW COMMENTS
49	04/29/23	REVISED PER CITY REVIEW COMMENTS
50	04/29/23	REVISED PER CITY REVIEW COMMENTS
51	04/29/23	REVISED PER CITY REVIEW COMMENTS
52	04/29/23	REVISED PER CITY REVIEW COMMENTS
53	04/29/23	REVISED PER CITY REVIEW COMMENTS
54	04/29/23	REVISED PER CITY REVIEW COMMENTS
55	04/29/23	REVISED PER CITY REVIEW COMMENTS
56	04/29/23	REVISED PER CITY REVIEW COMMENTS
57	04/29/23	REVISED PER CITY REVIEW COMMENTS
58	04/29/23	REVISED PER CITY REVIEW COMMENTS
59	04/29/23	REVISED PER CITY REVIEW COMMENTS
60	04/29/23	REVISED PER CITY REVIEW COMMENTS
61	04/29/23	REVISED PER CITY REVIEW COMMENTS
62	04/29/23	REVISED PER CITY REVIEW COMMENTS
63	04/29/23	REVISED PER CITY REVIEW COMMENTS
64	04/29/23	REVISED PER CITY REVIEW COMMENTS
65	04/29/23	REVISED PER CITY REVIEW COMMENTS
66	04/29/23	REVISED PER CITY REVIEW COMMENTS
67	04/29/23	REVISED PER CITY REVIEW COMMENTS
68	04/29/23	REVISED PER CITY REVIEW COMMENTS
69	04/29/23	REVISED PER CITY REVIEW COMMENTS
70	04/29/23	REVISED PER CITY REVIEW COMMENTS
71	04/29/23	REVISED PER CITY REVIEW COMMENTS
72	04/29/23	REVISED PER CITY REVIEW COMMENTS
73	04/29/23	REVISED PER CITY REVIEW COMMENTS
74	04/29/23	REVISED PER CITY REVIEW COMMENTS
75	04/29/23	REVISED PER CITY REVIEW COMMENTS
76	04/29/23	REVISED PER CITY REVIEW COMMENTS
77	04/29/23	REVISED PER CITY REVIEW COMMENTS
78	04/29/23	REVISED PER CITY REVIEW COMMENTS
79	04/29/23	REVISED PER CITY REVIEW COMMENTS
80	04/29/23	REVISED PER CITY REVIEW COMMENTS
81	04/29/23	REVISED PER CITY REVIEW COMMENTS
82	04/29/23	REVISED PER CITY REVIEW COMMENTS
83	04/29/23	REVISED PER CITY REVIEW COMMENTS
84	04/29/23	REVISED PER CITY REVIEW COMMENTS
85	04/29/23	REVISED PER CITY REVIEW COMMENTS
86	04/29/23	REVISED PER CITY REVIEW COMMENTS
87	04/29/23	REVISED PER CITY REVIEW COMMENTS
88	04/29/23	REVISED PER CITY REVIEW COMMENTS
89	04/29/23	REVISED PER CITY REVIEW COMMENTS
90	04/29/23	REVISED PER CITY REVIEW COMMENTS
91	04/29/23	REVISED PER CITY REVIEW COMMENTS
92	04/29/23	REVISED PER CITY REVIEW COMMENTS
93	04/29/23	REVISED PER CITY REVIEW COMMENTS
94	04/29/23	REVISED PER CITY REVIEW COMMENTS
95	04/29/23	REVISED PER CITY REVIEW COMMENTS
96	04/29/23	REVISED PER CITY REVIEW COMMENTS
97	04/29/23	REVISED PER CITY REVIEW COMMENTS
98	04/29/23	REVISED PER CITY REVIEW COMMENTS
99	04/29/23	REVISED PER CITY REVIEW COMMENTS
100	04/29/23	REVISED PER CITY REVIEW COMMENTS

SCALE IN FEET  
 0 25 50 100

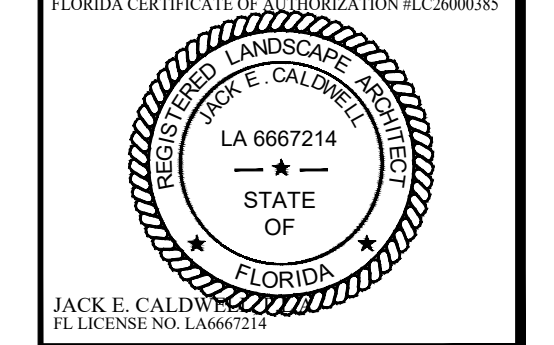

CITY OF PORT ST. LUCIE PROJECT #  
**P21-173**  
 SET NUMBER: 890-004-01  
 SHEET: L-108

PSLUSD # 5309C





c:\projects\890-004 (esplanade at tradition) phase 1 to services\drawings\civil\890-004-01 code min landscape phase 2 layout\document\plan\8900001L-111.dwg  
 4/28/2023 3:28:44 PM

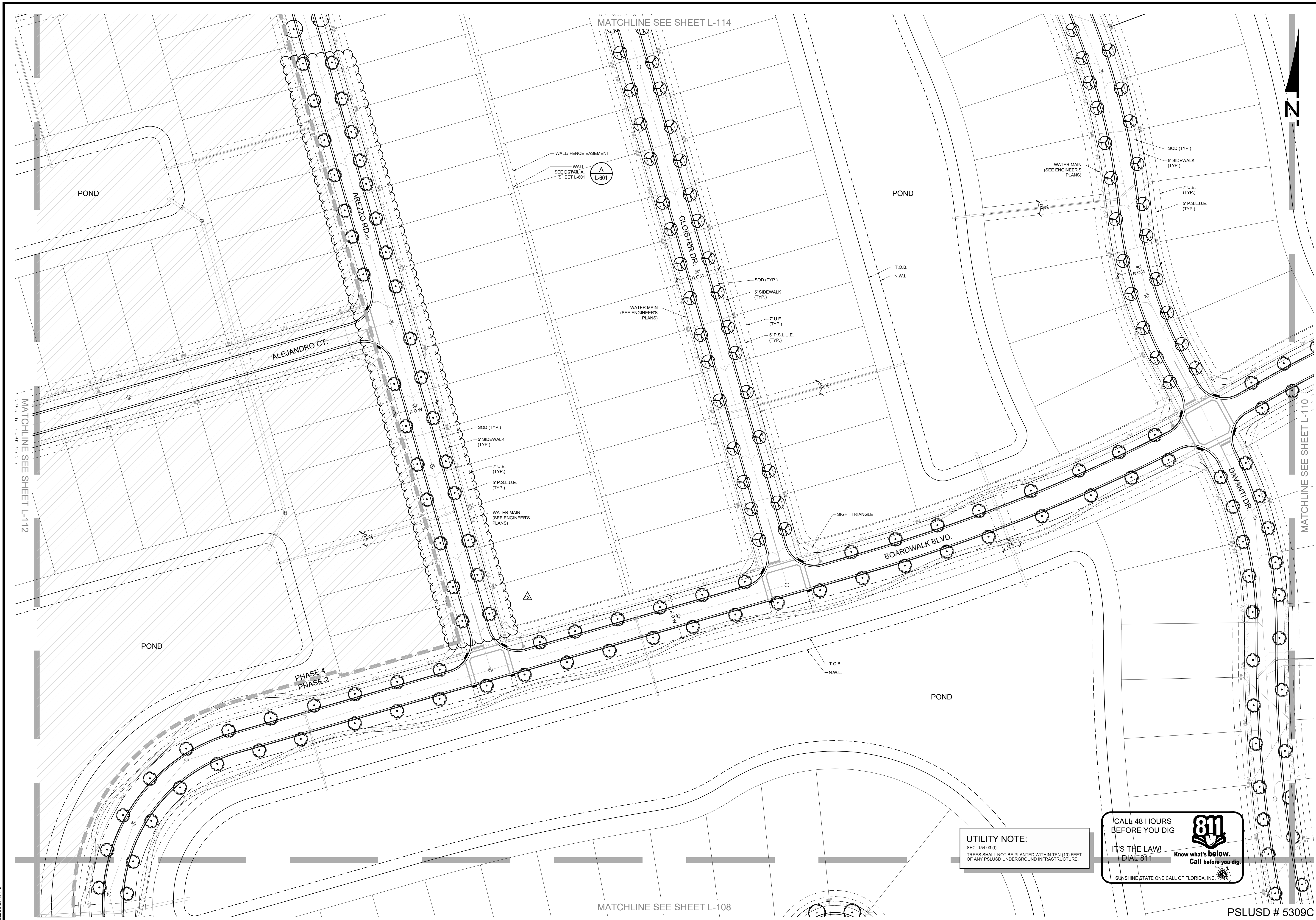

**UTILITY NOTE:**  
 SEC. 154.03 (f)  
 TREES SHALL NOT BE PLANTED WITHIN TEN (10) FEET  
 OF ANY P.S.L.U.D. UNDERGROUND INFRASTRUCTURE.

CALL 48 HOURS  
 BEFORE YOU DIG

**811**

IT'S THE LAW!  
 DIAL 811

Know what's below.  
 Call before you dig.

SUNSHINE STATE ONE CALL OF FLORIDA, INC.

NO.	DATE	REVISIONS
1	04/28/23	REVISED PER CITY REVIEW COMMENTS
2	04/28/23	REVISED PER CITY REVIEW COMMENTS
3	04/28/23	REVISED PER CITY REVIEW COMMENTS
4	04/28/23	REVISED PER CITY REVIEW COMMENTS
5	04/28/23	REVISED PER CITY REVIEW COMMENTS
6	04/28/23	REVISED PER CITY REVIEW COMMENTS
7	04/28/23	REVISED PER CITY REVIEW COMMENTS
8	04/28/23	REVISED PER CITY REVIEW COMMENTS
9	04/28/23	REVISED PER CITY REVIEW COMMENTS
10	04/28/23	REVISED PER CITY REVIEW COMMENTS
11	04/28/23	REVISED PER CITY REVIEW COMMENTS
12	04/28/23	REVISED PER CITY REVIEW COMMENTS
13	04/28/23	REVISED PER CITY REVIEW COMMENTS
14	04/28/23	REVISED PER CITY REVIEW COMMENTS
15	04/28/23	REVISED PER CITY REVIEW COMMENTS
16	04/28/23	REVISED PER CITY REVIEW COMMENTS
17	04/28/23	REVISED PER CITY REVIEW COMMENTS
18	04/28/23	REVISED PER CITY REVIEW COMMENTS
19	04/28/23	REVISED PER CITY REVIEW COMMENTS
20	04/28/23	REVISED PER CITY REVIEW COMMENTS
21	04/28/23	REVISED PER CITY REVIEW COMMENTS
22	04/28/23	REVISED PER CITY REVIEW COMMENTS
23	04/28/23	REVISED PER CITY REVIEW COMMENTS
24	04/28/23	REVISED PER CITY REVIEW COMMENTS
25	04/28/23	REVISED PER CITY REVIEW COMMENTS
26	04/28/23	REVISED PER CITY REVIEW COMMENTS
27	04/28/23	REVISED PER CITY REVIEW COMMENTS
28	04/28/23	REVISED PER CITY REVIEW COMMENTS
29	04/28/23	REVISED PER CITY REVIEW COMMENTS
30	04/28/23	REVISED PER CITY REVIEW COMMENTS
31	04/28/23	REVISED PER CITY REVIEW COMMENTS
32	04/28/23	REVISED PER CITY REVIEW COMMENTS
33	04/28/23	REVISED PER CITY REVIEW COMMENTS
34	04/28/23	REVISED PER CITY REVIEW COMMENTS
35	04/28/23	REVISED PER CITY REVIEW COMMENTS
36	04/28/23	REVISED PER CITY REVIEW COMMENTS
37	04/28/23	REVISED PER CITY REVIEW COMMENTS
38	04/28/23	REVISED PER CITY REVIEW COMMENTS
39	04/28/23	REVISED PER CITY REVIEW COMMENTS
40	04/28/23	REVISED PER CITY REVIEW COMMENTS
41	04/28/23	REVISED PER CITY REVIEW COMMENTS
42	04/28/23	REVISED PER CITY REVIEW COMMENTS
43	04/28/23	REVISED PER CITY REVIEW COMMENTS
44	04/28/23	REVISED PER CITY REVIEW COMMENTS
45	04/28/23	REVISED PER CITY REVIEW COMMENTS
46	04/28/23	REVISED PER CITY REVIEW COMMENTS
47	04/28/23	REVISED PER CITY REVIEW COMMENTS
48	04/28/23	REVISED PER CITY REVIEW COMMENTS
49	04/28/23	REVISED PER CITY REVIEW COMMENTS
50	04/28/23	REVISED PER CITY REVIEW COMMENTS
51	04/28/23	REVISED PER CITY REVIEW COMMENTS
52	04/28/23	REVISED PER CITY REVIEW COMMENTS
53	04/28/23	REVISED PER CITY REVIEW COMMENTS
54	04/28/23	REVISED PER CITY REVIEW COMMENTS
55	04/28/23	REVISED PER CITY REVIEW COMMENTS
56	04/28/23	REVISED PER CITY REVIEW COMMENTS
57	04/28/23	REVISED PER CITY REVIEW COMMENTS
58	04/28/23	REVISED PER CITY REVIEW COMMENTS
59	04/28/23	REVISED PER CITY REVIEW COMMENTS
60	04/28/23	REVISED PER CITY REVIEW COMMENTS
61	04/28/23	REVISED PER CITY REVIEW COMMENTS
62	04/28/23	REVISED PER CITY REVIEW COMMENTS
63	04/28/23	REVISED PER CITY REVIEW COMMENTS
64	04/28/23	REVISED PER CITY REVIEW COMMENTS
65	04/28/23	REVISED PER CITY REVIEW COMMENTS
66	04/28/23	REVISED PER CITY REVIEW COMMENTS
67	04/28/23	REVISED PER CITY REVIEW COMMENTS
68	04/28/23	REVISED PER CITY REVIEW COMMENTS
69	04/28/23	REVISED PER CITY REVIEW COMMENTS
70	04/28/23	REVISED PER CITY REVIEW COMMENTS
71	04/28/23	REVISED PER CITY REVIEW COMMENTS
72	04/28/23	REVISED PER CITY REVIEW COMMENTS
73	04/28/23	REVISED PER CITY REVIEW COMMENTS
74	04/28/23	REVISED PER CITY REVIEW COMMENTS
75	04/28/23	REVISED PER CITY REVIEW COMMENTS
76	04/28/23	REVISED PER CITY REVIEW COMMENTS
77	04/28/23	REVISED PER CITY REVIEW COMMENTS
78	04/28/23	REVISED PER CITY REVIEW COMMENTS
79	04/28/23	REVISED PER CITY REVIEW COMMENTS
80	04/28/23	REVISED PER CITY REVIEW COMMENTS
81	04/28/23	REVISED PER CITY REVIEW COMMENTS
82	04/28/23	REVISED PER CITY REVIEW COMMENTS
83	04/28/23	REVISED PER CITY REVIEW COMMENTS
84	04/28/23	REVISED PER CITY REVIEW COMMENTS
85	04/28/23	REVISED PER CITY REVIEW COMMENTS
86	04/28/23	REVISED PER CITY REVIEW COMMENTS
87	04/28/23	REVISED PER CITY REVIEW COMMENTS
88	04/28/23	REVISED PER CITY REVIEW COMMENTS
89	04/28/23	REVISED PER CITY REVIEW COMMENTS
90	04/28/23	REVISED PER CITY REVIEW COMMENTS
91	04/28/23	REVISED PER CITY REVIEW COMMENTS
92	04/28/23	REVISED PER CITY REVIEW COMMENTS
93	04/28/23	REVISED PER CITY REVIEW COMMENTS
94	04/28/23	REVISED PER CITY REVIEW COMMENTS
95	04/28/23	REVISED PER CITY REVIEW COMMENTS
96	04/28/23	REVISED PER CITY REVIEW COMMENTS
97	04/28/23	REVISED PER CITY REVIEW COMMENTS
98	04/28/23	REVISED PER CITY REVIEW COMMENTS
99	04/28/23	REVISED PER CITY REVIEW COMMENTS
100	04/28/23	REVISED PER CITY REVIEW COMMENTS

SCALE IN FEET  
 0 25 50 100

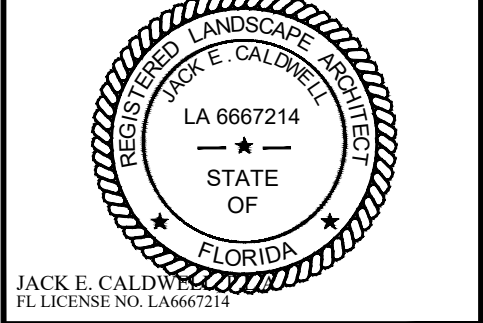

CITY OF PORT ST. LUCIE PROJECT #  
**P21-173**  
 SET NUMBER: 890-004-01  
 SHEET: L-111

**WALDROP ENGINEERING**

2600 MAITLAND CENTER PARKWAY - SUITE 262 MAITLAND, FL 32751  
 P. 407-775-6500 F. 407-775-6599 EMAIL: info@waldropengineering.com

LAND DEVELOPMENT CONSULTANTS

CODE MINIMUM LANDSCAPE PLANS  
**ESPLANADE AT TRADITION**  
 CLIENT: TAYLOR MORRISON OF FLORIDA, INC.  
 LANDSCAPE SITE PLAN





c:\projects\890-004 (esplanade at tradition) phase 1 & 2\misc\drawings\civil\890-004-01 code min landscape phase 2 layout\plan\890-004-L-114.dwg  
 4/29/2023 3:28:06 PM

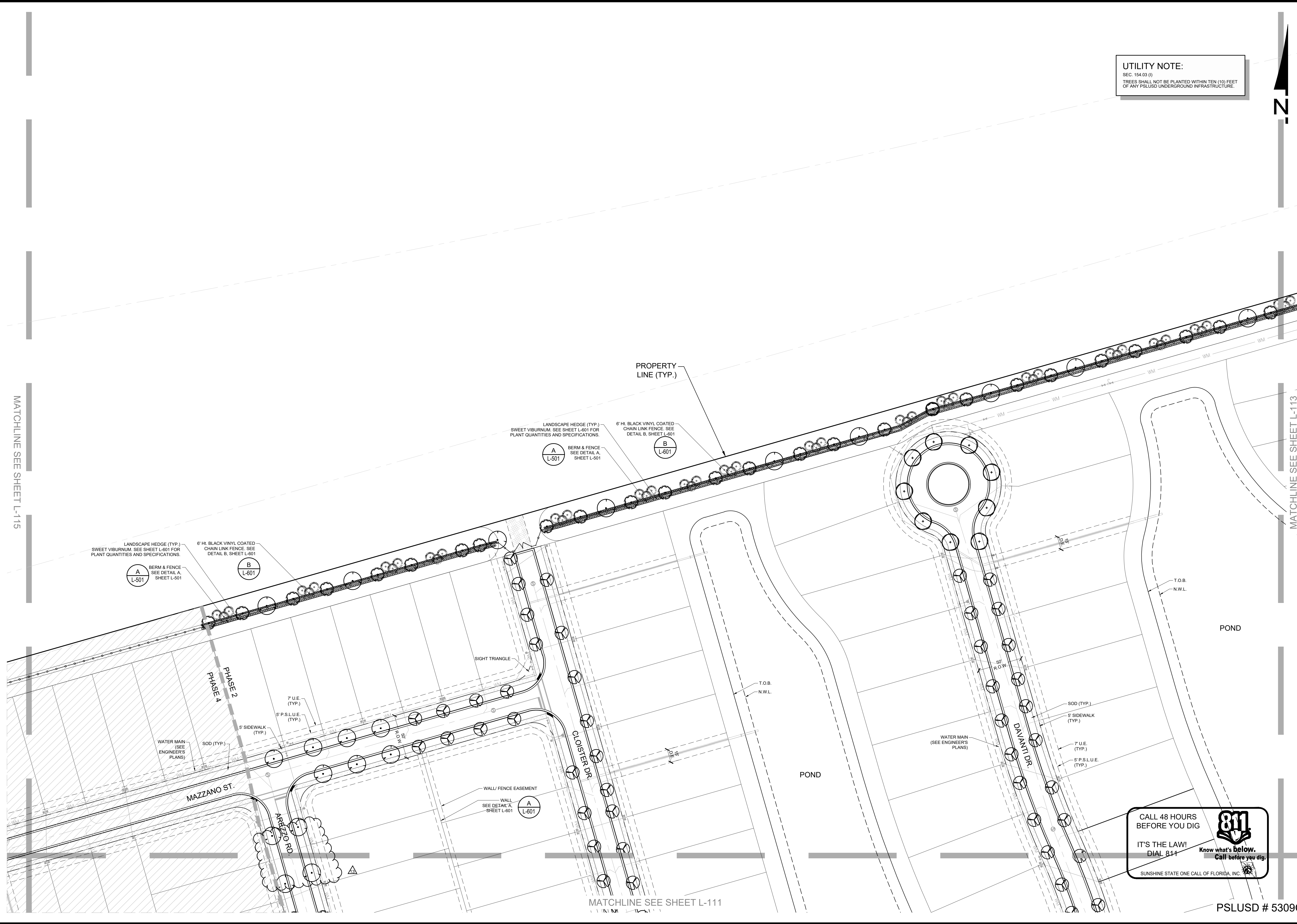

**UTILITY NOTE:**  
 SEC. 154.03 (f)  
 TREES SHALL NOT BE PLANTED WITHIN TEN (10) FEET  
 OF ANY PSLUSD UNDERGROUND INFRASTRUCTURE.



**WALDROP ENGINEERING**  
  
 CIVIL ENGINEERING &  
 LAND DEVELOPMENT CONSULTANTS  
 2600 MAITLAND CENTER PARKWAY - SUITE 262 MAITLAND, FL 32751  
 P. 407-775-6500 F. 407-775-6599 EMAIL: info@waldropengineering.com

**CODE MINIMUM LANDSCAPE PLANS**  
**ESPLANADE AT TRADITION**  
 CLIENT: TAYLOR MORRISON OF FLORIDA, INC.  
 LANDSCAPE SITE PLAN

DATE	REVISIONS	REVISION COMMENTS
04/26/22	01	REVISED PER CITY REVIEW COMMENTS
04/26/22	02	REVISED PER CITY REVIEW COMMENTS
04/26/22	03	REVISED PER CITY REVIEW COMMENTS
04/26/22	04	REVISED PER CITY REVIEW COMMENTS
04/26/22	05	REVISED PER CITY REVIEW COMMENTS
04/26/22	06	REVISED PER CITY REVIEW COMMENTS
04/26/22	07	REVISED PER CITY REVIEW COMMENTS
04/26/22	08	REVISED PER CITY REVIEW COMMENTS
04/26/22	09	REVISED PER CITY REVIEW COMMENTS
04/26/22	10	REVISED PER CITY REVIEW COMMENTS
04/26/22	11	REVISED PER CITY REVIEW COMMENTS
04/26/22	12	REVISED PER CITY REVIEW COMMENTS
04/26/22	13	REVISED PER CITY REVIEW COMMENTS
04/26/22	14	REVISED PER CITY REVIEW COMMENTS
04/26/22	15	REVISED PER CITY REVIEW COMMENTS
04/26/22	16	REVISED PER CITY REVIEW COMMENTS
04/26/22	17	REVISED PER CITY REVIEW COMMENTS
04/26/22	18	REVISED PER CITY REVIEW COMMENTS
04/26/22	19	REVISED PER CITY REVIEW COMMENTS
04/26/22	20	REVISED PER CITY REVIEW COMMENTS

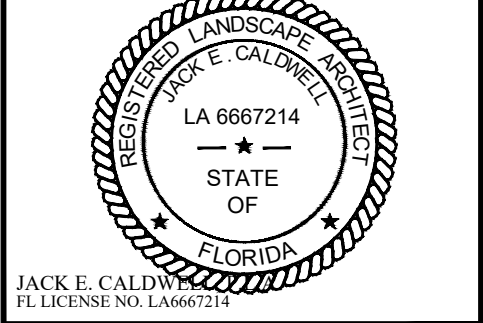
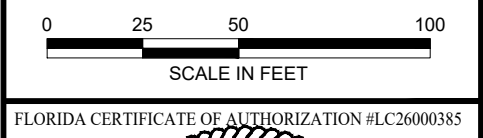

CITY OF PORT ST. LUCIE PROJECT #  
**P21-173**  
 SET NUMBER: 890-004-01  
 SHEET: L-114

**CALL 48 HOURS BEFORE YOU DIG**  
  
**IT'S THE LAW! DIAL 811**  
 Know what's below. Call before you dig.  
 SUNSHINE STATE ONE CALL OF FLORIDA, INC.

PSLUSD # 5309C



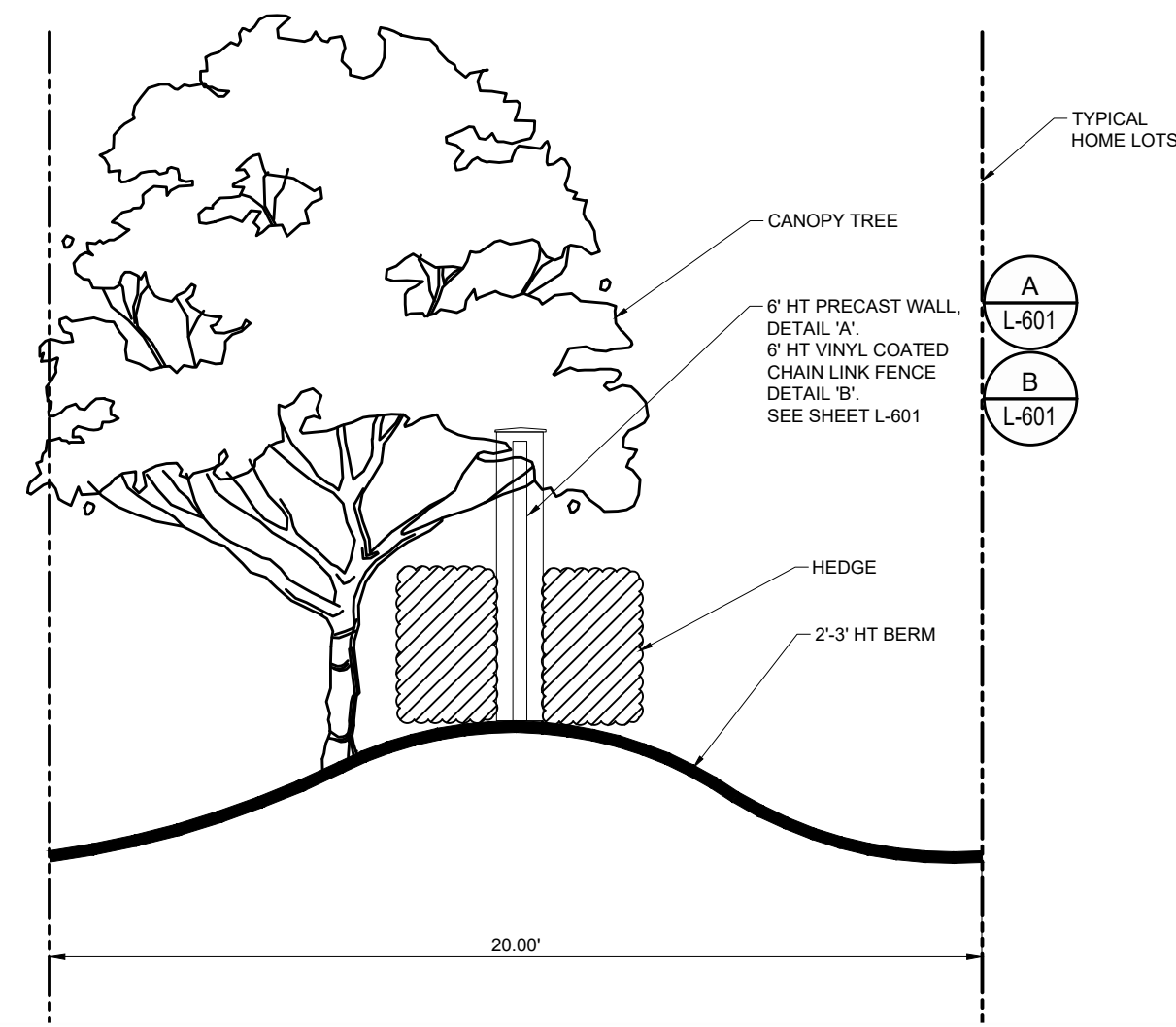

**C** 20' WIDE BUFFER (TYPICAL BOUNDARY) SECTION  
SCALE: 1/4" = 1'

(GRAPHIC IS REPRESENTATIVE OF CODE MINIMUM LANDSCAPE, CITY OF PORT ST. LUCIE: CH. 154 - Sec. 154.03)

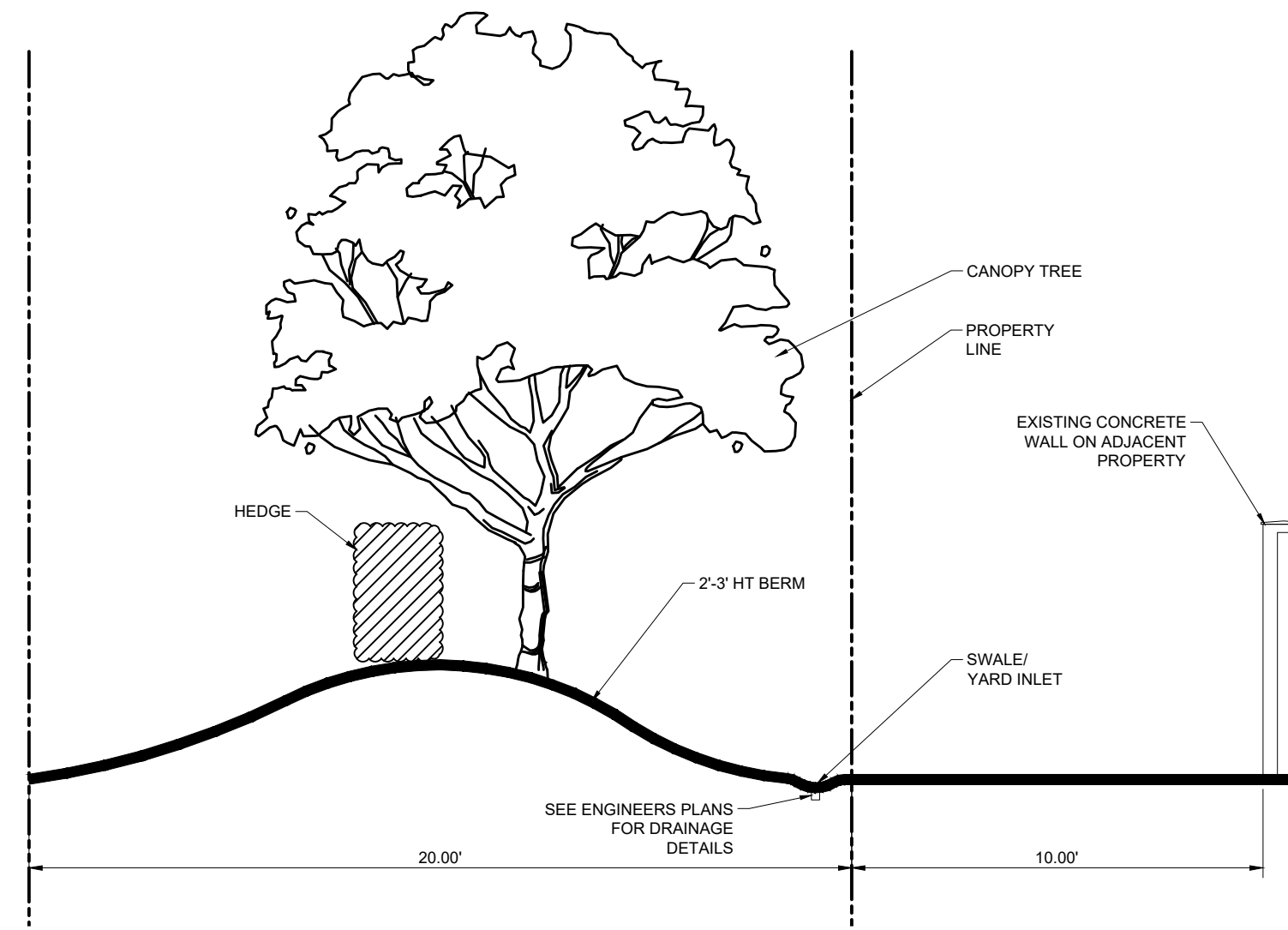

**D** 20' WIDE BUFFER (EAST BOUNDARY) SECTION  
SCALE: 1/4" = 1'

(GRAPHIC IS REPRESENTATIVE OF CODE MINIMUM LANDSCAPE, CITY OF PORT ST. LUCIE: CH. 154 - Sec. 154.03)

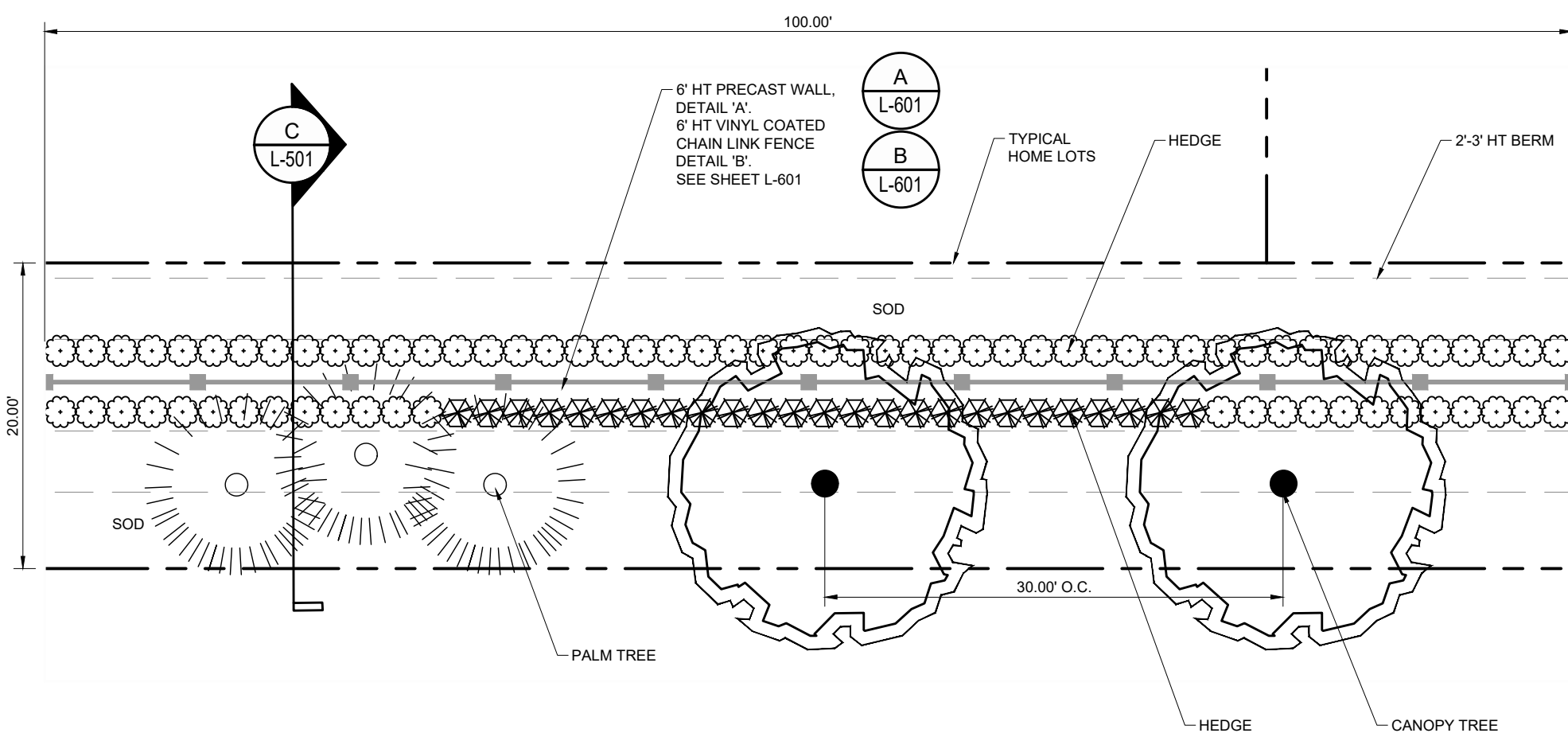

**A** 20' WIDE BUFFER (TYPICAL BOUNDARY)  
SCALE: 1" = 10'

(GRAPHIC IS REPRESENTATIVE OF CODE MINIMUM LANDSCAPE, CITY OF PORT ST. LUCIE: CH. 154 - Sec. 154.03)

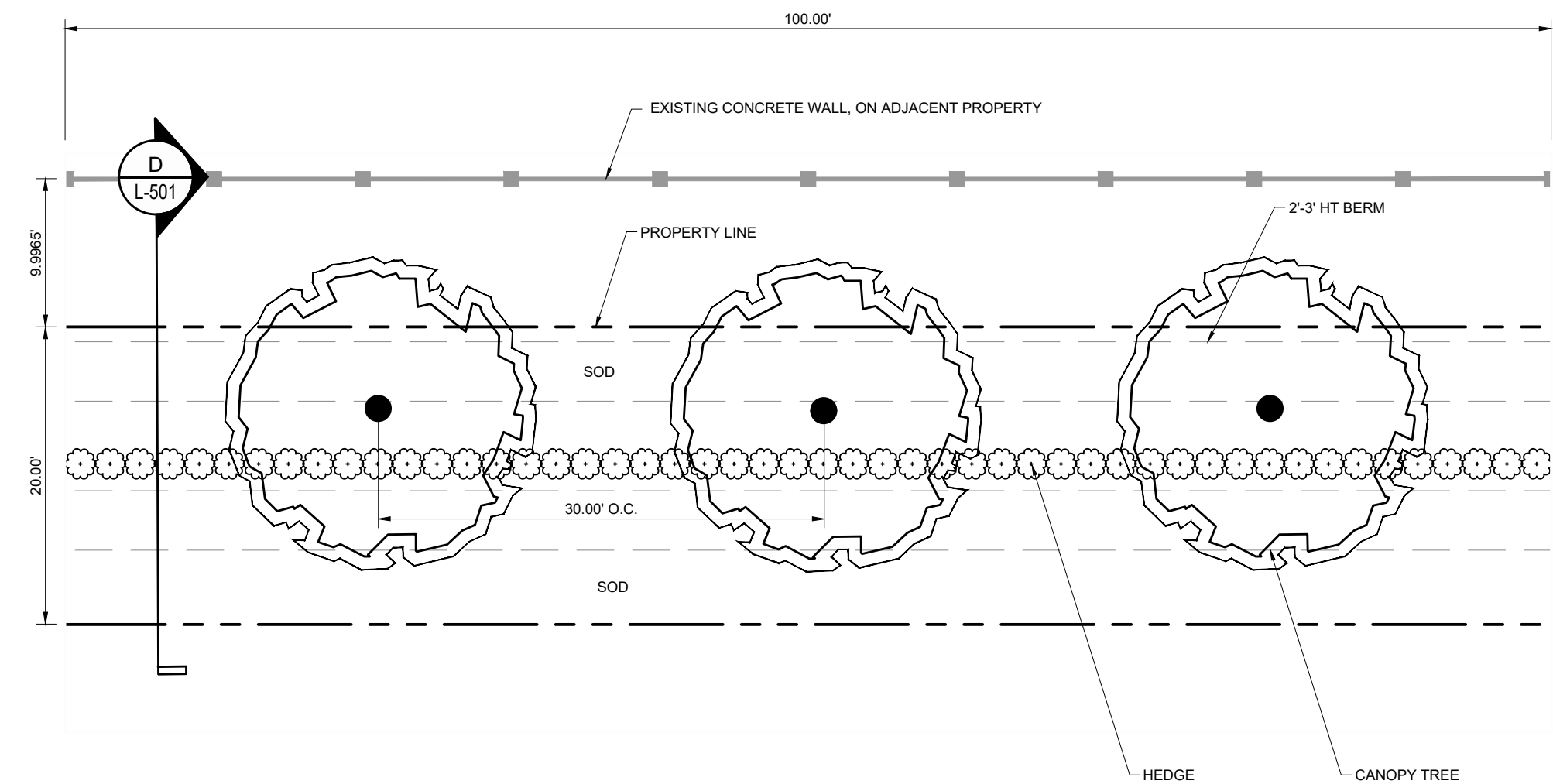

**B** 20' WIDE BUFFER (EAST BOUNDARY)  
SCALE: 1" = 10'

(GRAPHIC IS REPRESENTATIVE OF CODE MINIMUM LANDSCAPE, CITY OF PORT ST. LUCIE: CH. 154 - Sec. 154.03)



**WALDROP ENGINEERING**

ENGINEERING & ARCHITECTURE  
LAND DEVELOPMENT CONSULTANTS

2600 MAITLAND CENTER PARKWAY - SUITE 262 MAITLAND, FL 32751  
P. 407-775-6500 F. 407-775-6599 EMAIL: info@waldropengineering.com

CODE MINIMUM LANDSCAPE PLANS  
**ESPLANADE AT TRADITION**  
CLIENT: TAYLOR MORRISON OF FLORIDA, INC.  
BUFFER DETAILS

NO.	DATE	REVISIONS
1	04/26/22	REVISED PER CITY REVIEW COMMENTS
2	05/10/22	REVISED PER CITY REVIEW COMMENTS
3	05/10/22	REVISED PER CITY REVIEW COMMENTS
4	05/10/22	REVISED PER CITY REVIEW COMMENTS
5	05/10/22	REVISED PER CITY REVIEW COMMENTS
6	05/10/22	REVISED PER CITY REVIEW COMMENTS
7	05/10/22	REVISED PER CITY REVIEW COMMENTS
8	05/10/22	REVISED PER CITY REVIEW COMMENTS
9	05/10/22	REVISED PER CITY REVIEW COMMENTS
10	05/10/22	REVISED PER CITY REVIEW COMMENTS
11	05/10/22	REVISED PER CITY REVIEW COMMENTS
12	05/10/22	REVISED PER CITY REVIEW COMMENTS
13	05/10/22	REVISED PER CITY REVIEW COMMENTS
14	05/10/22	REVISED PER CITY REVIEW COMMENTS
15	05/10/22	REVISED PER CITY REVIEW COMMENTS
16	05/10/22	REVISED PER CITY REVIEW COMMENTS
17	05/10/22	REVISED PER CITY REVIEW COMMENTS
18	05/10/22	REVISED PER CITY REVIEW COMMENTS
19	05/10/22	REVISED PER CITY REVIEW COMMENTS
20	05/10/22	REVISED PER CITY REVIEW COMMENTS
21	05/10/22	REVISED PER CITY REVIEW COMMENTS
22	05/10/22	REVISED PER CITY REVIEW COMMENTS
23	05/10/22	REVISED PER CITY REVIEW COMMENTS
24	05/10/22	REVISED PER CITY REVIEW COMMENTS
25	05/10/22	REVISED PER CITY REVIEW COMMENTS
26	05/10/22	REVISED PER CITY REVIEW COMMENTS
27	05/10/22	REVISED PER CITY REVIEW COMMENTS
28	05/10/22	REVISED PER CITY REVIEW COMMENTS
29	05/10/22	REVISED PER CITY REVIEW COMMENTS
30	05/10/22	REVISED PER CITY REVIEW COMMENTS
31	05/10/22	REVISED PER CITY REVIEW COMMENTS
32	05/10/22	REVISED PER CITY REVIEW COMMENTS
33	05/10/22	REVISED PER CITY REVIEW COMMENTS
34	05/10/22	REVISED PER CITY REVIEW COMMENTS
35	05/10/22	REVISED PER CITY REVIEW COMMENTS
36	05/10/22	REVISED PER CITY REVIEW COMMENTS
37	05/10/22	REVISED PER CITY REVIEW COMMENTS
38	05/10/22	REVISED PER CITY REVIEW COMMENTS
39	05/10/22	REVISED PER CITY REVIEW COMMENTS
40	05/10/22	REVISED PER CITY REVIEW COMMENTS
41	05/10/22	REVISED PER CITY REVIEW COMMENTS
42	05/10/22	REVISED PER CITY REVIEW COMMENTS
43	05/10/22	REVISED PER CITY REVIEW COMMENTS
44	05/10/22	REVISED PER CITY REVIEW COMMENTS
45	05/10/22	REVISED PER CITY REVIEW COMMENTS
46	05/10/22	REVISED PER CITY REVIEW COMMENTS
47	05/10/22	REVISED PER CITY REVIEW COMMENTS
48	05/10/22	REVISED PER CITY REVIEW COMMENTS
49	05/10/22	REVISED PER CITY REVIEW COMMENTS
50	05/10/22	REVISED PER CITY REVIEW COMMENTS

SCALE AS SHOWN

FLORIDA CERTIFICATE OF ADOPTION - LC2000035

JACK E. CALDWELL  
FLORIDA  
LA 6667214  
STATE OF FLORIDA

CITY OF PORT ST. LUCIE PROJECT #  
**P21-173**

SET NUMBER: 890-004-01  
SHEET: L-501

PSLUSD # 5309C

c:\projects\890-004 (esplanade at tradition) phase 1a services\drawings-esplanade\890-004-01 code min landscape phase 2 layout\document plan\89000401L-501.dwg  
4/26/2022 3:28:12 PM







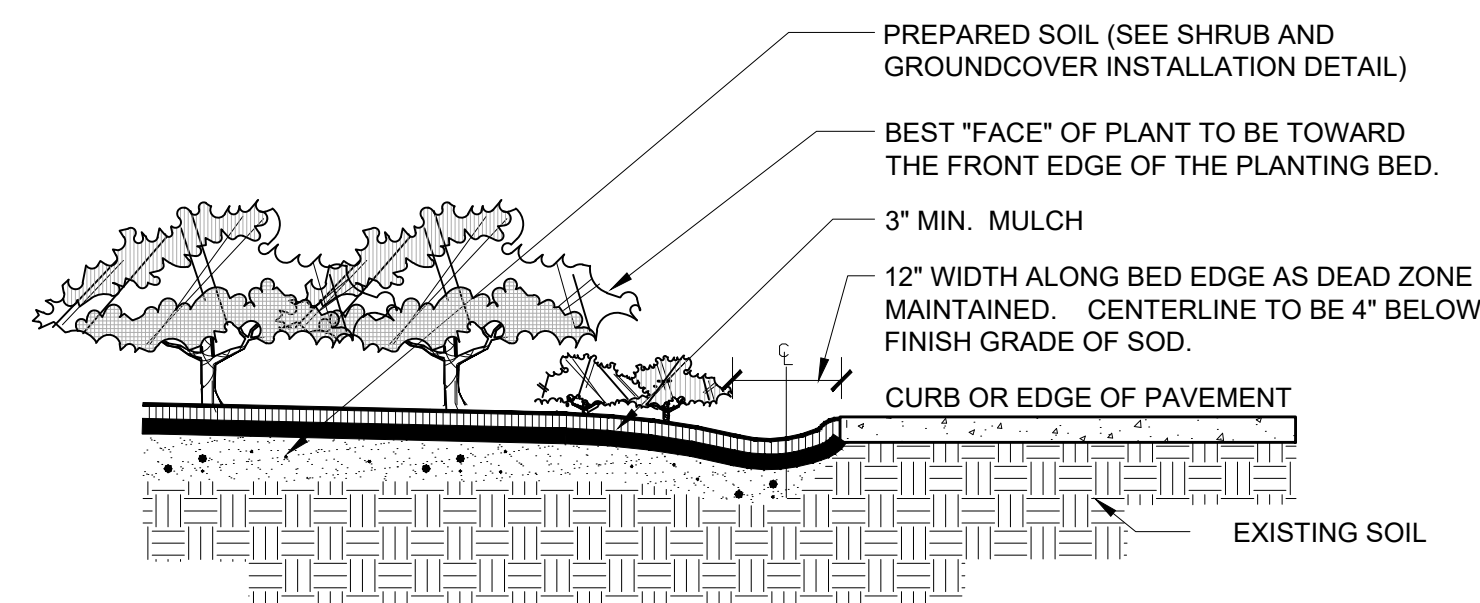

SECTION

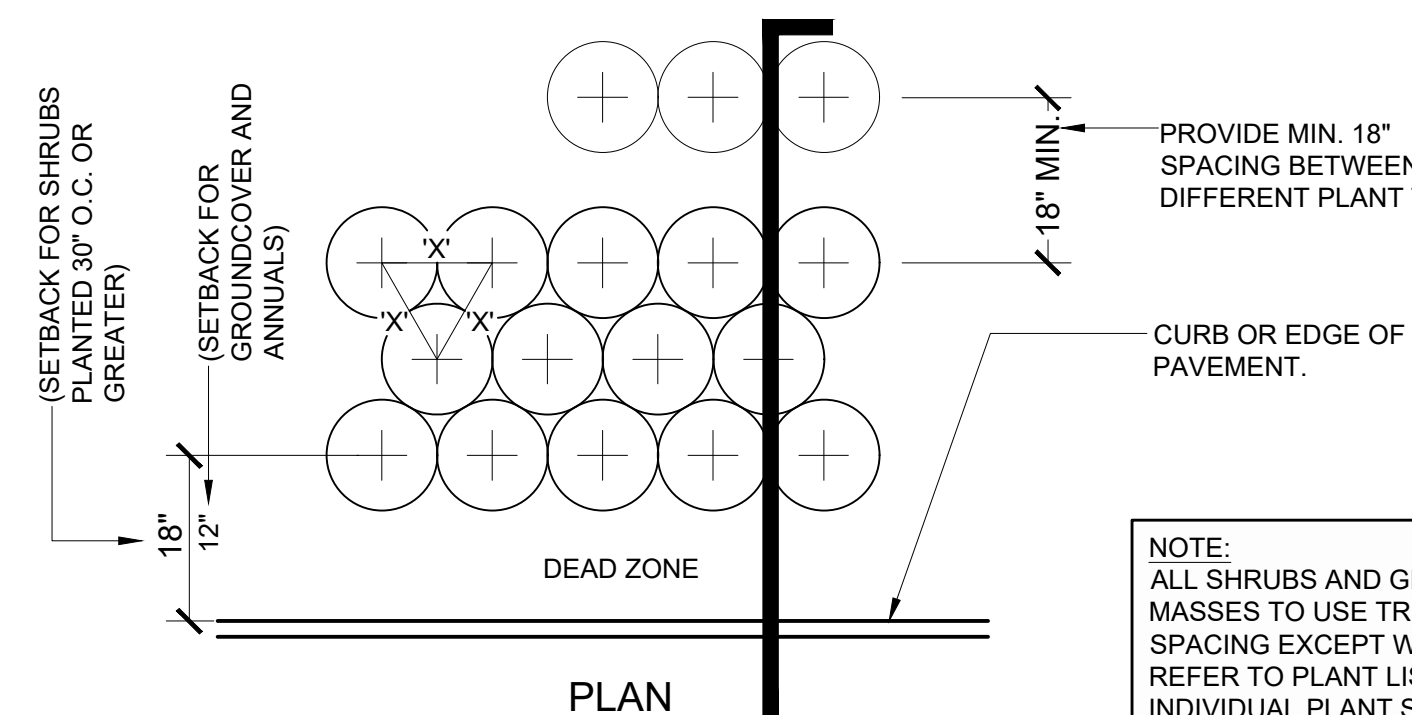

PLAN

NOTE:  
ALL SHRUBS AND GROUNDCOVER MASSES TO USE TRIANGULAR SPACING EXCEPT WHERE NOTED REFER TO PLANT LIST FOR INDIVIDUAL PLANT SPACING 'X'.

D TYPICAL PLANT SPACING DIAGRAM  
SCALE: N.T.S.

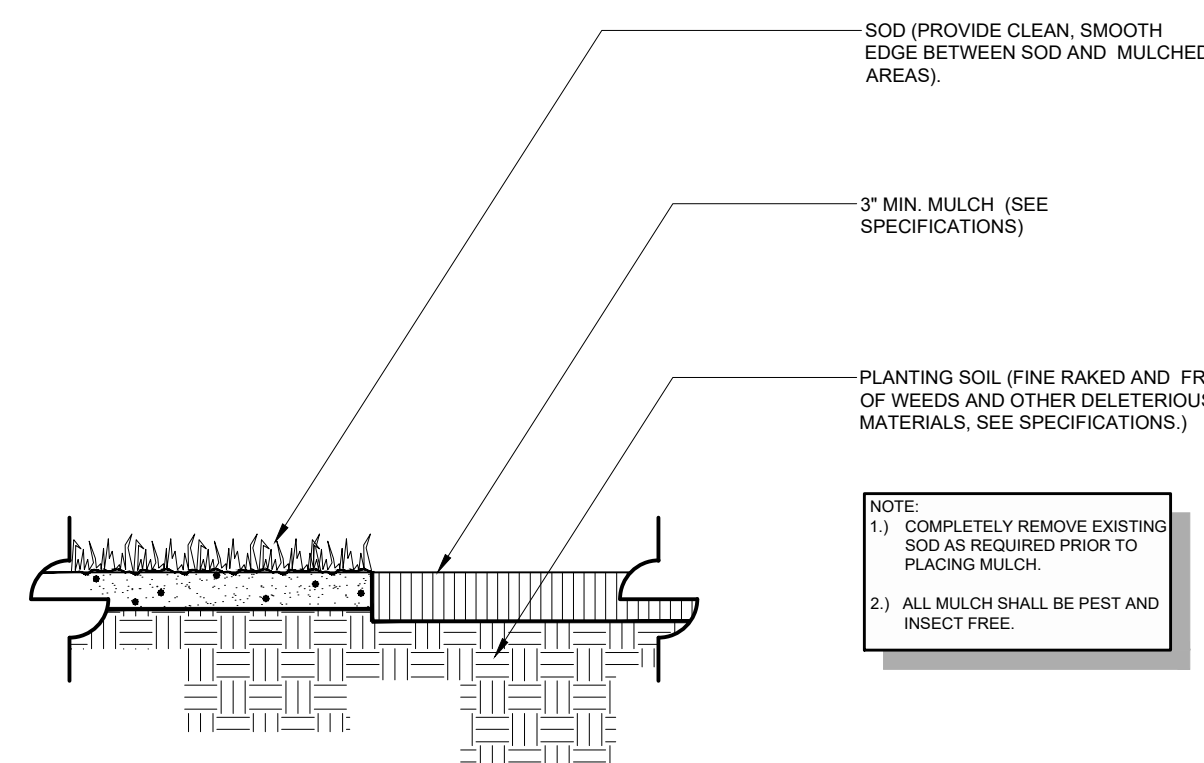

NOTE:  
1) COMPLETELY REMOVE EXISTING SOD AS REQUIRED PRIOR TO PLACING MULCH.  
2) ALL MULCH SHALL BE PEST AND INSECT FREE.

E MULCH APPLICATION ~ TYPE 1  
SCALE: N.T.S.

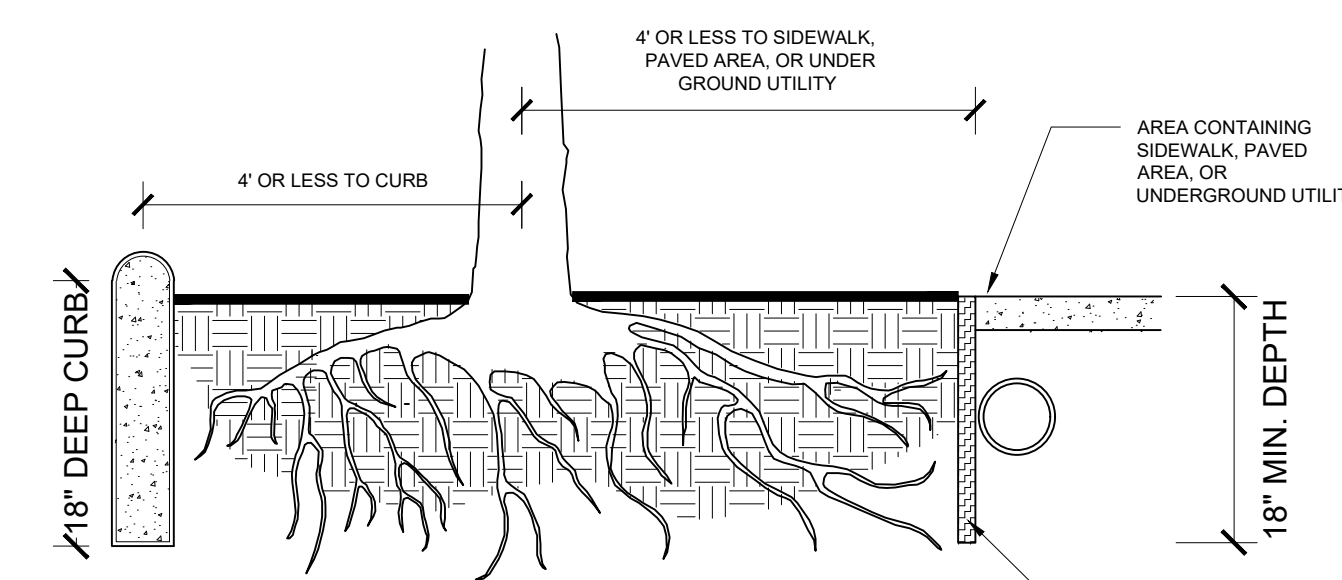

SECTION

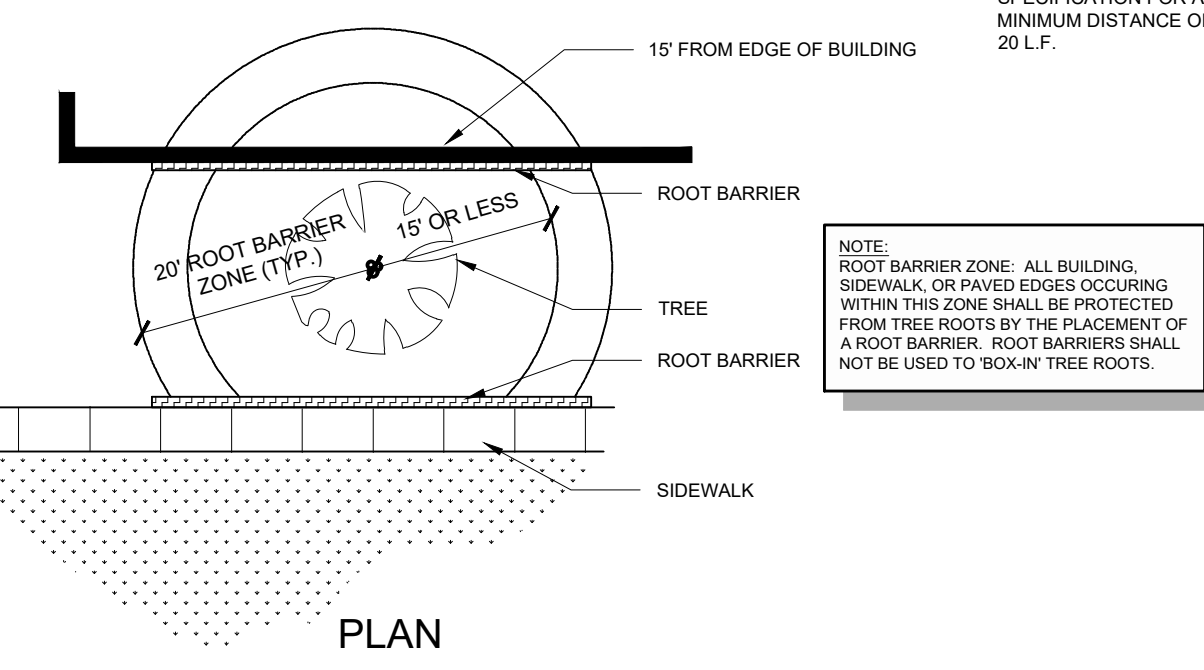

PLAN

NOTE:  
ROOT BARRIER ZONE. ALL BUILDING, SIDEWALK, OR PAVED EDGES OCCURRING WITHIN THIS ZONE SHALL BE PROTECTED FROM TREE ROOTS BY THE PLACEMENT OF A ROOT BARRIER. ROOT BARRIERS SHALL NOT BE USED TO "BOX-IN" TREE ROOTS.

F ROOT BARRIER DETAIL  
SCALE: N.T.S.

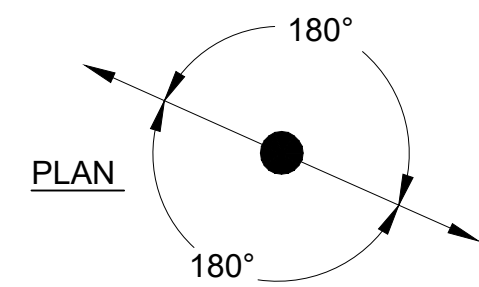

NOTES:  
1. FINAL TREE STAKING DETAILS AND PLACEMENT TO BE APPROVED BY THE LANDSCAPE ARCHITECT  
2. CONTRACTOR SHALL ASSURE FREE DRAINAGE/PERCOLATION OF ALL PLANTING PITS PRIOR TO INSTALLATION.

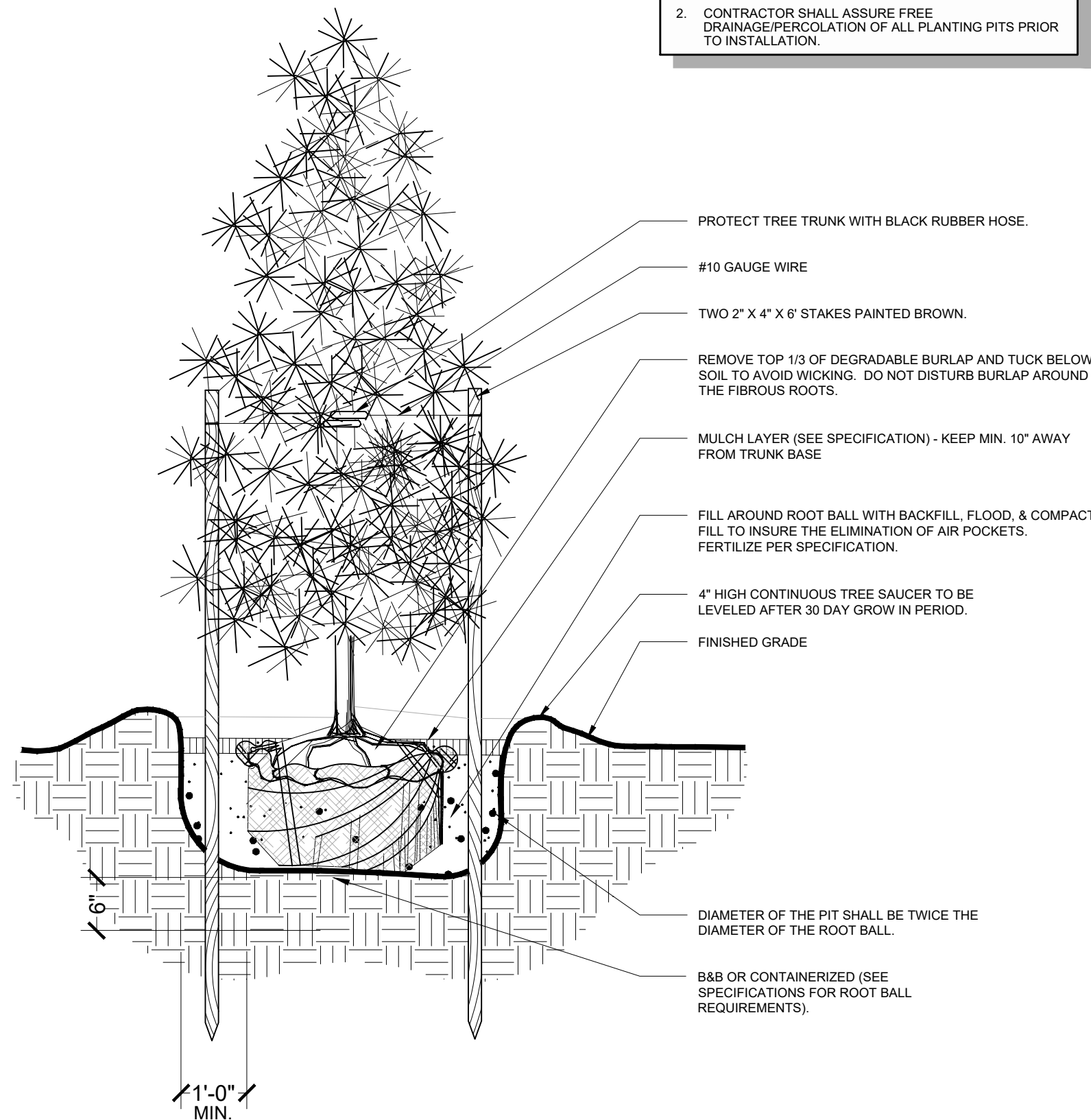

A SMALL TREE INSTALLATION  
SCALE: N.T.S.

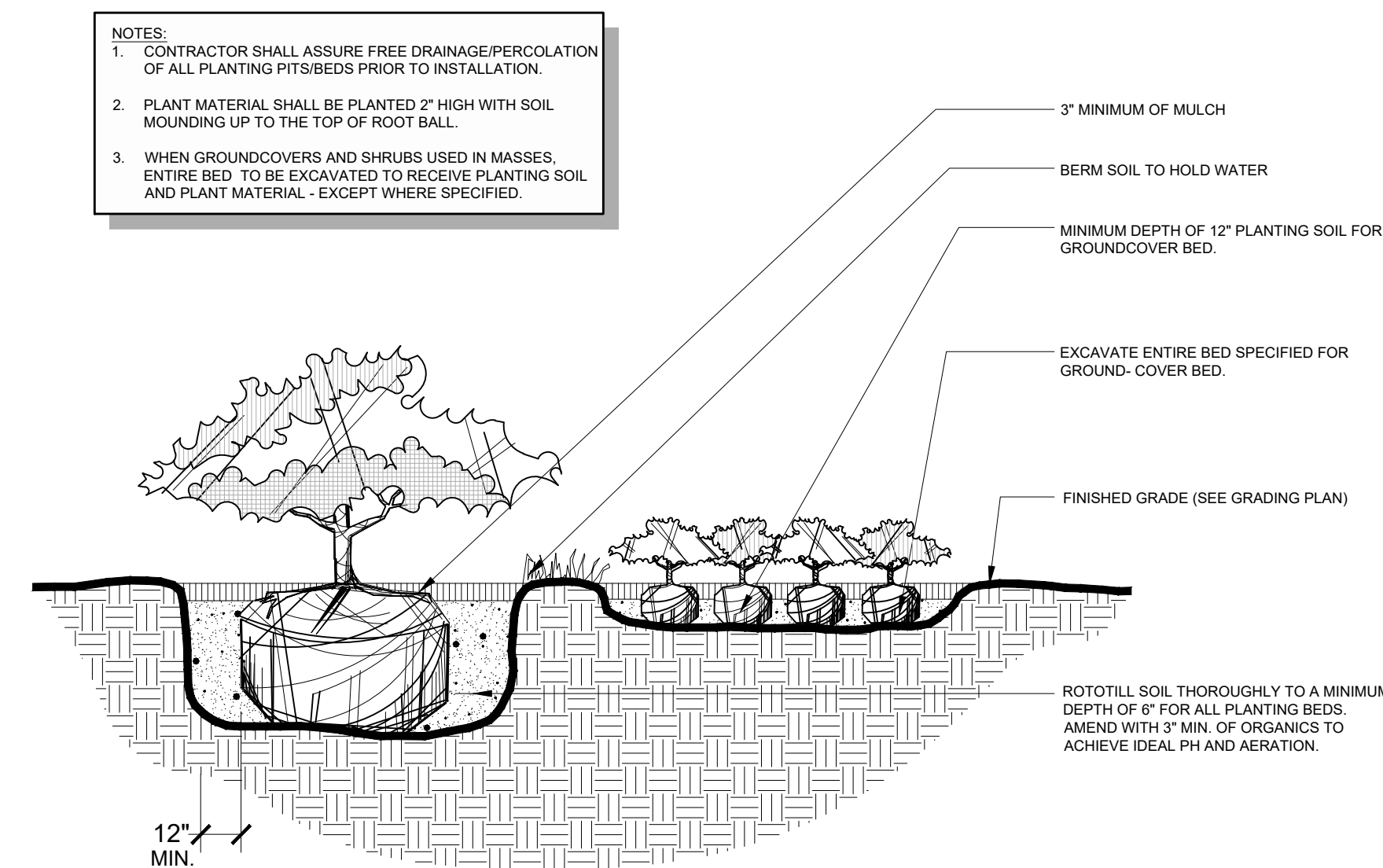

B SHRUB AND GROUNDCOVER INSTALLATION  
SCALE: N.T.S.

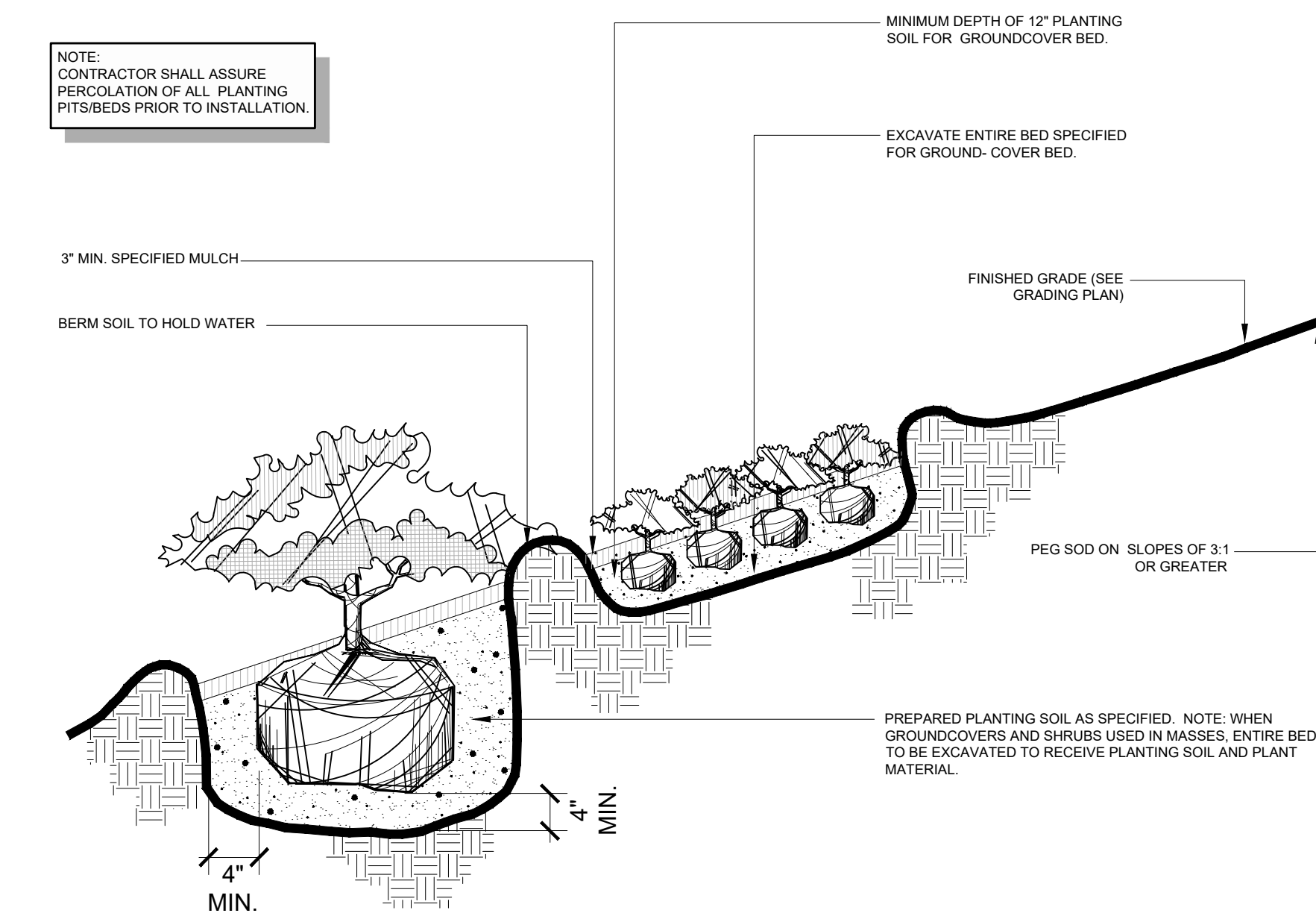

C SHRUB AND GROUNDCOVER ON SLOPE  
SCALE: N.T.S.

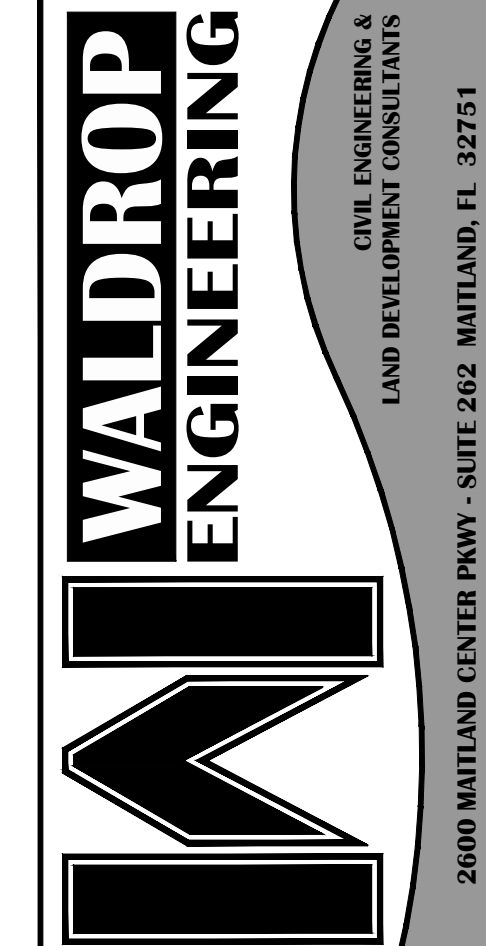

CODE MINIMUM LANDSCAPE PLANS

**ESPLANADE AT TRADITION**

CLIENT: TAYLOR MORRISON OF FLORIDA, INC.

LANDSCAPE DETAILS

NO.	DATE	REVISIONS
1	04/26/22	REVISED PER CITY REVIEW COMMENTS
2	05/03/22	REVISED PER CITY REVIEW COMMENTS
3	05/10/22	REVISED PER CITY REVIEW COMMENTS
4	05/17/22	REVISED PER CITY REVIEW COMMENTS
5	05/24/22	REVISED PER CITY REVIEW COMMENTS
6	06/07/22	REVISED PER CITY REVIEW COMMENTS
7	06/14/22	REVISED PER CITY REVIEW COMMENTS
8	06/21/22	REVISED PER CITY REVIEW COMMENTS
9	06/28/22	REVISED PER CITY REVIEW COMMENTS
10	07/05/22	REVISED PER CITY REVIEW COMMENTS
11	07/12/22	REVISED PER CITY REVIEW COMMENTS
12	07/19/22	REVISED PER CITY REVIEW COMMENTS
13	07/26/22	REVISED PER CITY REVIEW COMMENTS
14	08/02/22	REVISED PER CITY REVIEW COMMENTS
15	08/09/22	REVISED PER CITY REVIEW COMMENTS
16	08/16/22	REVISED PER CITY REVIEW COMMENTS
17	08/23/22	REVISED PER CITY REVIEW COMMENTS
18	08/30/22	REVISED PER CITY REVIEW COMMENTS
19	09/06/22	REVISED PER CITY REVIEW COMMENTS
20	09/13/22	REVISED PER CITY REVIEW COMMENTS
21	09/20/22	REVISED PER CITY REVIEW COMMENTS
22	09/27/22	REVISED PER CITY REVIEW COMMENTS
23	10/04/22	REVISED PER CITY REVIEW COMMENTS
24	10/11/22	REVISED PER CITY REVIEW COMMENTS
25	10/18/22	REVISED PER CITY REVIEW COMMENTS
26	10/25/22	REVISED PER CITY REVIEW COMMENTS
27	11/01/22	REVISED PER CITY REVIEW COMMENTS
28	11/08/22	REVISED PER CITY REVIEW COMMENTS
29	11/15/22	REVISED PER CITY REVIEW COMMENTS
30	11/22/22	REVISED PER CITY REVIEW COMMENTS
31	11/29/22	REVISED PER CITY REVIEW COMMENTS
32	12/06/22	REVISED PER CITY REVIEW COMMENTS
33	12/13/22	REVISED PER CITY REVIEW COMMENTS
34	12/20/22	REVISED PER CITY REVIEW COMMENTS
35	12/27/22	REVISED PER CITY REVIEW COMMENTS
36	01/03/23	REVISED PER CITY REVIEW COMMENTS
37	01/10/23	REVISED PER CITY REVIEW COMMENTS
38	01/17/23	REVISED PER CITY REVIEW COMMENTS
39	01/24/23	REVISED PER CITY REVIEW COMMENTS
40	01/31/23	REVISED PER CITY REVIEW COMMENTS
41	02/07/23	REVISED PER CITY REVIEW COMMENTS
42	02/14/23	REVISED PER CITY REVIEW COMMENTS
43	02/21/23	REVISED PER CITY REVIEW COMMENTS
44	02/28/23	REVISED PER CITY REVIEW COMMENTS
45	03/06/23	REVISED PER CITY REVIEW COMMENTS
46	03/13/23	REVISED PER CITY REVIEW COMMENTS
47	03/20/23	REVISED PER CITY REVIEW COMMENTS
48	03/27/23	REVISED PER CITY REVIEW COMMENTS
49	04/03/23	REVISED PER CITY REVIEW COMMENTS
50	04/10/23	REVISED PER CITY REVIEW COMMENTS
51	04/17/23	REVISED PER CITY REVIEW COMMENTS
52	04/24/23	REVISED PER CITY REVIEW COMMENTS
53	05/01/23	REVISED PER CITY REVIEW COMMENTS
54	05/08/23	REVISED PER CITY REVIEW COMMENTS
55	05/15/23	REVISED PER CITY REVIEW COMMENTS
56	05/22/23	REVISED PER CITY REVIEW COMMENTS
57	05/29/23	REVISED PER CITY REVIEW COMMENTS
58	06/05/23	REVISED PER CITY REVIEW COMMENTS
59	06/12/23	REVISED PER CITY REVIEW COMMENTS
60	06/19/23	REVISED PER CITY REVIEW COMMENTS
61	06/26/23	REVISED PER CITY REVIEW COMMENTS
62	07/03/23	REVISED PER CITY REVIEW COMMENTS
63	07/10/23	REVISED PER CITY REVIEW COMMENTS
64	07/17/23	REVISED PER CITY REVIEW COMMENTS
65	07/24/23	REVISED PER CITY REVIEW COMMENTS
66	07/31/23	REVISED PER CITY REVIEW COMMENTS
67	08/07/23	REVISED PER CITY REVIEW COMMENTS
68	08/14/23	REVISED PER CITY REVIEW COMMENTS
69	08/21/23	REVISED PER CITY REVIEW COMMENTS
70	08/28/23	REVISED PER CITY REVIEW COMMENTS
71	09/04/23	REVISED PER CITY REVIEW COMMENTS
72	09/11/23	REVISED PER CITY REVIEW COMMENTS
73	09/18/23	REVISED PER CITY REVIEW COMMENTS
74	09/25/23	REVISED PER CITY REVIEW COMMENTS
75	10/02/23	REVISED PER CITY REVIEW COMMENTS
76	10/09/23	REVISED PER CITY REVIEW COMMENTS
77	10/16/23	REVISED PER CITY REVIEW COMMENTS
78	10/23/23	REVISED PER CITY REVIEW COMMENTS
79	10/30/23	REVISED PER CITY REVIEW COMMENTS
80	11/06/23	REVISED PER CITY REVIEW COMMENTS
81	11/13/23	REVISED PER CITY REVIEW COMMENTS
82	11/20/23	REVISED PER CITY REVIEW COMMENTS
83	11/27/23	REVISED PER CITY REVIEW COMMENTS
84	12/04/23	REVISED PER CITY REVIEW COMMENTS
85	12/11/23	REVISED PER CITY REVIEW COMMENTS
86	12/18/23	REVISED PER CITY REVIEW COMMENTS
87	12/25/23	REVISED PER CITY REVIEW COMMENTS
88	01/01/24	REVISED PER CITY REVIEW COMMENTS
89	01/08/24	REVISED PER CITY REVIEW COMMENTS
90	01/15/24	REVISED PER CITY REVIEW COMMENTS
91	01/22/24	REVISED PER CITY REVIEW COMMENTS
92	01/29/24	REVISED PER CITY REVIEW COMMENTS
93	02/05/24	REVISED PER CITY REVIEW COMMENTS
94	02/12/24	REVISED PER CITY REVIEW COMMENTS
95	02/19/24	REVISED PER CITY REVIEW COMMENTS
96	02/26/24	REVISED PER CITY REVIEW COMMENTS
97	03/05/24	REVISED PER CITY REVIEW COMMENTS
98	03/12/24	REVISED PER CITY REVIEW COMMENTS
99	03/19/24	REVISED PER CITY REVIEW COMMENTS
100	03/26/24	REVISED PER CITY REVIEW COMMENTS

NOT TO SCALE

FLORIDA CERTIFICATE OF ADOPTION LA 6667214

JACK E. CALDWELL  
FLORIDA LICENSE NO. 11466273

CITY OF PORT ST. LUCIE PROJECT #  
**P21-173**

SET NUMBER: 890-004-01

SHEET: L-503

c:\projects\890-004 (esplanade at tradition) phase 1 landscape\890-004-01 code min landscape phase 2 layout\document\plan\89000401L-503.dwg  
4/26/2022 3:29:23 PM



