

CDNK RETAIL/OFFICE

1485 SW GATLIN BOULEVARD, PORT ST. LUCIE, FL

MARCH 23, 2021

PLANTING PLAN

PSL PROJ # P21_011

PLANTING SPECIFICATIONS

- All plant materials shall be Florida Number 1 as provided in the most current edition of the "Grades and Standards for Nursery Plants, Parts I & II" prepared by the state Department of Agriculture and Consumer Services.
- All trees, shrubs and groundcovers shall be of the sizes as specified in the Plant List.
- Quantities listed on the Plant List are for estimating purposes. Contractor shall verify all quantities. Mulch, Topsoil, Fertilizer, etc. shall be included in the unit cost of the plants.
- Where there is a discrepancy either in quantities, plant names, sizes or specifications between the plan of Plant List, the plan takes precedence.
- All planting beds and water basins for trees shall be covered with a 3" minimum depth of shredded cypress, eucalyptus or Floramulch grade "B" or better. Refer to the Plant List for the specified mulch type. Alternative mulch material is required to be approved by Landscape Architect.
- The Planting Plan shall be installed in compliance with all existing codes and applicable deed restrictions.
- PLANTING SOIL:** All trees and shrubs shall be planted with a minimum of 12" topsoil around and beneath the rootball. Minimum topsoil shall be 6" for groundcover areas.
- Planting soil to be a weed-free mixture of 50% sand and 50% mulch or other organic planting material suitable to the Landscape Architect.
- Contractor is responsible for determining all utility locations and installing facilities so as to not conflict. All damage to existing utilities or improvements caused by Contractor shall be repaired at no additional cost to the Owner.
- Contractor shall be responsible for providing final grading of all associated planting areas.
- After final grade, area to be raked to 6" depth and all rock and foreign inorganic materials removed and disposed of properly off site.
- All planting holes to be hand dug except where machine dug holds will not adversely affect or damage utilities or improvements (see note 7).
- No plunging of any tree or palm will be accepted. All plants to be planted at the nursery grade or slightly higher.
- Contractor shall stake and guy all trees and palms at time of planting as per the appropriate detail. Contractor is responsible for the maintenance and repair of all staking and staking during the Warranty Period and removal and disposal of staking after the establishment period.
- Fertilizer is required for plantings and shall be NPK 16-4-8 at 12.5 lbs/1000 s.f. or 345 lbs/acre. Nitrogen 50% slow release form and fertilizer to include secondary/minor micronutrients.
- SUBSTITUTIONS AND CHANGES:** All substitutions and changes shall be approved in writing prior to installation. Any discrepancies between plans, site and specifications shall be brought to the immediate attention of the Landscape Architect, the Owner and governing municipality.
- WATERING:** All plant material shall be watered in at time of planting in accordance with standard nursery practices. In addition, Contractor will continue watering of plant material until substantial completion and as needed and thereafter for a period of 2-months.
- All new plant material shall be guaranteed for 1-year from time of final acceptance of the project. Any plant material not in a healthy growing condition will be replaced by the Contractor at no additional cost to the Owner within 10-days of notification. For all replacement plant material, the warranty period shall be extended an additional 45-days beyond the original warranty period. All trees that lean or are blown over, caused by winds less than 75-MPH, will be re-set and braced by the contractor at no additional cost to the Owner.
- The successful bidder shall furnish to the Owner a unit price breakdown for all materials. The Owner may, at its discretion, add or delete from the materials utilizing the unit price breakdown submitted.
- No plant material will be accepted showing evidence of cable, chain marks, equipment scars, or otherwise damaged.
- Plant material will not be accepted when the ball of earth surrounding its roots has been cracked, broken or otherwise damaged.
- Root prune all field grown trees a minimum of 8-weeks prior to planting.

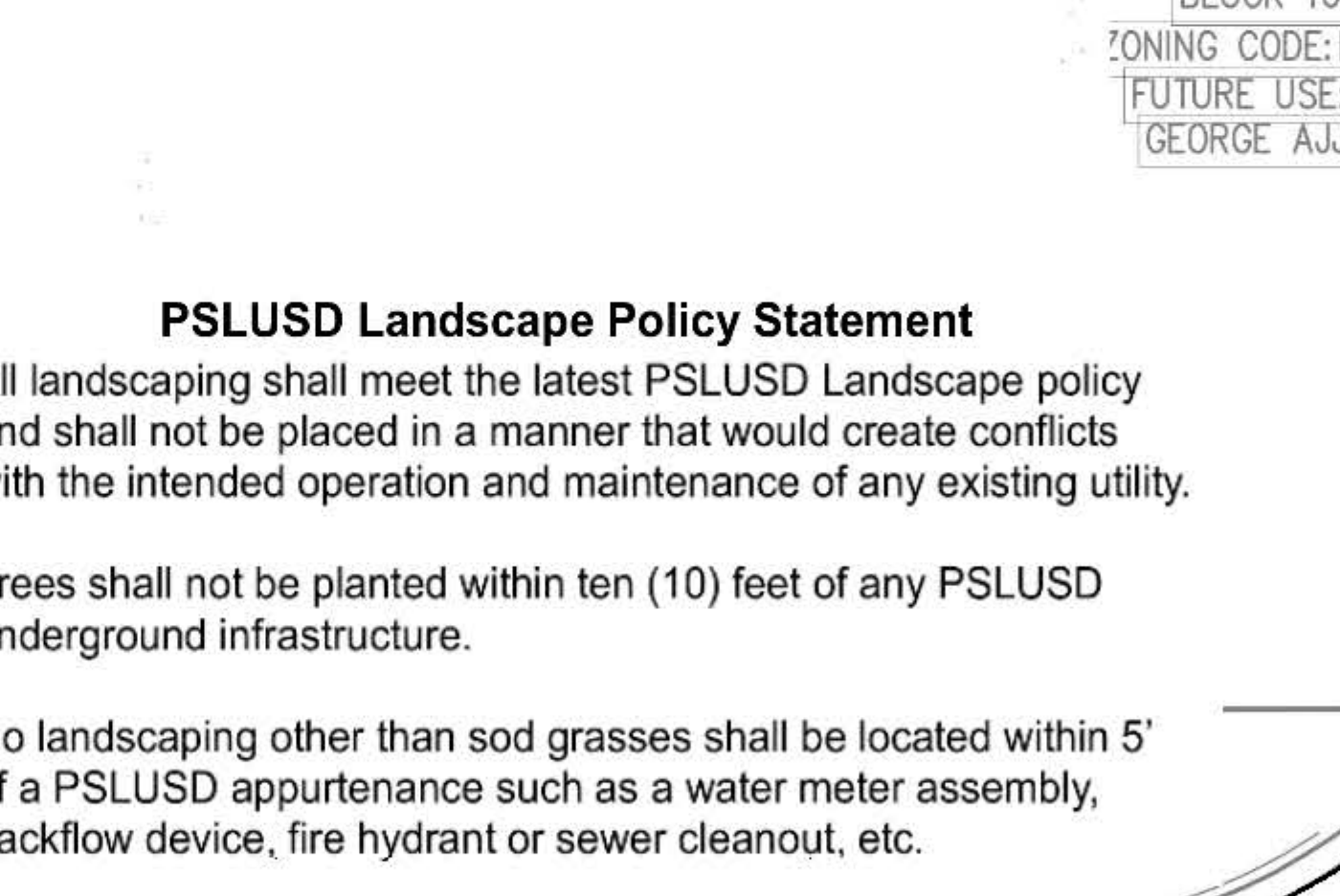
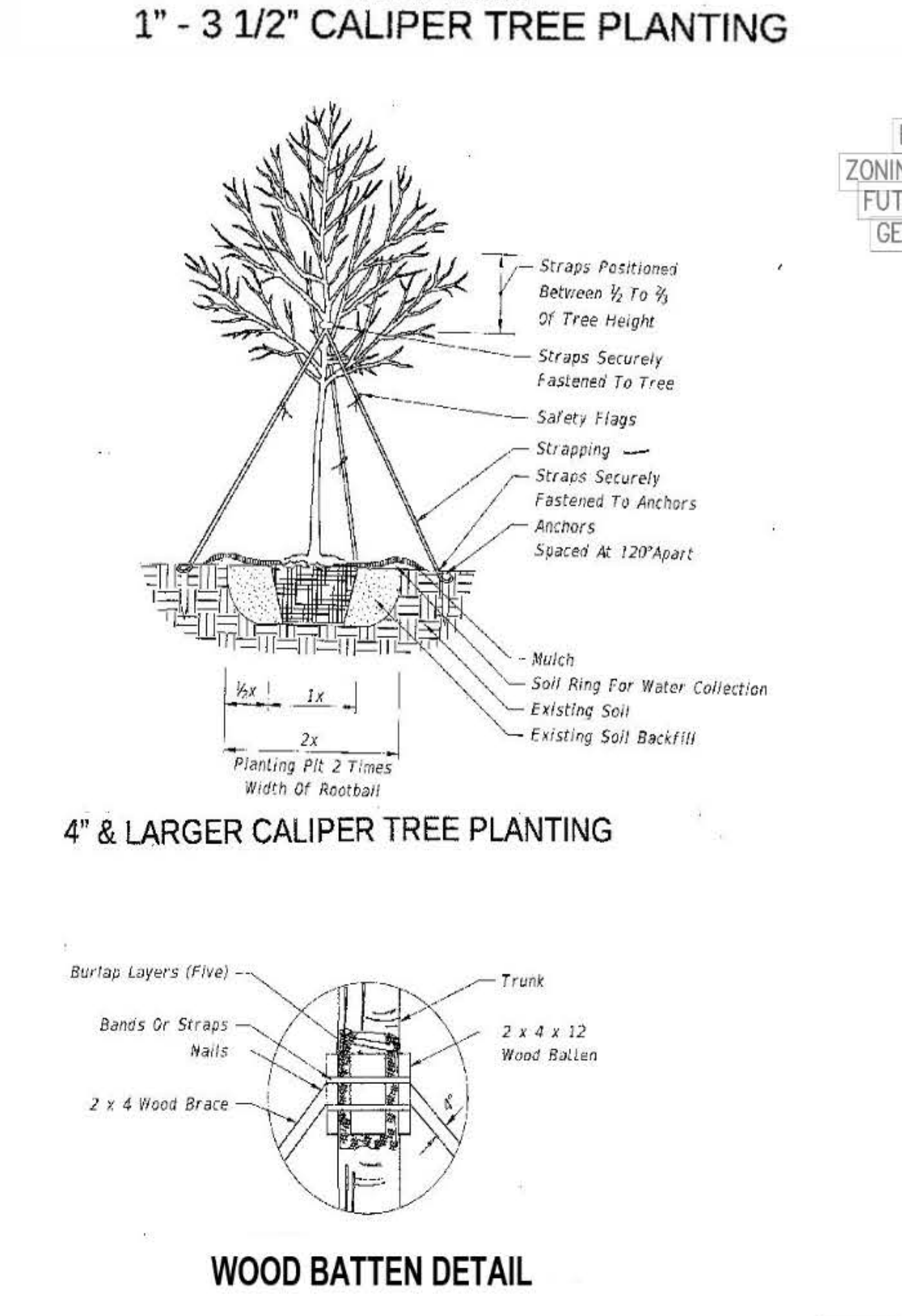
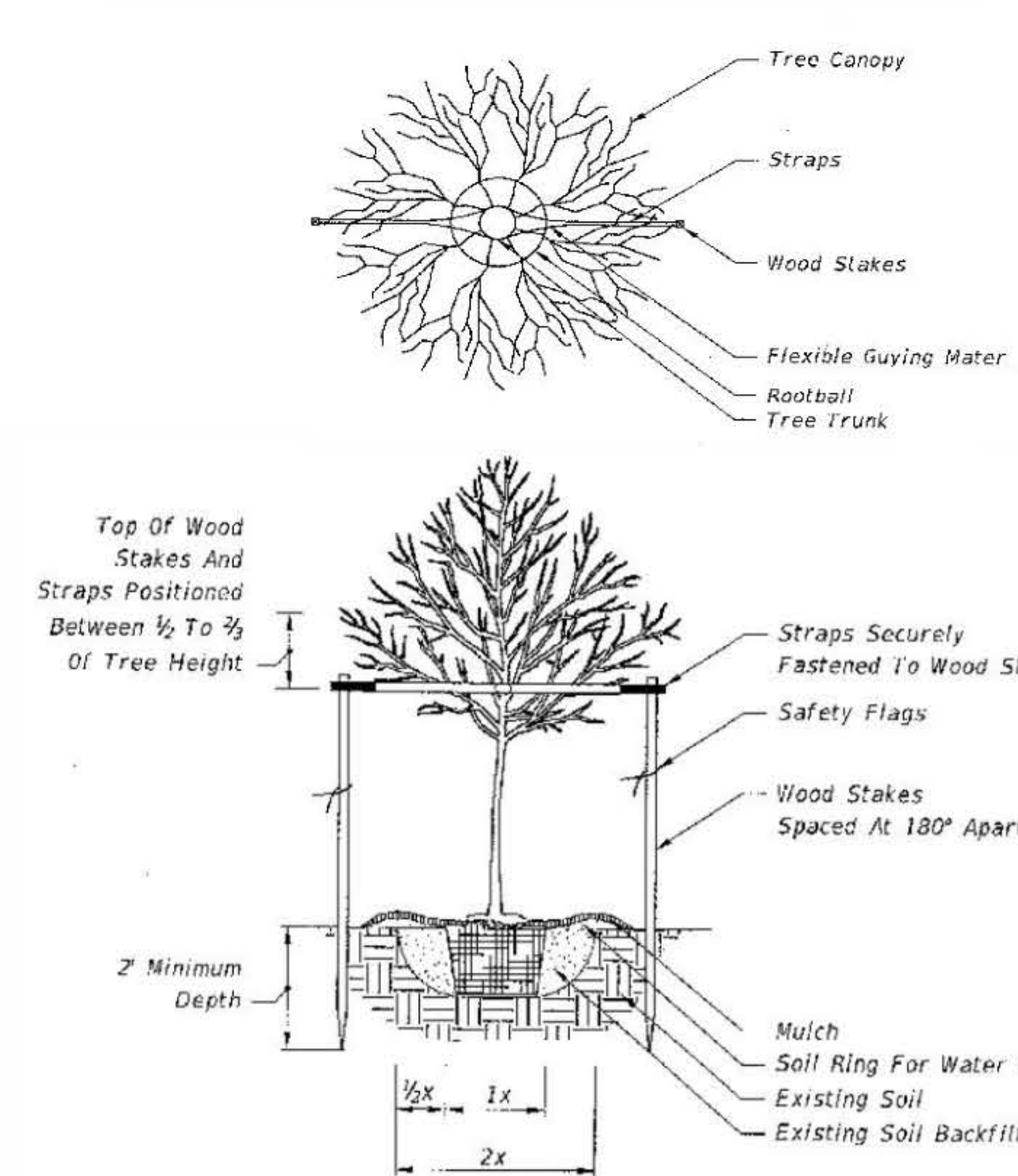
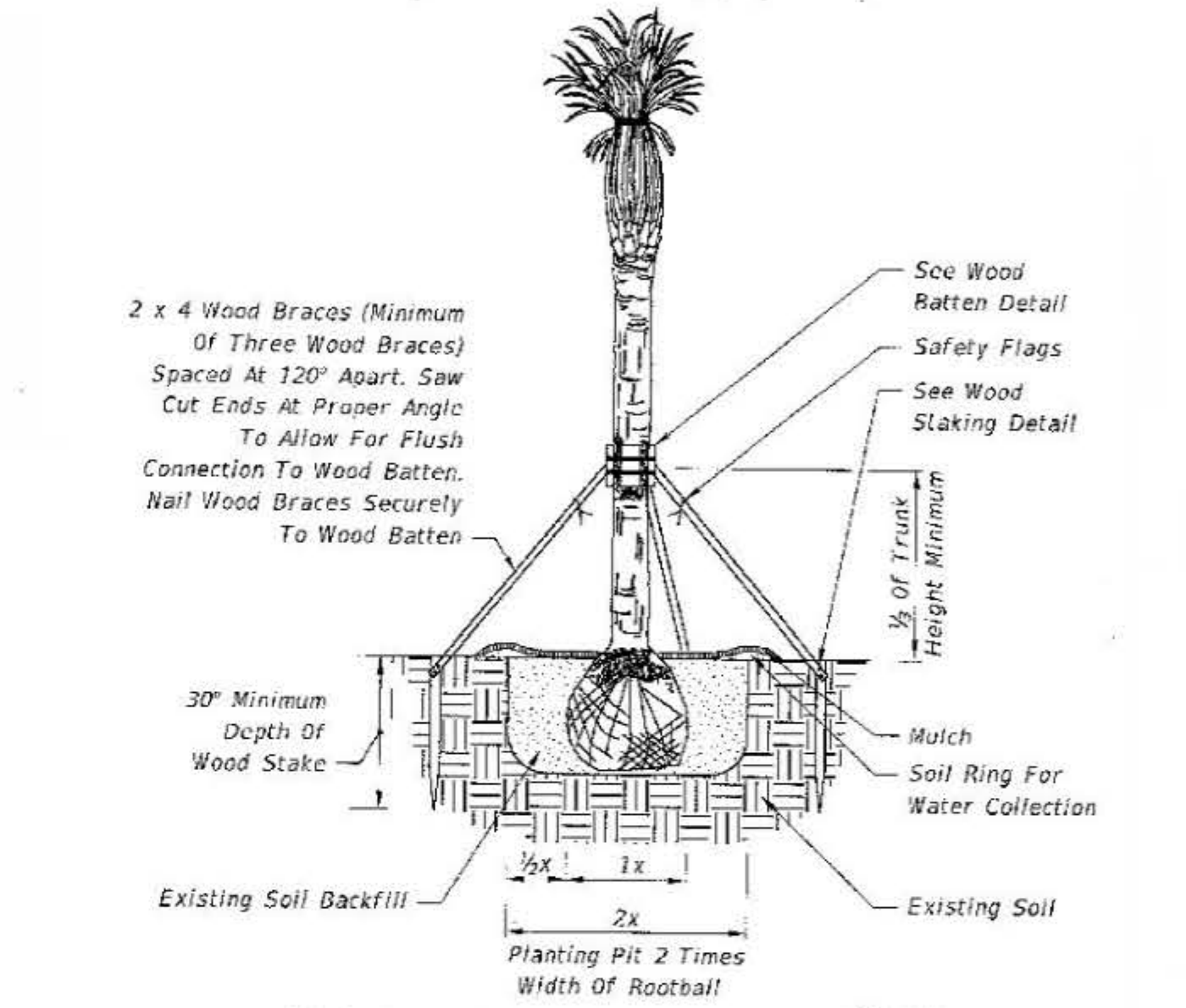

GENERAL PLANTING NOTES

- All dimensions 6" and less are exaggerated for illustrative purposes only.
- Plant containers shall be removed prior to planting. If plants are not container grown, remove a minimum of the top 1/3 of burlap, fabric, or wire mesh. Never lift or handle the tree by the trunk.
- The uppermost root on all trees shall be covered by no more than 1" of soil. Use hand tools to carefully remove all excess soil. The top of root ball shall be set 1" - 2" above finish grade and set plumb to the horizon. If planting pit is too deep, remove the tree and firmly pack additional soil in the bottom of the planting pit to raise the rootball. After positioning the tree in the planting pit slice through rootballs with 3 or 4 vertical slices (top to bottom) equally distributed around the tree.
- Backfill shall be loosened existing soil. Remove rocks, sticks, or other deleterious material greater than 1" in any direction prior to backfilling. Water and tamp to remove air pockets. If existing soils contain excessive sand, clay, or other material not conducive to proper plant growth, contact Landscape Architect prior to planting.
- Soil rings shall be constructed of existing soil at the outer edge of the planting pit, with a height of 3" and gently sloping sides. Do not pile soil on top of rootball.
- Mulch shall be a 3" deep layer placed to the edge of the trunk flare, around the base of shrub, or solidly around groundcover. Never pile mulch against the plant trunk. Allow air to meet trunk of all plants.
- Straps shall be a minimum 1" wide nylon or polypropylene. All wood stakes or anchors shall be located beyond the edge of soil ring and located below finished grade, unless otherwise specified. Remove above ground guying systems at the end of the establishment period.

PLANT LIST

KEY	QTY	BOTANICAL NAME	COMMON NAME	N*	WW*	SIZE/NOTES
*N-Native, WW-WaterWise						
TREES						
BC	9	Taxodium distichum	Bald Cypress	X	X	12' Ht., 2 1/2" Cal., 65 Gal.
LO	9	Quercus laurifolia	Laurel Oak	X	X	12' Ht., 2 1/2" Cal., 65 Gal.
MG	6	Magnolia grandiflora	Southern Magnolia	X	X	12' Ht., 2 1/2" Cal., 65 Gal.
PT	7	Simarouba glauca	Paradise Tree	X	X	12' Ht., 2 1/2" Cal., 65 Gal.
QV	13	Quercus virginiana	Live Oak	X	X	12' Ht., 2 1/2" Cal., 65 Gal.
RM	5	Acer rubrum	Red Maple	X	X	12' Ht., 2 1/2" Cal., 65 Gal.
TL	6	Ligustrum japonicum	Tree Ligustrum			8' Ht. x 4" Sp. Stand., Matched
PALMS						
FP	14	Wodyetia bifurcata	Foxtail Palm	X	X	10' C.T., Matched, B&B
SO	18	Ptychosperma elegans	Solitair Palm	X	X	10' C.T., Matched, B&B
SP	14	Sabal palmetto	Sabal/Cabbage Palm	X	X	10' - 16' C.T. Clean Trunk
SHRUBS / VINES						
CL	102	Clusia guttifera 'dwarf'	Dwarf Clusia	X	X	7 Gal., 30" Ht.
CV	17	Bignonia capreolata	Cross Vine	X	X	7 Gal., 30" Ht. Train to Trellis
CO	118	Chrysobalanus icaco	Cocoplum 'Red Tip'	X	X	3 Gal., 24" Ht.
FA	159	Tripsacum floridanum	Dwarf Fakahatchee	X	X	3 Gal., 24" Ht.
FB	167	Hamelis patens 'dwarf'	Fribush, Dwarf	X	X	3 Gal., 24" Ht.
IN	66	Ixora coccinea nora grant	Ixora 'Nora Grant'	X	X	3 Gal., 24" Ht.
IMO	120	Ixora coccinea 'Mau'	Ixora Maui Orange/Red	X	X	3 Gal., 24" Ht.
IMY	38	Ixora coccinea 'Mau'	Ixora Maui Yellow	X	X	3 Gal., 24" Ht.
GV	97	Viburnum obtovatum	Walter's Viburnum	X	X	3 Gal., 24" Ht.
GROUNDCOVERS / LAWN						
BH	253	Bougainvillea 'Helen Johnson'	Dwarf Majenta Boug.	X		1 Gal., 12" Ht.
JU	268	Juniperus horizontalis 'wiltonii'	Blue Rug Juniper	X		1 Gal., 10" Ht.
LM	638	Liriope muscari 'Emerald Goddess'	Liriope 'Emerald G.'	X		1/2 Gal., 1' O.C.
TA	80	Trachelospermum asiaticum	Dwarf Asiatic Jasmine Tri-Color	X		1/2 Gal., 1' O.C.
SA		Stenotaphrum secundatum	St. Augustine 'Floritan'	X		Solid Sod

PORT ST. LUCIE PLANTING AREA REQUIREMENTS

- ADJACENT RW & PROPERTIES**
Quantity Requirements:
10' Landscape strip, One tree per 30 Lin. Ft., Shrubs 2' O.C.
AREA:
North & West Side: Required: 15 Trees, 230 Shrubs
Provided: 19 Trees, 282 Shrubs
East Side: Required: 7 Trees, 110 Shrubs
Provided: 9 Trees, 118 Shrubs
South Side: Required: 12 Trees, 175 Shrubs
Provided: 17 Trees, 199 Shrubs
- BUILDING FACADE**
Quantity Requirements:
5' Landscape strip, One tree per 30 Lin. Ft., Shrubs 2' O.C.
Perimeter: 733 Lin. Ft. less 156' openings = 577 Lin. Ft.
Plant Requirements: 19 Trees, 288 Shrubs
Plants Provided: 24 Trees, 233 Shrubs + 775 Groundcovers
* Half of building fronts on a retention area/pond.
- VEHICULAR USE AREAS (VUA)**
Quantity Requirements:
10' Landscape strip at perimeter, One tree per 30 Lin. Ft., Shrubs 2' O.C.
Perimeter: 639 Total Lin. Ft.
Plant Requirements: 21 Trees, 319 Shrubs
Plants Provided: 27 Trees, 360 Shrubs

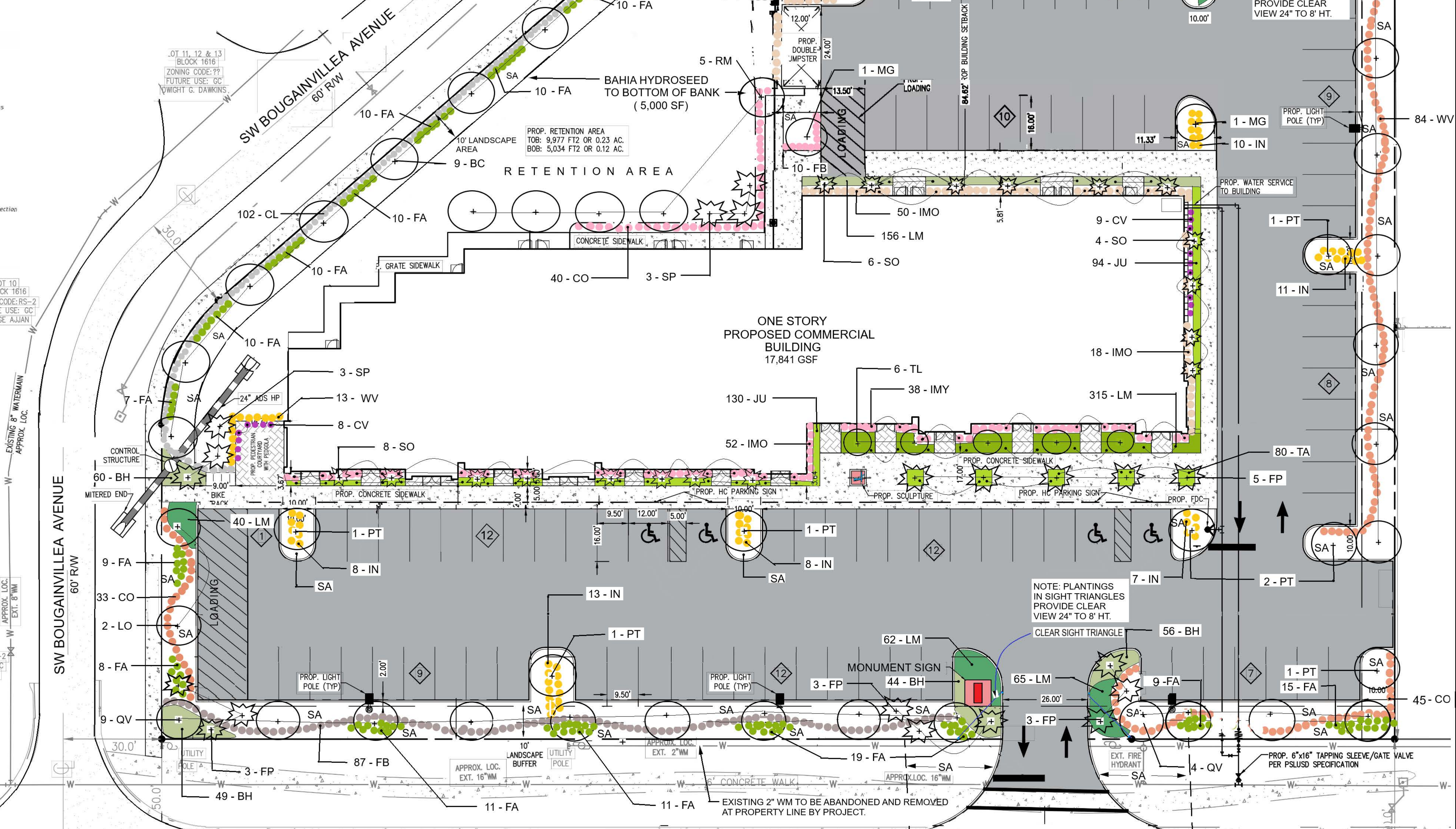

SPECIAL PLANTING TREES & SHRUBS

Planting trees and shrubs: Excavate hole per planting detail. When plant is set, place additional backfill consisting of a 50% mixture of Peat humus and natural soil around the base and side of hole, and work each layer to settle backfill and eliminate voids and air pockets. When excavation is approximately 2/3 full, water thoroughly before placing remaining backfill. Water again after placing final layer of backfill and before installing mulch. NOTE: Contractor is to include drainage testing for all trees and palms in bid. If drainage is inadequate, the soil specification noted above shall be revised for site conditions. Contractor shall notify the Owner and Landscape Architect of poor drainage conditions in writing and written direction will be provided to the contractor of appropriate soil mixture specifications to be used.

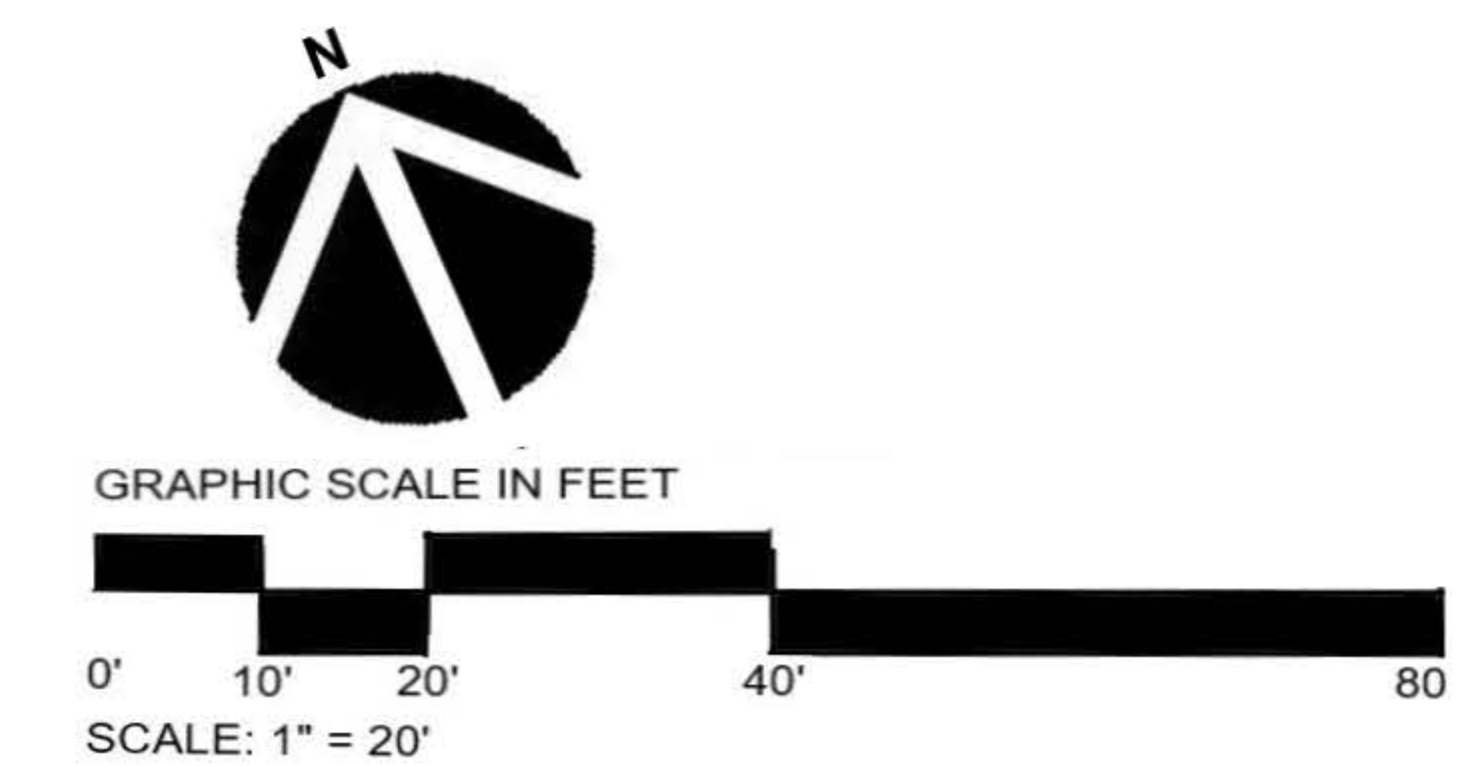

PREPARED BY: **GEORGE BOTNER, PLA, AICP**
LANDSCAPE ARCHITECTURE & PLANNING
4320 S E Cove Lake Circle, Suite # 104
Stuart, FL 34997
(954) 798-7158 (Cell)

FL LA # 0000422
botnrg@aol.com
(772) 221-9558

