

Ladybug Hideaway

An
ART IN PUBLIC PLACES PROPOSAL
For
WYLDER / Greenpointe LLC

To The
City of Port St. Lucie, Florida

AUGUST 2024
MARCH 2026

INDEX:

1 of 15	Index & General Notes
2 of 15	Artist Statement
3 of 15	Perspective Rendering
4 of 15	Ladybug Pin Details
5 of 15	Typical Elevation
6 of 15	Typical Blade Group Elements
7 of 15	Sprout Cluster Fabrication Details
8 of 15	Sprout Cluster Typical Details
9 of 15	Parent Blade Fabrication Details
10 of 15	Parent Blade Cut Pattern Details
11 of 15	Parent Blade Fabrication Details
12 of 15	Parent Concrete Footer Layout & Details
13 of 15	Parent Footer Mounting Plates Layout & Details
14 of 15	Parent Footer Mounting Plates - Hole Pattern Details
15 of 15	Typical Parent Elevations



Ladybug Hideaway

Artist Statement

In creating this public art installation, I seek to capture the essence of nature and bring an immersive experience to the urban landscape.

Inspired by the tranquility found in vast fields of tall grass, I envisioned a space where individuals could escape the hustle and bustle of city life - if only for a moment. As a result this installation is composed of giant blades or leaves of grass.

The tall grass serves as a metaphor for the resilience and vitality of nature, pushing its way through the man-made environment to offer a momentary respite. The installation, arranged in a series of planter beds, not only transforms the environment but also prompts viewers to reconsider the intersection between urban development and the natural world.

The decision to elevate the height of the leaves to be well overhead of a person is deliberate - intended to evoke a sense of awe and wonder, encouraging participants to walk among the towering grass blade groupings. In doing so, they immerse themselves in a unique experience, fostering a connection with the natural world within an urban context.

I constructed a study model to sort out a format to tame the grass in a civilized manner. The inner side of the blades are sheathed with mirror-polished stainless steel, and sparkled reflections of the sky become tethered into the viewers' spatial experience. My intended effect of how a viewer in the midst will feel dwarfed was great, but something was missing. A lovable, whimsical resident was needed, so without hesitation a Ladybug was invited to make it her home.

My research uncovered 18 different types of ladybugs. By creating contemporary interpretations of them and hiding them throughout the installation I bring an added element of surprise and joyful splendor to the act of exploring the installation.

Beyond the aesthetic appeal, this installation serves as a reminder of the importance of preserving green spaces in our urban environments. It prompts us to reflect on the delicate balance between progress and the preservation of the natural world, encouraging a dialogue about the coexistence of man-made structures and the beauty of the organic.

Through this art piece, I hope to inspire a sense of harmony and appreciation for the natural world, fostering a connection between individuals and the environment. As we navigate the challenges of urbanization, let this installation stand as a testament to the enduring power and beauty found in the simplest elements of nature.







TYPES OF LADYBUGS

DESCRIPTION:
 ENAMEL PAINTED LADYBUG BODY W/ CLEARCOAT FINISH
 SURFACE-MOUNTED TO SECOND SURFACE OF SCULPTURAL
 BLADE ELEMENT. LIMIT USE TO ONE OF THESE UNIQUE
 VARIETIES WITHIN A SINGLE BLADE CLUSTER.
 POSITION AND PLACEMENT WITHIN THE BLADE CLUSTER
 IDEALLY TO BE EVASIVE TO DISCOVERY.

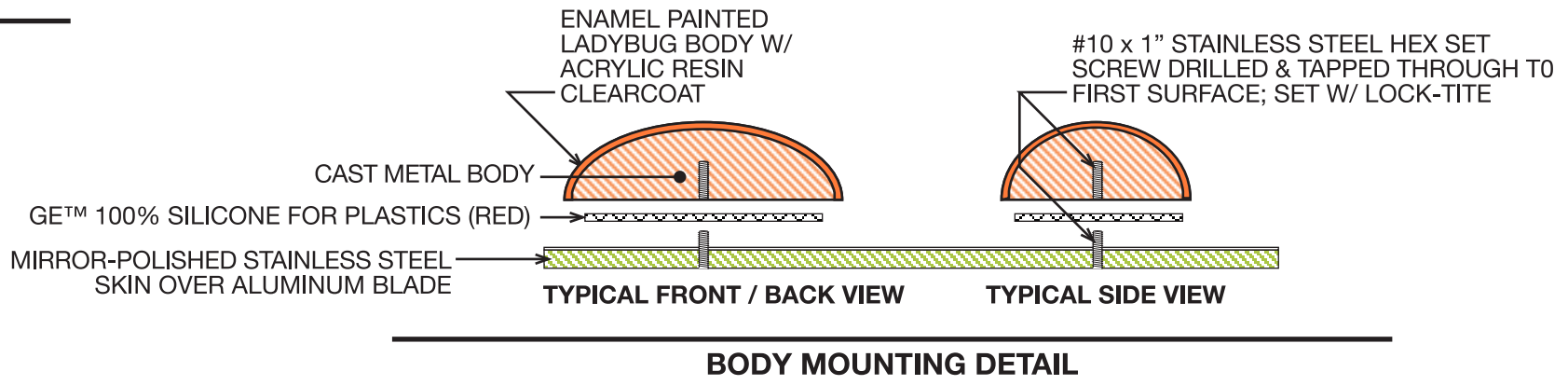
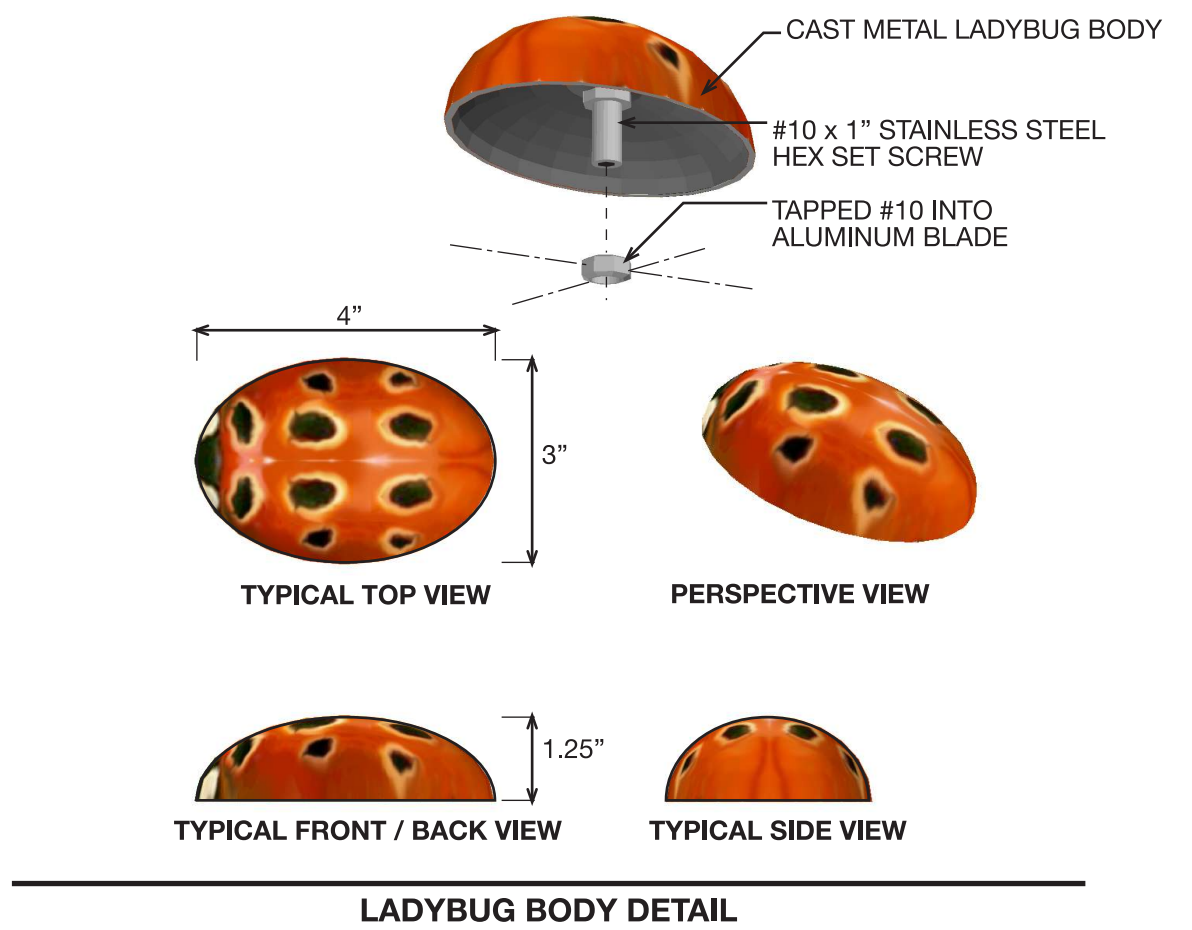



TYPICAL ELEVATION

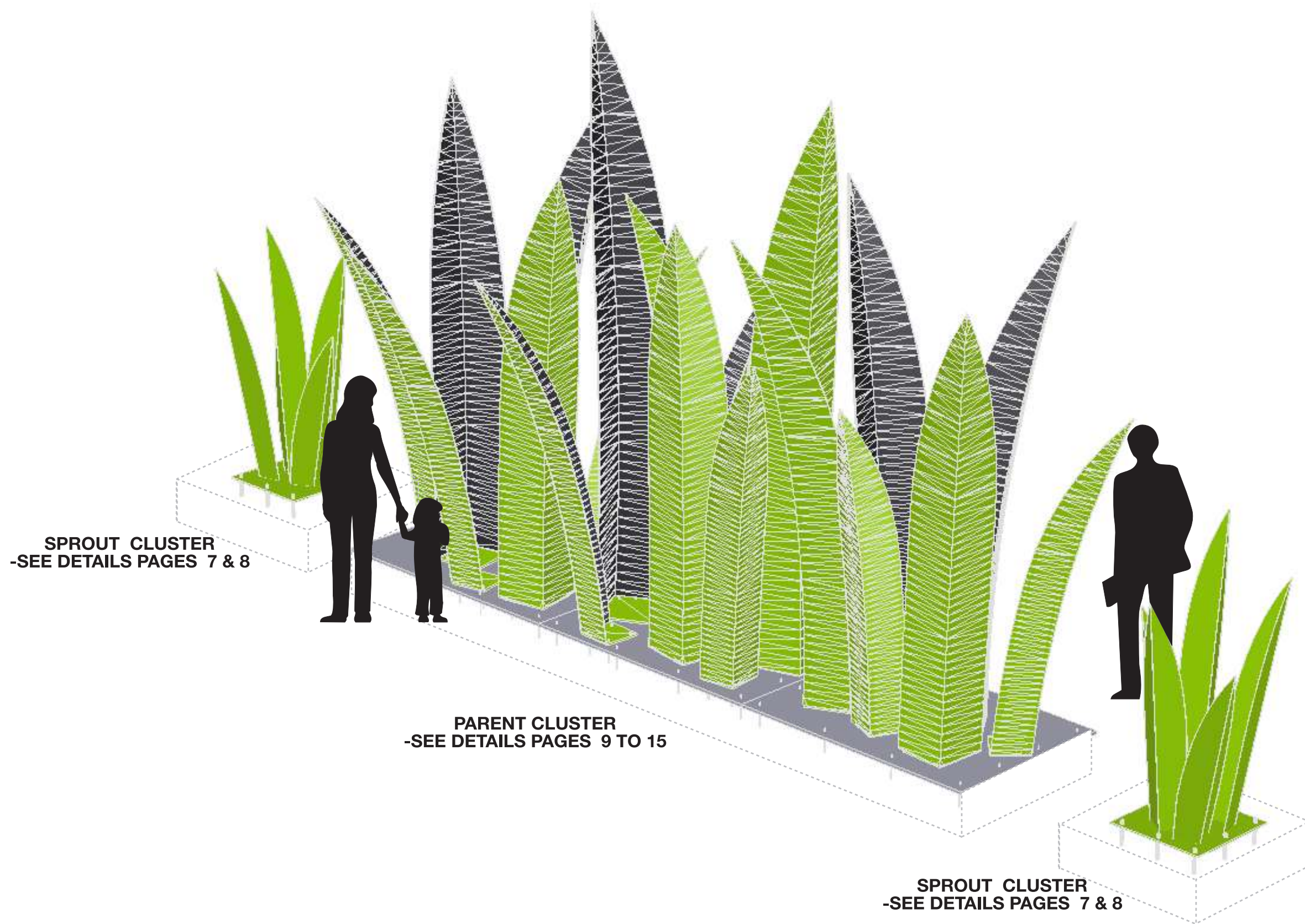

SPROUT CLUSTER
-SEE DETAILS PAGES 7 & 8

PARENT CLUSTER
-SEE DETAILS PAGES 9 TO 15

SPROUT CLUSTER
-SEE DETAILS PAGES 7 & 8

PERSPECTIVE RENDERING



FLAT PATTERN TOP VIEWS

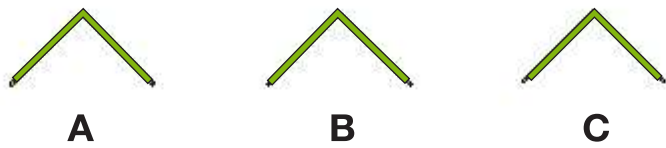

FORMED TOP VIEWS

4, 5, AND 6FT SCULPTURAL BLADES WELDED TO BASEPLATE

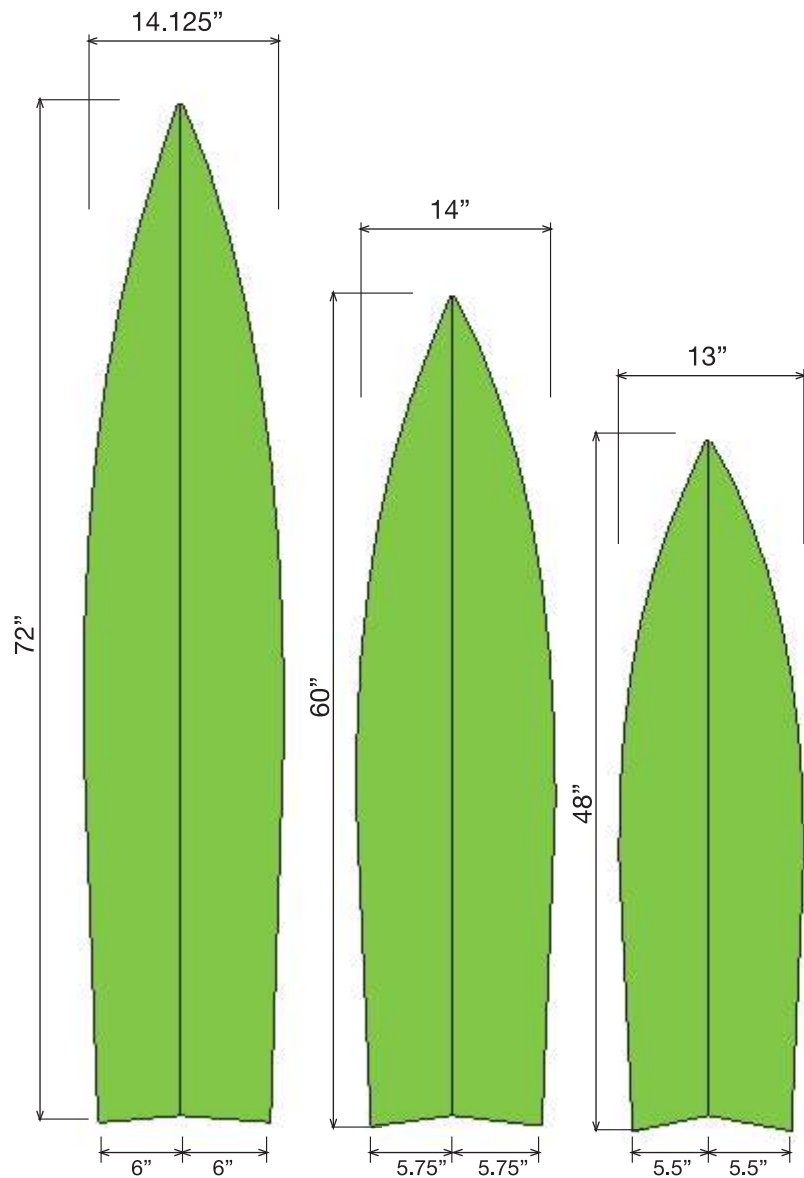
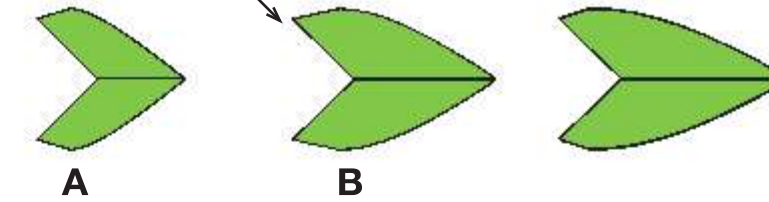

FLAT PATTERN LAYOUTS

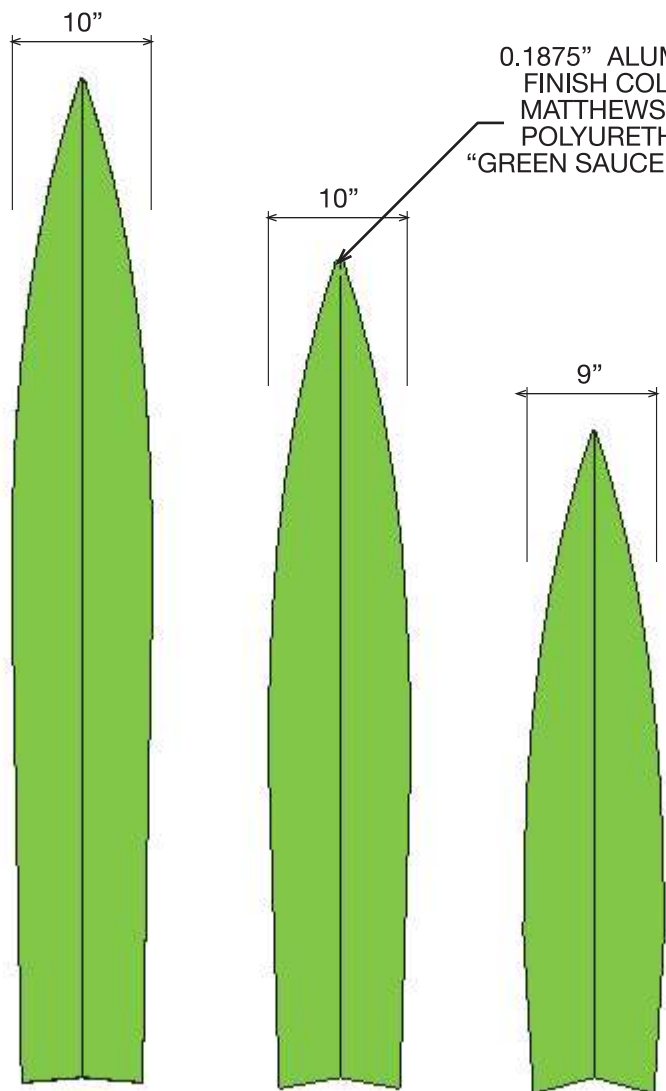

FORMED ELEVATIONS

0.1875" ALUMINUM BLADE. FINISH COLOR TO MATCH MATTHEWS MAP ACRYLIC POLYURETHANE MP00497 "GREEN SAUCE WITH LEMON"

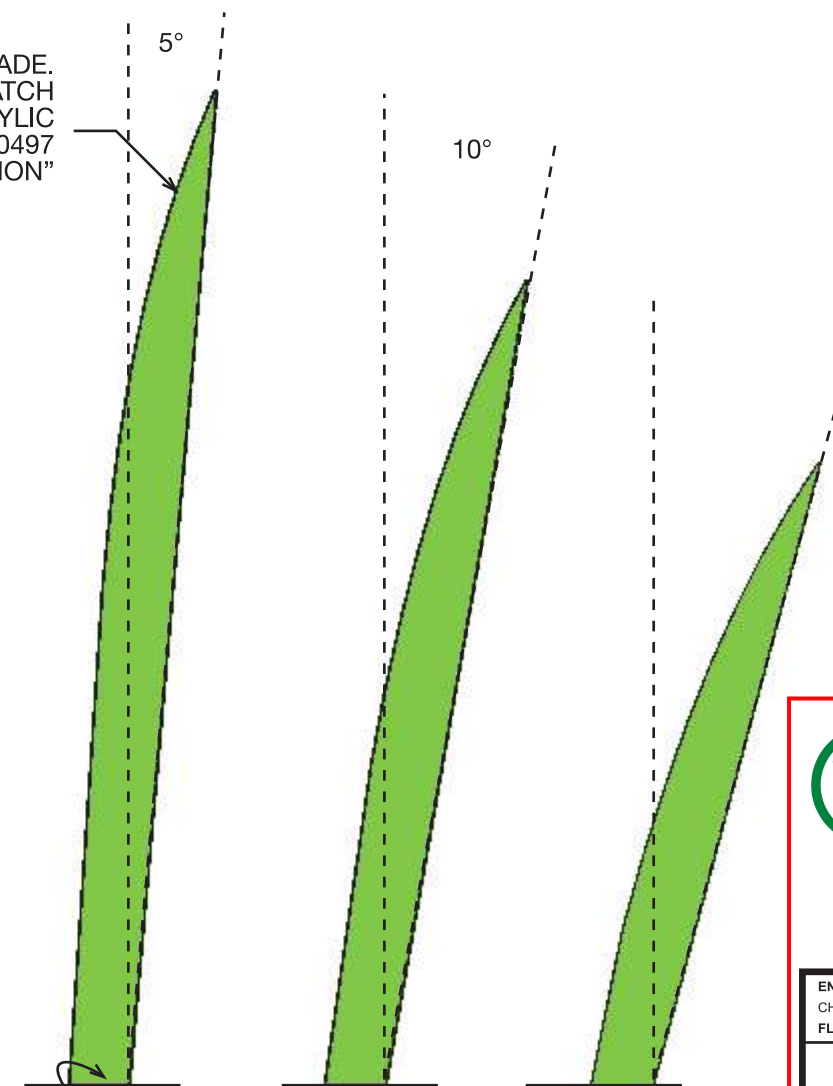

FORMED BLADES - WELD TO 0.375" ALUMINUM BASEPLATE ALL AROUND

FORMED MOUNTED SIDE VIEW

WGI
WGInc.com

2035 VISTA PARKWAY
WEST PALM BEACH, FL 33411
OFFICE - 561.687.2220
WGINC.COM
WGI PROJECT NUMBER 10800.00

ENGINEER OF RECORD:
CHRISTOPHER B. LAFORTE
FLORIDA P.E. LICENSE NO.: 76797

DATE:

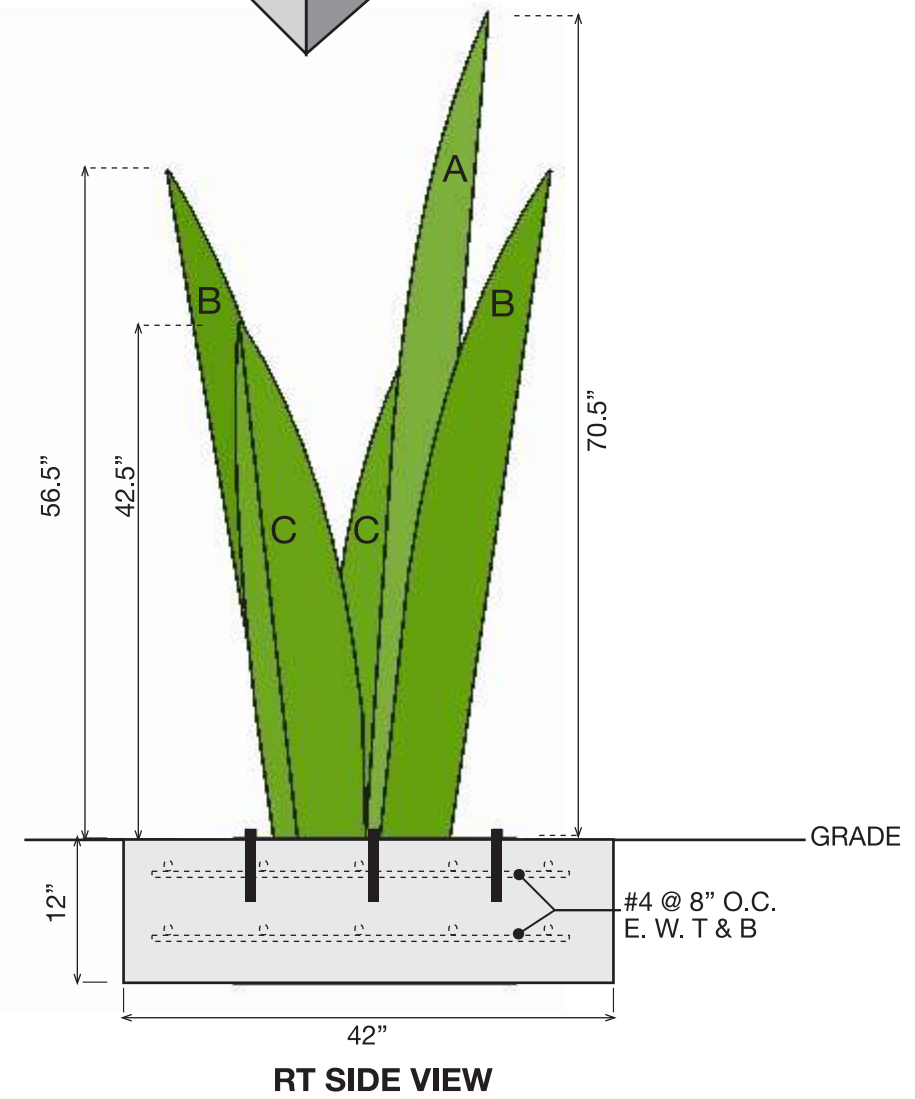
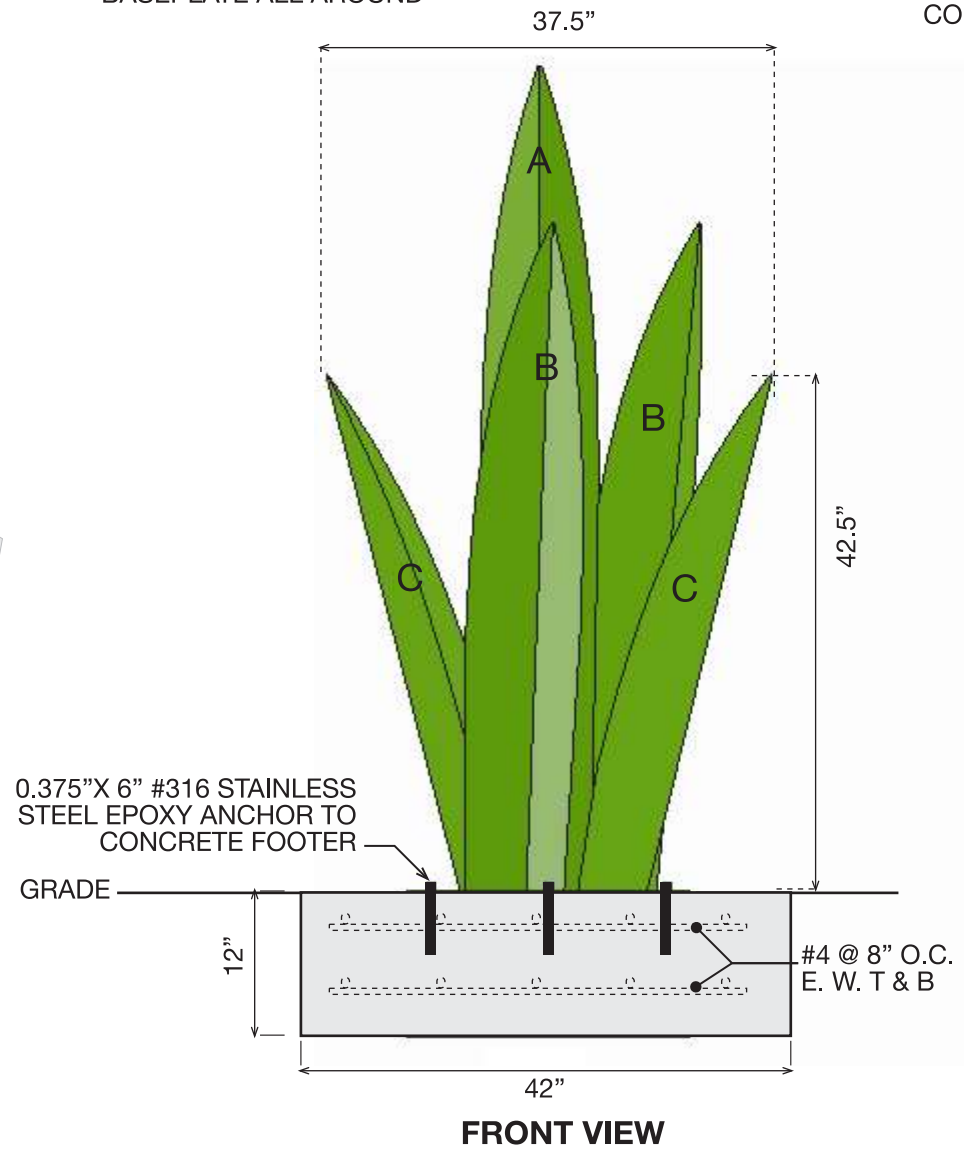
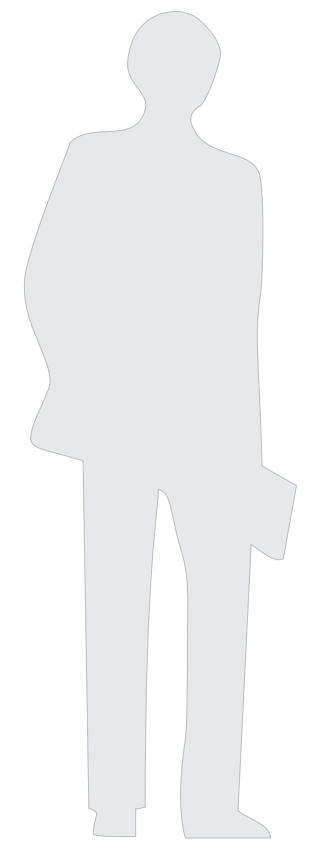
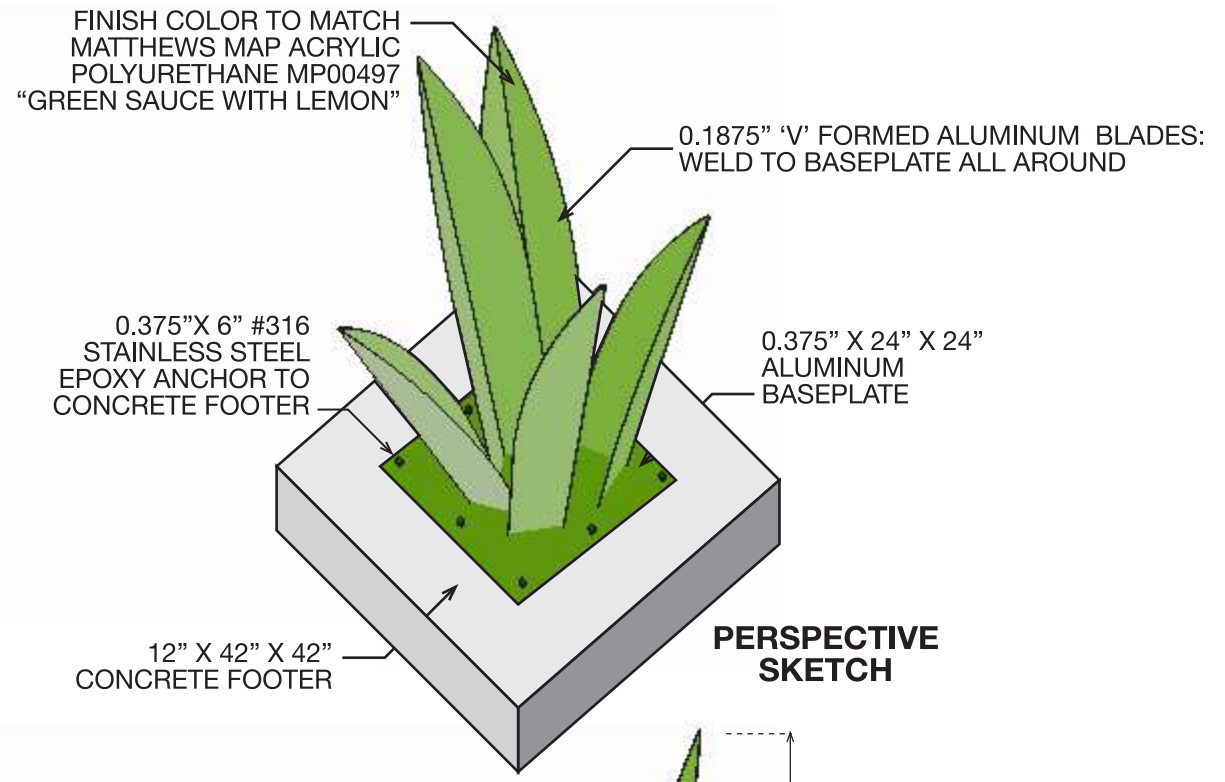
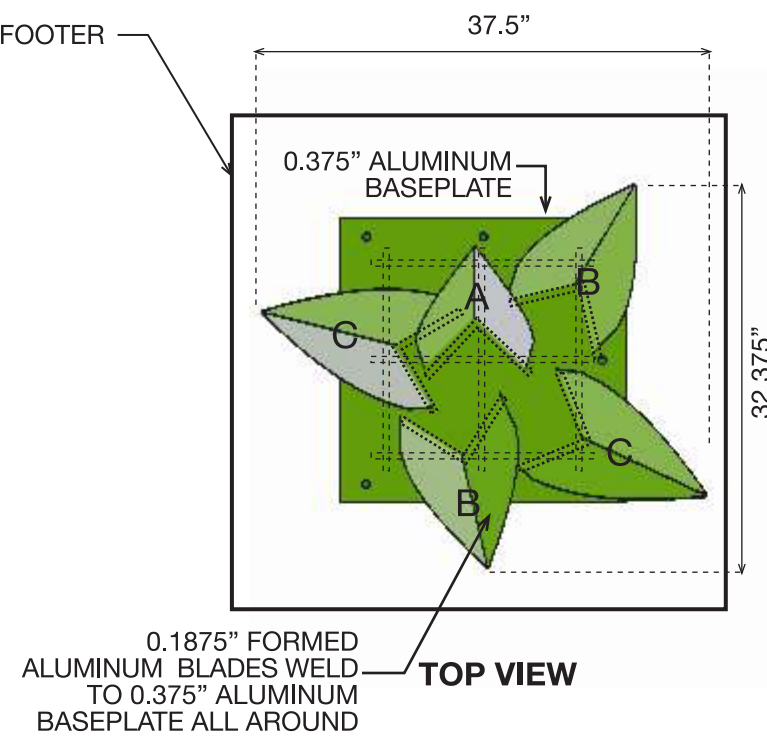
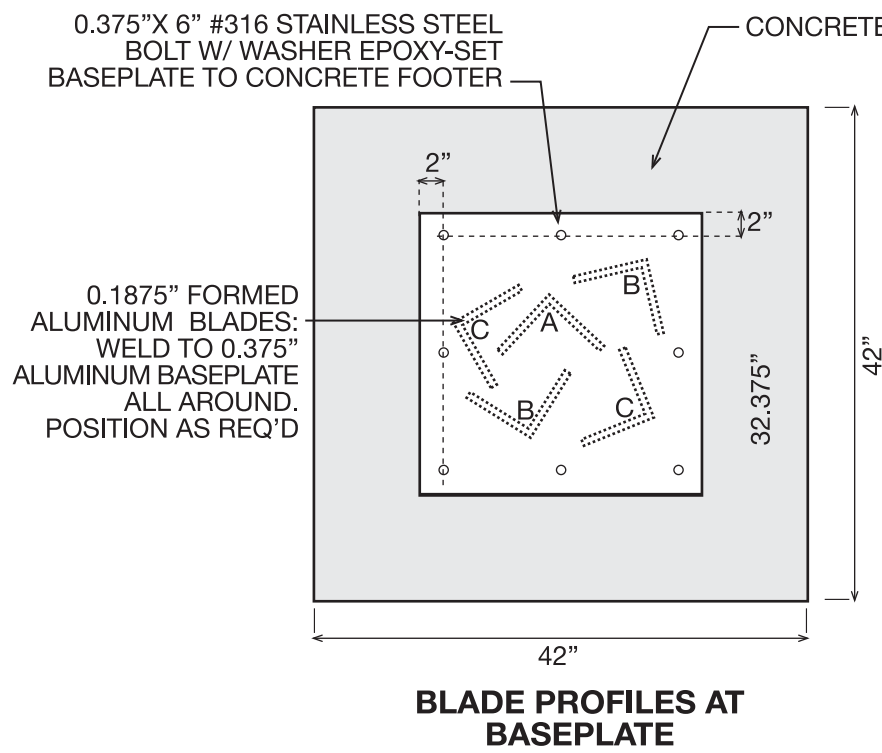

WGI
WGInc.com

2035 VISTA PARKWAY
WEST PALM BEACH, FL 33411
OFFICE - 561.687.2220
WGINC.COM
WGI PROJECT NUMBER 10800.00

ENGINEER OF RECORD:
CHRISTOPHER B. LAFORTE
FLORIDA P.E. LICENSE NO.: 76797

DATE:

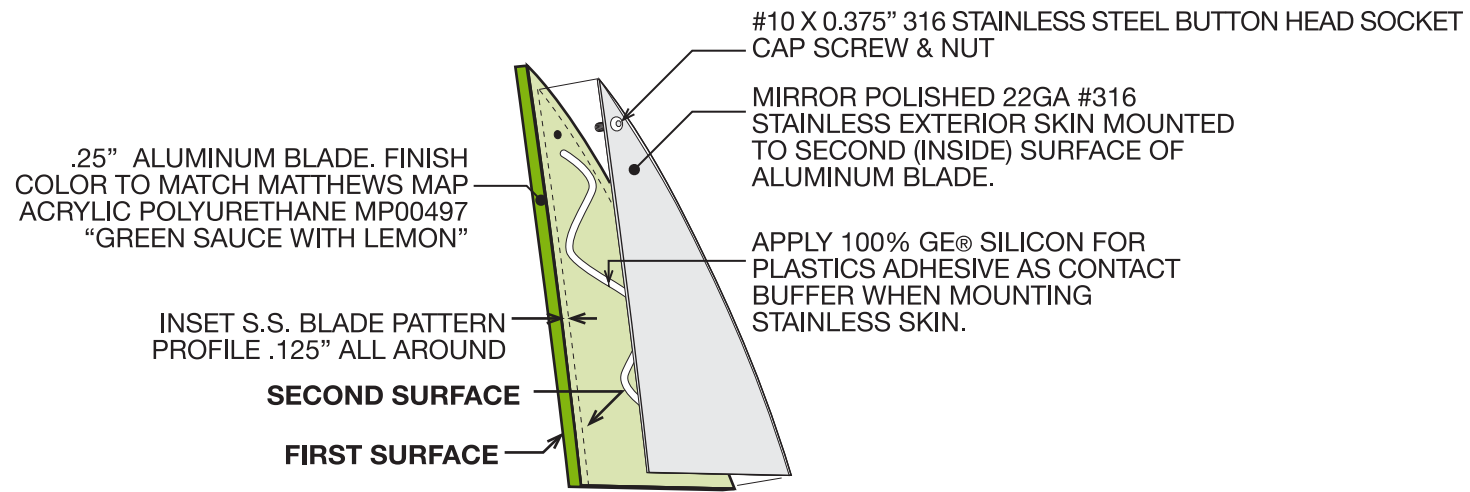

BOND-OVER DETAIL SKETCH

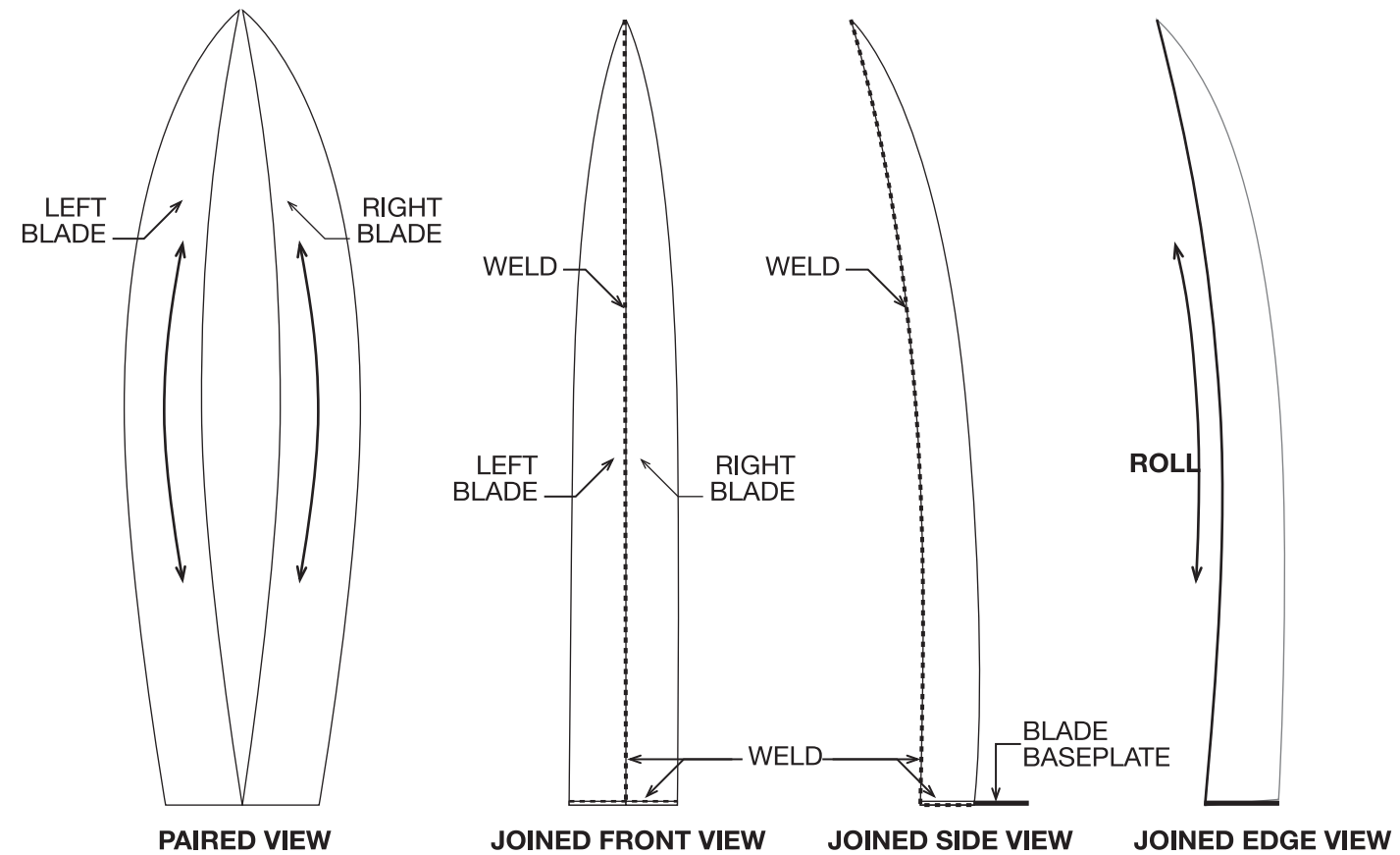

TYPICAL BLADE DETAIL

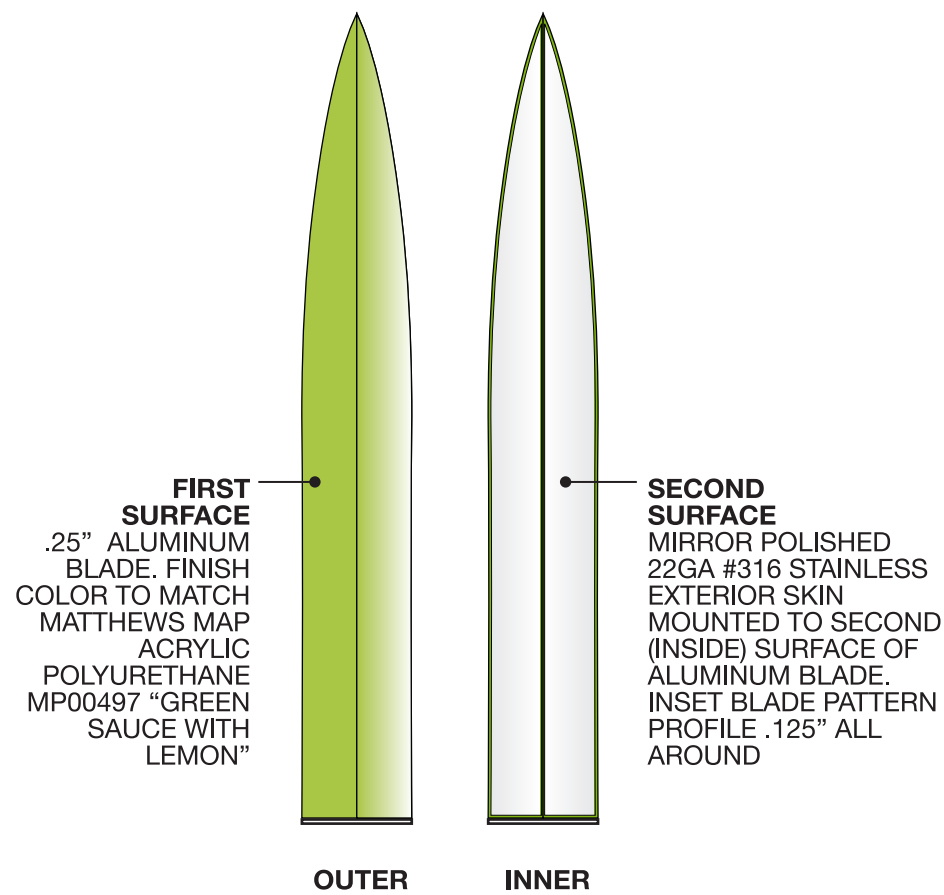

TYPICAL FORMED BLADE

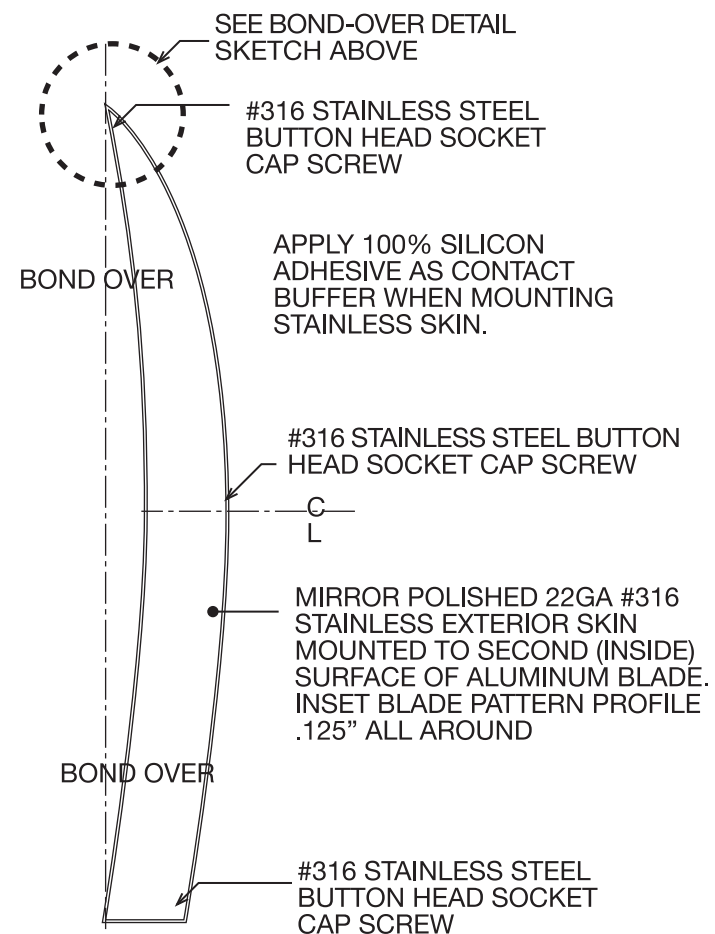

SECOND SURFACE BLADE DETAIL

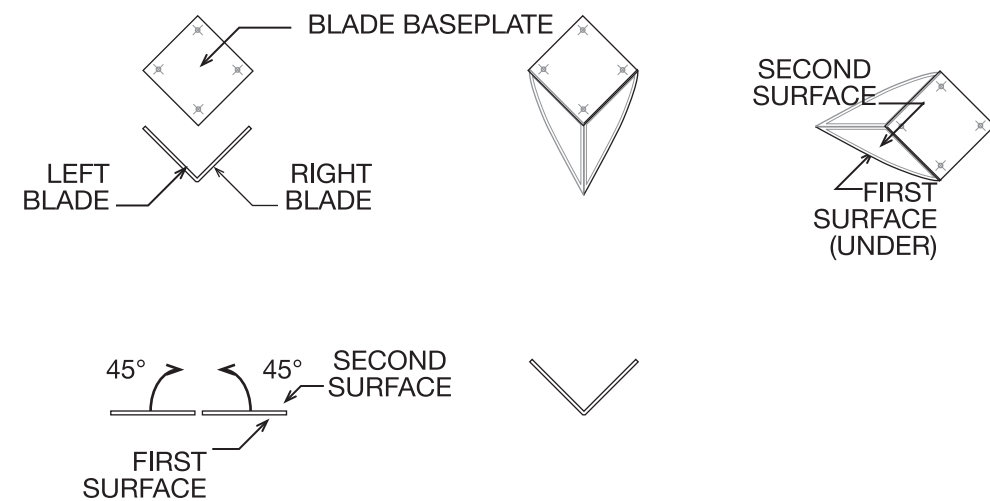

TOP VIEWS



2035 VISTA PARKWAY
WEST PALM BEACH, FL 33411
OFFICE - 561.687.2220
WGINC.COM
WGI PROJECT NUMBER 10800.00

ENGINEER OF RECORD:
CHRISTOPHER B. LAFORTE
FLORIDA P.E. LICENSE NO.: 76797

DATE:

PARENT BLADE FABRICATION DETAIL

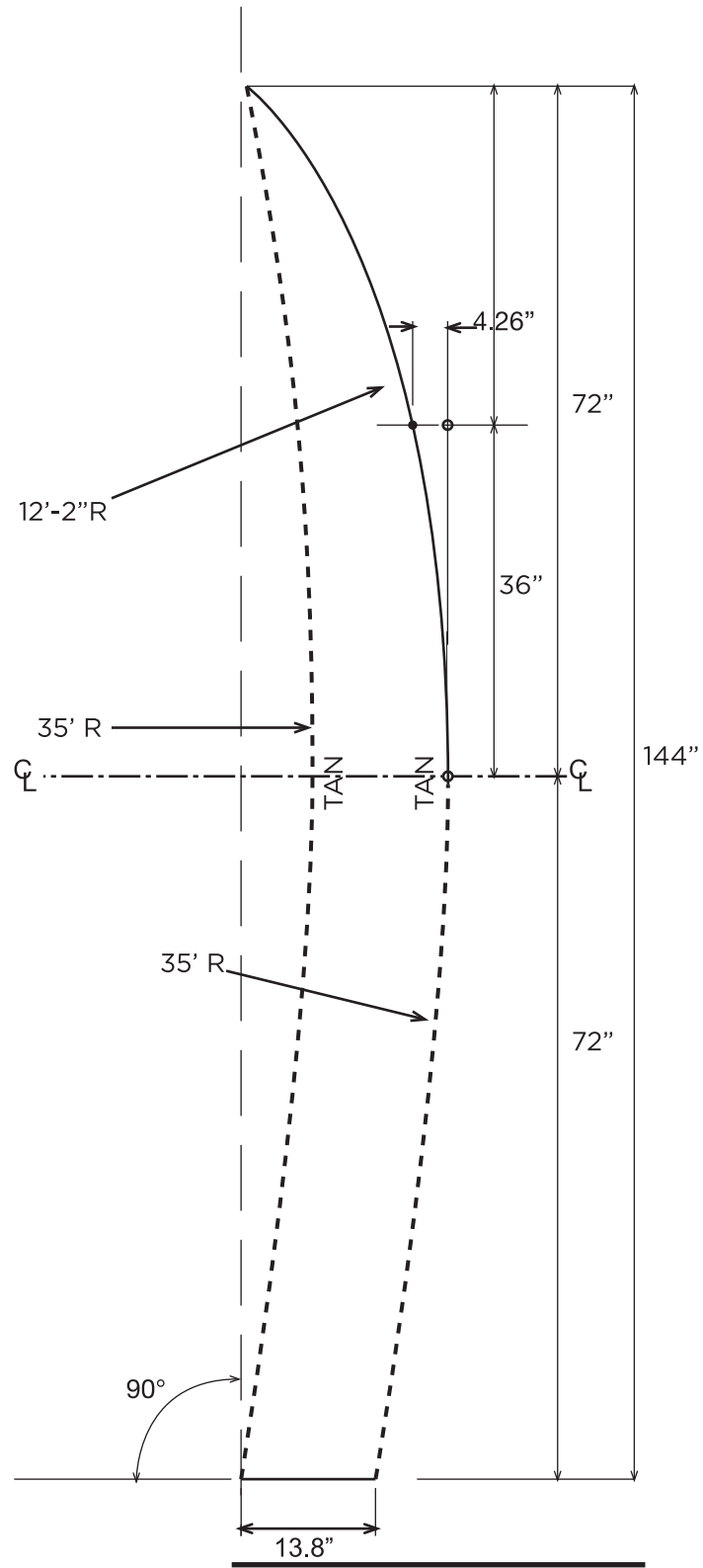

**BLADE TYPE A
FLAT PATTERN LAYOUT**

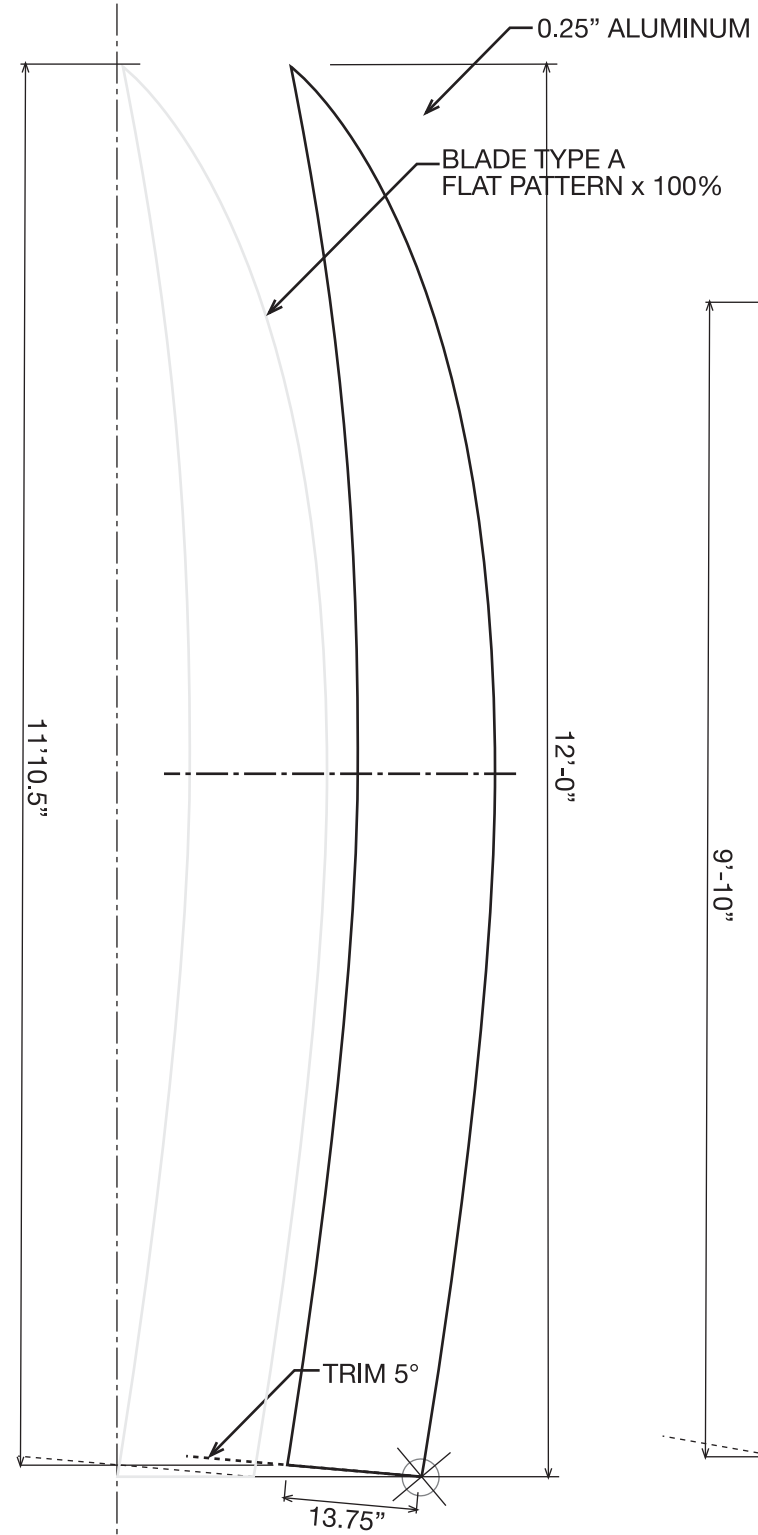

**BLADE TYPE A
CUT PATTERN LAYOUT**

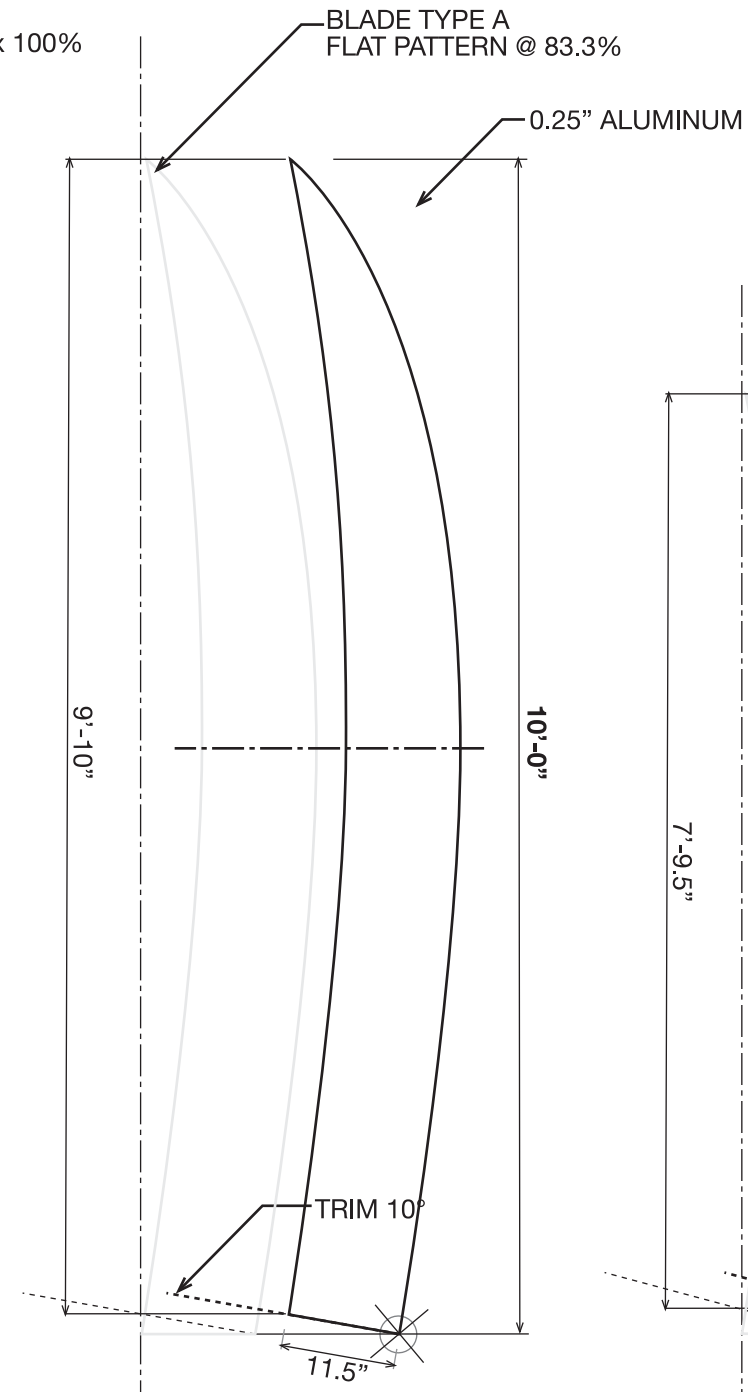

**BLADE TYPE B
CUT PATTERN LAYOUT**

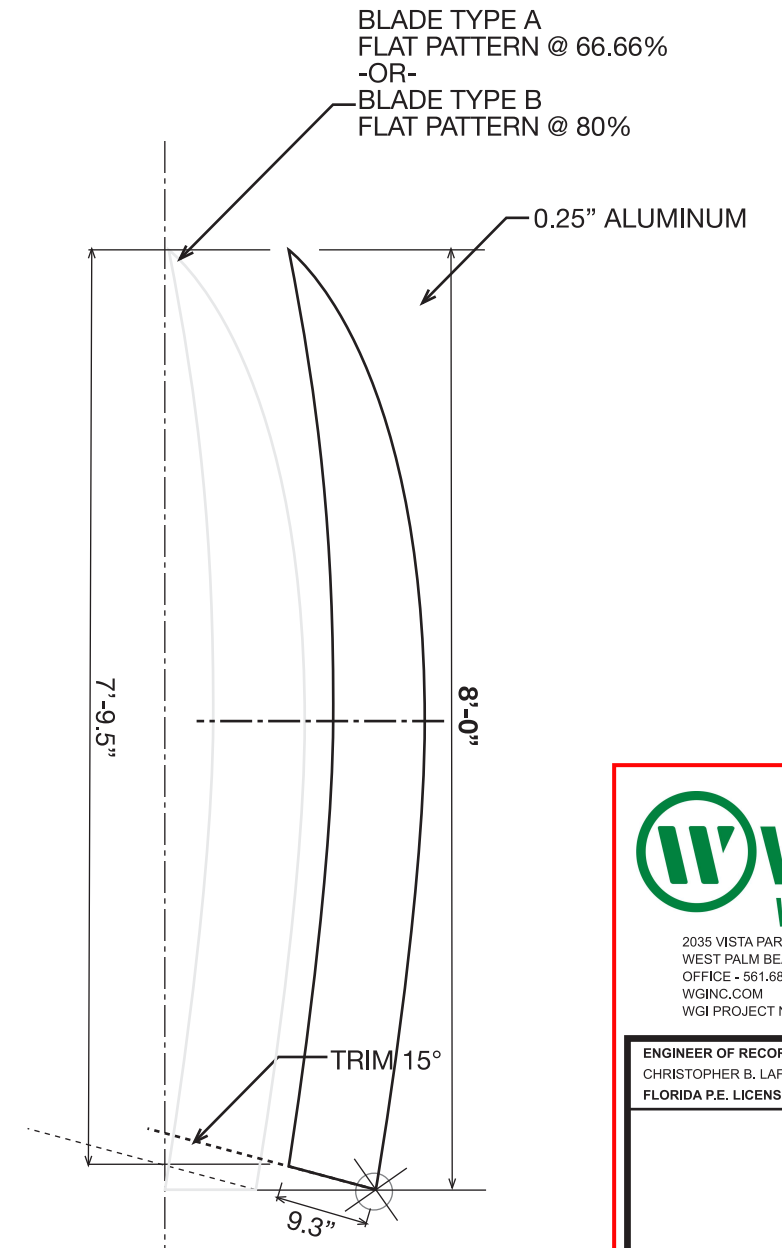

**BLADE TYPE C
CUT PATTERN LAYOUT**



2035 VISTA PARKWAY
WEST PALM BEACH, FL 33411
OFFICE - 561.687.2220
WGINC.COM
WGI PROJECT NUMBER 10800.00

ENGINEER OF RECORD:
CHRISTOPHER B. LAFORTE
FLORIDA P.E. LICENSE NO.: 76797

DATE:

PARENT BLADE TYPE A, B & C CUT PATTERN DETAILS

Ladybug Hideaway 10 of 15

WYLDER - Art In Public Places

City of Port St. Lucie, Florida

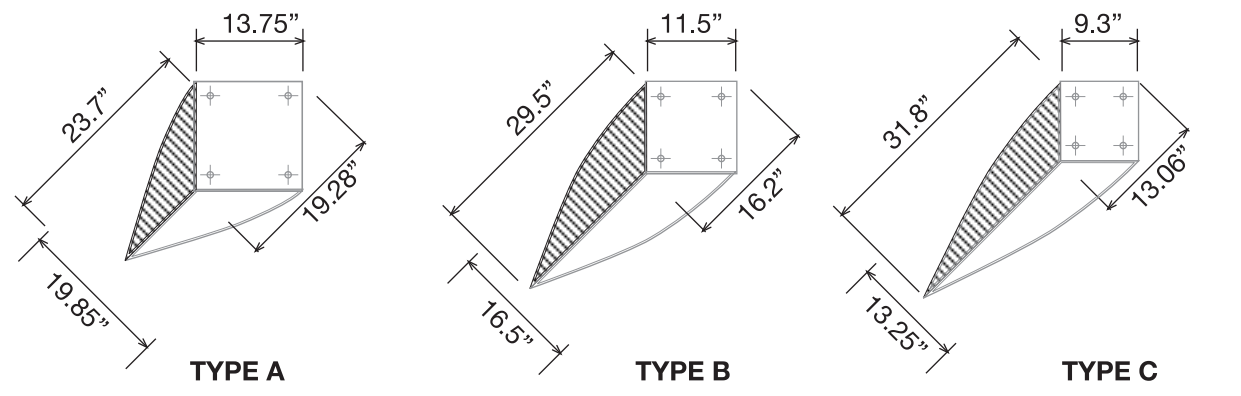

BLADE TYPE A, B, & C - PLAN VIEWS

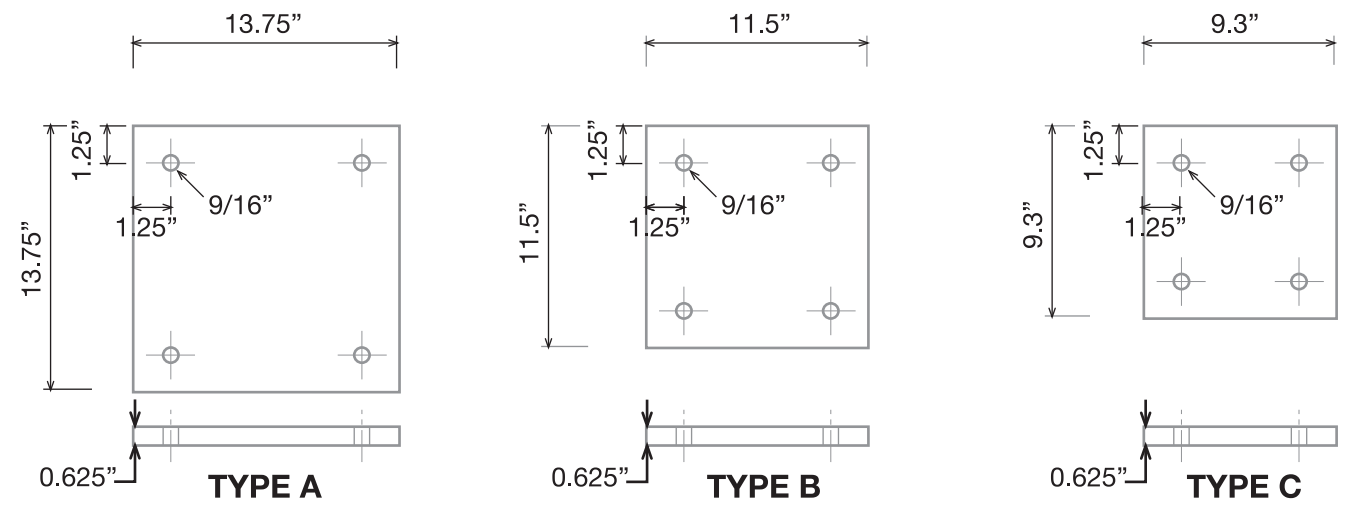

BLADE TYPE A, B, & C - ALUMINUM BASEPLATE DETAILS

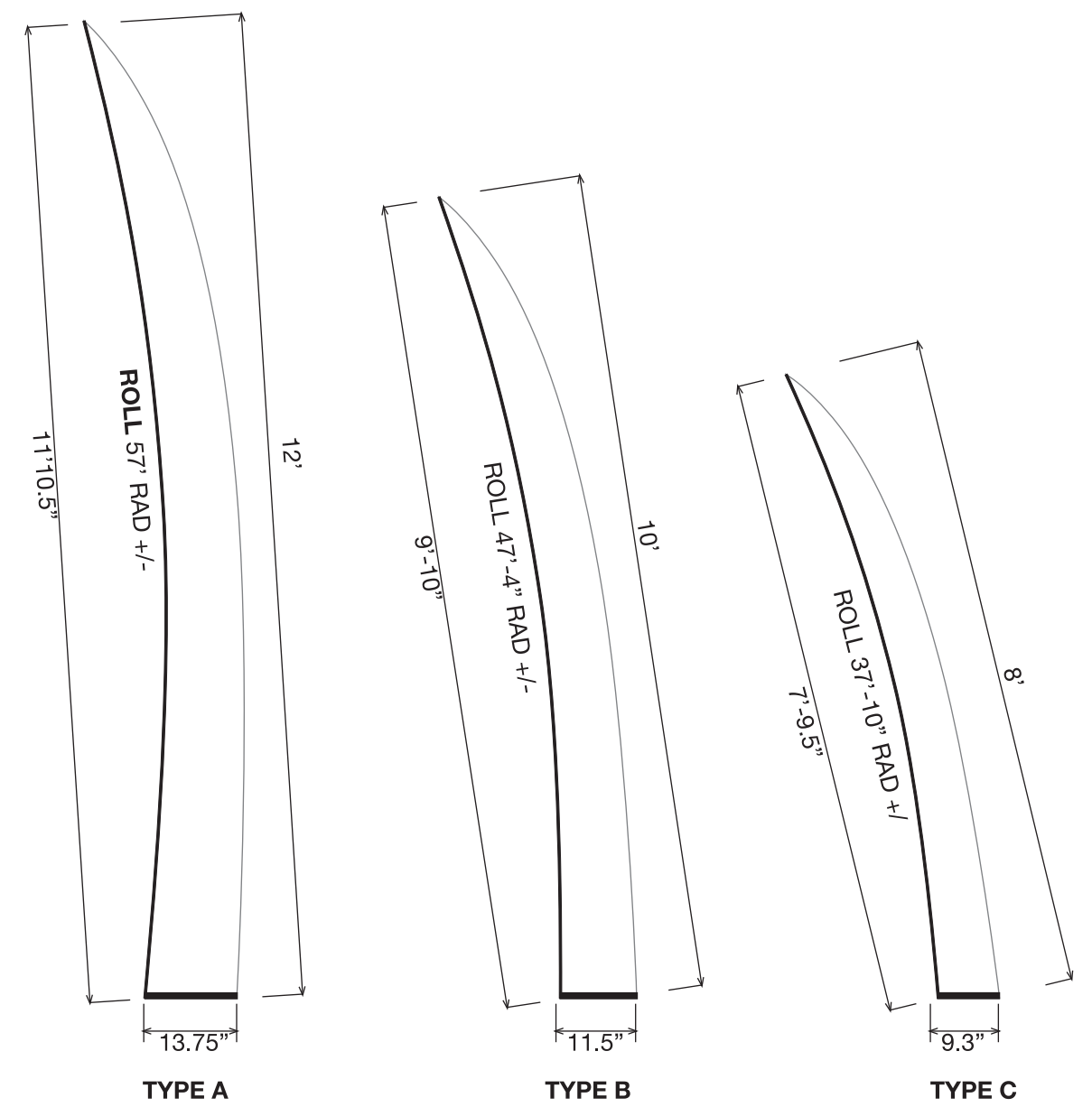

FORMED BLADES - SECTION ELEVATION

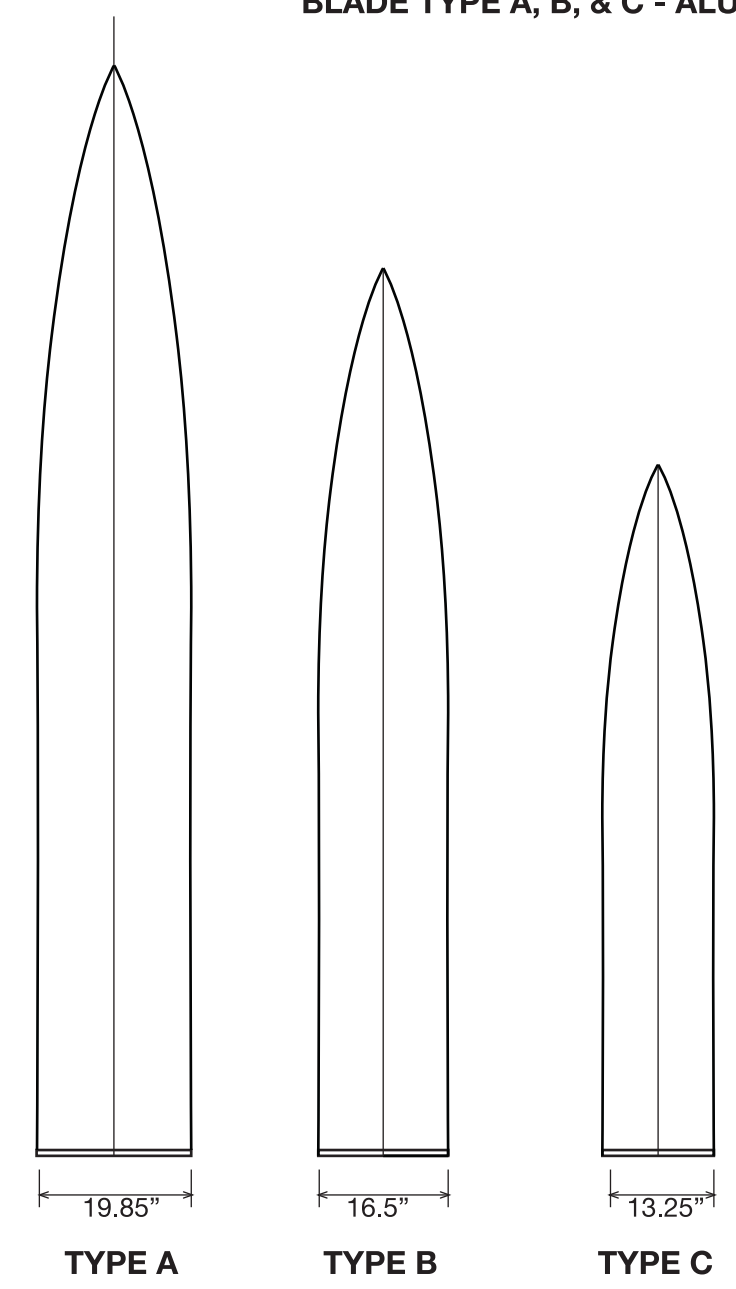

FORMED BLADES FRONT/BACK VIEWS

WGI
WGInc.com

2035 VISTA PARKWAY
WEST PALM BEACH, FL 33411
OFFICE - 561.687.2220
WGINC.COM
WGI PROJECT NUMBER 10800.00

ENGINEER OF RECORD:
CHRISTOPHER B. LAFORTE
FLORIDA P.E. LICENSE NO.: 76797

DATE:

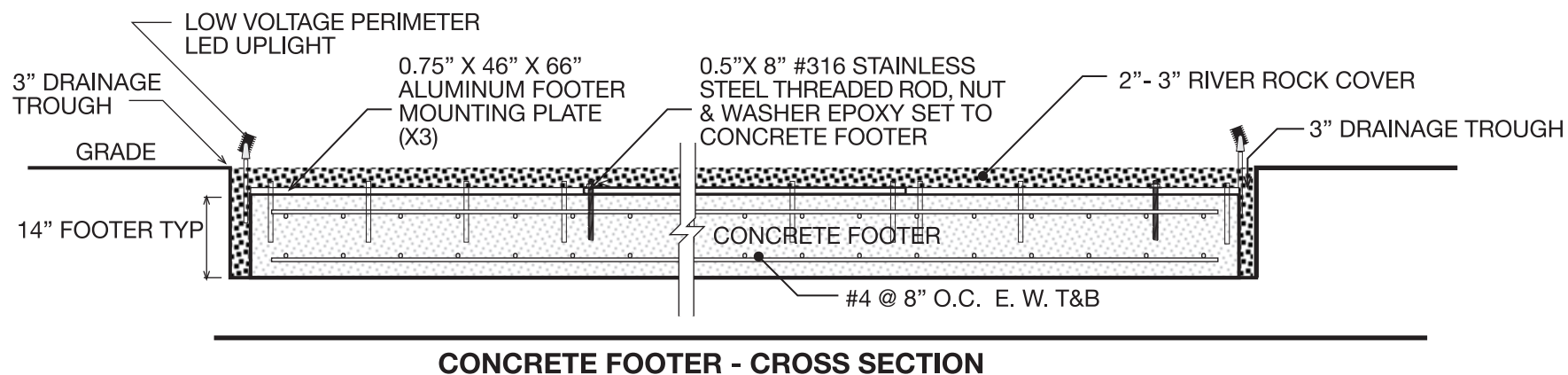
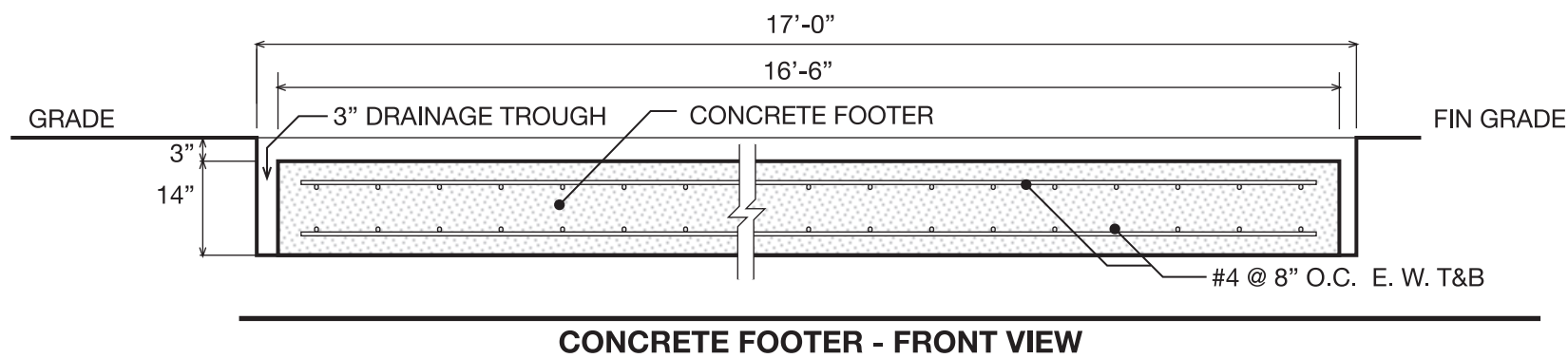
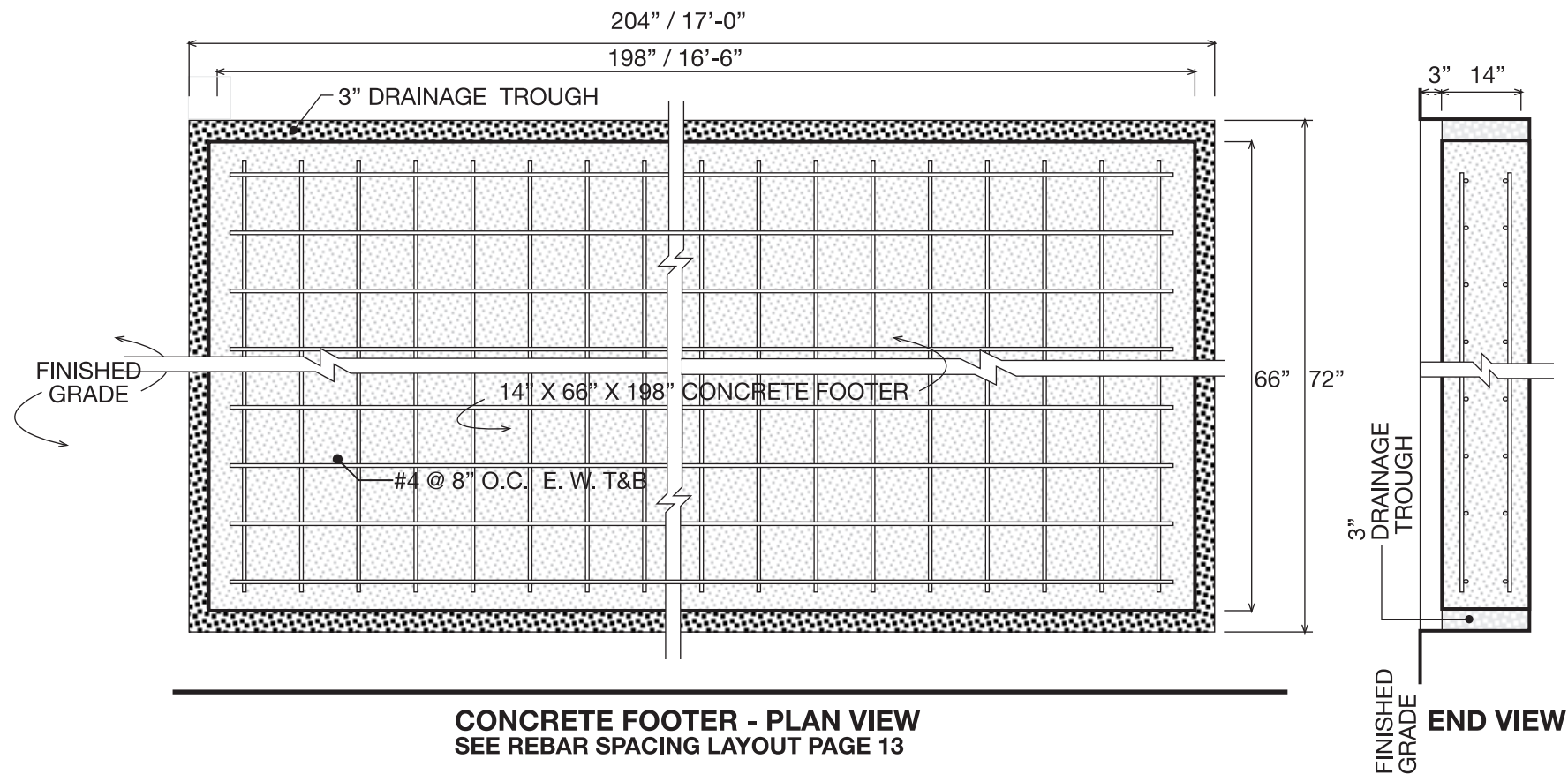

GENERAL NOTES:

- 1 - Fabricate all aluminum in accordance with the Aluminum Association Aluminum Design Manual, latest edition (ADM-20)
- 2 - All aluminum material shall be 6061-T6 (U.O.N.)
- 3 - All fasteners shall be grade 316 stainless steel w/ neoprene washers installed between nuts and aluminum plates.
- 4 - All welds must be 3/16" fillet minimum and in accordance with ANSI/AWS D.1.2/D1/2M gas metal arc welding (gmaw) process by experienced operators
- 5 - Coat all aluminum in contact with concrete and other dissimilar metals with bitumastic paint on the contact surface or 30# felt paper.
- 6 - All structures designed in accordance with Section 16 of the Florida Building Code 8th Edition - ASCE 7-22
- 7 - Artwork designed for 150 mph (3 second gust) ultimate wind speed, Risk Category 1, Exposure C,
- 8 - Assumed soil bearing pressure = 2500 psf.
- 9 - Compact subgrade to 95% of AASHTO T-180.
- 10 - All concrete shall be normal weight concrete (145 pcf) and strength shall meet $F_c' = 3000$ psi minimum 28 day compressive strength.
- 11 - Concrete work shall be in accordance with ACI 318, latest edition.
- 12 - All reinforcement shall be ASTM A615 Grade 60, deformed bars.
- 13 - Concrete reinforcement clear cover at minimum shall be:
 - 2" for formed concrete below grade
 - 3" for unformed concrete below grade
- 14 - Post-installed adhesive anchors shall use one of the following or engineer approved equivalent:
 - Ultrabond HS-1CC (ICC ES ESR-4094) By Adhesive Technology
 - Hilti HIT-RE 500 V3 (ICC ES ESR-3814) By Hilti
 - Set-XP (ICC ES ESR-2508) By Simpson Strongtie
 - Pure 110+ (ICC ES ESR-3298) By Dewalt



2035 VISTA PARKWAY
WEST PALM BEACH, FL 33411
OFFICE - 561.687.2220
WGINC.COM
WGI PROJECT NUMBER 10800.00

ENGINEER OF RECORD:
CHRISTOPHER B. LAFORTE
FLORIDA P.E. LICENSE NO.: 76797

DATE:



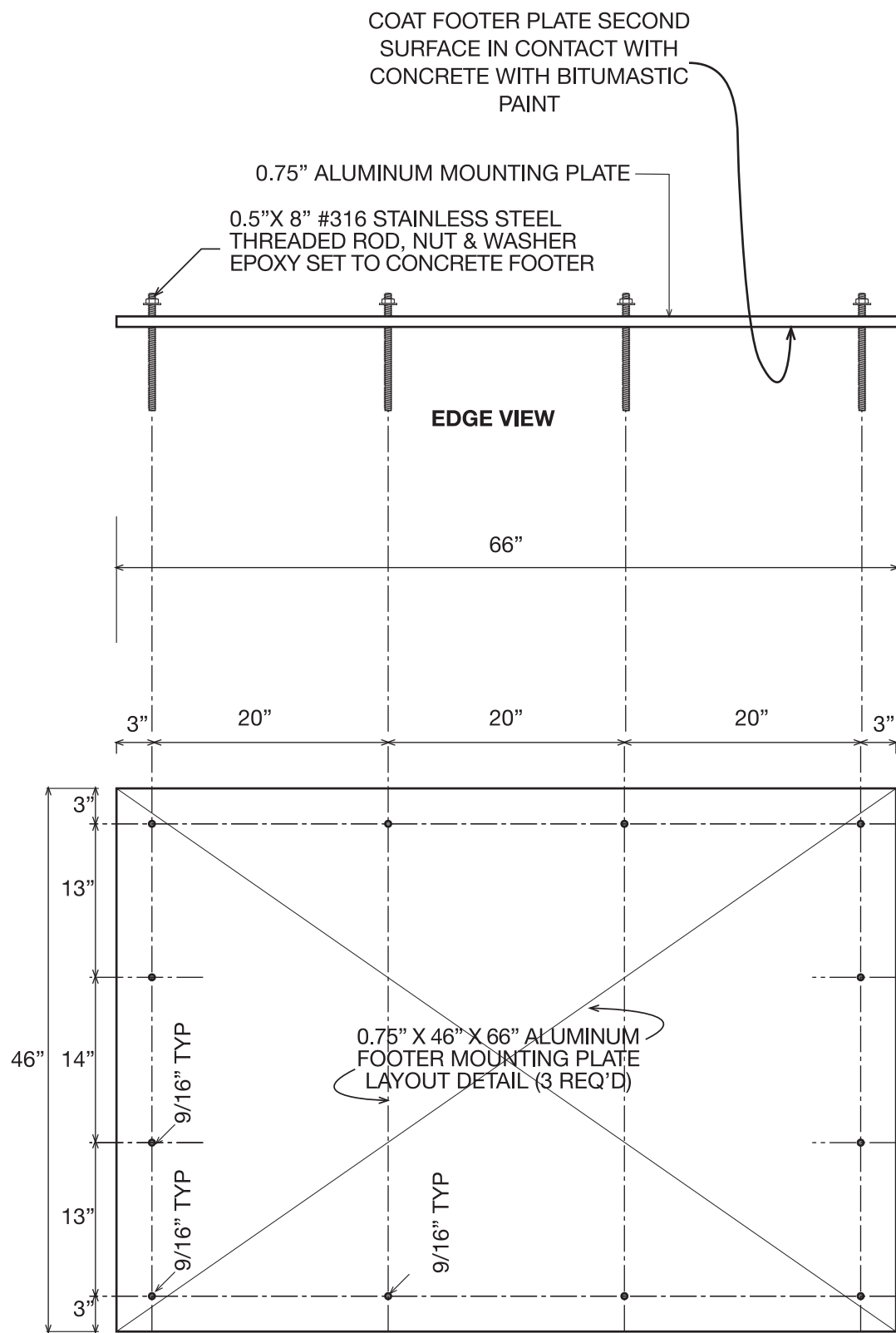

TYPICAL FOOTER MOUNTING PLATE
3 REQ'D PER FOOTER

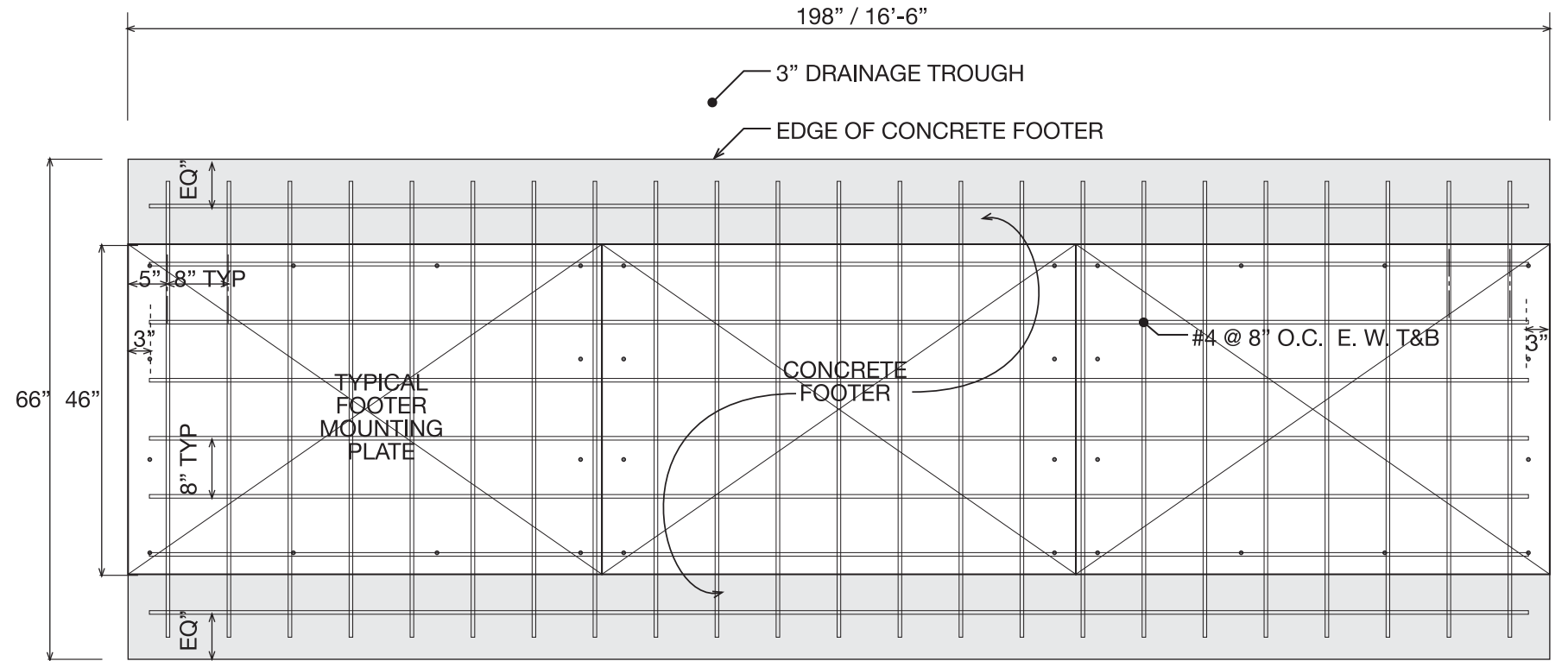

FOOTER MOUNTING PLATES ON CONCRETE FOOTER & REBAR SPACING LAYOUT

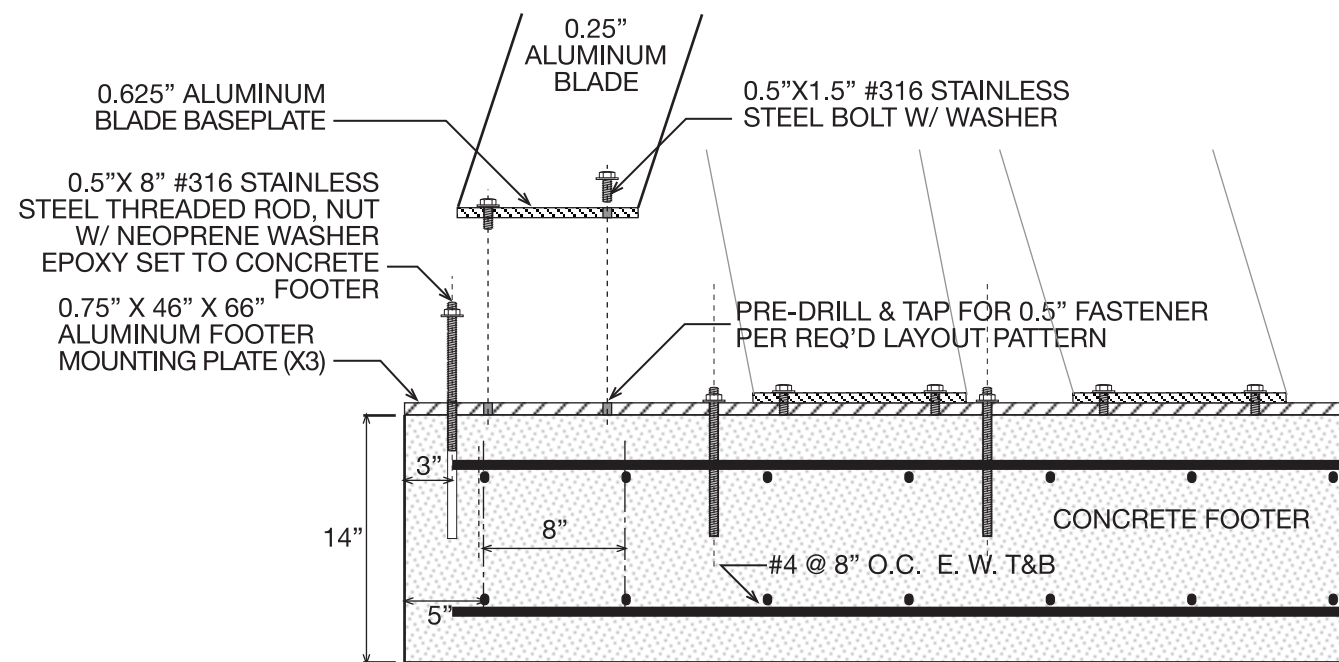
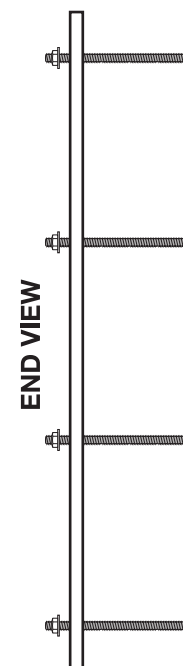

EXPLODED TYPICAL SECTION DETAIL

WGI
WGInc.com

2035 VISTA PARKWAY
WEST PALM BEACH, FL 33411
OFFICE - 561.687.2220
WGINC.COM
WGI PROJECT NUMBER 10800.00

ENGINEER OF RECORD:
CHRISTOPHER B. LAFORTE
FLORIDA P.E. LICENSE NO.: 76797

DATE:

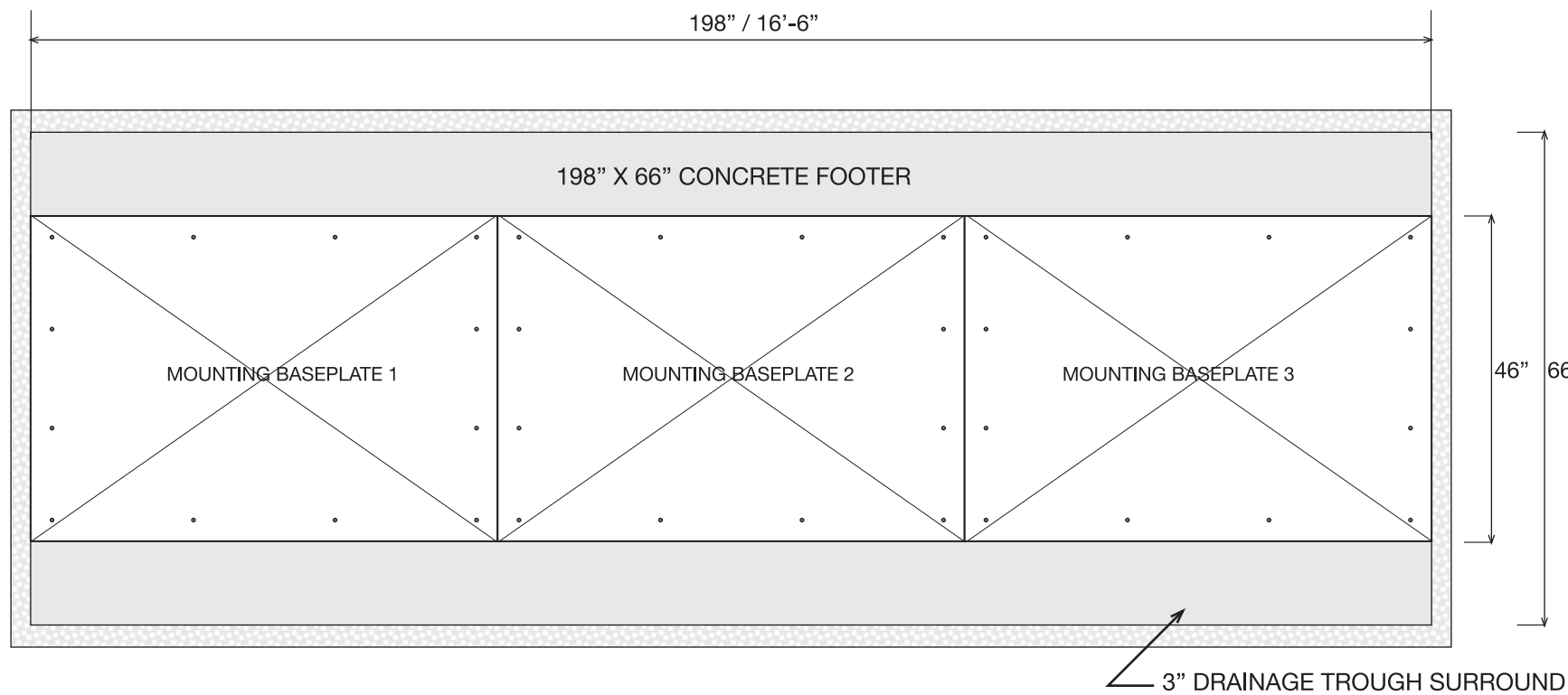

FOOTER MOUNTING PLATES - PLAN VIEW

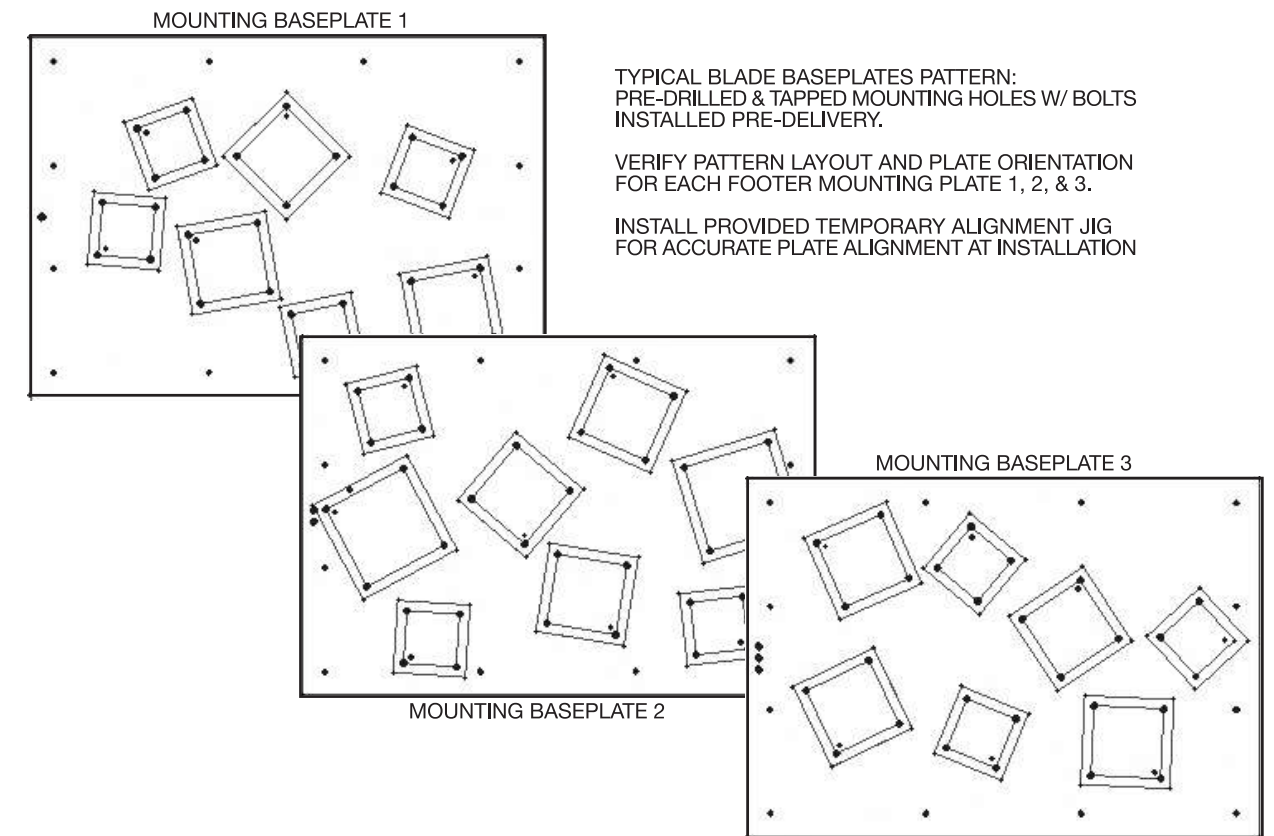

TYPICAL BLADE BASEPLATES PATTERN:
PRE-DRILLED & TAPPED MOUNTING HOLES W/ BOLTS
INSTALLED PRE-DELIVERY.

VERIFY PATTERN LAYOUT AND PLATE ORIENTATION
FOR EACH FOOTER MOUNTING PLATE 1, 2, & 3.

INSTALL PROVIDED TEMPORARY ALIGNMENT JIG
FOR ACCURATE PLATE ALIGNMENT AT INSTALLATION

FOOTER MOUNTING PLATES - HOLE PATTERNS

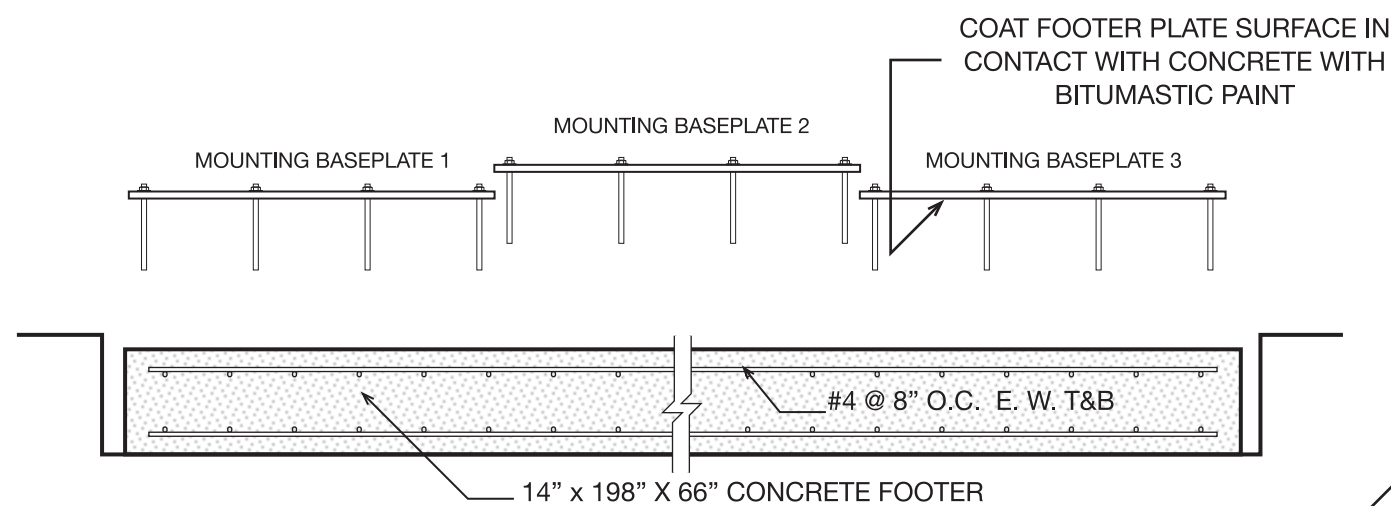

CONCRETE FOOTER FRONT VIEW

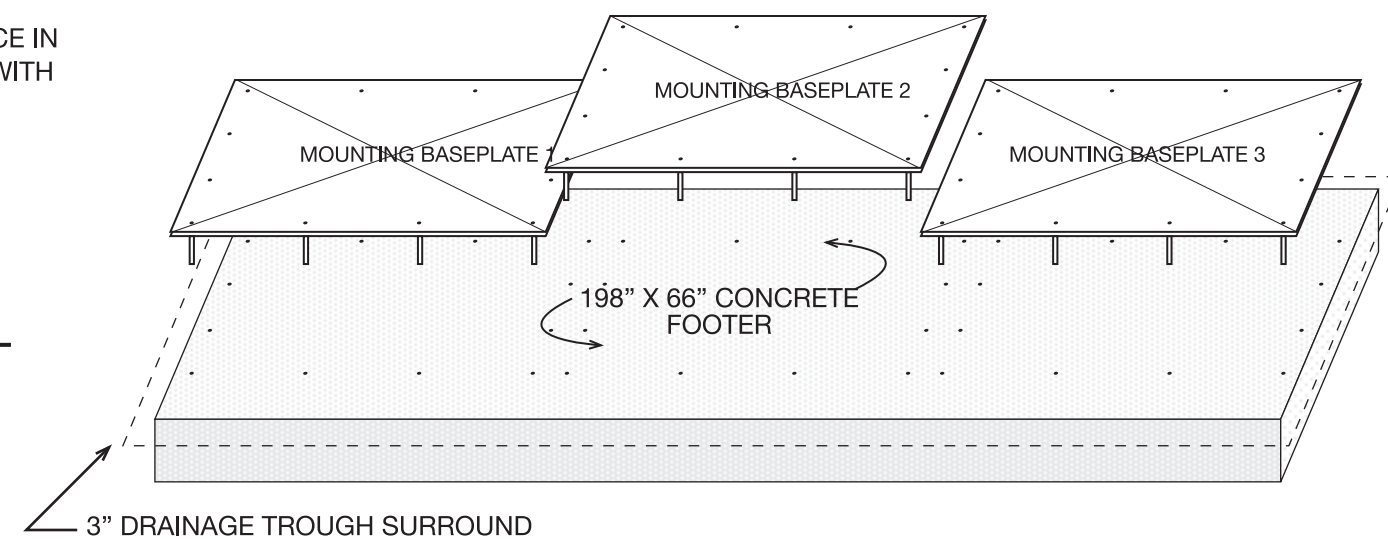

FOOTER & MOUNTING PLATE PERSPECTIVE SKETCH

WGI
WGInc.com

2035 VISTA PARKWAY
WEST PALM BEACH, FL 33411
OFFICE - 561.687.2220
WGINC.COM
WGI PROJECT NUMBER 10800.00

ENGINEER OF RECORD:
CHRISTOPHER B. LAFORTE
FLORIDA P.E. LICENSE NO.: 76797

DATE:

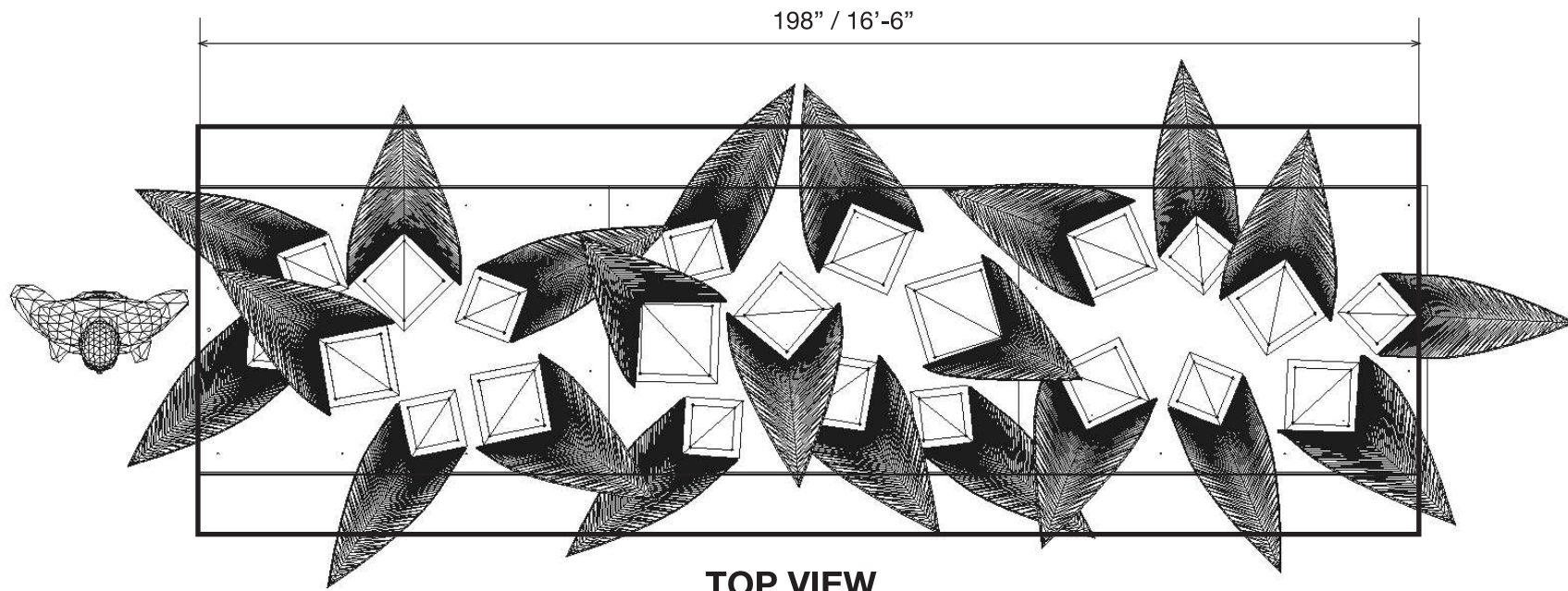

TOP VIEW

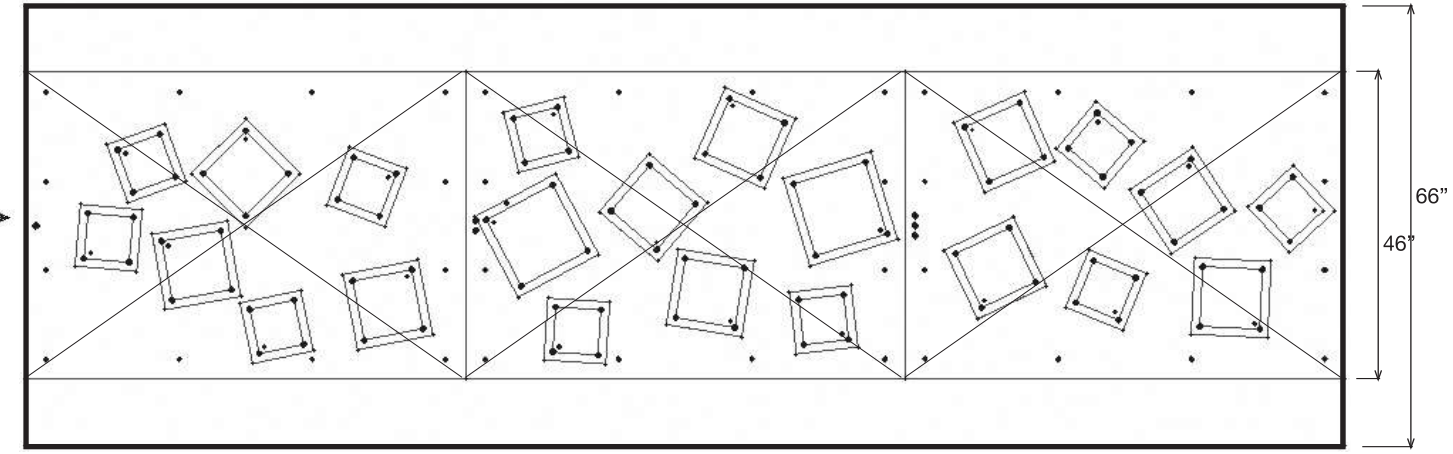

LAYOUT VIEW

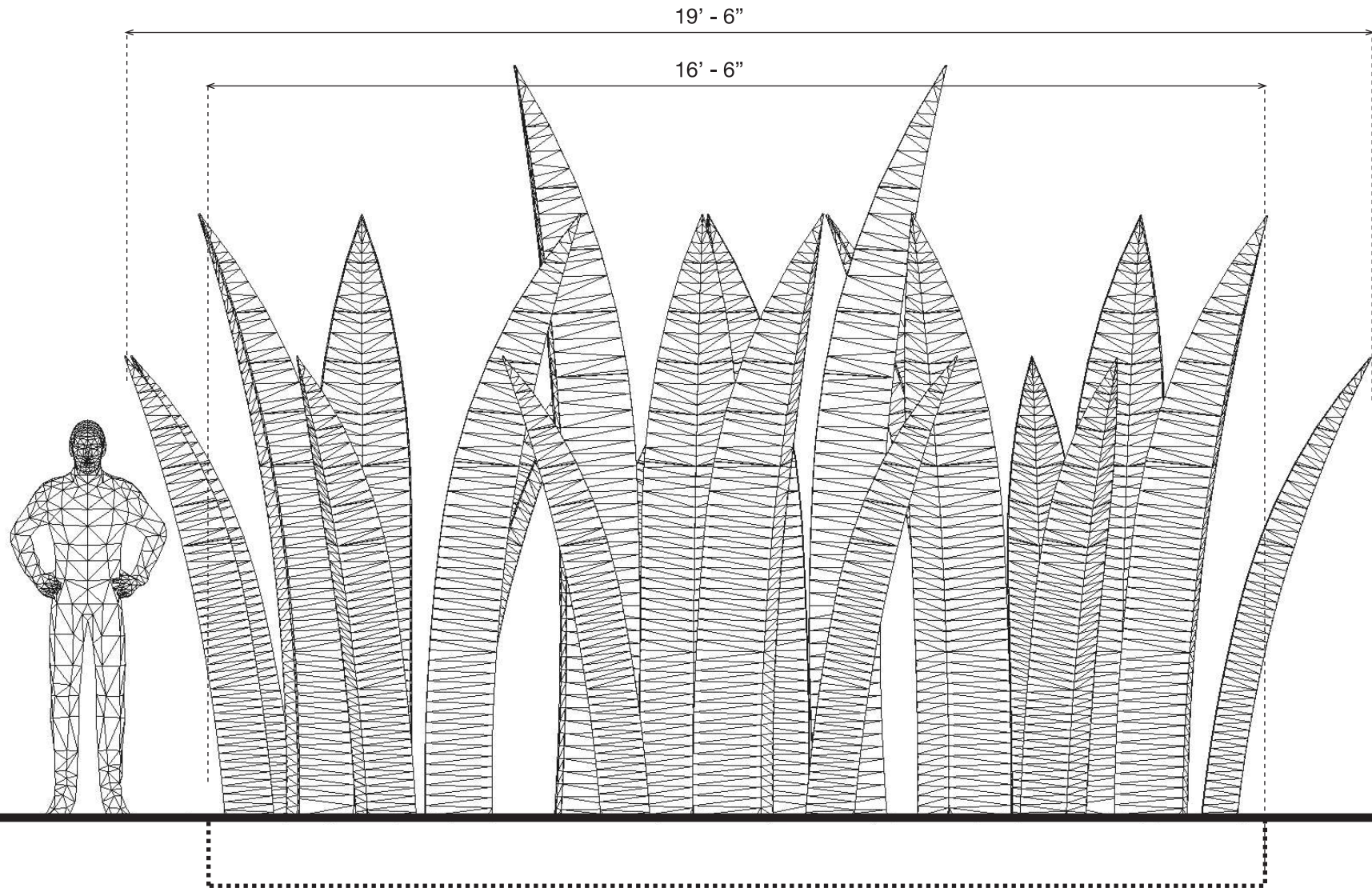

FRONT VIEW

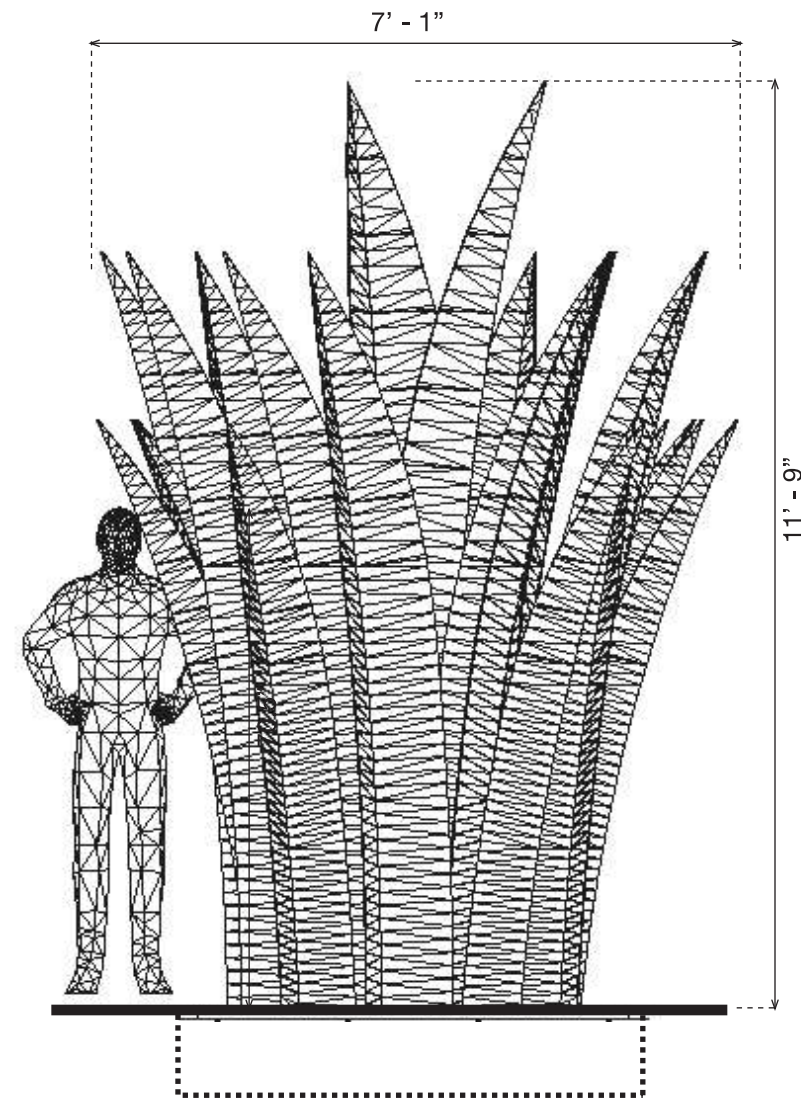

END VIEW

WGI
WGInc.com

2035 VISTA PARKWAY
WEST PALM BEACH, FL 33411
OFFICE - 561.687.2220
WGINC.COM
WGI PROJECT NUMBER 10800.00

ENGINEER OF RECORD:
CHRISTOPHER B. LAFORTE
FLORIDA P.E. LICENSE NO.: 76797

DATE: