

CPZ ARCHITECTS, INC.
4316 WEST BROWARD BOULEVARD
PLANTATION, FLORIDA 33317
PHONE: (954) 792-8532 FAX: (954) 337-0359

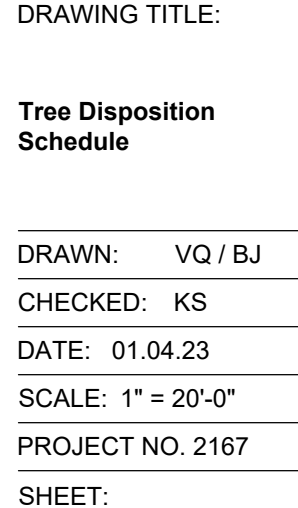

P22-339

Tag #	Common Name	Scientific Name	DBH (inches)	Disposition	Notes	
1	Slash Pine	<i>Pinus elliottii</i>	18	Preserve		
2	Slash Pine	<i>Pinus elliottii</i>	18	Preserve		
3	Slash Pine	<i>Pinus elliottii</i>	13	Preserve		
4	Slash Pine	<i>Pinus elliottii</i>	16	Preserve		
5	Slash Pine	<i>Pinus elliottii</i>	16	Preserve		
6	Queen Palm	<i>Syagrus romanzoffianum</i>	10	Remove		
7	Queen Palm	<i>Syagrus romanzoffianum</i>	10	Remove		
8	Laurel Oak	<i>Quercus laurifolia</i>	7	Remove		
9	Slash Pine	<i>Pinus elliottii</i>	15	Preserve		
10	Slash Pine	<i>Pinus elliottii</i>	14	Preserve		
11	Slash Pine	<i>Pinus elliottii</i>	18	Preserve		
12	Slash Pine	<i>Pinus elliottii</i>	12	Preserve		
13	Slash Pine	<i>Pinus elliottii</i>	13	Preserve		
14	Slash Pine	<i>Pinus elliottii</i>	10	Preserve		
15	Slash Pine	<i>Pinus elliottii</i>	12	Preserve		
16	Carrotwood	<i>Cupaniopsis anacardiodes</i>	9	Remove		Invasive
17	Live Oak	<i>Quercus virginiana</i>	15	Preserve		
18	Laurel Oak	<i>Quercus laurifolia</i>	18	Preserve		
19	Laurel Oak	<i>Quercus laurifolia</i>	11	Preserve		
20	Laurel Oak	<i>Quercus laurifolia</i>	20	Preserve		
21	Laurel Oak	<i>Quercus laurifolia</i>	12	Preserve		
22	Laurel Oak	<i>Quercus laurifolia</i>	10	Preserve		
23	Mahogany	<i>Swietenia mahogani</i>	11	Preserve		
24	Mahogany	<i>Swietenia mahogani</i>	10	Preserve		
25	Live Oak	<i>Quercus virginiana</i>	9	Preserve		Cluster
26	Live Oak	<i>Quercus virginiana</i>	15	Preserve		
27	Live Oak	<i>Quercus virginiana</i>	10	Preserve		Cluster
28	Bald cypress	<i>Taxodium distichum</i>	11	Remove		
29	Sabal Palm	<i>Sabal palmetto</i>	13	Remove		
30	Sabal Palm	<i>Sabal palmetto</i>	12	Remove		
31	Sabal Palm	<i>Sabal palmetto</i>	13	Remove		
32	Laurel Oak	<i>Quercus laurifolia</i>	16	Remove		
33	Laurel Oak	<i>Quercus laurifolia</i>	18	Remove		
34	Laurel Oak	<i>Quercus laurifolia</i>	15	Remove		
35	Laurel Oak	<i>Quercus laurifolia</i>	15	Remove		
36	Laurel Oak	<i>Quercus laurifolia</i>	15	Remove		
37	Laurel Oak	<i>Quercus laurifolia</i>	8	Remove		
38	Laurel Oak	<i>Quercus laurifolia</i>	18	Remove		
39	Norfolk Island Pine	<i>Araucaria excelsa</i>	9	Remove	Invasive	
40	Norfolk Island Pine	<i>Araucaria excelsa</i>	6	Remove		
41	Norfolk Island Pine	<i>Araucaria excelsa</i>	12	Remove	Invasive	
42	Live Oak	<i>Quercus virginiana</i>	15	Remove		
43	Norfolk Island Pine	<i>Araucaria excelsa</i>	12	Remove	Invasive	
44	Norfolk Island Pine	<i>Araucaria excelsa</i>	11	Remove		
45	Live Oak	<i>Quercus virginiana</i>	8	Preserve	Invasive	
46	Sabal Palm	<i>Sabal palmetto</i>	12	Remove		
47	Live Oak	<i>Quercus virginiana</i>	18	Remove		
48	Black Olive	<i>Terminalia buceras</i>	6	Remove		
49	Live Oak	<i>Quercus virginiana</i>	18	Preserve		
50	Live Oak	<i>Quercus virginiana</i>	20	Remove		
51	Live Oak	<i>Quercus virginiana</i>	18	Remove		
52	Live Oak	<i>Quercus virginiana</i>	24	Remove		
53	Sabal Palm	<i>Sabal palmetto</i>	9	Remove		
54	Sabal Palm	<i>Sabal palmetto</i>	9	Remove		
55	Laurel Oak	<i>Quercus laurifolia</i>	13	Remove		
56	Laurel Oak	<i>Quercus laurifolia</i>	12	Remove		
57	Laurel Oak	<i>Quercus laurifolia</i>	13	Remove		
58	Sabal Palm	<i>Sabal palmetto</i>	12	Remove		
59	Sabal Palm	<i>Sabal palmetto</i>	11	Remove		
60	Laurel Oak	<i>Quercus laurifolia</i>	15	Remove		
61	Laurel Oak	<i>Quercus laurifolia</i>	12	Remove		
62	Sabal Palm	<i>Sabal palmetto</i>	11	Remove		
63	Sabal Palm	<i>Sabal palmetto</i>	14	Remove		
64	Sabal Palm	<i>Sabal palmetto</i>	9	Remove		
65	Sabal Palm	<i>Sabal palmetto</i>	12	Remove		
66	Sabal Palm	<i>Sabal palmetto</i>	9	Remove		
67	Sabal Palm	<i>Sabal palmetto</i>	14	Remove		
68	Sabal Palm	<i>Sabal palmetto</i>	12	Remove		
69	Sabal Palm	<i>Sabal palmetto</i>	12	Remove		
70	Mahogany	<i>Swietenia mahogani</i>	19	Remove		
71	Sabal Palm	<i>Sabal palmetto</i>	11	Remove		
72	Sabal Palm	<i>Sabal palmetto</i>	11	Remove		
73	Sabal Palm	<i>Sabal palmetto</i>	12	Remove		
74	Mahogany	<i>Swietenia mahogani</i>	10	Remove		
75	Laurel Oak	<i>Quercus laurifolia</i>	10	Remove		
76	Laurel Oak	<i>Quercus laurifolia</i>	10	Remove		
77	Laurel Oak	<i>Quercus laurifolia</i>	10	Preserve		
78	Laurel Oak	<i>Quercus laurifolia</i>	10	Preserve		
79	Laurel Oak	<i>Quercus laurifolia</i>	21	Remove		
80	Florida Maple	<i>Acer rubum</i>	10	Remove		
81	Laurel Oak	<i>Quercus laurifolia</i>	16	Remove		
82	Laurel Oak	<i>Quercus laurifolia</i>	16	Remove		
83	Laurel Oak	<i>Quercus laurifolia</i>	16	Remove		
84	Laurel Oak	<i>Quercus laurifolia</i>	12	Remove		
85	Laurel Oak	<i>Quercus laurifolia</i>	11	Remove		

CONSULTANT:



PORT ST. LUCIE POLICE TRAINING FACILITY

121 SW PORT ST LUCIE BLVD
PORT ST. LUCIE, FL 34984

CPZ ARCHITECTS, INC.

4316 WEST BROWARD BOULEVARD
PLANTATION, FLORIDA 33317
PHONE: (954) 792-8525 FAX: (954) 337-0359
A #26900685 WWW.CPARCHITECTS.COM



DRAWING TITLE:

Landscape Plan

DRAWN: VQ / BJ

CHECKED: KS

DATE: 01.04.23

SCALE: 1" = 20'-0"

PROJECT NO. 216

SHEET:

LP-100

P22-339

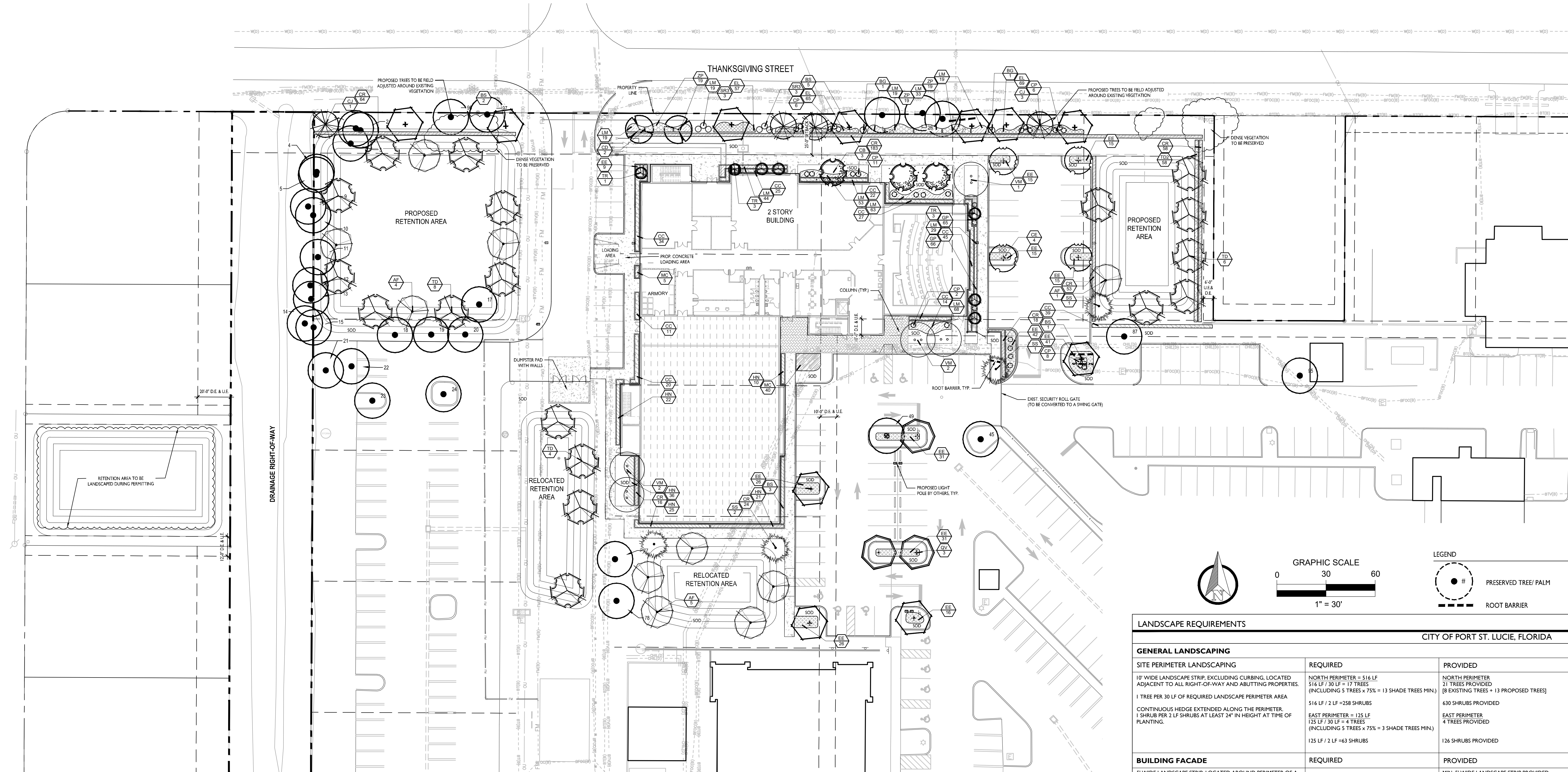

PLANT SCHEDULE OVERALL

AREES	QTY	COMMON NAME	BOTANICAL NAME	NATIVE	DROUGHT TOLERANCE	REMARKS
AF	10	Common Sugar Maple	Acer floridanum	YES	NO	16" HT X 6" SPRD, 3" CALIPER
BS	11	Gumbo Limbo	Bursera simaruba	YES	YES	14" HT. X 5" SPRD. MIN., 2.5" CAL
CJ	3	Pink Shower Tree	Cassia bakeriana	NO	YES	14" HT. X 5" SPRD. MIN., 2.5" CAL
CB	4	Rainbow Shower Tree	Cassia javanica	NO	YES	14" HT. X 5" SPRD. MIN., 2.5" CAL
CD	2	Pigeon Plum	Coccoloba diversifolia	YES	YES	14" HT. X 5" SPRD. MIN., 2.5" CAL
CE	4	Buttonwood	Conocarpus erectus	YES	YES	14" HT. X 5" SPRD. MIN., 2.5" CAL
CD	3	Southern Live Oak	Quercus virginiana	YES	YES	14" HT MIN, 5" SPRD MIN, 3" CAL.
QV	18	Bald Cypress	Taxodium distichum	YES	NO	14" HT X 5" SPRD. MIN., 3" CAL
PALMS	QTY	COMMON NAME	BOTANICAL NAME	NATIVE	DROUGHT TOLERANCE	REMARKS
SS	4	Cabbage Palmetto	Sabal palmetto	YES	YES	14 CT
TR	7	Florida Thatch Palm	Thrinax radiata	YES	YES	9 CT
VM	5	Montgomery Palm	Veitchia montgomeryana	NO	YES	DOUBLE TRUNK; 20' OA HT
SHRUBS	QTY	COMMON NAME	BOTANICAL NAME	NATIVE	DROUGHT TOLERANCE	REMARKS
BC	2	Yesterday, Today, and Tomorrow	Burrielia grandiflora	NO	YES	4" HT X 3" SPRD
GP	33	Petra Croton	Codiaeum variegatum 'Petra'	NO	YES	48" HT X 36" SPRD, FULL, LOW BRANCHED
SR3	6	Saw Palmetto	Serenoa repens	Yes	YES	18" HT. X 18" SPRD., FULL TO BASE
SHRUB AREAS	QTY	COMMON NAME	BOTANICAL NAME	NATIVE	DROUGHT TOLERANCE	REMARKS
CC	237	Jamaica Caper	Capparis cynophallophora	YES	YES	36" HT X 24" SPRD @24" O.C
CR	416	Red Tip Cocoplum	Chrysobalanus icaco 'Red Tip'	YES	YES	72" HT X 24" SPRD @ 24" O.C TO BE MAINTAINED AT 6' HT MIN.
EE	282	Elliott's Love Grass	Eragrostis elliottii	YES	YES	24" HT X 24" SPRD @ 24" O.C
HN	114	Dwarf Firebush	Hamelia nodosa	NO	YES	24" HT X 24" SPRD @ 24" O.C.
MC	45	Pink Muihy Grass	Muhlenbergia capillaris	YES	YES	24" HT X 24" SPRD @ 24" O.C
T02	58	Dwarf Fakahatchee	Tripsacum floridana	YES	YES	36" HT X 24" SPRD @ 24" O.C
ZP	57	Coontie Cud	Zamia pumila	YES	YES	24" HT X 24" SPRD., @24" O.C
GROUND COVERS	QTY	COMMON NAME	BOTANICAL NAME	NATIVE	DROUGHT TOLERANCE	REMARKS
EL	191	Golden Creeping	Erodia littoralis	YES	YES	15" HT X 18" SPRD @ 18" O.C
GP	131	Annual Gallardia	Gallardia pulchella	YES	YES	12" HT X 12" SPRD @12" O.C.
LM	366	Lilyturf	Liriope muscari	NO	YES	18" HT X 18" SPRD @ 18" O.C.

PSLUSD LANDSCAPE NOTES:

1. NO LANDSCAPING SHALL BE PLANTED IN A MANNER THAT WOULD ADVERSELY AFFECT UTILITY EASEMENTS. LANDSCAPING SHALL BE IN COMPLIANCE WITH CHAPTER 154 OF THE CITY OF PORT ST. LUCIE CODE OF ORDINANCES, PSUSD TECHNICAL SPECIFICATIONS AND POLICIES.
2. ALL LANDSCAPING WITHIN CITY UTILITY EASEMENTS SHALL COMPLY WITH PSUSD TECHNICAL SPECIFICATIONS, POLICIES, AND CODES.
3. ALL LANDSCAPING SHALL MEET THE LATEST PSUSD LANDSCAPE POLICY AND SHALL NOT BE PLACED IN SUCH A MANNER THAT IT WOULD CREATE CONFLICTS WITH THE INTENDED OPERATION AND MAINTENANCE OF ANY EXISTING UTILITY.
4. TREES SHALL NOT BE PLANTED WITHIN TEN (10) FEET OF ANY PSUSD UNDERGROUND INFRASTRUCTURE.
5. NO LANDSCAPING OTHER THAN SO GRASSES SHALL BE LOCATED WITHIN 5' OF A PSUSD APPURTENANCE SUCH AS A WATER METER ASSEMBLY, BACKFLOW DEVICE, FIRE HYDRANT OR SEWER CLEANOUT, ETC.

NOTE: ALL LANDSCAPING MEETS FDOT CLEAR ZONE AND SIGHT DISTANCE CRITERIA

LANDSCAPE REQUIREMENTS		
CITY OF PORT ST. LUCIE, FLORIDA		
GENERAL LANDSCAPE REQUIREMENTS		
SITE PERIMETER LANDSCAPING	REQUIRED	PROVIDED
10' WIDE LANDSCAPE STRIP, EXCLUDING CURBING, LOCATED ADJACENT TO ALL RIGHT-OF-WAY AND ABUTTING PROPERTIES. 1 TREE PER 30 LF OF REQUIRED LANDSCAPE PERIMETER AREA CONTINUOUS HEDGE EXTENDED ALONG THE PERIMETER. 1 SHRUB PER 2 LF SHRUBS AT LEAST 24" IN HEIGHT AT TIME OF PLANTING.	NORTH PERIMETER = 516 LF 516 LF / 30 LF = 17 TREES (INCLUDING 5 TREES x 75% = 13 SHADE TREES MIN) 516 LF / 2 LF = 258 SHRUBS EAST PERIMETER = 125 LF 125 LF / 30 LF = 4 TREES (INCLUDING 5 TREES x 75% = 3 SHADE TREES MIN) 125 LF / 2 LF = 63 SHRUBS	NORTH PERIMETER 21 TREES PROVIDED [8 EXISTING TREES + 13 PROPOSED TREES] 630 SHRUBS PROVIDED EAST PERIMETER 4 TREES PROVIDED 126 SHRUBS PROVIDED
BUILDING FACADE	REQUIRED	PROVIDED
5' WIDE LANDSCAPE STRIP, LOCATED AROUND PERIMETER OF A BUILDING ADJACENT TO ALL RIGHT-OF-WAY AND ABUTTING PROPERTIES. 1 TREE / PALM PER 30 LF OF BUILDING FACADE CONTINUOUS HEDGE EXTENDED ALONG THE PERIMETER. 1 SHRUB PER 2 LF SHRUBS AT LEAST 24" IN HEIGHT AT TIME OF PLANTING.	420 LF / 30 LF = 14 TREES / PALMS 420 LF / 2 LF = 210 SHRUBS	MIN. 5' WIDE LANDSCAPE STRIP PROVIDED 15 TREES PROVIDED [3 PROPOSED TREES + 7 PROPOSED SINGLE PALMS + 5 PROPOSED DOUBLE PALMS] 379 SHRUBS PROVIDED
VEHICULAR USE AREAS		
PARKING LOT INTERIOR LANDSCAPE	REQUIRED	PROVIDED
1 PARKING ISLAND AT EACH END OF A PARKING BAY WITH 1 SHADE TREE AND THE REMAINDER OF THE ISLAND LANDSCAPED WITH A GROUND COVER, MULCH, SHRUBS OR OTHER TREATMENT EXCLUDING PAVING.	15 PARKING ISLANDS = 15 SHADE TREES	15 TREES PROVIDED [3 EXISTING TREES + 11 PROPOSED TREES + 1 PROPOSED PALM] (1 ISLAND HAS UNDERGROUND UTILITIES PRESENT)
PLANT MATERIAL STANDARDS		
PLANT SPECIES		PROVIDED
MIN 50% OF TOTAL TREE MATERIAL MUST BE NATIVE		83% OF TREES PROVIDED ARE NATIVE
MAX 25% OF SHALL BE PALMS		20% OF TREES PROVIDED ARE PALMS
MIN 20% MUST BE FLOWERING TREES		24% OF TREES PROVIDED ARE FLOWERING TREES
MIN 75% SHALL BE EVERGREEN TREES		75% OF TREES PROVIDED ARE EVERGREEN TREES
MIN. 5 TREE SPECIES		10 TREE SPECIES PROVIDED
MIN 25% OF TOTAL SHRUBS MUST BE NATIVE		88% OF SHRUBS ARE NATIVE
MIN 10% OF GROUNDCOVERS SHALL BE FLOWERING		19% OF GROUNDCOVERS ARE FLOWERING
MIN. 50% OF PLANT MATERIAL SHALL BE DROUGHT TOLERANT		100% OF SHRUBS AND GROUND COVER PROVIDED ARE DROUGHT TOLERANT
TREE MITIGATION	REQUIRED	PROVIDED
TREES	566" DBH REMOVED = 566" DBH REQUIRED	566.5" DBH PROVIDED [411" DBH PRESERVED + 155.5" DBH PROPOSED (25 TREES @ 2.5" DBH + 31 TREES @ 3" DBH)]
PALMS	21 PALMS REMOVED = 21 PALMS REQUIRED	21 PALMS PROVIDED [11 SINGLE PALMS PROVIDED + 5 DOUBLE PALMS PROVIDED]

NOT FOR CONSTRUCTION

NOTE:
1. APPLICABLE TO ALL PALMS WITH CALIPER SIZE OF LESS THAN SIX (6) INCHES.
2. ALL TREE SUPPORTS MATERIALS ARE TO BE REMOVED FROM EACH TREE ONCE IT IS ESTABLISHED. TYPICALLY SIX MONTHS FOR SHADE TREES OR ONE YEAR FOR PALMS.

1. APPLICABLE TO ALL PALMS WITH CALIPER SIZE OF LESS THAN SIX (6) INCHES.

2. ALL TREE SUPPORTS MATERIALS ARE TO BE REMOVED FROM EACH TREE ONCE IT IS ESTABLISHED. TYPICALLY SIX MONTHS FOR SHADE TREES OR ONE YEAR FOR PALMS.

(3) 2" X 4" WOOD BRACES.
STAKE OUTSIDE PLANTING HOLE ZONE.

OUTSIDE EDGE OF PLANTING SAUCER.

120°

(3) WOOD BATTENS STRAPPED TO TRUNK WITH GALVANIZED METAL BANDS. ATTACH WOOD BRACES TO BATTENS TO AVOID TRUNK DAMAGE.
WRAP TRUNK WITH 3 LAYERS OF NATURAL BURLAP FOR PROTECTION AGAINST WOOD BATTENS AND STAKING BRACES.

PALM OR TREE TRUNK (SET VERTICAL AND PLUMB, TYP.).

* SEE PLAN IF SPECIAL SETTING/LEANING DIRECTIONS EXIST FOR PALMS

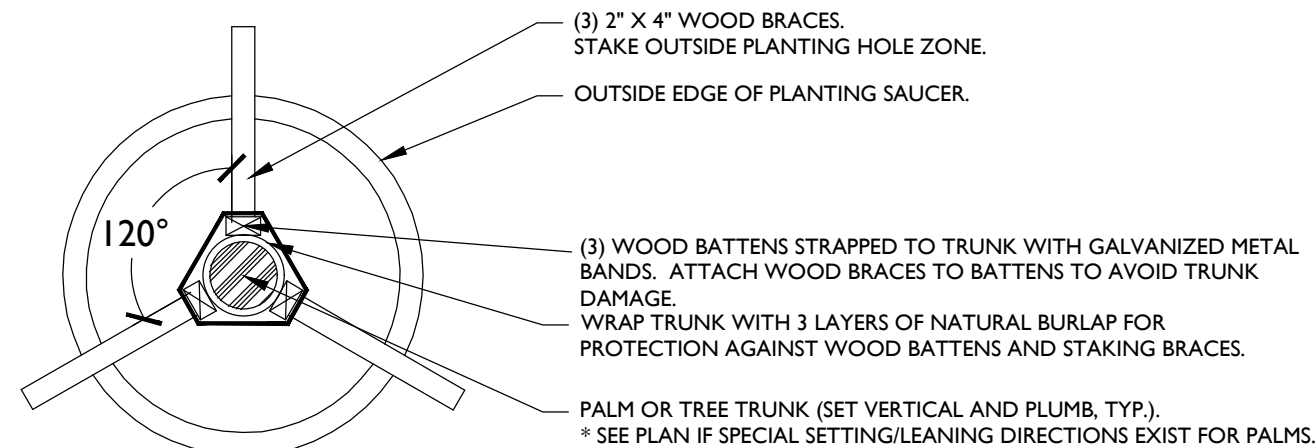

NOTE:
1. APPLICABLE TO ALL MULTI-TRUNK PALMS AND PALMS WITH CALIPER SIZE OF SIX (6) INCHES OR GREATER
2. ALL TREE SUPPORTS MATERIALS ARE TO BE REMOVED FROM EACH TREE ONCE IT IS ESTABLISHED. TYPICALLY SIX MONTHS FOR SHADE TREES OR ONE YEAR FOR PALMS.

1. APPLICABLE TO ALL MULTI-TRUNK PALMS AND PALMS WITH CALIPER SIZE OF SIX (6) INCHES OR GREATER
 2. ALL TREE SUPPORTS MATERIALS ARE TO BE REMOVED FROM EACH TREE ONCE IT IS ESTABLISHED, TYPICALLY SIX MONTHS FOR SHADE TREES OR ONE YEAR FOR PALMS.

(4) 2" X 4" WOOD BRACES.
 STAKE OUTSIDE PLANTING HOLE ZONE.

OUTSIDE EDGE OF PLANTING SAUCER.

(4) WOOD BATTENS STRAPPED TO TRUNK WITH METAL BANDS.
 ATTACH WOOD BRACES TO BATTENS TO AVOID TRUNK DAMAGE.

WRAP TRUNK WITH 3 LAYERS OF NATURAL BURLAP FOR PROTECTION AGAINST WOOD BATTENS AND STAKING BRACES.

PALM OR TREE TRUNK (SET VERTICAL AND PLUMB, TYP.).
 * SEE PLAN IF SPECIAL SIGHTING OR LEANING DIRECTIONS EXIST FOR

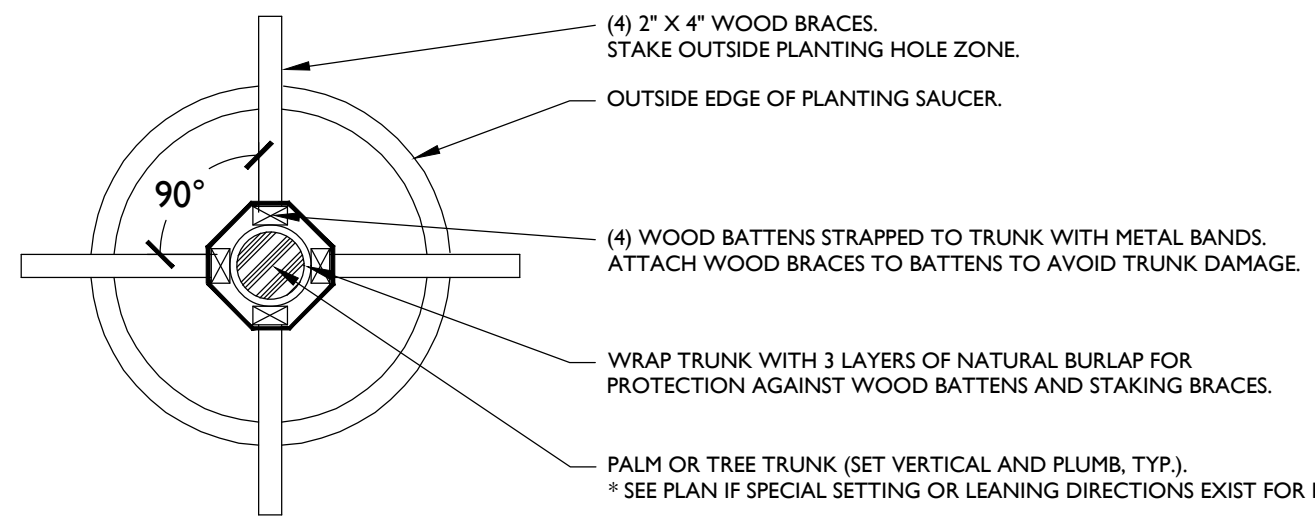

NTS

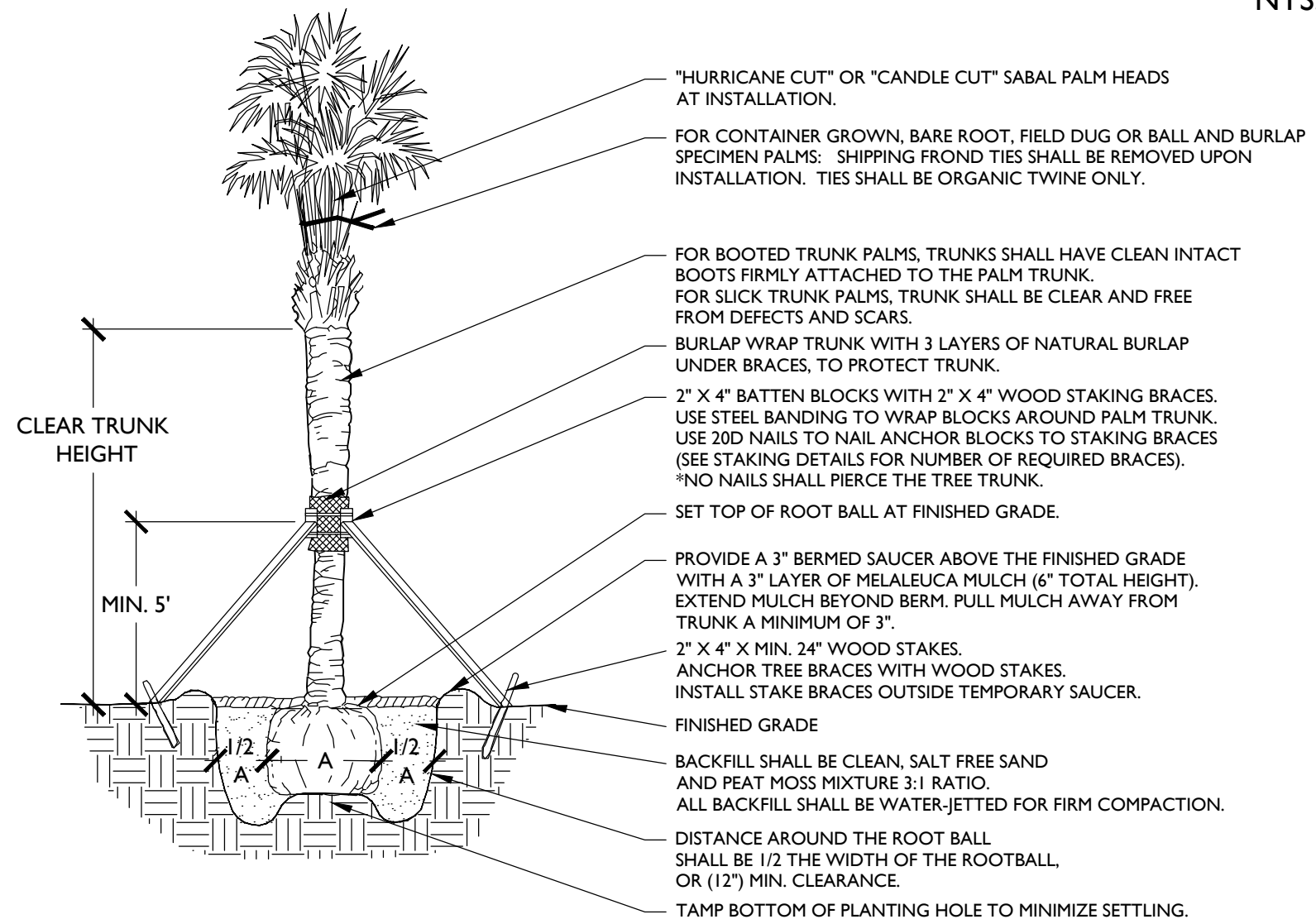

NOTE:
I. ALL TREE SUPPORT MATERIALS ARE TO BE REMOVED FROM EACH TREE ONCE IT IS ESTABLISHED. TYPICALLY SIX MONTHS TO ONE YEAR AFTER PLANTING FOR SHADE TREES.

1. ALL TREE SUPPORT MATERIALS ARE TO BE REMOVED FROM EACH TREE ONCE IT IS ESTABLISHED. TYPICALLY SIX MONTHS TO ONE YEAR AFTER PLANTING FOR SHADE TREES.

NEVER CUT TERMINAL LEADER.
THIN BRANCHES AND FOLIAGE AS DIRECTED BY LANDSCAPE ARCHITECT OR CERTIFIED ARBORIST.

FLEXIBLE GUYING MATERIAL.
LOCATE ABOVE FIRST LATERAL BRANCH.
AVOID OVER TIGHTENED TIES AS THEY PREVENT TREE'S NATURAL SWAY.

SAFETY FLAGGING

WOODEN STAKES.
SET STAKES OUTSIDE PLANTING SAUCER AT A MINIMUM DEPTH OF 2 FEET.

TRUNK FLARE OR TOP ROOT VISIBLE ON SURFACE.
DO NOT BURY ROOT IN MULCH.

SET ROOT BALL SLIGHTLY ABOVE GRADE (10% MAXIMUM, OR 2" ABOVE FINISHED GRADE).

3" SHREDDED MELALEUCA MULCH.
WITH 3" BERMED PLANTING SAUCER (6" TOTAL HEIGHT) ABOVE THE FINISHED GRADE.
EXTEND MULCH BEYOND BERM.
PULL MULCH AWAY FROM TRUNK FLARE A MINIMUM OF 3".

BACKFILL HOLE WITH APPROVED SOIL MIX (CHECK WITH LANDSCAPE ARCHITECT FOR MIX).
WATER LET ALL BACKFILL FOR FIRM COMPACTION.
TREE PLANTING SAUCER

REMOVE ROOT BALL COVERING.
CUT BACK WIRE BASKETS BELOW TOP HALF OF THE ROOT BALL.
FOLD BACK BURLAP COVERING MATERIALS BELOW TOP HALF OF ROOT BALL.
COMPLETELY REMOVE SYNTHETIC BURLAP COVERING MATERIALS

TAMP BOTTOM OF PLANTING HOLE TO MINIMIZE SETTLING.

PROVIDE A PLANTING HOLE WITH A MINIMUM OF 3 TIMES THE DIAMETER OF THE ROOT BALL ON THE SURFACE AND TWO TIMES THE ROOT BALL DIAMETER AT THE BASE.

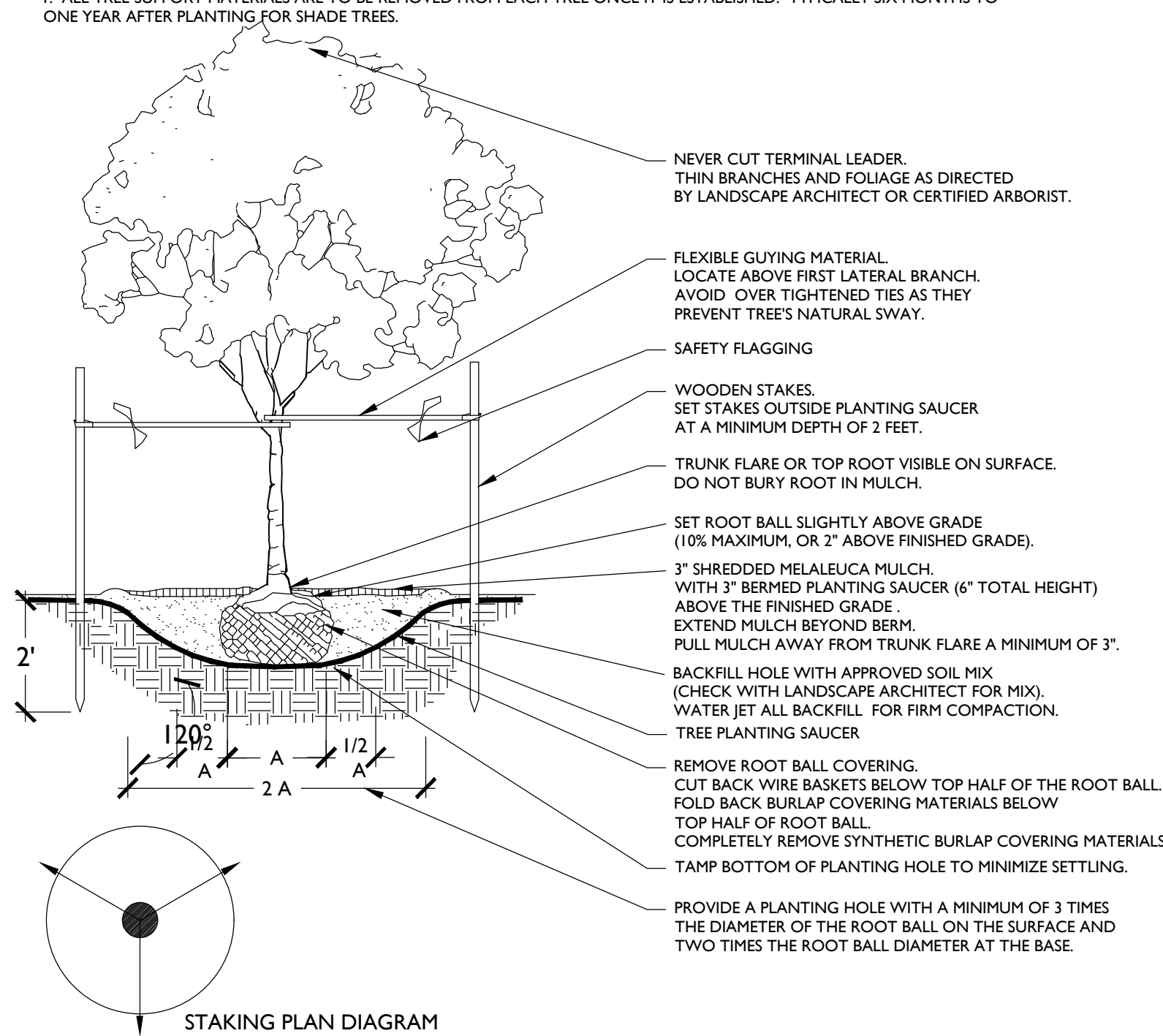

1" OF SHREDDED MELALEUCA MULCH NTS.

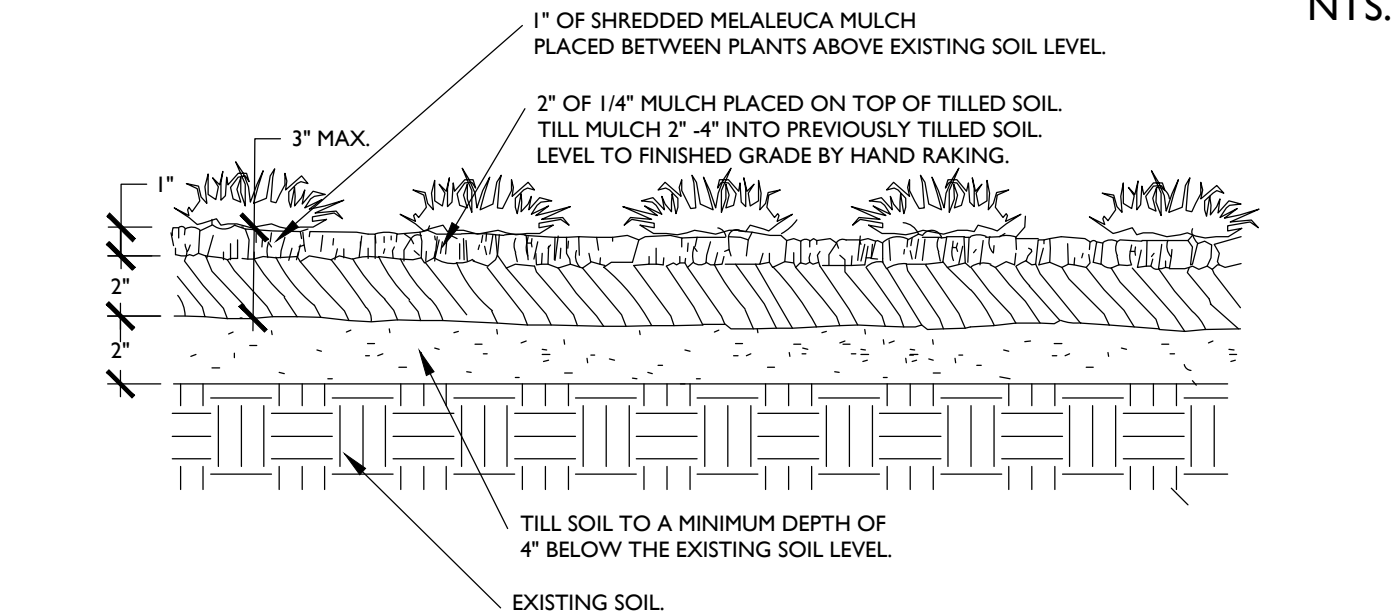

NTS.

SPACING "D"	ROW "A"
6" O.C.	5.2"
8" O.C.	6.93"
10" O.C.	8.66"
12" O.C.	10.4"
18" O.C.	15.6"
24" O.C.	20.8"
30" O.C.	26.0"
36" O.C.	31.2"
48" O.C.	41.6"

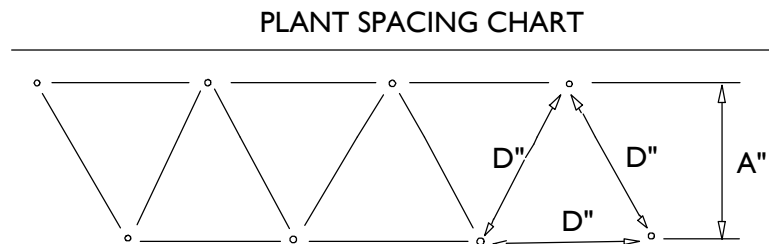

NTS.

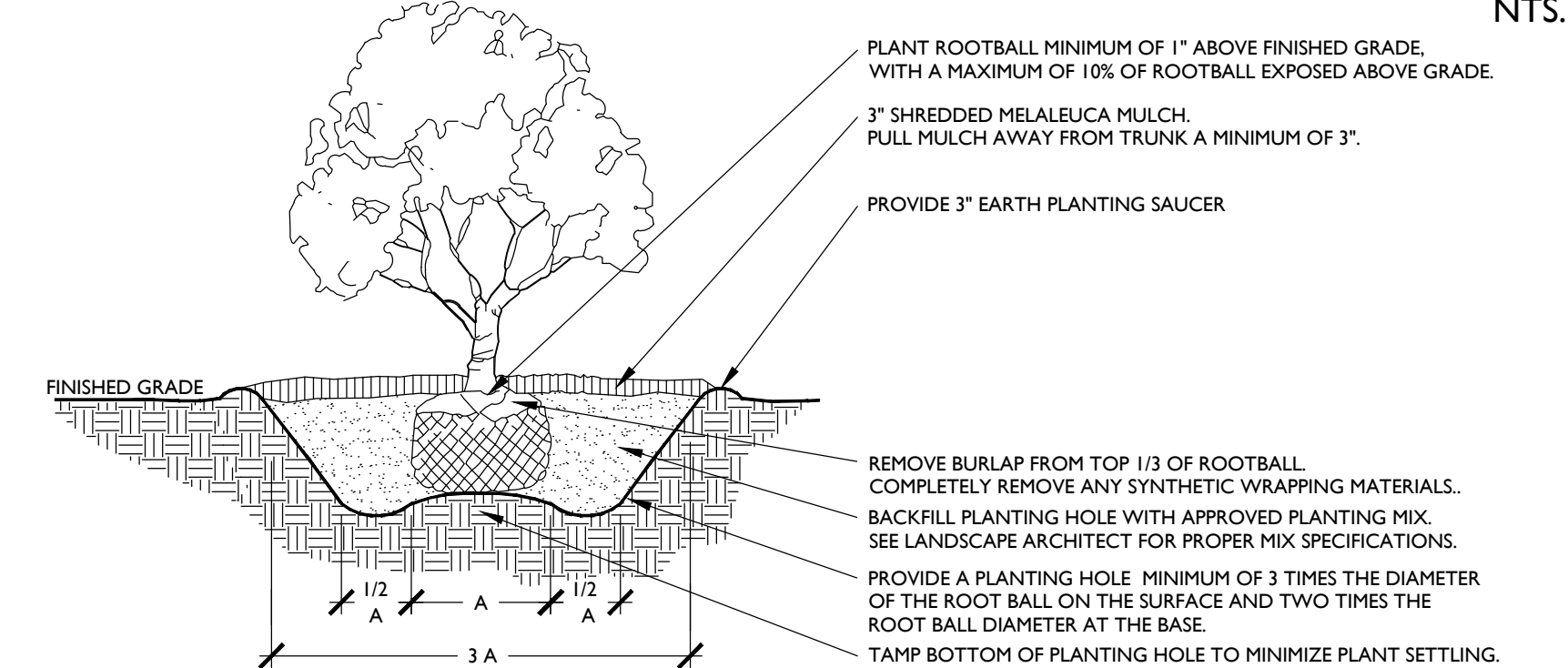

NOTE:
1. TREES ARE TO BE INSTALLED WITH

NOTE:
1. TREES ARE TO BE INSTALLED WITH A MINIMUM TEN FOOT (10') SEPARATION FROM ANY PUBLIC WATER OR PUBLIC SEWER MAIN AND/OR SERVICE, HYDRANTS, AND LIFT STATIONS. IF A TEN FOOT (10') SEPARATION CANNOT BE ACHIEVED, THE TREE SHALL BE INSTALLED WITH A ROOT BARRIER SYSTEM.

2. ROOT BARRIERS SHALL COMPLY WITH ALL REQUIREMENTS OF THE MUNICIPALITY WITHIN WHICH THEY ARE LOCATED AS WELL AS WITH ANY REQUIREMENTS OF THE UTILITY HOLDER OF THE AFFECTED UTILITIES. IN THE EVENT THAT CONFLICTING REQUIREMENTS EXIST BETWEEN THIS ROOT BARRIER DETAIL AND THE MUNICIPALITY/UTILITY HOLDER REQUIREMENTS, THE MORE STRINGENT OF THE REQUIREMENTS SHALL BE APPLICABLE.

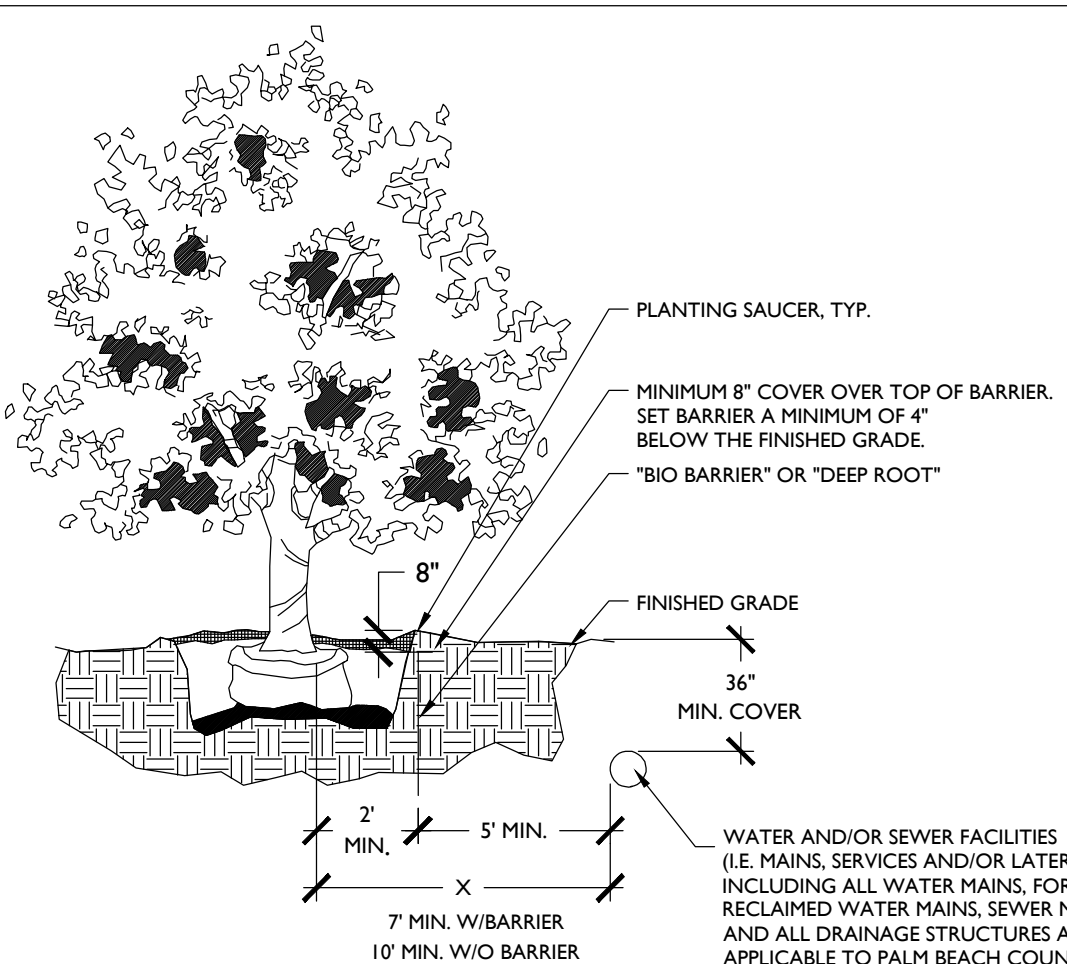

NTS.

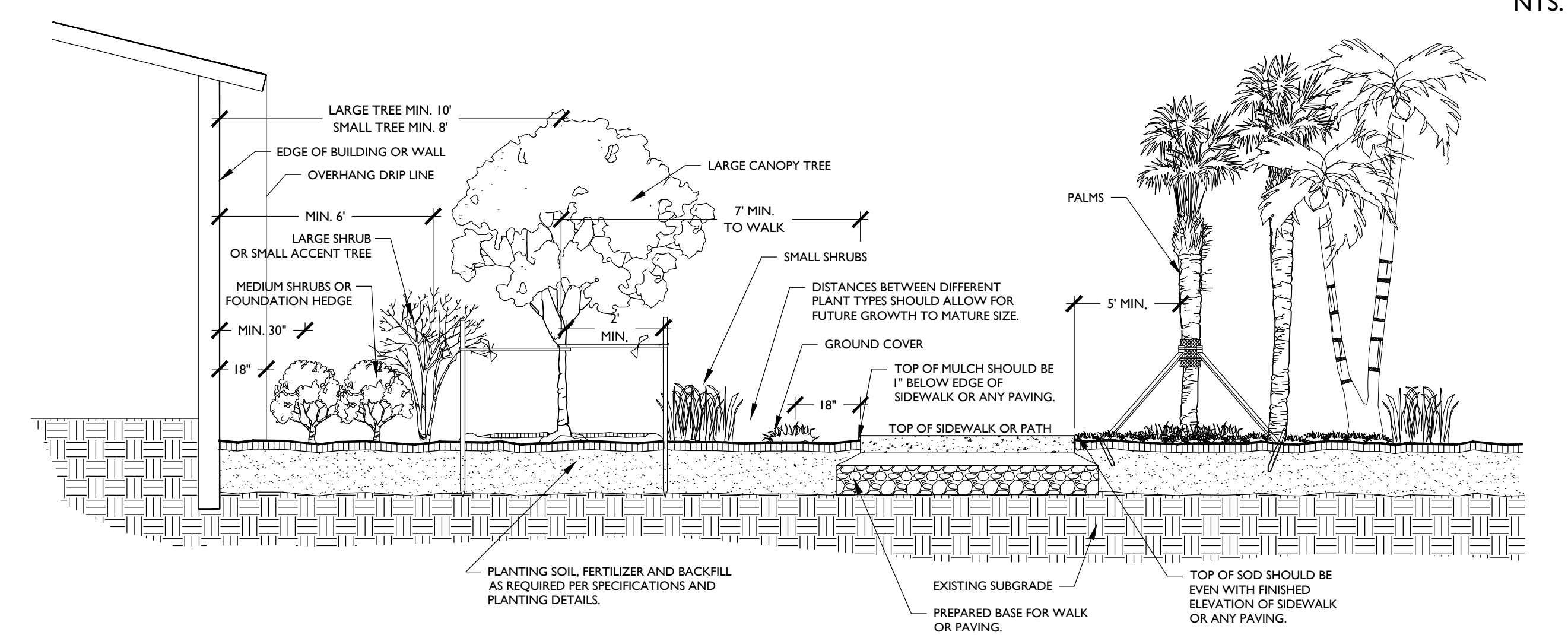

NOTE: 1. THIS DETAIL APPLIES TO ALL TREES THAT WILL BE PRESERVED IN PLACE OR BE RELOCATED.

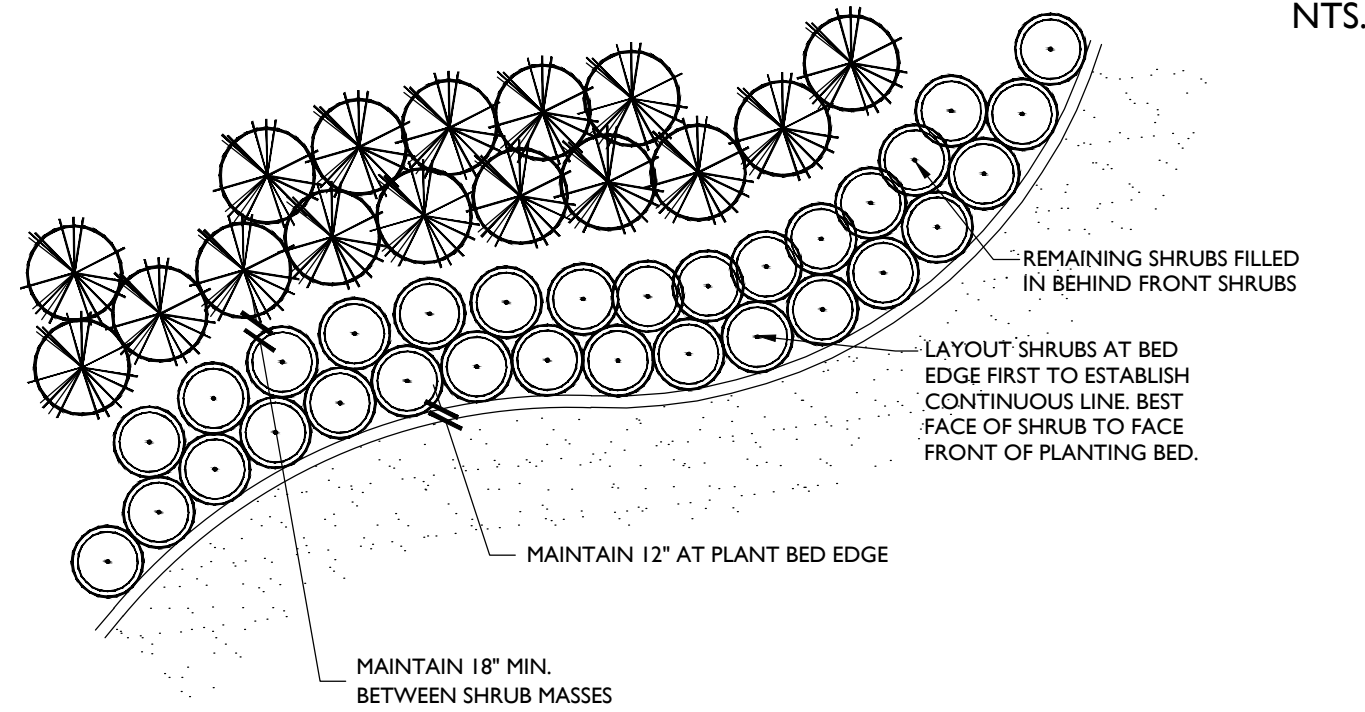
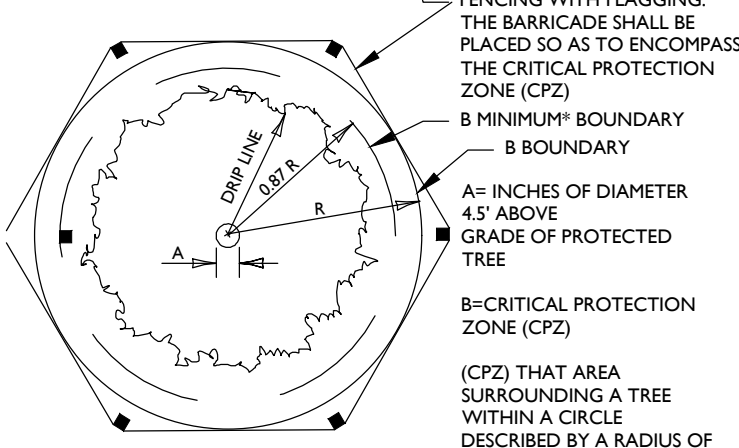
[illegible]

1. STRUCTURAL ELEMENTS AND HARDSCAPE FEATURES INDICATED ON LANDSCAPE PLANS ARE FOR INFORMATIONAL PURPOSES ONLY. LANDSCAPE PLANS SHOULD BE TO BE UTILIZED FOR LOCATION OF LIVING PLANT MATERIAL ONLY. LANDSCAPE PLANS SHOULD NOT BE UTILIZED FOR STAKING AND LAYOUT OR LOCATION OF ANY STRUCTURAL SITE FEATURES INCLUDING BUT NOT LIMITED TO: BUILDINGS, SIGNAGE, PATHWAYS, EASEMENTS, BERMS, WALL, FENCES, UTILITY BOXES OR MANHOLES.
2. THE CONTRACTOR SHALL ACQUIRE ALL APPLICABLE FEDERAL, STATE, LOCAL, JURISDICTIONAL OR UTILITY COMPANY PERMITS REQUIRED PRIOR TO REMOVAL, RELOCATION, AND/OR INSTALLATION OF LANDSCAPE MATERIALS INDICATED WITHIN PLAN DOCUMENTS. THE CONTRACTOR SHALL HAVE PERMITS "IN HAND" PRIOR TO STARTING WORK. LANDSCAPE ARCHITECT SHALL BEAR NO RESPONSIBILITY FOR WORK PERFORMED WITHOUT PERMITTED DRAWINGS. THE CONTRACTOR SHALL BE RESPONSIBLE FOR ALL CHANGES TO THE WORK, AT NO ADDITIONAL COST TO THE OWNER, AS A RESULT OF UNAUTHORIZED WORK PRIOR TO RECEIPT OF PERMIT.
3. TREES SHOWN ON THIS PLAN ARE FOR GRAPHIC REPRESENTATION ONLY. TREE SPACING IS BASED ON DESIGN REQUIREMENTS AND STANDARDS. IN EXERCISING THESE PLANS, ATTEMPT TO ACHIEVE THAT SPACING WHILE MAINTAINING THE REQUIRED SETBACKS FROM UTILITIES. IN THE EVENT OF A CONFLICT, AFFECTED PLANT MATERIAL SHALL BE HELD ADJUSTED WITH THE APPROVAL OF THE LANDSCAPE ARCHITECT TO AVOID CONFLICTS WITH THE WITH EXISTING AND PROPOSED UTILITIES, LIGHT POLES, DRAINAGE STRUCTURES OR LINES, LAKE MAINTENANCE EASEMENTS OR OTHER AFFECTED SITE FEATURES.
4. ANY PLANTING WITHIN THE SIGHT TRIANGLES SHALL PROVIDE UNOBSTRUCTED VIEWS AT A LEVEL BETWEEN 30" AND 8' ABOVE THE PAVEMENT.
5. ALL UTILITY BOXES/STRUCTURES TO BE SCREENED ON 3 SIDES W/ APPROVED PLANTING MATERIAL.
6. RELOCATION OF EXISTING TREES PROVIDING 100% COVERAGE WITH A MAXIMUM OF 50% OVERLAP, AN AUTOMATIC RAIN SENSOR MUST BE INCLUDED.
7. ALL PLANT MATERIAL TO BE INSTALLED SHALL CONFORM TO FLORIDA POWER AND LIGHT'S (FPLS) TRIPLE TREE RIGHT PLACE GUIDELINES.
8. IN CASE OF DISCREPANCIES PLANTS TAKE PRECEDENCE OVER PLANT LIST.
9. LANDSCAPE CONTRACTOR RESPONSIBLE FOR VERIFICATION OF ALL QUANTITIES PRIOR TO BIDDING.
10. REMOVAL OF EXISTING VEGETATION IS RESPONSIBILITY OF LANDSCAPE CONTRACTOR.
11. RELOCATION OF EXISTING VEGETATION IS RESPONSIBILITY OF LANDSCAPE CONTRACTOR. REFER TO SPECIFICATIONS FOR RELOCATION INSTRUCTIONS.
12. ALL PLANT MATERIAL TO BE FLORIDA GRADE #1 AT TIME OF INSTALLATION UNLESS OTHERWISE NOTED.
13. NO LANDSCAPING SHALL BE PLANTED IN A MANNER THAT WOULD ADVERSELY AFFECT UTILITY EASEMENTS. LANDSCAPING SHALL BE IN COMPLIANCE WITH CHAPTER 154 OF THE CITY OF PORT ST. LUCIE CODE OF ORDINANCES, PLUSLUD TECHNICAL SPECIFICATIONS AND POLICIES.
14. ALL LANDSCAPING WITHIN CITY UTILITY EASEMENTS SHALL COMPLY WITH PLUSLUD TECHNICAL SPECIFICATIONS, POLICIES, AND CODES.
15. ALL LANDSCAPING SHALL MEET THE LATEST PLUSLUD LANDSCAPE POLICY AND SHALL NOT BE PLACED IN A MANNER THAT WOULD CREATE CONFLICTS WITH THE INTENDED OPERATION AND MAINTENANCE OF ANY EXISTING UTILITY.
16. TREES SHALL NOT BE PLANTED WITHIN TEN (10) FEET OF ANY PLUSLUD UNDERGROUND INFRASTRUCTURE.
17. NO LANDSCAPING OTHER THAN SO GRASSES SHALL BE LOCATED WITHIN 5' OF A PLUSLUD APPURTENANCE SUCH AS A WATER METER ASSEMBLY, BACKFLOW DEVICE, FIRE HYDRANT OR SEWER COLLECTION, ETC.

CONSULTANT:



PORT ST. LUCIE POLICE TRAINING
FACILITY
121 SW PORT ST LUCIE BLVD
PORT ST. LUCIE, FL 34984

CPZ ARCHITECTS, INC.
4316 WEST BROWARD BOULEVARD
PLANTATION, FLORIDA 33317
PHONE: (954) 792-8525 FAX: (954) 337-4359
E-MAIL: info@cpzarchitects.com
WEB: www.cpzarchitects.com



DRAWING TITLE:

Landscape Details

DRAWN:	VQ / BJ
CHECKED:	KS
DATE:	01.04.23
SCALE:	1" = 20'-0"
PROJECT NO.	2167
SHEET:	

LP-500

P22-339

