

# Cotleur & Hearing

Landscape Architects  
Land Planners  
Environmental Consultants  
1934 Commerce Lane  
Suite 1  
Jupiter, Florida 33458  
561.747.6336 · Fax 747.1377  
www.cotleurhearing.com  
Lic# LC-26000535

# Gatlin Pointe

Port St. Lucie, Florida

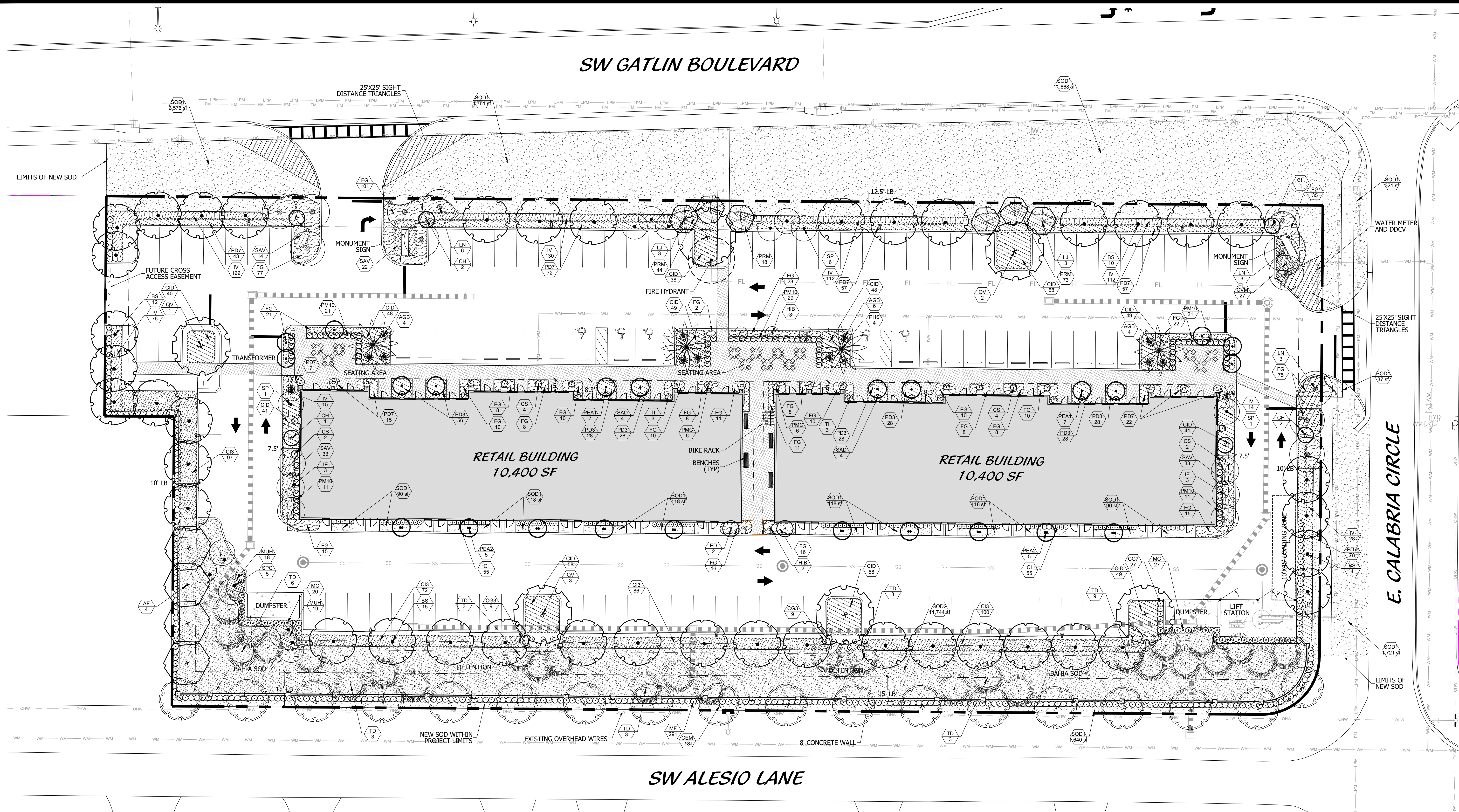

### LOCATION MAP

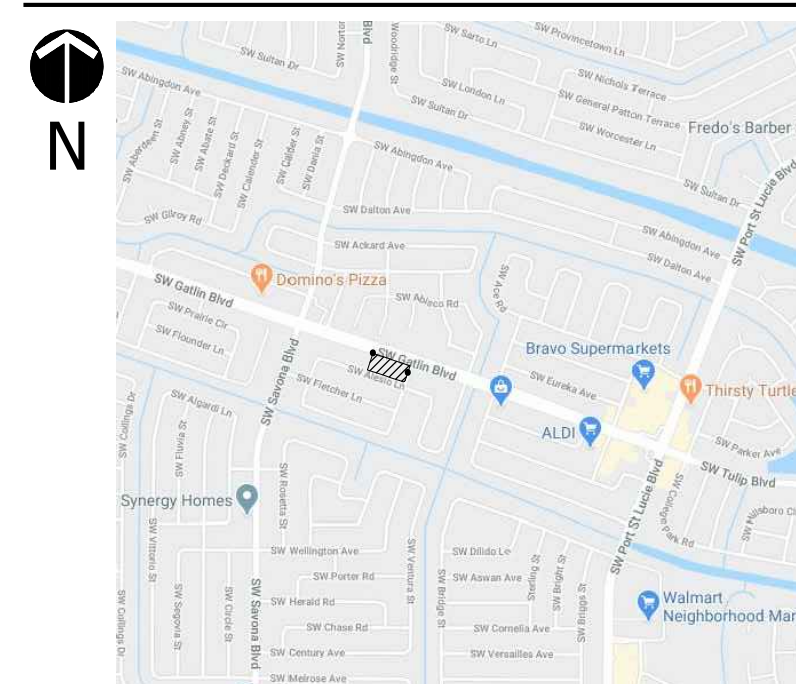

### LANDSCAPE DATA

TOTAL SITE AREA	111,680.67 SF		
	2.56 AC		
<b>LANDSCAPE BUFFER REQUIREMENTS</b>			
NORTH (REQ. 10' WIDE, 1 TREE PER 30', CONT. HEDGE 2' O.C.)	525.30	18	19
EAST (REQ. 10' WIDE, 1 TREE PER 30', CONT. HEDGE 2' O.C.)	221.80	7	7
* 2 MIDSTORY TREES = 1 12' TREE			
SOUTH (REQ. 10' WIDE, 1 TREE PER 30', CONT. HEDGE 2' O.C.)	495.30	17	17
* 2 MIDSTORY TREES = 1 12' TREE			
WEST (REQ. 10' WIDE, 1 TREE PER 30', CONT. HEDGE 2' O.C.)	220.00	7	13
<b>VEHICULAR USE LANDSCAPE AREA REQ.</b>			
(1) TREE PER LANDSCAPE ISLAND		REQUIRED	PROVIDED
		18	
<b>FOUNDATION PLANTING</b>			
RETAIL 1 TOTAL PERIMETER (REQ. 5' WIDE, 1 TREE PER 30', HEDGE 2' O.C.)	493.98	16	19
RETAIL 2 TOTAL PERIMETER (REQ. 5' WIDE, 1 TREE PER 30', HEDGE 2' O.C.)	493.98	16	19

### MITIGATION TABLE

<b>TREE MITIGATION DATA</b>	
TOTAL INCHES (DBH) PINES ON SITE	1,671
TOTAL INCHES (DBH) OAKS ON SITE	145
TOTAL DBH INCHES	1,816
TOTAL INCHES TO BE REMOVED	1,816
TOTAL INCHES TO BE MITIGATED ON SITE*	43.5
*TOTAL ON SITE MITIGATION: 29 TREES 3"=87" (1/2 CREDIT BY CODE) = 43.5"	
TOTAL INCHES REMAINING TO BE MITIGATED OFF SITE**	1,772.5
**OFF SITE MITIGATION TO INCLUDE PLANTING AND/OR CONTRIBUTION INTO THE CITY TREE PRESERVATION FUND.	

- NO LANDSCAPING SHALL BE PLANTED IN A MANNER THAT WOULD ADVERSELY AFFECT UTILITY EASEMENTS. LANDSCAPING SHALL BE IN COMPLIANCE WITH CHAPTER 153 OF THE CITY OF PORT ST. LUCIE CODE OF ORDINANCES, PSLUSD TECHNICAL SPECIFICATIONS AND POLICIES.
- ALL LANDSCAPING WITHIN CITY UTILITY EASEMENTS SHALL COMPLY WITH PSLUSD TECHNICAL SPECIFICATIONS, POLICIES, AND CODES.
- ALL LANDSCAPING SHALL MEET THE LATEST PSLUSD LANDSCAPE POLICY AND SHALL NOT BE PLACED IN A MANNER THAT WOULD CREATE CONFLICTS WITH THE INTENDED OPERATION AND MAINTENANCE OF ANY EXISTING UTILITY.
- TREES SHALL NOT BE PLANTED WITHIN TEN (10) FEET OF ANY PSLUSD INFRASTRUCTURE.
- NO LANDSCAPING OTHER THAN SOD GRASSES SHALL BE LOCATED WITHIN 5' OF A PSLUSD APPURTENANCE SUCH AS WATER METER ASSEMBLY, BACKFLOW DEVICE, FIRE HYDRANT OR SEWER CLEANOUT, ETC.

## Landscape Plan

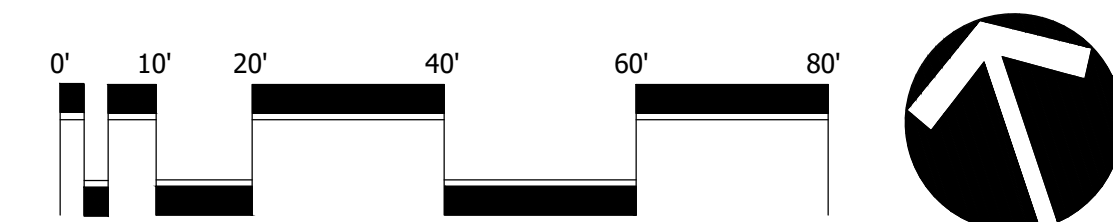

CITY OF PSL PROJECT #P20-239  
PSLUSD PROJECT NO. 5381

Scale: 1" = 20'-0"

North

DESIGNED	DEH
DRAWN	RO
APPROVED	DEH
JOB NUMBER	20-0704
DATE	07-29-20
REVISIONS	09-01-20
	11-13-20
	12-17-20
	12-21-20

January 25, 2021 9:46:23 a.m.  
Drawing: 20-0704.LP.DWG

SHEET 1 OF 2

© COTLEUR & HEARING, INC.  
These drawings are the property of the architect and are not to be used for extensions or on other projects except by agreement in writing with the architect. Immediately report any discrepancies to the architect.

