

# MARSHALL PARKWAY AT RIVERLAND PARCEL 'B' - PHASE 2

## (RIVERLAND MPUD) PLANTING PLANS

### SHEET KEY

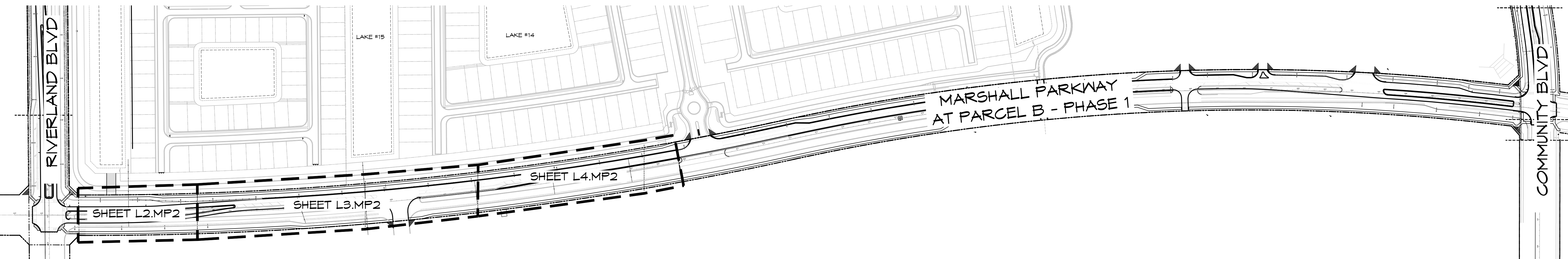

### Plant Specifications

SPECIES AND SIZE shall conform to those indicated on the drawings. Nomenclature shall conform to STANDARDIZED PLANT NAMES, current edition. All nursery stock shall be in accordance with Grades and Standards for Nursery Plants Parts I & II, latest edition published by the Florida Department of Agriculture and Consumer Services. All plants not otherwise specified as being Florida Fancy or Specimen, shall be Florida Grade Number 1 or better as determined by the Florida Division of Plant Industry. Specimen means an exceptionally heavy, symmetrical, tightly knit plant, so trained or favored in its development that first appearance is unquestionable and outstandingly superior in form, number of branches, compactness and symmetry.

#### GENERAL REQUIREMENTS

All plants shall be freshly dug, sound, healthy, vigorous, well branched, and free of disease and insect eggs and larvae, and shall have adequate root systems. Trees for planting rows shall be uniform in size and shape. All materials shall be subject to approval by the Landscape Architect. Where any requirements are omitted from the plant list, the plants furnished shall be normal for the variety. Plants shall be pruned prior to delivery only upon the approval of the Landscape Architect.

#### CONTAINER GROWN STOCK

All container grown material shall be healthy, vigorous, well rooted plants, and established in the container in which they are sold. The plants shall have tops which are good quality and in a healthy growing condition. An established container grown plant shall be grown in that container sufficiently long enough for the new fibrous roots to have developed so that the root mass will retain its shape and hold together when removed from the container. Plant root bound in containers are unacceptable.

#### MEASUREMENTS

**Trees:** Height shall be measured from ground to the average height of canopy. Spread shall be measured to the end of branching equally around the crown from the center of the trunk. Measurements are not to include any terminal growth. Single trunk trees shall be free of "V" crotches that could be points of weak, limp structure or disease infestation.

**Shrubs:** Heights shall be measured from the ground to the average points where mature plant growth stops. Spread shall be measured to the end of branching equally around the shrub mass. Measurements are not to include any terminal growth.

**Palms:** Clear Trunk (C.T.) shall be measured from the ground at the time of installation to the point where the mature aged trunk joins the immature or green portion of the trunk or the head.

Overall height (O.H.) shall be measured from the ground at the time of installation to a point three quarters the length of the unopened bud. Palms with marred or burned trunks will not be accepted.

#### SOIL

Planting soil for use in preparing backfill for plant pits shall be added at a rate of seventy-five (75%) percent to twenty-five (25%) percent existing soil. This soil mix shall be used in all plant pits except Sabal palms which shall be backfilled with clean sand. Planting soil shall be a fertile, friable natural topsoil or loamy character. It shall contain forty (40) to fifty (50) percent decomposed organic matter and shall be free from heavy clay, stones, lime, plants, roots or other foreign materials or noxious grasses (such as Bermuda or nut grass) and noxious weeds. It shall not contain toxic substances which may be harmful to plant growth.

#### COMMERCIAL FERTILIZER

Two fertilizer shall be used in all types of plantings, except palms. Granular fertilizer shall be uniform in composition, dry and free flowing. This fertilizer shall be delivered to the site in the original unopened bags, each bearing the Manufacturer's statement of analysis, and shall meet the following requirements: sixteen (16%) percent nitrogen, seven (7%) percent phosphorus, twelve (12%) percent potassium, plus iron. Tablet fertilizer ("Agriform" or equal) in 21 gram size shall meet the following requirements: twenty (20%) percent nitrogen, ten (10%) percent phosphorus, five (5%) percent potassium.

The two fertilizers will be applied at the following rates:

PLANT SIZE	16"-12"	"AGRIFORM" TABLET (21 grams)
1 gal.	1/4 lb.	1
3 gal.	1/2 lb.	2
7-15 gal.	1/2 lb.	4
1"-6" caliper	2 lbs./1" caliper	2/1" caliper
6" and larger	3 lbs./1" caliper	2/1" caliper

"Florida East Coast Palm Special" will be applied to all palms at installation at a rate of 1/2 lb. per inch of trunk caliper unless otherwise specified.

#### MULCH

Mulch material shall be three (3) inches of shredded Class 'A' mulch (sterilized and free of seeds) or approved equal, moistened at the time of application to prevent wind displacement.

#### SUBSTITUTIONS

No substitutions of plant material types or size will be allowed without written consent of the Landscape Architect. B&B material will not be accepted as substitute for container grown material unless previously approved. Alternate substitutions shall be indicated in bid.

### PSLUSD Notes:

LANDSCAPE PLANS shall be submitted for the PROJECT INDICATING the LOCATION OF LANDSCAPE AREAS, PERIMETER WALLS, FOUNDATIONS, BERMES, TREE WELLS, FENCES, GATES, SIGNS, DECORATIVE ROCKS, SCULPTURE, FOUNTAINS, AND ANY OTHER FEATURES THAT MAY INFLUENCE the LOCATION OF WATER / WASTEWATER / RECLAIMED WATER FACILITIES; ALSO, EXISTING AND PROPOSED WATER / WASTEWATER / RECLAIMED FACILITIES, AND RIGHT-OF-WAY, LOT LINES AND ALL ADJACENT INFORMATION, SHOWING OFFICIAL RECORD BOOK AND PAGE NUMBER SHALL BE INCLUDED. THE PLANS SHALL INCLUDE AND CONFORM TO THE FOLLOWING STANDARD NOTES:

- NO LANDSCAPING SHALL BE PLANTED IN A MANNER THAT WOULD ADVERSELY AFFECT UTILITY EASEMENTS. LANDSCAPING SHALL BE IN COMPLIANCE WITH CHAPTER 154 OF THE CITY OF PORT ST. LUCIE CODE OF ORDINANCES, PSLUSD TECHNICAL SPECIFICATIONS AND POLICIES.
- ALL LANDSCAPING WITHIN CITY UTILITY EASEMENTS SHALL COMPLY WITH PSLUSD TECHNICAL SPECIFICATIONS, POLICIES, AND CODES.
- ALL LANDSCAPING SHALL MEET THE LATEST PSLUSD LANDSCAPE POLICY AND SHALL NOT BE PLACED IN A MANNER THAT WOULD CREATE CONFLICTS WITH THE INTENDED OPERATION AND MAINTENANCE OF ANY EXISTING UTILITY.
- TREES SHALL NOT BE PLANTED WITHIN TEN (10) FEET OF ANY PSLUSD UNDERGROUND INFRASTRUCTURE, EXCEPT AS ALLOWED BY CITY OF PORT ST. LUCIE UTILITY SYSTEMS DEPARTMENT LANDSCAPE POLICY.
- NO LANDSCAPING OTHER THAN SOD GRASSES SHALL BE LOCATED WITHIN 5' OF A PSLUSD APPURTENANCE SUCH AS A WATER METER ASSEMBLY, BACK-FLOW DEVICE, FIRE HYDRANT OR SEWER CLEANSOUT, ETC.

### Symbols Legend

D.E. DRAINAGE EASEMENT  
L.M.E. LAKE MAINTENANCE EASEMENT  
L.M.A.E. LAKE MAINTENANCE ACCESS EASEMENT  
R.O.W. RIGHT OF WAY  
U.E. UTILITY EASEMENT  
U.E.-R.A. UTILITY EASEMENT - RESTRICTED AREA (SEE "U.E." PLAT DEDICATION)

STM STORM SEWER LINE WITH MANHOLE  
STM STORM SEWER LINE WITH CATCH BASIN  
SAN SANITARY SEWER LINE WITH MANHOLE  
WM WATER MAIN

WATER SVC. TO LOT WITH METER W.M.  
SANITARY SVC. TO LOT WITH CLEANSOUT C.O.

O.E. OVERHANG EASEMENT  
G.E. GRADING EASEMENT  
P.S.L. PORT ST. LUCIE  
L.E. LANDSCAPE EASEMENT  
D.S.E. DRAINAGE SWALE EASEMENT  
O.S. OPEN SPACE  
S&M SEED & MULCH

1 LOT NUMBER

FIRE HYDRANT  
STREET LIGHT

### Root Barrier Detail

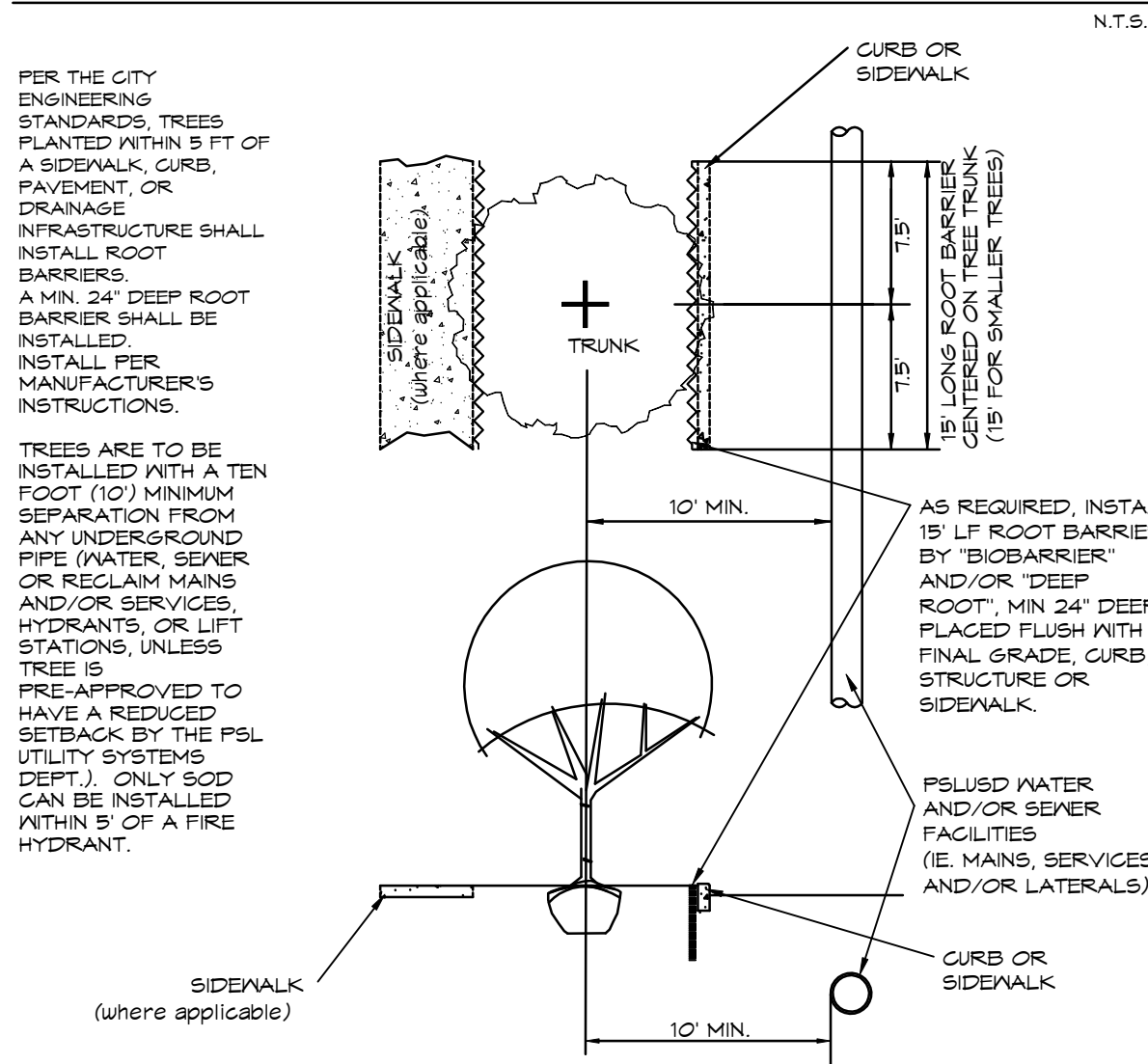

### Planting Details

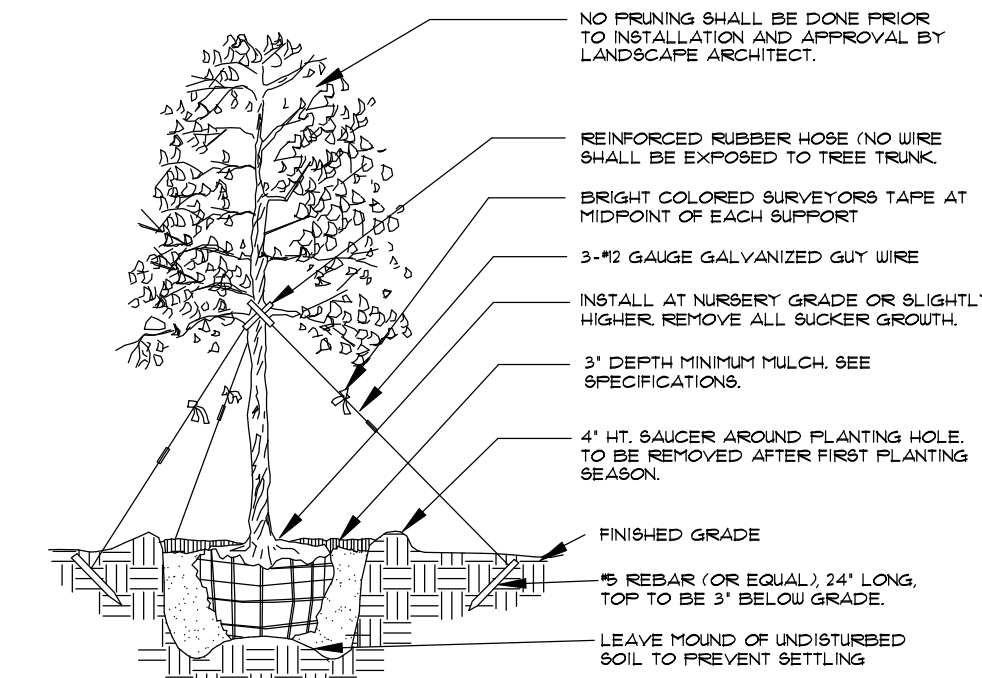

#### Tree Planting

• SEE SPECIFICATIONS FOR BACKFILL MIXTURE AND FERTILIZATION.  
• BRACING - SPECIAL SITE CONDITIONS MAY REQUIRE MODIFICATION TO BRACING TECHNIQUE. LANDSCAPE CONTRACTOR WILL ADEQUATELY BRACE (OR WIRE) ALL TREES TO PREVENT EXCESSIVE MOVEMENT & MAINTAIN A VERTICAL POSITION.

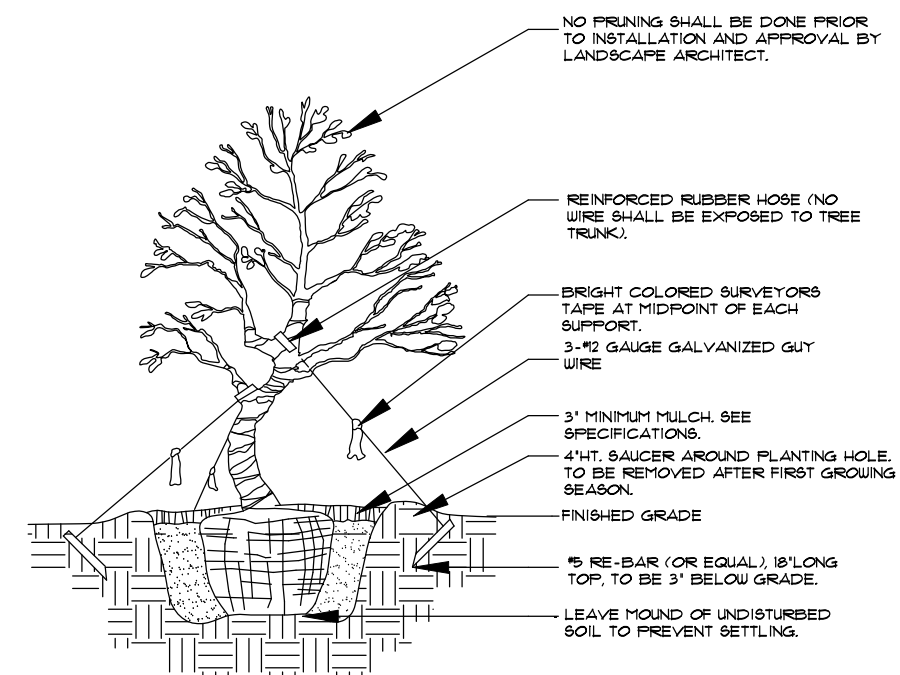

#### Irregular & Multi-Stem Tree Planting

FOR TREES 6"-14"  
NOTES:  
• SEE SPECIFICATIONS FOR BACKFILL MIXTURE AND FERTILIZATION.  
• BRACING - SPECIAL SITE CONDITIONS MAY REQUIRE MODIFICATION TO BRACING TECHNIQUE. LANDSCAPE CONTRACTOR WILL ADEQUATELY BRACE (OR WIRE) ALL TREES TO PREVENT EXCESSIVE MOVEMENT & MAINTAIN A VERTICAL POSITION.

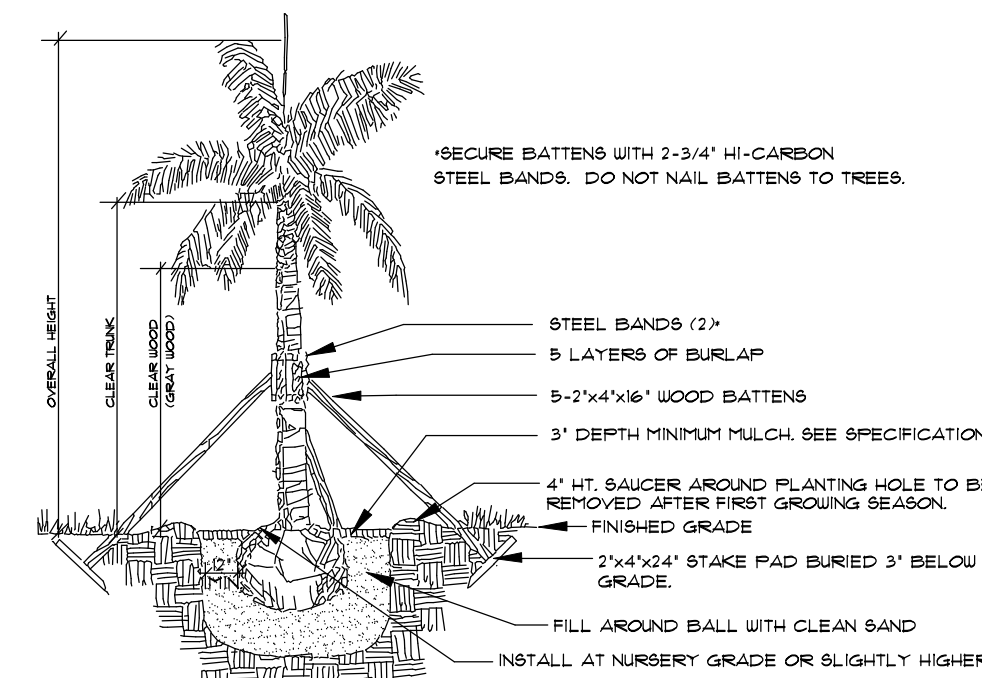

#### Palm Planting

APPLIES TO: ROYAL PALMS, QUEEN PALMS, ALEXANDER PALMS, FOXTAIL PALMS.  
• SEE SPECIFICATIONS FOR BACKFILL MIXTURE AND FERTILIZATION.  
• BRACING - SPECIAL SITE CONDITIONS MAY REQUIRE MODIFICATION TO BRACING TECHNIQUE. LANDSCAPE CONTRACTOR WILL ADEQUATELY BRACE (OR WIRE) ALL PALMS TO PREVENT EXCESSIVE MOVEMENT & MAINTAIN A VERTICAL POSITION.

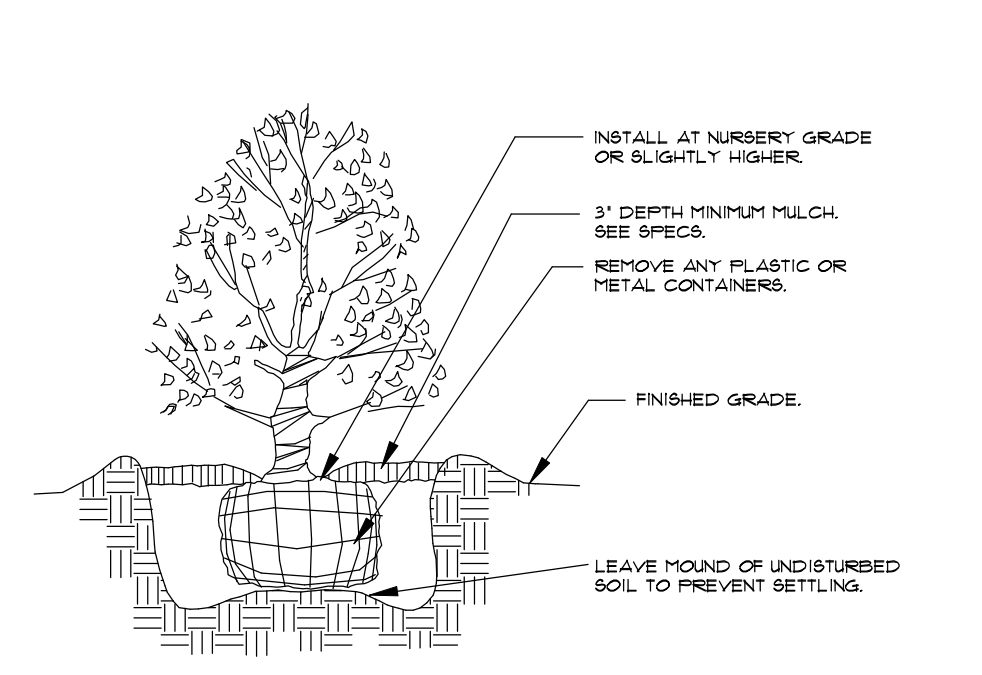

#### Shrub Planting

• SEE SPECIFICATIONS FOR BACKFILL MIXTURE AND FERTILIZATION.

### SCHEDULE OF CONTENTS

Sheet L1.MP2	COVER SHEET, DETAILS, AND SPECIFICATIONS
Sheet L2.MP2	MARSHALL PARKWAY - PHASE 2 PLANTING PLANS
Sheet L3.MP2	MARSHALL PARKWAY - PHASE 2 PLANTING PLANS
Sheet L4.MP2	MARSHALL PARKWAY - PHASE 2 PLANTING PLANS

### MARSHALL PARKWAY AT PARCEL B - PHASE 2 DATA TABLE

	Trees Required	Palms Allowed (25%)	Palms Provided	Shade Trees Provided	Total Trees/Palms Provided	Native Trees Required (50%)	Native Shade Trees Provided
MARSHALL PARKWAY AT PARCEL B - TREES	77.9 (1)	19.4	34	93	112 (2)	38.5	98 (127%)

(1) 3444 LF OF ROADWAY WITH LARGE TREES (CALCULATED AT 60' O.C. PER SEC. 156.121) = 57.4 TREES  
348 LF OF ROADWAY WITH MEDIUM TREES (CALCULATED AT 50' O.C. PER SEC. 156.121) = 6.9 TREES  
545 LF OF ROADWAY WITH SMALL TREES/PALMS (CALCULATED AT 40' O.C. PER SEC. 156.121) = 13.6 TREES  
57.4 TREES + 6.9 TREES + 13.6 TREES = 77.9 TREES REQUIRED  
BALANCE OF ROADWAY IS NOT PLANTABLE SPACE DUE TO INTERSECTIONS, TURN LANES, OR FUTURE MEDIAN OPENINGS.

(2) TOTAL TREES /PALMS PROVIDED: 93 SHADE TREES PROVIDED (AVG SPACING 40' O.C. PER PSL BEAUTIFICATION POLICY) + 19 PALMS ALLOWED (25%) = 112 TOTAL TREES/PALMS PROVIDED.  
15 ADDITIONAL PALMS WERE PROVIDED IN EXCESS OF THE 25% ALLOWED BY CODE AND WERE NOT USED TO MEET THE TOTAL NUMBER OF TREES REQUIRED.

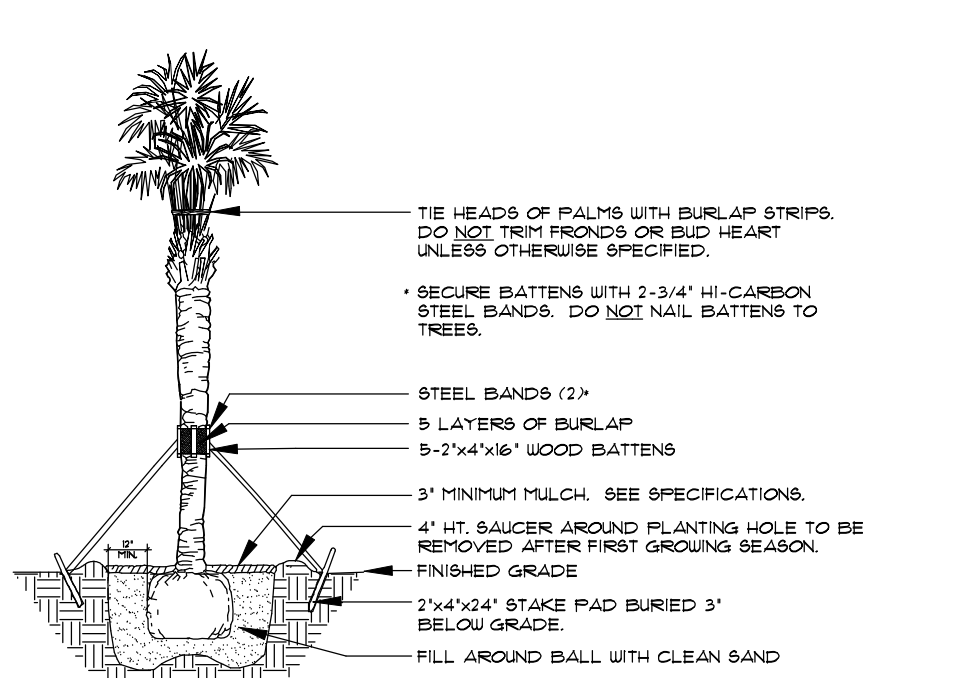

#### Palm Planting

APPLIES TO: SABAL PALMS, WASHINGTON PALMS, CANARY ISLAND DATE PALMS, SENEGAL DATE PALMS.  
• SEE SPECIFICATIONS FOR BACKFILL MIXTURE AND FERTILIZATION.

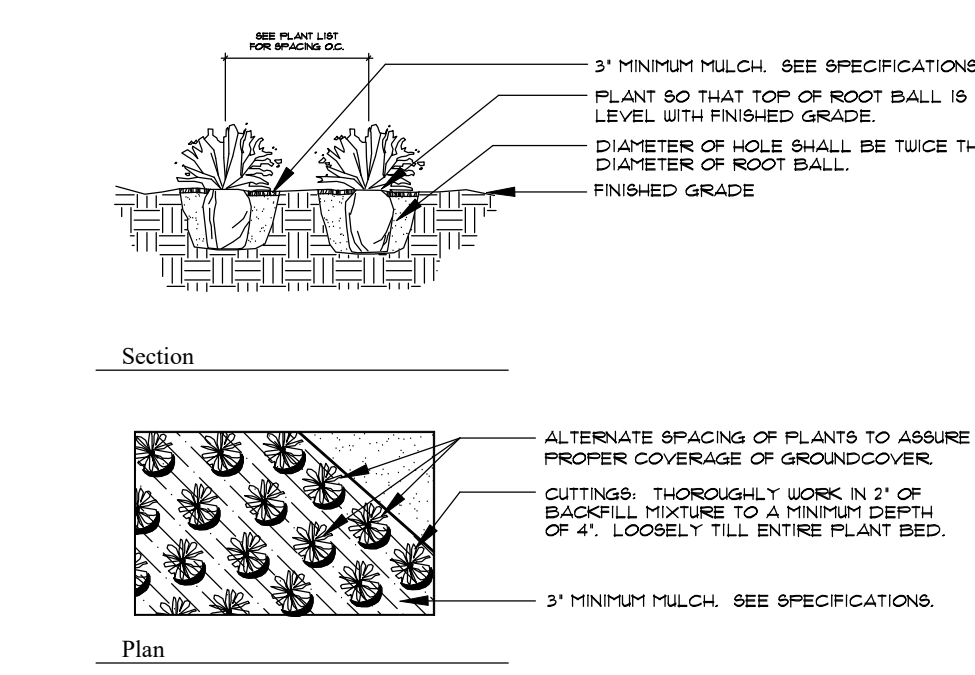

#### Groundcover Planting

• SEE SPECIFICATIONS FOR BACKFILL MIXTURE AND FERTILIZATION.

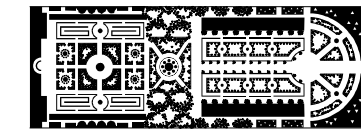

PARKER-YANNETTE  
design group, inc.

LANDSCAPE ARCHITECTURE  
PLANNING • GRAPHICS  
4425 Military Trail, Suite 202  
Suite 330  
Jupiter, Florida 33458

Telephone: (561) 747-5069  
Fax: (561) 747-2041  
Email: mail@pydg.com  
License #LA-0001347

MARSHALL PARKWAY AT RIVERLAND  
PARCEL B - PHASE 2  
PORT ST. LUCIE, FLORIDA  
Developer: Riverland Development Company, LLC  
PHASE 2 COVER SHEET

DATE: 02.07.24  
DRAWN BY: AO/ITY  
JOB NO.: 17-077  
SCALE: N/A  
FILENAME: Rvr Mstr HOA

REVISIONS:  
4.11.24 PSL crmts.  
6.28.24 PSL crmts.  
9.15.24 PSL crmts.  
9.16.24 Utl upds

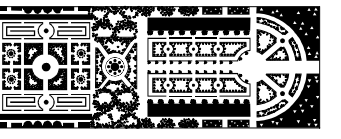

PARKER-YANNETTE  
design group, inc.

LANDSCAPE ARCHITECTURE  
PLANNING • GRAPHICS  
4425 Military Trail, Suite 202  
Suite 330  
Jupiter, Florida 33458

Telephone: (561) 747-5069  
Fax: (561) 747-2041  
Email: mail@pydg.com  
License #LA-0001347

# MARSHALL PARKWAY AT RIVERLAND PARCEL B - PHASE 2

PORT ST. LUCIE, FLORIDA  
Developer: Riverland Development Company, LLC  
PHASE 2 RIGHT-OF-WAY PLANTING PLAN

DATE: 02.07.24  
DRAWN BY: AO/TY  
JOB NO.: 17-071  
SCALE: 1" = 20'-0"  
FILENAME: Rvr Mstr HOA

REVISIONS:  
4.11.24 PSL crmts.  
6.28.24 PSL crmts.  
8.15.24 PSL crmts.  
9.16.24 Utl updates

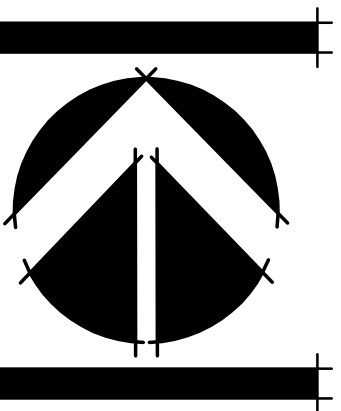

SHEET:

L2.MP2

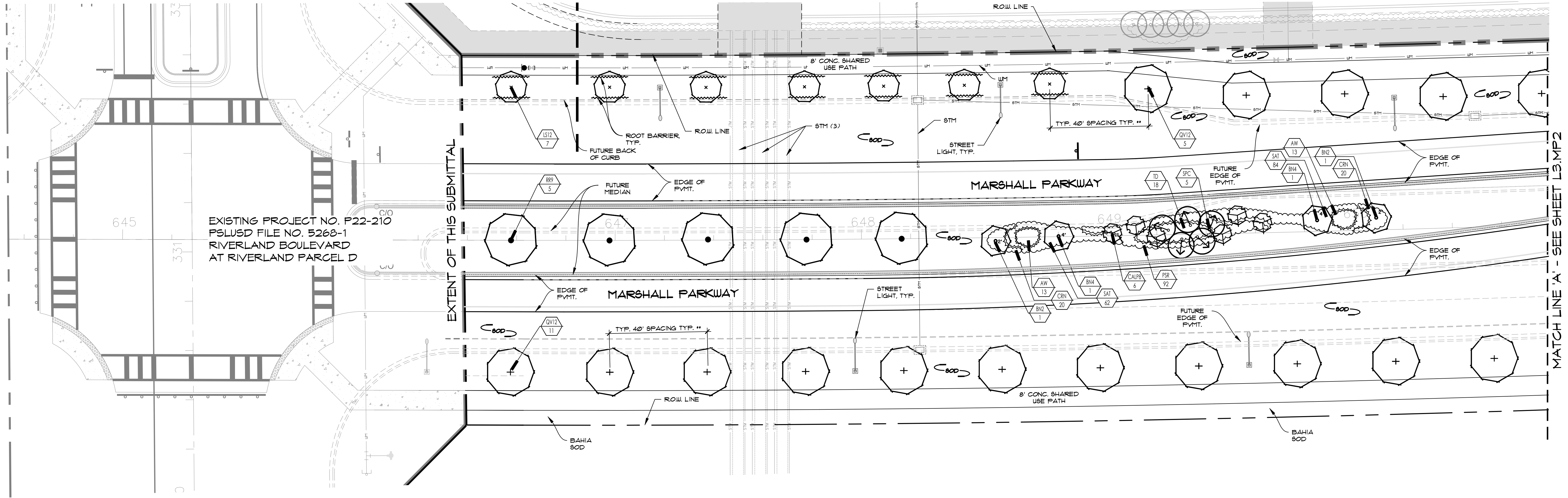

## SHEET KEY

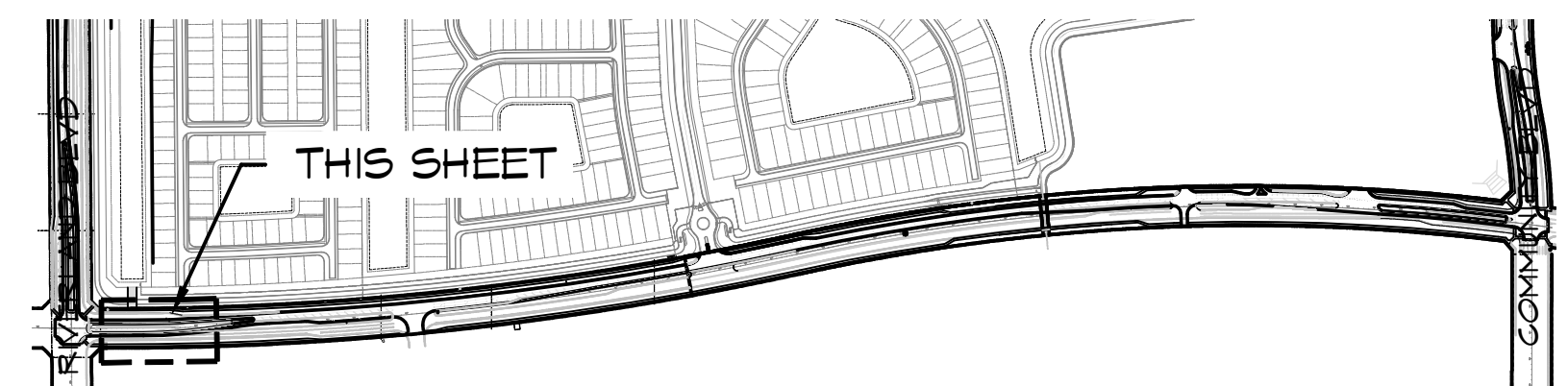

### PLANT LIST - SHEET L2.MP2

TREES			
CALPS	Calliandra haematocephala / Pink Powder Puff	8' ht., 15 gal., full canopy, pink flower	6
LS12	Lagerstroemia speciosa / Queen's Grape Myrtle	12' ht., 5' cal., 45 gal., full canopy	7
QV12	Quercus virginiana / Live Oak	12' x 5', 3' cal., 45 gal., full canopy	16
PALMS			
BN2	Bismarckia nobilis / Bismarck Palm	1'-2' c.t., heavy cal., full frond	2
BN4	Bismarckia nobilis 'Silver' / Silver Bismarck Palm	4' c.t., heavy cal., full frond	2
RR4	Royaltonia regia / Royal Palm	4' g.w., heavy cal., full frond	5
SPC	Sabal palmetto / Cabbage Palm	6' - 22' c.t. hts., staggered hts., hurricane cut, slick trunk, curved as noted on plan	5
SHRUBS, ACCENTS, AND GROUNDCOVER			
AW	Acalypha wilkesiana / Copperleaf	3 gal., 22" x 22", full	20
CRN	Cuscuta rosea 'Nana' / Dwarf Pitch Apple	3 gal., 14 x 18", full, 24" o.c.	40
PSR	Pennisetum setaceum 'rubrum' / Red Fountain Grass	3 gal., 20 x 14", full	142
SAT	Schefflera arboricola 'Trinette' / Variegated Dwarf Schefflera	3 gal., 22 x 20", full	146
TD	Tripsacum dactyloides / Flakatchee Grass	3 gal., 24" x 22", full, 30" o.c.	18
SOD	Stenotaphrum secundatum / St. Augustine 'Floradam'	Solid sod, laid tight, Qty in 9ft	
BAHIA SOD	Paspalum notatum / Bahia Grass	Solid sod, laid tight, Qty in 9ft	
BAHIA S&M	Paspalum notatum / Bahia Grass	Seed Mulch	
MULCH	Chocolate Mulch	3" Thick 'A' Grade Raw Wood Mulch, CHOCOLATE color - BID PER CY	

NOTE:  
-ALL PLANT MATERIAL SHALL MEET OR EXCEED SIZE AND CONTAINER SPECIFICATIONS IN PLANT LIST. PLANT MATERIALS NOT MEETING SPECIFICATION WILL BE REJECTED. CONTRACTOR TO COORDINATE AVAILABILITY ISSUES WITH OWNER PRIOR TO COMMENCING WORK.  
-AT A MINIMUM, ALL PLANT MATERIAL TO MEET SIZE SPECIFICATIONS SET OUT IN THE CITY OF PORT ST. LUCIE CODE OF ORDINANCES, SEC. 154.04 - LANDSCAPE MATERIAL STANDARDS.  
-ALL TREE BRACING TO BE REMOVED BY THE CONTRACTOR AT THE CONCLUSION OF THE WARRANTY.

\*\* TREES SPACED AT 40' O.C. TYPICAL. 50' MAXIMUM IN THE EVENT OF INFRASTRUCTURE CONFLICT.



PSLUSD #5266F-2 PSL PROJECT NO. P24-020

## Symbols Legend

D.E.	DRAINAGE EASEMENT	O.E.	OVERHANG EASEMENT
L.M.E.	LAKE MAINTENANCE EASEMENT	G.E.	GRADING EASEMENT
L.M.A.E.	LAKE MAINTENANCE ACCESS EASEMENT	PSL	PORT ST LUCIE
R.O.W.	RIGHT OF WAY	L.E.	LANDSCAPE EASEMENT
U.E.	UTILITY EASEMENT	D.S.E.	DRAINAGE SWALE EASEMENT
U.E.-R.A.	UTILITY EASEMENT - RESTRICTED AREA (SEE "U.E." PLAT DEDICATION)	O.S.	OPEN SPACE
STM	STORM SEWER LINE WITH MANHOLE	S&M	SEED & MULCH
STM	STORM SEWER LINE WITH CATCH BASIN	SIGN	SIGN
SAN	SANITARY SEWER LINE WITH MANHOLE	1	LOT NUMBER
WM	WATER MAIN	FIRE HYDRANT	FIRE HYDRANT
WATER SVC. TO LOT WITH METER W.M.	WATER SVC. TO LOT WITH METER W.M.	STREET LIGHT	STREET LIGHT
SANITARY SVC. TO LOT WITH CLEANOUT C.O.	SANITARY SVC. TO LOT WITH CLEANOUT C.O.		



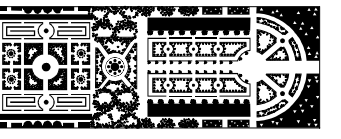

PARKER-YANNETTE  
design group, inc.

LANDSCAPE ARCHITECTURE  
PLANNING • GRAPHICS  
4425 Military Trail, Suite 202  
Suite 330  
Jupiter, Florida 33458

Telephone: (561) 747-5069  
Fax: (561) 747-2041  
Email: mail@pydg.com  
License #LA-0001347

MARSHALL PARKWAY AT RIVERLAND  
PARCEL B - PHASE 2  
PORT ST. LUCIE, FLORIDA  
Developer: Riverland Development Company, LLC  
PHASE 2 RIGHT-OF-WAY PLANTING PLAN

DATE: 02.07.24  
DRAWN BY: AO/TY  
JOB NO.: 17-07T  
SCALE: 1" = 20'-0"  
FILENAME: Rvr Mstr HOA

REVISIONS:  
4.11.24 PSL crmts.  
6.28.24 PSL crmts.  
8.15.24 PSL crmts.  
9.16.24 ULI updates

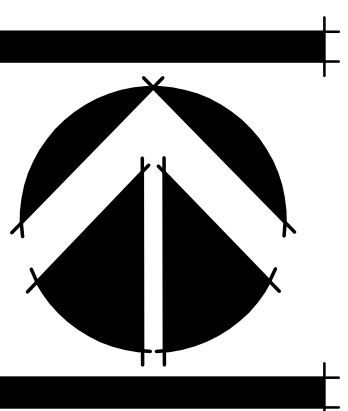

SHEET:

L3.MP2

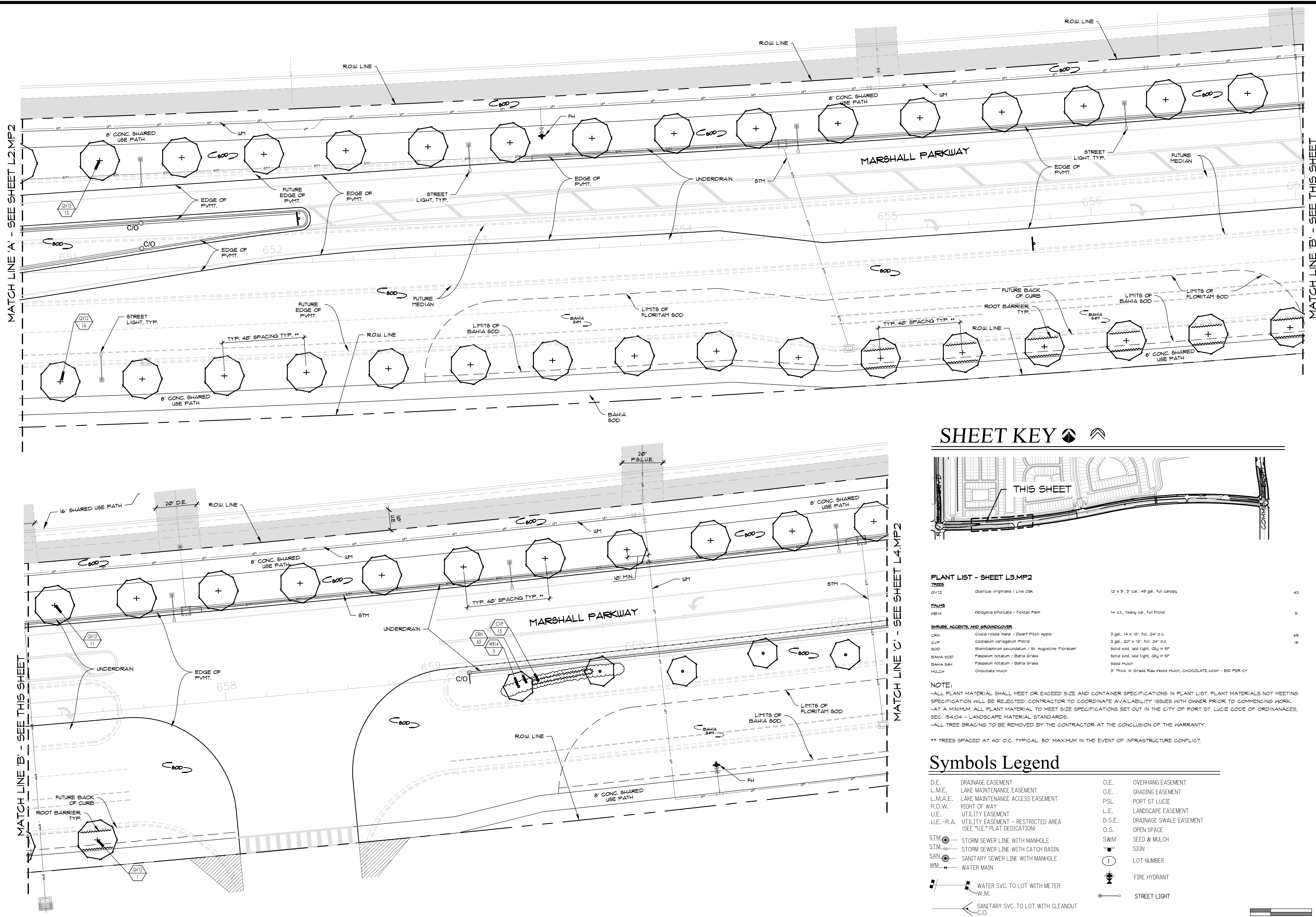

## SHEET KEY



### PLANT LIST - SHEET L3.MP2

PLANT	DESCRIPTION	QUANTITY
QV12	Quercus virginiana / Live Oak	40
CRN	Cordia rosea / Dwarf Peach Apple	5
CVP	Cordia variegata / Petal	5
SOD	Stenotaphrum secundatum / St. Augustine Floristam	15
BAHIA SOD	Paspalum notatum / Bahia Grass	
BAHIA SEM	Paspalum notatum / Bahia Grass	
MULCH	Chocolate Mulch	

### NOTE:

-ALL PLANT MATERIAL SHALL MEET OR EXCEED SIZE AND CONTAINER SPECIFICATIONS IN PLANT LIST. PLANT MATERIALS NOT MEETING SPECIFICATION WILL BE REJECTED. CONTRACTOR TO COORDINATE AVAILABILITY ISSUES WITH OWNER PRIOR TO COMMENCING WORK.  
-AT A MINIMUM, ALL PLANT MATERIAL TO MEET SIZE SPECIFICATIONS SET OUT IN THE CITY OF PORT ST. LUCIE CODE OF ORDINANCES, SEC. 154.04 - LANDSCAPE MATERIAL STANDARDS.  
-ALL TREE BRACING TO BE REMOVED BY THE CONTRACTOR AT THE CONCLUSION OF THE WARRANTY.

\*\* TREES SPACED AT 40' O.C. TYPICAL. 50' MAXIMUM IN THE EVENT OF INFRASTRUCTURE CONFLICT.

## Symbols Legend

D.E.	DRAINAGE EASEMENT	O.E.	OVERHANG EASEMENT
L.M.E.	LAKE MAINTENANCE EASEMENT	G.E.	GRADING EASEMENT
L.M.A.E.	LAKE MAINTENANCE ACCESS EASEMENT	PSL	PORT ST LUCIE
R.O.W.	RIGHT OF WAY	L.E.	LANDSCAPE EASEMENT
U.E.	UTILITY EASEMENT	D.S.E.	DRAINAGE SWALE EASEMENT
U.E.-R.A.	UTILITY EASEMENT - RESTRICTED AREA (SEE "U.E." PLAT DEDICATION)	O.S.	OPEN SPACE
STM	STORM SEWER LINE WITH MANHOLE	S&M	SEED & MULCH
STM	STORM SEWER LINE WITH CATCH BASIN	1	LOT NUMBER
SAN	SANITARY SEWER LINE WITH MANHOLE	1	FIRE HYDRANT
WM	WATER MAIN	1	STREET LIGHT
1	WATER SVC. TO LOT WITH METER W.M.		
1	SANITARY SVC. TO LOT WITH CLEANOUT C.O.		

PSLUSD #5266F-2 PSL PROJECT NO. P24-020

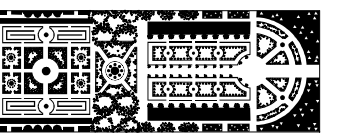

PARKER-YANNETTE  
design group, inc.

LANDSCAPE ARCHITECTURE  
PLANNING • GRAPHICS  
4425 Military Trail, Suite 202  
Suite 330  
Jupiter, Florida 33458

Telephone: (561) 747-5069  
Fax: (561) 747-2041  
Email: mail@pydg.com  
License #LA-0001347

MARSHALL PARKWAY AT RIVERLAND  
PARCEL B - PHASE 2  
PORT ST. LUCIE, FLORIDA  
Developer: Riverland Development Company, LLC  
PHASE 2 RIGHT-OF-WAY PLANTING PLAN

DATE: 02.01.24  
DRAWN BY: AO/TY  
JOB NO.: 17-071  
SCALE: 1" = 20'-0"  
FILENAME: Rvr Mstr HOA

REVISIONS:  
4.11.24 PSL crmts.  
6.28.24 PSL crmts.  
8.15.24 PSL crmts.  
9.16.24 ULI updates

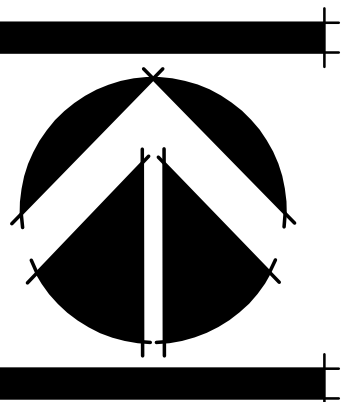

SHEET:

L4.MP2

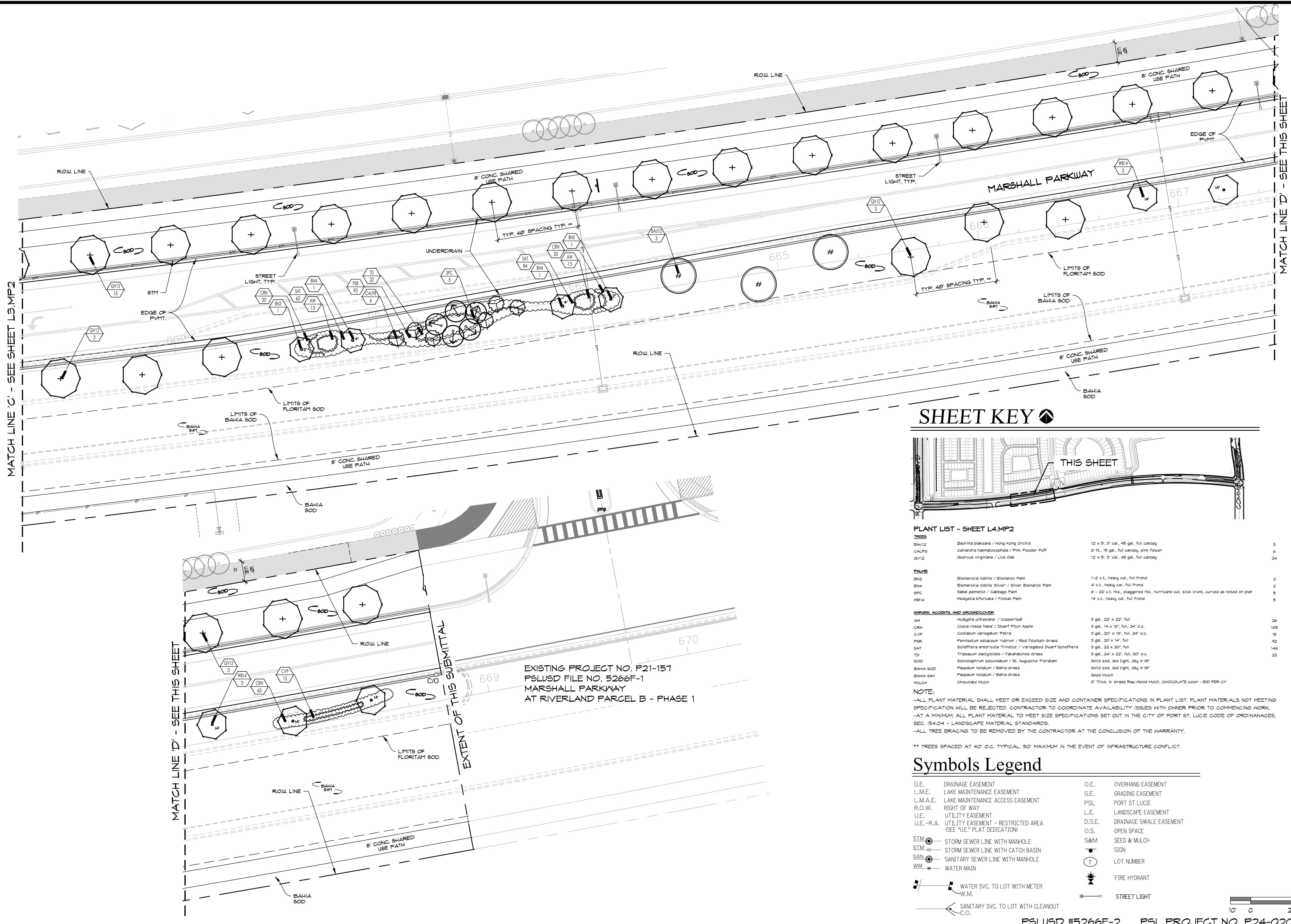

## SHEET KEY

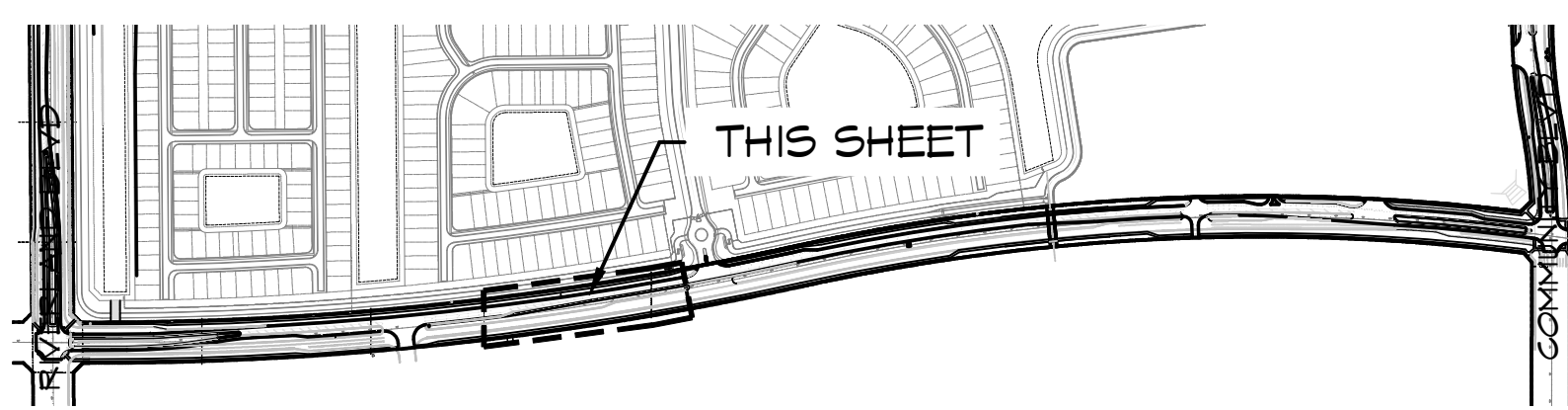

### PLANT LIST - SHEET L4.MP2

TREES			
BAU12	Bauhinia blakeana / Hong Kong Orchid	12' x 5', 3" cal., 45 gal., full canopy	3
CALP0	Calliandra haematocephala / Pink Powder Puff	0' ft., 15 gal., full canopy, pink flower	6
QV12	Quercus virginiana / Live Oak	12' x 5', 3" cal., 45 gal., full canopy	24
PALMS			
BN2	Bismarckia nobilis / Bismarck Palm	1'-2' c.t., heavy cal., full frond	2
BN4	Bismarckia nobilis 'Silver' / Silver Bismarck Palm	4' c.t., heavy cal., full frond	2
SPC	Sabal palmetto / Cabbage Palm	6' - 22' c.t. hts., staggered hts., hurricane cut, slick trunk, curved as noted on plan	5
NB14	Noddyella bifurcata / Foxtail Palm	14' c.t., heavy cal., full frond	5
SHRUBS, ACCENTS AND GROUNDCOVER			
AW	Acalypha wilkesiana / Copperleaf	3 gal., 22" x 22", full	26
CRN	Cleome rosea Nana / Dwarf Pitch Apple	3 gal., 14" x 15", full, 24" o.c.	109
GVP	Cordia alliodora / Alligator Tree	3 gal., 20" x 18", full, 24" o.c.	15
PSR	Pennisetum setaceum 'Rubrum' / Red Fountain Grass	3 gal., 20" x 14", full	42
SAT	Schefflera arboricola 'Trinette' / Variegated Dwarf Schefflera	3 gal., 22" x 20", full	146
TD	Tripsacum dactyloides / Fakahatchee Grass	3 gal., 24" x 22", full, 30" o.c.	22
SOD	Stenotaphrum secundatum / St. Augustine Floratam	Solid sod, laid tight, clay in 5F	
BAHIA SOD	Paspalum notatum / Bahia Grass	Solid sod, laid tight, clay in 5F	
BAHIA S&M	Paspalum notatum / Bahia Grass	Seed Mulch	
MULCH	Chocolate Mulch	3" Thick 'A' Grade Raw Wood Mulch, CHOCOLATE COLOR - BID PER CY	

### NOTE:

-ALL PLANT MATERIAL SHALL MEET OR EXCEED SIZE AND CONTAINER SPECIFICATIONS IN PLANT LIST. PLANT MATERIALS NOT MEETING SPECIFICATION WILL BE REJECTED. CONTRACTOR TO COORDINATE AVAILABILITY ISSUES WITH OWNER PRIOR TO COMMENCING WORK.  
-AT A MINIMUM, ALL PLANT MATERIAL TO MEET SIZE SPECIFICATIONS SET OUT IN THE CITY OF PORT ST. LUCIE CODE OF ORDINANCES, SEC. 154.04 - LANDSCAPE MATERIAL STANDARDS.  
-ALL TREE BRACING TO BE REMOVED BY THE CONTRACTOR AT THE CONCLUSION OF THE WARRANTY.

\*\* TREES SPACED AT 40' O.C. TYPICAL. 50' MAXIMUM IN THE EVENT OF INFRASTRUCTURE CONFLICT.

## Symbols Legend

D.E.	DRAINAGE EASEMENT	O.E.	OVERHANG EASEMENT
L.M.E.	LAKE MAINTENANCE EASEMENT	G.E.	GRADING EASEMENT
L.M.A.E.	LAKE MAINTENANCE ACCESS EASEMENT	PSL	PORT ST LUCIE
R.O.W.	RIGHT OF WAY	L.E.	LANDSCAPE EASEMENT
U.E.	UTILITY EASEMENT	D.S.E.	DRAINAGE SWALE EASEMENT
U.E.-R.A.	UTILITY EASEMENT - RESTRICTED AREA (SEE "U.E." PLAT DEDICATION)	O.S.	OPEN SPACE
SSM	STORM SEWER LINE WITH MANHOLE	S&M	SEED & MULCH
SSM	STORM SEWER LINE WITH CATCH BASIN	1	SIGN
SAN	SANITARY SEWER LINE WITH MANHOLE	1	LOT NUMBER
WM	WATER MAIN	1	FIRE HYDRANT
1	WATER SVC. TO LOT WITH METER W.M.	1	STREET LIGHT
1	SANITARY SVC. TO LOT WITH CLEANOUT C.O.		

PSLUSD #5266F-2 PSL PROJECT NO. P24-020