

FUTURE LAND USE

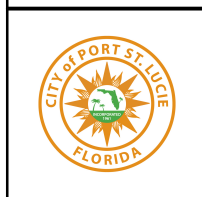
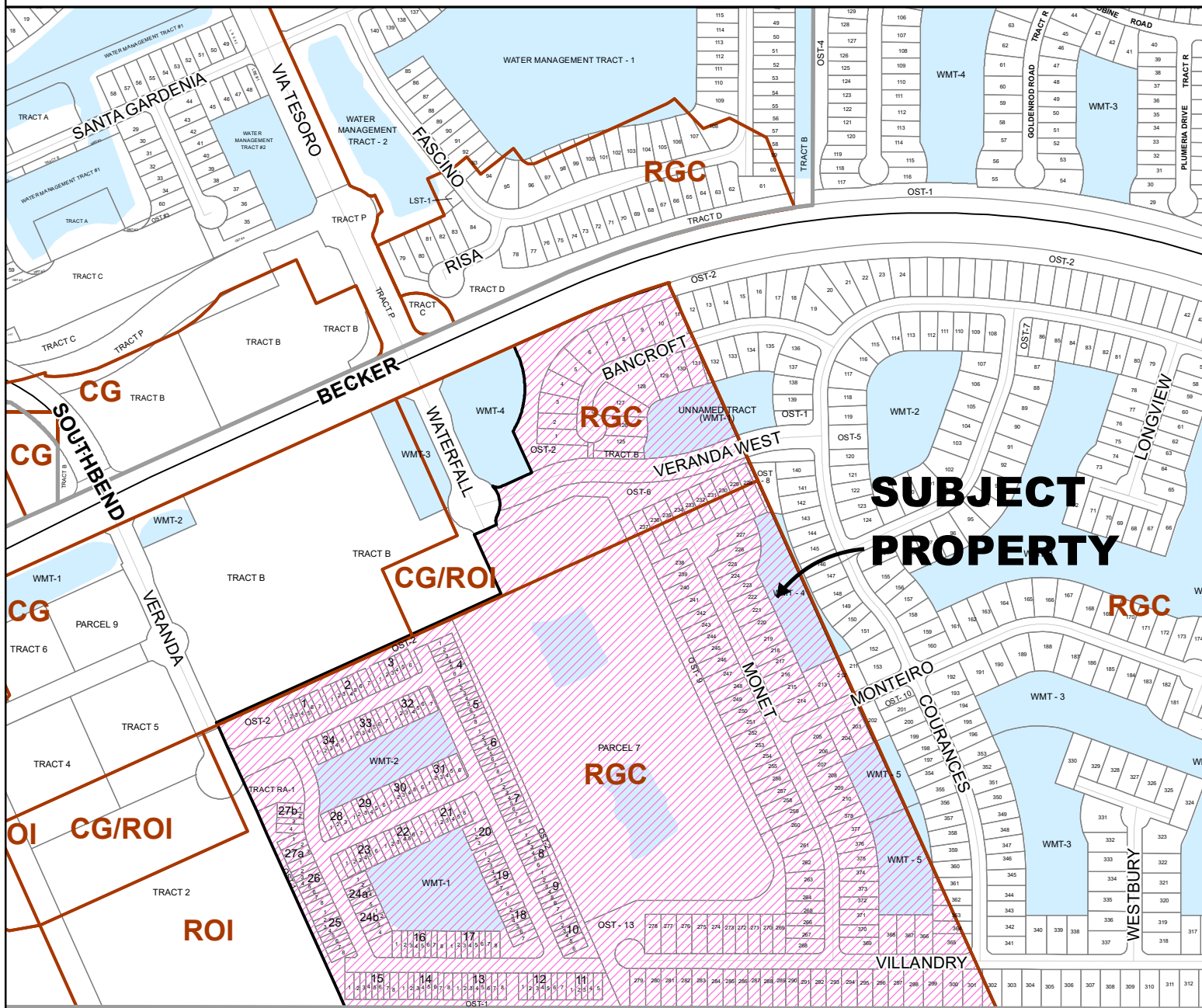

CITY OF PORT ST. LUCIE
 PLANNING & ZONING DEPT.

COMPREHENSIVE PLAN AMENDMENT
 ST. LUCIE LANDS/VERANDA
 VERANDA PLAT NO. 8, TRACT 3

DATE:	3/29/2023
APPLICATION NUMBER:	P22-356
USER:	rtaylor
SCALE:	1 in = 500 ft