

Legend
Parcels

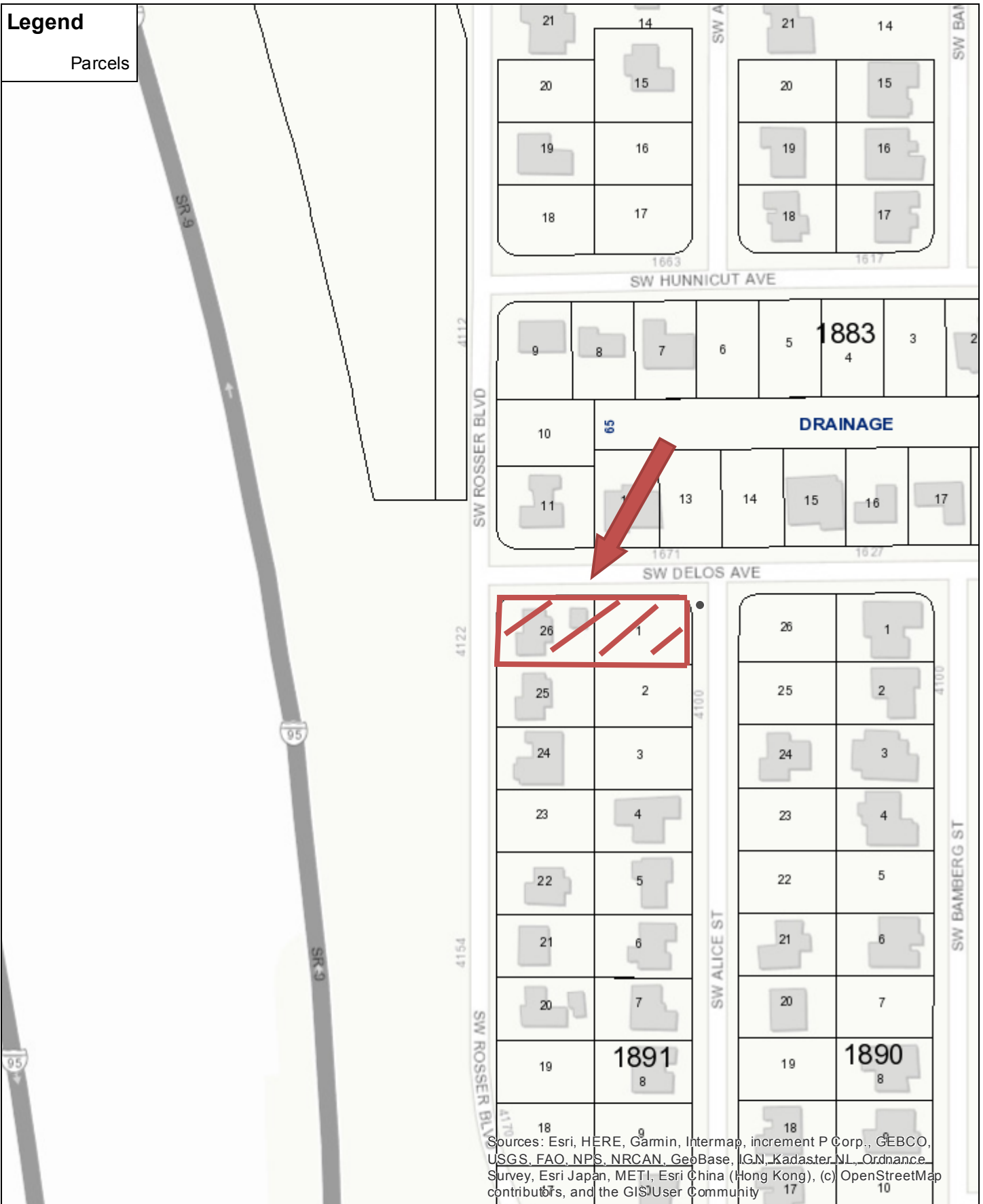

Sources: Esri, HERE, Garmin, Intermap, increment P Corp., GEBCO, USGS, FAO, NPS, NRCAN, GeoBase, IGN, Kadaster NL, Ordnance Survey, Esri Japan, METI, Esri China (Hong Kong), (c) OpenStreetMap contributors, and the GIS User Community



Termination of Restrictive Covenant

Lots 1 and 26, Block 1891, Port St Lucie Section Nineteen

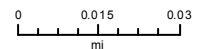

1 inch = 188 feet