

Existing Tree Chart

CODE #	TREE SPECIES	SIZE	PROTECTED	ASSESSMENT	STATUS
1	Pine	18" DBH	Yes	Good	Remove
2	Pine	18" DBH	Yes	Good	Remove
3	Pine	11" DBH	No	Fair	Remove
4	Oak	5" DBH	No	Good	Preserve / Offsite
5	Oak	5" DBH	No	Good	Preserve / Offsite
6	Oak	4" DBH	No	Good	Preserve / Offsite
7	Oak	4" DBH	No	Good	Preserve
8	Pine	21" DBH	Yes	Fair	Remove
9	Pine	28" DBH	Yes	Fair	Remove
10	Bay	5" DBH	No	Good	Remove
11	Pine	5" DBH	No	Good	Remove
12	Pine	5" DBH	No	Good	Remove
13	Pine	8" DBH	No	Fair	Remove
14	Oak	4" DBH	No	Good	Remove
15	Oak	5" DBH	No	Good	Remove
16	Pine	7" DBH	No	Good	Remove
17	Pine	13" DBH	Yes	Fair	Remove
18	Pine	10" DBH	No	Good	Remove
19	Oak	4" DBH	No	Good	Remove
20	Pine	5" DBH	No	Fair	Remove
21	Pine	22" DBH	Yes	Fair	Remove
22	Oak	6" DBH	No	Good	Remove
23	Oak	4" DBH	No	Good	Remove
24	Pine	4" DBH	No	Good	Remove
25	Pine	20" DBH	Yes	Good	Remove
26	Pine	28" DBH	Yes	Good	Remove
27	Oak	4" DBH	No	Good	Preserve / Offsite
28	Oak	4" DBH	No	Good	Preserve
29	Oak	4" DBH	No	Good	Preserve / Offsite
30	Oak	8" DBH	No	Good	Preserve
31	Pine	10" DBH	Yes	Good	Preserve / Offsite
32	Pine	5" DBH	No	Good	Preserve
33	Pine	10" DBH	No	Fair	Remove
34	Pine	12" DBH	Yes	Fair	Remove
35	Pine	20" DBH	Yes	Good	Remove
36	Pine	6" DBH	No	Good	Remove
37	Pine	6" DBH	No	Good	Remove
38	Pine	5" DBH	No	Fair	Remove
39	Pine	5" DBH	No	Fair	Remove
40	Pine	5" DBH	No	Good	Remove
41	Pine	5" DBH	No	Good	Remove
42	Pine	4" DBH	No	Good	Preserve
43	Oak	4" DBH	No	Good	Preserve
44	Pine	6" DBH	No	Good	Remove
45	Pine	6" DBH	No	Good	Remove
46	Pine	6" DBH	No	Good	Remove
47	Pine	6" DBH	No	Good	Remove
48	Pine	6" DBH	No	Good	Remove
49	Pine	9" DBH	No	Fair	Remove
50	Pine	9" DBH	No	Fair	Remove
51	Oak	4" DBH	No	Good	Remove
52	Oak	4" DBH	No	Good	Remove
53	Oak	4" DBH	No	Good	Remove
54	Oak	9" DBH	No	Good	Remove
55	Oak	7" DBH	No	Good	Remove
56	Pine	8" DBH	No	Fair	Remove
57	Pine	6" DBH	No	Good	Preserve
58	Pine	6" DBH	No	Good	Preserve
59	Pine	8" DBH	No	Good	Preserve / Offsite
60	Pine	4" DBH	No	Good	Preserve
61	Oak	4" DBH	No	Fair	Remove
62	Oak	4" DBH	No	Fair	Remove
63	Pine	20" DBH	Yes	Good	Remove
64	Pine	22" DBH	Yes	Good	Remove
65	Pine	24" DBH	Yes	Good	Remove
66	Pine	22" DBH	Yes	Good	Remove
67	Pine	22" DBH	Yes	Good	Remove
68	Pine	4" DBH	No	Good	Remove
69	Pine	5" DBH	No	Good	Preserve
70	Pine	8" DBH	No	Good	Preserve
71	Pine	4" DBH	No	Fair	Remove
72	Pine	6" DBH	No	Fair	Remove
73	Oak	6" DBH	No	Fair	Remove
74	Oak	4" DBH	No	Good	Remove
75	Pine	28" DBH	Yes	Fair	Remove
76	Pine	22" DBH	Yes	Good	Remove
77	Pine	28" DBH	Yes	Good	Remove
78	Oak	4" DBH	No	Good	Remove
79	Pine	5" DBH	No	Good	Remove
80	Pine	5" DBH	No	Good	Remove
81	Pine	5" DBH	No	Good	Remove
82	Pine	4" DBH	No	Fair	Remove
83	Pine	5" DBH	No	Good	Remove
84	Pine	4" DBH	No	Fair	Remove
85	Pine	7" DBH	No	Fair	Remove
86	Pine	20" DBH	Yes	Good	Remove
87	Pine	4" DBH	No	Good	Remove
88	Pine	6" DBH	No	Good	Remove
89	Pine	5" DBH	No	Good	Remove
90	Pine	5" DBH	No	Good	Remove
91	Pine	6" DBH	No	Good	Remove
92	Oak	4" DBH	No	Good	Remove
93	Pine	4" DBH	No	Good	Remove
94	Oak	4" DBH	No	Good	Preserve / Offsite
95	Pine	6" DBH	No	Good	Preserve / Offsite
96	Oak	4" DBH	No	Good	Preserve
97	Oak	4" DBH	No	Good	Preserve
98	Oak	4" DBH	No	Good	Remove
99	Oak	4" DBH	No	Fair	Remove
100	Pine	4" DBH	No	Fair	Remove
101	Pine	4" DBH	No	Fair	Remove
102	Pine	5" DBH	No	Good	Remove
103	Pine	4" DBH	No	Fair	Remove
104	Pine	5" DBH	No	Good	Remove
105	Pine	5" DBH	No	Good	Remove
106	Pine	5" DBH	No	Fair	Remove
107	Pine	4" DBH	No	Fair	Remove
108	Pine	5" DBH	No	Good	Preserve
109	Oak	4" DBH	No	Good	Remove
110	Oak	6" DBH	No	Good	Remove
111	Pine	4" DBH	No	Good	Remove
112	Pine	4" DBH	No	Good	Remove
113	Pine	8" DBH	No	Good	Remove
114	Pine	8" DBH	No	Fair	Remove
115	Pine	8" DBH	No	Good	Remove
116	Pine	6" DBH	No	Fair	Remove
117	Oak	5" DBH	No	Fair	Remove
118	Pine	5" DBH	No	Good	Remove
119	Pine	4" DBH	No	Good	Preserve
120	Oak	6" DBH	No	Good	Preserve
121	Oak	5" DBH	No	Good	Preserve
122	Oak	4" DBH	No	Good	Remove
123	Pine	6" DBH	No	Fair	Remove
124	Oak	4" DBH	No	Fair	Remove
125	Pine	4" DBH	No	Good	Remove
126	Pine	5" DBH	No	Good	Remove
127	Bay	5" DBH	No	Good	Remove
128	Bay	5" DBH	No	Good	Remove
129	Bay	4" DBH	No	Fair	Remove
130	Bay	5" DBH	No	Good	Remove
131	Bay	5" DBH	No	Good	Remove
132	Bay	12" DBH	Yes	Good	Remove
133	Bay	5" DBH	No	Fair	Remove
134	Bay	4" DBH	No	Fair	Remove
135	Bay	5" DBH	No	Good	Remove
136	Bay	5" DBH	No	Good	Remove
137	Bay	8" DBH	No	Good	Remove
138	Bay	5" DBH	No	Good	Remove
139	Bay	4" DBH	No	Fair	Remove
140	Bay	6" DBH	No	Good	Remove
141	Bay	5" DBH	No	Fair	Remove
142	Bay	8" DBH	No	Fair	Remove
143	Bay	5" DBH	No	Fair	Remove
144	Bay	10" DBH	No	Good	Remove
145	Bay	5" DBH	No	Good	Remove
146	Bay	5" DBH	No	Good	Remove
147	Bay	9" DBH	No	Fair	Remove
148	Pine	7" DBH	No	Good	Remove
149	Pine	5" DBH	No	Good	Remove
150	Bay	7" DBH	No	Good	Remove
151	Bay	5" DBH	No	Good	Remove
152	Bay	9" DBH	No	Good	Remove
153	Bay	8" DBH	No	Good	Remove
154	Bay	9" DBH	No	Good	Remove
155	Bay	6" DBH	No	Good	Remove
156	Oak	6" DBH	No	Good	Remove
157	Pine	5" DBH	No	Fair	Remove
158	Bay	4" DBH	No	Good	Remove
159	Bay	5" DBH	No	Good	Remove
160	Bay	6" DBH	No	Good	Remove
161	Bay	4" DBH	No	Fair	Remove
162	Bay	4" DBH	No	Good	Remove
163	Pine	8" DBH	No	Good	Remove



Environmental Assessment Statement

The parcel lot I-37 (639 NW Enterprise Drive) site consists of a xeric slash pine flatwoods community with exotic dominated perimeter vegetation with a small area that contains wetland characteristics. Wildlife utilization on the site is very low and consists of urban songbirds, arthropods, reptiles and a small number of reptiles and amphibians in the western ditch/swale. careful evaluation of the site for listed species, including the gopher tortoise, red-cockaded woodpecker and florida scrub jay resulted in no listed species sightings onsite or in directly adjacent lands.

There is no critical habitat or critical type habitat within the subject site, and there is no suitable habitat for wading birds including the wood stork. Upland mitigation impacts are currently calculated at 1.42 ac x 25% = 0.355 ac; 0.335 ac x 1.5 = 0.5325 ac.

All projected costs are estimated based on current site conditions and may change as a result of ecological changes on the site, regulatory changes, jurisdictional determinations or weather events.

Tree Protection / Barricade Detail

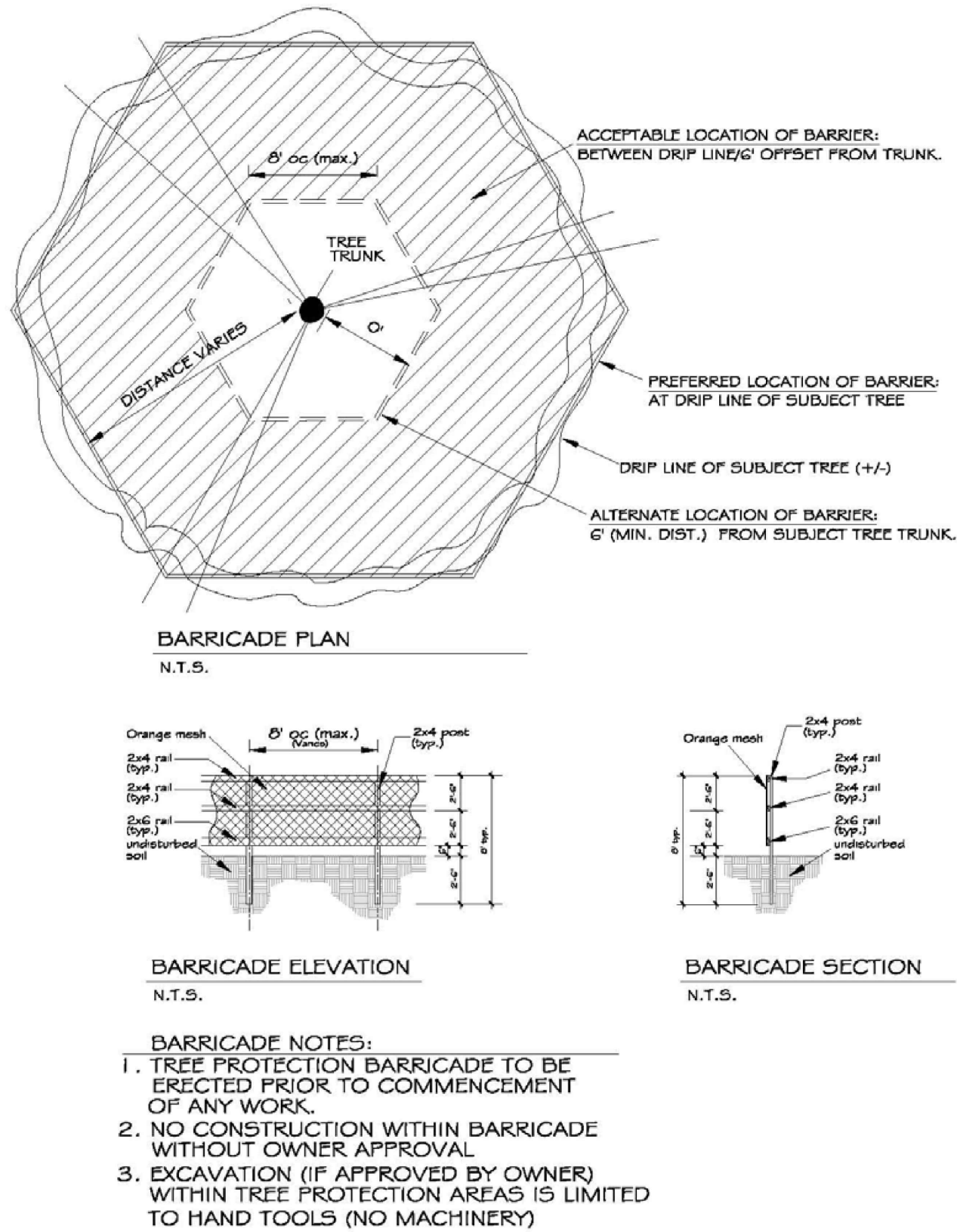

Scale: 1" = 20'



50 E. Ocean Blvd., Suite 101  
Stuart, Florida 34994

T 772.678.7200  
F 772.678.7201

www.hjadesignstudio.com  
LA 0000905

639 NW Enterprise - Landscape Plan  
City of Port St. Lucie  
Existing Tree Removal Plan  
Florida

Copyright  
The following drawings are instruments of service to the Landscape Architect. They are not products of design. All ideas, designs, arrangements, and plans indicated or represented by this drawing are owned by and the property of the designer, and were created, evolved, and developed for use on and in connection with the specified project. None of such ideas, designs, arrangements, or plans shall be used by or disclosed to any person, firm, or corporation for any purpose whatsoever without the written permission of the designer.

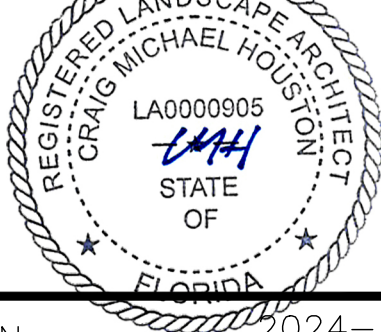

Job No. 2024-22

Drawn By EB

Checked By MH

Approved By MH

Submittal Dates 07-10-24

Revision Dates 01-07-2025

LP- 1

PSL # P24-092



Landscape Data

Site Perimeter Landscape Buffers:  
A landscape strip at least 10' in depth, exclusive of curbing, shall be located along all sides of the right-of-way or abutting property. 1 tree per 30 LF along with a continuous hedge shall be required along along all sides of the property. 1 shrub per 2 LF and shall be planted at least 24" in height.

Perimeter Buffer Along West Property - NW Enterprise Dr.  
Trees Required: (172 LF / 30) = 6 Trees  
Trees Provided: = 11 Trees  
(8 Trees + 6 Trees @ 2:1)

Perimeter Buffer Along North Property  
Trees Required: (338 LF / 30) = 11 Trees  
Trees Provided: = 13 Trees  
(7 Ex. Trees + 6 Trees)

Perimeter Buffer Along East Property  
Trees Required: (172 LF / 30) = 6 Trees  
Trees Provided: = 11 Trees  
(3 Ex. Trees + 8 Trees)

Perimeter Buffer Along South Property  
Trees Required: (298 LF / 30) = 10 Trees  
Trees Provided: = 12 Trees  
(4 Ex. Trees + 8 Trees + 2 Trees @ 2:1)

Parking lot Island Landscaping:  
Each landscape island shall have at least (1) one tree with the remainder of the island landscaped with ground cover, mulch, shrubs or other treatment excluding paving.

1 Tree per Terminal / Landscape Island:  
Trees Required: = 2 Tree  
Trees Provided: = 2 Trees  
\* Interior islands and required trees (1) are to be provided elsewhere on site (1 Tree + 2 Trees @ 2:1)

Total Trees Required: = 35 Trees  
Total Trees Provided: = 57 Trees  
(22 Ex. Trees + 31 Trees + 8 Trees @ 2:1)

Tree Requirements (See Tree Schedule on Sheet LP-3)

Required Tree Species Mix:  
Species Mix Required: = 4  
Species Mix Provided: = 5

Max. Palm Trees - No more than 50% of Required Trees:  
Max. Palms Allowed: (35 Req. Trees x 50%) = 18 Trees  
Palm Provided: = 0 Trees

Native Tree Requirement- 50% Min.of all Req. Trees:  
Native Trees Required: (35 Req. Trees x 50%) = 19 Trees  
Native Trees Provided: = 45 Trees  
(22 Ex. Trees + 23 Trees)

Evergreen Shade Trees Requirement- 75% Min. within landscape Islands:  
Shade Trees Required: (2 Req. Trees x 75%) = 2 Trees  
Shade Trees Provided: = 2 Trees

Flowering Trees Requirement- 20% Min. of all Required Trees:  
Trees Required: (35 Req. Trees x 20%) = 7 Trees  
Trees Provided: = 12 Trees

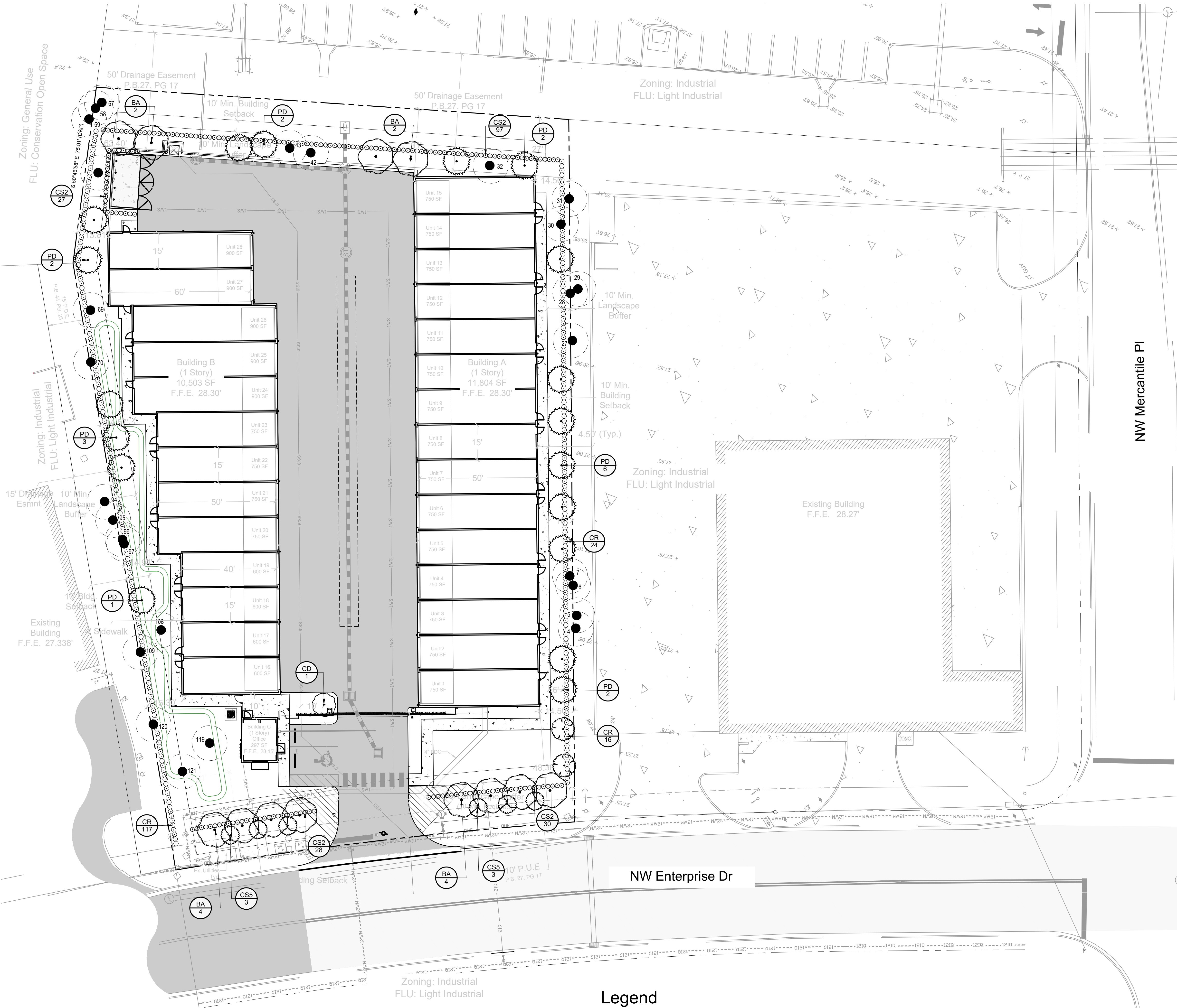

Legend

● # Existing Trees to be Preserved

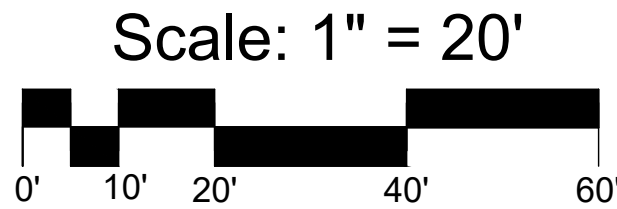

50 E. Ocean Blvd., Suite 101  
Stuart, Florida 34994

T 772.678.7200  
F 772.678.7201

www.hjadesignstudio.com  
LA 0000905

639 NW Enterprise - Landscape Plan  
City of Port St. Lucie  
Landscape Plan  
Florida

Copyright  
The following drawings are instruments of service to the Landscape Architect. They are not products of design. All ideas, designs, arrangements, and plans indicated or represented by this drawing are owned by and the property of the designer, and were created, evolved, and developed for use on and in connection with the specified project. None of such ideas, designs, arrangements, or plans shall be used by or disclosed to any person, firm, or corporation for any purpose whatsoever without the written permission of the designer.



Job No. 2024-22  
Drawn By EB  
Checked By MH  
Approved By MH  
Submittal Dates 07-10-24

Revision Dates 01-07-2025

LP- 2

PSL # P24-092



Landscape Notes

1. THE LANDSCAPE CONTRACTOR SHALL BE RESPONSIBLE FOR ADHERING TO ALL THE REQUIREMENTS STATED UNDER DIVISION 1 - GENERAL REQUIREMENTS AND CONDITIONS AS WELL AS THE SPECIFIC CRITERIA OUTLINED HEREIN AND ON THE LANDSCAPE DRAWINGS INCLUDING ADDENDA AS MAY BE ISSUED BY THE OWNER.

2. THE SCOPE OF WORK FOR THE LANDSCAPE CONTRACTOR FOR THIS PROJECT SHALL INCLUDE THE PROVISION OF ALL LABOR, MATERIALS AND EQUIPMENT REQUIRED TO COMPLETE ALL TASKS ASSOCIATED WITH THE LANDSCAPE AND IRRIGATION INSTALLATION AS SHOWN ON THE DRAWINGS OR NOTED HEREIN. THE LANDSCAPE CONTRACTOR IS RESPONSIBLE FOR COORDINATING WITH THE GENERAL CONTRACTOR REASONABLE ACCESS TO POWER AND POTABLE WATER SOURCES AS REQUIRED.

3. THE LANDSCAPE CONTRACTOR SHALL BE RESPONSIBLE FOR INSURING ALL WORK INCLUDING DELIVERY, STORAGE AND DISPOSAL OF THEIR MATERIALS IS PERFORMED IN COMPLIANCE WITH APPLICABLE JURISDICTIONAL CODES. THE CONTRACTOR IS RESPONSIBLE FOR OBTAINING ALL PERMITS ASSOCIATED WITH THE WORK.

4. THE LANDSCAPE CONTRACTOR SHALL ASSIGN A QUALIFIED PROJECT MANAGER AND FIELD SUPERVISOR TO WORK DIRECTLY WITH THE LANDSCAPE ARCHITECT AND SUPERVISE THE WORK AT ALL TIMES THROUGH FINAL OWNER ACCEPTANCE. IT IS THE CONTRACTOR'S RESPONSIBILITY TO ENSURE THAT PROJECT MANAGER HAS A COMPLETE, CURRENT SET OF DOCUMENTS ON-SITE AT ALL TIMES.

5. THE LANDSCAPE CONTRACTOR SHALL BE RESPONSIBLE FOR FAMILIARIZING THEMSELVES WITH EXISTING SITE CONDITIONS AND NOTIFYING THE OWNER IN WRITING OF ANY CONCERNS PRIOR TO COMMENCEMENT OF WORK. THIS EVALUATION SHOULD INCLUDE, BUT IS NOT LIMITED TO, VERIFICATION OF SURFACE AND SUBSURFACE UTILITIES, GRADES, DIMENSIONS AND SOIL CONDITIONS.

6. THE LANDSCAPE CONTRACTOR SHALL BE RESPONSIBLE FOR FAMILIARIZING THEMSELVES WITH PROJECT PLANS AND SCOPES OF WORK RELATED TO ASSOCIATED TRADES TO BE PERFORMED BY OTHERS IN ORDER TO IDENTIFY KEY COORDINATION ITEMS INCLUDING, BUT NOT LIMITED TO, SITE ACCESS, MATERIAL STORAGE, SCHEDULING AND SEQUENCING OF WORK. THE LANDSCAPE CONTRACTOR IS RESPONSIBLE FOR COORDINATING ALL SITE ISSUES WITH THE GENERAL CONTRACTOR.

7. THE LANDSCAPE CONTRACTOR SHALL BE RESPONSIBLE FOR THE PROTECTION OF ALL ADJACENT WORK, MATERIALS AND EQUIPMENT FROM DAMAGE DUE TO THEIR ACTIVITIES. THE LANDSCAPE CONTRACTOR WILL BE SOLELY RESPONSIBLE FOR ANY DAMAGE OR INJURY TO PERSON OR PROPERTY THAT MAY OCCUR AS A RESULT OF THE EXECUTION OF THEIR WORK.

8. THE LANDSCAPE CONTRACTOR SHALL BE RESPONSIBLE FOR MAINTAINING THE AREA, MATERIALS AND EQUIPMENT WITHIN THE LIMITS OF WORK IN A SAFE, NEAT AND ORDERLY MANNER. EXCESS MATERIALS AND DEBRIS ARE TO BE REMOVED FROM THE WORK AREA NO LESS THAN WEEKLY OR AS DIRECTED BY THE GENERAL CONTRACTOR.

9. THE LANDSCAPE CONTRACTOR MUST TAKE PRECAUTIONS TO PROTECT ALL EXISTING SITE ROADS PARKING LOTS, CURBS AND UTILITIES FROM DAMAGE. THIS APPLIES NOT ONLY TO THE AREA WITHIN THE LIMITS OF WORK BUT ALSO ALONG ANY LOCAL ACCESS ROADS.

10. THE LANDSCAPE CONTRACTOR SHALL PROVIDE ALL NECESSARY SAFETY MEASURES DURING CONSTRUCTION OPERATIONS TO PROTECT THE PUBLIC ACCORDING TO ALL APPLICABLE CODES AND RECOGNIZE LOCAL PRACTICES.

11. THE LANDSCAPE CONTRACTOR SHALL COORDINATE WITH GENERAL CONTRACTOR TO ENSURE THAT TEMPORARY EROSION AND SEDIMENTATION CONTROL MEASURES (SILT FENCE, ORANGE GEE FENCE AND/OR OTHER MEASURES) ARE INSTALLED PRIOR TO BEGINNING EXCAVATION.

12. THE LANDSCAPE CONTRACTOR SHALL BE RESPONSIBLE FOR THE MAINTENANCE OF ALL PLANT MATERIALS AND THE PLANTING AREAS UNTIL FINAL ACCEPTANCE BY THE OWNER.

13. THE LANDSCAPE CONTRACTOR IS RESPONSIBLE FOR THE AGRONOMIC EVALUATION OF SOIL CHARACTERISTICS. EVALUATION MUST INCLUDE CHEMICAL ANALYSIS BY A QUALIFIED AGRICULTURAL SOILS TESTING LABORATORY (CERTIFIED IN THE STATE OF FLORIDA). SOILS SAMPLE SHOULD BE TAKEN IMMEDIATELY FOLLOWING COMPLETION OF ROUGH GRADING ACTIVITIES AND SHOULD BE COLLECTED AT A RATE ON ONE SAMPLE FOR EACH 5,000 SQUARE FEET OF IMPACTED AREA OR A TOTAL OF SIX, WHICHEVER IS GREATER. AT A MINIMUM THE CHEMICAL ANALYSIS OF THE SOIL SHOULD CONSIDER THE FOLLOWING:

- A. PERCENTAGE OF ORGANIC MATTER
- B. SALINITY
- C. PH
- D. LIME CONTENT
- E. MINERAL NUTRIENTS INCLUDING CONCENTRATIONS OF NITROGEN, PHOSPHOROUS, POTASSIUM, CALCIUM, MAGNESIUM, IRON, ZINC, MANGANESE, COPPER, SULFUR, AND MOLYBDENUM.
- F. POTENTIAL HAZARDS OR IMPEDIMENTS FOR PLANT GROWTH INCLUDING SALINITY, SODIUM CHLORIDE, BORON, IMPAIRED SOIL STRUCTURE OR DRAINAGE.
- F. SAND FRACTION ANALYSIS AS A PERCENTAGE PASSING THROUGH 1", 1/2", AND NO. 200 SIEVES
- H. PERCOLATION RATE IN INCHES PER HOUR.

THE ANALYSIS SHOULD ALSO INCLUDE SPECIFIC RECOMMENDATIONS TO THE OWNER FOR ANY AMENDMENTS AND BACKFILL MIXES FOR OPTIMAL PLANT GROWTH TO BE MADE TO THE SOILS PRIOR TO PLANTING. THE CONTRACTOR SHOULD INCLUDE THE COST FOR SOIL AMENDMENTS. THE CONTRACTOR IS TO PROVIDE THE OWNER WITH COPIES OF ALL SOIL TESTING RESULTS. SUBMITTAL DOCUMENTATION MUST ALSO CONTAIN A GRAPHIC SITE PLAN DEPICTING LOCATIONS FROM WHICH EACH SAMPLE WAS DRAWN.

14. THE LANDSCAPE CONTRACTORS BARE BID FOR SOIL PREPARATION IS TO INCLUDE THE FOLLOWING WITH THE UNDERSTANDING THAT MIX DESIGN MAY NEED TO BE ADJUSTED BASED ON OUTCOME OF AGRONOMIC TESTING.

- A. TREES: 100% SITE SOIL WITH 5LB. TRIPLE SUPER PHOSPHATE PER CU. YD.
- B. SHRUBS: 100% SITE SOIL WITH OSMOCOTE CONTROLLER RELEASE FERTILIZER (14-14-14) PER MANUFACTURER'S RECOMMENDATION.

C. THE SOILS TEST RESULTS TAKE PRECEDENCE OVER THE ITEMS NOTED IN A AND B ABOVE.

15. SHOULD OWNER AND LANDSCAPE CONTRACTOR AGREE WITH THE RECOMMENDATION OF THE TESTING AGENCY TO FURTHER AMEND THE SOILS THE CONTRACTOR'S CONTRACT WILL BE ADJUSTED ACCORDINGLY. THE CONTRACTOR SHALL BE REQUIRED TO SUBMIT SAMPLES OF AMENDED SOILS TO BE RE-TESTED TO CONFIRM COMPLIANCE WITH RECOMMENDATIONS FOLLOWING THE SAME PROCEDURES AS THE ORIGINAL TESTS.

16. THE LANDSCAPE CONTRACTOR IS RESPONSIBLE FOR CONFIRMING THE QUANTITIES OF EACH PLANT MATERIAL REQUIRED TO ADEQUATELY COVER THE AREA SHOWN ON THE LANDSCAPE PLANS AT THE PRESCRIBED SPACINGS AND NOTIFYING THE OWNER IMMEDIATELY OF ANY PERCEIVED DISCREPANCIES FOR RESOLUTION. THE PLANT SPACING CONTROLS BED LAYOUT, NOT THE PLAN QUANTITY FOR THAT PARTICULAR BED.

FINE GRADING NOTES

1. FINISHED GRADE IN PLANTING AREAS SHALL BE HELD 3" BELOW THE FINISHED ELEVATIONS SHOWN FOR ALL ADJACENT HARDCAPE SURFACES.

2. ALL FILL REQUIRED SHALL BE CLEAN, WELL DRAINING SOIL. FILL SHALL BE CLEAN AND FREE OF ALL MATERIAL HARMFUL TO PLANT GROWTH AND DELETERIOUS MATERIAL SUCH AS ROCKS (LARGER THAN 2" DIA.), COMPACTED CLAY, ROADBED OR SURFACING MATERIAL, MUCK, ROOTS AND BRANCHES, ETC.

3. THE LANDSCAPE CONTRACTOR IS TO ENSURE THAT THEIR WORK DOES NOT ADVERSELY IMPACT ESTABLISHED OR PROJECTED DRAINAGE PATTERNS.

INSTALLATION NOTES

- 1. PLANT AND LANDSCAPE MATERIALS SHALL CONFORM TO THE STANDARDS FOR FLORIDA NO. 1, AS GIVEN IN THE GRADES AND STANDARDS FOR NURSERY PLANTS, PARTS I & II, AS PREPARED BY THE FLORIDA DEPT. OF AGRICULTURE AND CONSUMER SERVICES.
- 2. A 3" THICK LAYER OF ORGANIC NON-CYPRESS MULCH SHALL BE APPLIED TO ALL LANDSCAPE AND PLANTING AREAS.
- 3. ALL EXOTIC VEGETATION TO BE REMOVED FROM THE SITE PRIOR TO THE ISSUANCE OF A CERTIFICATE OF OCCUPANCY.
- 4. THIS PLAN HAS BEEN DESIGNED TO MEET WITH THE TREE PLANTING REQUIREMENTS CONTAINED WITHIN THE FPL DOCUMENT ENTITLED "PLANT THE RIGHT TREE IN THE RIGHT PLACE."

5. FOR EXISTING OR PROPOSED UTILITIES, NO TREE SHALL BE PLANTED WHERE IT COULD, AT MATURE HEIGHT, CONFLICT WITH OVERHEAD POWER LINES. LARGE TREES [HEIGHT AT MATURITY OF MORE THAN THIRTY (30) FEET] SHALL BE PLANTED NO CLOSER THAN A HORIZONTAL DISTANCE OF THIRTY (30) FEET FROM THE NEAREST OVERHEAD POWER LINE. MEDIUM HEIGHT TREE [HEIGHT AT MATURITY BETWEEN TWENTY (20) AND THIRTY (30) FEET] SHALL BE OFFSET AT LEAST TWENTY (20) FEET AND SMALL TREES [HEIGHT AT MATURITY OF LESS THAN (20) FEET] REQUIRE NO OFFSET.

6. NO TREE, SHRUBS, HEDGES OR VINES SHALL BE PLANTED WITHIN FIVE (5) FEET OF ANY EXISTING OR PROPOSED UTILITY POLE, GUY WIRE OR PAD MOUNTED TRANSFORMER. PALMS SHOULD BE PLANTED AT A DISTANCE EQUAL TO OR GREATER THAN THE AVERAGE FRONT LENGTH PLUS TWO (2) FEET FROM POWER LINES.

7. WETLAND BUFFERS, BUFFER PROTECTION AREAS, AND UPLAND PRESERVE AREAS SHALL BE PROTECTED FROM EXCAVATION, CONSTRUCTION, AND OTHER BUILDING MAINTENANCE ACTIVITIES.

8. TREES TO REMAIN DURING CONSTRUCTION SHALL BE PROTECTED AND BARRICADED. SEE TREE PROTECTION NOTE.

9. FERTILIZER SHALL BE COMPLETE WITH APPROXIMATELY THE FOLLOWING RATIO: 3N-1P-3K (+1MG FOR PALMS ONLY)

10. TREES AND PALMS ARE TO BE PLANTED IN ACCORDANCE TO LANDSCAPE PLAN. GOOD HORTICULTURAL PRACTICES MUST BE OBSERVED.

11. TREES AND PALMS ARE TO BE PLANTED IN THE RIGHT-OF-WAY (ROW) AT A MINIMUM OF FOUR (4) FEET FROM BACK OF CURB AT LOCATIONS IDENTIFIED ON THE LANDSCAPE PLAN. AWARDED BIDDER SHALL STAKE AND/OR PAINT PLANTING LOCATIONS IN THE FIELD. UPON APPROVAL BY THE CUSTOMER, THESE AREAS SHALL BE SPRAYED WITH AN APPROVED HERBICIDE AND MAINTAINED WEED-FREE FOR THE DURATION OF THE PROJECT.

12. EXCAVATE PLANTING HOLES WITH VERTICAL SIDES. DO NOT DISTURB SOIL AT BOTTOM OF PLANTING HOLES. MAKE EXCAVATIONS TWICE AS WIDE AS THE ROOT BALL DIAMETER AND SLIGHTLY LESS (TWO INCHES) THAN THE DISTANCE BETWEEN THE TOP-MOST ROOT IN THE ROOT BALL AND THE BOTTOM OF THE ROOT BALL. ALTERNATIVELY, EXCAVATE THE HOLE SLIGHTLY WIDER THAN THE ROOT BALL AND PLACE THE ROOT BALL IN THE HOLE SO THE TOP-MOST ROOT IS EVEN WITH OR SLIGHTLY (2 INCHES) HIGHER THAN THE SURROUNDING LANDSCAPE GRADE. THEN, LOOSEN THE SURROUNDING SOIL OUT TO A DIAMETER EQUAL TO TWICE THE DIAMETER OF THE ROOT BALL. FINALLY, PUSH THE LOOSENED SOIL TOWARD THE ROOT BALL TO FILL THE HOLE.

IF WATER FILLS THE BOTTOM OF THE PLANTING HOLE, ADD SOIL TO THE BOTTOM OF THE HOLE UNTIL THE WATER IS COVERED. PACK THIS ADDED SOIL FIRMLY. PLACE THE ROOT BALL ON THIS PACKED, SOLID SOIL, NOT IN WATER. NO PART OF THE ROOT BALL SHALL BE PLACED IN WATER. IF NECESSARY, BRING IN SOIL SIMILAR TO SITE SOIL TO COVER THE BOTTOM OF THE ROOT BALL, CREATING A RAISED MOUND. THE BASE OF THE MOUND (I.E. THE OUTER DIAMETER) CREATED SHALL BE AT LEAST SIX TIMES THE DIAMETER OF THE ROOT BALL.

WHEN PLANTING ON A SLOPE, THE TOP-MOST MAIN ROOT IN THE ROOT BALL SHALL BE EVEN WITH THE GRADE ON THE UPHILL SIDE OF THE TREE. SITE SOIL WILL NEED TO BE ADDED ON THE DOWNHILL SIDE TO COVER THE SIDES OF THE ROOT BALL AND TO CONSTRUCT THE SOIL BERM TO HOLD WATER. THE AMOUNT OF SOIL ADDED ON THE DOWNHILL SIDE WILL DEPEND ON THE SLOPE AND SIZE OF THE ROOT BALL.

13. REMOVE ALL WOOD, PLASTIC, OR GRO-BAGS FROM THE ROOT BALL. SET PLANTS IN CENTER OF HOLES WITH THE TOP-MOST ROOT IN THE ROOT BALL AT THE SAME HEIGHT OR SLIGHTLY (2 INCHES) HIGHER THAN FINISHED LANDSCAPE GRADES AND PLUMB THE TREE SO THE TRUNK IS VERTICAL. BACKFILL FIELD SOIL AROUND SIDES OF ROOT MASS AND WORK EACH LAYER TO SETTLE AND ELIMINATE VOIDS AND AIR POCKETS. MATERIAL MUST BE WATERED IN AS PLANTED. PROVIDE APPROXIMATELY 5 GALLONS OF WATER PER INCH OF TRUNK CALIPER TO THE ROOT BALL ONCE ALL BACKFILL IS FILLED IN AROUND THE ROOT BALL.

14. PROVIDE A 2-3" HIGH SOIL BERM AROUND THE EDGE OF ROOT BALL TO FORM A SHALLOW SAUCER TO COLLECT WATER. THE WATERING SAUCER, REGARDLESS OF HOLE SIZE, IS TO BE AT EDGE OF ROOT BALL. ALTERNATIVELY, COBRA EDGING IS TO BE INSTALLED AT THE EDGE OF THE ROOT BALL.

15. BROADCAST OVER THE ROOT BALL AND BACKFILL SOIL AT THE RECOMMENDED RATE, A BROAD-SPECTRUM PRE-EMERGENT HERBICIDE PRIOR TO MULCHING.

16. APPLY A CONTROLLED-RELEASE FERTILIZER TO THE SOIL SURFACE UNDER THE MULCH AT 1LB. NITROGEN PER 1000 FT2. PRIOR TO MULCHING. NO OTHER AMENDMENTS ARE NECESSARY.

17. ON TREES UP TO 4" CALIPER, APPLY A THREE (3) -INCH LAYER OF MULCH TO AN EIGHT (8) -FOOT DIAMETER CIRCULAR AREA AROUND THE TRUNK. ON LARGER CALIPER TREES, APPLY A TWO (2) -FOOT DIAMETER MULCH AREA FOR EACH INCH OF TRUNK CALIPER. NO MULCH SHALL BE APPLIED TO THE INNER HALF OF THE ROOT BALL SURFACE.

18. TREES AND PALMS ARE TO BE SECURED BY AWARDED BIDDER AS SHOWN IN EXHIBITS A-C. (NOTE: STAKING IS OPTIONAL FOR MORE PROTECTED LOCATIONS).

19. A REPRESENTATIVE WILL INSPECT TREES AND PALMS DURING INSTALLATION. MATERIAL THAT IS IN SHOCK OR HAS BEEN DAMAGED DURING INSTALLATION SHALL BE REPLACED BY AWARDED BIDDER WITHIN FIVE (5) WORKING DAYS FROM NOTIFICATION.

20. REMOVE FROM WORK SITE ALL EXCESS MATERIALS (E.G., SOIL, DEBRIS AND EQUIPMENT) DAILY THROUGH DURATION OF PROJECT. DAMAGES RESULTING FROM INSTALLATION SHALL BE REPAIRED BY AWARDED BIDDER.

21. PRUNING: IF THERE IS A DOUBLE LEADER IN THE TOP HALF OF THE TREE, SHORTEN ONE, BY ABOUT ONE-HALF, BACK TO A LIVE BRANCH THAT POINTS AWAY FROM THE TREE AND IS AT LEAST ONE-THIRD THE DIAMETER OF THE CUT LEADER. REMOVE BROKEN PORTIONS OF DAMAGED BRANCHES BACK TO A LIVE LATERAL BRANCH.

21. PRUNING: IF THERE IS A DOUBLE LEADER IN THE TOP HALF OF THE TREE, SHORTEN ONE, BY ABOUT ONE-HALF, BACK TO A LIVE BRANCH THAT POINTS AWAY FROM THE TREE AND IS AT LEAST ONE-THIRD THE DIAMETER OF THE CUT LEADER. REMOVE BROKEN PORTIONS OF DAMAGED BRANCHES BACK TO A LIVE LATERAL BRANCH.

22. REMOVE ALL STRING OR WIRE WRAPPED AROUND THE TRUNK. REMOVE ALL STRAPS, ROPE AND STRING USED TO LIFT THE ROOT BALL. REMOVE ALL BURLAP AND WIRE FROM THE TOP OF THE ROOT BALL.

SOIL NOTES

1. OFF-SITE TOPSOIL SHALL BE NATURAL, FERTILE FRIABLE LOAM OR SANDY LOAM AS CLASSIFIED BY THE U.S. DEPARTMENT OF AGRICULTURE SOIL CLASSIFICATION SYSTEM. THE SOIL SHALL CONTAIN NOT LESS THAN 3 PERCENT OR MORE THAN 8 PERCENT BY WEIGHT OF DECAYED ORGANIC MATTER (HUMUS) AS DETERMINED BY ASTM F-1647. THE TOPSOIL SHALL BE FREE OF STONES 1 INCH (25 MILLIMETERS) OR LARGER AND OTHER EXTRANEOUS MATERIALS HARMFUL TO PLANT GROWTH. TOPSOIL SHALL NOT HAVE A PH OF LESS THAN 6.0 OR GREATER THAN 7.5, AND SHALL NOT BE DELIVERED OR USED FOR PLANTING WHILE IN A FROZEN OR MUDDY CONDITION.

IF ORGANIC AMENDMENTS ARE NEEDED TO OBTAIN THE SPECIFIC ORGANIC MATTER CONTENT OF THE TOPSOIL, THE ORGANIC MATTER SOURCE MAY BE A PEAT OR COMPOST MATERIAL. THE PEAT SHALL BE SPHAGNUM PEAT HAVING AN ASH CONTENT NOT EXCEEDING 15 PERCENT, AS DETERMINED BY ASTM D-2974. COMPOSTS MAY BE USED PROVIDED THAT THE MATERIAL HAS AN ASH CONTENT NOT EXCEEDING 40 PERCENT.

ACCEPTANCE NOTES

1. INSPECTION TO DETERMINE ACCEPTANCE OF PLANTED AREAS WILL BE MADE BY THE CUSTOMER REPRESENTATIVE UPON AWARDED BIDDER'S REQUEST. PROVIDE NOTIFICATION A MINIMUM OF FIVE (5) WORKING DAYS BEFORE REQUESTED INSPECTION DATE.

PLANTED AREAS WILL BE ACCEPTED PROVIDED ALL REQUIREMENTS, INCLUDING MAINTENANCE, HAVE BEEN SATISFIED AND PLANT MATERIALS ARE IN A HEALTHY, VIGOROUS CONDITION.

2. THE CUSTOMER REPRESENTATIVE WILL PREPARE A "PUNCH LIST" OF THOSE ITEMS, WHICH MUST BE CORRECTED BEFORE RE-INSPECTION FOR FINAL ACCEPTANCE. THE REPRESENTATIVE WILL DETERMINE AN APPROPRIATE TIME PERIOD FOR CORRECTIONS. AWARDED BIDDER MUST REQUEST RE-INSPECTION TWO (2) WORKING DAYS IN ADVANCE.

PLANT SCHEDULE

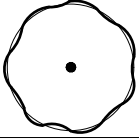
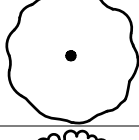
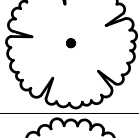
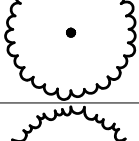
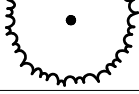
SYMBOL	QTY	COMMON / BOTANICAL NAME	SIZE	NATIVE
TREES				
	12	Verawood / Bulnesia arborea	2.5" Cal., 12' Ht. x 5' Spr. Min., Std., 5' ct.	No
	1	Pigeon Plum / Coccoloba diversifolia	2.5" Cal, 12' Ht. x 5' - 6' Spr., STD., 5' ct	Yes
	2	Green Buttonwood / Conocarpus erectus	2.5" Cal., 12' Ht x 5' Spr., Std., 5-6' ct.	Yes
	6	Silver Buttonwood / Conocarpus erectus 'Sericeus'	2.5" Cal. , 12' Ht. x 5' Spr. Min.	Yes
	18	Slash Pine / Pinus elliotti 'Densa'	2.5" Cal., 12' Ht x 5' Spr., Std., 5-6' ct.	Yes

PLANT SCHEDULE

CODE	QTY	COMMON / BOTANICAL NAME	SIZE	NATIVE	SPACING
HEDGE					
CR	291	Red Tip Cocoplum / Chrysobalanus icaco 'Red Tip'	30" Ht. x 24" Spr.	Yes	24" o.c.
CS2	185	Silver Buttonwood / Conocarpus erectus 'Sericeus'	30" Ht. x 24" Spr.	Yes	24" o.c.

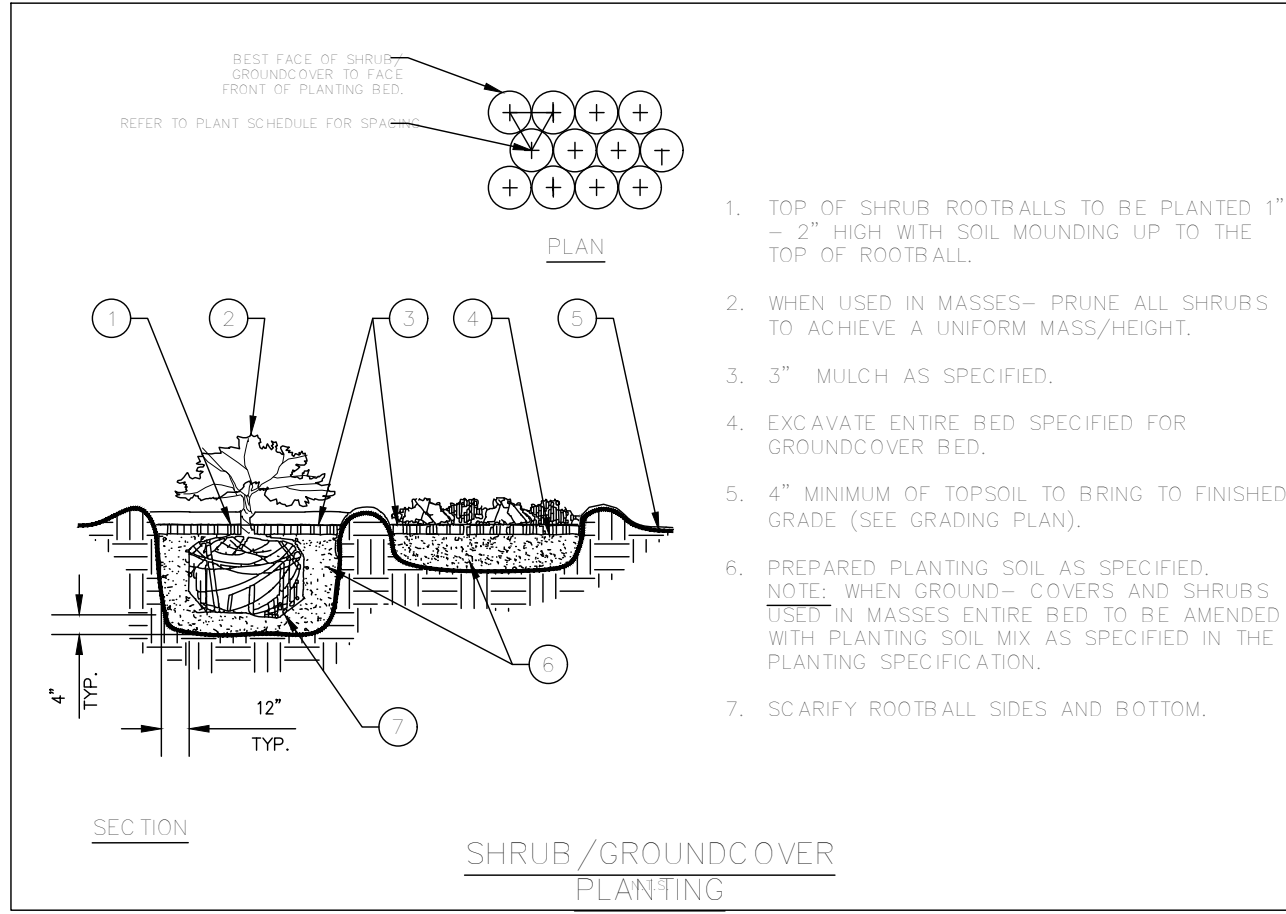
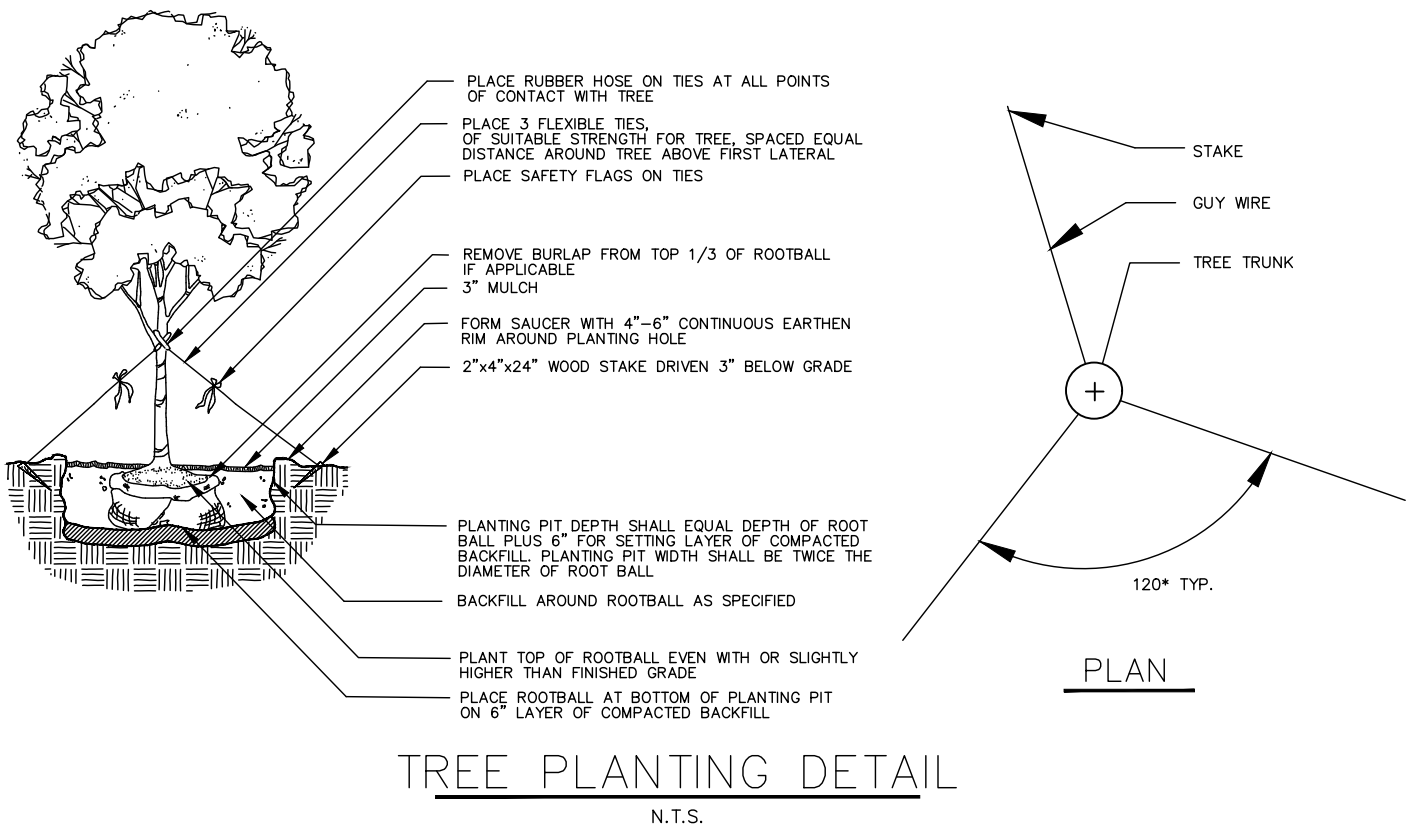
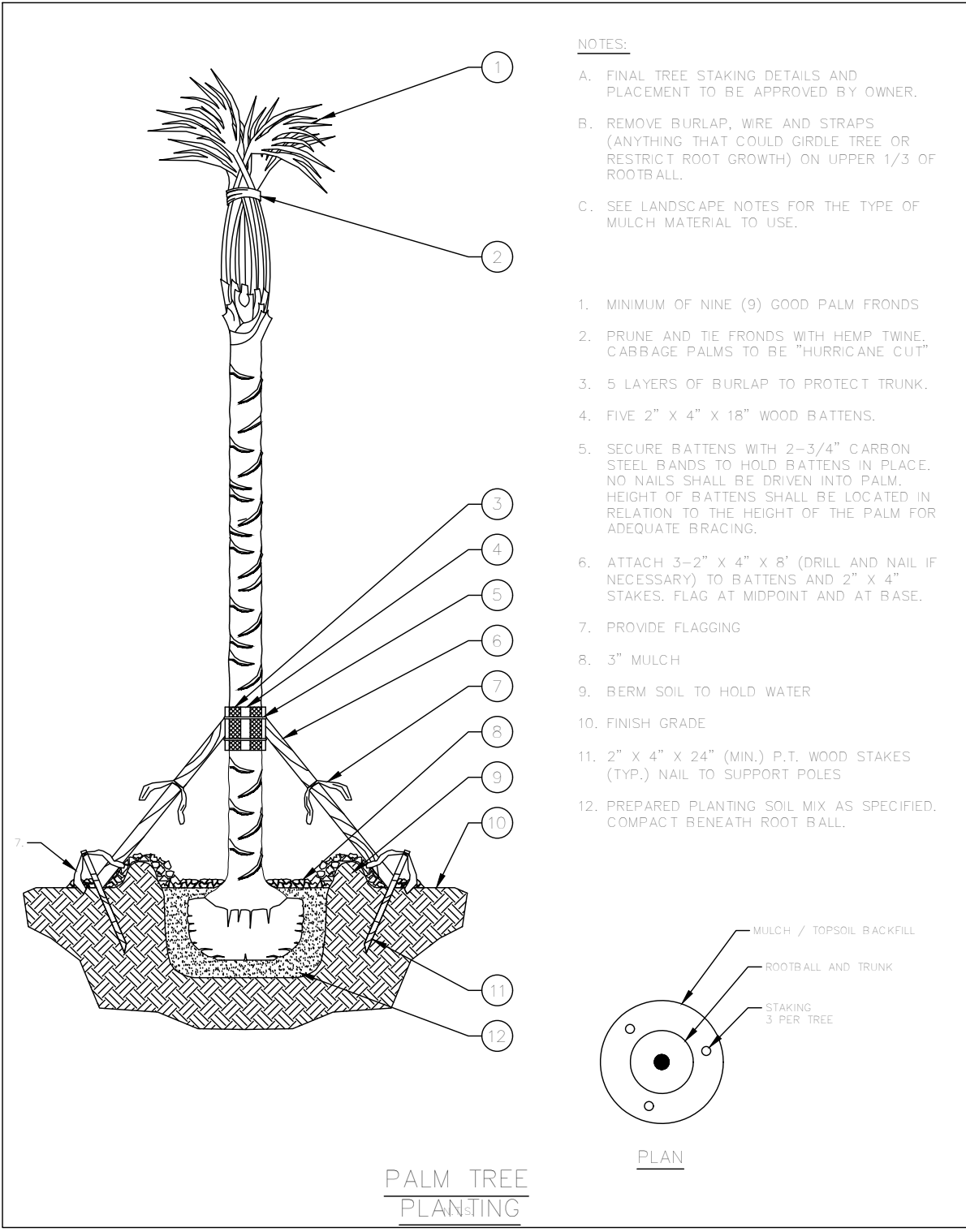

LANDSCAPE AND ROOT BARRIER NOTE:

Trees shown on this plan are for graphic representation only. Tree spacing is based on design requirements and the trees shown on this plans attempt to accomplish that spacing while maintaining the required setbacks from utilities. Trees may be field adjusted to avoid conflicts with driveways and underground utilities. In any case the trees shall be located in the filed in accordance with the planting details shown hereon.

Where a tree(s) is planted closer than five (5) feet from a sidewalk, or structure, a root barrier(s) shall be installed. Root barriers for trees shall be installed along the edge of structure, paving, or curb. The root barrier shall be a minimum of twenty-four inches deep, but depending on the size, location, and species of tree to be planted, a larger barrier may be required. The root barrier shall be installed with twenty (20) linear feet, centered from the trunk, for large trees and fifteen (15) linear feet for smaller trees. All root barriers shall be linear. Refer to the "Root Barrier" detail for installation requirements.

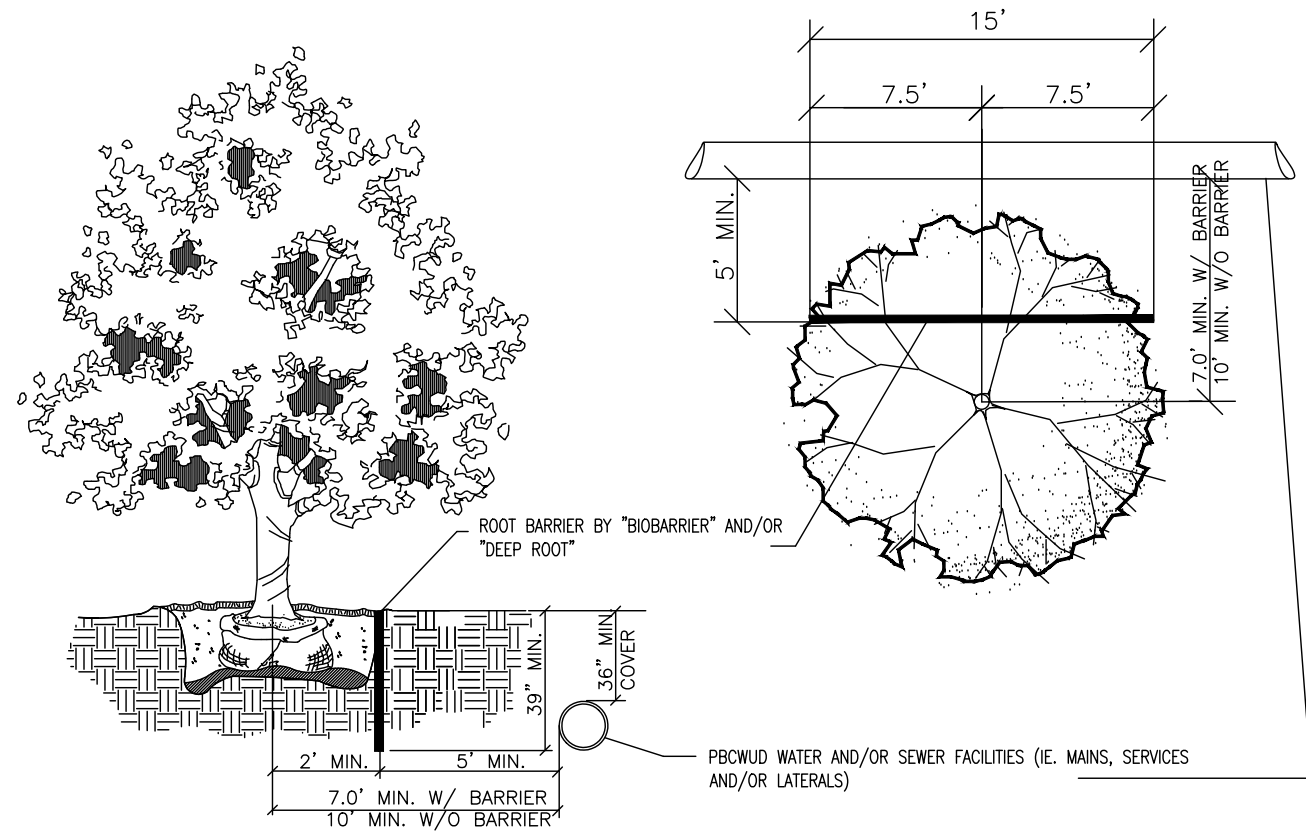

Root Barrier Detail NTS



50 E. Ocean Blvd., Suite 101  
Stuart, Florida 34994

T 772.678.7200  
F 772.678.7201

www.hjdesignstudio.com  
LA 0000905

639 NW Enterprise - Landscape Plan  
City of Port St. Lucie  
Landscape Specifications  
Florida



Job No. 2024-22  
Drawn By EB  
Checked By MH  
Approved By MH  
Submittal Dates 07-10-24

Revision Dates 01-07-2025

LP- 3

PSL # P24-092