

**Project Team:**  
 Owner/Developer:  
 Mattamy Homes  
 1500 Gateway Blvd, Suite 212  
 Boynton Beach, FL 33426  
 561-739-7902  
 Engineer:  
 Kimley-Horn  
 445 24th Street, Suite 200  
 Vero Beach, FL 32960  
 772-794-4100  
 Surveyor:  
 Caulfield & Wheeler, Inc  
 410 SE Port St. Lucie Blvd  
 Port St. Lucie, FL 34984  
 772-408-1920  
 Landscape Architect/Land Planner:  
 Lucido & Associates  
 701 E Ocean Blvd  
 Stuart, FL 34904  
 772-220-2100

**Capstone Community**  
 Port St. Lucie, Florida  
 Product Type Exhibit

City of Port St. Lucie P# 20-141  
 PSLUD No. 5367

Date	By	Description
3.8.21	MY	Response to SPRC comm
4.14.21	MY	Revise product type

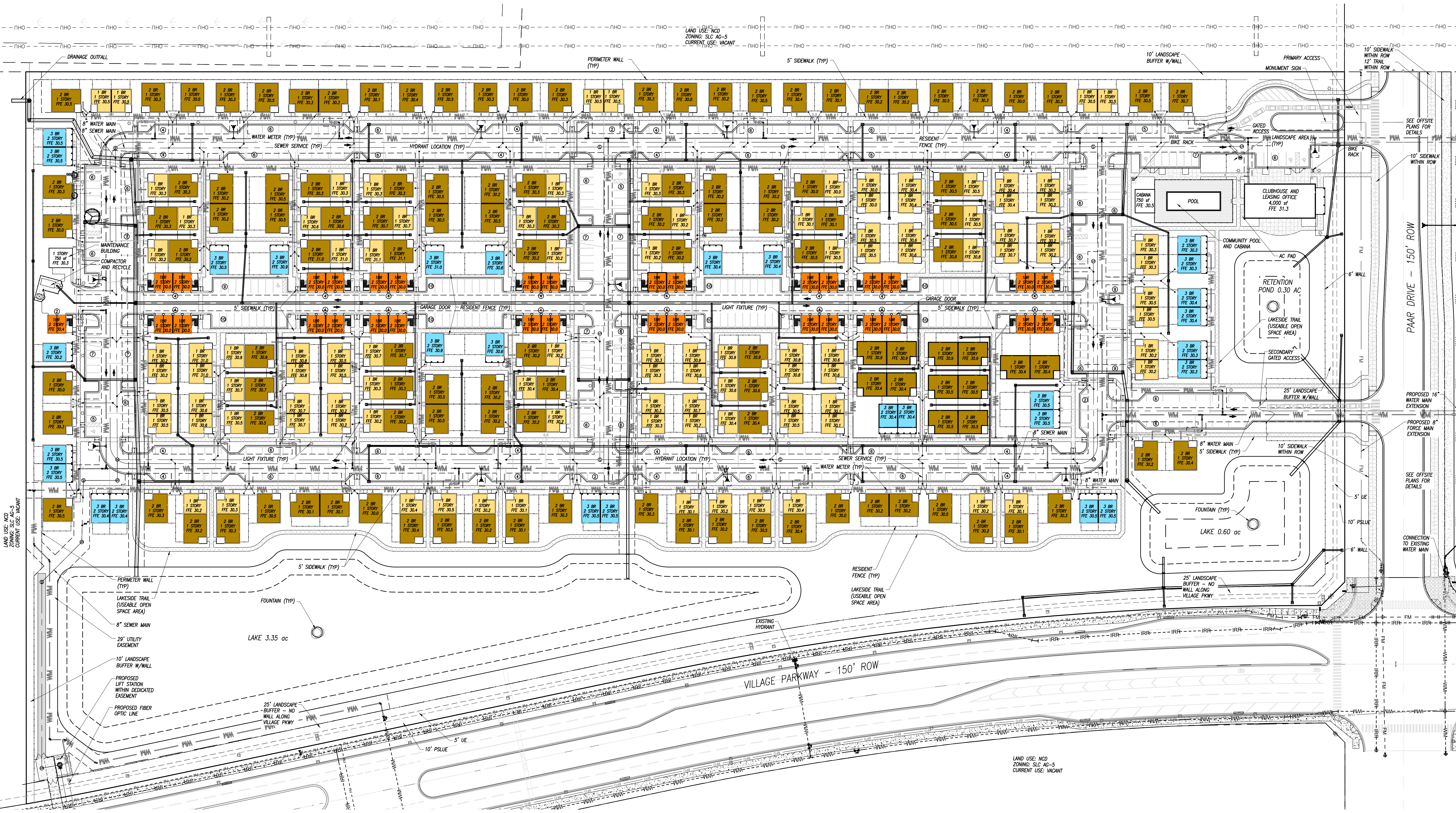

**Product Type/Unit Count:**

- 1 Bedroom Cottage / 105 Units  
1 Story
- 1 Bedroom Cottage - Over Garage / 33 Units  
2 Story
- 2 Bedroom Cottage / 119 Units  
1 Story
- 3 Bedroom Cottage / 29 Units  
2 Story

Total Units = 286 Units

