

Property Identification

Site Address: 3881 SW MCCRORY ST
 Sec/Town/Range: 30/37S/40E
 Parcel ID: 3420-600-0918-000-9
 Jurisdiction: Port Saint Lucie

Use Type: 0100
 Account #: 72500
 Map ID: 44/30N
 Zoning: RS-2 PSL

Ownership

Port St Lucie City of
 121 SW Port St Lucie BLVD
 Port St Lucie, FL 34984

Legal Description

PORT ST LUCIE-SEC 21- BLK 2087 LOT 8 (MAP 44/30N) (OR 1338-327)



Current Values

Just/Market Value: \$39,000
 Assessed Value: \$10,285
 Exemptions: \$10,285
 Taxable Value: \$0

Total Areas

Finished/Under Air (SF): 1,550
 Gross Sketched Area (SF): 2,098
 Land Size (acres): 0.23
 Land Size (SF): 10,000

Property taxes are subject to change upon change of ownership.

- Past taxes are not a reliable projection of future taxes.
- The sale of a property will prompt the removal of all exemptions, assessment caps, and special classifications.

Building Design Wind Speed

Occupancy Category	I	II	III & IV
Speed	140	150	160

Sources/links:

Taxes for this parcel: SLC Tax Collector's Office [📄](#)

Download TRIM for this parcel: [Download PDF](#) [📄](#)

Sale History

Date	Book/Page	Sale Code	Deed	Grantor	Price
Oct 18, 2000	1338 / 0327	XX01	WD	Matics Roger L	\$100
Oct 26, 1990	0713 / 1479	XX00	WD	Hover Rick	\$6,000
Dec 1, 1989	0666 / 2768	XX00	WD	Maxine Parker	\$9,000
Oct 5, 1989	0658 / 0870	XX05	WD	Floyd H Ewell	\$6,000
Aug 1, 1978	0283 / 1694	XX00	CV		\$2,400

Building Information (1 of 1)

Finished Area: 1,550 SF

Gross Sketched Area: 2,098 SF

Exterior Data

View:	Roof Cover: Dim Shingle	Roof Structure: Hip
Building Type: HC	Year Built: 2021	Frame:
Grade: C	Effective Year: 2021	Primary Wall: CB Stucco
Story Height: 1 Story	No. Units: 1	Secondary Wall:

Interior Data

Bedrooms: 3	Electric: MAXIMUM	Primary Int Wall:
Full Baths: 2	Heat Type: FredHotAir	Avg Hgt/Floor: 0

Half Baths: 0
A/C %: 100%

Heat Fuel: ELEC
Heated %: 100%

Primary Floors: Carpet
Sprinkled %: 0%

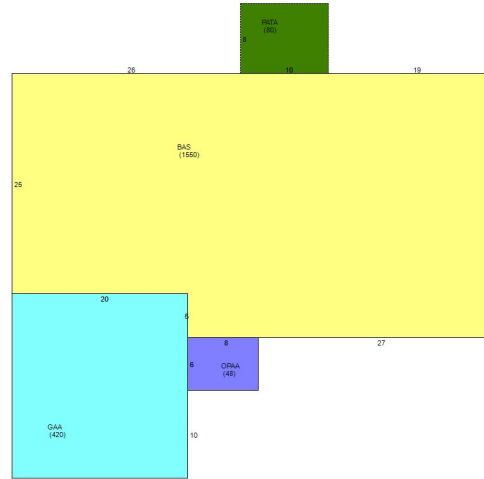

Sketch Area Legend

Sub Area	Description	Area	Fin. Area	Perimeter
BAS	BASE AREA	1550	1550	170
GAA	Garage Attached Average	420	0	82
OPAA	Open Porch Attached Average	48	0	28
PATA	Patio Average (Plain Slab)	80	0	36

Special Features and Yard Items

Type	Qty	Units	Year Blt
------	-----	-------	----------

Current Year Values

Current Values Breakdown		Current Year Exemption Value Breakdown				
		Tax Year	Grant Year	Code	Description	Amount
Building:	\$0			7900	City of Port St Lucie	\$10,285
Land:	\$39,000	2021	2001			
Just/Market:	\$39,000					
Ag Credit:	\$0					
Save Our Homes or 10% Cap:	\$28,715					
Assessed:	\$10,285					
Exemption(s):	\$10,285					
Taxable:	\$0					

Current Year Special Assessment Breakdown

Start Year	AssessCode	Units	Description	Amount
2021	0061	1	Port St. Lucie Stormwater	\$0.00

This does not necessarily represent the total Special Assessments that could be charged against this property. The total amount charged for special assessments

Historical Values

Year	Just/Market	Assessed	Exemptions	Taxable
2021	\$39,000	\$10,285	\$10,285	\$0
2020	\$31,200	\$9,350	\$9,350	\$0
2019	\$27,300	\$8,500	\$8,500	\$0
2018	\$22,100	\$7,728	\$7,728	\$0

Permits

Number	Issue Date	Description	Amount	Fee
P20-10568	May 4, 2020	Residential New Construction	\$182,000	\$18,936

Notice: This does not necessarily represent all the permits for this property.
Click the following link to check for additional permit data in Port Saint Lucie

All information is believed to be correct at this time, but is subject to change and is provided without any warranty.
© Copyright 2022 Saint Lucie County Property Appraiser. All rights reserved.