

Site Area = 14.55 Ac  
 Site Area = 110.23 Ac  
**Total Site Area = 124.78 Ac**  
 (Total Site Area includes CT 76 and CT 80)

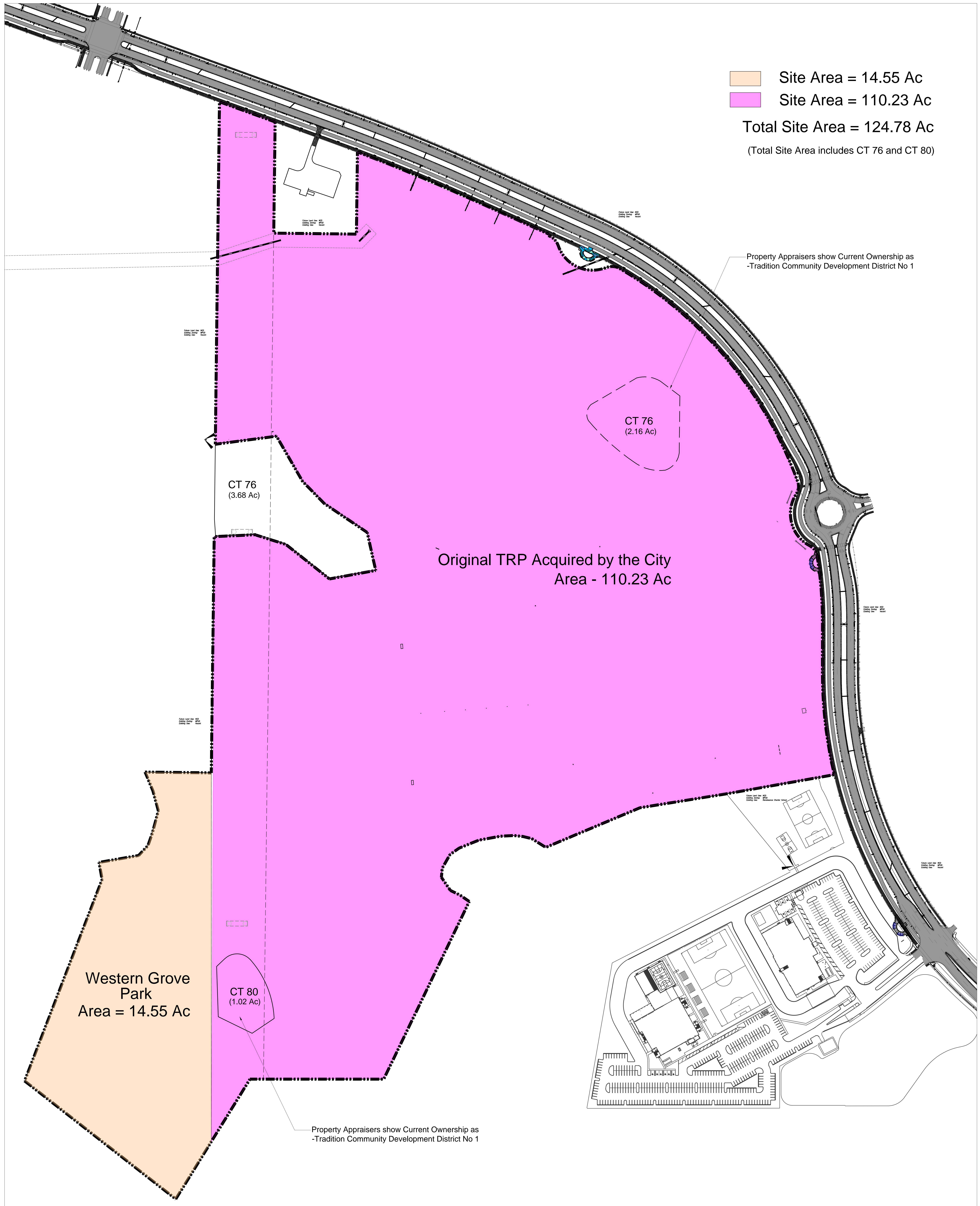

Original TRP Acquired by the City  
Area - 110.23 Ac

Western Grove  
Park  
Area = 14.55 Ac

CT 76  
(3.68 Ac)

CT 76  
(2.16 Ac)

CT 80  
(1.02 Ac)

Property Appraisers show Current Ownership as  
-Tradition Community Development District No 1