

Jeffrey W. Smith, RLA
 Florida Registration Number: LA 0001635

Job No.	21-1204
Drawn By	JWS
Submittal Dates	1-4-2022 5-2-2022 11-17-2022
Revision Dates	5-2-2022
New Base	5-2-2022
City Comments	10-12-2022
City Comments	11-17-2022
City Comments	1-5-2023

These drawings are the property of the landscape architect and are not to be used for other projects except by written permission from the landscape architect. Report any discrepancies immediately to the landscape architect.

PSLUSD Project Number: 11-447-00
 Sheet **L-1** of 3
 City Project Number: P22-005 & P22-006

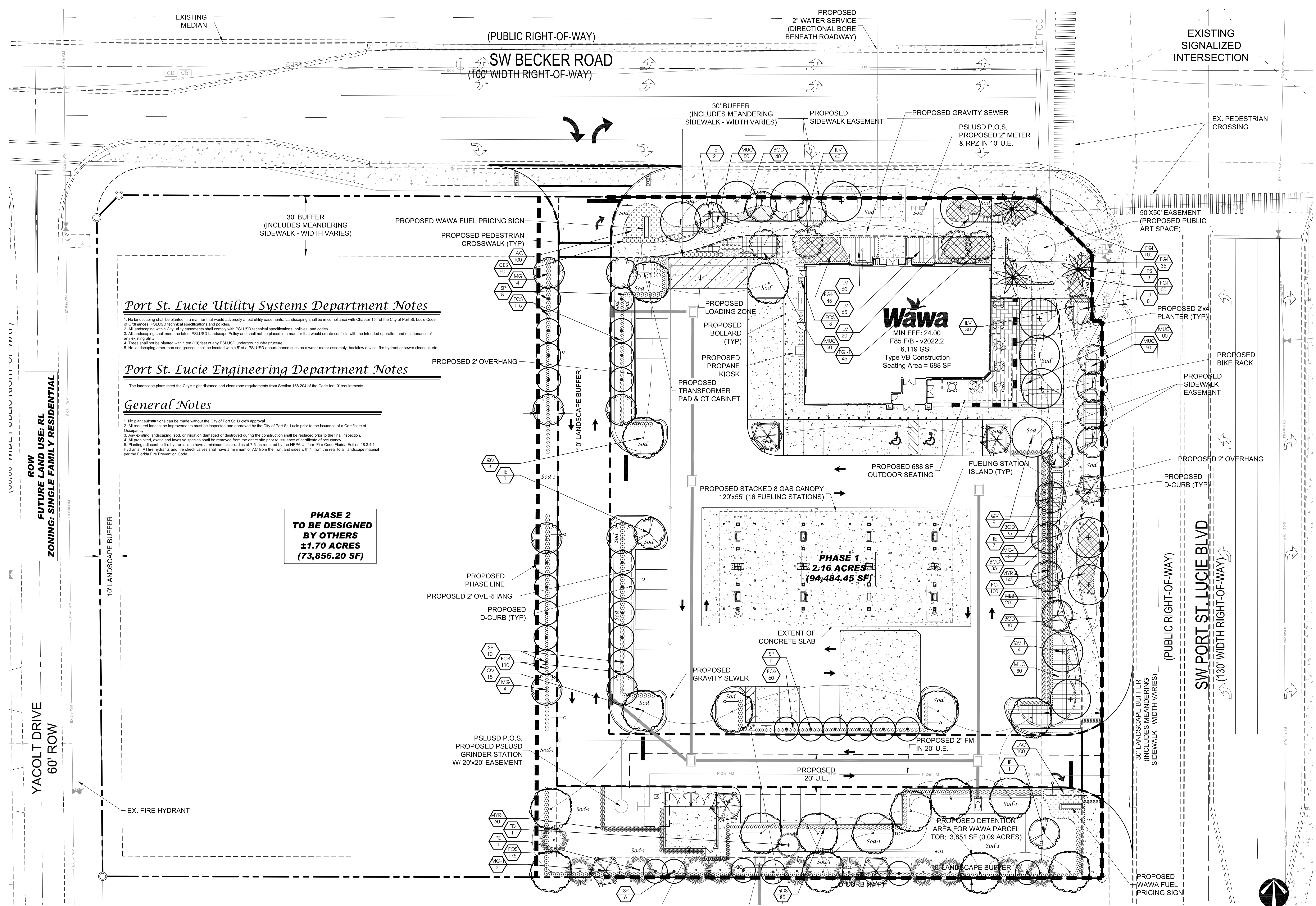

Port St. Lucie Utility Systems Department Notes

- No landscaping shall be planted in a manner that would adversely affect utility easements. Landscaping shall be in compliance with Chapter 154 of the City of Port St. Lucie Code of Ordinances, PSLUSD technical specifications and policies.
- All landscaping within City utility easements shall comply with PSLUSD technical specifications, policies, and codes.
- All landscaping shall meet the latest PSLUSD Landscape Policy and shall not be placed in a manner that would create conflicts with the intended operation and maintenance of any existing utility.
- Trees shall not be planted within ten (10) feet of any PSLUSD underground infrastructure.
- No landscaping other than sod grasses shall be located within 5' of a PSLUSD appurtenance such as a water meter assembly, backflow device, fire hydrant or sewer cleanout, etc.

Port St. Lucie Engineering Department Notes

- The landscape plans meet the City's sight distance and clear zone requirements from Section 156.204 of the Code for 10' requirements.

General Notes

- No plant substitutions can be made without the City of Port St. Lucie's approval.
- All required landscape improvements must be inspected and approved by the City of Port St. Lucie prior to the issuance of a Certificate of Occupancy.
- Any existing landscaping, sod, or irrigation damaged or destroyed during the construction shall be replaced prior to the final inspection.
- All prohibited, exotic, and invasive species shall be removed from the entire site prior to issuance of certificate of occupancy.
- Planting adjacent to fire hydrants is to have a minimum clear radius of 7.5' as required by the NFPA Uniform Fire Code Florida Edition 18.3.4.1 Hydrants. All fire hydrants and fire check valves shall have a minimum of 7.5' from the front and sides with 4' from the rear to all landscape material per the Florida Fire Prevention Code.

**PHASE 2
 TO BE DESIGNED
 BY OTHERS
 ±1.70 ACRES
 (73,856.20 SF)**

Landscape Plan

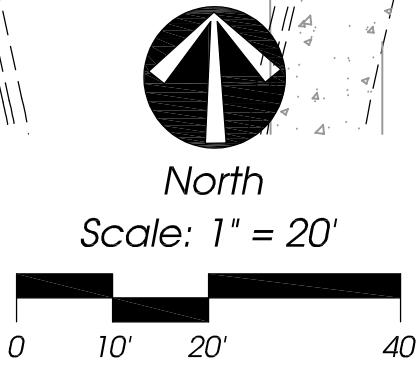

General Notes

- No plant substitutions can be made without the City of Port St. Lucie's and the Landscape Architect's approval.
- All required landscape improvements must be inspected and approved by the City of Port St. Lucie prior to the issuance of a Certificate of Occupancy.
- Any existing landscaping, sod, or irrigation damaged or destroyed during the construction shall be replaced prior to the final inspection.
- All prohibited, exotic and invasive species shall be removed from the entire site prior to issuance of certificate of occupancy.
- Planting adjacent to fire hydrants is to have a minimum clear radius of 7.5' as required by the NFPA Uniform Fire Code Florida Edition 18.3.4.1 Hydrants. All fire hydrants and fire check valves shall have a minimum of 7.5' from the front and sides with 4' from the rear to all landscape material per the Florida Fire Prevention Code.
- All fertilizers shall meet the City of Port St. Lucie's fertilizer ordinances.
- All tree and plant material to be Florida No. 1 or better, as classified in "Grades and Standards for Nursery Plants", Part 1 and Part II, State of Florida, Dept. of Agriculture, Tallahassee. All plants not listed in "Grades and Standards for Nursery Plants" shall conform to a Florida No. 1 as set: (1) health and vitality, (2) condition of foliage, (3) root system, (4) freedom from pest or mechanical damage, (5) heavily branched and densely foliated according to the accepted normal shape of the species.
- Underlining or substitution of one species or cultivar for another species is a breach of contract and will be "Rejected" at the time of final landscape inspection unless approved by Landscape Architect.
- Any and all conditions which the contractor feels will be detrimental to the success of the planting shall be brought to the owner or representative's attention.
- The contractor shall verify the location of underground utilities prior to commencing work on any project area.
- Cypress Mulch is NOT ACCEPTABLE.
- All planting areas and St. Augustine sod to be irrigated to provide 100% coverage. Shop drawings to be submitted by the irrigation contractor for approval prior to installation.
- Maintain positive drainage, no planting is to block drainage.
- Contractor shall include drainage testing for all trees and palms in bid. If drainage is inadequate, the Contractor shall notify the Owner and Landscape Architect in writing of poor drainage conditions and written direction will be provided to the Contractor of appropriate soil mixture specification to be used.
- Drainage Testing
 - Prior to planting of trees, palms, and specimen material, each planting pit shall be tested in the following manner to verify adequate drainage.
 - Dig each planting pit to the minimum specified size.
 - Fill the planting pit with (12") twelve inches of water. If the water level in the planting pit drops (4") four or more inches within (4) four hours, the drainage is sufficient and a drainage channel is not required. If the water level drops less than (4") four inches within the (4) four hour period, then a drainage channel is required.
 - When a drainage channel is required, the drainage channel must extend down through the non porous soil and into porous soil. (See Drainage Testing Detail)
 - Discard all material removed from the drainage channel.
 - When backfilling the planting pit, add coarse gravel to the drainage channel. Also, care must be taken to keep the consistency of the soil mix the same throughout the planting pit.
- Refer to the Wawa Landscape Specification Book and the Wawa Irrigation Specification Book for Figures, Appendices and additional information.

Landscape Data

(5.9.1) Parking Lot Landscape Buffer Along Frontage (Becker Road - 88 I.F.)
 Fuel Station, Parking & Storm Water Buffer Trees
 Required - (1 Type B Tree/20 I.F.) - 88 I.F./20 = 4 Trees
 Provided - 4 Trees

Hedge
 Required - 1 Shrub / 2' O.C. = 44 Shrubs
 Provided - 44 Shrubs

Shrubs
 Required - 1 Shrub / 4 L.F. = 22 Shrubs
 Provided - 22 Shrubs

Ground Covers
 Required - 1 G.C. / 2 L.F. = 44 Ground Covers
 Provided - 44 Ground Covers

(5.6) Perimeter Landscaping Adjacent to Becker Road Right-of-way (275 I.F. x 30' Width)
 Trees
 Required - (1 Tree/40 I.F.) - 275 I.F./40 = 7 Trees
 Provided - 7 Trees

Shrubs
 Required - 1 Shrub / 6 L.F. = 46 Shrubs
 Provided - 46 Shrubs

Shrubs
 Required - 1 Shrub / 3 L.F. = 92 Shrubs
 Provided - 92 Shrubs

Ground Covers
 Required - 1 G.C. / 2 L.F. = 138 Shrubs
 Provided - 142 Shrubs

(5.9.1) Parking Lot Landscape Buffer Along Frontage (PSL Blvd - 30' Width)
 Fuel Station, Parking & Storm Water Buffer Trees
 Required - (1 Type B Tree/20 I.F.) - 229 I.F./20 = 12 Trees
 Provided - 15 Trees

Hedge
 Required - 1 Shrub / 2' O.C. = 115 Shrubs
 Provided - 115 Shrubs

Shrubs
 Required - 1 Shrub / 4 L.F. = 58 Shrubs
 Provided - 58 Shrubs

Ground Covers
 Required - 1 G.C. / 2 L.F. = 115 Ground Covers
 Provided - 115 Ground Covers

(5.6) Perimeter Landscaping Adjacent to PSL Blvd Right-of-way (315 I.F. x 30' Width)
 Trees
 Required - (1 Tree/40 I.F.) - 110 I.F./40 = 8 Trees
 Provided - 8 Trees

Shrubs
 Required - 1 Shrub / 6 L.F. = 55 Shrubs
 Provided - 55 Shrubs

Shrubs
 Required - 1 Shrub / 3 L.F. = 105 Shrubs
 Provided - 105 Shrubs

Ground Covers
 Required - 1 G.C. / 2 L.F. = 158 Shrubs
 Provided - 172 Shrubs

Perimeter Landscaping Adjacent to Another Property
 Trees
 Required: (1 Tree/30 I.F.) - 586 I.F./30 = 20 Trees
 Provided: 20 Trees

Shrubs
 Required: Continuous Hedge 2' O.C. = 293 Shrubs
 Provided: 300 Shrubs

Plant List

QTY	SYM	SPECIES	COMMON NAME/DESCRIPTION	SIZE	SPACING	REMARKS	DROUGHT TOLERANCE
CANOPY / ORNAMENTAL TREES							
11	IE*	ILEX ATTEMUATA 'EAGLESTON'	EAGLESTON HOLLY	12' x 5', 2.5' CAL.	A.S.	FULL CANOPY, 4' C.T. MIN.	HIGH
8	LI*	LAKESIIFROEMIA INDICA 'TUSKEGEE'	CREPE MYRTLE REEF	12' x 6', 2.5' CAL.	A.S.	FULL CANOPY, 4' C.T. MIN.	HIGH
8	MG*	MAGNOLIA GRANDIFLORA	LITTLE GEM MAGNOLIA	12' x 5', 2.5' CAL.	A.S.	FULL CANOPY, 4' C.T. MIN.	HIGH
6	MG-1*	MAGNOLIA GRANDIFLORA	SOUTHERN MAGNOLIA D.D. BLANCHARD	12' x 5', 2.5' CAL.	A.S.	FULL CANOPY, 4' C.T. MIN.	HIGH
11	PE*	PINUS ELLIOTTI DENSE	SOUTH FLORIDA SLASH PINE	12' x 5', 2.5' CAL.	A.S.	FULL CANOPY, 4' C.T. MIN.	HIGH
13	QV-1*	QUERCUS VIRGINIANA	LIVE OAK	16' x 6', 3.5' CAL.	A.S.	FULL CANOPY, 5' C.T. MIN.	HIGH
18	QV*	QUERCUS VIRGINIANA	LIVE OAK	12' x 5', 2.5' CAL.	A.S.	FULL CANOPY, 4' C.T. MIN.	HIGH
1	TD*	TAXODIUM DISTICHUM	BALD CYPRESS	12' x 5', 2.5' CAL.	A.S.	FULL CANOPY, 4' C.T. MIN.	HIGH
PALMS							
3	PS	PHOENIX SYLVESTRIS	SYLVESTER PALM	8' C.T.	A.S.	MATCHED FULL SYMMETRICAL.	HIGH
30	SP*	SABAL PALMETTO	SABAL PALM	12' C.T.	A.S.	SUCK TRUNKS	HIGH
HEDGES / SHRUBS / GROUNDCOVERS / VINES							
60	CES*	CONOCARPUS ERECTUS VAR. SERICEUS	SILVER BUTTOMWOOD	#3, 2' x 2'	2' O.C.	FULL & THICK	HIGH
563	FO3*	FORESTERA SEGREGATA	FLORIDA PRIVET	#3, 2' x 2'	2' O.C.	FULL & THICK	HIGH
415	MUC*	MUHLENBERGIA CAPILLARIS	MUHLY GRASS	#3, 2' x 2'	2.5' O.C.	FULL & THICK	HIGH
60	MYR-1*	MYRICANTHES FRAGRANS	SIMPSON STOPPER	#7, 4' x 2'	2' O.C.	FULL & THICK	HIGH
145	MYR-2*	MYRICANTHES FRAGRANS	SIMPSON STOPPER	#7, 3' x 2'	2' O.C.	FULL & THICK	HIGH
LOW SHRUBS / GROUNDCOVERS / VINES							
325	BOD	BOUGAINVILLEA DWARF HELEN JOHNSON*	DWARF HELEN JOHNSON BOUGAINVILLEA	#3, 12" x 12"	24" O.C.	FULL & THICK	HIGH
520	FGI	FIGUS MICROCARPA 'GREEN ISLAND'	GREEN ISLAND FIGUS	#3, 12" x 12"	24" O.C.	FULL & THICK	HIGH
80	FGI-1	FIGUS MICROCARPA 'GREEN ISLAND'	GREEN ISLAND FIGUS	#3, 12" x 12"	24" O.C.	FULL & THICK	HIGH
200	LAC*	LANTANA CAMARA 'GOLD MOUND'	GOLD MOUND LANTANA	#1, 8" x 12"	24" O.C.	FULL & THICK	HIGH
515	ILV*	ILEX VOMITORIA	DWARF YAUPOIN HOLLY	#3, 12" x 12"	24" O.C.	FULL & THICK	HIGH
200	NEB*	NEPHELOPSIS EXALTATA	BOSTON FERN	#1, 12" x 12"	24" O.C.	FULL & THICK	HIGH
SOD-1		PASPALUM NOTATUM	BAHIA SOD	SEE SPECS			HIGH
SOD		STENOTAPHRUM SECUNDATUS	ST. AUGUSTINE SOD	SEE SPECS			LOW - MEDIUM
** FLORIDA NATIVE							

Landscape Details

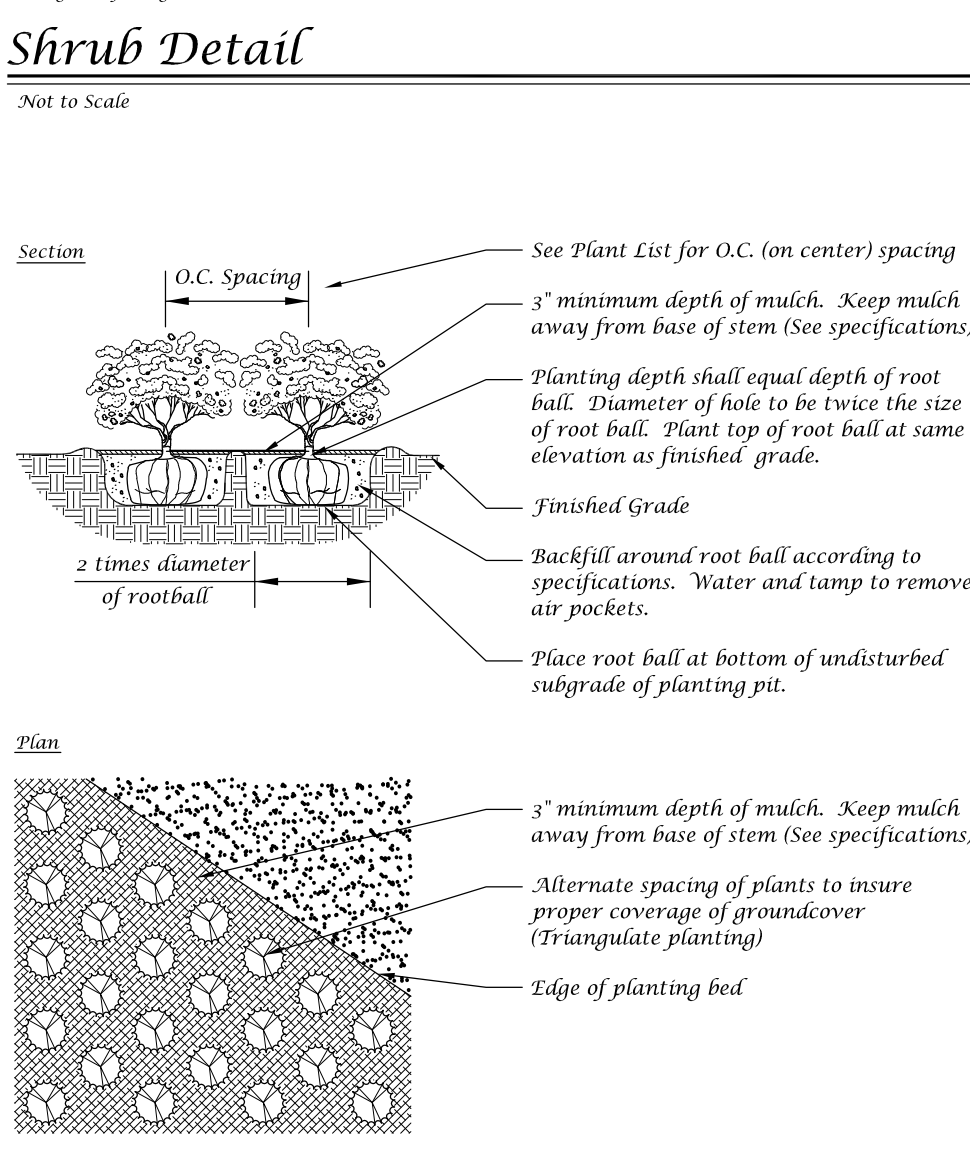
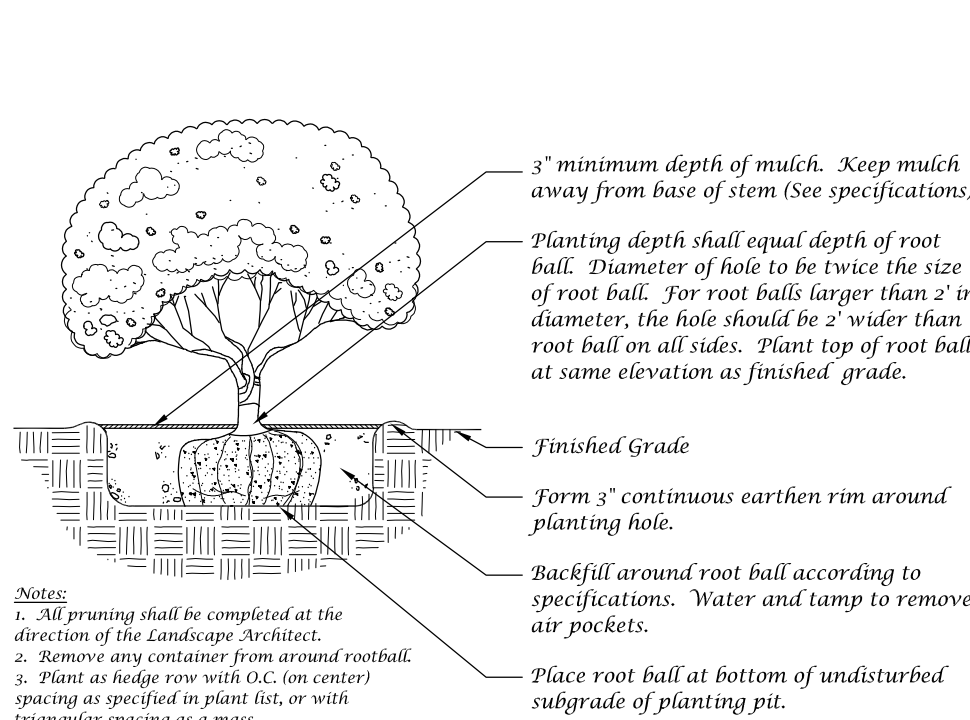
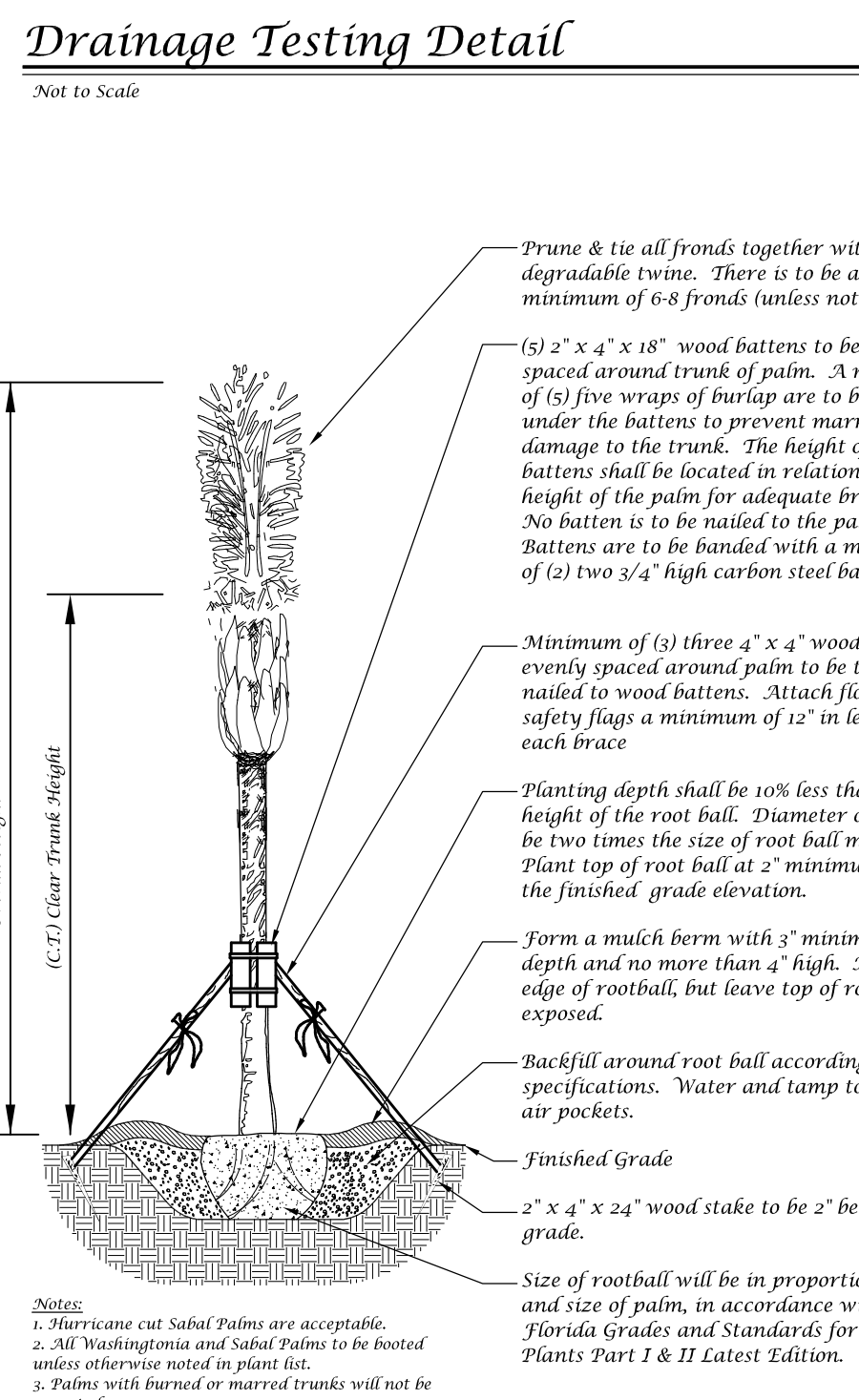
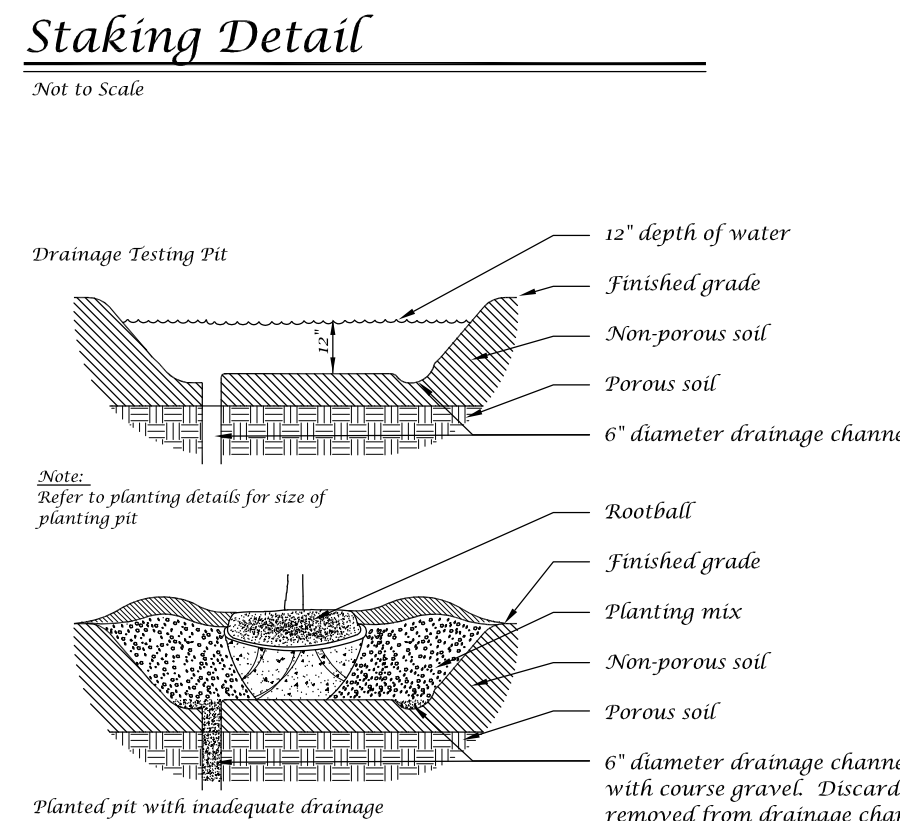
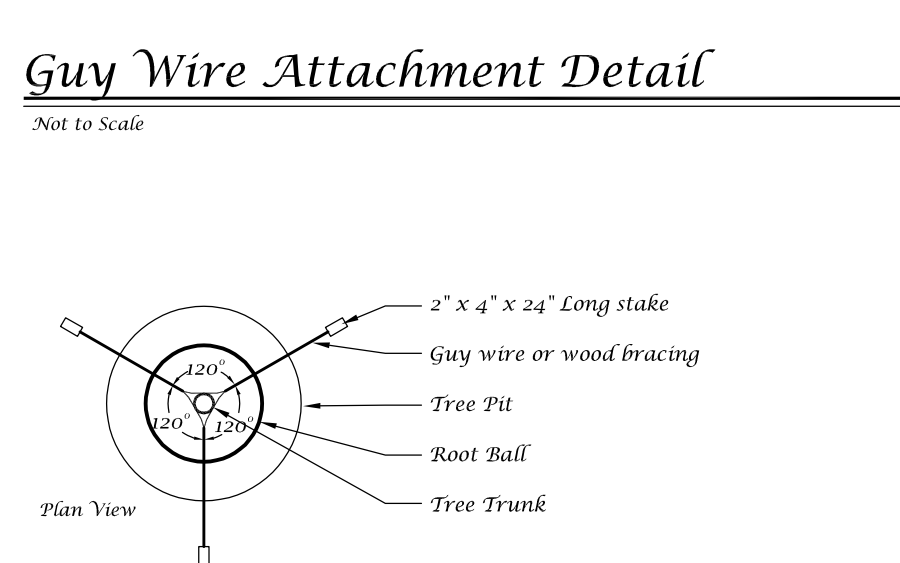
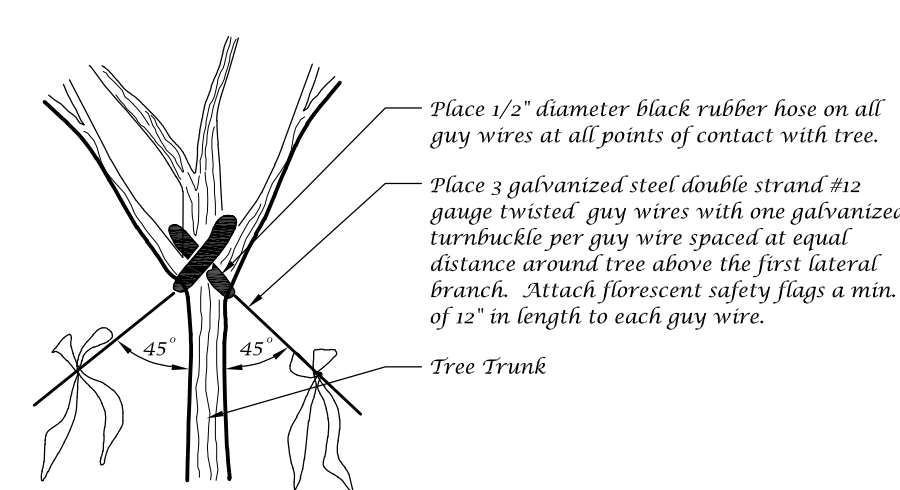
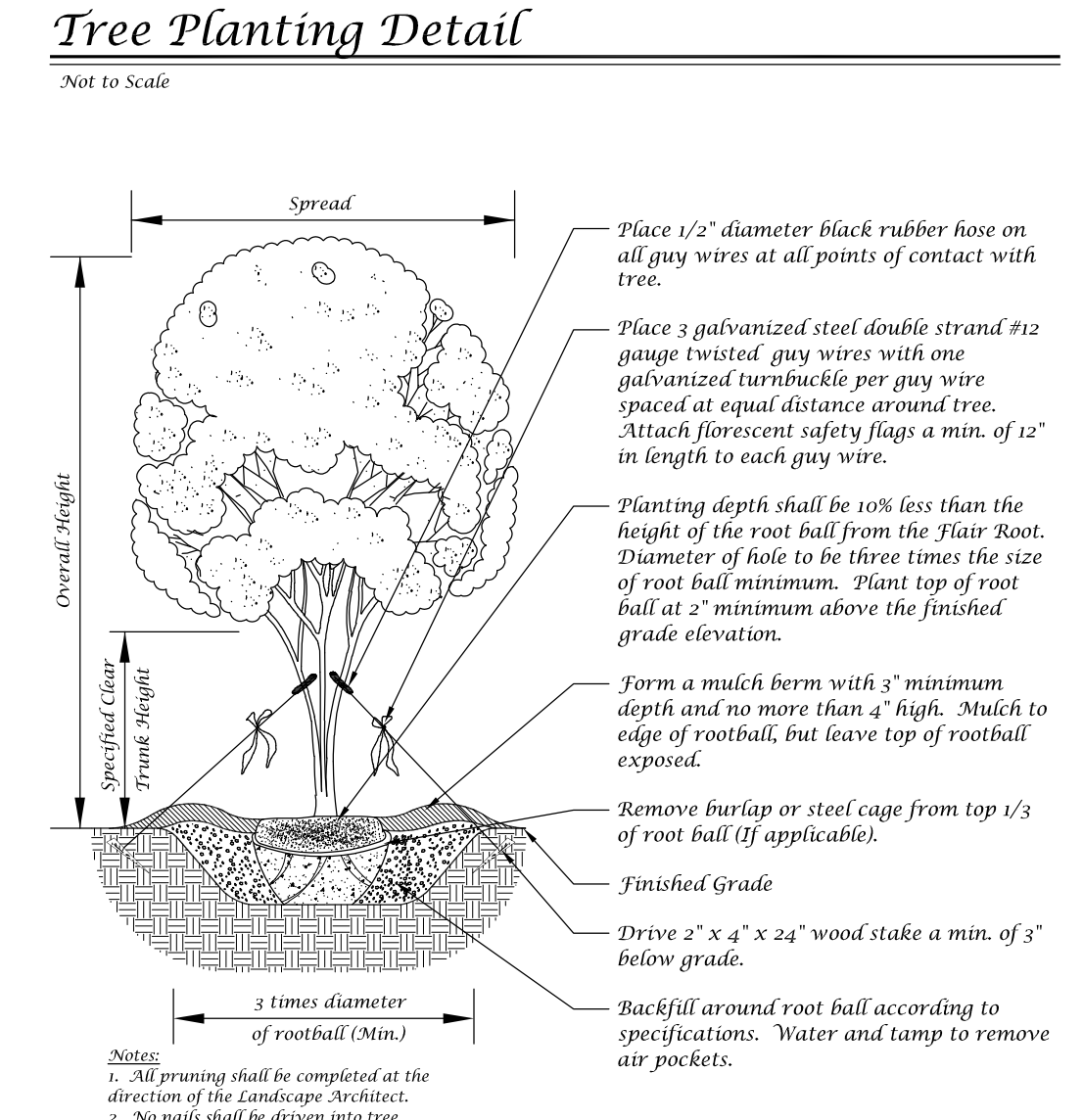
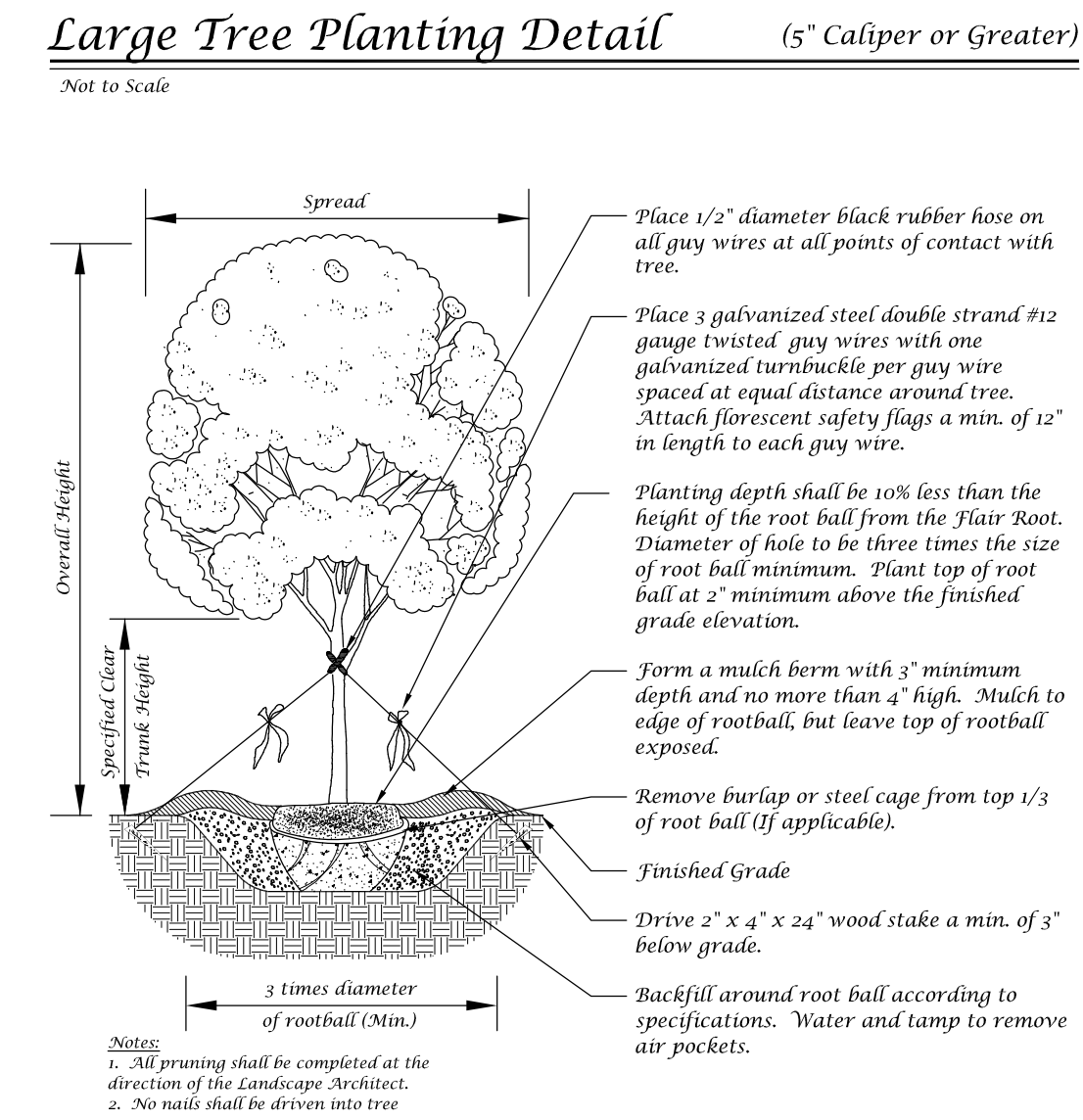
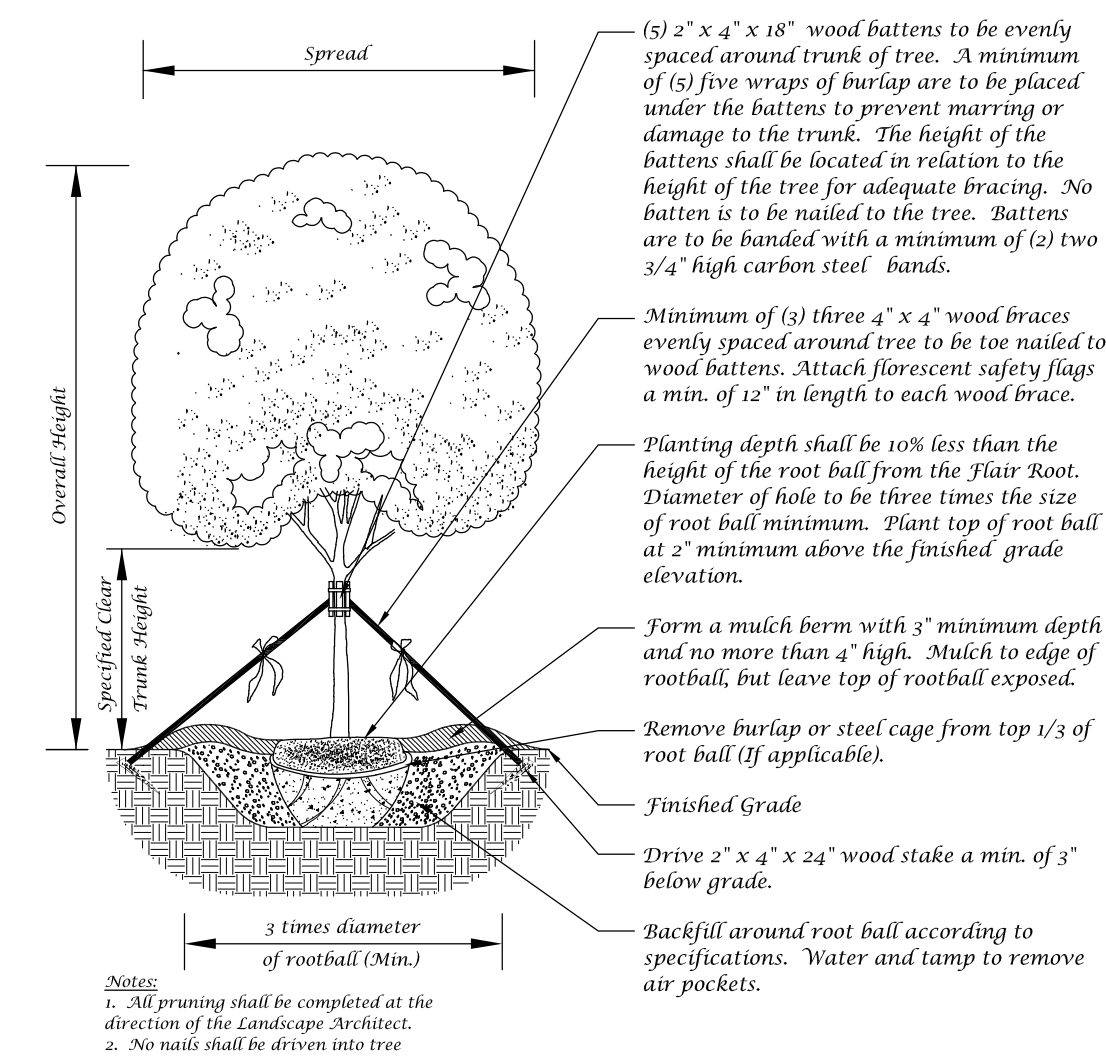

Conceptual Design Group, Inc.
 Landscape Architecture - Site Planning
 900 East Ocean Boulevard, Suite 1300
 Stuart, Florida 34994
 (772) 344-2340
 LA-0001635

Wawa
 Port St. Lucie Boulevard & Becker Road
 City of Port St. Lucie, Florida

Jeffrey W. Smith, RLA
 Florida Registration Number: LA 0001635

Job No. 21-1204
 Drawn By JWS
 Submitted Dates 1-4-2022
 5-2-2022 10-12-2022
 11-17-2022 1-5-2023

Revision Dates 5-2-2022
 New Base 10-12-2022
 City Comments 11-17-2022
 City Comments 1-5-2023

These drawings are the property of the landscape architect and are not to be used for other projects except by written permission from the landscape architect. Report any discrepancies immediately to the landscape architect.

PSLUSD Project Number: 11-447-00
 Sheet L-2 of 3
 City Project Number: P22-005 G P22-006

General Notes, Plant List, Landscape Data & Landscape Details

