

Symbols Legend

- | | | | |
|-----------|---|--------|-------------------------|
| D.E. | DRAINAGE EASEMENT | O.E. | OVERHANG EASEMENT |
| L.M.E. | LAKE MAINTENANCE EASEMENT | G.E. | GRADING EASEMENT |
| L.M.A.E. | LAKE MAINTENANCE ACCESS EASEMENT | PSL | PORT ST LUCIE |
| R.O.W. | RIGHT OF WAY | L.E. | LANDSCAPE EASEMENT |
| U.E. | UTILITY EASEMENT | D.S.E. | DRAINAGE SWALE EASEMENT |
| U.E.-R.A. | UTILITY EASEMENT - RESTRICTED AREA (SEE "U.E." PLAT DEDICATION) | O.S. | OPEN SPACE |
| STM | STORM SEWER LINE WITH MANHOLE | — | SIGN |
| STM | STORM SEWER LINE WITH CATCH BASIN | ① | LOT NUMBER |
| SAN | SANITARY SEWER LINE WITH MANHOLE | — | FIRE HYDRANT |
| WM | WATER MAIN | | |
| — | WATER SVC. TO LOT WITH METER W.M. | | |
| — | SANITARY SVC. TO LOT WITH CLEANOUT C.O. | | |

Planting Details

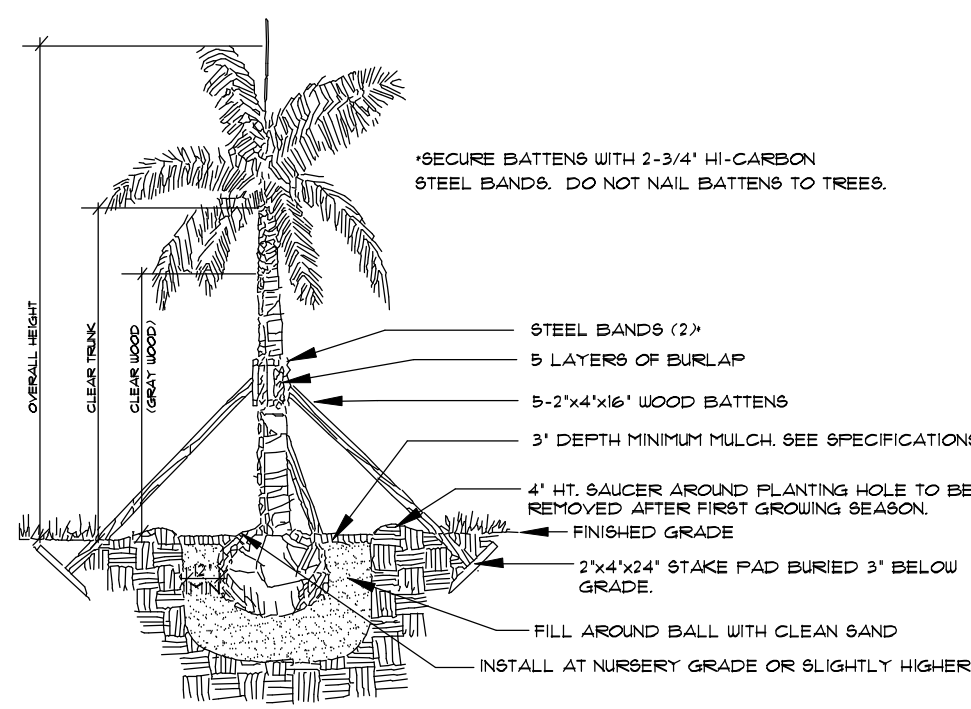
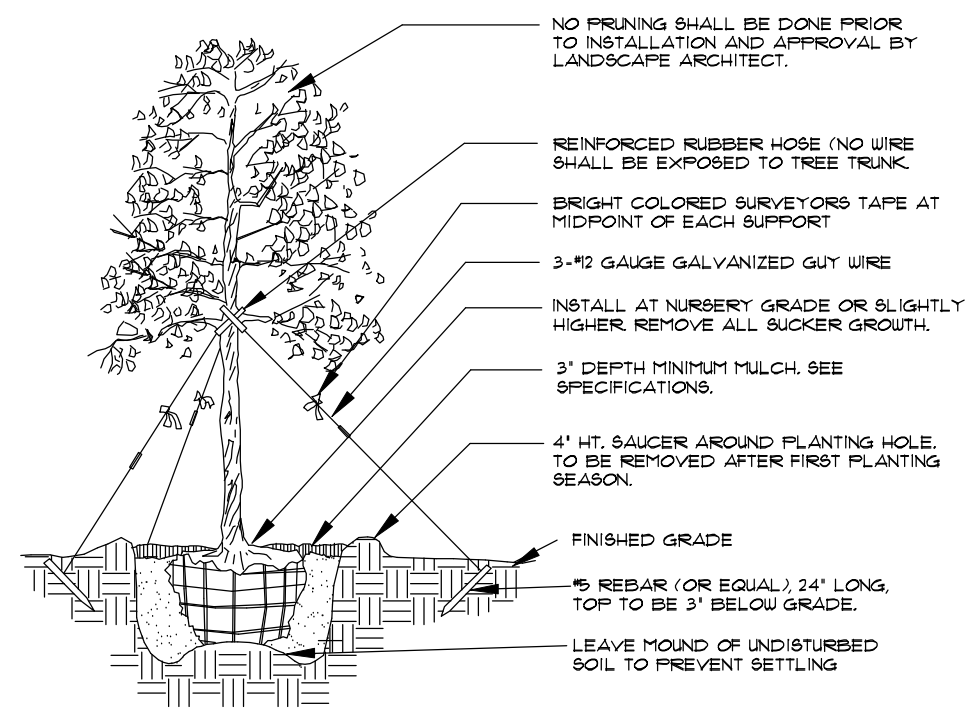

Tree Planting

SEE SPECIFICATIONS FOR BACKFILL MIXTURE AND FERTILIZATION

BRACING - SPECIAL SITE CONDITIONS MAY REQUIRE MODIFICATION TO BRACING TECHNIQUE

LANDSCAPE CONTRACTOR WILL ADEQUATELY BRACE (OR WIRE) ALL TREES TO PREVENT EXCESSIVE MOVEMENT & MAINTAIN A VERTICAL POSITION.

Palm Planting

APPLIES TO: ROYAL PALMS, QUEEN PALMS, ALEXANDER PALMS, FOXTAIL PALMS

SEE SPECIFICATIONS FOR BACKFILL MIXTURE AND FERTILIZATION

BRACING - SPECIAL SITE CONDITIONS MAY REQUIRE MODIFICATION TO BRACING TECHNIQUE. LANDSCAPE CONTRACTOR WILL ADEQUATELY BRACE ALL PALMS TO PREVENT EXCESSIVE MOVEMENT AND MAINTAIN A VERTICAL POSITION.

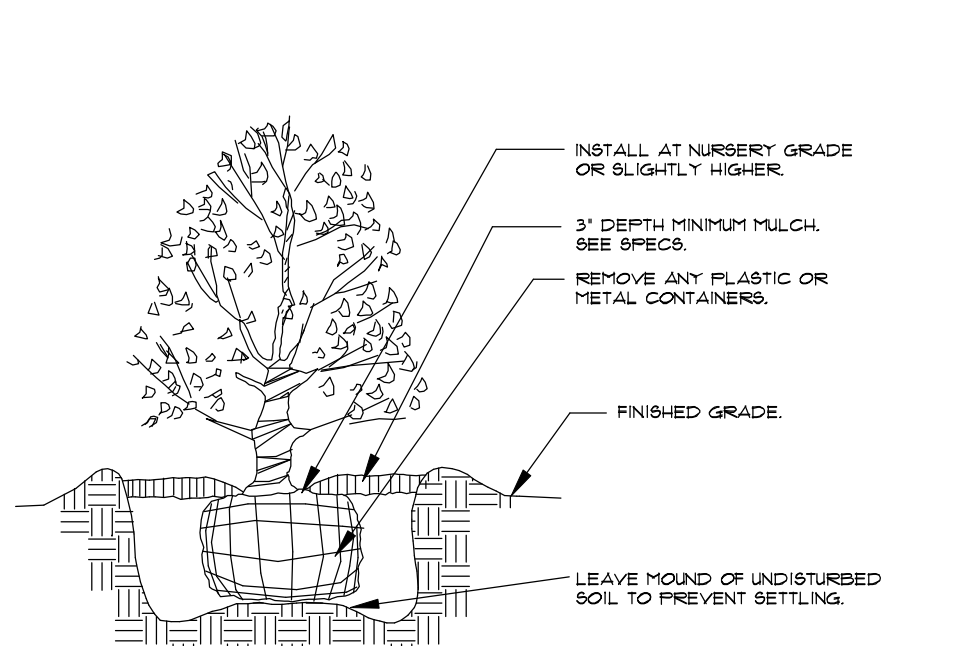
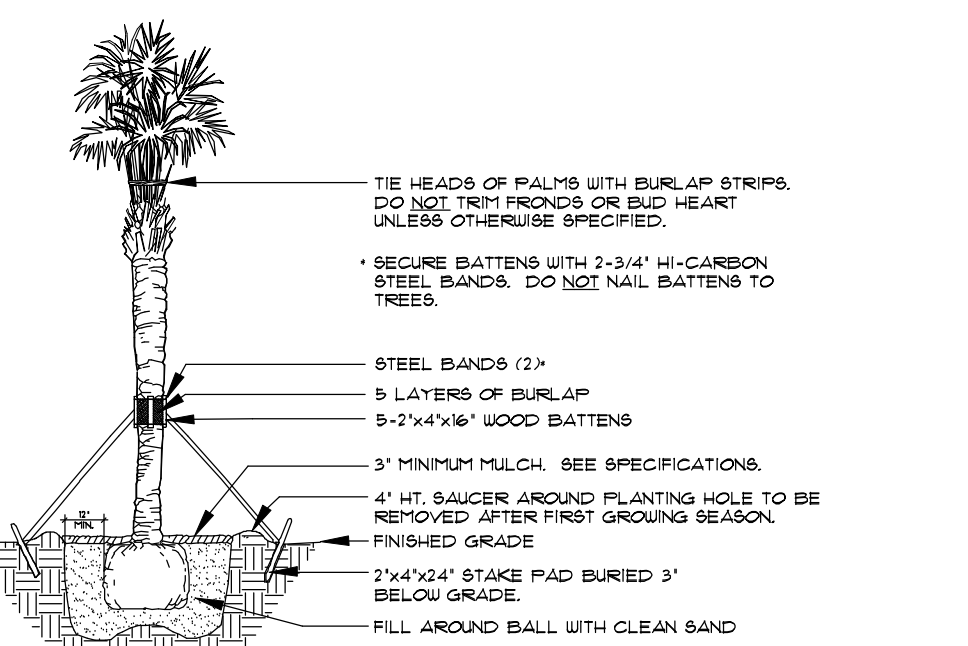

Palm Planting

APPLIES TO: BABAL PALMS, WASHINGTON PALMS, CANARY ISLAND DATE PALMS, SENEGAL DATE PALMS

SEE SPECIFICATIONS FOR BACKFILL MIXTURE AND FERTILIZATION

Shrub Planting

SEE SPECIFICATIONS FOR BACKFILL MIXTURE AND FERTILIZATION

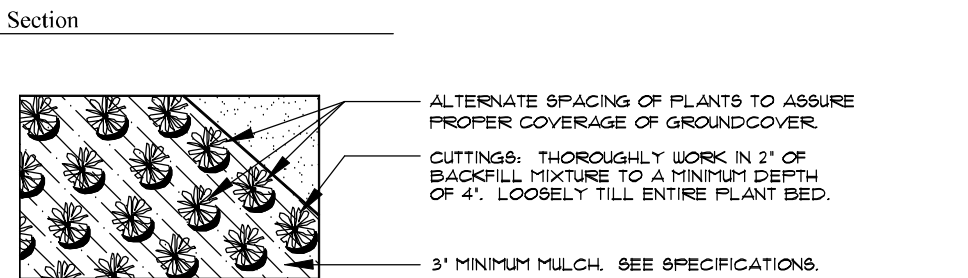
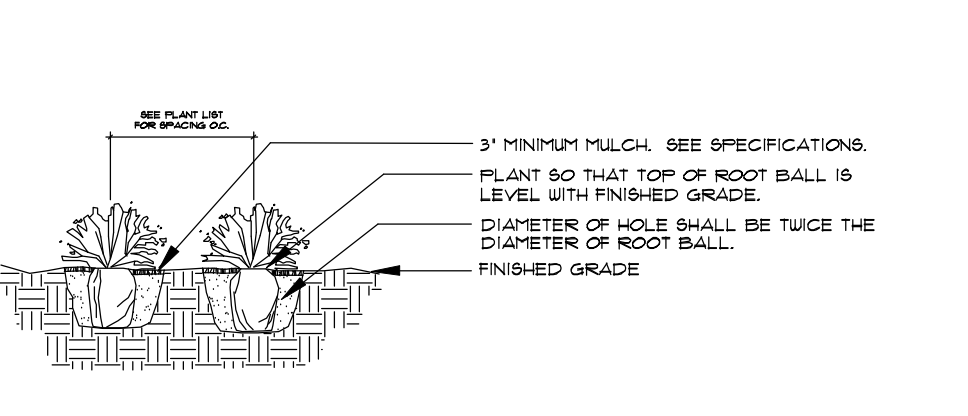

Groundcover Planting

SEE SPECIFICATIONS FOR BACKFILL MIXTURE AND FERTILIZATION

RIVERLAND BOULEVARD AT RIVERLAND PASEO OVERPASS

(RIVERLAND MPUD) PLANTING PLANS

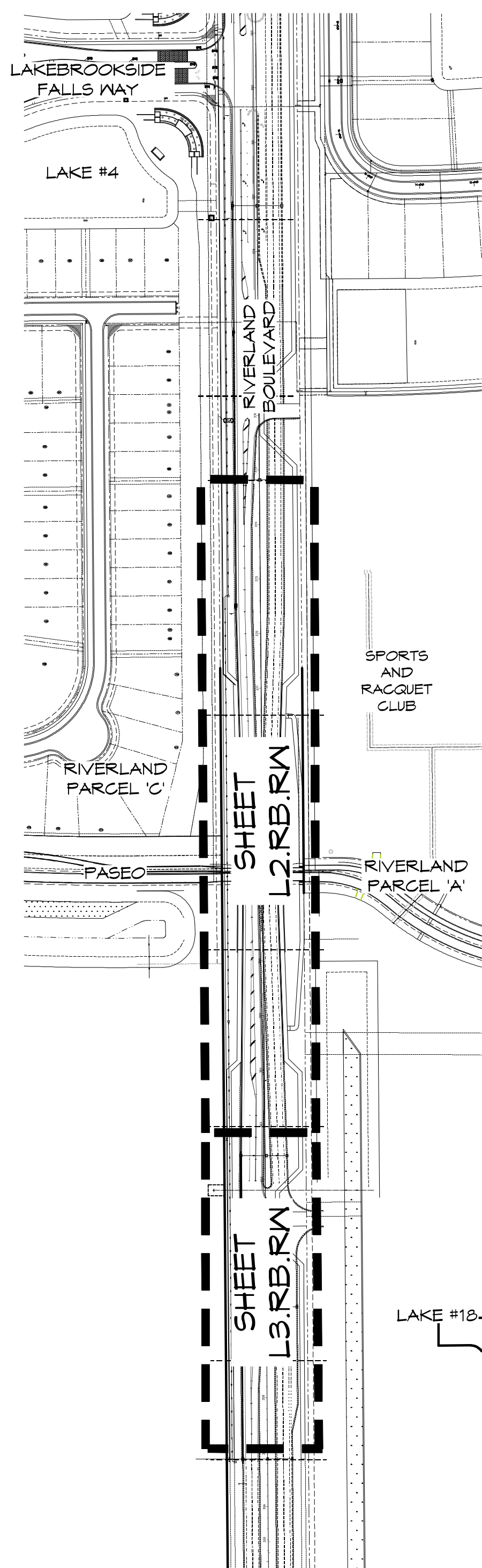

Planting Plans for:

- Sheet L1.RB.RW COVER SHEET, DETAILS, AND SPECIFICATIONS
- Sheet L2.RB.RW RIVERLAND BOULEVARD R.O.W. PLANTING PLAN
- Sheet L3.RB.RW RIVERLAND BOULEVARD R.O.W. PLANTING PLAN

PSLUD Notes:

- LANDSCAPE PLANS SHALL BE SUBMITTED FOR THE PROJECT INDICATING THE LOCATION OF LANDSCAPE AREAS, PERIMETER WALLS, FOUNDATIONS, BERRIS, TREE WELLS, FENCES, GATES, SIGNS, DECORATIVE ROCKS, SCULPTURE, FOUNTAINS, AND ANY OTHER FEATURES THAT MAY INFLUENCE THE LOCATION OF WATER / WASTEWATER / RECLAIMED WATER FACILITIES. ALSO, EXISTING AND PROPOSED WATER / WASTEWATER / RECLAIMED FACILITIES, AND RIGHT-OF-WAY, LOT LINES AND ALL EASEMENT INFORMATION, SHOWING OFFICIAL RECORD BOOK AND PAGE NUMBER SHALL BE INCLUDED. THE PLANS SHALL INCLUDE AND CONFIRM TO THE FOLLOWING STANDARD NOTES:
- ALL LANDSCAPING WITHIN PSLUD UTILITY EASEMENTS AND WITHIN 10' OF PSLUD INFRASTRUCTURE SHALL COMPLY WITH CHAPTER 154 OF THE CITY'S CODE OF ORDINANCES AND PSLUD UTILITY STANDARDS.
 - NO LANDSCAPING SHALL BE PLANTED IN SUCH A MANNER AS TO ADVERSELY AFFECT UTILITY INSTALLATION, OPERATION, OR MAINTENANCE.
 - NO LANDSCAPING OTHER THAN 60D GRASSES MAY BE PLANTED WITHIN A 5' RADIUS MAINTENANCE AREA OF ANY PSLUD APPURTENANCE SUCH AS WATER METERS, BACKFLOW DEVICES, FIRE HYDRANTS, SANITARY SEWER CLEANOUTS, MANHOLES, AIR RELEASE VALVES, ETC. WITH THE EXCEPTION OF FOXTAIL PALMS. TREES SHALL NOT BE PLANTED WITHIN 10' OF ANY PSLUD INFRASTRUCTURE. AS SPECIFICALLY APPROVED BY THE PSLUD, FOXTAIL PALMS MAY BE A DISTANCE NOT LESS THAN SEVEN (7) FEET OF ANY PSLUD INFRASTRUCTURE. ALL MEASUREMENTS ARE FROM OUTSIDE TO OUTSIDE, NOT CENTERLINE TO CENTERLINE. EXAMPLE: OUTSIDE OF PIPE TO NEAREST POINT ON TREE TRUNK.
 - TREES SHALL NOT BE PLANTED WITHIN TEN (10) FEET OF ANY PSLUD MAINS OR APPURTENANCES (UNLESS OTHERWISE APPROVED BY PSLUD).
 - UTILITY & DRAINAGE EASEMENTS TO REMAIN CLEAR OF TREES.

Plant Specifications

SPECIES AND SIZE shall conform to those indicated on the drawings. Nomenclature shall conform to STANDARDIZED PLANT NAMES, current edition. All nursery stock shall be in accordance with Florida Grades and Standards for Nursery Plants, latest edition published by the Florida Department of Agriculture and Consumer Services. All plants not otherwise specified as being Florida Fancy or Specimen shall be Florida Grade Number 1 or better as determined by the Florida Division of Plant Industry. Specimen means an exceptionally heavy, symmetrical, tightly knit plant, so trained or favored in its development that first appearance is unquestionable and outstandingly superior in form, number of branches, compactness and symmetry.

GENERAL REQUIREMENTS

All plants shall be freshly dug, sound, healthy, vigorous, well branched, and free of disease and insect eggs and larvae, and shall have adequate root systems. Trees for planting shall be uniform in size and shape. All materials shall be subject to approval by the Landscape Architect. Where any requirements are omitted from the plant list, the plants furnished shall be normal for the variety. Plants shall be pruned prior to delivery only upon the approval of the Landscape Architect.

CONTAINER GROWN STOCK

All container grown material shall be healthy, vigorous, well rooted plants, and established in the container in which they are sold. The plants shall have tops which are good quality and in a healthy growing condition. An established container grown plant shall be grown in that container sufficiently long enough for the root fibrous roots to have developed so that the root mass will retain its shape and hold together when removed from the container. Plant root bound in containers are unacceptable.

MEASUREMENTS

Trees: Height shall be measured from ground to the top most portion of the tree. Small, multi-trunked trees are measured to the top of main body of the crown. Spread shall be measured to the end of branching equally around the crown from the center of the trunk. Measurements are not to include any terminal growth. Single trunk trees shall be free of "Y" crotches that could be points of weak limb structure or disease infestation.

Shrubs: Heights shall be measured from the ground to the average points where mature plant growth occurs. Spread shall be measured to the end of branching equally around the shrub mass. Measurements are not to include any terminal growth.

Palms: Clear Trunk (C.T.) shall be measured from the ground at the time of installation to the point where the mature aged trunk joins the immature or green portion of the trunk or the head.

Overall Height (O.H.) shall be measured from the ground at the time of installation to a point three quarters the length of the unopened bud. Palms with nipped or burned trunks will not be accepted.

SOIL

Planting soil for use in preparing backfill for plant pits shall be free from heavy clay, stones, lime plants, roots or other foreign materials or noxious grasses (such as Bermuda or nut grass) and noxious weeds. It shall not contain toxic substances which may be harmful to plant growth.

COMMERCIAL FERTILIZERS

Two fertilizer shall be used in all types of plantings, except palms. Granular fertilizer shall be uniform in composition, dry and free flowing. This fertilizer shall be delivered to the site in the original unopened bags, each bearing the manufacturer's statement of analysis, and shall meet the following requirements: sixteen (16%) percent nitrogen, seven (7%) percent phosphorus, twelve (12%) percent potassium, plus iron. Tablet fertilizer ("Agriform" or equal) in 21 gram size shall meet the following requirements: twenty (20%) percent nitrogen, ten (10%) percent phosphorus, five (5%) percent potassium.

The two fertilizers will be applied at the following rates:

PLANT SIZE	16-17-12	"AGRIFORM" TABLET (21 Grams)
1 gal.	1/4 lb.	1
3 gal.	1/3 lb.	2
7-15 gal.	1/2 lb.	4
1'-6" caliper	2 lbs./1" caliper	2 1/2" caliper
6" and larger	3 lbs./1" caliper	2 1/2" caliper

"Florida East Coast Palm Special" will be applied to all palms at installation at a rate of 1/2 lb. per inch of trunk caliper unless otherwise specified.

MULCH

Mulch material shall be three (3) inches of shredded melaleuca mulch (sterilized and free of seeds) or approved equal, moistened at the time of application to prevent wind displacement.

SUBSTITUTIONS

No substitutions of plant material types or size will be allowed without written consent of the Landscape Architect. B4B material will not be accepted as substitute for container grown material unless previously approved. Alternate substitutions shall be indicated in bid.

PARKER-YANNETTE
design group, inc.

LANDSCAPE ARCHITECTURE
PLANNING • GRAPHICS

4425 Military Trail, Suite 202
Suite 330
Jupiter, Florida 33458

Telephone: (561) 747-5069
Fax: (561) 747-2041
Email: mail@pydg.com
License #LA-0001347

RIVERLAND BOULEVARD AT RIVERLAND PASEO OVERPASS
PORT ST. LUCIE, FLORIDA
COVER SHEET

DATE: 11.17.20
DRAWN BY: AJO/MAY
JOB NO.: 17-077
SCALE:
FILENAME: RYR.MHOA

REVISIONS:

01.14.21 Safe sight triangle
2.18.21 Shift walk
2.23.21 Add street light

EXTENT OF THIS SUBMITTAL - SEE RIVERLAND BOULEVARD AT PARCEL C PLANS, SHEET L4.RB.RW

MATCH LINE 'G' - SEE BELOW LEFT

PLANT LIST - SHEET L2.RB.RW

BAU12	Bauhinia blakeana / Hong Kong Orchid	12' x 6', 9' cal., full canopy	6
BB16	Bulbocuceras 'Shady Lady' / Black Olive	16' ht. x 8' spr., 3" cal., full canopy, B & B	9
BB30	Bulbocuceras / Black Olive	30' x 30', 11" cal., full canopy	2
CAL10	Calliandra haematocephala / Powder Puff	10' ht., full canopy	2
QV12	Quercus virginiana / Live Oak	12' x 6', 2.5" cal., full canopy	36
QV30	Quercus virginiana / Live Oak	30'-35' x 22'-25', 12-14" cal., straight trunk, full canopy	2
PALMS			
LC6	Livistona chinensis / Chinese Fan Palm	8' o.a., multi-stem, full frond	25
LC6	Livistona chinensis / Chinese Fan Palm	8' o.a., multi-stem, full frond	24
SP5	Sabal palmetto / Cabbage Palm	10' - 22' c.t. hts., staggered hts., hurricane cut, slick trunk, straight trunk	76
VM16	Voitokia montgomeryana / Montgomery Palm	16' c.t., triple stem, full heads, single, straight, unscarred trunks	4
MB14	Poddytia bifurcata / Foxtail Palm	14' c.t., heavy cal., full frond	10
SHRUBS, ACCENTS, AND GROUND COVER			
AR	Acalypha wilkesiana 'Marginata' / Copperleaf	9 gal., 22" x 22", full	609
CFX	Cordyline frutescens 'Xerox'	9 gal., 22" x 20", full	64
MH4	Muhlenbergia capillaris / Muhly Grass	9 gal., 22" x 10", full, purple flower	1,407
SAT	Schefflera arboricola 'Trinette' / Variegated Dwarf Schefflera	9 gal., 22" x 20", full	641
SOD	Stenotaphrum secundatum / St. Augustine Floratam	Solid sod, laid light, Qty in SF	
BAHA SOD	Paspalum notatum / Bahiá Grass	Solid sod, laid light, Qty in SF	
MULCH	Chocolate Mulch	2" Thick 'A' Grade Raw Wood Mulch, CHOCOLATE color - BID PER CY	
** TREES SPACED AT 40' TYPICAL, MAXIMUM 50' TREE SPACING IN THE EVENT OF INFRASTRUCTURE CONFLICTS			

NOTE: ALL PLANT MATERIAL SHALL MEET OR EXCEED SIZE AND CONTAINER SPECIFICATIONS IN PLANT LIST. PLANT MATERIALS NOT MEETING SPECIFICATION WILL BE REJECTED. CONTRACTOR TO COORDINATE AVAILABILITY ISSUES WITH OWNER PRIOR TO COMMENCING WORK.

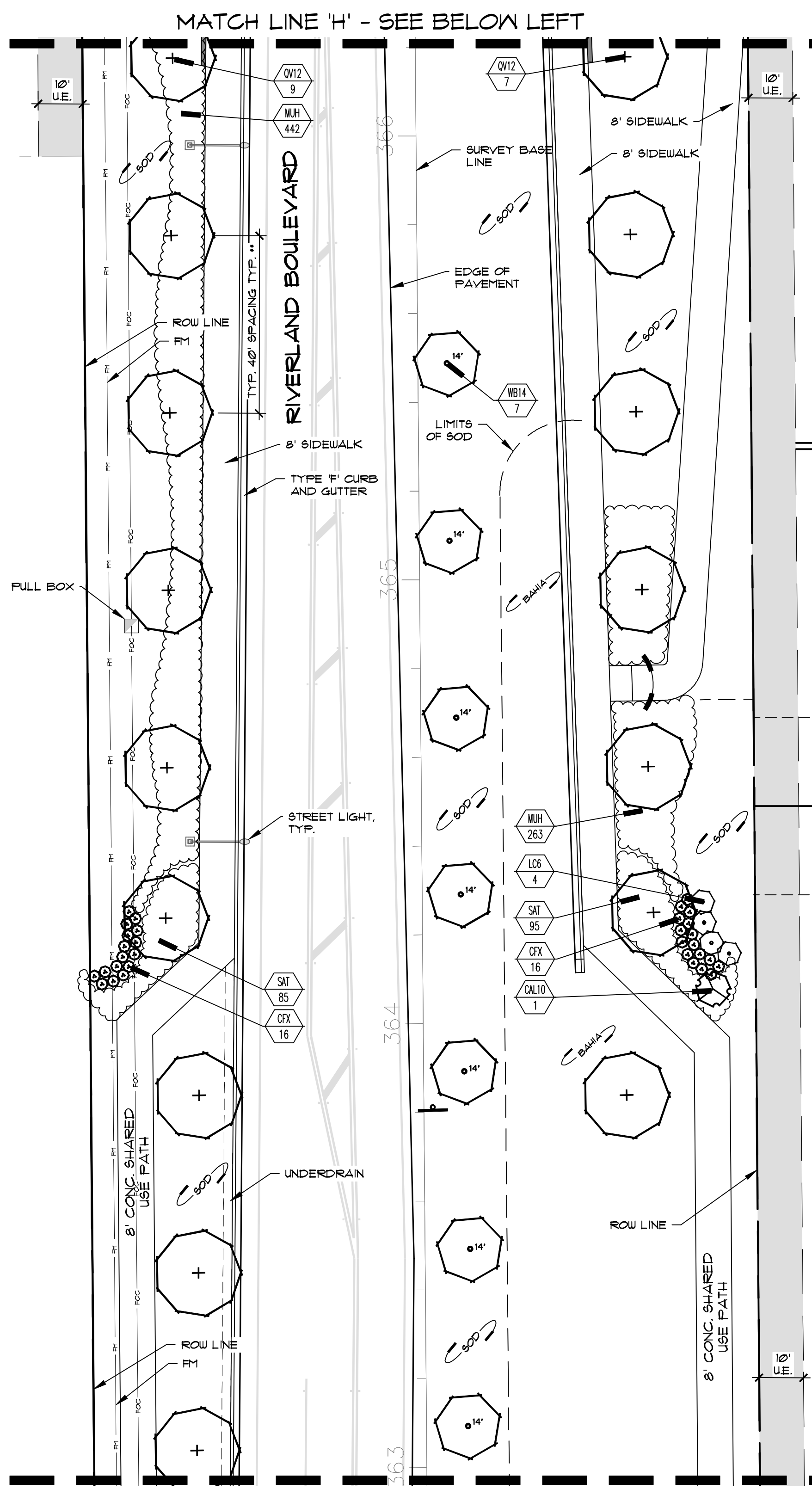
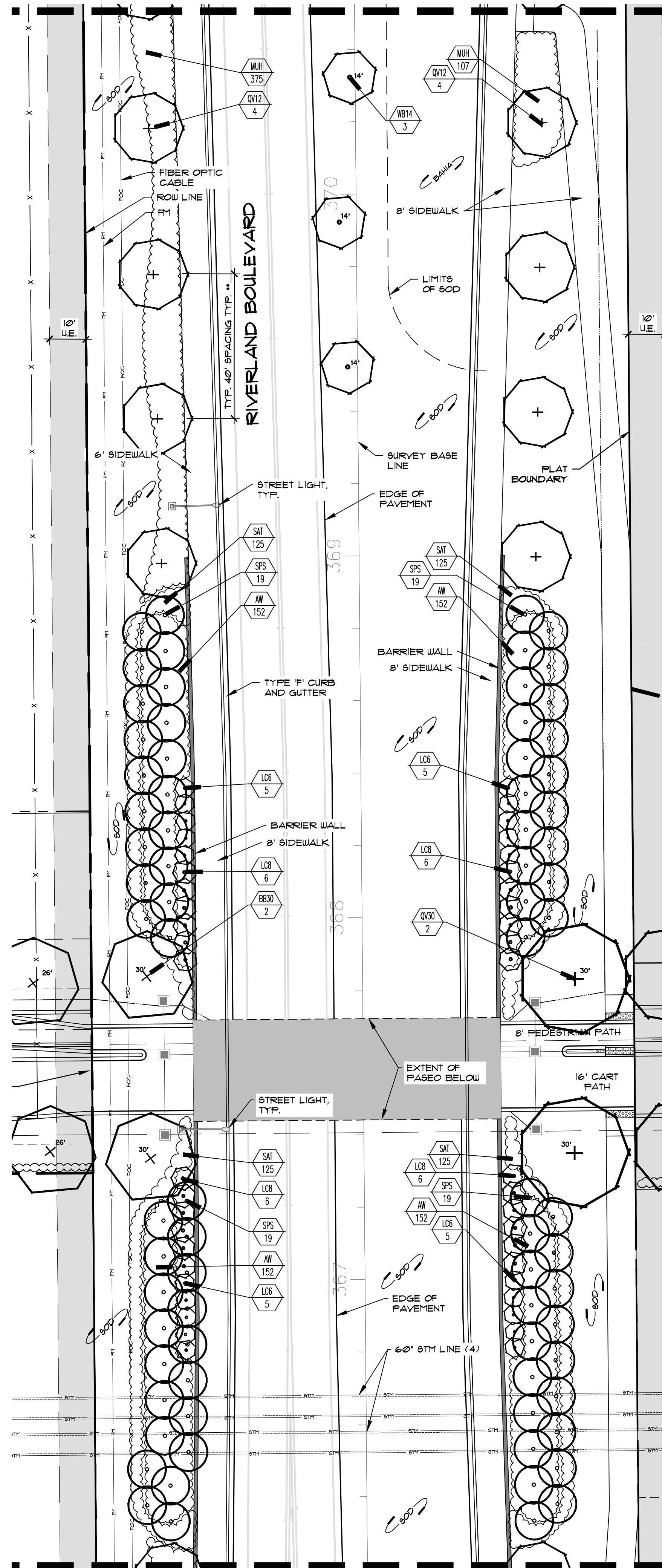
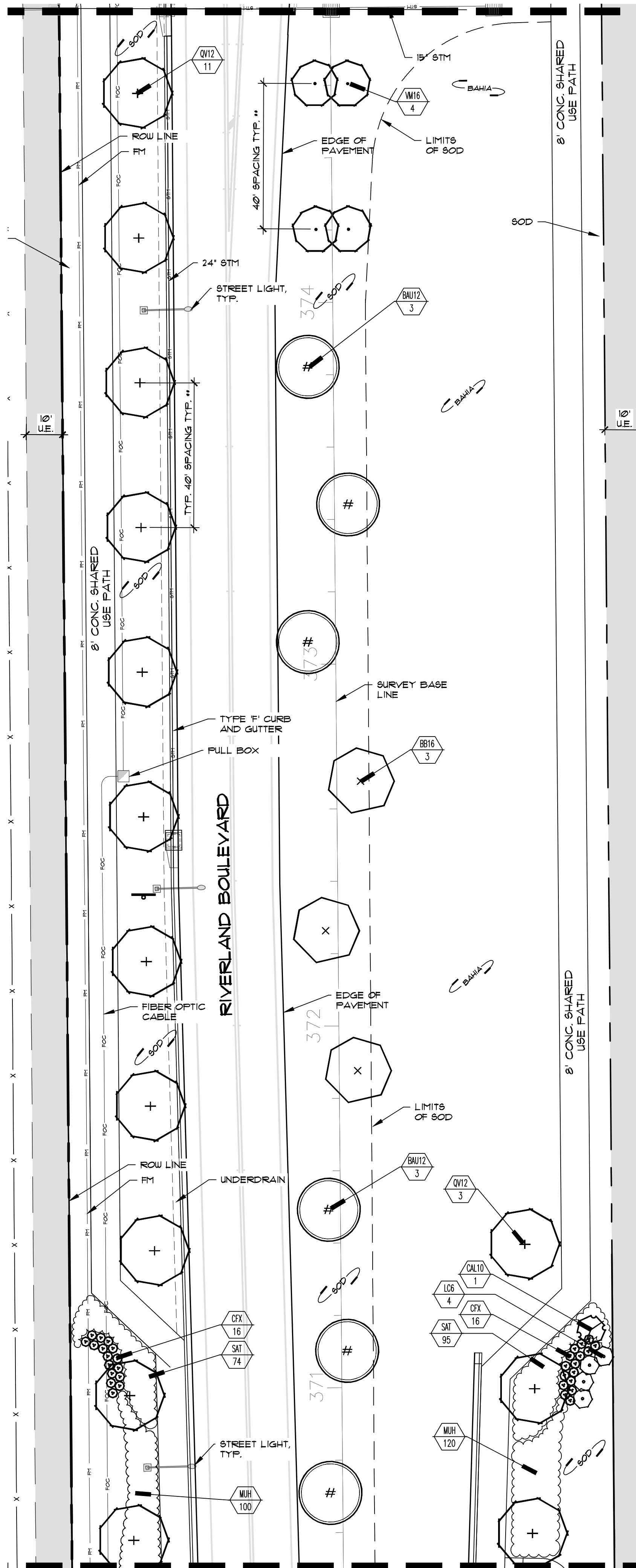

SHEET KEY

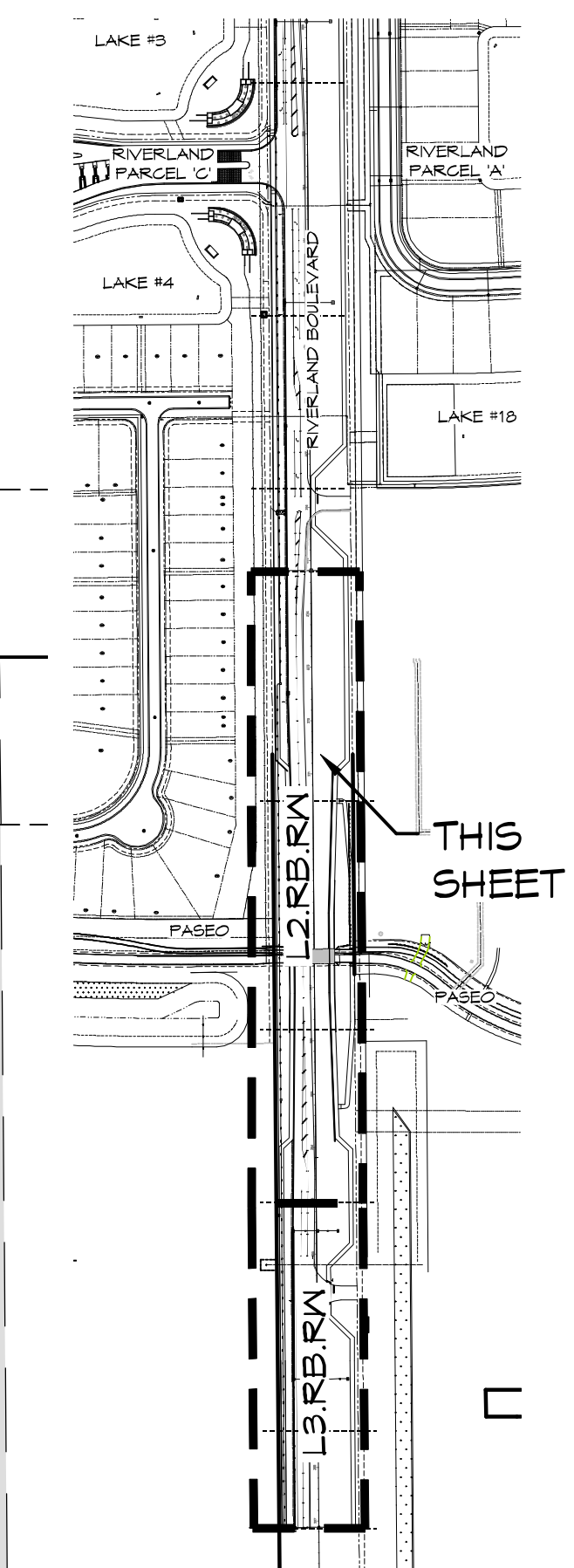

RIVERLAND BOULEVARD AT RIVERLAND PASEO OVERPASS
PORT ST. LUCIE, FLORIDA
R.O.W. PLANTING PLAN

DATE: 11.17.20
DRAWN BY: ALO/WAY
JOB NO.: 17-077
SCALE: 1" = 20'-0"
FILENAME: RIV.MHOA

REVISIONS:
01.06.21 PSL cmnts.
01.14.21 Safe sght triangle
2.19.21 Shift walk
2.29.21 Add street light

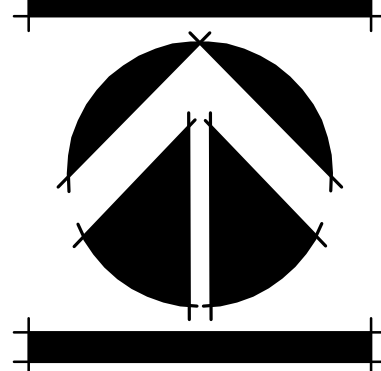

SHEET:
L2.RB.RW

10' 0" 20'
PSL PROJECT NO. F20-239
PSLUSD PROJECT NO. 5267A-1

MATCH LINE 'I' - SEE SHEET L2.RB.RW

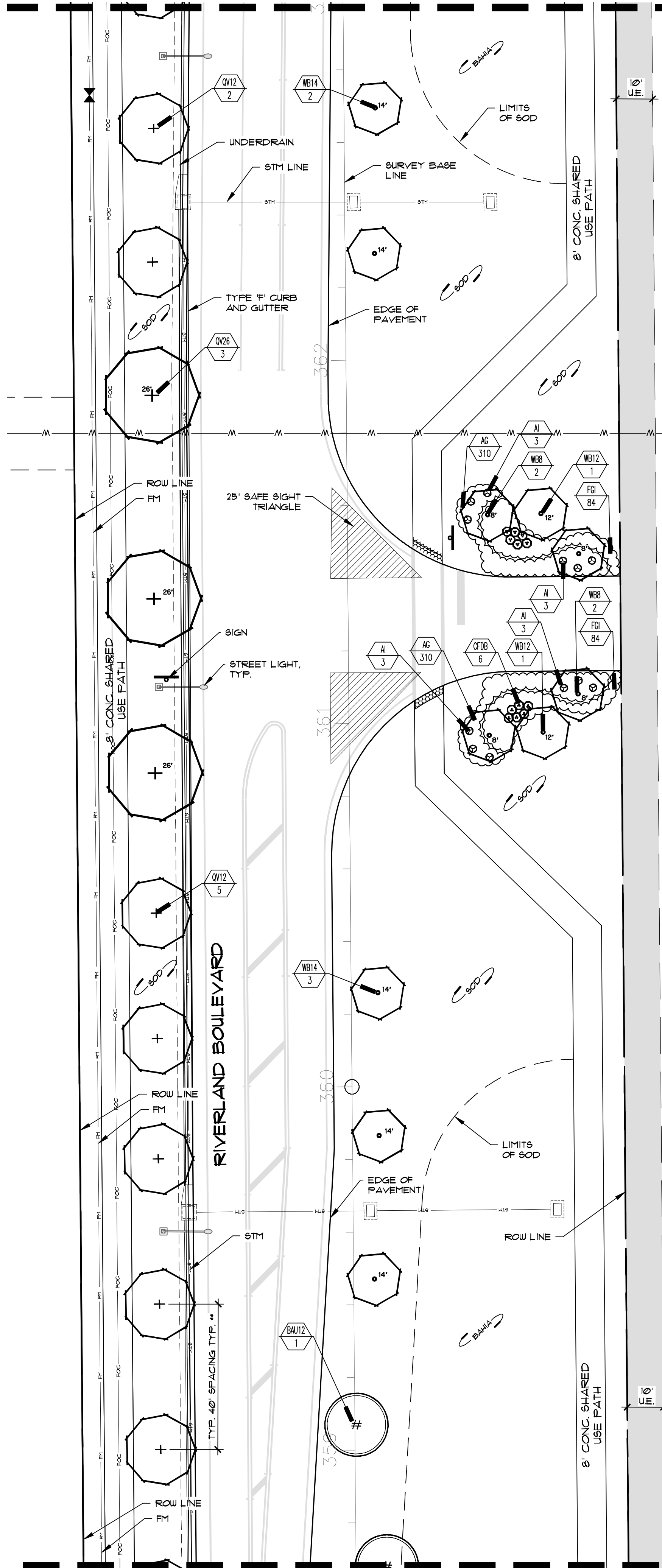

MATCH LINE 'J' - SEE ABOVE RIGHT

MATCH LINE 'J' - SEE BELOW LEFT

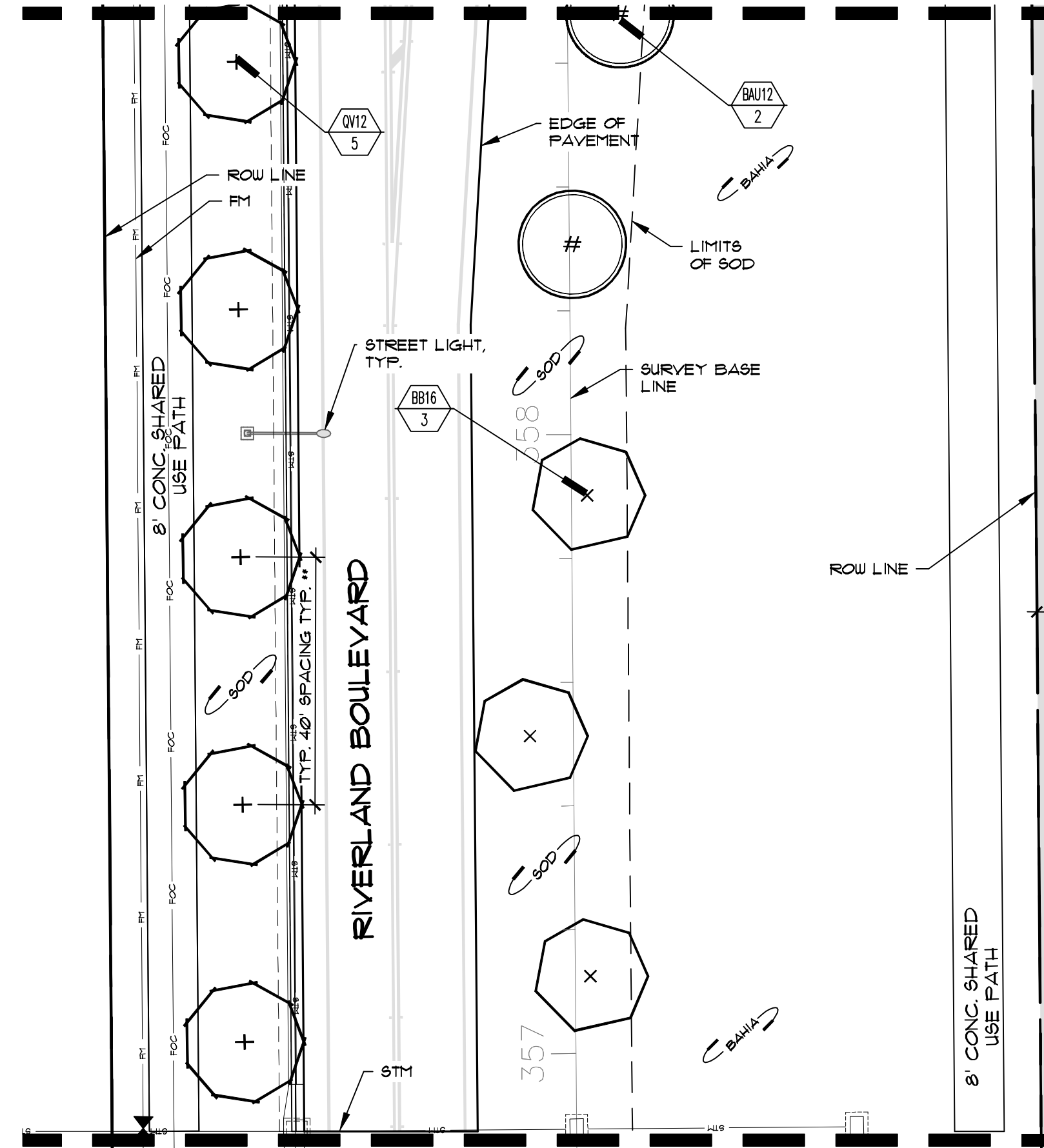

LIMIT OF THIS SUBMITTAL

PLANT LIST - SHEET L3.RB.RW

TREES			
BAU12	Bauhinia blakeana / Hong Kong Orchid	12 x 6', 5 cal., full canopy	3
BB16	Bucida bucceras / Shady Lady / Black Olive	16' ht. x 8' spr., 3' cal., full canopy, B 4 B	3
CALD	Calliandra haematocephala / Powder Puff	8' ht., full canopy	6
QV12	Quercus virginiana / Live Oak	12 x 6', 2.5' cal., full canopy	12
QV26	Quercus virginiana / Live Oak	26'-28' x 20'-22', 10'-12" cal., straight trunk, full canopy	3
PALMS			
BN2	Bismarckia nobilis / Bismarck Palm	1'-2' c.t., heavy cal., full frond	2
BN4	Bismarckia nobilis 'Silver' / Silver Bismarck Palm	4' c.t., heavy cal., full frond	2
SPC	Sabal palmetto / Cabbage Palm	6' - 22' c.t. hts., staggered hts., hurricane cut, slick trunk, curved as noted	5
WB3	Neodytia bifurcata / Foxtail Palm	8' c.t., heavy cal., full frond	4
WB12	Neodytia bifurcata / Foxtail Palm	12' c.t., heavy cal., full frond	2
WB14	Neodytia bifurcata / Foxtail Palm	14' c.t., heavy cal., full frond	5
SHRUBS, ACCENTS, AND GROUNDCOVER			
AG	Arachis gabrata / Perennial Peanut	Solid panels, laid tight, Qty in SF	620
AI	Alcantarea imperialis / Bromeliad	7 gal, 36" x 36", full, no damage to leaves	12
CFDB	Conyza macrocarpa DP/ Brown / TI Plant	7 gal, 22" x 20", full	12
CMCB	Carissa macrocarpa Emerald Blauket / Dwarf Carissa	3 gal, 14" x 14", full, dense foliage to base, 24" o.c.	40
FGI	Ficus 'Green Island' / Green Island Ficus	3 gal, 14" x 18", full, 24" o.c.	41
FFV	Femisetum purpureum 'Vertigo'	3 gal, 20" x 14", full	168
SAT	Schefflera arboricola 'Trinette' / Variegated Dwarf Schefflera	3 gal, 22" x 20", full	41
TD	Tripsacum dactyloides / Fakahatchee Grass	3 gal, 24" x 22", full, 50" o.c.	124
SOD	Stenotaphrum secundatum / St. Augustine Floratam	Solid sod, laid tight, Qty in SF	16
BAHA SOD	Paspalum notatum / Bahia Grass	Solid sod, laid tight, Qty in SF	
MULCH	Chocolate Mulch	2" Thick 'A' Grade Raw Wood Mulch, CHOCOLATE color - BID PER CY	

NOTE:
ALL PLANT MATERIAL SHALL MEET OR EXCEED SIZE AND CONTAINER SPECIFICATIONS IN PLANT LIST. PLANT MATERIALS NOT MEETING SPECIFICATION WILL BE REJECTED. CONTRACTOR TO COORDINATE AVAILABILITY ISSUES WITH OWNER PRIOR TO COMMENCING WORK.

SHEET KEY

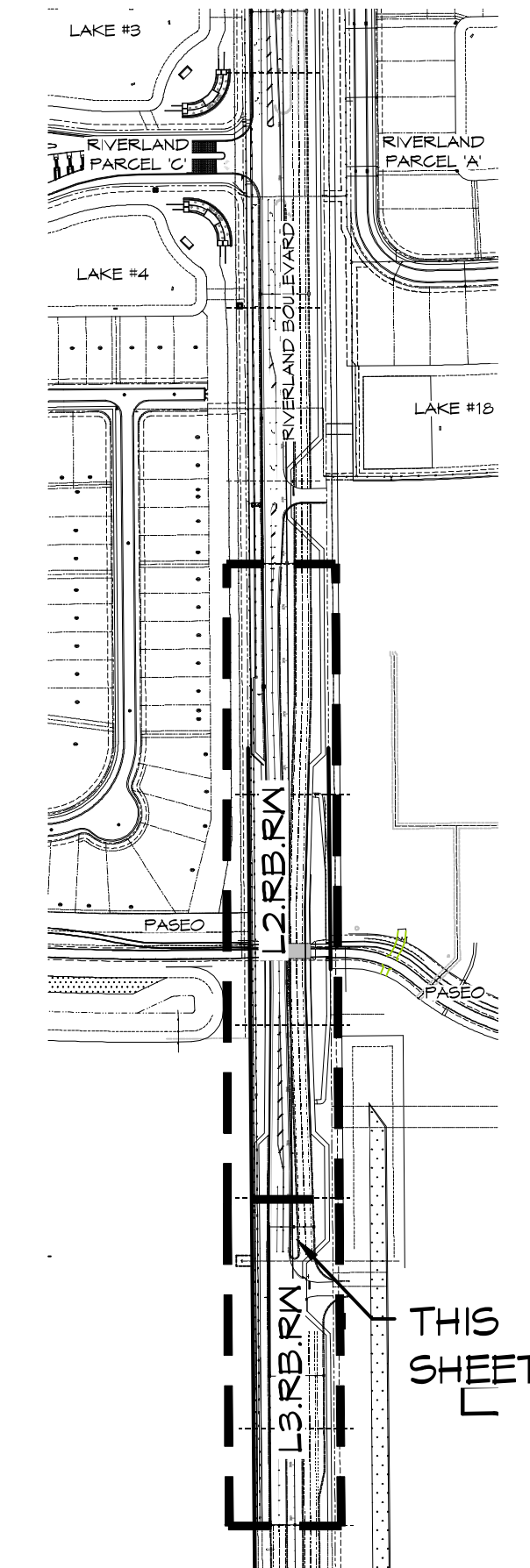

10' 0" 20'
PSL PROJECT NO. F20-239
PSLUSD PROJECT NO. 5267A-1

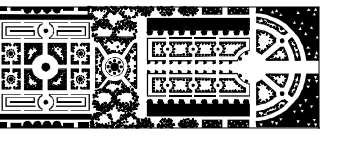

PARKER-YANNETTE
design group, inc.

LANDSCAPE ARCHITECTURE
PLANNING • GRAPHICS
4425 Military Trail, Suite 202
Suite 330
Jupiter, Florida 33458

Telephone: (561) 747-5069
Fax: (561) 747-2041
Email: mail@pydg.com

License #LA-0001347

RIVERLAND BOULEVARD AT
RIVERLAND PASEO OVERPASS
PORT ST. LUCIE, FLORIDA
R.O.W. PLANTING PLAN

DATE: 11.17.20
DRAWN BY: ALJ/WAY
JOB NO.: 17-071
SCALE: 1" = 20'-0"
FILENAME: Rvr MHOA

REVISIONS:
01.06.21 PSL cmts.
01.14.21 Safe sight triangle

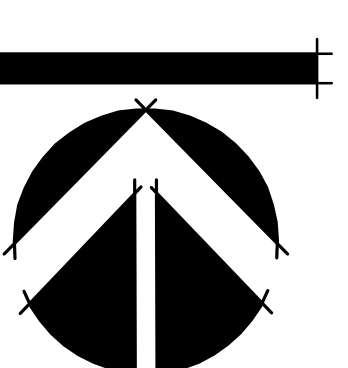

SHEET:
L3.RB.RW