

Landscape Data

Perimeter Landscaping Adjacent to Road Right-of-way (15' PSL Blvd)

Trees
Required - (1 Tree/30 L.F.) - 400 L.F./30 = 13 Trees
Provided - 13 Trees

Shrubs
Required - Continuous Hedge 2' O.C. = 200 Shrubs
Provided - 200 Shrubs

Perimeter Landscaping Adjacent to Road Right-of-way (10' Seagull Terrace)

Trees
Required - (1 Tree/30 L.F.) - 400 L.F./30 = 13 Trees
Provided - 13 Trees

Shrubs
Required - Continuous Hedge 2' O.C. = 200 Shrubs
Provided - 200 Shrubs

Perimeter Landscaping Adjacent to Another Property

Trees
Required: (1 Tree/30 L.F.) - 500 L.F./30 = 17 Trees
Provided: 17 Trees

Shrubs
Required: Continuous Hedge 2' O.C. = 250 Shrubs
Provided: 250 Shrubs

Parking Area Interior Landscaping

Required Terminal/Interior Island Trees - 1 Tree per Terminal/Interior Island = 19 Trees
Total Terminal/Interior Island Trees Provided = 19 Trees

Palm Requirements

Required: No more than 25% of required trees may be palms
Total Trees & Palms = 75
Total Palms = 0 x 2 @ 2:1 = 0
Provided: Palms = 0 / 2 = 0 / 75 = 0%

Total Trees:
Total Trees Required: 75
Total Trees Provided: 75
75 Trees + 0 Palms @ 2:1 = 0 Trees = 75 Trees

Native Plants

Trees
Required: 50% of all required trees shall be native
Total Trees = 75
Provided: Native Trees = 32 / 75 = 69%

Shrubs
Required: 25% of all required shrubs shall be native
Total Shrubs = 1,127
Provided: Native Shrubs = 1,127 / 1,127 = 100%

Flowering Trees

Required: 20% of all required trees shall be flowering
Total Trees = 75 (Not Including Palms) x 20% = 15
Provided: Flowering Trees = 15 = 20%

Landscape Island Evergreen Shade Trees

Required: 75% of all required trees located within landscape islands shall be evergreen shade trees
Total Landscape Islands = 19 x 75% = 14 Trees
Provided: Landscape Islands with Evergreen Shade Trees = 14 = 100%

Tree Species Mix

Required: When 41+ trees are required the minimum species mix = 5
Provided: 9

Building Facades

Trees
Required - 1 Tree / 30 L.F. of Building Perimeter
788 L.F. of Building Perimeter / 30 L.F. = 26 Trees
Provided - 26 (Some relocated to dry retention for additional water cleansing)

Shrubs

Require - 1 Shrub / 1.5 L.F. of Building Perimeter
Excluding Paved Access Areas = 680 L.F. / 1.5 = 453 Shrubs
Provided - 453 Shrubs

Dumpster

Required - Hedge / Vine 2' O.C. 48 L.F. / 2 = 24 Shrubs
Provided - 24 Shrubs

Plant List

SYM	SPECIES	COMMON NAME/DESCRIPTION	SIZE	SPACING	REMARKS	DROUGHT TOLERANCE
IE*	ILEX x ATTENUATA 'EAGLESTON'	EAGLESTON HOLLY	12' x 5', 2.5' CAL.	A.S.	FULL CANOPY, 4' C.T. MIN.	HIGH
LI	LAGERSTROEMIA INDICA 'TUSKEGEE'	CREPE MYRTLE RED	12' x 6', 2.5' CAL.	A.S.	FULL CANOPY, 4' C.T. MIN.	HIGH
LJ	LIGUSTRUM JAPONICUM	LIGUSTRUM TREE FORM	12' x 5', 2.5' CAL.	A.S.	FULL CANOPY, 4' C.T. MIN.	HIGH
MG*	MAGNOLIA GRANDIFLORA	LITTLE GEM MAGNOLIA	12' x 5', 2.5' CAL.	A.S.	FULL CANOPY, 4' C.T. MIN.	HIGH
MG-1*	MAGNOLIA GRANDIFLORA	SOUTHERN MAGNOLIA D.D. BLANCHARD	12' x 5', 2.5' CAL.	A.S.	FULL CANOPY, 4' C.T. MIN.	HIGH
PE*	PINUS ELLIOTTI Densa	SOUTH FLORIDA SLASH PINE	12' x 5', 2.5' CAL.	A.S.	FULL CANOPY, 4' C.T. MIN.	HIGH
OL*	QUERCUS LAURIFOLIA	LAUREL OAK	14' x 5', 2.5' CAL.	A.S.	FULL CANOPY, 4' C.T. MIN.	HIGH
Ov*	QUERCUS VIRGINIANA	LIVE OAK	14' x 5', 2.5' CAL.	A.S.	FULL CANOPY, 4' C.T. MIN.	HIGH
TD*	TAXODIUM DISTICHUM	BALD CYPRESS	12' x 5', 2.5' CAL.	A.S.	FULL CANOPY, 4' C.T. MIN.	HIGH
PT	PTYCHOSPERMA ELEGANS	ALEXANDER PALM	8' O.A.	A.S.	DOUBLE TRUNKS	HIGH
FOS*	FORESTIERA SEGREGATA	FLORIDA PRIVET	#3, 2' x 2'	2 O.C.	FULL & THICK	HIGH
MYR*	MYRICANTHES FRAGRANS	SIMPSON STOPPER	#3, 2' x 2'	2 O.C.	FULL & THICK	HIGH
MYR-1*	MYRICANTHES FRAGRANS	SIMPSON STOPPER	#7, 4' x 2'	2 O.C.	FULL & THICK	HIGH
SOD-1	PASPALUM NOTATUM	BAHIA SOD	SEE SPECS	SEE SPECS		HIGH
SOD	STENOTAPHRUM SECUNDATUS	ST. AUGUSTINE SOD	SEE SPECS	SEE SPECS		LOW - MEDIUM

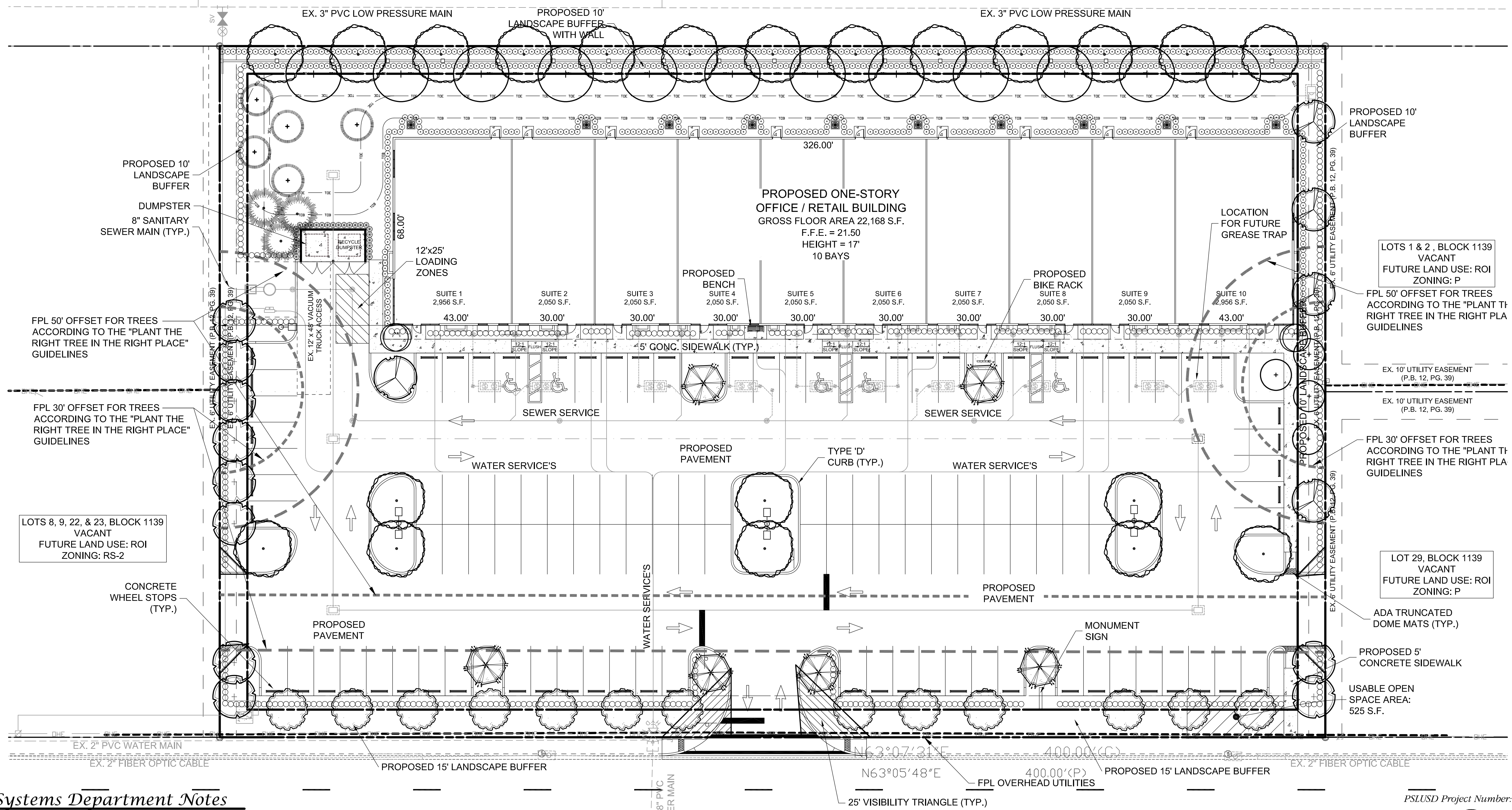
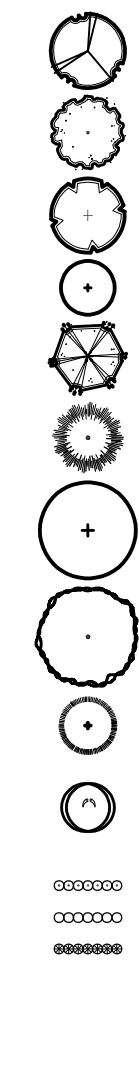

Port St. Lucie Utility Systems Department Notes

- No landscaping shall be planted in such a manner as to adversely affect drainage or utility easements.
- Trees with a maximum mature height great enough to interfere with overhead power lines shall not be planted below overhead power lines. Such trees with a maximum mature height less than the height of the overhead power line shall be selected from Appendix C, Table 1, Type B Trees. No tree shall be planted within 10 feet of any existing utility pole, guy wire, or cast mounted transformer. (See FPAL's publication "Plant the Right Tree in the Right Place" for placement and maintenance requirements.)
- All landscaping within Port St. Lucie Utility Systems Department (PSLUSD) utility easements shall comply with PSLUSD technical specifications, policies, and codes.
- Trees shall not be planted within ten (10) feet of any PSLUSD underground infrastructure.
- In locations where the perimeter landscape buffers must be designed to be located in utility easements due to site constraints, the trees, palm trees and shrubs shall be selected from the list in §153.04(2)(3) and used in these areas to meet the landscape buffer requirements. Trees and palm trees may be planted not less than seven (7) feet from the underground PSLUSD infrastructure. The remainder of the landscape strip shall be planted with grass and ground cover.

Port St. Lucie Engineering Department Notes

- The landscape plans meet the City's sight distance and clear zone requirements from Section 158.204 of the Code for 10' requirements.

General Notes

- No plant substitutions can be made without the City of Port St. Lucie's approval.
- All required landscape improvements must be inspected and approved by the City of Port St. Lucie prior to the issuance of a Certificate of Occupancy.
- Any existing landscaping, sod, or irrigation damaged or destroyed during the construction shall be replaced prior to the final inspection.
- All prohibited, exotic and invasive species shall be removed from the entire site prior to issuance of certificate of occupancy.
- Planting adjacent to fire hydrants is to have a minimum clear radius of 7.5' as required by the NFPA Uniform Fire Code Florida Edition 18.3.4.1 Hydrants. All fire hydrants and fire check valves shall have a minimum of 7.5' from the front and sides with 4' from the rear to all landscape material per the Florida Fire Prevention Code.

Conceptual Landscape Plan

PSLUSD Project Number: 5417

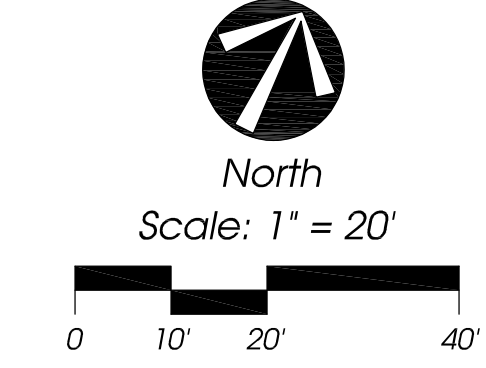

Conceptual Design Group, Inc.
Landscape Architecture - Site Planning
900 East Ocean Boulevard, Suite 130d
Stuart, Florida 34994
(772) 344-2340
LC: 26000198

BlueKey
S.W. Port St. Lucie Boulevard
City of Port St. Lucie, Florida

Jeffrey W. Smith, RLA
Florida Registration Number: LA 0001635

Job No. 21-0502
Drawn By JWS
Submitted Dates 10-27-2021
12-13-2021

Revision Dates
City Comments #1 12-13-2021

These drawings are the property of the landscape architect and are not to be used for other projects except by written permission from the landscape architect. Report any discrepancies immediately to the landscape architect.

Sheet CL-1 of 1
City Project Number: P21-258 & P21-260