

- General Notes:**
- All landscape material to be Florida No.1
 - All landscaping meets FDOT clearzone and sight distance criteria.
 - All trees installed within 4' of a hard surface such as sidewalk, curb or building to be installed with 24" rootbarrier per detail on sheet LD-06. Rootbarrier to extend 5' in each direction, measured from center of trunk.
 - Quantities are given for contractor convenience only. In case of discrepancy between tags and plant list, the plant list shall prevail.

- Notes:**
- Less than 50% of the required trees are palm trees.
 - 80% of the required trees are native
 - 28% of the required trees are flowering trees
 - 95% of the required trees located within landscape Islands are shade trees.
 - 100% of the required trees are low water use.
 - 100% of the required shrubs are moderate to low water use.
 - All sod to be St. Augustine 'Floritam', weed free and laid tight, unless otherwise noted.

- PSLUSD Notes:**
- No landscaping shall be planted in a manner that would adversely affect utility easements.
 - Landscaping shall be in compliance with Chapter 153 of the City of Port St. Lucie Code of Ordinances, PSLUSD technical specifications and policies.
 - All landscaping within City utility easements shall comply with PSLUSD technical specifications, policies, and codes.
 - All landscaping shall meet the latest PSLUSD Landscape Policy and shall not be placed in a manner that would create conflicts with the intended operation and maintenance of any existing utility.
 - Trees shall not be planted within ten (10) feet of any PSLUSD underground infrastructure.
 - No landscaping other than sod grasses shall be located within 5' of a PSLUSD appurtenance such as a water meter assembly, backflow device, fire hydrant or sewer cleanout, etc.

Landscape Irrigation Notes:

- All areas to receive 100% irrigation coverage
- All zones to be automatically controlled.
- Clocks to have automatic "Rain sensors".
- Water source may be potable or well and shall be determined at time of building permit application

SW VILLAGE PKWY

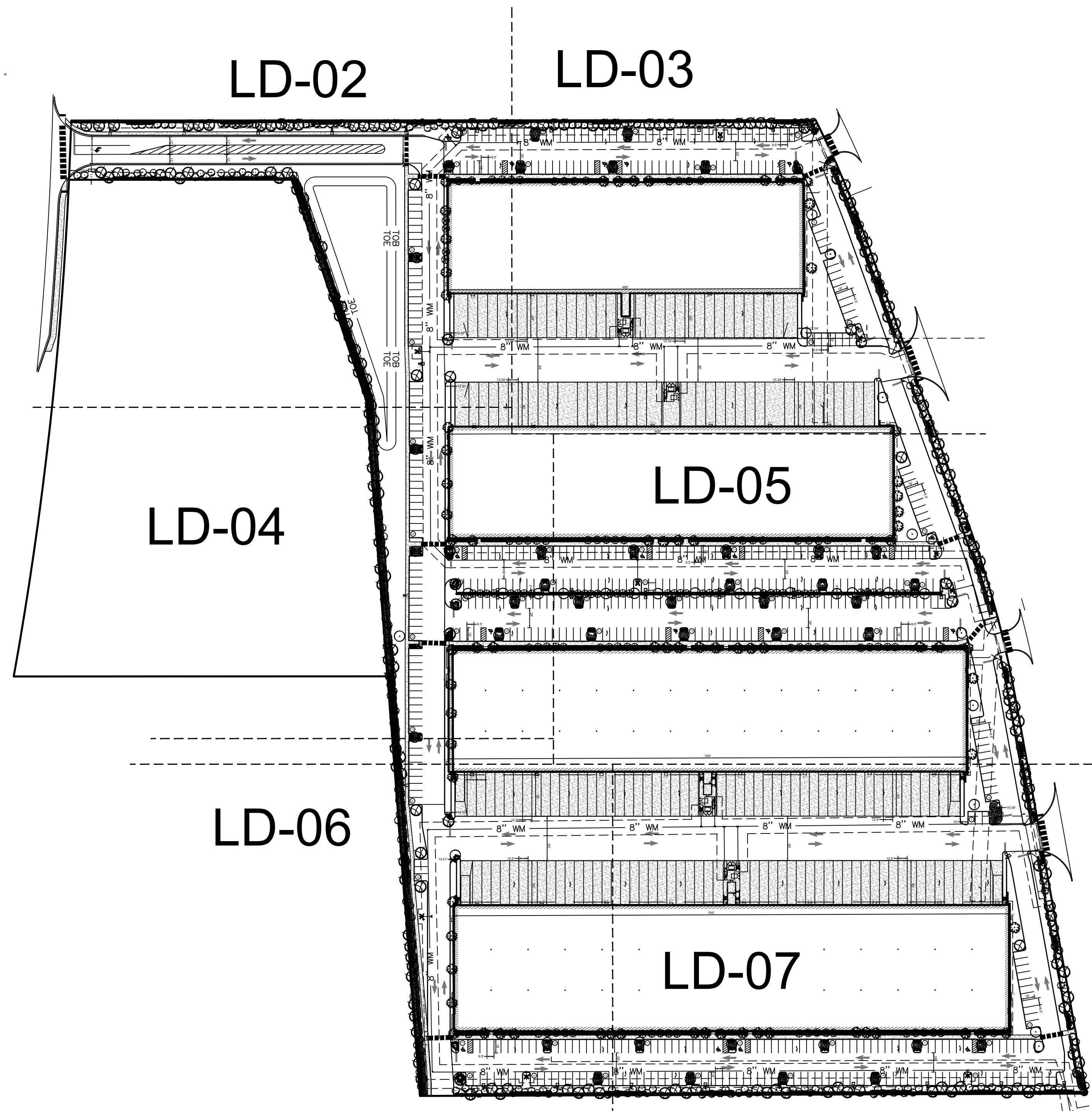

Landscape Legend

Qty	Sym	Water	Name
Trees			
69	AR		Red Maple 'Florida Flame', B&B, 4" Cal, 14'Hx7'S
121	CE		Green Buttonwood
176	LI1		Conocarpus erectus, 45 gal, 12" ht, 3" cal, 5' Spr, Standard
103	LI2		Lagerstroemia indica x fauriei 'Muskogee', 65 Gal., 2.5" Cal., Standard
190	QV		Crape Myrtle
74	SP		Lagerstroemia indica x fauriei 'Natchez', 65 Gal., 2.5" Cal., Standard
			Live Oak
			Quercus virginiana, B&B, 4" Cal, 14'Hx7'S
			Cabbage Palm
			Sabal Palmetto, B&B, 10' CT
Shrubs			
531	DUR		Dwarf Golden Dew Drop
436	HAM		Duranta erecta 'Compacta', 24"H, 7 Gal., 30" oc
105	ILE		Dwarf Firebush
489	ILL		Hamelis patens 'Compacta', 24"H, 7 Gal., 30" oc
667	MUH		Yaupon Holly
888	MYR		Ilex vomitoria 'shilling's Dwarf', 24"H, 3 Gal., 30" oc
3342	VIB		Yellow Anise
408	ZAM		Illicium parviflorum, 24"H, 7 Gal., 36" oc
			Muhly Grass
			Muhlenbergia capillaris, 3 Gal., 36" oc
			Wax Myrtle
			Myrica cerifera, 24"H, 7 Gal., 36" oc
			Dwarf Walter's Viburnum
			Viburnum obovatum 'Select', 24"H, 3 Gal., 24" oc
			Coontie
			Zamia floridana, 3 Gal., 36" oc
Groundcover			
656	LAN		Pinelant Lantana
1352	LIR		Lantana depressa, 1 Gal., 36" oc
			Liriope
			Liriope muscari, 1 Gal., 18" oc

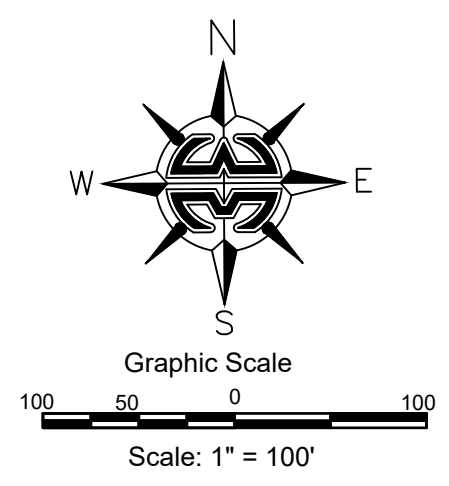

Landscape Data: Roadway Buffers

Buffer	Length	Trees: 1/25 LF, 14" Ht, 2.5" Cal			Understory: Tradition 12'Ht, 2.5" Cal			Shrubs: Double Row, 2' o.c.										
		Required	Provided	Total	Required	Provided	Total	Required	Provided	Total	DUR	ILE	ILL	MUH	MYR	VIB	ZAM	Total
WEST	1257	50	50	67	35	32	67	503							482	301		783
East	1163	47	47	78	54	24	78	1163			668					511	80	1259
Total		97	97	145	89	56	145	1666	0	0	668	0	482	812	80	2042		

Landscape Data: Perimeter Buffers

Buffer	Length	Trees: 1/30 LF, 14" Ht, 2.5" Cal			Understory: Tradition 12'Ht, 2.5" Cal			Shrubs: 2' o.c.										
		Required	Provided	Total	Required	Provided	Total	Required	Provided	Total	DUR	ILE	ILL	MUH	MYR	VIB	ZAM	Total
NORTH	1006	34	42	42	67	19	67	503							345	158		503
SOUTH	841	28	28	28	56	36	57	421						267	159		426	
DRIVEWAY BUFFER	301	10	10	10	20	14	20	151						76	75		151	
Total		38	38	38	76	50	77	571	0	0	0	0	343	234	0	577		

Total Perimeter Buffer Trees Prov. 30

Buffer	Length	Façade: 1 tree per 25 LF 10' CT or 14' Ht					Parking Islands				Shrubs: 2' o.c.								
		Required	Provided	Total	Required	Provided	Required	Provided	Total	Required	Provided	Total	DUR	VIB	LAN	LIR	Total	OVER	
Bldg. 1	755	30	19	14**	33							378	46	333	109	155		643	266
Bldg. 2	877	35	19	16	35							439	44	394	109	310		857	419
Bldg. 3	1000	40	20	20	40							500	53	447	108	428		1036	536
Bldg. 4	1065	43	22	24*	46							533	56	475	121	459		1111	579
Islands	81								81	55	22	77							
Median	688	41		41	41				20	20	20				302	154			
Total		189	80	41	74	195	101	75	22	97	1849	199	1951					3647	1799

Total Interior Trees Req.	290																		
Total Interior Trees Prov.	292	296																	
Overall Trees Req.	562																		
Overall Trees Prov.	564	799																	
Overall Shrubs Req.	3663																		
Overall Shrubs Prov.	3663																		

* 3 parking lot trees relocated to facade
 1 parking lot tree relocated to facade

PSLUSD File # 5360D
 City of Port St. Lucie Project No P22-143

Landscape Design Associates
 25110 NW 182nd Ave
 High Springs, FL 32643
 352-210-5765 pjt. www.landscapea.com

Scale: 1" = 100'
 Drawn by: CA
 Checked by: SM
 CADD No.: 22-021 Dragonfly LP.dwg
 Date: 04.21.22

Revisions
 Date Comments
 4.21.22 CA Revised LP per new base
 01.12.23 Per staff comments
 02.09.23 Enhanced west buffer
 02.14.23 Updated tree species
 03.24.23 Per PSLUSD Comments

Dragonfly
 City of Port St. Lucie
 Overall Landscape Plan

3.24.23
 LD-01

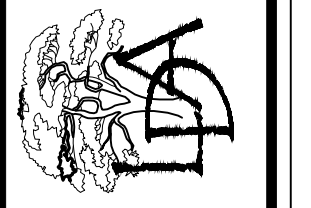

Scale:	1" = 20'
Drawn by:	CA
Checked by:	SM
CADD No.:	22-021 Dragonfly LP.dwg
Date:	04.21.22

Revisions	Date	Comments
1	01.12.23	Per staff comments
2	02.09.23	Enhanced west buffer
3	02.14.23	Updated tree species
4	03.24.23	Per PSLUSD Comments

DRAGONFLY LANDSCAPE ARCHITECTURE
 2510 NW 182ND AVE
 HIGH SPRINGS, FL 32643
 352-210-5765
 WWW.LANDSCAPEA.COM

Dragonfly
 City of Port St Lucie
Landscape Plan

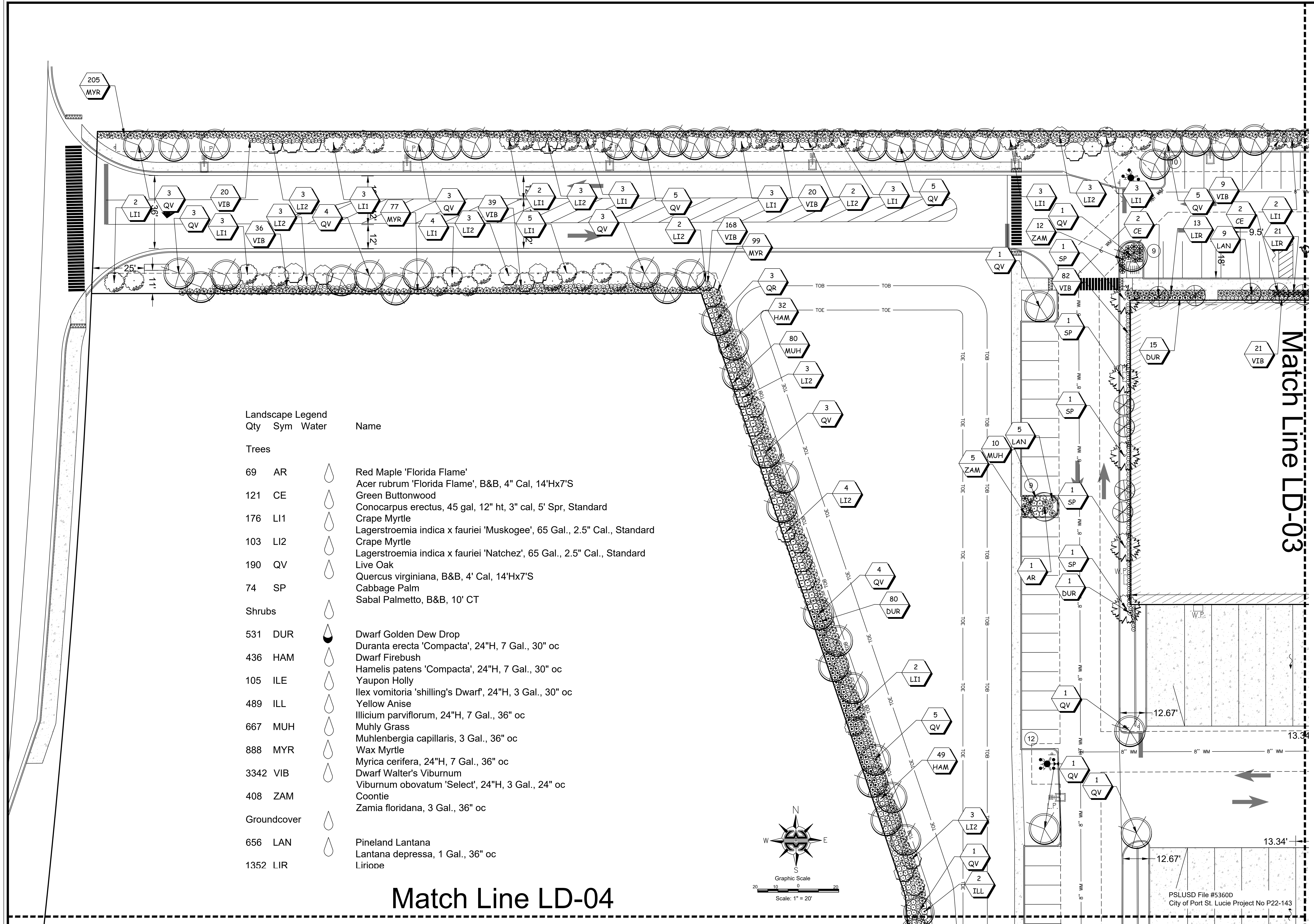

Qty	Sym	Water	Name
Trees			
69	AR	Water	Red Maple 'Florida Flame'
121	CE	Water	Acer rubrum 'Florida Flame', B&B, 4" Cal, 14'Hx7'S
176	LI1	Water	Green Buttonwood
103	LI2	Water	Conocarpus erectus, 45 gal, 12" ht, 3" cal, 5' Spr, Standard
190	QV	Water	Crape Myrtle
74	SP	Water	Lagerstroemia indica x fauriei 'Muskogee', 65 Gal., 2.5" Cal., Standard
		Water	Crape Myrtle
		Water	Lagerstroemia indica x fauriei 'Natchez', 65 Gal., 2.5" Cal., Standard
		Water	Live Oak
		Water	Quercus virginiana, B&B, 4' Cal, 14'Hx7'S
		Water	Cabbage Palm
		Water	Sabal Palmetto, B&B, 10' CT
Shrubs			
531	DUR	Water	Dwarf Golden Dew Drop
436	HAM	Water	Duranta erecta 'Compacta', 24"H, 7 Gal., 30" oc
105	ILE	Water	Dwarf Firebush
489	ILL	Water	Hamelis patens 'Compacta', 24"H, 7 Gal., 30" oc
667	MUH	Water	Yaupon Holly
888	MYR	Water	Ilex vomitoria 'shilling's Dwarf', 24"H, 3 Gal., 30" oc
3342	VIB	Water	Yellow Anise
408	ZAM	Water	Illicium parviflorum, 24"H, 7 Gal., 36" oc
		Water	Muhly Grass
		Water	Muhlenbergia capillaris, 3 Gal., 36" oc
		Water	Wax Myrtle
		Water	Myrica cerifera, 24"H, 7 Gal., 36" oc
		Water	Dwarf Walter's Viburnum
		Water	Viburnum obovatum 'Select', 24"H, 3 Gal., 24" oc
		Water	Coontie
		Water	Zamia floridana, 3 Gal., 36" oc
Groundcover			
656	LAN	Water	Pineland Lantana
1352	LIR	Water	Lantana depressa, 1 Gal., 36" oc
		Water	Liriope

Match Line LD-04

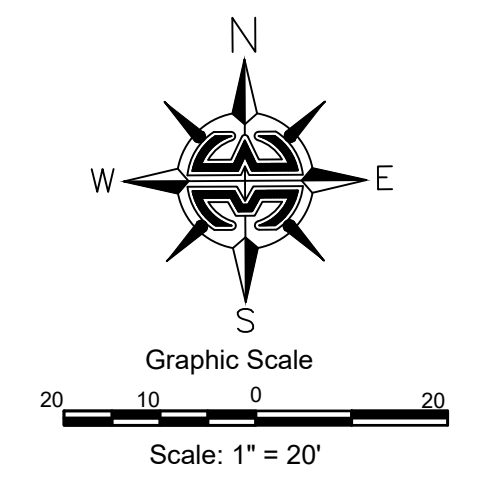

Match Line LD-03

PSLUSD File #5360D
 City of Port St. Lucie Project No P22-143

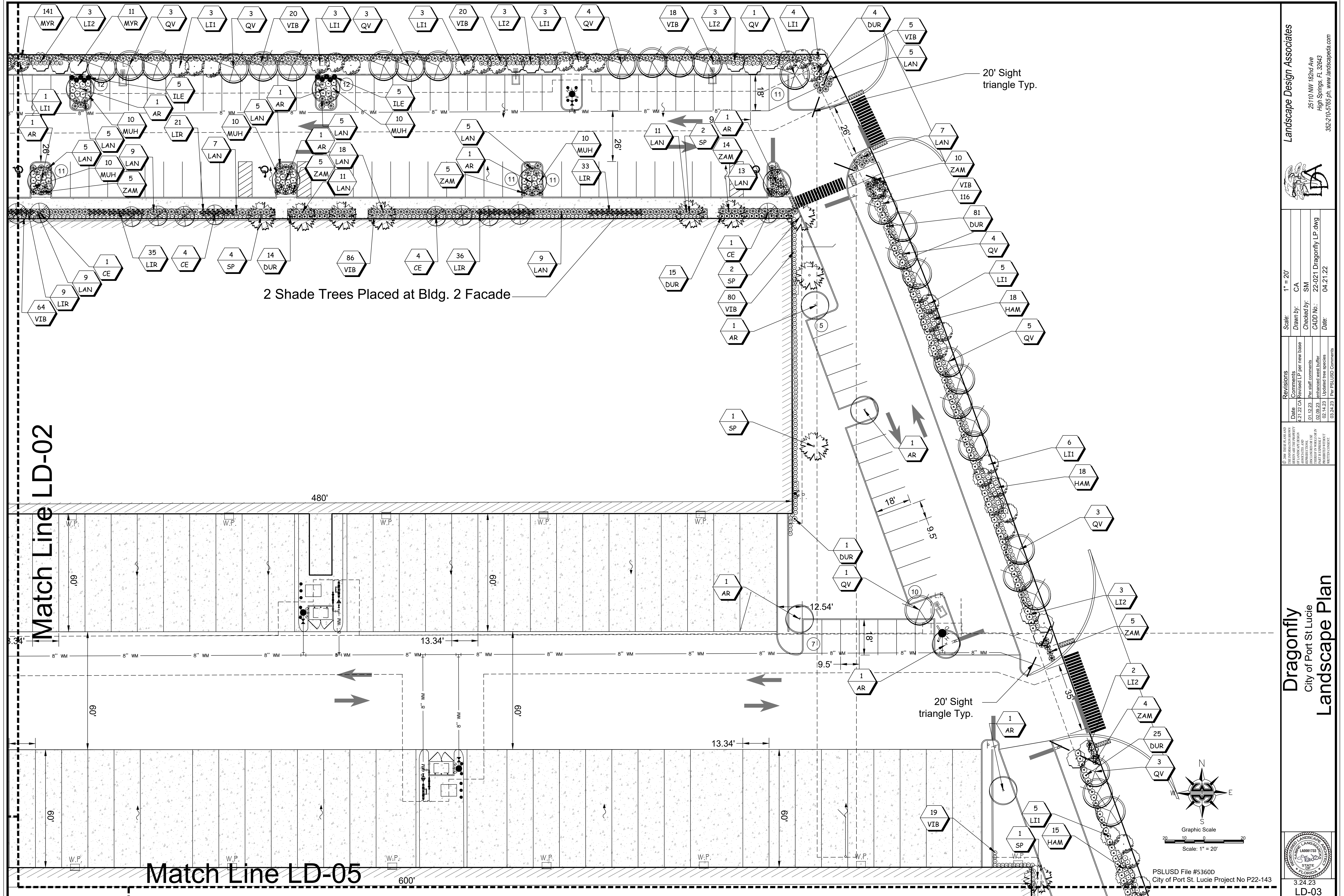

Landscape Design Associates
 25110 NW 182nd Ave
 High Springs, FL 32643
 352-210-5765 pht, www.landscapea.com

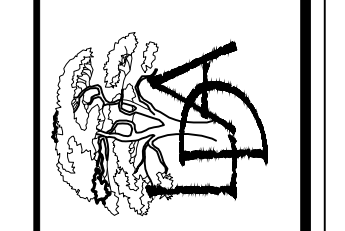

Scale:	1" = 20'
Drawn by:	CA
Checked by:	SM
CADD No.:	22-021 Dragonfly LP.dwg
Date:	04.21.22

Revisions	Date	Comments
1	01.12.23	Per staff comments
2	02.09.23	Enhanced west buffer
3	02.14.23	Updated tree species
4	03.24.23	Per PSLUSD Comments

ALL PLANT MATERIALS AND SPECIES ARE THE PROPERTY OF LANDSCAPE DESIGN ASSOCIATES, INC. AND ARE TO BE USED ONLY FOR THE PROJECT AND SITE SPECIFICALLY IDENTIFIED HEREIN. ANY OTHER USE IS PROHIBITED WITHOUT THE WRITTEN CONSENT OF LANDSCAPE DESIGN ASSOCIATES, INC.

Dragonfly
 City of Port St. Lucie
Landscape Plan

PSLUSD File #5360D
 City of Port St. Lucie Project No P22-143
 3.24.23
 LD-03

Match Line LD-04

Match Line LD-03

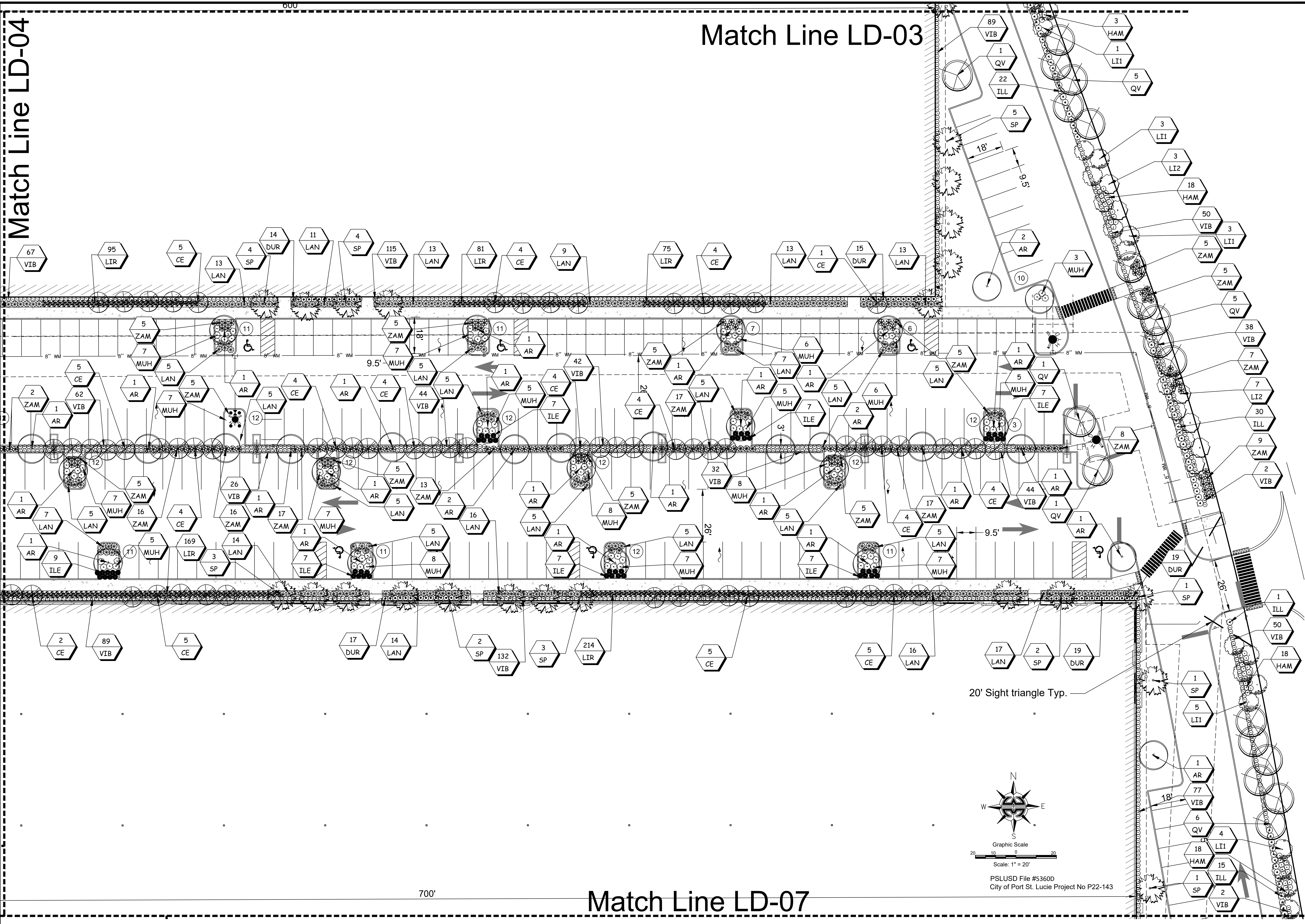

Match Line LD-07

Landscape Design Associates
25110 NW 182nd Ave
High Springs, FL 32643
352-210-5765 ph, www.landscapea.com



Revisions	Date	Comments	Scale	Drawn by	Checked by
	01.12.23	Per staff comments	1" = 20'	CA	SM
	02.09.23	Enhanced west buffer			
	02.14.23	Updated tree species			
	03.24.23	Per PSLUSD Comments			
					04.21.22

Dragonfly
City of Port St. Lucie
Landscape Plan

PSLUSD File #5360D	City of Port St. Lucie Project No P22-143
--------------------	---

LD-05

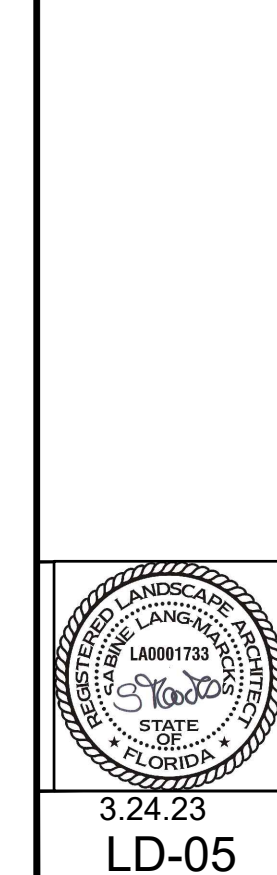

Match Line LD-04

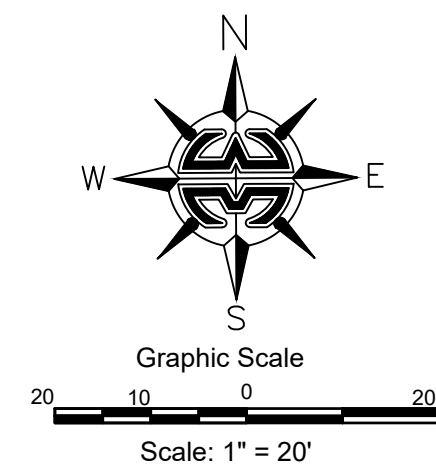

PSLUSD File # 5360D
City of Port St. Lucie Project No P22-143

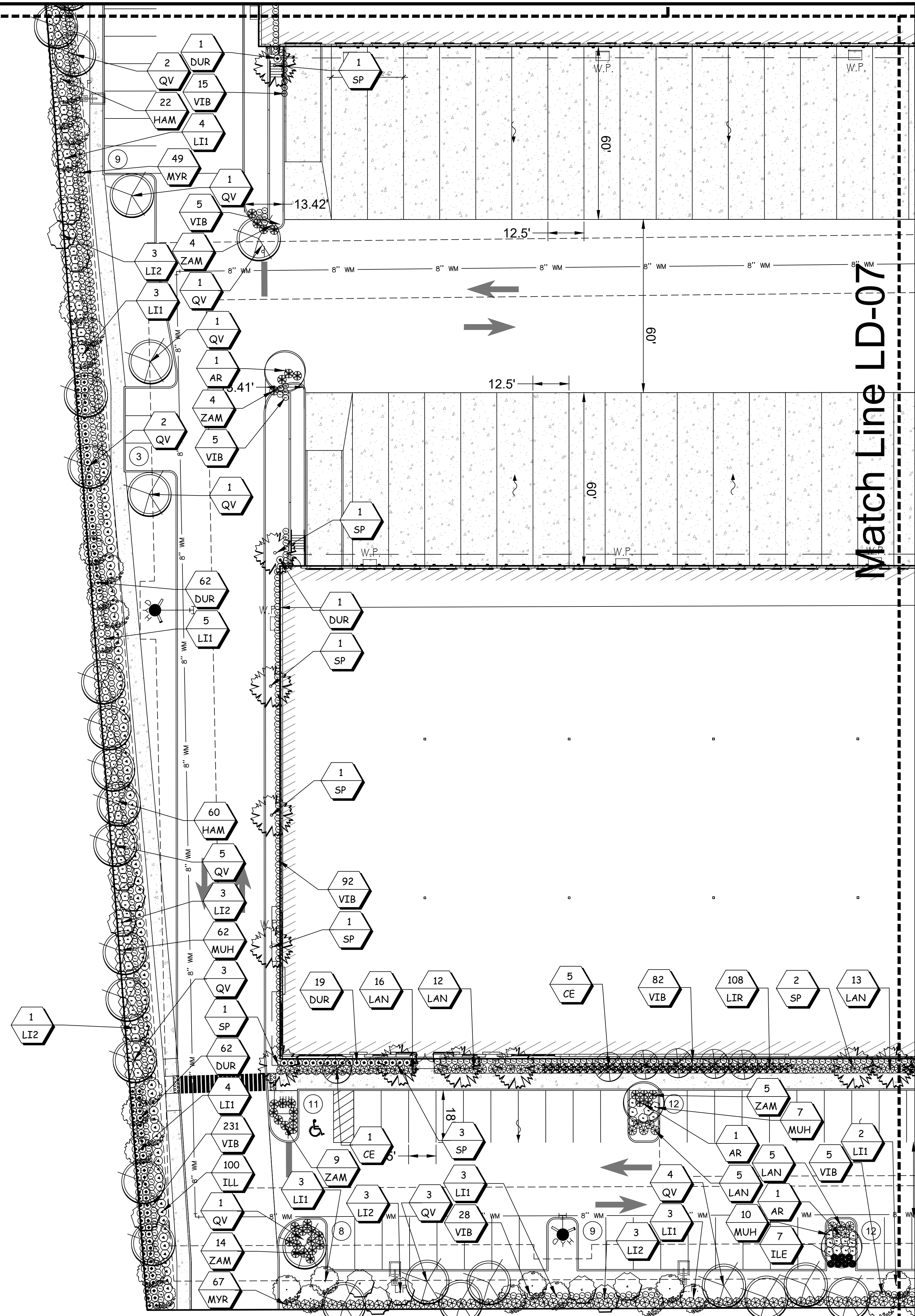

Landscape Design Associates
25110 NW 182nd Ave
High Springs, FL 32643
352-210-5765 p/h, www.landscapea.com

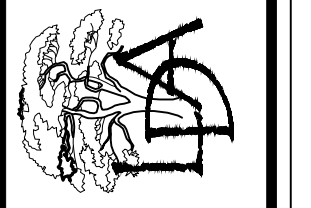

Scale:	1" = 20'
Drawn by:	CA
Checked by:	SM
CADD No.:	22-021 Dragonfly LP.dwg
Date:	04.21.22

REVISIONS	
Date	Comments
4.21.22 CA	Revised LP per new base
01.12.23	Per staff comments
02.09.23	Enhanced west buffer
02.14.23	Updated tree species
03.24.23	Per PSLUSD Comments

IF YOU TRUST PLANS AND
SPECIFICATIONS FOR THE PROPERTY
AND THE PROPERTY IS NOT A
RESIDENTIAL HOME, YOU
SHOULD CONSULT WITH AN
ENGINEER OR ARCHITECT FOR
ADVICE ON THE PROPER USE
OF THESE PLANS AND SPECIFICATIONS.
PROHIBITED WITHOUT
WRITTEN CONSENT
OF L.D.A.

Dragonfly
City of Port St. Lucie
Landscape Plan

3.24.23
LD-06

Match Line LD-05

Match Line LD-06

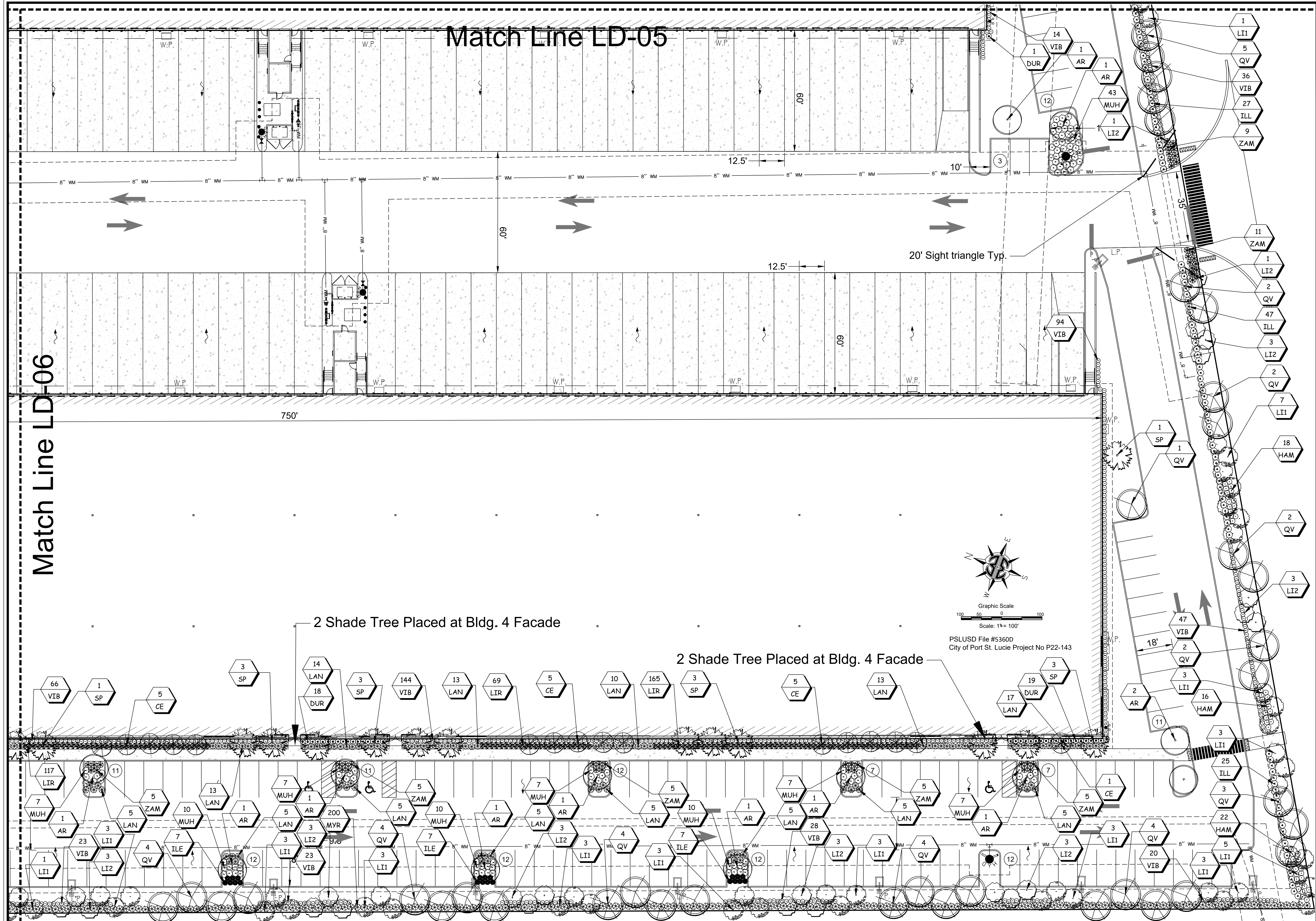

2 Shade Tree Placed at Bldg. 4 Facade

2 Shade Tree Placed at Bldg. 4 Facade

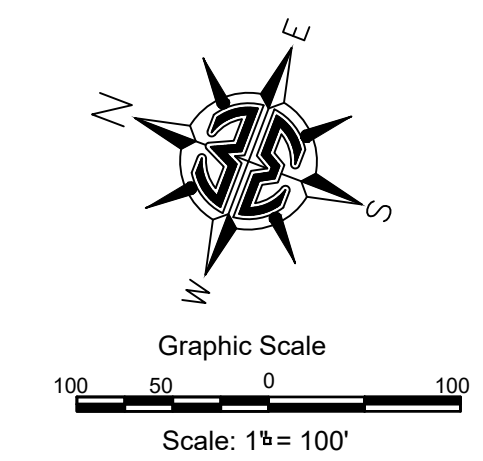

PSLUSD File #5360D
City of Port St. Lucie Project No P22-143

Landscape Design Associates
25110 NW 182nd Ave
High Springs, FL 32643
352-210-5765 ph, www.landscapeda.com



Revisions	Date	Comments	Scale	Drawn by	Checked by	CADD No.	Date
1	01.12.23	Per staff comments	1" = 100'	CA	SM	22-021 Dragonfly LP.dwg	04.21.22
2	02.09.23	Enhanced west buffer					
3	02.14.23	Updated tree species					
4	03.24.23	Per PSLUSD Comments					

PSLUSD File #5360D
City of Port St. Lucie Project No P22-143

Dragonfly
City of Port St. Lucie
Landscape Plan

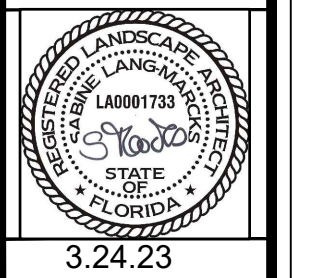

3.24.23
LD-07

PLANTING NOTES:

FERTILIZER

FERTILIZERS SHALL BE SLOW RELEASE, UNIFORM IN COMPOSITION, DRY AND FREE FLOWING. THE FERTILIZER SHALL BE DELIVERED TO THE SITE IN THE ORIGINAL UNOPENED BAGS, EACH BEARING THE MANUFACTURER'S STATEMENT OF ANALYSIS AND SHALL MEET THE FOLLOWING REQUIREMENTS: SIX (6) PERCENT NITROGEN, SIX (6) PERCENT PHOSPHOROUS AND SIX (6) PERCENT POTASSIUM. FERTILIZER SHALL BE APPLIED TO ALL SHRUBS (1/3 LB PER 3 GAL POT, 1/4 LB PER 1 GAL POT) AND GROUNDCOVER. THE SOD STARTER FERTILIZER MIXTURE SHALL BE A 5-10-10 ANALYSIS. A 14-14-14 FERTILIZER ANALYSIS IS REQUIRED ON ALL TREES AND SHRUBS OVER 5' IN HEIGHT (1/2 LB PER 5' OF SPREAD). AGRIFORM TABLETS WITH TWENTY (20) PERCENT NITROGEN, TEN (10) PERCENT PHOSPHOROUS, FIVE (5) PERCENT POTASSIUM IN 21 GRAM SIZES SHALL BE APPLIED ALONG WITH THE FERTILIZER PROCESS (1 WITH 1 GAL PLANTS, 2 WITH 3 GAL PLANTS AND 2 TABLETS PER 1" OF TREE TRUNK CALIPER). MAGNESIUM SULFATE SHALL BE APPLIED TO ALL PALMS AT INSTALLATION AT A RATE OF 1/2 LB PER INCH OF TRUNK CALIPER. MANGANESE SHALL BE APPLIED AT THE SAME RATE.

MULCH

MULCH MATERIAL SHALL BE COLORED 'A' GRADE CERTIFIED RECYCLED MULCH AND MOISTENED AT THE TIME OF APPLICATION TO PREVENT WIND DISPLACEMENT. MULCH SHALL BE APPLIED TO A MINIMUM OF 3" DEPTH IN PLANTING BEDS. MULCH SHALL NOT BE PLACED WITHIN 6" OF TREE OR PALM TRUNKS.

SOD

THE SOD SHALL BE CERTIFIED TO MEET FLORIDA STATE PLANT BOARD SPECIFICATIONS, ABSOLUTELY TRUE TO VARIETAL TYPE AND FREE FROM WEEDS, FUNGUS, INSECTS AND DISEASE OF ANY KIND.

SUBSTITUTIONS

NO SUBSTITUTION OF PLANT MATERIAL TYPES OR SIZES WILL BE ALLOWED WITHOUT WRITTEN AUTHORIZATION FROM THE LANDSCAPE ARCHITECT OF RECORD. CONTAINER GROWN MATERIAL WILL NOT BE ACCEPTED AS A SUBSTITUTE FOR B & B MATERIAL UNLESS PREVIOUSLY APPROVED. INTENDED SUBSTITUTIONS SHALL BE SPELLED OUT IN BID MEASUREMENTS.

MEASUREMENTS

SHADE TREES: HEIGHT SHALL BE MEASURED FROM GROUND TO THE AVERAGE BRANCH HEIGHT OF CANOPY. SPREAD SHALL BE MEASURED TO THE END OF BRANCHING EQUALLY AROUND THE CROWN FROM THE CENTER OF THE TRUNK. MEASUREMENTS ARE NOT TO INCLUDE ANY TERMINAL GROWTH. SINGLE TRUNK TREES SHALL BE FREE OF "V" CROTCHES THAT COULD BE POINTS OF WEAK LIMB STRUCTURE OR DISEASE INFESTATION.

SHRUBS: HEIGHT SHALL BE MEASURED FROM THE GROUND TO THE AVERAGE POINT WHERE MATURE PLANT GROWTH STOPS. SPREAD SHALL BE MEASURED TO THE END OF BRANCHING EQUALLY AROUND THE SHRUB MASS. MEASUREMENT AREA NOT TO INCLUDE ANY TERMINAL GROWTH.

PALMS: CLEAR TRUNK SHALL BE MEASURED FROM THE GROUND AT THE TIME OF INSTALLATION TO THE POINT WHERE THE MATURE AGED TRUNK JOINS THE IMMATURE OR GREEN PORTION OF THE TRUNK OR HEAD.

GREY WOOD (G.W.): SHALL BE MEASURED FROM THE GROUND AT THE TIME OF INSTALLATION TO TOP OF THE HARDENED TRUNK.

OVERALL HEIGHT (O.A.): SHALL BE MEASURED FROM THE GROUND AT THE TIME OF INSTALLATION TO THE AVERAGE FROND HEIGHT.

PALMS WITH MARRED OR BURNED TRUNKS WILL NOT BE ACCEPTED.

Palm Planting Detail

Tree Stakes are to be removed between 6-12 months by the Owner.

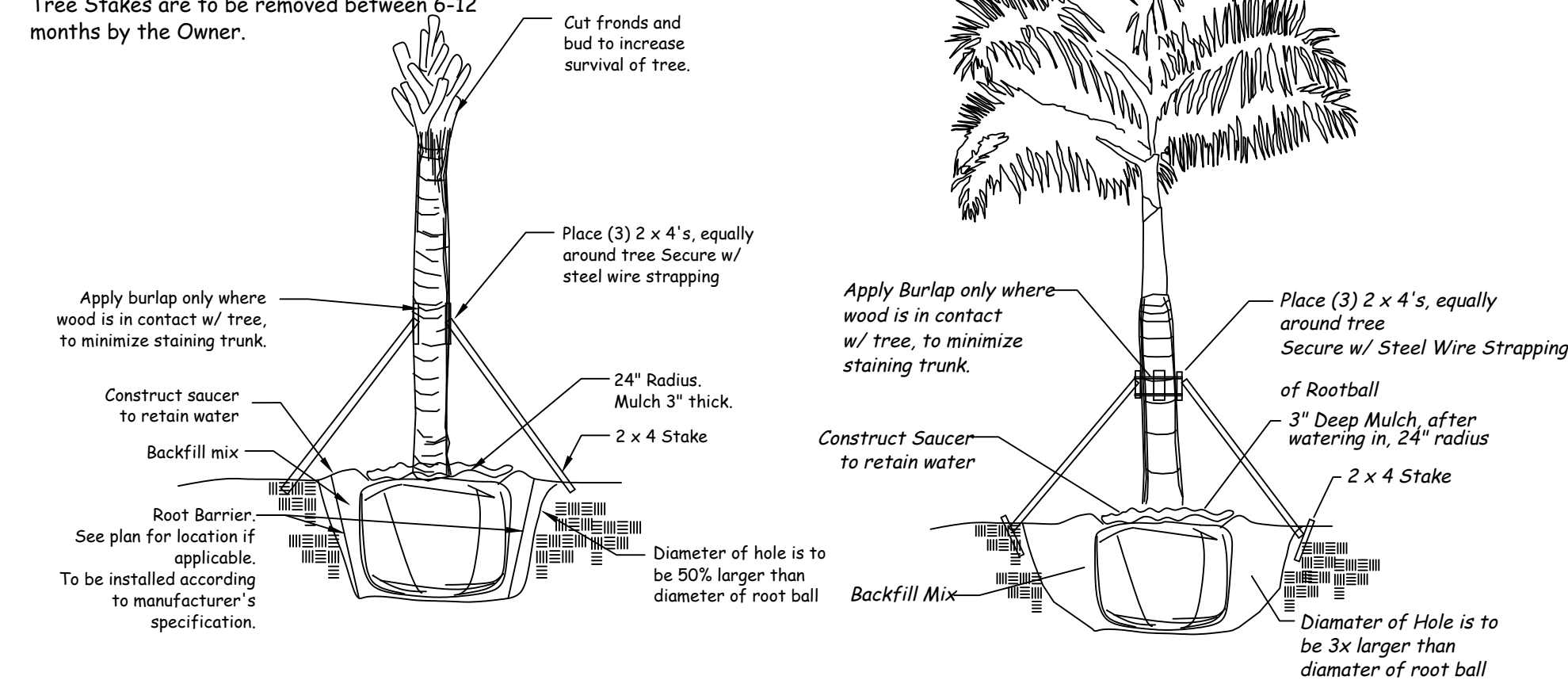

PLANTING SOIL AND BACKFILL

TOPSOIL SHALL CONSIST OF A STABILIZED MIXTURE OF GROUND YARD TRIMMINGS AND POSSIBLY BIOSOLIDS PROCESSED ACCORDING TO STATE OF FLORIDA DEPARTMENT OF ENVIRONMENTAL PROTECTION GUIDELINES FOR THE PROCESSING AND DISTRIBUTION OF SEWAGE SLUDGE COMPOST. RECYCLED TOPSOIL SHALL ONLY BE OBTAINED FROM A STATE PERMITTED RECYCLING FACILITY WHICH IS ALSO D.O.T. CERTIFIED AND STORES PRODUCT ON A PAD WITH A CURRENT NEMATODE CERTIFICATION FROM FLORIDA DEPARTMENT OF AGRICULTURE. RECYCLED TOPSOIL SHALL HAVE THE FOLLOWING CHARACTERISTICS:

- WEED FREE
- MOISTURE CONTENT 50% BY WEIGHT MAXIMUM
- WATER HOLDING CAPACITY 200% BY WEIGHT MINIMUM
- CARBON TO NITROGEN RATIO LESS THAN 25 TO 1
- ORGANIC MATTER CONTENT 40% BY DRY WEIGHT MINIMUM
- SOLUBLE SALTS LESS THAN 3 MMHOS/CM
- PH RANGE 7.0 - 7.9
- MINIMUM NUTRIENT LEVELS AS FOLLOWS:
 - MACRO NUTRIENTS: NITROGEN (N) - 1% MINIMUM, WATER INSOLUBLE NITROGEN 90% MINIMUM, PHOSPHORUS (P) - 0.5% MINIMUM, POTASSIUM (K) - 0.2% MINIMUM AND OTHER MACRO AND MICRO NUTRIENTS. THE RECYCLED TOPSOIL SHALL CONTAIN LEVELS OF THOSE MICRO NUTRIENTS NECESSARY FOR PLANT GROWTH. THESE INCLUDE CALCIUM, MAGNESIUM, SULFUR, BORON, COPPER, IRON, MANGANESE AND MOLYBDENUM. TOPSOIL NOT MEETING THESE REQUIREMENTS WILL NOT BE ACCEPTED.

BACKFILL:

ALL NEW AND TRANSPLANTED PLANT MATERIAL (INCLUDING NEW SOD) SHALL BE PLANTED ONLY AFTER PREPARATION OF EXISTING SOIL AS FOLLOWS: SPREAD A LAYER OF 3" DEPTH OF RECYCLED TOPSOIL (AS DEFINED ABOVE) OVER THE ENTIRE PLANTING AREA. THE TOPSOIL SHALL THEN BE UNIFORMLY DISKED, TILLED OR AERIFIED INTO THE EXISTING SOIL TO A DEPTH OF 12" UNDERNEATH SHRUBS AND GROUNDCOVERS, 6" UNDERNEATH SOD AND TO A DEPTH OF 36" FOR THE TREE PITS, WITH THE FOLLOWING EXCEPTION: NO ROTOTILLING OR DISKING SHALL OCCUR CLOSER TO THE TRUNKS OF ESTABLISHED PLANTS THAN ONE HALF (1/2) THE DISTANCE OF THE CANOPY FURTHER OUT FROM THE DRIP LINE OF THE EXISTING PLANT CANOPY. ALL PLANTS, INCLUDING HEDGES AND GROUND COVER SHALL BE PLANTED IN INDIVIDUALLY DUG HOLES AND THE MATERIAL DUG FROM THE HOLES SHALL THEN BE FURTHER MIXED WITH THE PREPARED SITE SOIL PRIOR TO BACKFILLING OF THE PLANTING HOLES AROUND THE ROOT BALLS. NO ADDITIONAL BACKFILL SOIL SHALL BE USED. AN EXCEPTION ARE PLANTING PITS FOR CABBAGE PALMS, WHICH SHALL BE BACKFILLED WITH CLEAN NATIVE SAND ONLY.

REMOVE EXCESS MATERIAL TO PROVIDE PROPER FINISHED GRADE.

PLANT MATERIALS

TREES, PALMS, SHRUBS, GROUND COVERS:

PLANT SPECIES AND SIZES SHALL CONFORM TO THOSE INDICATED IN THE DRAWINGS. NOMENCLATURE SHALL CONFORM TO STANDARDIZED PLANT NAMES, 1942 EDITION. ALL NURSERY STOCK SHALL BE IN ACCORDANCE WITH GRADES AND STANDARDS FOR NURSERY PLANTS, PARTS I & II, LATEST EDITION PUBLISHED BY THE FLORIDA DEPARTMENT OF AGRICULTURE AND CONSUMER SERVICES, UNLESS SPECIFIED OTHERWISE. ALL PLANTS SHALL BE NORMAL FOR THE VARIETY AND FLORIDA GRADE NUMBER 1 OR BETTER AS DETERMINED BY THE FLORIDA DIVISION OF PLANT INDUSTRY.

SPECIMEN MEANS AN EXCEPTIONALLY HEAVY, SYMMETRICAL, TIGHTLY KNIT PLANT, SO TRAINED OR FAVORED IN ITS DEVELOPMENT THAT FIRST APPEARANCE IS UNQUESTIONABLE AND IT IS OUTSTANDINGLY SUPERIOR IN FORM, NUMBER OF BRANCHES, COMPACTNESS AND SYMMETRY.

ALL PLANTS SHALL BE FRESHLY DUG, SOUND, HEALTHY, VIGOROUS, WELL BRANCHED AND FREE OF DISEASE AND INSECT EGGS AND LARVAE AND SHALL HAVE ADEQUATE ROOT SYSTEMS. TREES FOR PLANTING ROWS SHALL BE UNIFORM IN SIZE AND SHAPE. ALL MATERIALS SHALL BE SUBJECT TO APPROVAL BY THE LANDSCAPE ARCHITECT, WHERE REQUIREMENTS ARE OMITTED FROM THE PLANT LIST. PLANTS SHALL BE PRUNED PRIOR TO DELIVERY ONLY UPON THE APPROVAL OF THE LANDSCAPE ARCHITECT.

ALL CONTAINER GROWN MATERIAL SHALL BE HEALTHY, VIGOROUS, WELL ROOTED PLANTS AND ESTABLISHED IN THE CONTAINER IN WHICH THEY ARE SOLD. THE PLANTS SHALL HAVE TOPS OF GOOD QUALITY AND BE IN HEALTHY GROWING CONDITION. AN ESTABLISHED CONTAINER GROWN PLANT SHALL BE TRANSPLANTED INTO A CONTAINER AND GROWN IN THAT CONTAINER SUFFICIENTLY LONG ENOUGH FOR THE NEW FIBROUS ROOTS TO HAVE DEVELOPED SO THAT THE ROOT MASS WILL RETAIN ITS SHAPE AND HOLD TOGETHER WHEN REMOVED FROM THE CONTAINER.

GENERAL NOTES:

1. THE CONTRACTOR SHALL PERSONALLY ACQUAINT HIM/HER SELF WITH THE EXISTING SITE CONDITIONS AND THE EXTENT AND SCOPE OF WORK REQUIRED.
2. THE PLANT LIST INDICATES THE NAMES, SIZES AND SPACING OF SPECIFIC PLANT MATERIALS. QUANTITIES HAVE BEEN PROVIDED TO THE CONTRACTOR AS A CONVENIENCE. THE CONTRACTOR IS RESPONSIBLE FOR HIS/HER OWN QUANTITY COUNT. IN CASE OF DISCREPANCIES BETWEEN THE DRAWINGS AND PLANT LIST, THE QUANTITIES ON THE PLANT LIST SHALL PREVAIL.
3. NO SUBSTITUTES ON VARIETIES LISTED WILL BE ALLOWED WITHOUT WRITTEN APPROVAL FROM LANDSCAPE ARCHITECT.
4. PLANTS SHALL BE WATERED AS NECESSARY OR WITHIN 24 HOURS AFTER NOTIFICATION BY THE LANDSCAPE ARCHITECT.
5. THE LOCATIONS OF PLANTS, AS SHOWN IN THESE PLANS, ARE APPROXIMATE. THE FINAL LOCATIONS MAY BE ADJUSTED TO ACCOMMODATE UNFORESEEN FIELD CONDITIONS. MAJOR ADJUSTMENTS TO THE LAYOUT ARE TO BE APPROVED BY THE LANDSCAPE ARCHITECT OF RECORD.
6. ALL PLASTIC FABRIC SHALL BE REMOVED FROM PLANT MATERIAL AT TIME OF INSTALLATION.
7. ALL TREES MUST BE STAKED AS SHOWN ON THE LANDSCAPE DETAIL SHEET WITHIN 24 HRS OF PLANTING. STAKES TO REMAIN FOR A MINIMUM OF 12 MONTH BUT NO LONGER THAN 18 MONTH. CONTRACTOR RESPONSIBLE FOR MAINTENANCE AND REMOVAL OF THE STAKES.
8. ALL TREES MUST BE PRUNED AS PER LANDSCAPE ARCHITECT DIRECTION.
9. ALL SOD EDGES SHALL BE TRIMMED AS PER THE LANDSCAPE ARCHITECT'S DIRECTION.
10. ALL SHRUBS, TREES, GROUNDCOVERS, AND SOD AREAS SHALL HAVE IMPROVED SOIL AS PER PLANTING SOIL NOTES.
11. WILDFLOWER AREAS SHALL BE NATIVE TOPSOIL ONLY.
12. DO NOT ALLOW AIR POCKETS TO FORM WHEN BACKFILLING.
13. SOAK PLANTS IMMEDIATELY WITH WATER FOLLOWING PLANTING.
14. MAINTAIN THE ORIGINAL GRADE OF THE TREE BASE.
15. DO NOT BREAK ROOTBALL. SHAVE ROOTBALL OF TREES PER DETAIL BELOW.
16. ALL PLANTS SHALL BE HARDY UNDER CLIMATIC CONDITIONS SIMILAR TO THOSE ON LOCALITY OF THE PROJECT.
17. THE LANDSCAPE CONTRACTOR SHALL WATER, MULCH, WEED, PRUNE, AND OTHERWISE MAINTAIN ALL PLANTS, INCLUDING SOD, UNTIL COMPLETION OF THE CONTRACT OR ACCEPTANCE BY THE LANDSCAPE ARCHITECT. SETTLED PLANTS SHALL BE RESET TO PROPER GRADE, PLANTING SAUCERS RESTORED, AND DEFECTIVE WORK CORRECTED.
18. THE LANDSCAPE CONTRACTOR SHALL AT ALL TIMES KEEP THE PREMISES FREE FROM ACCUMULATION OF WASTE MATERIALS OR DEBRIS CAUSED BY THE CREWS DURING THE PERFORMANCE OF THE WORK. UPON COMPLETION OF THE WORK, THE CONTRACTOR SHALL PROMPTLY REMOVE ALL WASTE MATERIALS, DEBRIS, UNUSED PLANT MATERIAL, EMPTY PLANT CONTAINERS AND ALL EQUIPMENT FROM THE PROJECT SITE.
19. UPON COMPLETION OF THE WORK, THE LANDSCAPE CONTRACTOR SHALL NOTIFY THE LANDSCAPE ARCHITECT AND REQUEST A FINAL INSPECTION. ANY ITEMS THAT ARE JUDGED INCOMPLETE OR UNACCEPTABLE BY THE LANDSCAPE ARCHITECT OR REPRESENTATIVE SHALL BE PROMPTLY CORRECTED BY THE LANDSCAPE CONTRACTOR.
20. THE LANDSCAPE CONTRACTOR SHALL GUARANTEE ALL PLANT MATERIAL FOR A PERIOD OF ONE (1) YEAR FROM THE DATE OF FINAL ACCEPTANCE IN WRITING FROM THE LANDSCAPE ARCHITECT. AT THE TIME OF FINAL ACCEPTANCE THE ONE (1) YEAR PERIOD SHALL COMMENCE. ANY MATERIALS WHICH HAVE DIED DURING THIS PERIOD SHALL BE PROMPTLY REPLACED WITH SPECIMENS THAT MEET THE MINIMUM REQUIREMENTS CALLED FOR IN THE DRAWINGS. THE LANDSCAPE CONTRACTOR SHALL NOT BE HELD RESPONSIBLE FOR THE DEATH OR DAMAGE RESULTING FROM LIGHTNING, VANDALISM, AUTOMOBILES OR FROM NEGLIGENCE BY THE OWNER. CONTRACTOR SHALL BE RESPONSIBLE FOR WATERING AND OTHERWISE MAINTAINING PLANTS DURING THE GUARANTEE PERIOD UNLESS A WRITTEN AGREEMENT WITH THE LANDSCAPE ARCHITECT PROVIDES FOR A DIFFERENT ARRANGEMENT.
21. ALL LABOR AND MATERIAL FOR SOIL AMENDMENTS AND FERTILIZER THAT IS REQUIRED TO INSURE THE SUCCESSFUL ESTABLISHMENT AND SURVIVAL OF THE PROPOSED VEGETATION AS WELL AS ALL COST FOR THE REMOVAL OF UNSUITABLE OR EXCESS BACKFILL MATERIAL SHALL BE INCLUDED IN THE CONTRACTORS BID TO PERFORM THE WORK PRESENTED IN THIS PLAN SET.
22. NO LANDSCAPING ADDED UNDER THIS PROJECT SHALL BE LOCATED SUCH THAT SAID LANDSCAPING OBSCURES MOTORIST'S VISIBILITY OF ANY EXISTING SIGN(S).
23. 100% OF REQUIRED SHRUBS ARE DROUGHT TOLERANT.

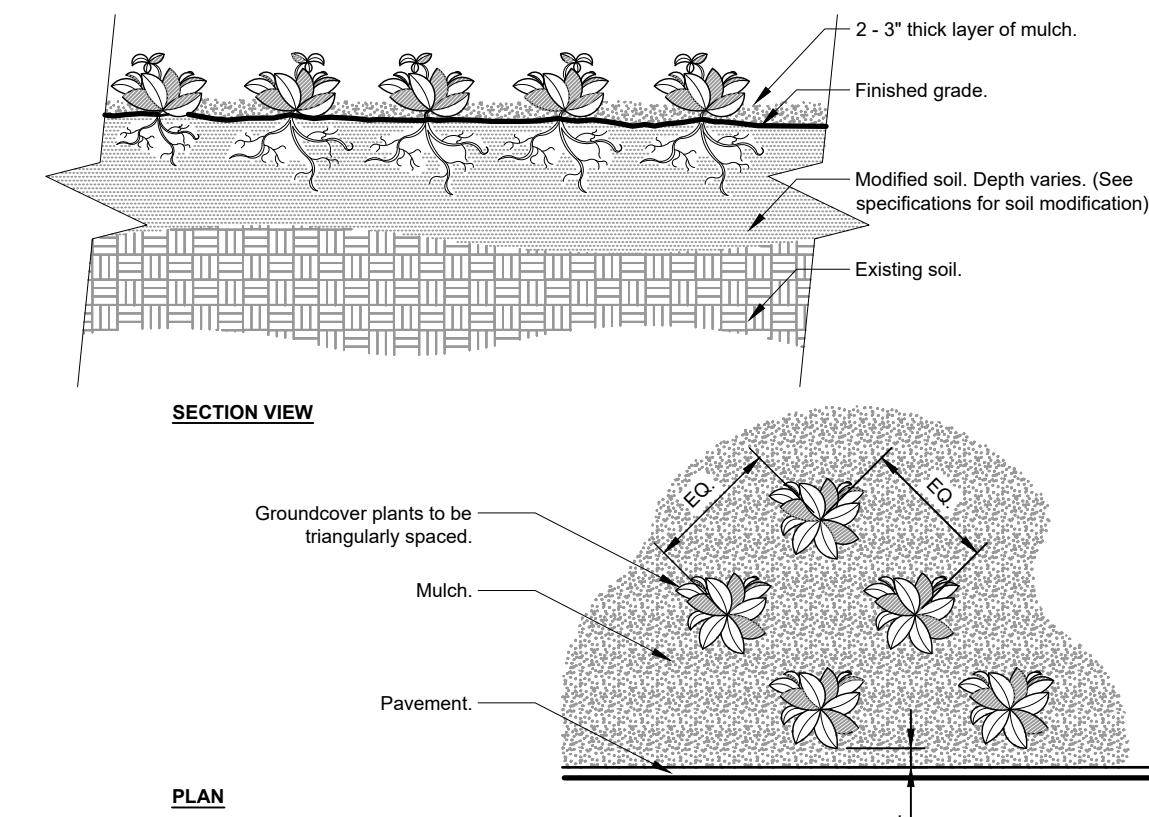

Notes:
1- See planting legend for groundcover species, size, and spacing dimension.
2- Small roots (1/2" or less) that grow around, up, or down the root ball periphery are considered a normal condition in container production and are acceptable however they should be eliminated at the time of planting. Roots on the periphery can be removed at the time of planting. (See root ball shaving container detail).
3- Settle soil around root ball of each groundcover prior to mulching.

GROUNDCOVER

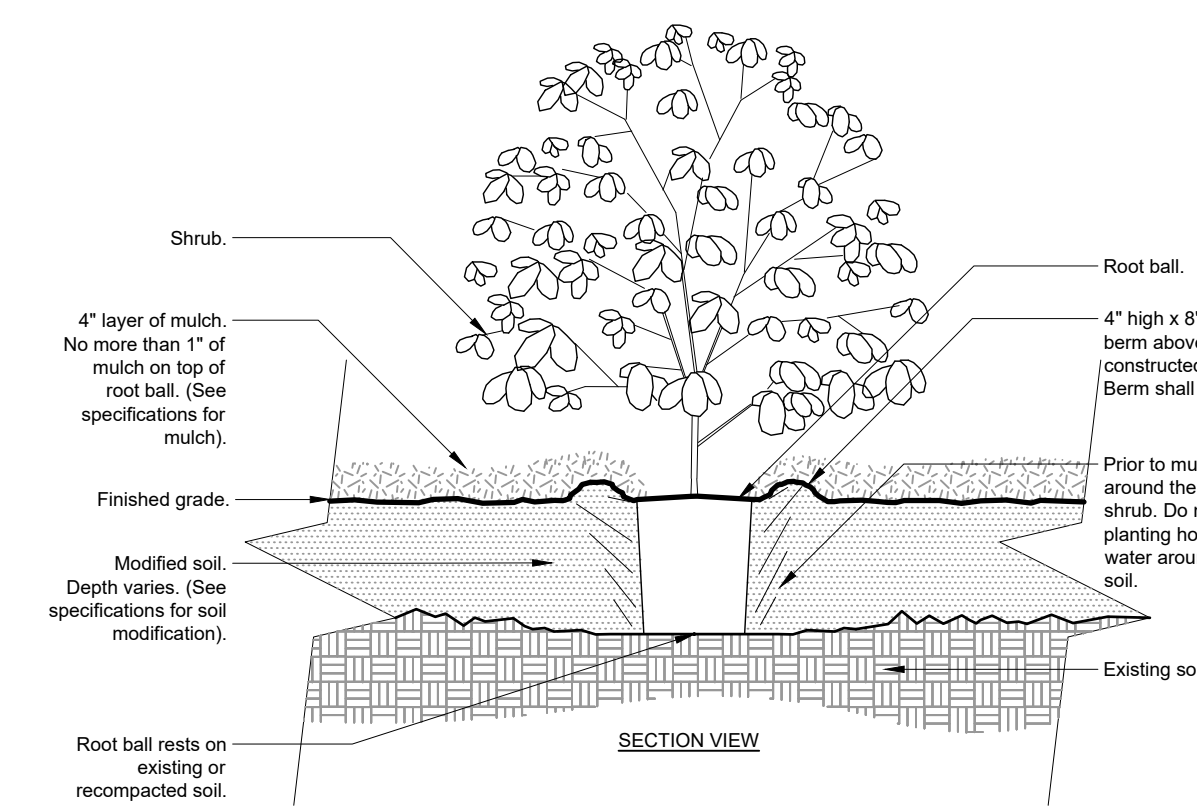

Notes:
1- Shrubs shall be of quality prescribed in the root observations detail and specifications.
2- See specifications for further requirements related to this detail.

SHRUB - MODIFIED SOIL

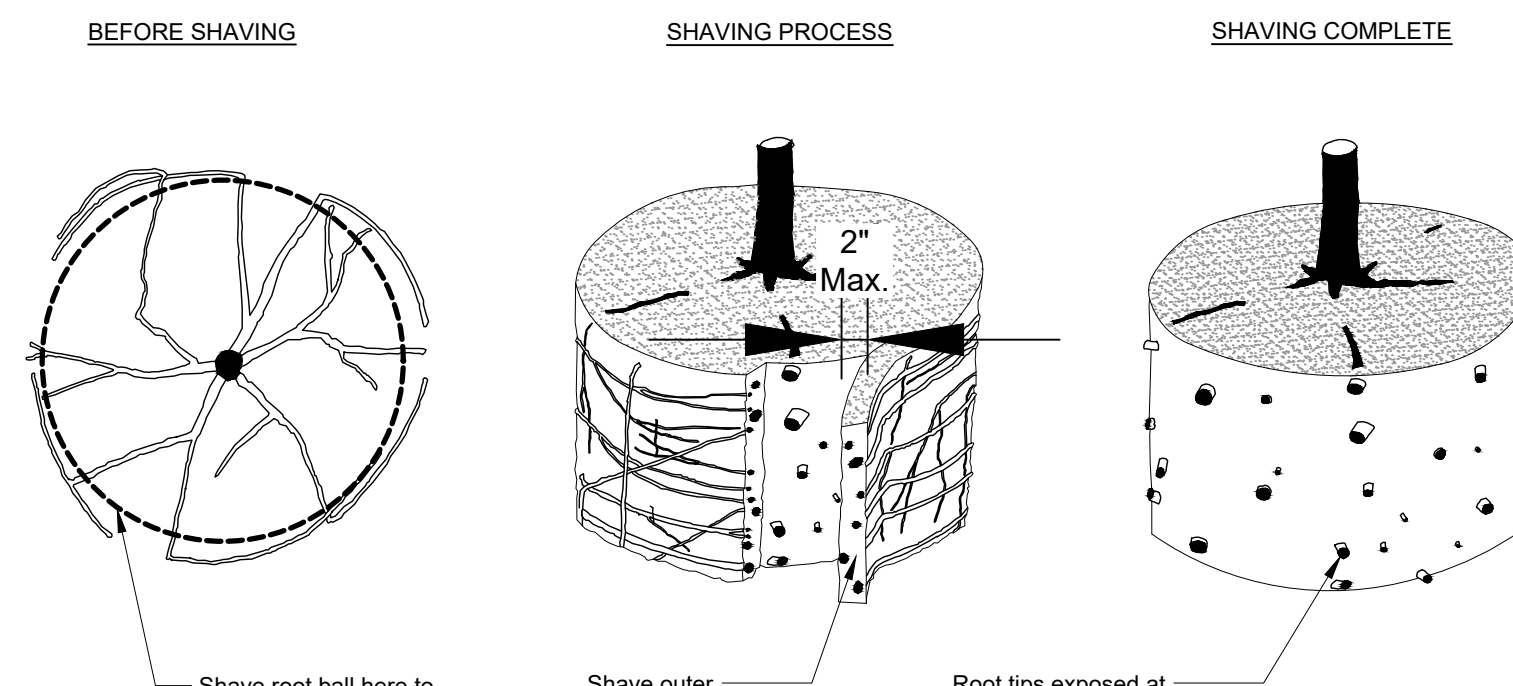

Notes:
1- Shaving to be conducted using a sharp blade or hand saw eliminating no more than needed to remove all roots on the periphery of root ball.
2- Shaving can be performed just prior to planting or after placing in the hole.

ROOT BALL SHAVING CONTAINER DETAIL

Watering Schedule			
Item	Water	Month	No. of Applications
Palms	20 gal	1	12
Large Trees	30 gal	2	12
Small Trees	20 gal	3	8
Large Shrubs	10 gal	4	8
Small Shrubs	5 gal	5	5
Groundcover	5 gal		
Total Applications			45

Gravel Strip Detail

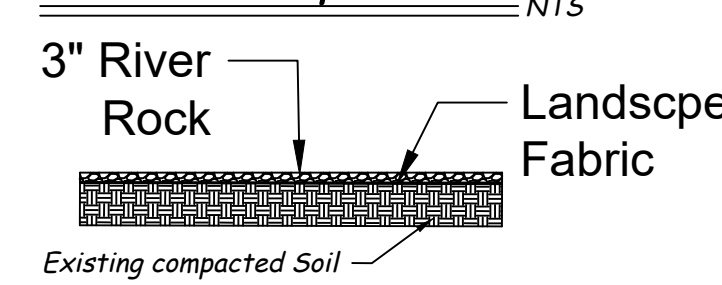

Planting Edge at Sod Detail

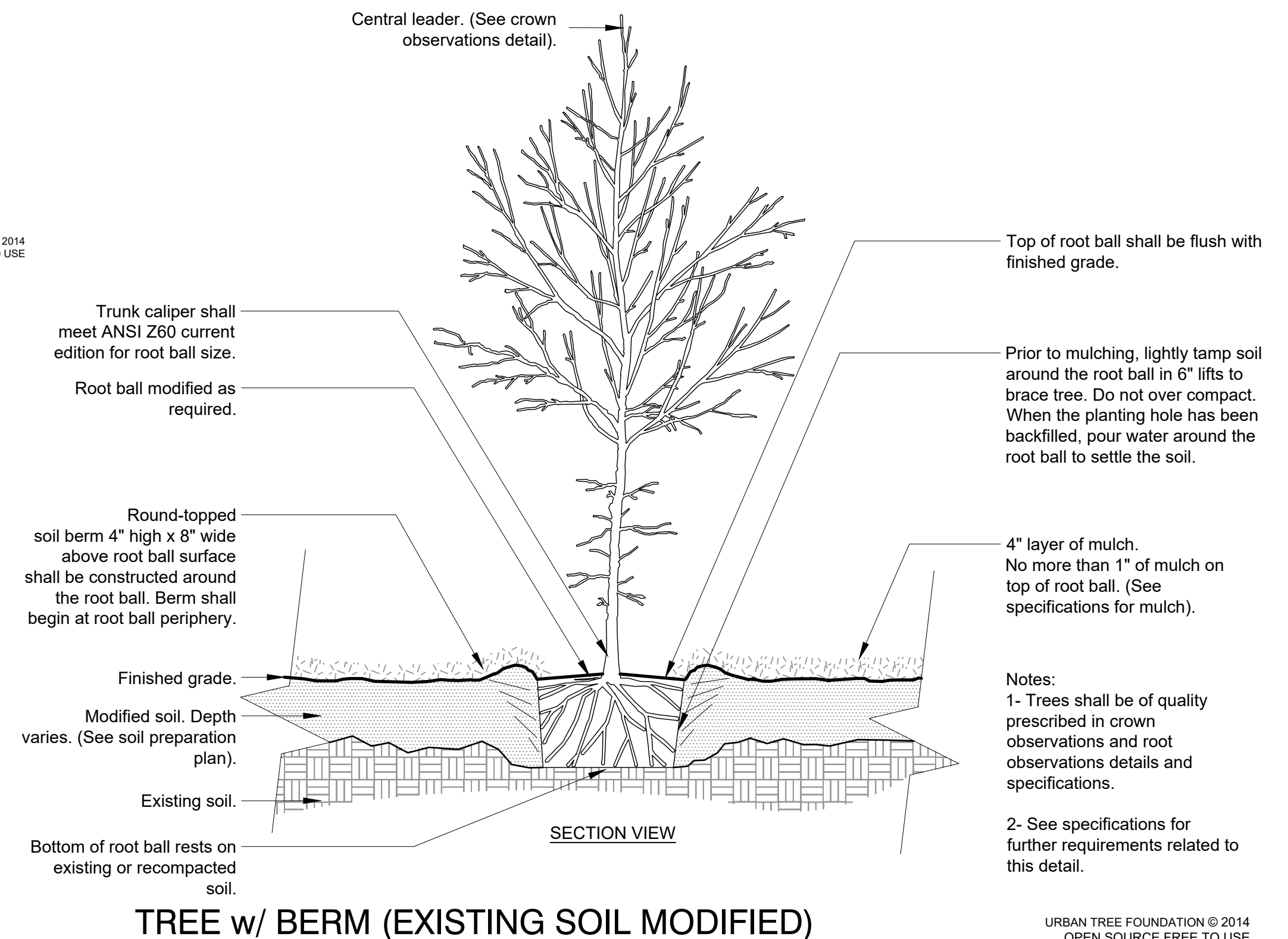
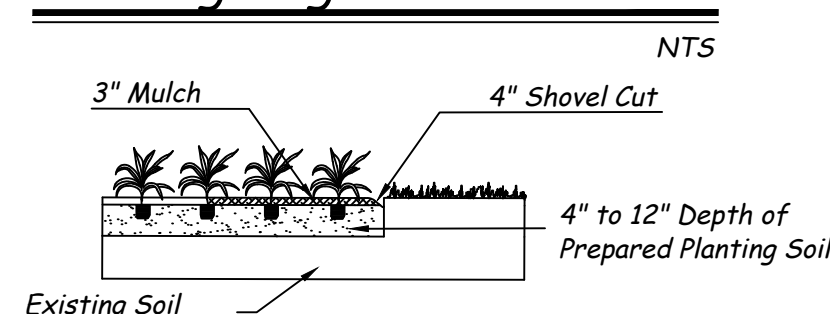

TREE w/ BERM (EXISTING SOIL MODIFIED)

URBAN TREE FOUNDATION © 2014
OPEN SOURCE FREE TO USE

PSLUSD File # 5360D
City of Port St. Lucie Project No P22-143

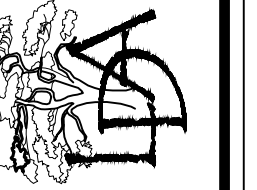

Scale:	1" = 10'
Drawn by:	CA
Checked by:	SM
CADD No.:	22-021 Dragonfly LP.dwg
Date:	04.21.22

Revisions	Date	Comments
1	4-21-22 CA	Revised LP per new base
2	01-12-23	Per staff comments
3	02-09-23	Enhanced west buffer
4	02-14-23	Updated tree species
5	03-24-23	Per PSLUSD Comments

DRAGONFLY TREE & LANDSCAPE ARCHITECTS, INC. 1000 W. PALM BLVD. SUITE 100 PORT ST. LUCIE, FL 34952
PH: 888-888-8888 FAX: 888-888-8888
WWW.DRAGONFLYTREE.COM



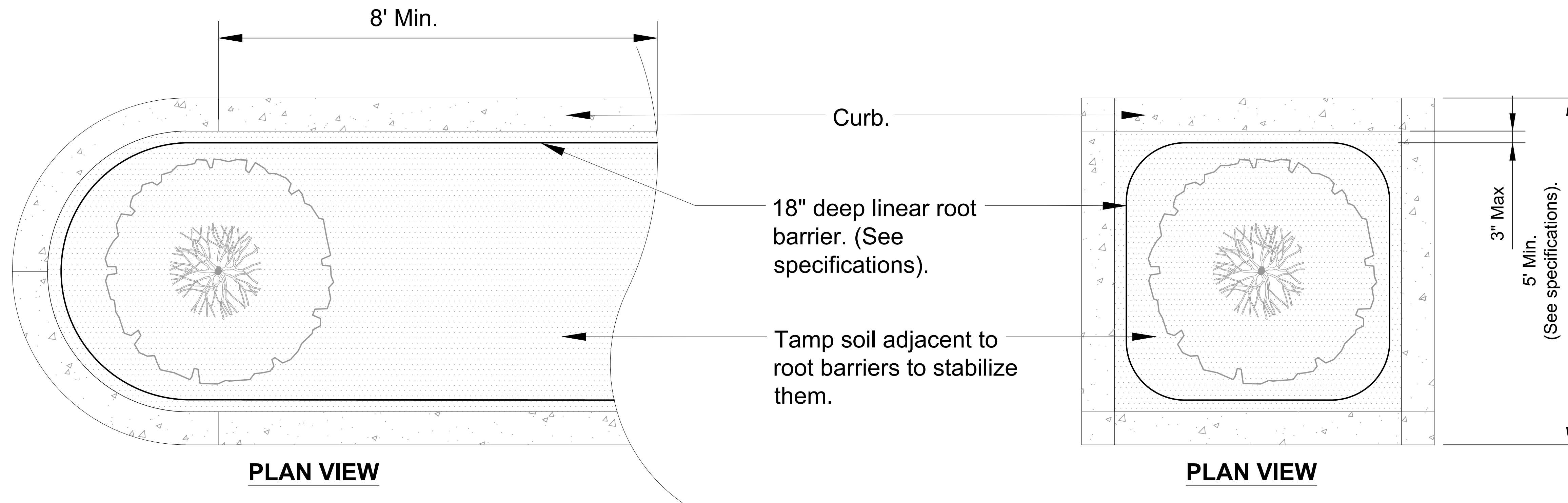

PLAN VIEW

PLAN VIEW

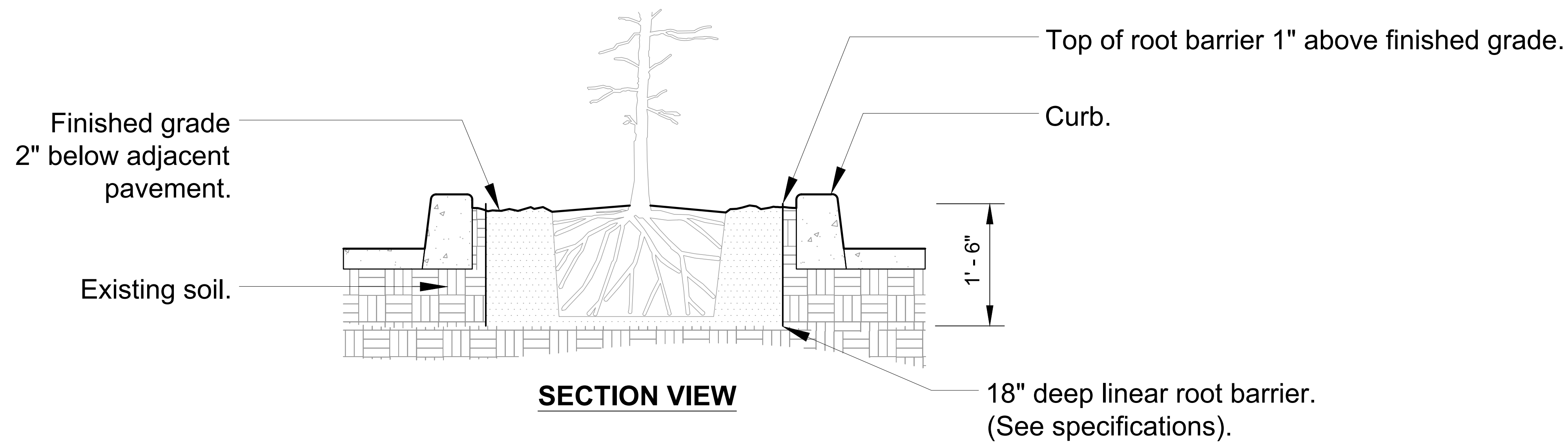

SECTION VIEW

Notes:

- 1- Root barriers shall be installed per manufacturer's specifications and recommendations.
- 2- Root barriers shall be installed when root ball is located within 6' of pavement.

ROOT BARRIERS - PARKING LOT ISLANDS

URBAN TREE FOUNDATION © 2014
OPEN SOURCE FREE TO USE

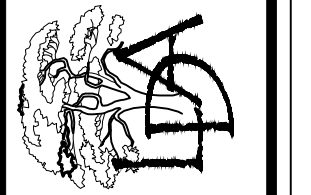

Scale:	1" = 100'
Drawn by:	CA
Checked by:	SM
CADD No.:	22-021 Dragonfly LP.dwg
Date:	04.21.22

Date	Comments
4.21.22 CA	Revised LP per new base
01.12.23	Per staff comments
02.09.23	Enhanced west buffer
02.14.23	Updated tree species
03.24.23	Per PSLUSD Comments

IF YOU ARE THE DESIGNER OR ARCHITECT FOR THIS PROJECT, YOU MAY NOT REPRODUCE OR TRANSMIT THIS INFORMATION WITHOUT WRITING TO THE AUTHOR.

