

Project Team:

Client & Property Owner:
Midway Glades Developers, LLC
7807 Baymeadows Road East, Suite 205
Jacksonville, Florida 32256

Land Planner / Landscape Architect:
Lucido & Associates
701 East Ocean Boulevard
Stuart, Florida 34994

Engineer:
Kawley Horn & Associates
1000 S. US Highway 1
Suite 200
Vero Beach, Florida 32960

Surveyor:
Culpepper & Terpening, Inc.
2500 US Highway 1
Fort Pierce, Florida 34981

Traffic Engineer:
Mechanical Engineering & Planning, Inc.
1172 SW 30th Street
Suite 500
Palm City, Florida 34980

Environmental Consultant:
EIM Consultants
1000 SE Mariner Commons Blvd.
Suite 205
Stuart, Florida 34956

LTC Ranch DRI

Proposed Future Land Use Plan

City of Port St. Lucie

Date	By	Description
16SEP20	SJS	Submittal
11DEC20	SJS	SLC - School Comments

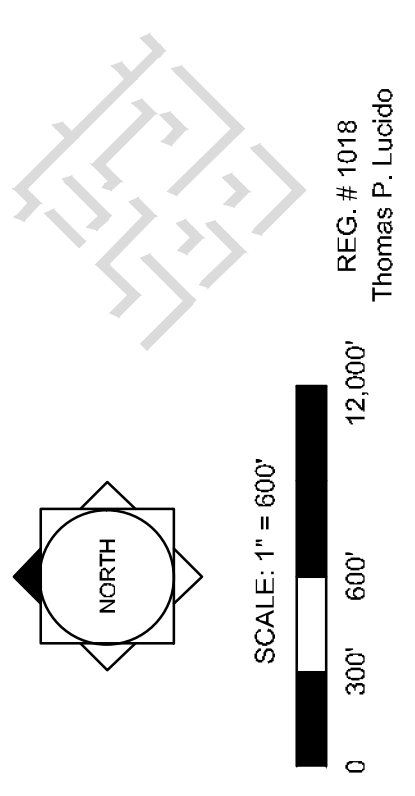

Designer: SJS
Manager: SG
Project Number: 20-535
Municipal Number: ---
Computer File: 20-535 - LTC - Proposed Future Land Use Plan.dwg

Sheet: **1 of 1**

© Copyright Lucido & Associates. These documents and their contents are the property of Lucido & Associates. Any reproductions, resellers, modifications or use of these documents without the express written consent of Lucido & Associates is prohibited by law.

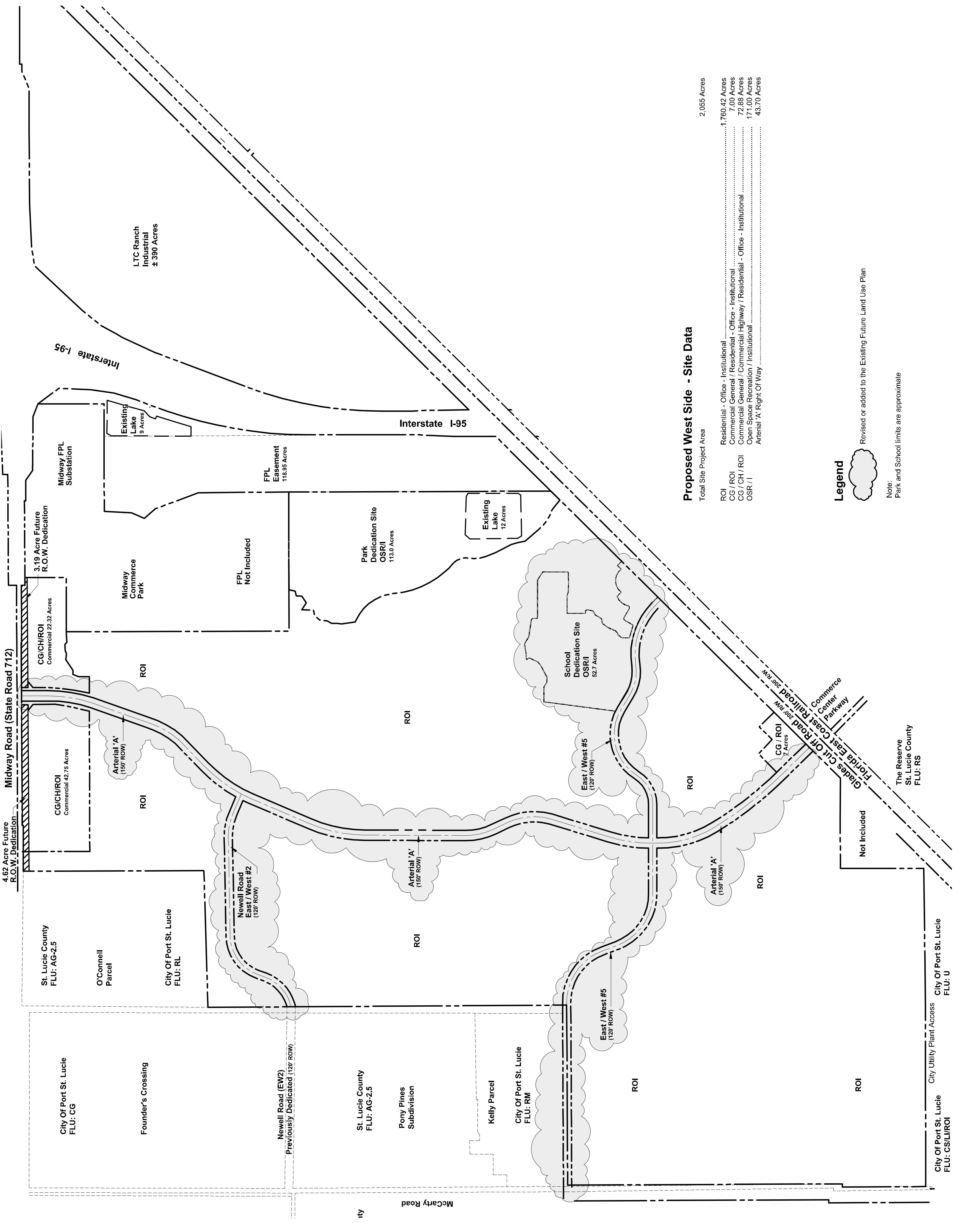

Proposed West Side - Site Data

Category	Area
Total Site Project Area	2,055 Acres
ROI	1,760.42 Acres
CG / ROI	7.00 Acres
CG / CH / ROI	72.88 Acres
OSR / I	171.00 Acres
Arterial 'A' Right Of Way	43.70 Acres

Legend



Revised or added to the Existing Future Land Use Plan

Note:
Park and School limits are approximate

The Reserve
St. Lucie County
FLU: RS

City Of Port St. Lucie
FLU: U

City Of Port St. Lucie
FLU: CS/LIRO

City Utility Plant Access

City Of Port St. Lucie
FLU: RL

City Of Port St. Lucie
FLU: AG-2.5

City Of Port St. Lucie
FLU: RM

City Of Port St. Lucie
FLU: AG-2.5

City Of Port St. Lucie
FLU: RL

City Of Port St. Lucie
FLU: AG-2.5

City Of Port St. Lucie
FLU: RL

City Of Port St. Lucie
FLU: AG-2.5

City Of Port St. Lucie
FLU: RL

City Of Port St. Lucie
FLU: AG-2.5

City Of Port St. Lucie
FLU: RL

City Of Port St. Lucie
FLU: AG-2.5

City Of Port St. Lucie
FLU: RL