

Landscape Data:

Trees:

Exterior Landscaping:	
North Buffer: 1265 lf, 1 tree/30 lf =	42 Trees
East Roadway Buffer: 1217'-88' driveway= 1144 lf, 1 tree/30 lf	38 Trees
Understory/Flowering Trees:	37 Trees
South Roadway Buffer: 1232'-97' driveway=1120 lf, 1 tree/30 lf =	37 Trees
Understory/Flowering Trees:	28 Trees
West Buffer 834 lf, 1 tree/30 lf=	28 Trees
Total Exterior Trees required	221 Trees
Total Exterior Trees provided	221 Trees
Facade Landscaping:	
Front of Building: 1165 lf, 1 tree/30 lf	39 Trees
Total Facade Trees Required	39 Trees
Total Facade Trees Provided	39 Trees
Interior Landscaping:	
69 Parking Islands, 1 tree/island, =	69 Trees
Total Interior Shade Trees Provided:	69 Trees
Total Trees Required:	329 Trees
Total Trees Provided:	329 Trees

General Notes:

1. All landscape material to be Florida No.1
2. All landscaping meets FDOT clearzone and sight distance criteria.
3. All trees installed within 4' of a hard surface such as sidewalk, curb or building to be installed with 24" rootbarrier per detail on sheet LD-06. Rootbarrier to extend 5' in each direction, measured from center of trunk.
4. Quantities are given for contractor convenience only. In case of discrepancy between tags and plant list, the plant list shall prevail.

Notes:

1. Less than 50% of the required trees are palm trees.
2. 78% of the required trees are native
3. 28% of the required trees are flowering trees
4. 95% of the required trees located within landscape Islands are shade trees.
5. 100% of the required trees are low water use.
6. 100% of the required shrubs are moderate to low water use.
7. All sod to be St. Augustine 'Floritam', weed free and laid tight, unless otherwise noted.

PSLUSD Notes:

1. No landscaping shall be planted in a manner that would adversely affect utility easements.
2. Landscaping shall be in compliance with Chapter 153 of the City of Port St. Lucie Code of Ordinances, PSLUSD technical specifications and policies.
3. All landscaping within City utility easements shall comply with PSLUSD technical specifications, policies, and codes.
4. All landscaping shall meet the latest PSLUSD Landscape Policy and shall not be placed in a manner that would create conflicts with the intended operation and maintenance of any existing utility.
5. Trees shall not be planted within ten (10) feet of any PSLUSD underground infrastructure.
6. No landscaping other than sod grasses shall be located within 5' of a PSLUSD appurtenance such as a water meter assembly, backflow device, fire hydrant or sewer cleanout, etc.

Landscape Irrigation Notes:

- All areas to receive 100% irrigation coverage
- All zones to be automatically controlled.
- Clocks to have automatic "Rain sensors".
- Water source may be potable or well and shall be determined at time of building permit application

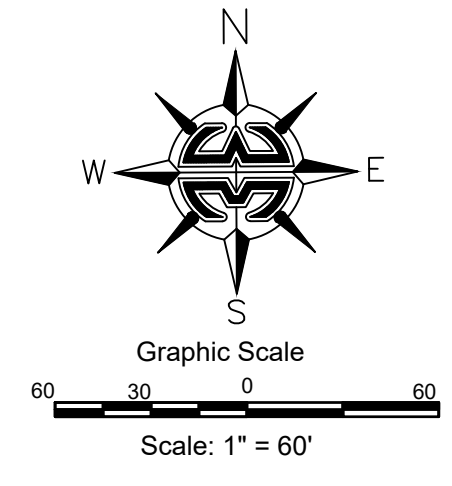

PSLUSD File #5360E
City of Port St. Lucie Project No P21-096

Landscape Design Associates

25110 NW 182nd Ave
High Springs, FL 32643
352-710-5765 ph, www.landscape.com

Scale:	1" = 60"
Drawn by:	SM
Checked by:	SM
CADD No.:	20-124Spec 2 lp.dwg
Date:	6.21.21

Revisions	Comments
Date	per staff comments
7.02.21	

I, JIM BIRKLAND, LANDSCAPE ARCHITECT, AMERICAN SOCIETY OF LANDSCAPE ARCHITECTS, AND I HEREBY CERTIFY THAT I AM THE AUTHOR OF THIS PLAN AND THAT I AM A LICENSED PROFESSIONAL LANDSCAPE ARCHITECT IN THE STATE OF FLORIDA.

Legacy Park - Spec 2
 City of Port St Lucie
Overall Landscape Plan

7.02.21
LD-01

Match Line LD-03

Match Line LD-07

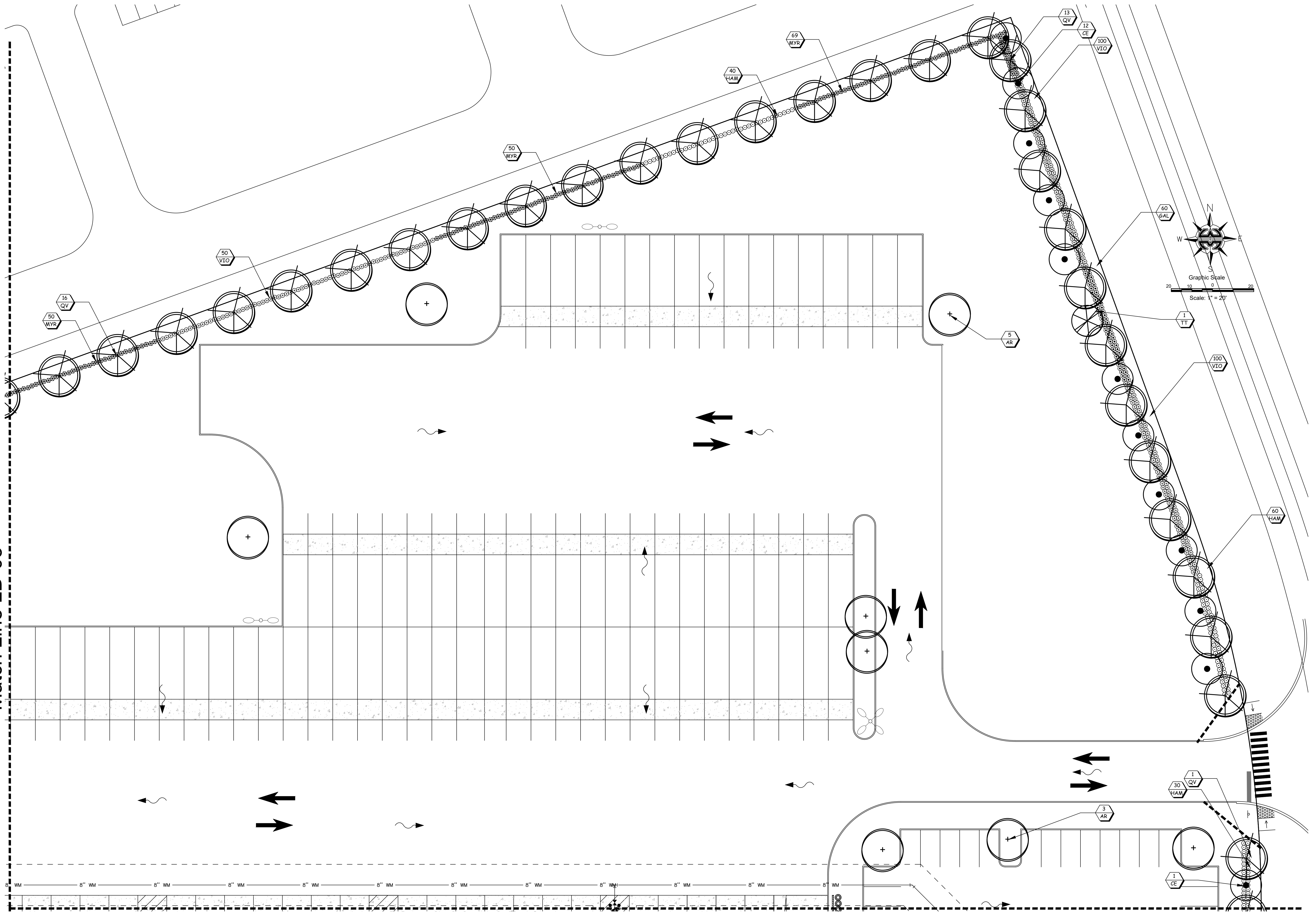

Landscape Design Associates
 25110 NW 182nd Ave
 High Springs, FL 32643
 352-210-5765 ph, www.landscapeda.com

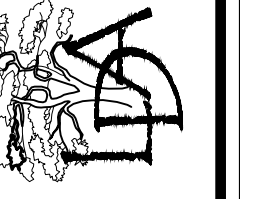

Scale:	1" = 20'
Drawn by:	SM
Checked by:	SM
CADD No.:	20-124Spec 2 lp.dwg
Date:	6.21.21

Revisions	Comments	Date
	per staff comments	7.02.21

© 2011 LANDSCAPE DESIGN ASSOCIATES, INC. ALL RIGHTS RESERVED. THIS DOCUMENT IS THE PROPERTY OF LANDSCAPE DESIGN ASSOCIATES, INC. AND IS NOT TO BE REPRODUCED OR TRANSMITTED IN ANY FORM OR BY ANY MEANS, ELECTRONIC OR MECHANICAL, WITHOUT PERMISSION IN WRITING FROM LANDSCAPE DESIGN ASSOCIATES, INC.

Legacy Park - Spec 2
 City of Port St Lucie
Landscape Plan

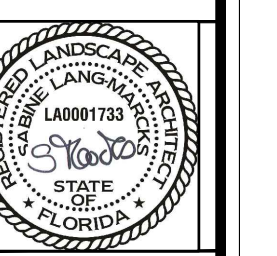

7.02.21
 LD-02

PSLUSD File #5360E
 City of Port St. Lucie Project No P21-096

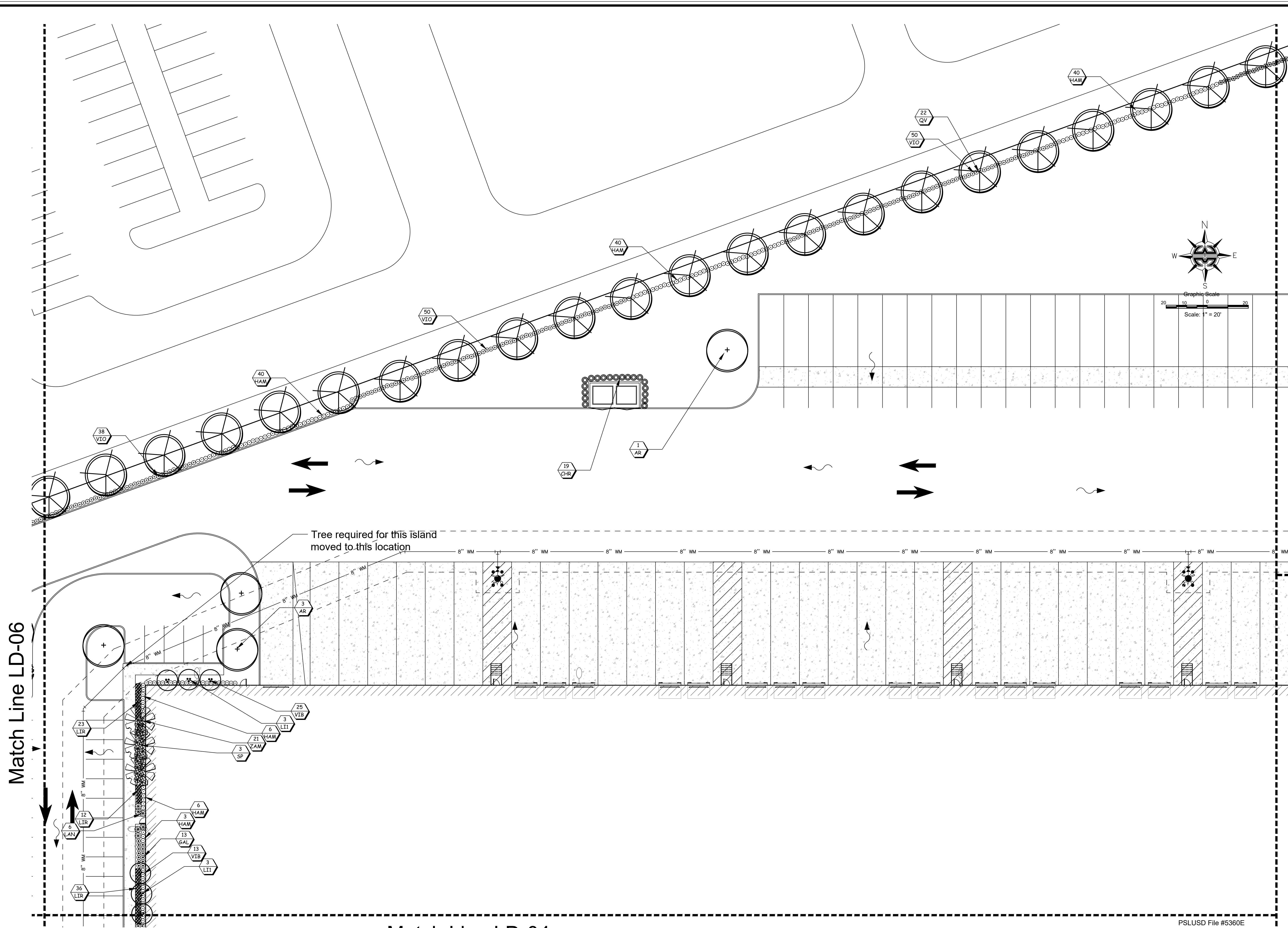

Tree required for this island moved to this location

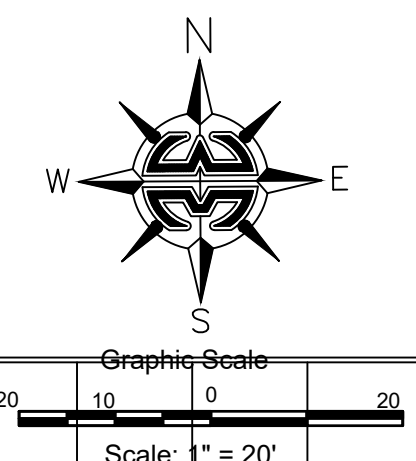

Match Line LD-06

Match Line LD-07

Match Line LD-04

Match Line LD-02

Landscape Design Associates
 25110 NW 182nd Ave
 High Springs, FL 32643
 352-710-5765 ph, www.landscape.com

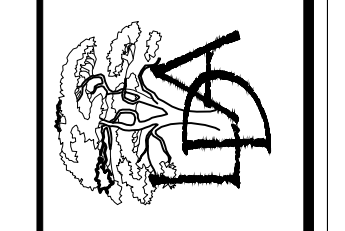

Scale:	1" = 20'
Drawn by:	SM
Checked by:	SM
CADD No.:	20-124Spec 2 lp.dwg
Date:	6.21.21

Revisions	Date	Comments
	7.02.21	per staff comments

© 2000 LANDSCAPE DESIGN ASSOCIATES, INC. ALL RIGHTS RESERVED. THIS DOCUMENT IS THE PROPERTY OF LANDSCAPE DESIGN ASSOCIATES, INC. AND IS TO BE USED ONLY FOR THE PROJECT AND SITE SPECIFICALLY IDENTIFIED HEREIN. NO PART OF THIS DOCUMENT IS TO BE REPRODUCED OR TRANSMITTED IN ANY FORM OR BY ANY MEANS, ELECTRONIC OR MECHANICAL, WITHOUT PERMISSION IN WRITING FROM LANDSCAPE DESIGN ASSOCIATES, INC.

Legacy Park - Spec 2
 City of Port St Lucie
 Landscape Plan

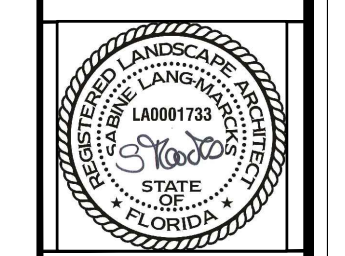

PSLUSD File #5360E
 City of Port St. Lucie Project No P21-096

7.02.21
 LD-03

Match Line LD-03

Match Line LD-06

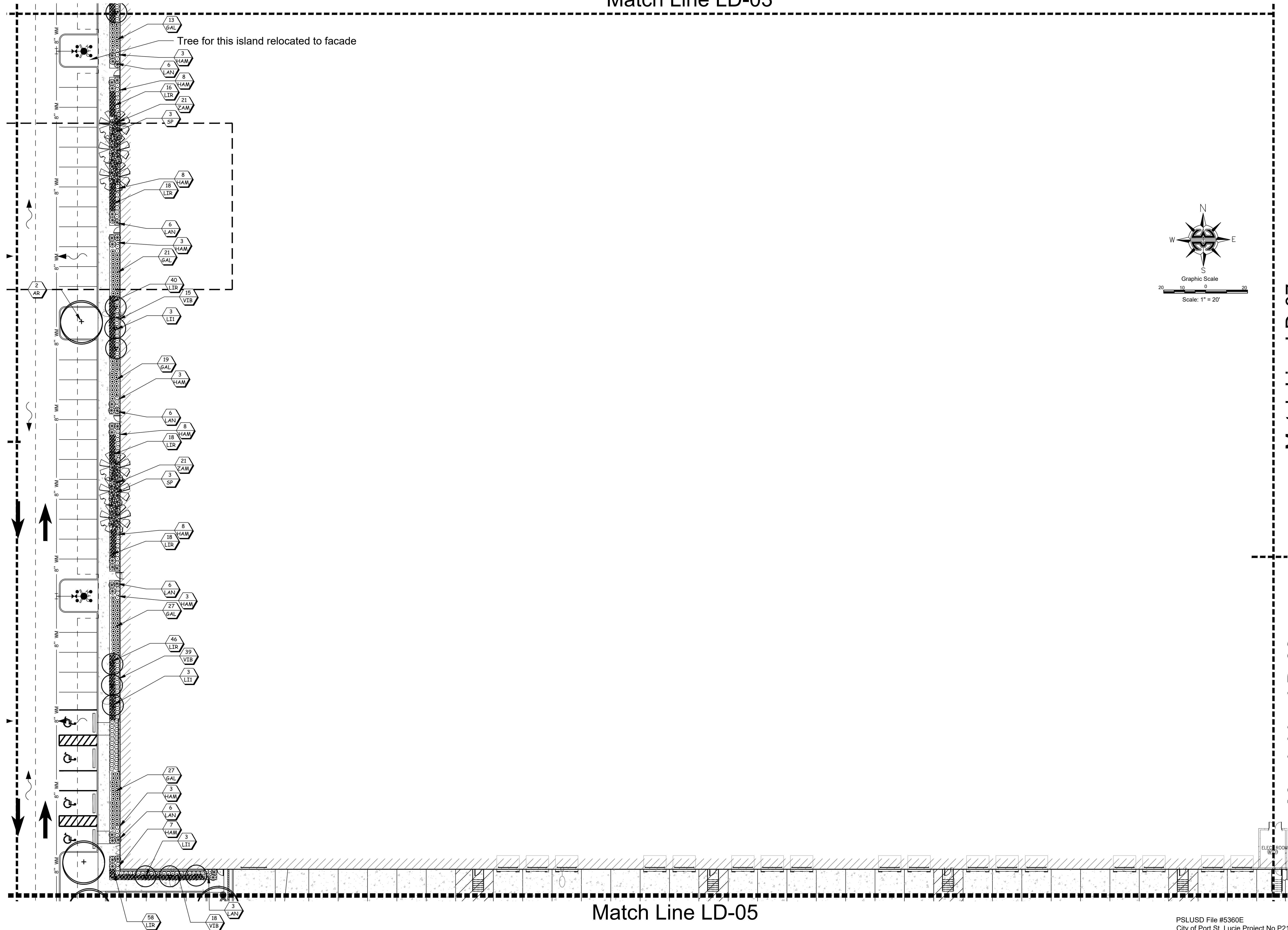

Match Line LD-05

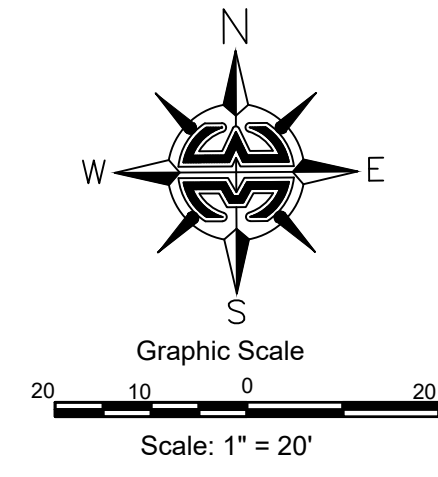

Match Line LD-07

Match Line LD-08

Legacy Park - Spec 2
City of Port St Lucie
Landscape Plan

Landscape Design Associates
25110 NW 182nd Ave
High Springs, FL 32643
352-710-5765 ph, www.landscapeda.com

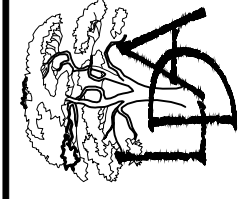

Revisions	Date	Comments
	7.02.21	per staff comments

Scale: 1" = 20'
Drawn by: SM
Checked by: SM
CADD No.: 20-124Spec 2 lp.dwg
Date: 6.21.21

© 2007 LANDSCAPE DESIGN ASSOCIATES, INC. ALL RIGHTS RESERVED. THIS DOCUMENT IS THE PROPERTY OF LANDSCAPE DESIGN ASSOCIATES, INC. AND IS NOT TO BE REPRODUCED OR TRANSMITTED IN ANY FORM OR BY ANY MEANS, ELECTRONIC OR MECHANICAL, WITHOUT PERMISSION IN WRITING FROM LANDSCAPE DESIGN ASSOCIATES, INC.

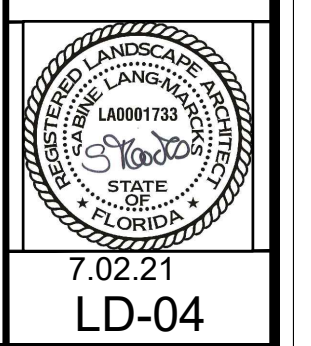

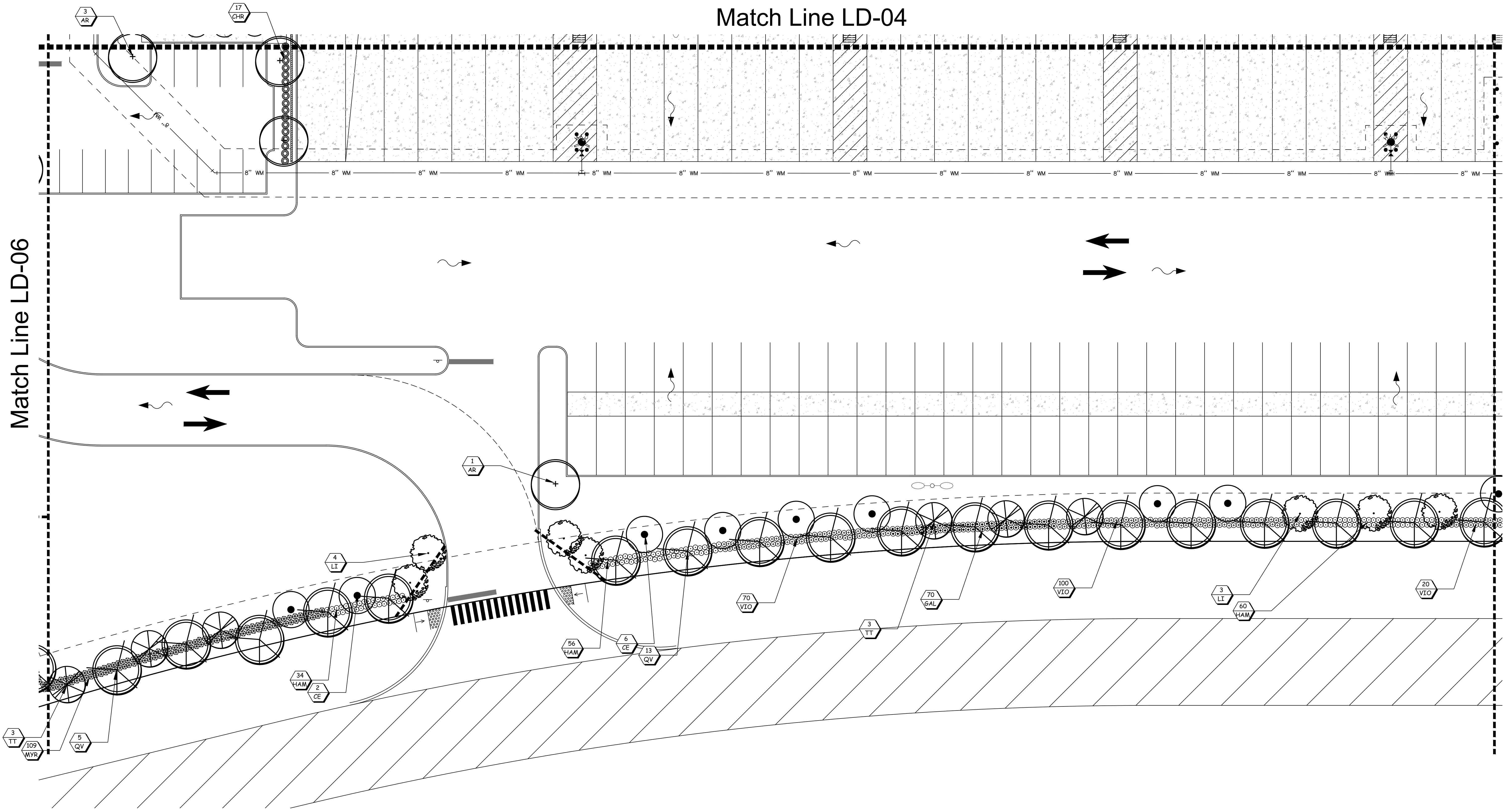

Match Line LD-06

Match Line LD-04

Match Line LD-08

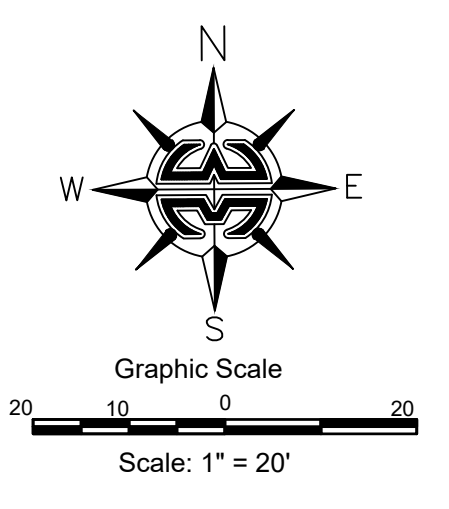

PSLUSD File #5360E
City of Port St. Lucie Project No P21-096

Landscape Design Associates
25110 NW 182nd Ave
High Springs, FL 32643
352-210-5765 ph, www.landscape.com

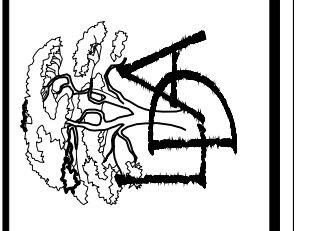

Scale:	1" = 20'
Drawn by:	SM
Checked by:	SM
CADD No.:	20-124Spec 2 lp.dwg
Date:	6.21.21

Revisions	Date	Comments
	7.02.21	per staff comments

© 2011 LANDSCAPE DESIGN ASSOCIATES, INC. ALL RIGHTS RESERVED. THIS DOCUMENT IS THE PROPERTY OF LANDSCAPE DESIGN ASSOCIATES, INC. AND IS NOT TO BE REPRODUCED OR TRANSMITTED IN ANY FORM OR BY ANY MEANS, ELECTRONIC OR MECHANICAL, WITHOUT PERMISSION IN WRITING FROM LANDSCAPE DESIGN ASSOCIATES, INC.

Legacy Park - Spec 2
City of Port St Lucie
Landscape Plan

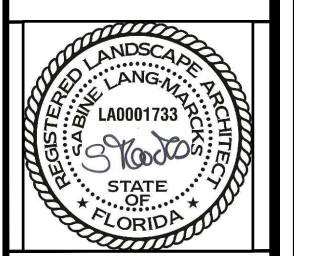

LD-05

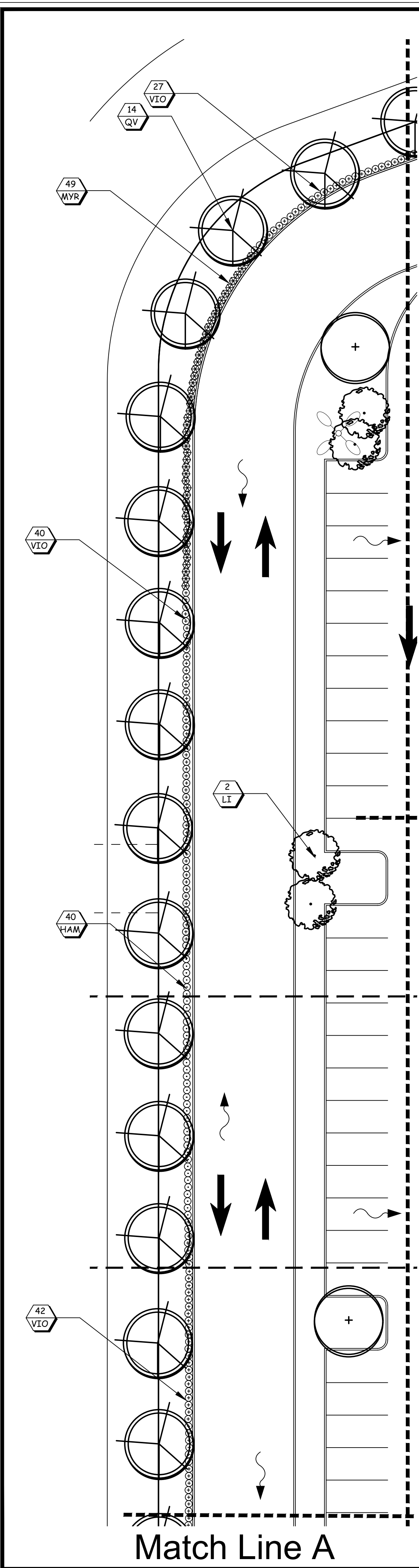

Match Line LD-03

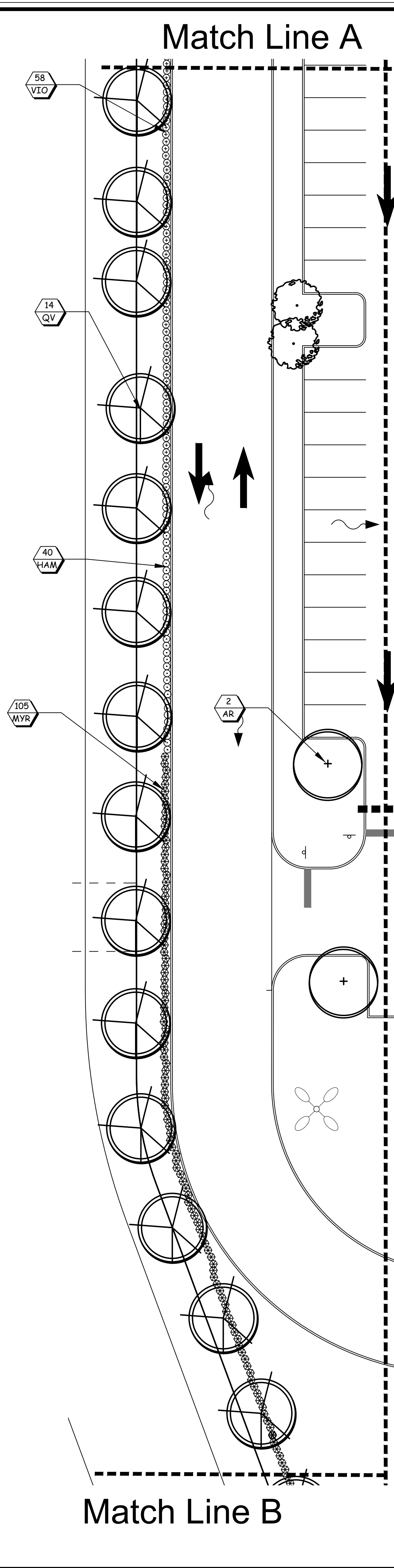

Match Line A

Match Line B

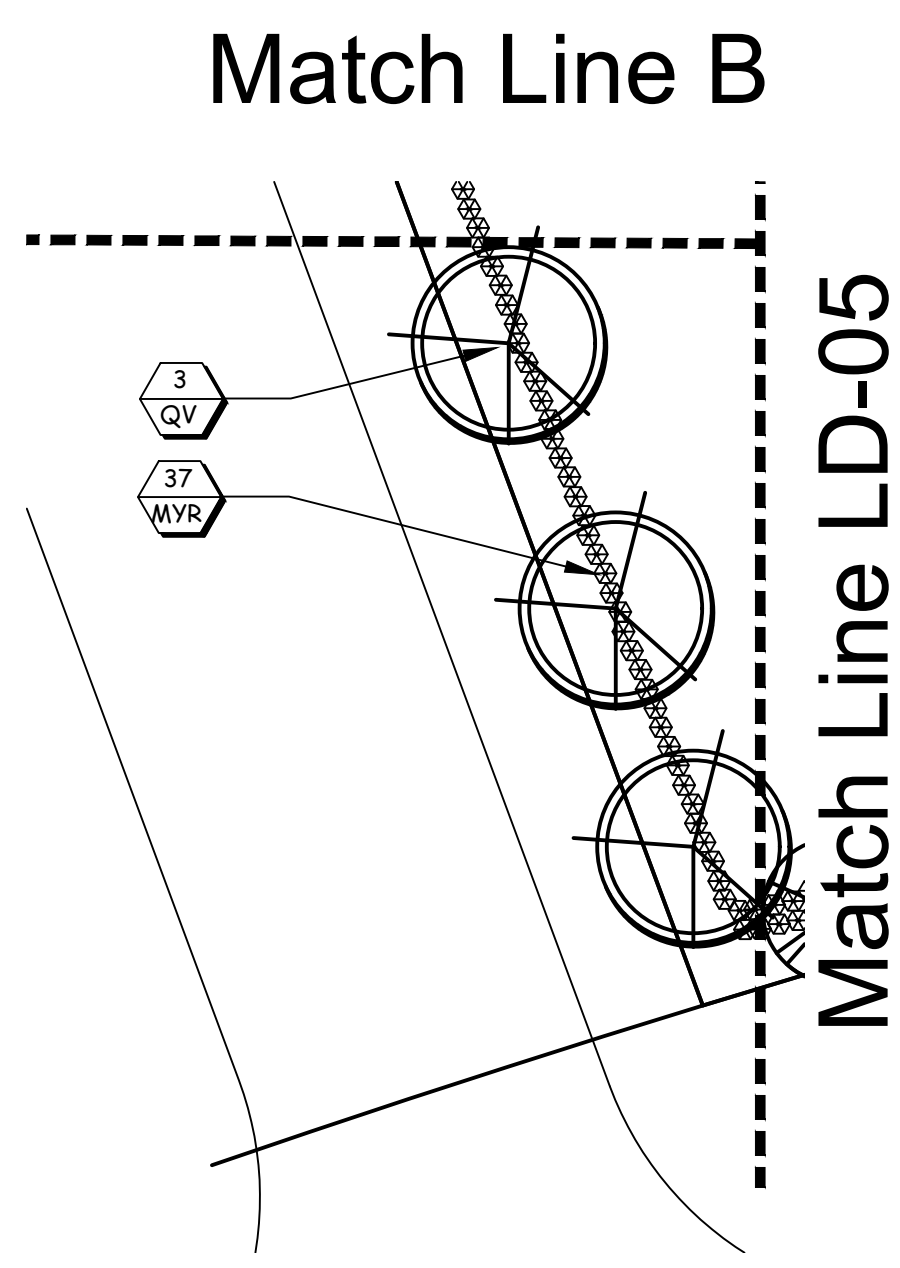

Match Line B

Match Line LD-05

Landscape Legend:

Qty	Symb	WU	Name	(N) Native (F) Flowering Tree (E) Evergreen
Shade Trees:				
55	AR	🌳	Red Maple (N)	
141	QV	🌳	Acer rubrum 'Florida Flame', FG, 14' Ht, 5' Spr., 2.5" cal	
			Live Oak (N)(E)	
			Quercus virginiana, FG, 14' Ht, 5' Spr., 2.5" cal	
Understory/Flowering Trees:				
37	CE	🌳	Green Buttonwood (N)	
			Conocarpus erectus, FG, 10' Ht, 1.5" cal, 5' Spr. Standard	
51	LI	🌳	Crepe Myrtle (F)	
24	LI1	🌳	Lagerstroemia indica 'Nanchez', FG, 12' Ht, 6' Spr., 2.5" cal, Multi	
			Crape Myrtle (F)	
24	SP	🌳	Lagerstroemia indica 'Red Rocket', FG, 12' Ht, 6' Spr., 2.5" cal, Multi	
			Cabbage Palm (N)	
			Sabal palmetto, FG, 30' OA, matched	
17	TT	🌳	Pride of Bolivia	
			Tipuana tipu, FG, 10' ht, 1.5" cal	
Shrubs				
626	GAL	🌿	Thryallis	
			Galphimia gracilis, 3 gal, 24"x18", 24" o.c.	
917	HAM	🌿	Dwarf Firebush (N)	
			Hamelia patens 'Compacta', 7 gal, 24"x18", 24" o.c.	
164	MUH	🌿	Muhly Grass	
			Muhlenbergia capillaris, 3 gal, 24" ht, 36" o.c.	
472	MYR	🌿	Wax Myrtle	
			Myrica cerifera, 7 gal, 24"x18", 24" o.c.	
70	CHR	🌿	Red Tip Cocoplum	
			Chrysobalanus icaco, 7 gal, 24"x18", 36" o.c.	
1427	VIO	🌿	Walters Viburnum	
			Viburnum obovatum 'Select', 7 gal, 24"x18", 24" o.c.	
304	VIB	🌿	Dwarf Walters Viburnum	
			Viburnum obovatum 'Mrs Shillers', 7 gal, 24"x18", 24" o.c.	
96	ZAM	🌿	Coontie	
			Zamia pumila, 3 gal, 24" ht, 36" o.c.	
Groundcover:				
140	LAN	🌿	Pineland Lantana	
			Lantana depressa, 1 gal, 6"x12", 36" o.c.	
497	LIR	🌿	Liriope Superblue	
			Liriope muscari 'Superblue', 1 gal, 12"x12", 18" o.c.	

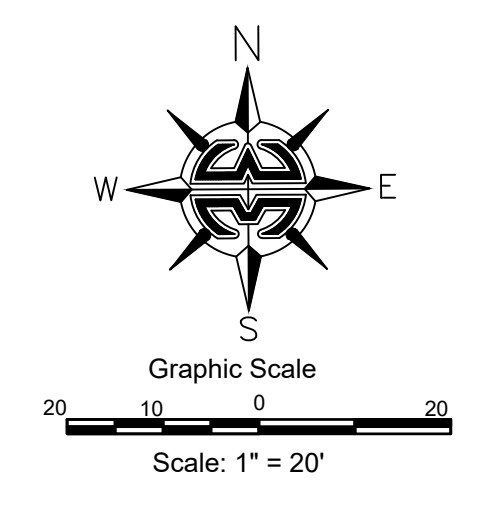

PSLUSD File #5360E
City of Port St. Lucie Project No P21-096

Landscape Design Associates
25110 NW 182nd Ave
High Springs, FL 32643
352-710-5765 ph, www.landscape.com

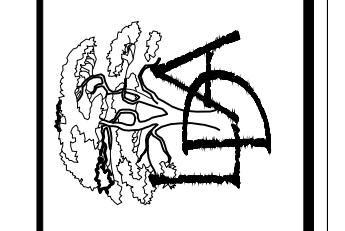

Scale:	1" = 20'
Drawn by:	SM
Checked by:	SM
CADD No.:	20-124Spec 2 lp.dwg
Date:	6.21.21

Revisions	Comments
Date	per staff comments
7.02.21	

© 2011 LANDSCAPE DESIGN ASSOCIATES, INC. ALL RIGHTS RESERVED. THIS DRAWING IS THE PROPERTY OF LANDSCAPE DESIGN ASSOCIATES, INC. AND IS NOT TO BE REPRODUCED OR TRANSMITTED IN ANY FORM OR BY ANY MEANS, ELECTRONIC OR MECHANICAL, WITHOUT PERMISSION IN WRITING FROM LANDSCAPE DESIGN ASSOCIATES, INC.

Legacy Park - Spec 2
City of Port St Lucie
Landscape Plan



7.02.21
LD-06

Match Line LD-02

Match Line LD-03

Match Line LD-04

Match Line LD-08

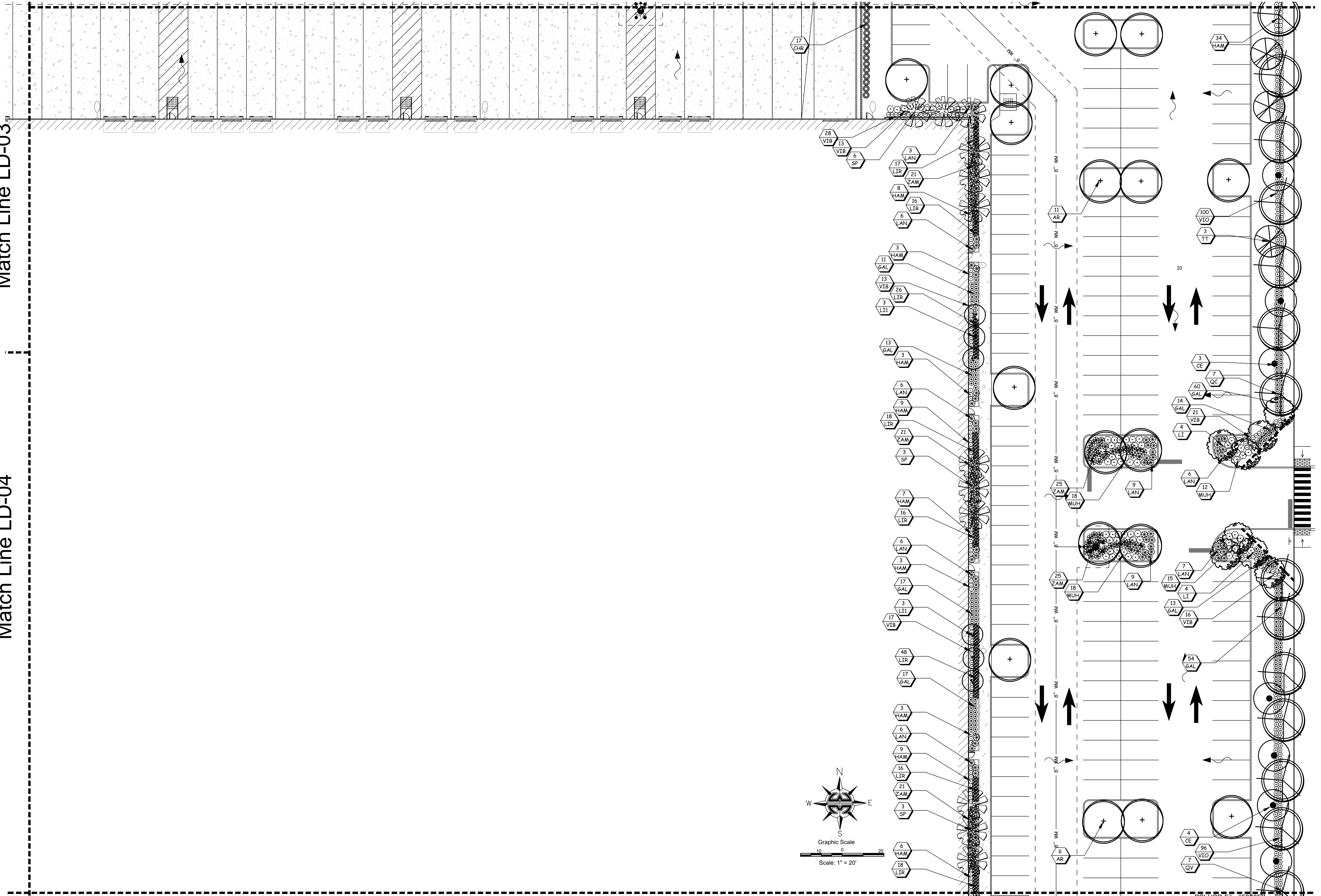

Landscape Design Associates

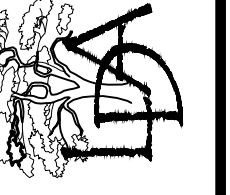

25110 NW 182nd Ave
High Springs, FL 32643
352-210-5765 ph, www.landscape.com

Scale:	1" = 20'
Drawn by:	SM
Checked by:	SM
CADD No.:	20-124Spec 2 lp.dwg
Date:	6.21.21

Revisions	Date	Comments
	7.02.21	per staff comments

© 2011 LANDSCAPE DESIGN ASSOCIATES, INC. ALL RIGHTS RESERVED. THIS DOCUMENT IS THE PROPERTY OF LANDSCAPE DESIGN ASSOCIATES, INC. AND IS NOT TO BE REPRODUCED OR TRANSMITTED IN ANY FORM OR BY ANY MEANS, ELECTRONIC OR MECHANICAL, WITHOUT PERMISSION IN WRITING FROM LANDSCAPE DESIGN ASSOCIATES, INC.

Legacy Park - Spec 2 City of Port St Lucie Landscape Plan



7.02.21
LD-07

PSLUSD File #5360E
City of Port St. Lucie Project No P21-096

Match Line LD-07

Match Line LD-04

Match Line LD-05

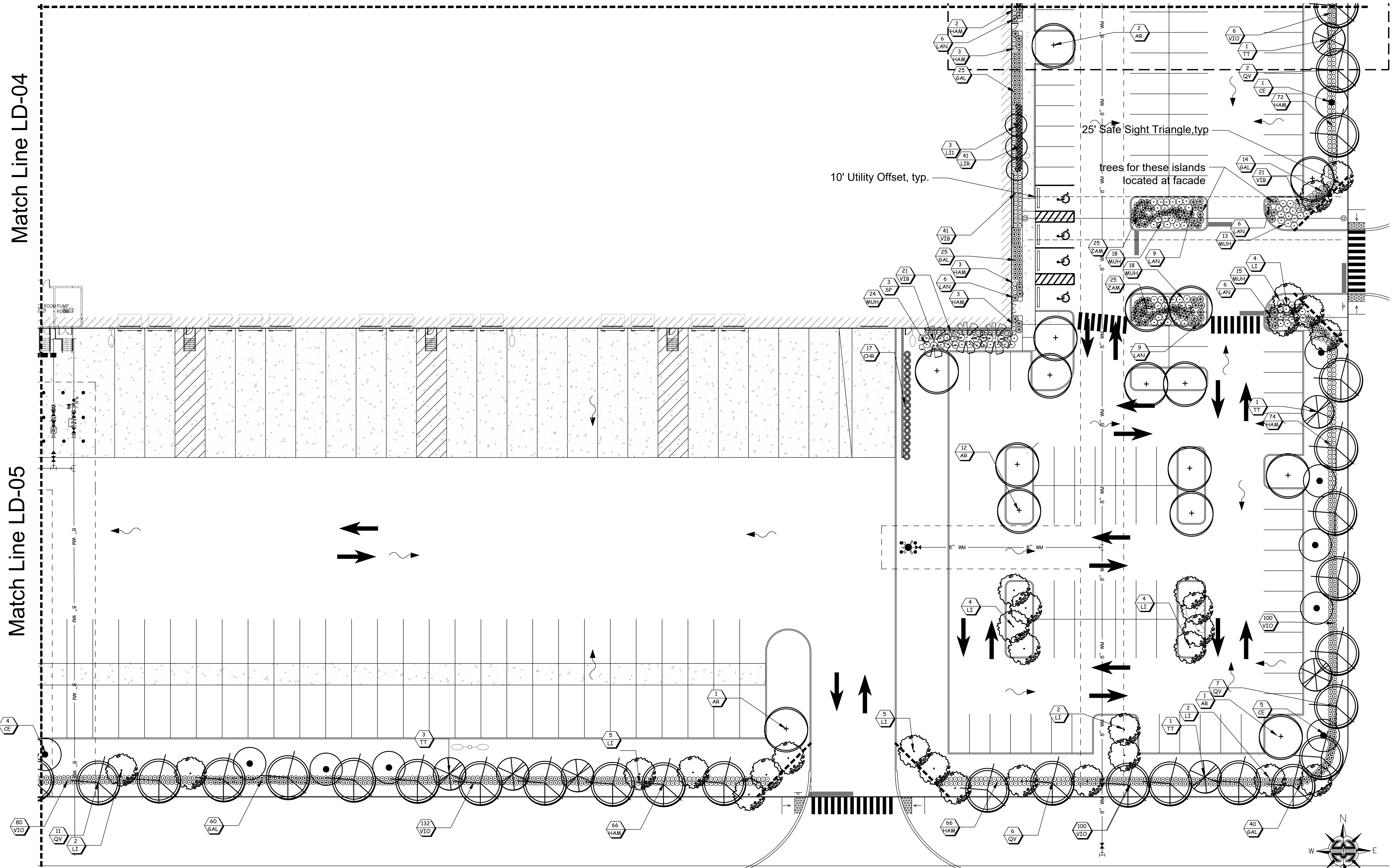

Landscape Design Associates

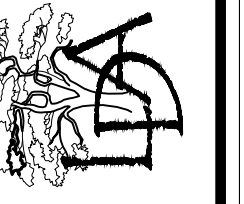

25110 NW 182nd Ave
High Springs, FL 32643
352-210-5765 ph, www.landscape.com

Scale: 1" = 20'
Drawn by: SM
Checked by: SM
CADD No.: 20-124Spec 2 lp.dwg
Date: 6.21.21

Revisions

Date

Comments

7.02.21

per staff comments

per staff comments

per staff comments

per staff comments

per staff comments

per staff comments

per staff comments

per staff comments

per staff comments

per staff comments

per staff comments

per staff comments

per staff comments

per staff comments

per staff comments

per staff comments

per staff comments

per staff comments

per staff comments

per staff comments

per staff comments

per staff comments

per staff comments

per staff comments

Legacy Park - Spec 2
City of Port St Lucie
Landscape Plan

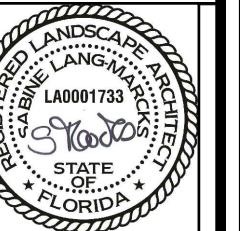

7.02.21
LD-08

PSLUSD File #5360E
City of Port St. Lucie Project No P21-096

PLANTING NOTES:

FERTILIZER

FERTILIZERS SHALL BE SLOW RELEASE, UNIFORM IN COMPOSITION, DRY AND FREE FLOWING. THE FERTILIZER SHALL BE DELIVERED TO THE SITE IN THE ORIGINAL UNOPENED BAGS, EACH BEARING THE MANUFACTURERS STATEMENT OF ANALYSIS, AND SHALL MEET THE FOLLOWING REQUIREMENTS: SIX (6) PERCENT NITROGEN, SIX (6) PERCENT PHOSPHOROUS, AND SIX (6) PERCENT POTASSIUM. FERTILIZER SHALL BE APPLIED TO ALL SHRUBS (1/3 LB PER 3 GAL POT, 1/4 LB PER 1 GAL POT) AND GROUNDCOVER. THE SOD STARTER FERTILIZER MIXTURE SHALL BE A 5-10-10 ANALYSIS. A 14-14-14 FERTILIZER ANALYSIS IS REQUIRED ON ALL TREES AND SHRUBS OVER 5' IN HEIGHT (1/2 LB PER 5' OF SPREAD). AGRIFORM TABLETS WITH TWENTY (20) PERCENT NITROGEN, TEN (10) PERCENT PHOSPHOROUS, FIVE (5) PERCENT POTASSIUM IN 21 GRAM SIZES SHALL BE APPLIED ALONG WITH THE FERTILIZER PROCESS (1 WITH 1 GAL PLANTS, 2 WITH 3 GAL PLANTS AND 2 TABLETS PER 1" OF TREE TRUNK CALIPER). MAGNESIUM SULFATE SHALL BE APPLIED TO ALL PALMS AT INSTALLATION AT A RATE OF 1/2 LB PER INCH OF TRUNK CALIPER. MANGANESE SHALL BE APPLIED AT THE SAME RATE.

MULCH

MULCH MATERIAL SHALL BE COLORED 'A' GRADE CERTIFIED RECYCLED MULCH AND MOISTENED AT THE TIME OF APPLICATION TO PREVENT WIND DISPLACEMENT. MULCH SHALL BE APPLIED TO A MINIMUM OF 3" DEPTH IN PLANTING BEDS. MULCH SHALL NOT BE PLACED WITHIN 6" OF TREE OR PALM TRUNKS.

SOD

THE SOD SHALL BE CERTIFIED TO MEET FLORIDA STATE PLANT BOARD SPECIFICATIONS, ABSOLUTELY TRUE TO VARIETAL TYPE AND FREE FROM WEEDS, FUNGUS, INSECTS AND DISEASE OF ANY KIND.

SUBSTITUTIONS

NO SUBSTITUTION OF PLANT MATERIAL TYPES OR SIZES WILL BE ALLOWED WITHOUT WRITTEN AUTHORIZATION FROM THE LANDSCAPE ARCHITECT OF RECORD. CONTAINER GROWN MATERIAL WILL NOT BE ACCEPTED AS A SUBSTITUTE FOR B & B MATERIAL UNLESS PREVIOUSLY APPROVED. INTENDED SUBSTITUTIONS SHALL BE SPELLED OUT IN BID.

MEASUREMENTS

SHADE TREES: HEIGHT SHALL BE MEASURED FROM GROUND TO THE AVERAGE BRANCH HEIGHT OF CANOPY. SPREAD SHALL BE MEASURED TO THE END OF BRANCHING EQUALLY AROUND THE CROWN FROM THE CENTER OF THE TRUNK. MEASUREMENTS ARE NOT TO INCLUDE ANY TERMINAL GROWTH. SINGLE TRUNK TREES SHALL BE FREE OF "V" CROTCHES THAT COULD BE POINTS OF WEAK LIMB STRUCTURE OR DISEASE INFESTATION.

SHRUBS: HEIGHT SHALL BE MEASURED FROM THE GROUND TO THE AVERAGE POINT WHERE MATURE PLANT GROWTH STOPS. SPREAD SHALL BE MEASURED TO THE END OF BRANCHING EQUALLY AROUND THE SHRUB MASS. MEASUREMENT AREA NOT TO INCLUDE ANY TERMINAL GROWTH.

PALMS: CLEAR TRUNK SHALL BE MEASURED FROM THE GROUND AT THE TIME OF INSTALLATION TO THE POINT WHERE THE MATURE AGED TRUNK JOINS THE IMMATURE OR GREEN PORTION OF THE TRUNK OR HEAD.

GREY WOOD (G.W.): SHALL BE MEASURED FROM THE GROUND AT THE TIME OF INSTALLATION TO TOP OF THE HARDENED TRUNK.

OVERALL HEIGHT (O.A.): SHALL BE MEASURED FROM THE GROUND AT THE TIME OF INSTALLATION TO THE AVERAGE FROND HEIGHT.

PALMS WITH MARRED OR BURNED TRUNKS WILL NOT BE ACCEPTED.

PLANTING SOIL AND BACKFILL

PLANTING SOIL SHALL BE RECYCLED TOPSOIL. RECYCLED TOPSOIL SHALL CONSIST OF A STABILIZED MIXTURE OF GROUND YARD TRIMMINGS AND POSSIBLY BIOSOLIDS PROCESSED ACCORDING TO STATE OF FLORIDA DEPARTMENT OF ENVIRONMENTAL PROTECTION GUIDELINES FOR THE PROCESSING AND DISTRIBUTION OF SEWAGE SLUDGE COMPOST. RECYCLED TOPSOIL SHALL ONLY BE OBTAINED FROM A STATE PERMITTED RECYCLING FACILITY WHICH IS ALSO D.O.T. CERTIFIED AND STORES PRODUCT ON A PAD WITH A CURRENT NEMATODE CERTIFICATION FROM FLORIDA DEPARTMENT OF AGRICULTURE. RECYCLED TOPSOIL SHALL HAVE THE FOLLOWING CHARACTERISTICS:

- WEED FREE
- MOISTURE CONTENT 50% BY WEIGHT MAXIMUM
- WATER HOLDING CAPACITY 200% BY WEIGHT MINIMUM
- CARBON TO NITROGEN RATIO LESS THAN 25 TO 1
- ORGANIC MATTER CONTENT 40% BY DRY WEIGHT MINIMUM
- SOLUBLE SALTS LESS THAN 3 MMHOS/CM
- PH RANGE 7.0 - 7.9

- MINIMUM NUTRIENT LEVELS AS FOLLOWS:
MACRO NUTRIENTS: NITROGEN (N) - 1% MINIMUM, WATER INSOLUBLE NITROGEN 90% MINIMUM, PHOSPHORUS (P) - 0.5% MINIMUM, POTASSIUM (K) - 0.2% MINIMUM AND OTHER MACRO AND MICRO NUTRIENTS. THE RECYCLED TOPSOIL SHALL CONTAIN LEVELS OF THOSE MICRO NUTRIENTS NECESSARY FOR PLANT GROWTH. THESE INCLUDE CALCIUM, MAGNESIUM, SULFUR, BORON, COPPER, IRON, MANGANESE AND MOLYBDENUM. RECYCLED TOPSOIL NOT MEETING THESE REQUIREMENTS WILL NOT BE ACCEPTED.

BACKFILL

ALL NEW AND TRANSPLANTED PLANT MATERIAL (INCLUDING NEW SOD) SHALL BE PLANTED ONLY AFTER PREPARATION OF EXISTING SOIL AS FOLLOWS:
SPREAD A LAYER OF 3" DEPTH OF RECYCLED TOPSOIL (AS DEFINED ABOVE) OVER THE ENTIRE PLANTING AREA. THE TOPSOIL SHALL THEN BE UNIFORMLY DISKED, TILLED OR AERIFIED INTO THE EXISTING SOIL TO A DEPTH OF 12" UNDERNEATH SHRUBS AND GROUNDCOVERS, 6" UNDERNEATH SOD AND TO A DEPTH OF 36" FOR THE TREE PITS, WITH THE FOLLOWING EXCEPTION: NO ROTOTILLING OR DISKING SHALL OCCUR CLOSER TO THE TRUNKS OF ESTABLISHED PLANTS THAN ONE HALF (1/2) THE DISTANCE OF THE CANOPY FURTHER OUT FROM THE DRIP LINE OF THE EXISTING PLANT CANOPY. ALL PLANTS, INCLUDING HEDGES AND GROUND COVER SHALL BE PLANTED IN INDIVIDUALLY DUG HOLES AND THE MATERIAL DUG FROM THE HOLES SHALL THEN BE FURTHER MIXED WITH THE PREPARED SITE SOIL PRIOR TO BACKFILLING OF THE PLANTING HOLES AROUND THE ROOT BALLS. NO ADDITIONAL BACKFILL SOIL SHALL BE USED.

AN EXCEPTION ARE PLANTING PITS FOR CABBAGE PALMS, WHICH SHALL BE BACKFILLED WITH CLEAN NATIVE SAND ONLY.

REMOVE EXCESS MATERIAL TO PROVIDE PROPER FINISHED GRADE.

ALL PLANTING PITS AND PLANTING AREAS SHALL BE AMENDED WITH AGRODIAMONDS PER MANUFACTURERS SPECIFICATIONS.

PLANT MATERIALS

TREES, PALMS, SHRUBS, GROUND COVERS:

PLANT SPECIES AND SIZES SHALL CONFORM TO THOSE INDICATED IN THE DRAWINGS. NOMENCLATURE SHALL CONFORM TO STANDARDIZED PLANT NAMES, 1942 EDITION. ALL NURSERY STOCK SHALL BE IN ACCORDANCE WITH GRADES AND STANDARDS FOR NURSERY PLANTS, PARTS I & II, LATEST EDITION PUBLISHED BY THE FLORIDA DEPARTMENT OF AGRICULTURE AND CONSUMER SERVICES, UNLESS SPECIFIED OTHERWISE. ALL PLANTS SHALL BE NORMAL FOR THE VARIETY AND FLORIDA GRADE NUMBER 1 OR BETTER AS DETERMINED BY THE FLORIDA DIVISION OF PLANT INDUSTRY.

SPECIMEN MEANS AN EXCEPTIONALLY HEAVY, SYMMETRICAL, TIGHTLY KNIT PLANT, SO TRAINED OR FAVORED IN ITS DEVELOPMENT THAT FIRST APPEARANCE IS UNQUESTIONABLE AND IT IS OUTSTANDINGLY SUPERIOR IN FORM, NUMBER OF BRANCHES, COMPACTNESS AND SYMMETRY.

ALL PLANTS SHALL BE FRESHLY DUG, SOUND, HEALTHY, VIGOROUS, WELL BRANCHED AND FREE OF DISEASE AND INSECT EGGS AND LARVAE AND SHALL HAVE ADEQUATE ROOT SYSTEMS. TREES FOR PLANTING ROWS SHALL BE UNIFORM IN SIZE AND SHAPE. ALL MATERIALS SHALL BE SUBJECT TO APPROVAL BY THE LANDSCAPE ARCHITECT, WHERE REQUIREMENTS ARE OMITTED FROM THE PLANT LIST. PLANTS SHALL BE PRUNED PRIOR TO DELIVERY ONLY UPON THE APPROVAL OF THE LANDSCAPE ARCHITECT.

ALL CONTAINER GROWN MATERIAL SHALL BE HEALTHY, VIGOROUS, WELL ROOTED PLANTS AND ESTABLISHED IN THE CONTAINER IN WHICH THEY ARE SOLD. THE PLANTS SHALL HAVE TOPS OF GOOD QUALITY AND BE IN HEALTHY GROWING CONDITION. AN ESTABLISHED CONTAINER GROWN PLANT SHALL BE TRANSPLANTED INTO A CONTAINER AND GROWN IN THAT CONTAINER SUFFICIENTLY LONG ENOUGH FOR THE NEW FIBROUS ROOTS TO HAVE DEVELOPED SO THAT THE ROOT MASS WILL RETAIN ITS SHAPE AND HOLD TOGETHER WHEN REMOVED FROM THE CONTAINER.

GENERAL NOTES:

- THE CONTRACTOR SHALL PERSONALLY ACQUAINT HIM/HER SELF WITH THE EXISTING SITE CONDITIONS AND THE EXTENT AND SCOPE OF WORK REQUIRED.
- THE PLANT LIST INDICATES THE NAMES, SIZES AND SPACING OF SPECIFIC PLANT MATERIALS. QUANTITIES HAVE BEEN PROVIDED TO THE CONTRACTOR AS A CONVENIENCE. THE CONTRACTOR IS RESPONSIBLE FOR HIS/HER OWN QUANTITY COUNT. IN CASE OF DISCREPANCIES BETWEEN THE DRAWINGS AND PLANT LIST, THE QUANTITIES ON THE DRAWINGS SHALL PREVAIL.
- NO SUBSTITUTES ON VARIETIES LISTED WILL BE ALLOWED WITHOUT WRITTEN APPROVAL FROM LANDSCAPE ARCHITECT.
- PLANTS SHALL BE WATERED AS NECESSARY OR WITHIN 24 HOURS AFTER NOTIFICATION BY THE LANDSCAPE ARCHITECT.
- THE LOCATIONS OF PLANTS, AS SHOWN IN THESE PLANS, ARE APPROXIMATE. THE FINAL LOCATIONS MAY BE ADJUSTED TO ACCOMMODATE UNFORESEEN FIELD CONDITIONS. MAJOR ADJUSTMENTS TO THE LAYOUT ARE TO BE APPROVED BY THE LANDSCAPE ARCHITECT OF RECORD.
- ALL PLASTIC FABRIC SHALL BE REMOVED FROM PLANT MATERIAL AT TIME OF INSTALLATION.
- ALL TREES MUST BE STAKED AS SHOWN ON THE LANDSCAPE DETAIL SHEET WITHIN 24 HRS OF PLANTING. STAKES TO REMAIN FOR A MINIMUM OF 12 MONTH BUT NO LONGER THAN 18 MONTH. CONTRACTOR RESPONSIBLE FOR MAINTENANCE AND REMOVAL OF THE STAKES.
- ALL TREES MUST BE PRUNED AS PER LANDSCAPE ARCHITECT DIRECTION.
- ALL SOD EDGES SHALL BE TRIMMED AS PER THE LANDSCAPE ARCHITECTS DIRECTION.
- ALL SHRUBS, TREES, GROUNDCOVERS, SOD AND WILDFLOWER AREAS SHALL HAVE IMPROVED SOIL AS PER PLANTING SOIL NOTES.
- DO NOT ALLOW AIR POCKETS TO FORM WHEN BACKFILLING.
- SOAK PLANTS IMMEDIATELY WITH WATER FOLLOWING PLANTING.
- MAINTAIN THE ORIGINAL GRADE OF THE TREE BASE.
- DO NOT BREAK ROOTBALL.
- ALL PLANT SHALL BE HARDY UNDER CLIMATIC CONDITIONS SIMILAR TO THOSE ON LOCALITY OF THE PROJECT.
- THE LANDSCAPE CONTRACTOR SHALL WATER, MULCH, WEED, PRUNE, AND OTHERWISE MAINTAIN ALL PLANTS, INCLUDING SOD, UNTIL COMPLETION OF THE CONTRACT OR ACCEPTANCE BY THE LANDSCAPE ARCHITECT. SETTLED PLANTS SHALL BE RESET TO PROPER GRADE, PLANTING SAUCERS RESTORED, AND DEFECTIVE WORK CORRECTED.
- THE LANDSCAPE CONTRACTOR SHALL AT ALL TIMES KEEP THE PREMISES FREE FROM ACCUMULATION OF WASTE MATERIALS OR DEBRIS CAUSED BY THE CREWS DURING THE PERFORMANCE OF THE WORK. UPON COMPLETION OF THE WORK, THE CONTRACTOR SHALL PROMPTLY REMOVE ALL WASTE MATERIALS, DEBRIS, UNUSED PLANT MATERIAL, EMPTY PLANT CONTAINERS AND ALL EQUIPMENT FROM THE PROJECT SITE.
- UPON COMPLETION OF THE WORK, THE LANDSCAPE CONTRACTOR SHALL NOTIFY THE LANDSCAPE ARCHITECT AND REQUEST A FINAL INSPECTION. ANY ITEMS THAT ARE JUDGED INCOMPLETE OR UNACCEPTABLE BY THE LANDSCAPE ARCHITECT OR REPRESENTATIVE SHALL BE PROMPTLY CORRECTED BY THE LANDSCAPE CONTRACTOR.
- THE LANDSCAPE CONTRACTOR SHALL GUARANTEE ALL PLANT MATERIAL FOR A PERIOD OF ONE (1) YEAR FROM THE DATE OF FINAL ACCEPTANCE IN WRITING FROM THE LANDSCAPE ARCHITECT. AT THE TIME OF FINAL ACCEPTANCE THE ONE (1) YEAR PERIOD SHALL COMMENCE. ANY MATERIALS WHICH HAVE DIED DURING THIS PERIOD SHALL BE PROMPTLY REPLACED WITH SPECIMENS THAT MEET THE MINIMUM REQUIREMENTS CALLED FOR IN THE DRAWINGS. THE LANDSCAPE CONTRACTOR SHALL NOT BE HELD RESPONSIBLE FOR THE DEATH OR DAMAGE RESULTING FROM LIGHTNING, VANDALISM, AUTOMOBILES OR FROM NEGLIGENCE BY THE OWNER. CONTRACTOR SHALL BE RESPONSIBLE FOR WATERING AND OTHERWISE MAINTAINING PLANTS DURING THE GUARANTEE PERIOD UNLESS A WRITTEN AGREEMENT WITH THE LANDSCAPE ARCHITECT PROVIDES FOR A DIFFERENT ARRANGEMENT.
- ALL LABOR AND MATERIAL FOR SOIL AMENDMENTS AND FERTILIZER THAT IS REQUIRED TO INSURE THE SUCCESSFUL ESTABLISHMENT AND SURVIVAL OF THE PROPOSED VEGETATION AS WELL AS ALL COST FOR THE REMOVAL OF UNSUITABLE OR EXCESS BACKFILL MATERIAL SHALL BE INCLUDED IN THE CONTRACTORS BID TO PERFORM THE WORK PRESENTED IN THIS PLAN SET.
- NO LANDSCAPING ADDED UNDER THIS PROJECT SHALL BE LOCATED SUCH THAT SAID LANDSCAPING OBSCURES MOTORIST'S VISIBILITY OF ANY EXISTING SIGN(S).

Linear Application of DeepRoot Tree Root Barriers at Time of Installing Concrete Sidewalks and Curbs

TYPICAL SECTION OF CURB AND GUTTER WITH DEEPROOT TREE ROOT BARRIER INSET INTO CONCRETE. BARRIER INSTALLED IN A TRENCH IN SUBGRADE WHICH IS THEN COMPACTED. BARRIER IS SET SO THAT TOP EDGE WILL BE 2" BELOW FINISH GRADE OF CURB, AND SET FLUSH WITH EDGE OF CURB. BARRIER RIBS FACE TOWARD TREE ROOTS.

INSTALLATION SEQUENCE:

- Prepare base and subgrade
- Trench to appropriate depth for installation of root barrier so that top of barrier is 2" below finish grade of top of curb.
- Place root barrier in trench, vertical ribs must face toward tree roots.
- Backfill and compact to requirements.
- Place form material against barrier (It may be nailed from the outside of the form)

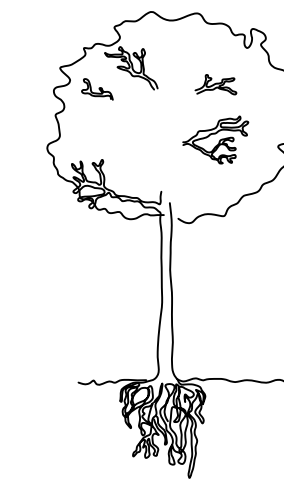
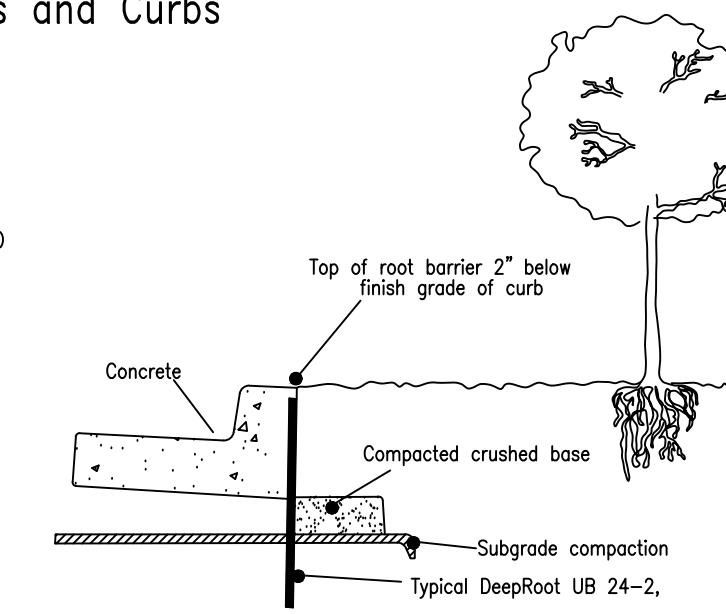

TYPICAL SECTION OF CURB, GUTTER AND SIDEWALK WITH DEEPROOT TREE ROOT BARRIER INSET INTO CONCRETE. BARRIER INSTALLED IN A TRENCH IN SUBGRADE WHICH IS THEN COMPACTED. BARRIER IS SET SO THAT TOP EDGE WILL BE 2" ABOVE COMPACTED BASE (OR HALFWAY BETWEEN BASE AND FINISH GRADE OF SW). BARRIER RIBS FACE TOWARD TREE ROOTS.

INSTALLATION SEQUENCE:

- Prepare base and subgrade
- Trench to appropriate depth for installation of root barrier so that top of barrier is 2" (5cm) below finish grade of top of sidewalk (or halfway between top of compacted base and finish grade of SW)
- Place root barrier in trench, vertical ribs must face toward tree roots.
- Backfill and compact to requirements.
- Place form material against barrier (It may be nailed from the outside of the form)

IMPORTANT NOTE: Tree location must align with "as-built" center of barrier.

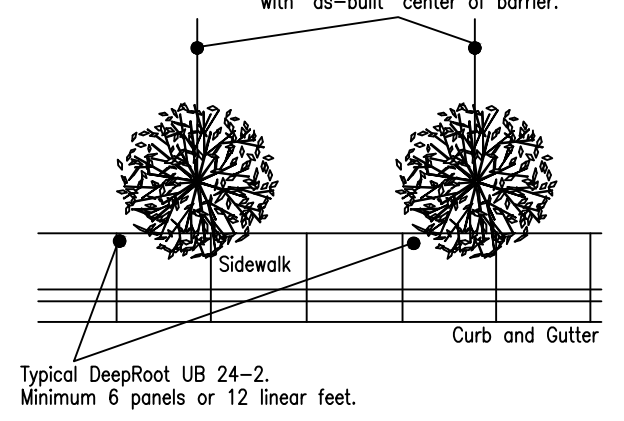

WATERING SCHEDULE

APPLICATION SCHEDULE	
PALM TREES	20 GAL/APPLICATION/PLANT
LARGE TREES	30 GAL/APPLICATION/PLANT
SMALL TREES	20 GAL/APPLICATION/PLANT
LARGE SHRUBS	10 GAL/APPLICATION/PLANT
SMALL SHRUBS	5 GAL/APPLICATION/PLANT
GROUNDCOVER	5 GAL/APPLICATION/PLANT

APPLICATION AMOUNT	
MONTH 1	12 APPLICATIONS
MONTH 2	12 APPLICATIONS
MONTH 3	8 APPLICATIONS
MONTH 4	8 APPLICATIONS
MONTH 5	5 APPLICATIONS
TOTAL:	45 APPLICATIONS

ABBREVIATIONS: C.T. - CLEAR TRUNK
HT. - HEIGHT
O.C. - ON CENTER
Spr. - SPREAD

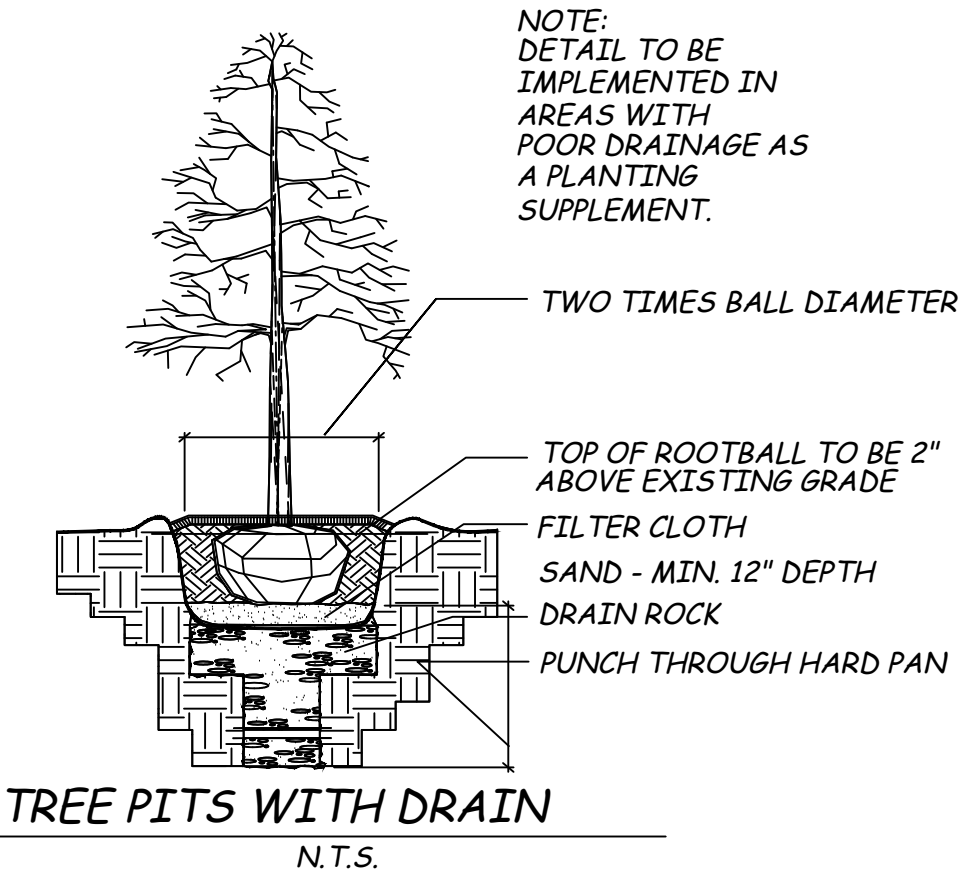

Tree Planting Detail

Tree Stakes are to be removed between 6-12 months by the Owner. NTS

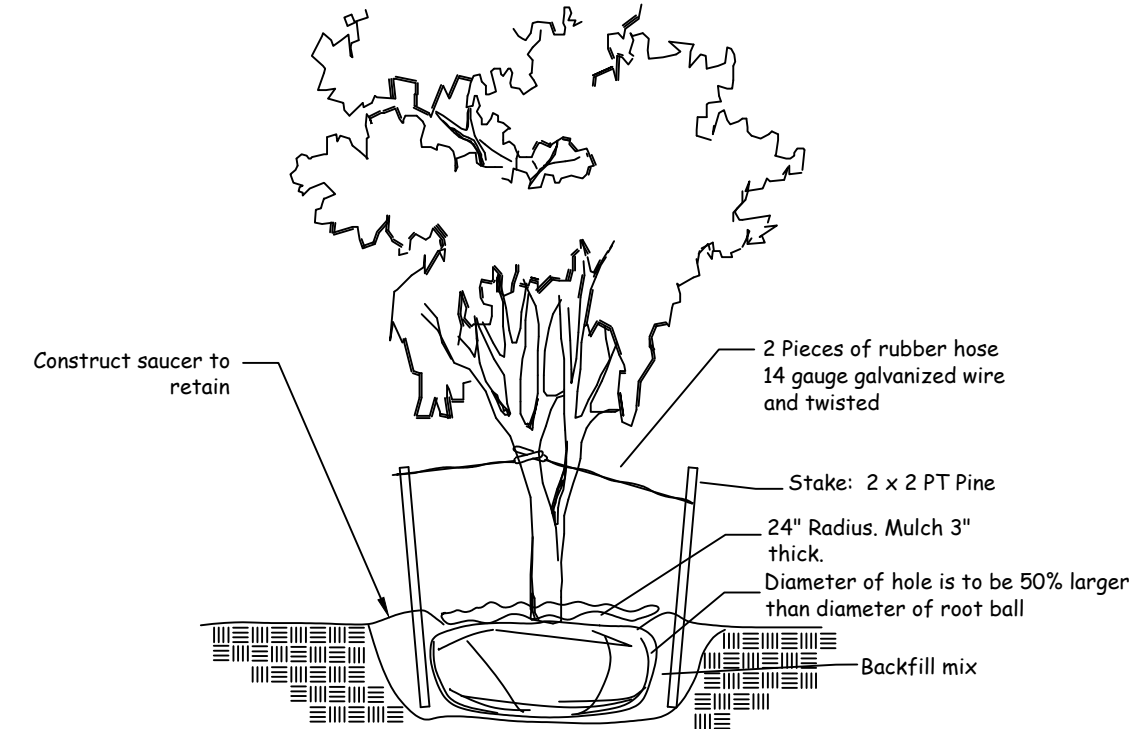

Palm Planting Detail

Tree Stakes are to be removed between 6-12 months by the Owner. NTS

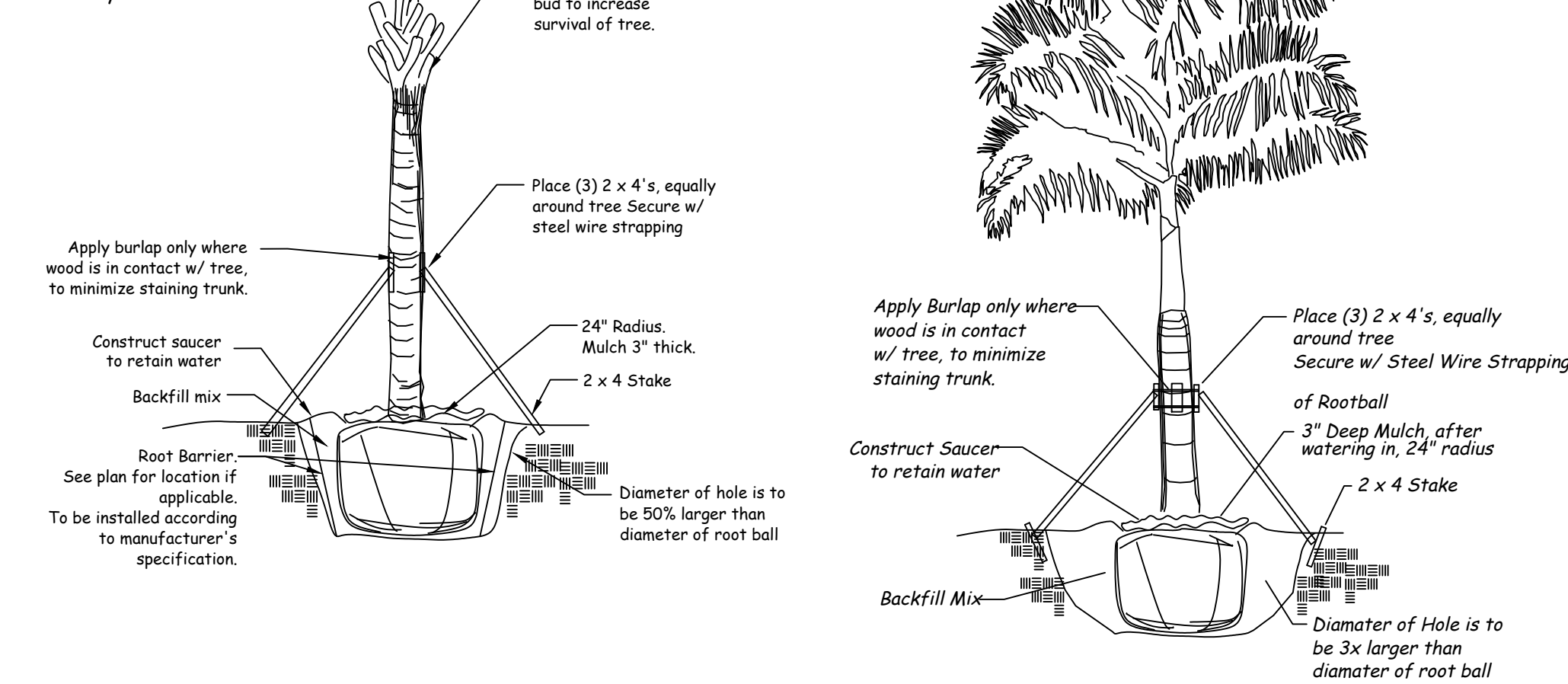

Shrub & Groundcover Planting Detail

Note: All Shrubs And Groundcover Shall Be Triangular Spaced Along Straight Edges And Will Be Planted In Parallel Rows Along Curved Edges. NTS

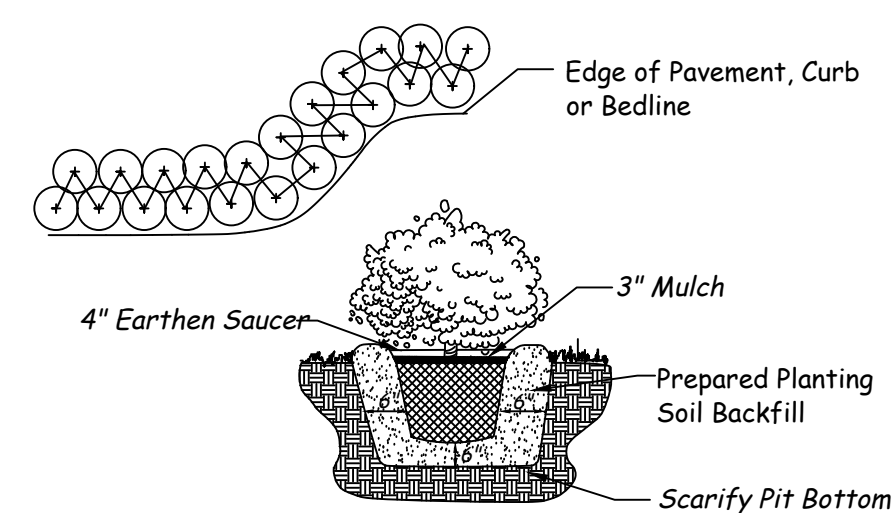

Planting Edge at Sod Detail

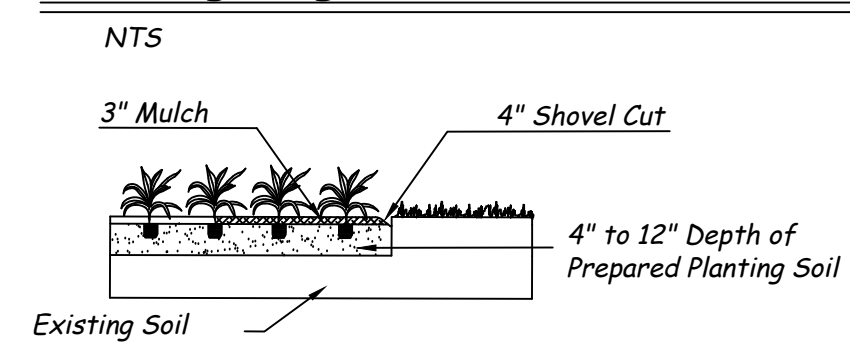

Groundcover & Annual Detail

NTS NOTE: Annuals Are To Be Planted As Per Groundcover Detail Excluding Mulch.

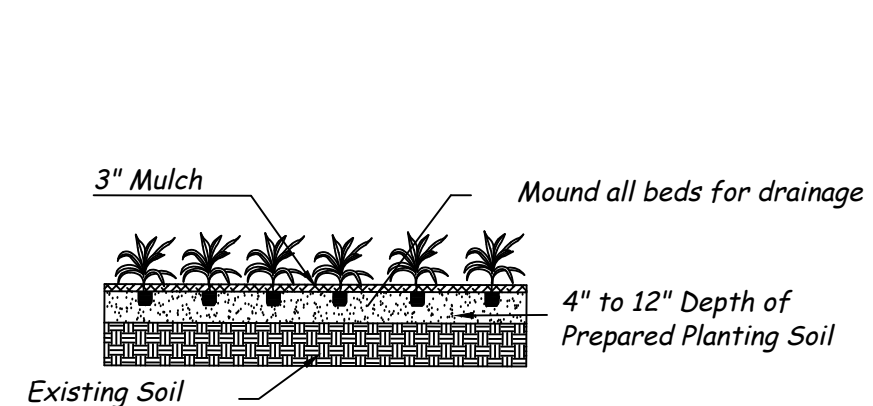

Gravel Strip Detail

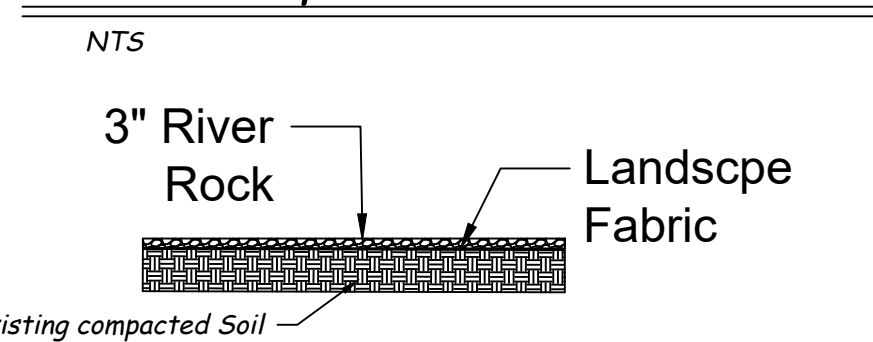

Scale:	NTS
Drawn by:	SM
Checked by:	SM
CADD No.:	20-124Spec 2 lp.dwg
Date:	6.21.21

Revisions	Date	Comments
	7.02.21	per staff comments