



"A City for All Ages"

CITY OF PORT ST. LUCIE

Planning & Zoning Department

MEMORANDUM

TO: Irene Sorensen, Assessment and Property Tax Manager

FROM: Laura H. Dodd, AICP, Senior/Transportation Planner

SUBJECT: Veranda (St. Lucie Lands PUD) Plat 8 (P21-140) Preliminary and Final Plat

DATE: November 30, 2021

The purpose of this memo is to clarify the platting boundaries for the proposed project. The subject replatting is associated with the +/- 68-acre property, owned by VF II, LLC, delineated as Veranda Plat 7 in the following graphic and PID #4434-703-0003-000-4. The property is legally defined as follows:

VERANDA PLAT NO. 7 (PB 86-14) TRACT 2 (68.028 AC - 2,963,300 SF)

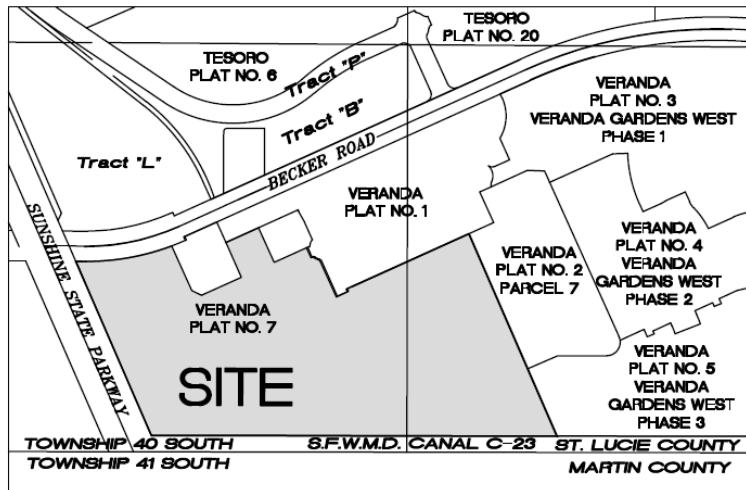

For clarification purposes, the St. Lucie Lands PUD includes a property associated with PID #4434-703-0002-000-7 and legally defined as follows:

VERANDA PLAT NO. 7 (PB 86-14) TRACT 1 (2.487 AC - 108,334 SF)

This (4434-703-0002-000-7) property is not included within the Veranda Plat 8 proposal.

Any questions please do not hesitate to contact me.