









-  Proposed Lights (7)
-  Proposed Boundary (34)
-  Existing Boundary
-  Parcels

SE DAMASK AVENUE Boundary # 664

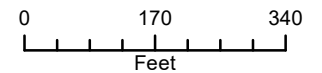
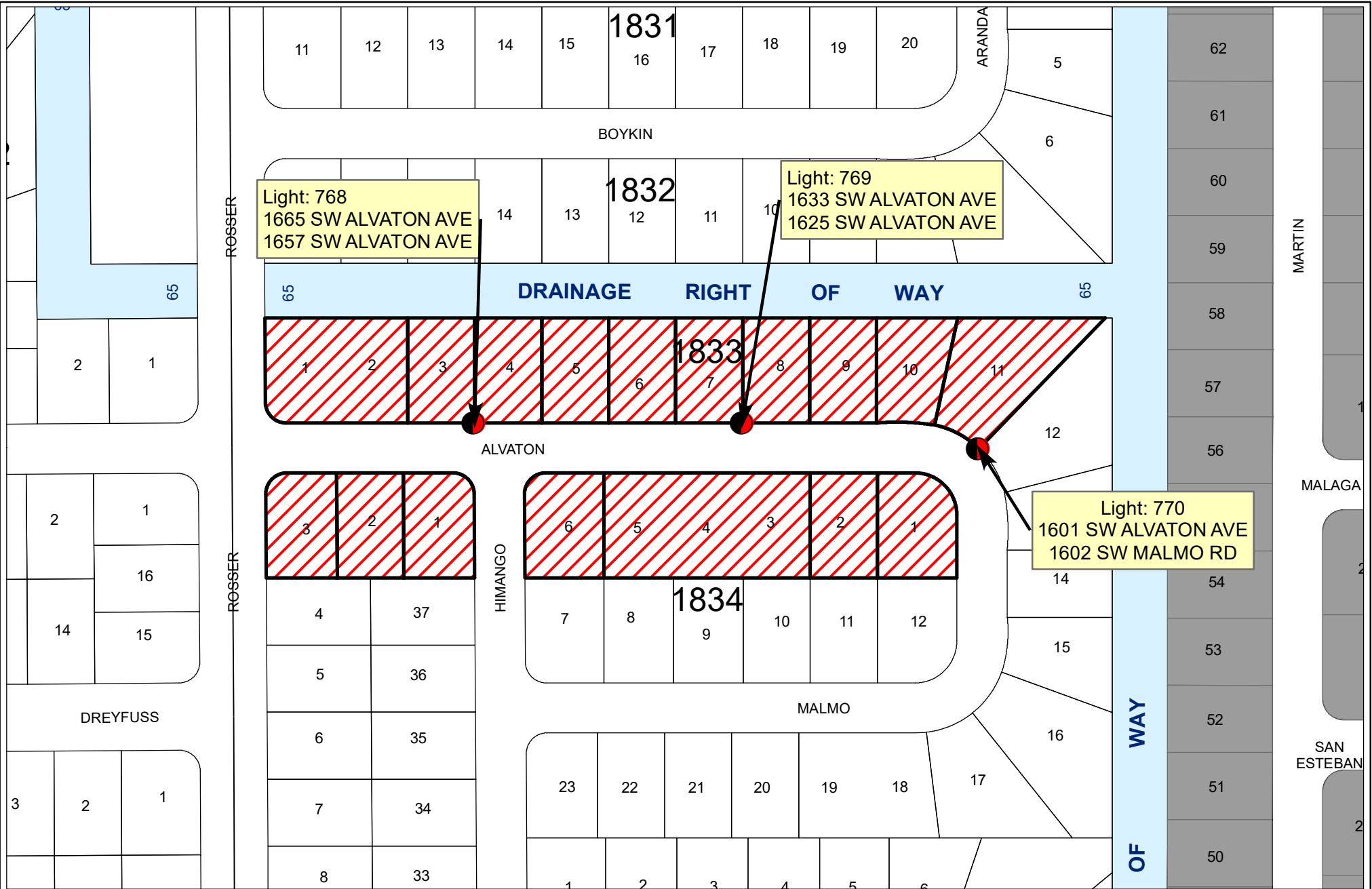

Prepared by City of Port St. Lucie
City Clerks Office
Friday, June 7, 2024





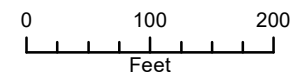

-  Proposed Lights (3)
-  Proposed Boundary (17)
-  Existing Boundary
-  Parcels

SW ALVATON AVENUE Boundary # 666

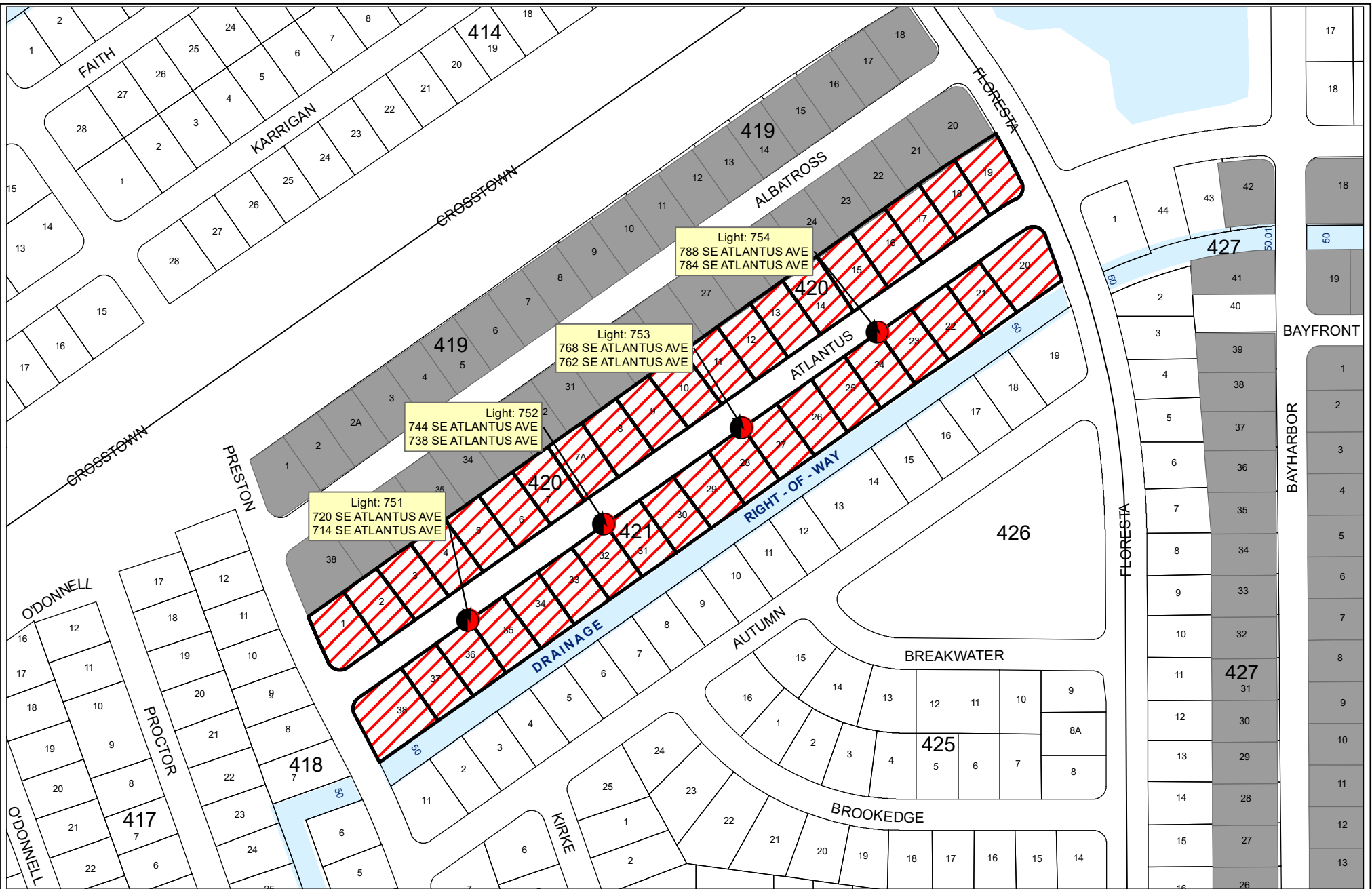

Prepared by City of Port St. Lucie
City Clerks Office
Friday, June 7, 2024





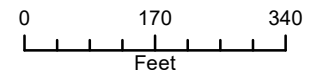

-  Proposed Lights (4)
-  Proposed Boundary (39)
-  Existing Boundary
-  Parcels

SE ATLANTUS AVENUE Boundary # 668

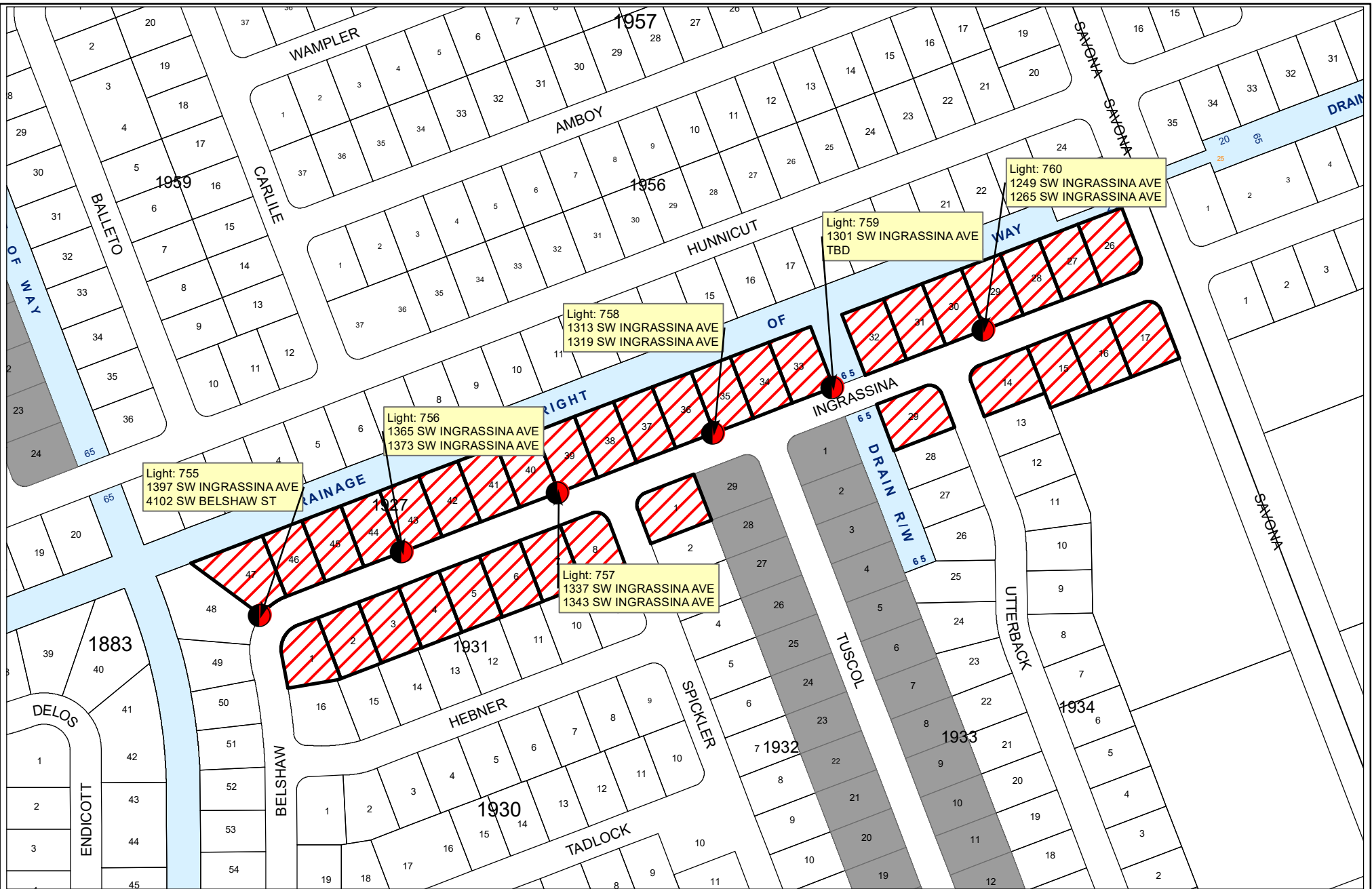

Prepared by City of Port St. Lucie
City Clerks Office
Friday, June 7, 2024



-  Proposed Lights (6)
-  Proposed Boundary (36)
-  Existing Boundary
-  Parcels

SW INGRASSINA AVENUE Boundary # 669

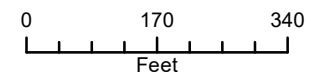

Prepared by City of Port St. Lucie
City Clerks Office
Friday, June 7, 2024

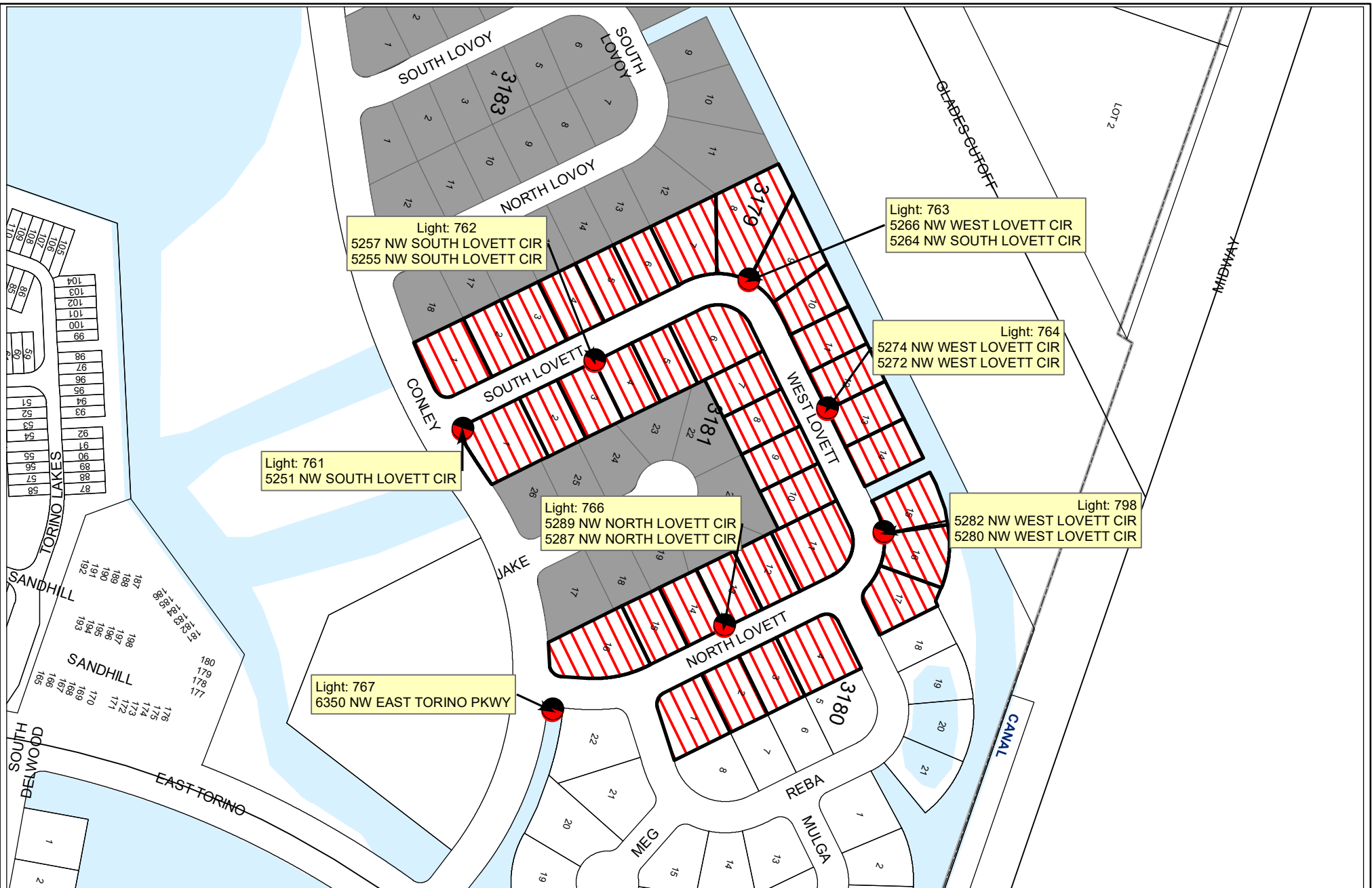

Light: 762
5257 NW SOUTH LOVETT CIR
5255 NW SOUTH LOVETT CIR

Light: 763
5266 NW WEST LOVETT CIR
5264 NW SOUTH LOVETT CIR

Light: 764
5274 NW WEST LOVETT CIR
5272 NW WEST LOVETT CIR





Light: 761
5251 NW SOUTH LOVETT CIR

Light: 766
5289 NW NORTH LOVETT CIR
5287 NW NORTH LOVETT CIR

Light: 798
5282 NW WEST LOVETT CIR
5280 NW WEST LOVETT CIR

Light: 767
6350 NW EAST TORINO PKWY



-  Proposed Lights (7)
-  Proposed Boundary (37)
-  Existing Boundary
-  Parcels

NW NORTH LOVETT CIRCLE Boundary # 670

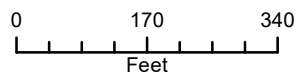

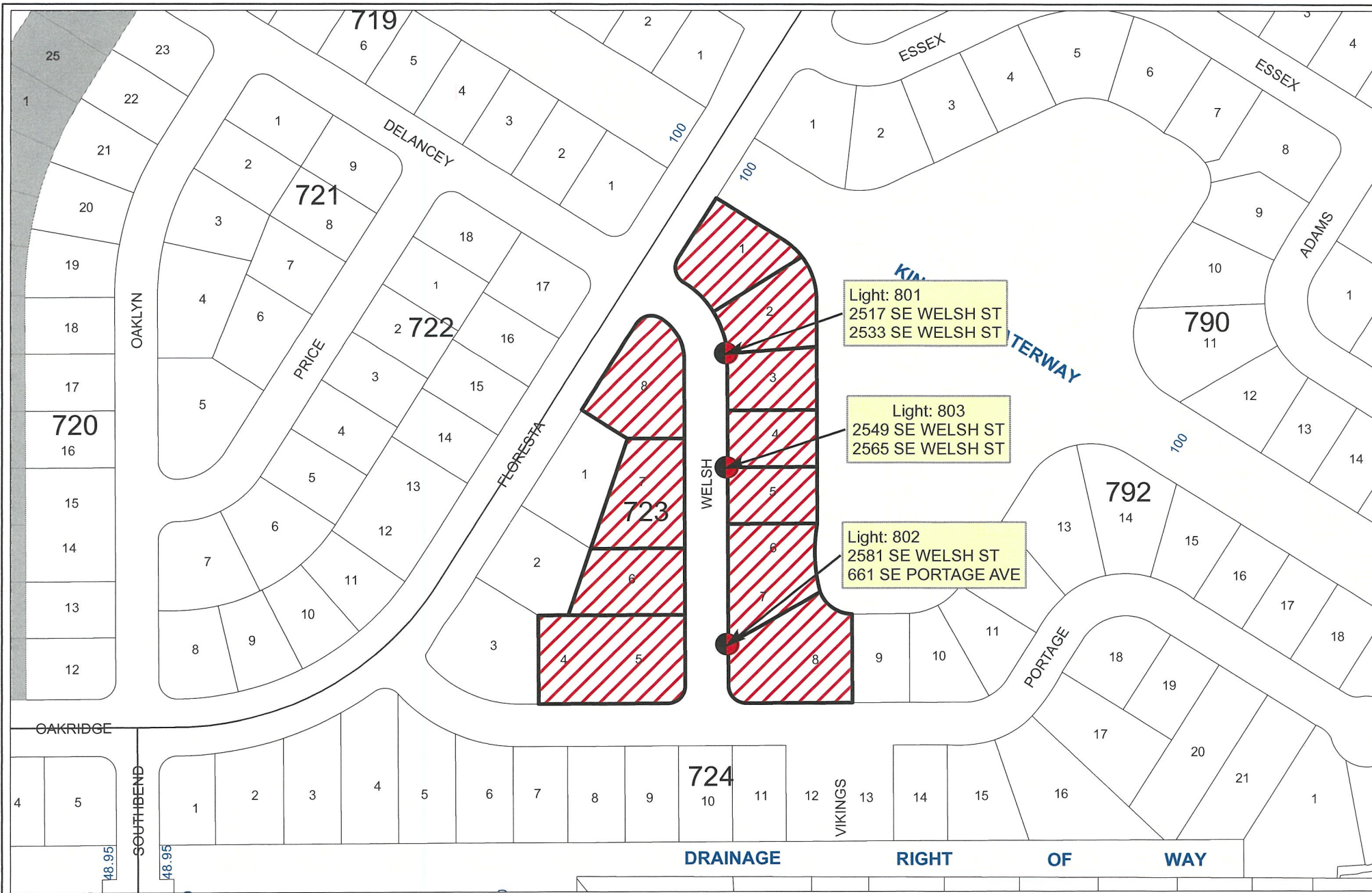

Prepared by City of Port St. Lucie
City Clerks Office
Friday, June 7, 2024



SE WELSH STREET Boundary # 672





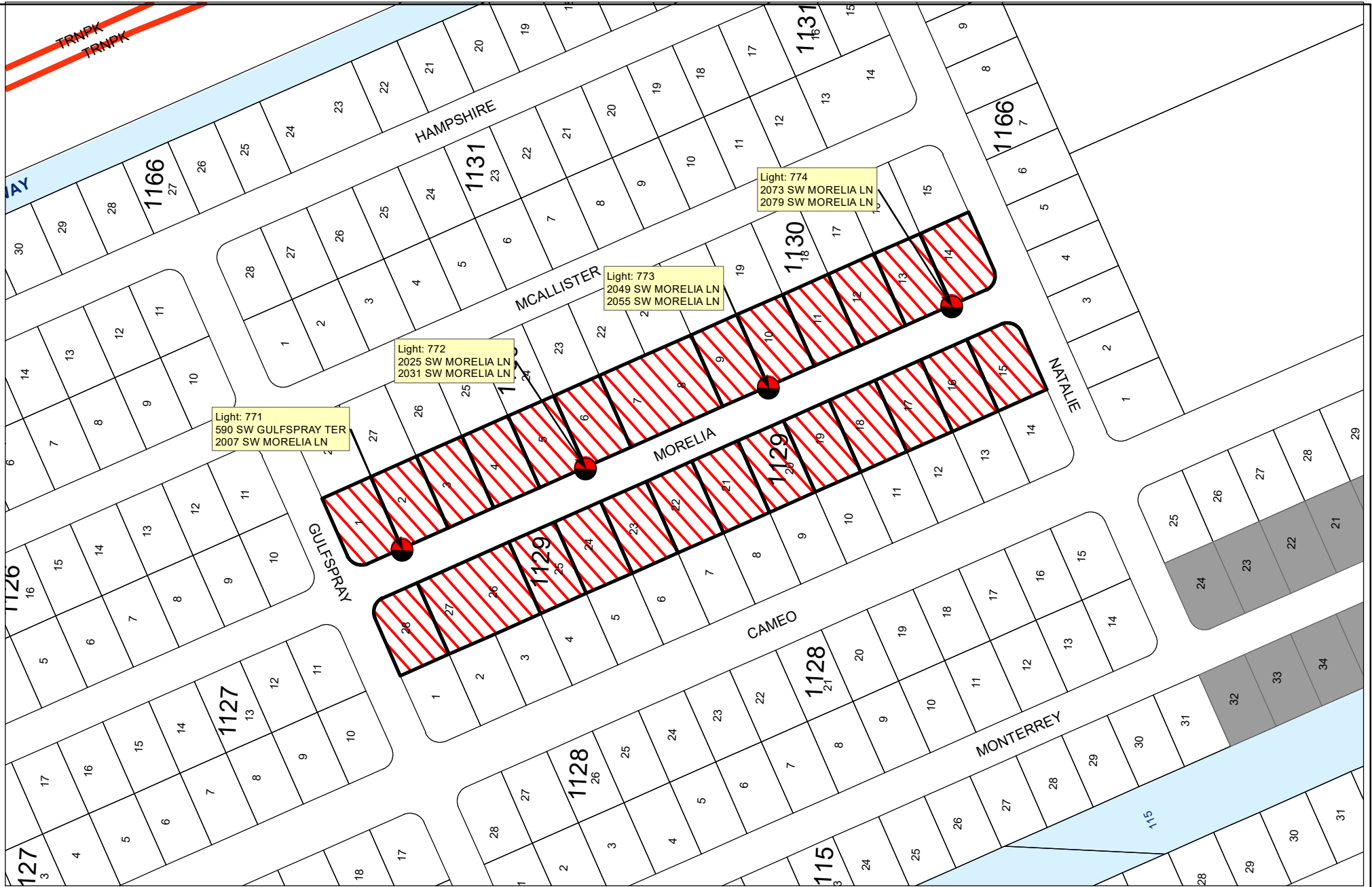

-  Proposed Lights (3)
-  Proposed Boundary (11)
-  Existing Boundary
-  Parcels





"A City for All Ages"

-  Proposed Lights (4)
-  Proposed Boundary (26)
-  Existing Boundary
-  Parcels

SW MORELIA LANE Boundary # 673

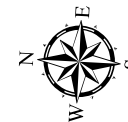

Prepared by City of Port St. Lucie
City Clerks Office
Friday, June 7, 2024



SE BYWOOD AVENUE Boundary # 674



"A City for All Ages"

- Proposed Lights (5)
- Proposed Boundary (25)
- Existing Boundary
- Parcels

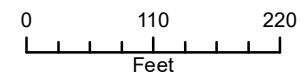
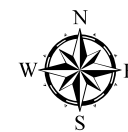

Prepared by City of Port St. Lucie
City Clerks Office
Friday, June 7, 2024

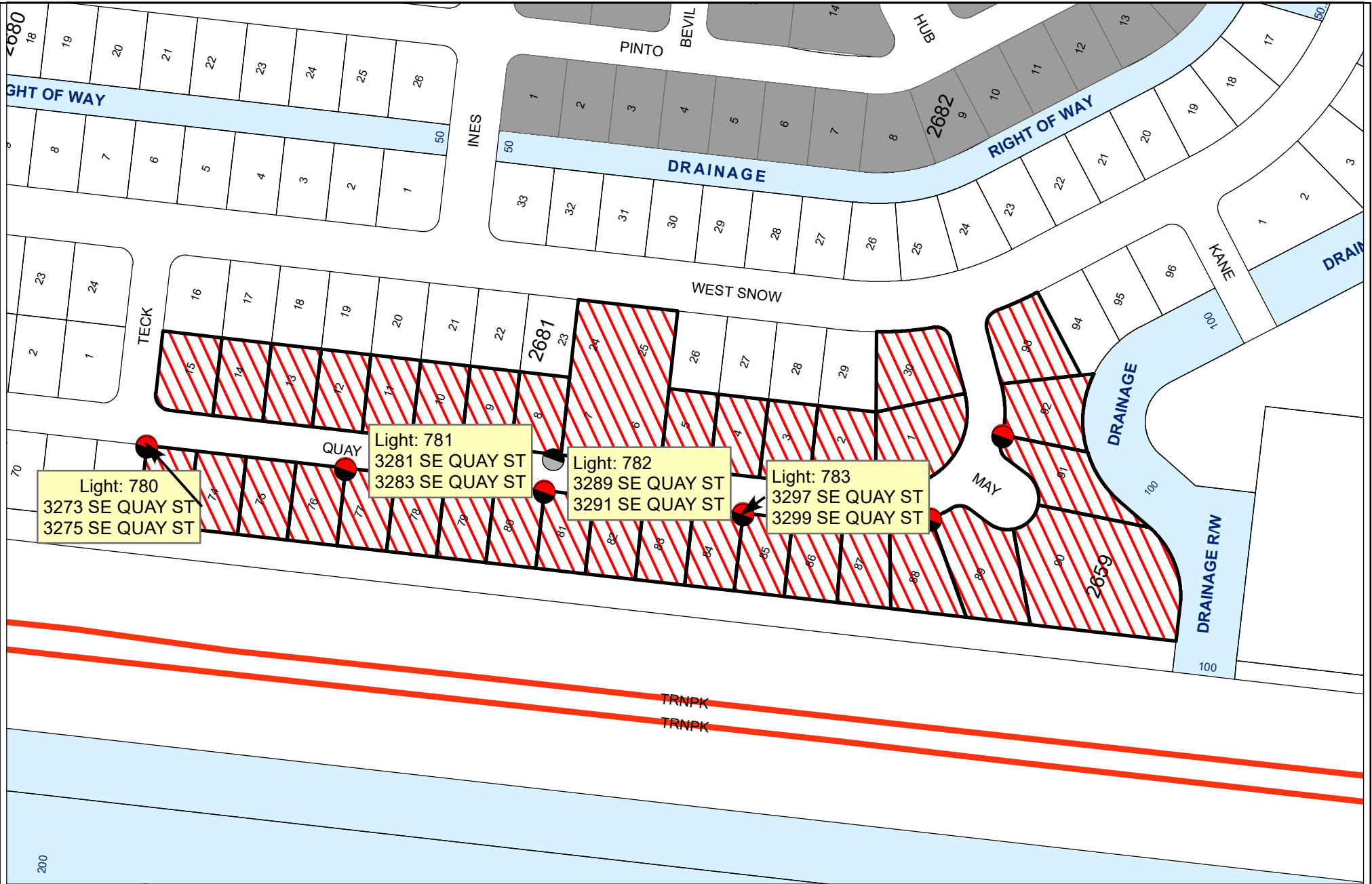





Light: 780
3273 SE QUAY ST
3275 SE QUAY ST

Light: 781
3281 SE QUAY ST
3283 SE QUAY ST

Light: 782
3289 SE QUAY ST
3291 SE QUAY ST

Light: 783
3297 SE QUAY ST
3299 SE QUAY ST

-  Existing Lights
-  Proposed Lights (6)
-  Proposed Boundary (36)
-  Existing Boundary
-  Parcels

SE QUAY STREET Boundary # 675

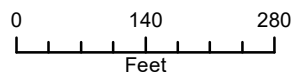

Prepared by City of Port St. Lucie
City Clerks Office
Friday, June 7, 2024



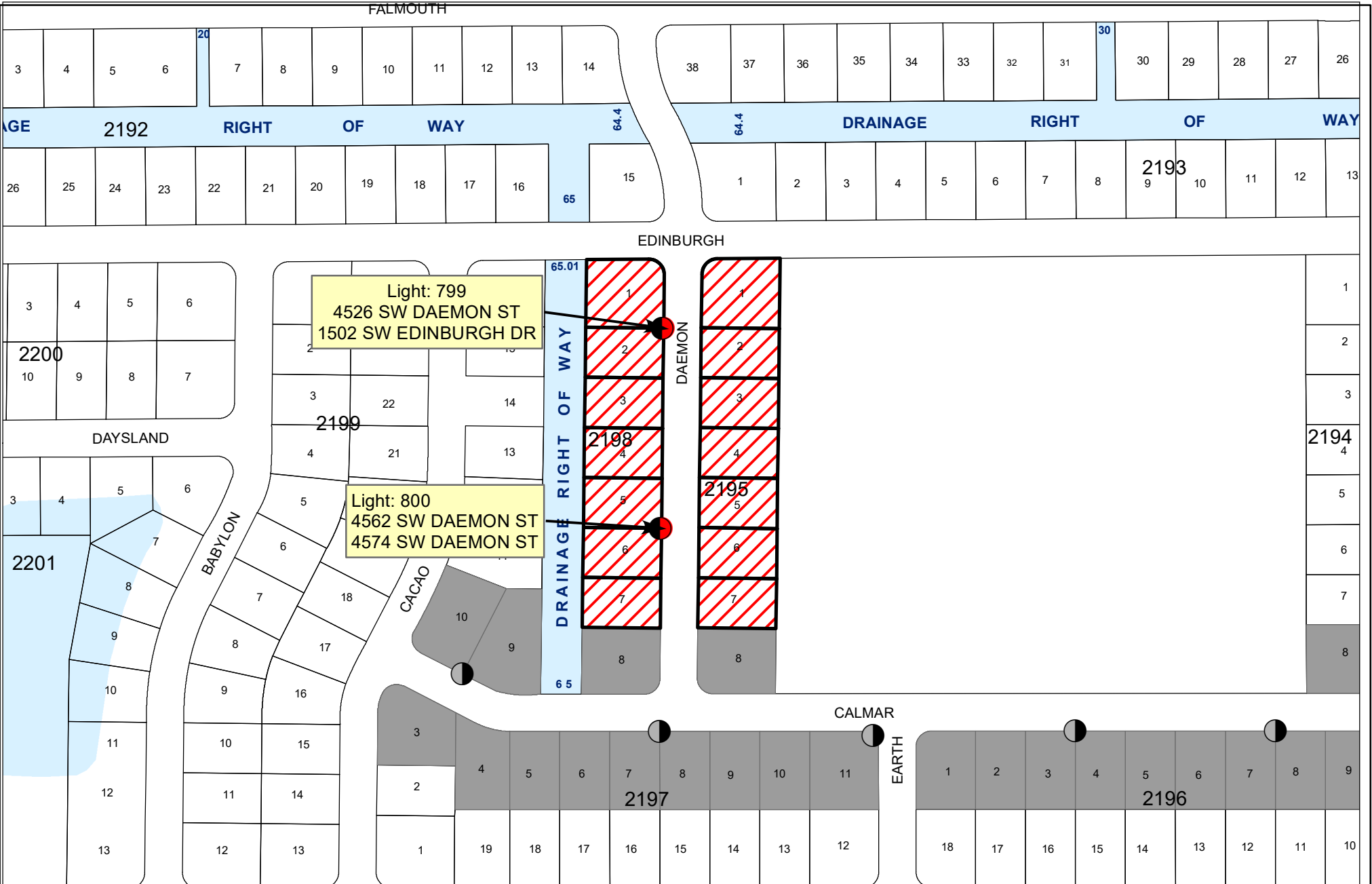





Light: 799
4526 SW DAEMON ST
1502 SW EDINBURGH DR

Light: 800
4562 SW DAEMON ST
4574 SW DAEMON ST

SW DAEMON STREET Boundary # 678

-  Existing Lights
-  Proposed Lights (2)
-  Proposed Boundary (14)
-  Existing Boundary
-  Parcels

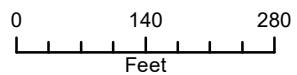

Prepared by City of Port St. Lucie
City Clerks Office
Friday, June 7, 2024

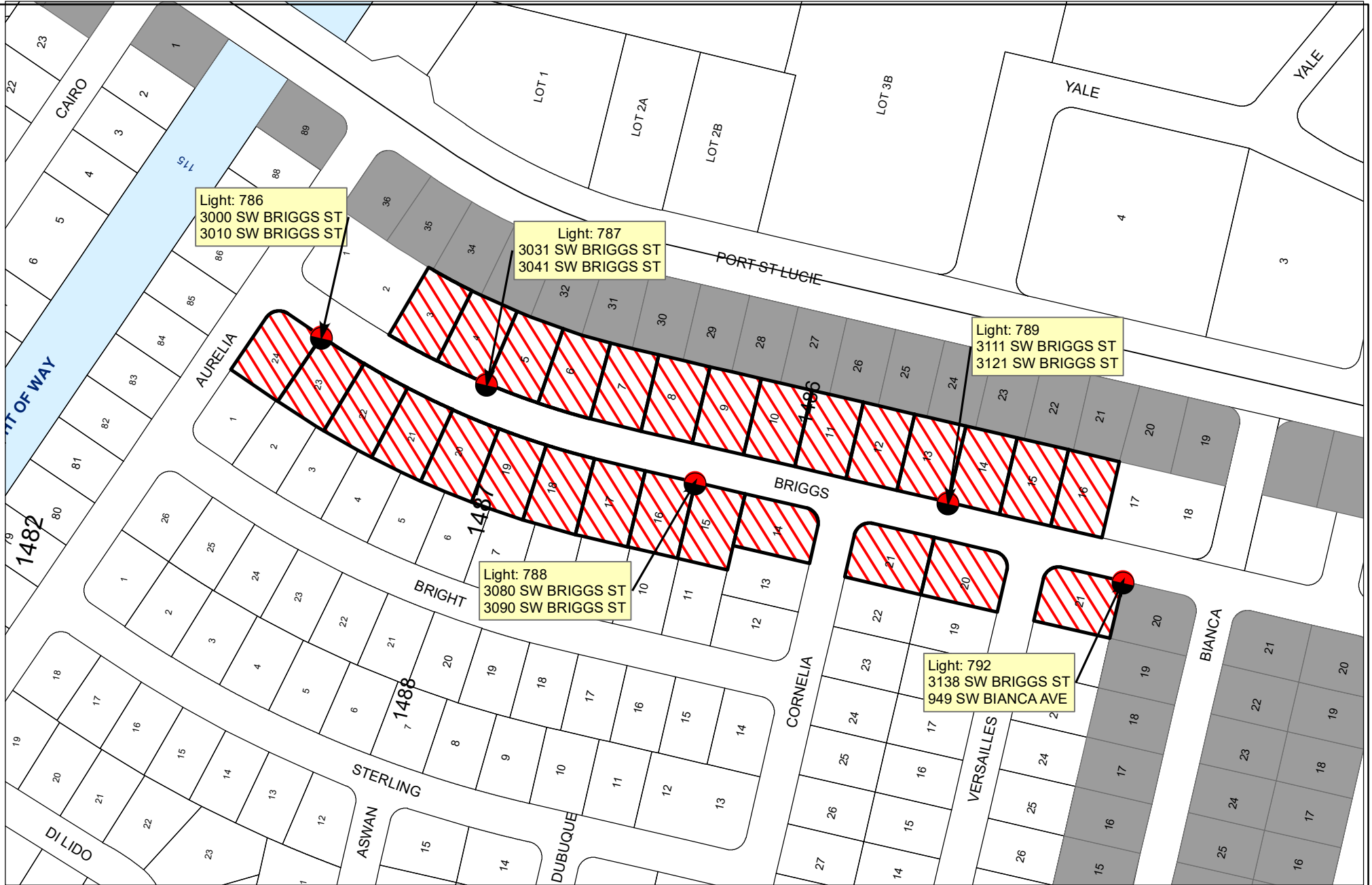

Light: 786
3000 SW BRIGGS ST
3010 SW BRIGGS ST

Light: 787
3031 SW BRIGGS ST
3041 SW BRIGGS ST





Light: 789
3111 SW BRIGGS ST
3121 SW BRIGGS ST

Light: 788
3080 SW BRIGGS ST
3090 SW BRIGGS ST

Light: 792
3138 SW BRIGGS ST
949 SW BIANCA AVE



"A City for All Ages"



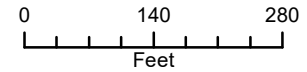
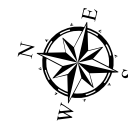

-  Proposed Lights (5)
-  Proposed Boundary (28)
-  Existing Boundary
-  Parcels

SW BRIGGS STREET Boundary # 681

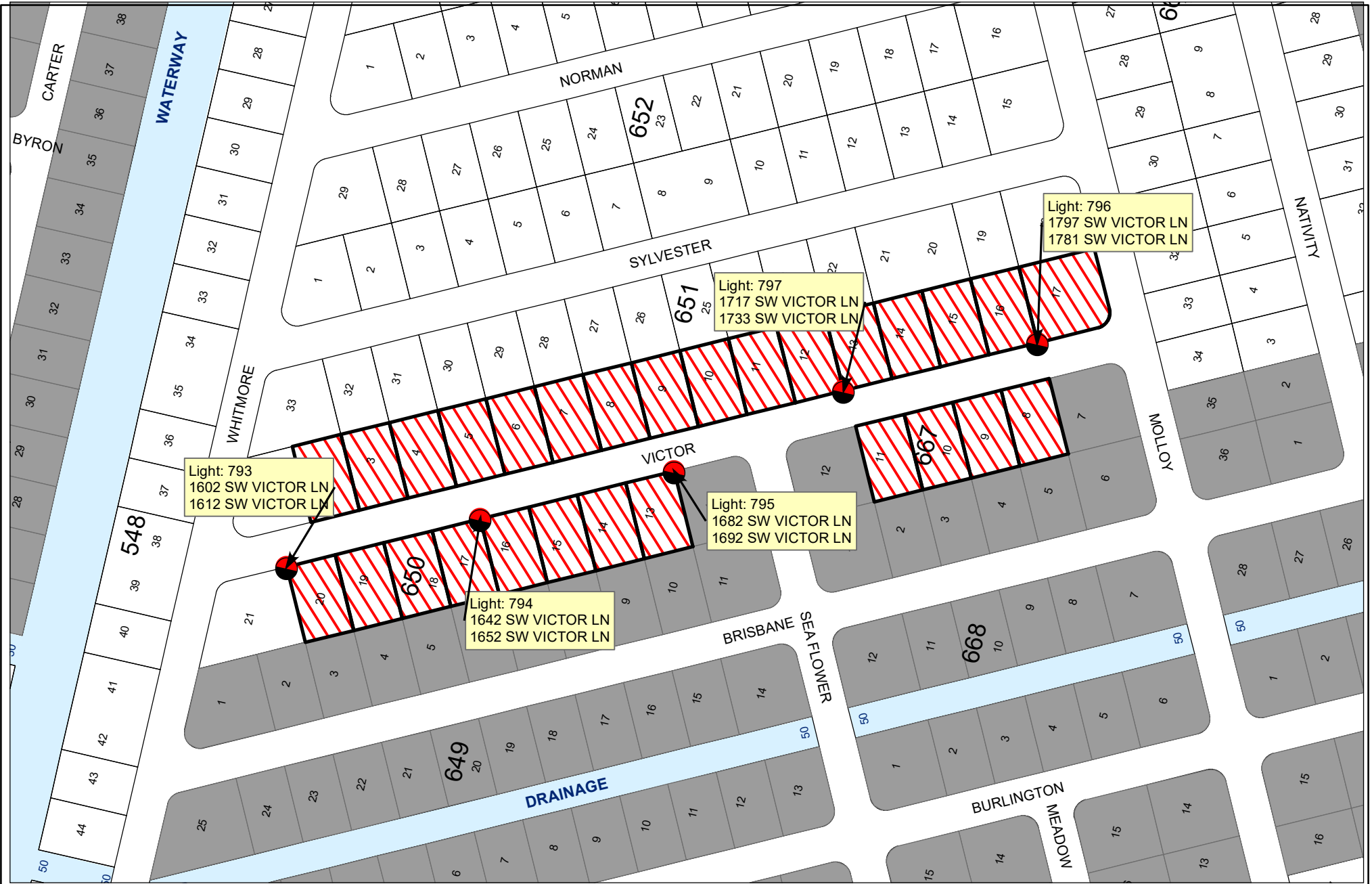

Prepared by City of Port St. Lucie
City Clerks Office
Friday, June 7, 2024



-  Proposed Lights (5)
-  Proposed Boundary (28)
-  Existing Boundary
-  Parcels

SW VICTOR LANE Boundary # 682

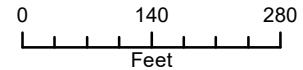

Prepared by City of Port St. Lucie
City Clerks Office
Friday, June 7, 2024