

\\netw\c\user\p1\10007866.dwg Plot: P1 User: P1 Date: 15/03/2023 5:50:30 PM

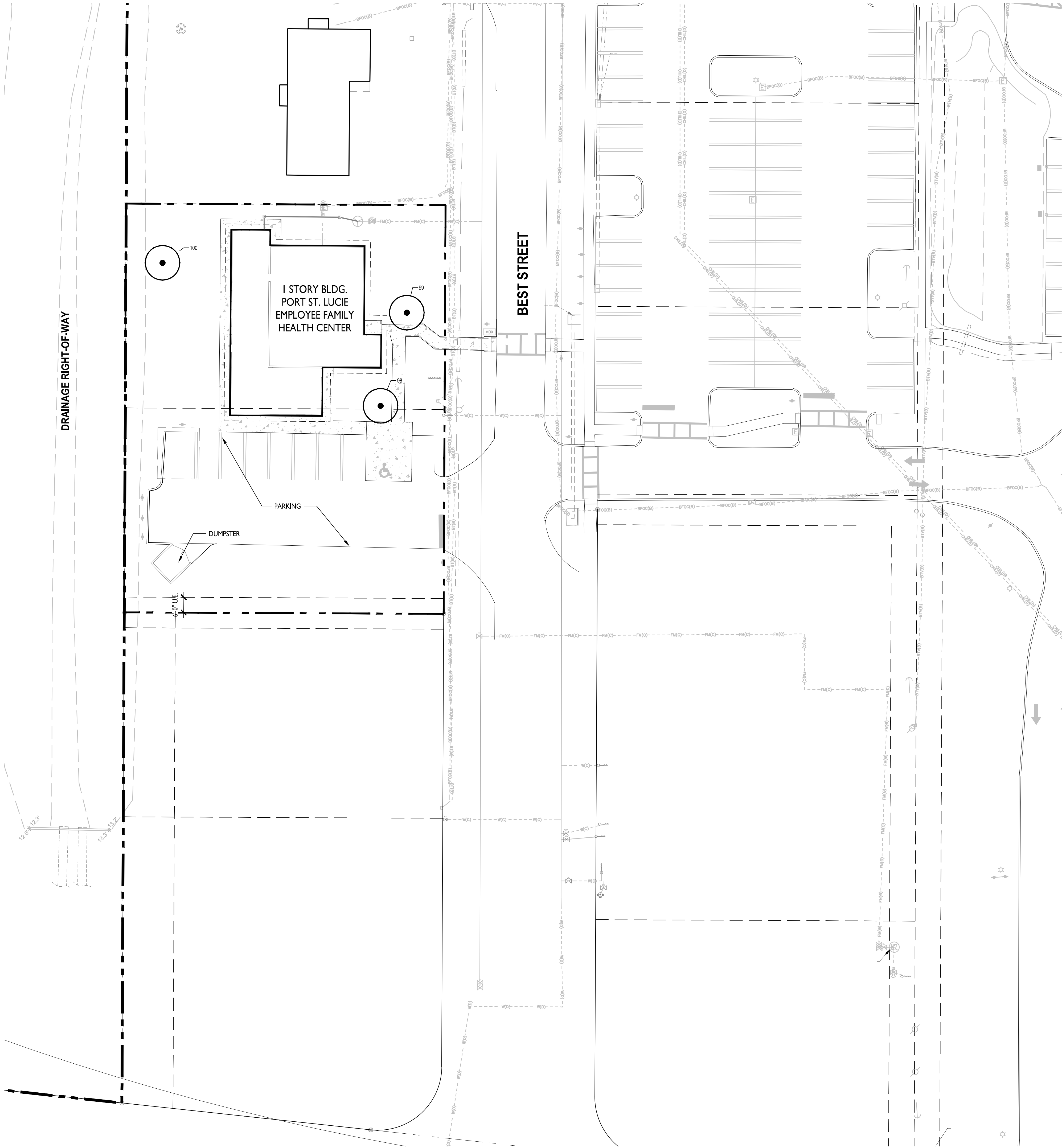

TREE TABLE

Tag #	Common Name	Scientific Name	DBH (inches)	Disposition	Notes
98	Live Oak	Quercus virginiana	18	Preserve	
99	Live Oak	Quercus virginiana	19	Preserve	
100	Live Oak	Quercus virginiana	42	Preserve	
				Hardwood Removed: 0	Total Hardwood DBH preserved 79
				Palms Removed: 0	Total Hardwood DBH removed 0
				Hardwoods Relocated: 0	Total Hardwood DBH mitigation required 0
				Palms Relocated: 0	
				Hardwoods Preserved: 3	
				Palms Preserved: 0	

*All palms are measured in feet to clear trunk

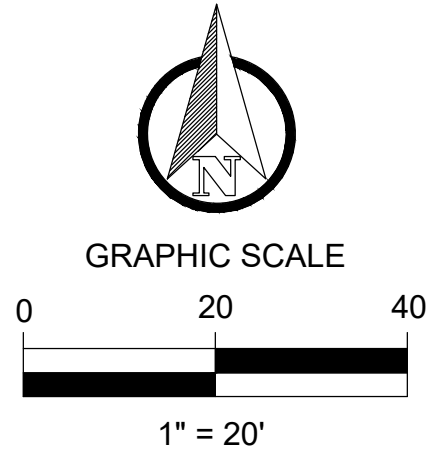

LEGEND

- PRESERVED TREE/ PALM
- RELOCATED TREE/ PALM

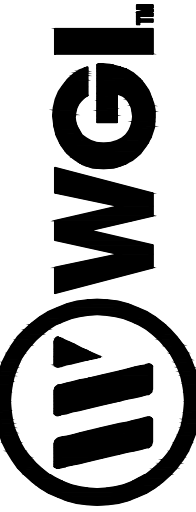

2035 Vista Parkway, West Palm Beach, FL 33411
Phone No. 866.909.2220 www.wginc.com
Cert No. 6091 - LB No. 7055

REVISIONS			
NO.	DATE	DESCRIPTION	BY

CAD 768600_TD_HCDWG	
JOB NO. 7686.00	
DRAWN BY VO / BJ	
CHECK BY KS	
DATE 01/04/2023	

LANDSCAPE ARCHITECT OF RECORD
KIRSTEN SIEGEL, PLA
LA 6667375

NOT FOR
CONSTRUCTION

PORT ST. LUCIE EMPLOYEE
FAMILY HEALTH CENTER
TREE DISPOSITION PLAN

SHEET:
LD-100
P22-339

V:\Users\Quinn\p190070986.00 Port St Lucie Police Trial\Drawing\p190070986.00 LP-100.dwg -- Plotted: 15/02/2023 5:54:18 PM, Saved: 15/02/2023 5:55:38 PM

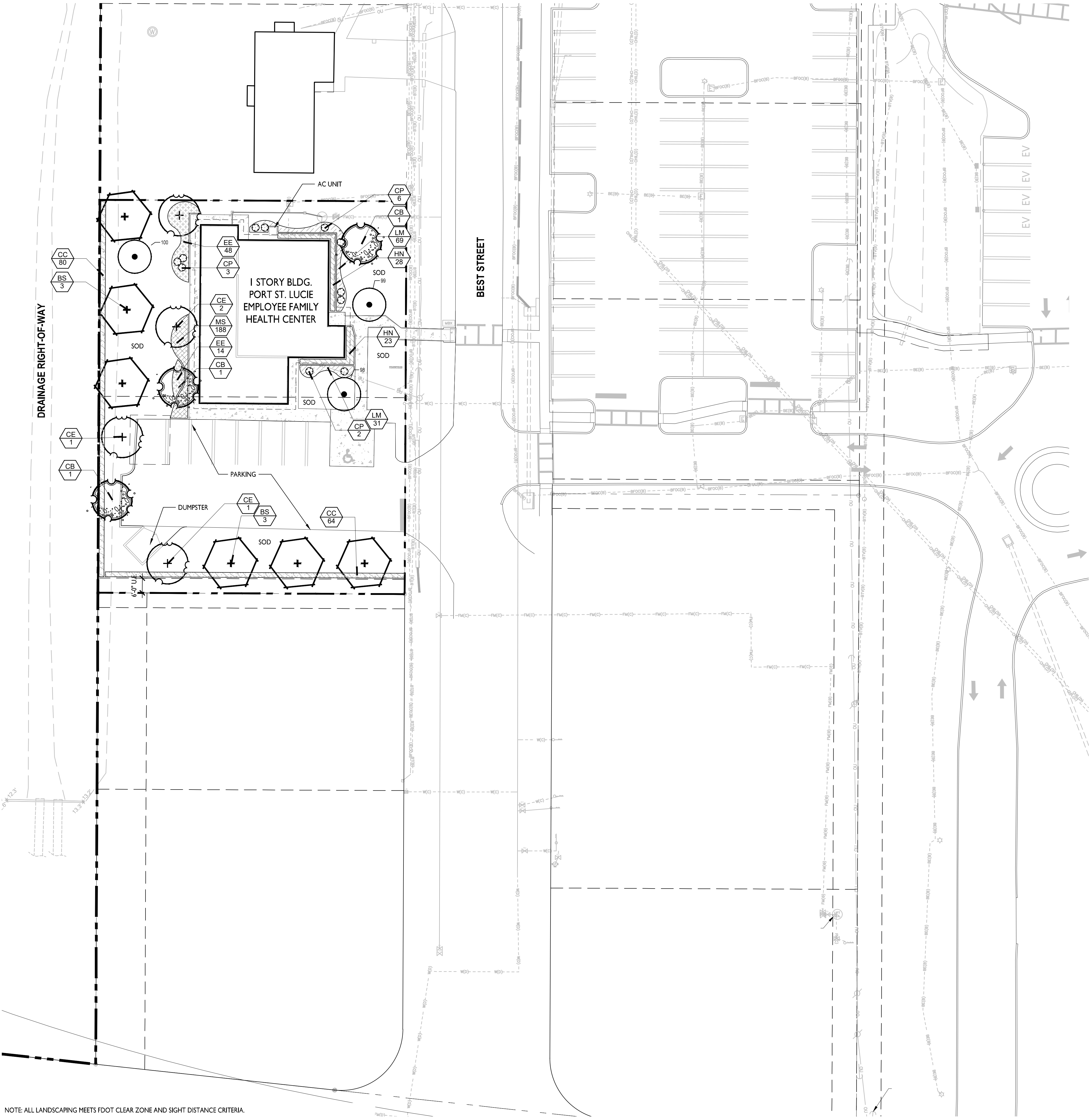

NOTE: ALL LANDSCAPING MEETS FOOT CLEAR ZONE AND SIGHT DISTANCE CRITERIA.

PLANT SCHEDULE

TREES	QTY	COMMON NAME	BOTANICAL NAME	NATIVE	DROUGHT TOLERANCE	REMARKS
BS	6	Gumbo Limbo	Bursera simaruba	YES	YES	14' HT. X 5' SPRD. MIN., 2.5" CAL
CB	3	Pink Shower Tree	Cassia bakeriana	NO	YES	14' HT. X 5' SPRD. MIN., 2.5" CAL
CE	4	Buttonwood	Conocarpus erectus	YES	YES	14' HT. X 5' SPRD. MIN., 2.5" CAL
SHRUBS	QTY	COMMON NAME	BOTANICAL NAME	NATIVE	DROUGHT TOLERANCE	REMARKS
CP	11	Petra Croton	Codiaeum variegatum 'Petra'	NO	YES	48" HT X 36" SPRD, FULL, LOW BRANCHED
SHRUB AREAS	QTY	COMMON NAME	BOTANICAL NAME	NATIVE	DROUGHT TOLERANCE	REMARKS
CC	144	Jamaica Caper	Capparis cynophallophora	YES	YES	36" HT X 24" SPRD @24" O.C.
EE	62	Elliot's Love Grass	Eragrostis eliotii	YES	YES	24" HT x 24" SPRD @ 24" O.C.
HN	51	Dwarf Firebush	Hamelia nodosa	NO	YES	24" HT. X 24" SPRD. @ 24" O.C.
GROUND COVERS	QTY	COMMON NAME	BOTANICAL NAME	NATIVE	DROUGHT TOLERANCE	REMARKS
LM	100	Lilyturf	Liriope muscari	NO	YES	18" HT X 18" SPRD @ 18" O.C.
MS	188	Sunshine Mimosa	Mimosa strigillosa	YES	YES	6" HT, 8" SPRD, FULL, LOW BRANCHED, BLOOMING @ 12" O.C.

PSLUSD LANDSCAPE NOTES:

1. NO LANDSCAPING SHALL BE PLANTED IN A MANNER THAT WOULD ADVERSELY AFFECT UTILITY EASEMENTS. LANDSCAPING SHALL BE IN COMPLIANCE WITH CHAPTER 154 OF THE CITY OF PORT ST. LUCIE CODE OF ORDINANCES, PSLUSD TECHNICAL SPECIFICATIONS AND POLICIES.
2. ALL LANDSCAPING WITHIN CITY UTILITY EASEMENTS SHALL COMPLY WITH PSLUSD TECHNICAL SPECIFICATIONS, POLICIES, AND CODES.
3. ALL LANDSCAPING SHALL MEET THE LATEST PSLUSD LANDSCAPE POLICY AND SHALL NOT BE PLACED IN A MANNER THAT WOULD CREATE CONFLICTS WITH THE INTENDED OPERATION AND MAINTENANCE OF ANY EXISTING UTILITY.
4. TREES SHALL NOT BE PLANTED WITHIN TEN (10) FEET OF ANY PSLUSD UNDERGROUND INFRASTRUCTURE.
5. NO LANDSCAPING OTHER THAN SOD GRASSES SHALL BE LOCATED WITHIN 5' OF A PSLUSD APPURTENANCE SUCH AS A WATER METER ASSEMBLY, BACKFLOW DEVICE, FIRE HYDRANT OR SEWER CLEANOUT, ETC.

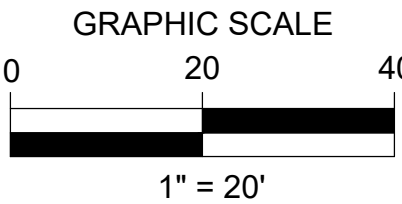
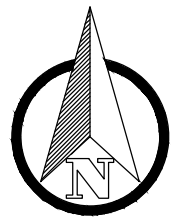

LANDSCAPE REQUIREMENTS		
CITY OF PORT ST. LUCIE, FLORIDA		
GENERAL LANDSCAPING		
SITE PERIMETER LANDSCAPING	REQUIRED	PROVIDED
10' WIDE LANDSCAPE STRIP, EXCLUDING CURBING, LOCATED ADJACENT TO ALL RIGHT-OF-WAY AND ABUTTING PROPERTIES. 1 TREE PER 30 LF OF REQUIRED LANDSCAPE PERIMETER AREA CONTINUOUS HEDGE EXTENDED ALONG THE PERIMETER. 1 SHRUB PER 2 LF SHRUBS AT LEAST 24" IN HEIGHT AT TIME OF PLANTING.	DRAINAGE RIGHT-OF-WAY 160 LF / 30 LF = 5 TREES (INCLUDING 5 TREES x 75% = 3 SHADE TREES MIN.) 160 LF / 2 LF = 80 SHRUBS SOUTH PERIMETER 125 LF / 30 LF = 4 TREES (INCLUDING 4 TREES x 75% = 3 SHADE TREES MIN.) 125 LF / 2 LF = 63 SHRUBS	DRAINAGE RIGHT-OF-WAY 5 TREES PROVIDED [1 EXISTING TREE + 4 PROPOSED TREES] 4 SHADE TREES PROVIDED 83 SHRUBS PROVIDED SOUTH PERIMETER 4 TREES PROVIDED 4 SHADE TREES PROVIDED 64 SHRUBS PROVIDED
BUILDING FACADE	REQUIRED	PROVIDED
5' WIDE LANDSCAPE STRIP, LOCATED AROUND PERIMETER OF A BUILDING ADJACENT TO ALL RIGHT-OF-WAY AND ABUTTING PROPERTIES. 1 TREE / PALM PER 30 LF OF BUILDING FACADE CONTINUOUS HEDGE EXTENDED ALONG THE PERIMETER. 1 SHRUB PER 2 LF SHRUBS AT LEAST 24" IN HEIGHT AT TIME OF PLANTING.	180 LF / 30 LF = 6 TREES / PALMS 180 LF / 2 LF = 90 SHRUBS	MIN. 5' WIDE LANDSCAPE STRIP PROVIDED 6 TREES PROVIDED [2 EXISTING TREES + 4 PROPOSED TREES] 130 SHRUBS PROVIDED
VEHICULAR USE AREAS		
PARKING LOT INTERIOR LANDSCAPE	REQUIRED	PROVIDED
1 PARKING ISLAND AT EACH END OF A PARKING BAY WITH 1 SHADE TREE AND THE REMAINDER OF THE ISLAND LANDSCAPED WITH A GROUND COVER, MULCH, SHRUBS OR OTHER TREATMENT EXCLUDING PAVING.	2 PARKING ISLANDS = 2 SHADE TREES	1 TREE PROVIDED (1 ISLAND HAS CONFLICT WITH EXISTING UTILITIES)
PLANT MATERIAL STANDARDS		
PLANT SPECIES		PROVIDED
MIN 50% OF TOTAL TREE MATERIAL MUST BE NATIVE MAX 25% OF SHALL BE PALMS MIN 20% MUST BE FLOWERING TREES MIN 75% SHALL BE EVERGREEN TREES MIN. 2 TREE SPECIES MIN 25% OF TOTAL SHRUBS MUST BE NATIVE MIN 10% OF GROUNDCOVERS SHALL BE FLOWERING MIN. 50% OF PLANT MATERIAL SHALL BE DROUGHT TOLERANT		70% OF TREES PROVIDED ARE NATIVE 10% OF TREES PROVIDED ARE PALMS 30% OF TREES PROVIDED ARE FLOWERING TREES 75% OF TREES PROVIDED ARE EVERGREEN TREES 4 TREE SPECIES PROVIDED 95% OF SHRUBS ARE NATIVE 19% OF GROUNDCOVERS ARE FLOWERING 100% OF SHRUBS AND GROUND COVER PROVIDED ARE DROUGHT TOLERANT

REVISIONS		BY
NO.	DATE	DESCRIPTION

CAD 7686.00_LP_HCDWG	JOB NO. 7686.00	DRAWN BY VO / BJ	CHECK BY KS	DATE 01/04/2023
LANDSCAPE ARCHITECT OF RECORD KIRSTEN SIEGEL, PLA LA 6667375				

NOT FOR CONSTRUCTION

PORT ST. LUCIE EMPLOYEE
FAMILY HEALTH CENTER
LANDSCAPE PLAN

NOTE:

1. APPLICABLE TO ALL PALMS WITH CALIPER SIZE OF LESS THAN SIX (6) INCHES.
2. ALL TREE SUPPORTS MATERIALS ARE TO BE REMOVED FROM EACH TREE ONCE IT IS ESTABLISHED. TYPICALLY SIX MONTHS FOR SHADE TREES OR ONE YEAR FOR PALMS.

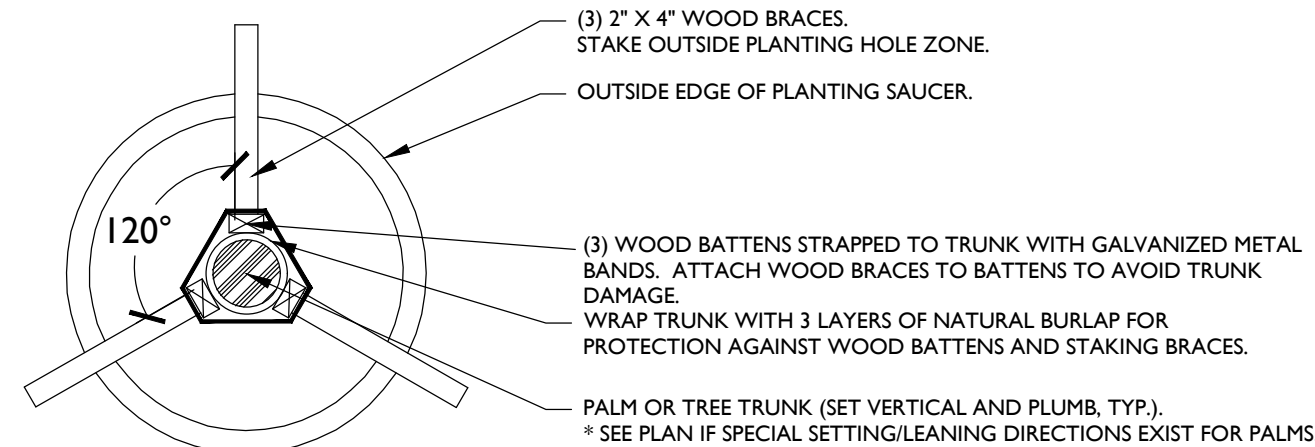

NOTE:

1. APPLICABLE TO ALL MULTI-TRUNK PALMS AND PALMS WITH CALIPER SIZE OF SIX (6) INCHES OR GREATER
2. ALL TREE SUPPORTS MATERIALS ARE TO BE REMOVED FROM EACH TREE ONCE IT IS ESTABLISHED. TYPICALLY SIX MONTHS FOR SHADE TREES OR ONE YEAR FOR PALMS.

NTS.

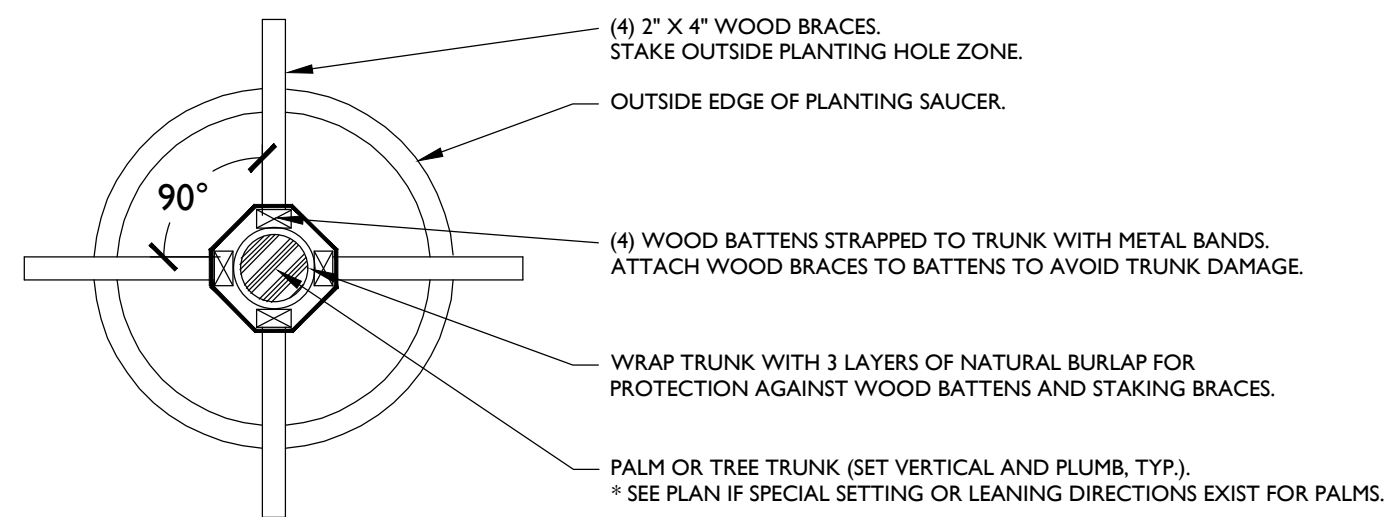

Technical drawing of a palm tree installation showing various specifications for trunk, root ball, and backfill. The drawing includes a cross-section of the tree and its root ball, with dimensions and materials specified. Key features include:

- Trunk:** Hurricane cut or candle cut at the top. Trunk shall be clear and free from defects and scars. Trunk is wrapped with 3 layers of natural burlap under braces. Trunk is supported by 2" x 4" wooden staking braces, secured with steel banding and 20d nails.
- Root Ball:** Set top of root ball at finished grade. Root ball is wrapped with 3" layer of melaleuca mulch (6" total height). Mulch is extended 12" beyond berm and pulled 12" away from trunk.
- Backfill:** Backfill shall be clean, salt free sand and peat moss mixture 3:1 ratio. All backfill shall be water-jetted for firm compaction.
- Dimensions:** Clear trunk height is indicated. Minimum 5' clearance is shown. Distance around the root ball is 12" (or 12" min. clearance).
- Labels:** "HURRICANE CUT" OR "CANDLE CUT" SABAL PALM HEADS AT INSTALLATION. FOR CONTAINER GROWN, BARE ROOT, FIELD DUG OR BALL AND BURLAP SPECIMEN PALMS: SHIPPING FROND TIES SHALL BE REMOVED UPON INSTALLATION. TIES SHALL BE ORGANIC TWINE ONLY. FOR BOOTED TRUNK PALMS, TRUNKS SHALL HAVE CLEAN INTACT BOOTS FIRMLY ATTACHED TO THE PALM TRUNK. FOR SLICK TRUNK PALMS, TRUNK SHALL BE CLEAR AND FREE FROM DEFECTS AND SCARS. BURLAP WRAP TRUNK WITH 3 LAYERS OF NATURAL BURLAP UNDER BRACES, TO PROTECT TRUNK. 2" X 4" BATTEN BRACES WITH 2" X 4" WOOD STAKING BRACES. USE STEEL BANDING TO WRAP BLOCKS AROUND PALM TRUNK. USE 20D NAILS TO NAIL ANCHOR BLOCKS TO STAKING BRACES (SEE STAKING DETAILS FOR NUMBER OF REQUIRED BRACES). *NO NAILS SHALL PERCE THE TREE TRUNK. SET TOP OF ROOT BALL AT FINISHED GRADE. PROVIDE A 3" BERMED SAUCER ABOVE THE FINISHED GRADE WITH A 3" LAYER OF MELALEUCA MULCH (6" TOTAL HEIGHT). EXTEND MULCH BEYOND BERM. PULL MULCH AWAY FROM TRUNK A MINIMUM OF 3". 2" X 4" X MIN. 24" WOOD STAKES. ANCHOR TREE BRACES WITH WOOD STAKES. INSTALL STAKE BRACES OUTSIDE TEMPORARY SAUCER. FINISHED GRADE. BACKFILL SHALL BE CLEAN, SALT FREE SAND AND PEAT MOSS MIXTURE 3:1 RATIO. ALL BACKFILL SHALL BE WATER-JETTED FOR FIRM COMPACTION. DISTANCE AROUND THE ROOT BALL SHALL BE 1/2 THE WIDTH OF THE ROOTBALL, OR (12") MIN. CLEARANCE. TAMP BOTTOM OF PLANTING HOLE TO MINIMIZE SETTLING.

NOTE:
1. ALL TREE SUPPORT MATERIALS ARE TO BE REMOVED FROM EACH TREE ONCE IT IS ESTABLISHED. TYPICALLY SIX MONTHS TO ONE YEAR AFTER PLANTING FOR SHADE TREES.

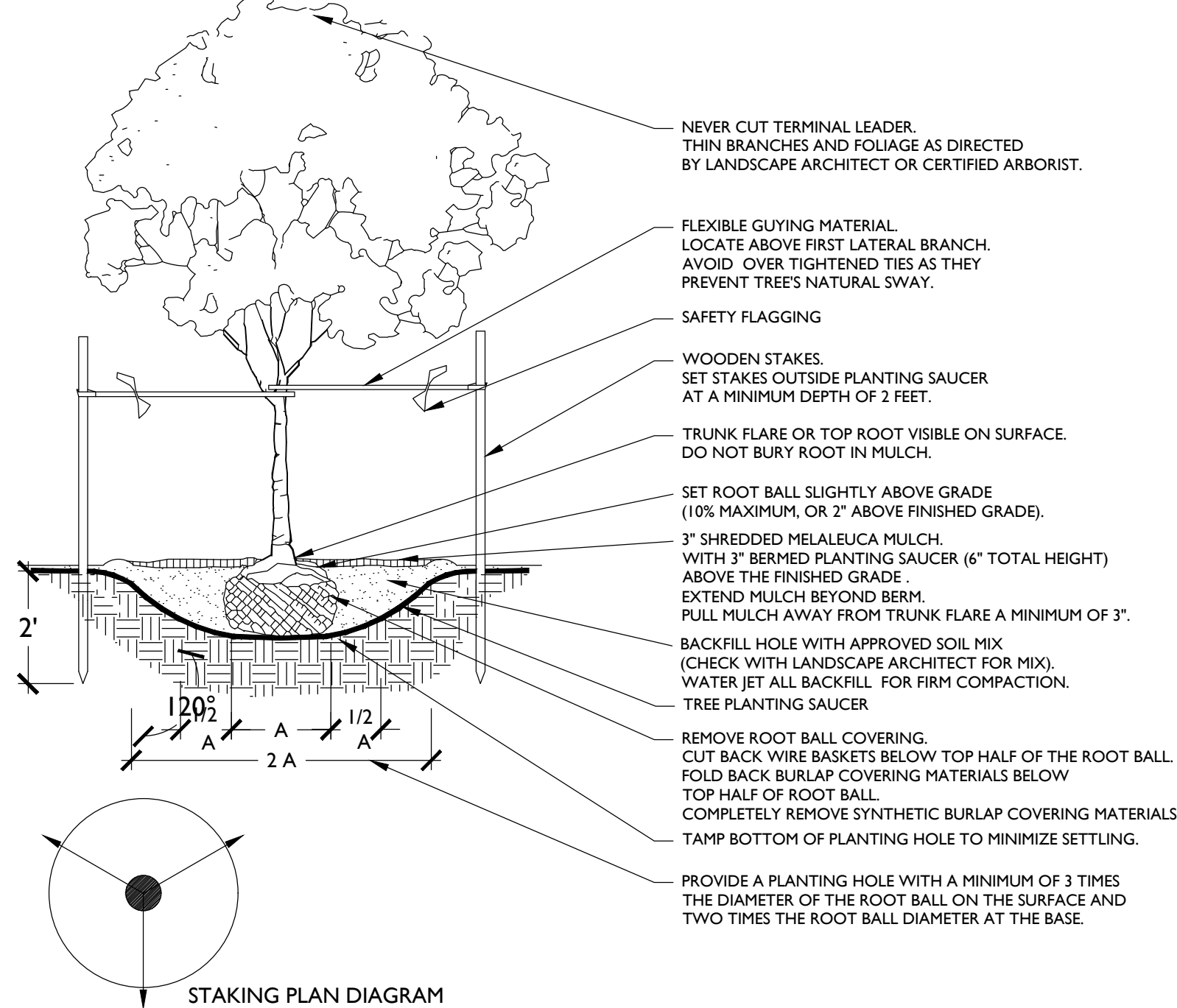

SPACING "D"	ROW "A"	PLANT SPACING CHART	NTS.
6" O.C.	5.3"		
8" O.C.	6.93"		
10" O.C.	8.66"		
12" O.C.	10.4"		
18" O.C.	15.6"		
24" O.C.	20.8"		
30" O.C.	26.0"		
36" O.C.	31.2"		
48" O.C.	41.6"		

NTS.

PLANT ROOTBALL MINIMUM OF 1" ABOVE FINISHED GRADE WITH A MAXIMUM OF 10% OF ROOTBALL EXPOSED ABOVE GRADE.

3" SHREDDED HEMLOCK MULCH. PULL MULCH AWAY FROM TRUNK A MINIMUM OF 3".

PROVIDE 3" EARTH PLANTING SAUCER

FINISHED GRADE

REMOVE BURLAP FROM TOP 1/3 OF ROOTBALL. COMPLETELY REMOVE ANY SYNTHETIC WRAPPING MATERIALS.

BACKFILL PLANTING HOLE WITH APPROVED PLANTING MIX. SEE LANDSCAPE ARCHITECT FOR PROPER MIX SPECIFICATIONS.

PROVIDE A PLANTING HOLE MINIMUM OF 3 TIMES THE DIAMETER OF THE ROOT BALL ON THE SURFACE AND TWO TIMES THE ROOT BALL DIAMETER AT THE BASE.

TAMP BOTTOM OF PLANTING HOLE TO MINIMIZE PLANT SETTLING.

1/2 A A 1/2 A

3 A

NOTE:

1. TREES ARE TO BE INSTALLED WITH A MINIMUM TEN FOOT (10') SEPARATION FROM ANY PUBLIC WATER OR PUBLIC SEWER MAIN AND/OR SERVICE, HYDRANTS, AND LIFT STATIONS. IF A TEN FOOT (10') SEPARATION CANNOT BE ACHIEVED, THE TREE SHALL BE INSTALLED WITH A ROOT BARRIER SYSTEM.
2. ROOT BARRIERS SHALL COMPLY WITH ALL REQUIREMENTS OF THE MUNICIPALITY WITHIN WHICH THEY ARE LOCATED AS WELL AS WITH ANY REQUIREMENTS OF THE UTILITY HOLDER OF THE AFFECTED UTILITIES. IN THE EVENT THAT CONFLICTING REQUIREMENTS EXIST BETWEEN THIS ROOT BARRIER DETAIL AND THE MUNICIPALITY/UTILITY HOLDER REQUIREMENTS, THE MORE STRINGENT OF THE REQUIREMENTS SHALL BE APPLICABLE.

PLANTING SAUCER, TYP.

MINIMUM 8" COVER OVER TOP OF BARRIER. SET BARRIER A MINIMUM OF 4" BELOW THE FINISHED GRADE.

"BIO BARRIER" OR "DEEP ROOT"

5'

8'

FINISHED GRADE

NOTE 1. THIS DETAIL APPLIES TO ALL TREES THAT WILL BE PRESERVED IN PLACE OR BE RELOCATED.

NTS.

STRUCTURAL ELEMENTS AND HARDWARE FEATURES INDICATED ON LANDSCAPE PLANS ARE FOR INFORMATIONAL PURPOSES ONLY. LANDSCAPE PLANS ARE TO BE UTILIZED FOR LOCATION OF LIVING PLANT MATERIAL ONLY. LANDSCAPE PLANS SHOULD NOT BE UTILIZED FOR STAKING AND LAYOUT OR LOCATION OF ANY STRUCTURAL, SITE FEATURES INCLUDING BUT NOT LIMITED TO: BUILDINGS, SIGNAGE, PATHWAYS, EASEMENTS, BERMS, WALL, FENCES, UTILITIES OR ROADWAYS.

5. CONTRACTOR SHALL ACQUIRE ALL APPLICABLE FEDERAL, STATE, LOCAL, JURISDICTIONAL, OR UTILITY COMPANY PERMITS REQUIRED PRIOR TO REMOVAL, REPLACEMENT, AND/OR INSTALLATION OF LANDSCAPE MATERIALS INDICATED WITHIN PLAN DOCUMENTS. THE CONTRACTOR SHALL HAVE PERMITS "IN HAND" PRIOR TO STARTING WORK. LANDSCAPE ARCHITECT SHALL BEAR NO RESPONSIBILITY FOR WORK PERFORMED WITHOUT PERMITTED DRAWINGS. THE CONTRACTOR SHALL BE RESPONSIBLE FOR ALL CHANGES TO THE WORK, AT NO ADDITIONAL COST TO THE OWNER, AS A RESULT OF UNAUTHORIZED WORK PRIOR TO RECEIPT OF PERMIT.

6. TREES SHOWN ON THIS PLAN ARE FOR GRAPHIC REPRESENTATION ONLY. TREE SPACING IS BASED ON DESIGN REQUIREMENTS AND THE TREES SHOWN ON THESE PLANS ATTEMPT TO ACCOMPLISH THAT SPACING WHILE MAINTAINING FIELD OF VISION BACKS FROM UTILITIES. IN THE EVENT OF A CONFLICT, AFFECTED PLANT MATERIAL SHALL BE FIELD ADJUSTED WITH THE APPROVAL OF THE LANDSCAPE ARCHITECT TO AVOID CONFLICTS WITH THE EXISTING AND PROPOSED UTILITIES, LIGHT POLES, DRAINAGE STRUCTURES OR LINES, LAKE MAINTENANCE EASEMENTS OR OTHER AFFECTED SITE FEATURES.

7. ANY PLANTING WITHIN THE SIGHT TRIANGLES SHALL PROVIDE UNOBSTRUCTED VIEWS AT A LEVEL BETWEEN 30" AND 8' ABOVE THE PAVEMENT.

8. ALL UTILITY BOXES/ STRUCTURES TO BE SCREENED ON 3 SIDES W/ APPROVED PLANTING MATERIAL.

9. IRRIGATION IS REQUIRED PROVIDING 100% COVERAGE WITH A MAXIMUM OF 50% OVERLAP, AN AUTOMATIC RAIN SENSOR MUST BE INCLUDED.

10. ALL PLANT MATERIAL TO BE INSTALLED SHALL CONFORM TO FLORIDA POWER AND LIGHTS' (FPL'S) RIGHT TREE RIGHT PLACE GUIDELINES.

11. IN CASE OF DISCREPANCIES PLANS TAKE PRECEDENCE OVER PLANT LIST.

12. LANDSCAPE CONTRACTOR RESPONSIBLE FOR VERIFICATION OF ALL QUANTITIES PRIOR TO BIDDING.

13. REMOVAL OF EXISTING VEGETATION IS RESPONSIBILITY OF LANDSCAPE CONTRACTOR.

14. RELOCATION OF EXISTING VEGETATION IS RESPONSIBILITY OF LANDSCAPE CONTRACTOR. REFER TO SPECIFICATIONS FOR RELOCATION INSTRUCTIONS.

15. ALL PLANT MATERIAL SHALL BE INSTALLED BY 11:00 AM AT TIME OF INSTALLATION UNLESS OTHERWISE NOTED.

16. NO LANDSCAPING SHALL BE PLANTED IN A MANNER THAT WOULD ADVERSELY AFFECT UTILITY EASEMENTS. LANDSCAPING SHALL BE IN COMPLIANCE WITH CHAPTER 154 OF THE CITY OF PORT ST. LUCIE CODE OF ORDINANCES, PLUSLSD TECHNICAL SPECIFICATIONS AND POLICIES.

17. ALL LANDSCAPING WITHIN CITY UTILITY EASEMENTS SHALL COMPLY WITH PLUSLSD TECHNICAL SPECIFICATIONS, POLICIES, AND CODES.

18. ALL LANDSCAPING SHALL MEET THE LATEST PLUSLSD LANDSCAPE POLICY AND SHALL NOT BE PLACED IN A MANNER THAT WOULD CREATE CONFLICTS WITH THE INTENDED OPERATION AND MAINTENANCE OF ANY EXISTING UTILITY.

19. TREES SHALL NOT BE PLANTED WITHIN TEN (10) FEET OF ANY PLUSLSD UNDERGROUND INFRASTRUCTURE.

20. NO LANDSCAPING OTHER THAN SOSS GRASSES SHALL BE LOCATED WITHIN 5' OF A PLUSLSD APPURTENANCE SUCH AS A WATER METER ASSEMBLY, BACKFLOW DEVICE, FIRE HYDRANT OR SEWER CLEANOUT, ETC.

