



SKETCH OF EASEMENT TO  
BE VACATED



C/L ABRAHAM AVENUE  
60' WIDE PUBLIC R/W

(N89°58'11"W) (117.80)

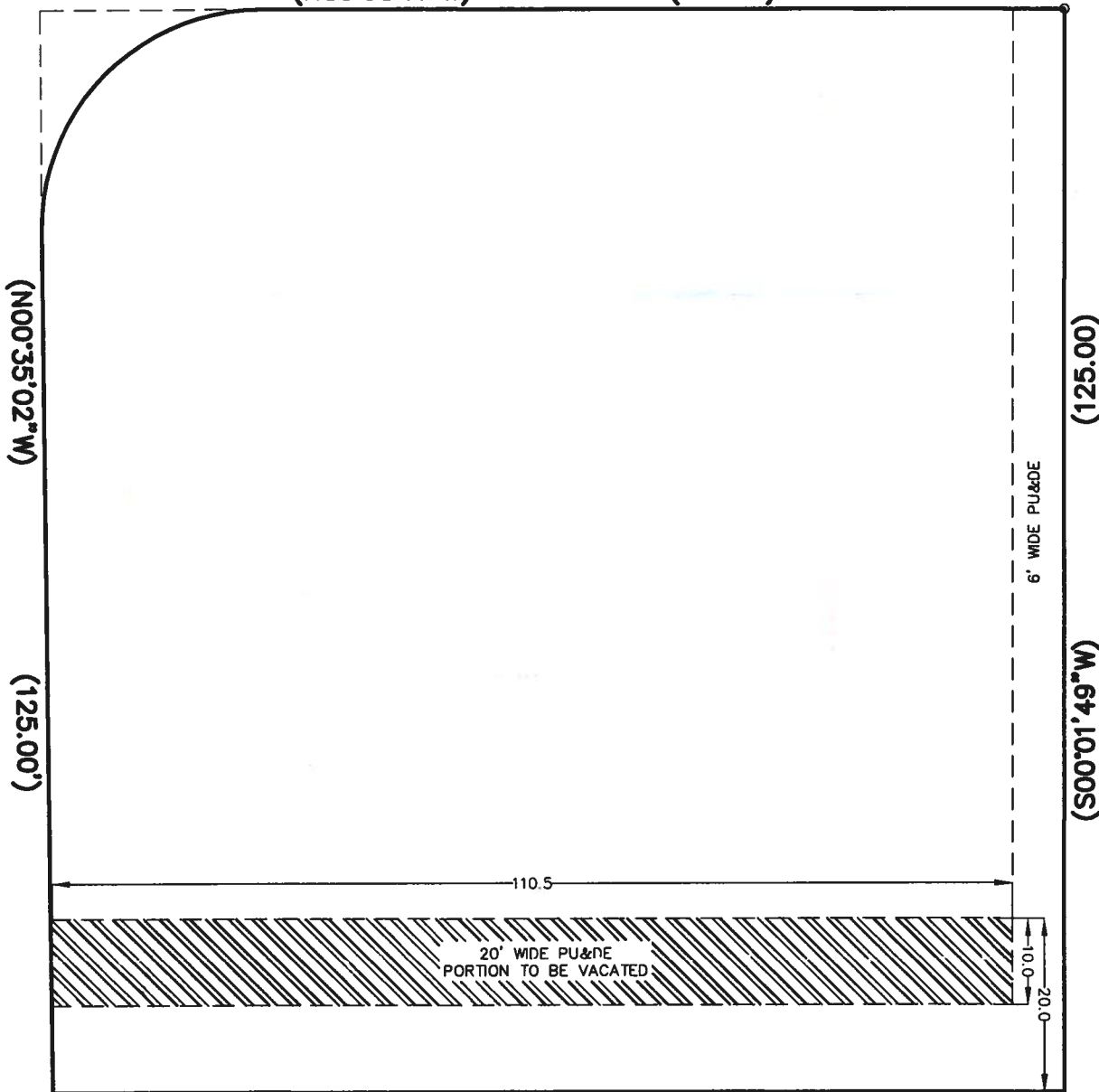

C/L YACOLT DRIVE  
60' WIDE PUBLIC R/W

(125.00)

(500°01'49"W)

(S89°58'11"E) (116.46)

65' DRAINAGE R/W

DESCRIPTION

BEING THE NORTH 10.0' OF THE SOUTH 20 FEET, OF THE WEST 110.5 FEET OF LOT 1, BLOCK 2282, PORT ST. LUCIE SECTION THIRTY THREE, ACCORDING TO THE PLAT THEREOF, RECORDED IN PLAT BOOK 15, PAGES 1,1A THROUGH 1V, INCLUSIVE, OF THE PUBLIC RECORDS OF ST. LUCIE COUNTY, FLORIDA.

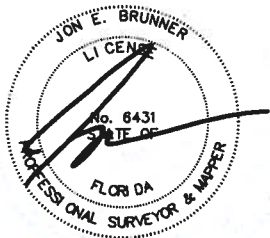

JON E. BRUNNER, FLORIDA PSM 6431  
STATE OF FLORIDA

DATE: 8/19/21	SECTION: 31	PAGE:	<b>BRUNNER-HAGEN, INC.</b> ENGINEERS AND LAND SURVEYORS 801 CAROLIN STREET, MELBOURNE, FL., 32901 PH (321) 728-1961 info@brunner-hagen.com
PROJECT: 705-20	TOWNSHIP: 37 S.	REVISION:	
SCALE: 1"=20'	RANGE: 40 E.	REVISION:	

EXHIBIT "A"

**EXHIBIT "A"**

**DESCRIPTION**

**BEING THE NORTH 10.0' OF THE SOUTH 20 FEET, OF THE WEST 110.5 FEET OF LOT 1, BLOCK 2282, PORT ST. LUCIE SECTION THIRTY THREE, ACCORDING TO THE PLAT THEREOF, RECORDED IN PLAT BOOK 15, PAGES 1,1A THROUGH 1V, INCLUSIVE, OF THE PUBLIC RECORDS OF ST. LUCIE COUNTY, FLORIDA.**

A handwritten signature in black ink, consisting of a large, stylized initial 'R' followed by a long horizontal line extending to the right.