

Sheet Index

- LA-1.....Landscape Plan
- LA-2.....Overall Plant Schedule
- LA-3.....Phases Plant Schedules
- LA-4.....Landscape Details
- LA-5.....Landscape Specifications

Key / Location:

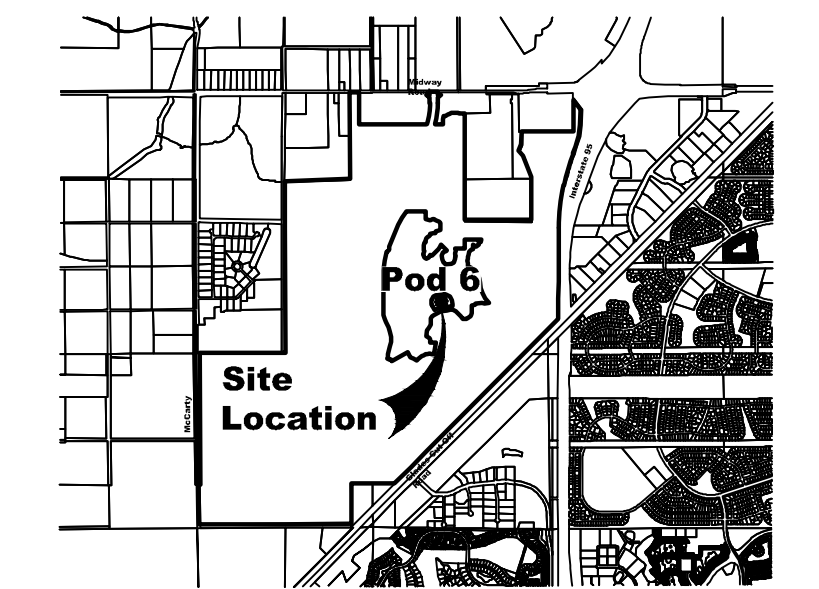

N.T.S.

Project Team:

- Client & Property Owner:** K. Hovanian  
 Southeast Florida Division, LLC  
 3601 Quantum Blvd.  
 Boynton Beach, Florida 33426
- Land Planner / Landscape Architect:** Lucido & Associates  
 701 East Ocean Boulevard  
 Stuart, Florida 34994
- Engineer:** Kimley Horn And Associates  
 445 24th Street, Suite 200  
 Vero Beach, FL 32960  
 772-794-4067
- Surveyor:** Kimley Horn And Associates  
 445 24th Street, Suite 200  
 Vero Beach, FL 32960  
 772-794-4067

**Wylder**

**POD 6**

**Amenity Landscape Plan**

Port St Lucie, Florida

P23-121  
 PSLUSD No. 11-642-09B

Date	By	Description
07.19.23	SAW	Initial Submittal
08.24.23	SAW	Re-Submittal
11.01.23	SAW	Re-Submittal
11.16.23	SJS	Re-Submittal

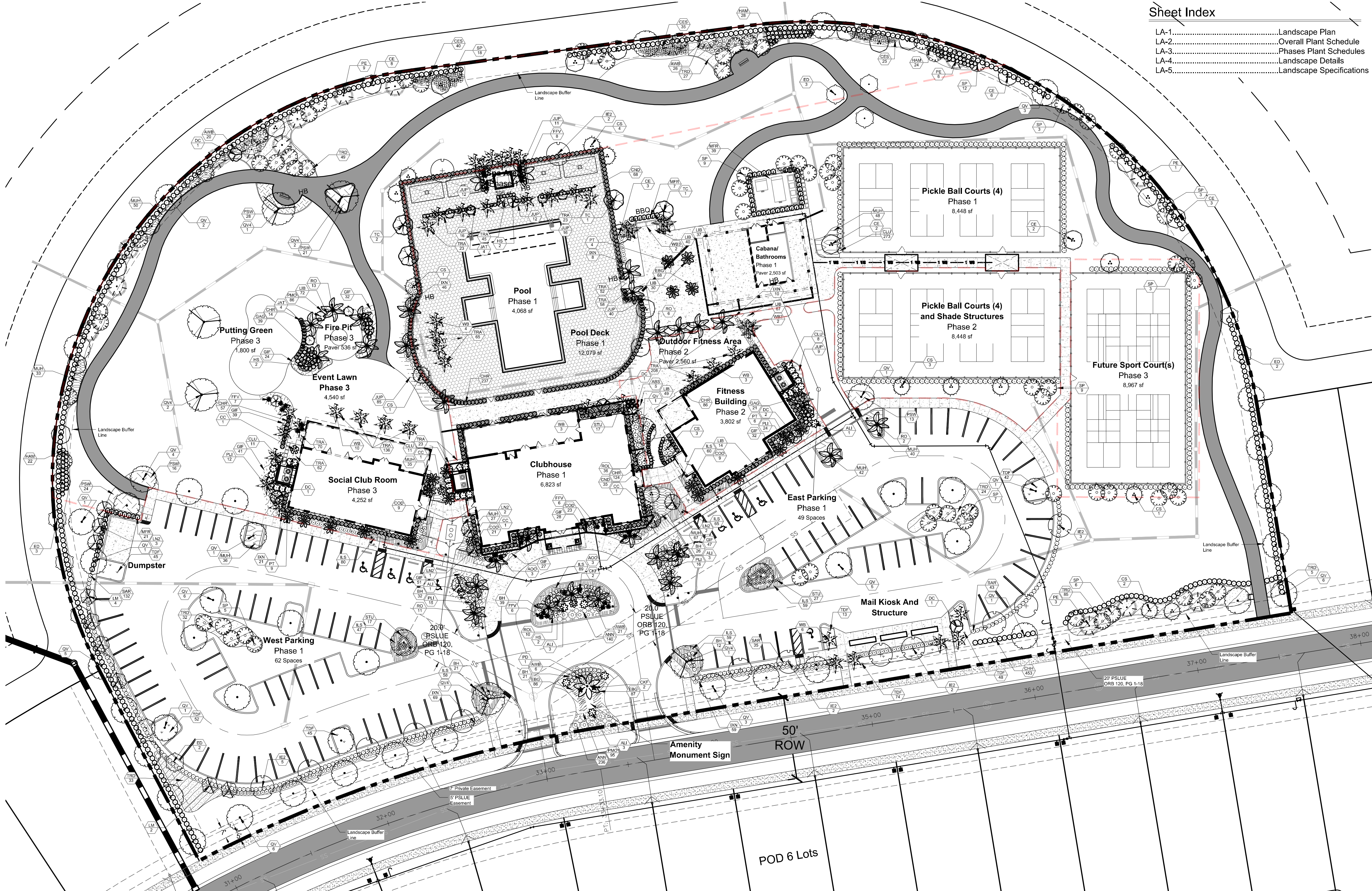

Landscape Calculations

Amenity - Parking (Vehicular Use Area):

**Perimeter Trees: (VUA)**  
 One (1) Canopy Tree per 30 If Perimeter (522/ 30 = 17 Trees)  
**Total Perimeter Trees Required = 17 Canopy Trees**  
**Trees Provided = 20**  
 20 Canopy Trees

**Perimeter Shrubs:**  
 One (1) Shrub per 2 If Perimeter (522/ 2 = 261 Shrubs)  
**Total Perimeter Shrubs Required = 261**  
**Shrubs Provided = 264 Shrubs**

**Terminal Island Trees:**  
 One (1) Canopy Tree per End of Terminal Island  
**Total Terminal Island Trees Required = 26**  
**Trees Provided = 24 Canopy Trees**  
 6 Palms (@ 3/2 = 2 tree credit)

Amenity - Perimeter Landscaping:

**Perimeter Trees:**  
 One (1) Canopy Tree per 30 If Perimeter (1,954/ 30 = 65 Trees)  
**Total Perimeter Trees Required = x Canopy Trees**  
**Trees Provided = 79**  
 68 Canopy Trees  
 11 Palm Trees (@ 34/3=11 tree credits)

**Perimeter Shrubs:**  
 One (1) Shrub per 2 If Perimeter (1,954 / 2 = 977 Shrubs)

**Total Perimeter Shrubs Required = 977**  
**Shrubs Provided = 1,011 Shrubs**

Amenity - Building Foundation:

**Foundation Trees:**  
 One (1) Canopy Tree or Palm Tree per 30 If Perimeter (698 / 30 = 23 Trees)  
**Total Foundation Trees Required = 23 Trees**  
**Trees Provided = 25**  
 12 Canopy Trees (4 Royal Palm)  
 13 Palm Trees (@27/2=13 tree credits)

**Foundation Shrubs:**  
 One (1) Shrub per 2 If Perimeter (698 / 2 = 349 Shrubs)  
**Total Foundation Shrubs Required = 349**  
**Shrubs Provided = 430 Shrubs**

General Landscape Notes

- At least 50% of all required trees shall be of a native species.
- All plant material to be Florida No. 1 or better.
- All landscape & sod areas to be irrigated by an automated system that provides 100% coverage with 100% overlap with a minimum d.u. of .70.
- All landscaping at intersection and corners complies with Section 158.204 of the Port St Lucie Code of Ordinances to provide a clear sight zone between 2' - 6' above the final road crown elevation. All hedges and shrubs with in the 25' sight triangle will be maintained at a height no higher than 2' above the crown elevation of the road. In addition, the foliage line any tree within the 25' sight triangle will maintained at a height of no less than 6' above the road crown.

PSLUSD Notes for Landscape Plan

- All new landscaping within utility easements and within ten (10) feet of underground utility infrastructure shall comply with PSLUSD technical specifications, policies, and codes.
- No landscaping other than sod grasses may be planted within a 5' radius maintenance area of any utility appurtenances such as water meters, backflow devices, fire hydrants, sanitary sewer cleanouts, and manholes, air release valves, etc.
- Trees shall not be planted within ten (10) feet of any underground infrastructure.
- No landscaping shall be planted in such a manner as to adversely affect utility easements. Landscaping shall be in compliance with chapter 154 of the City of Port St Lucie Code of Ordinances, PSLUSD technical specifications and policies.
- All landscaping shall meet the latest PSLUSD landscape policy and shall not be placed in a manner that would create conflicts with the intended operation and maintenance of any existing utility.

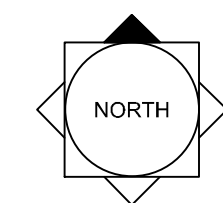

SCALE: 1" = 30'  
 0 15' 30' 60'



REG. # 1018  
 Thomas P. Lucido

Designer: SJS  
 Manager: SG  
 Project Number: 22-471  
 Municipal Number: P23-121  
 Computer File: 22-471 - POD 6 - Amenity Landscape Plan - Revised Pool & Spa

**LA 1**

Key / Location:

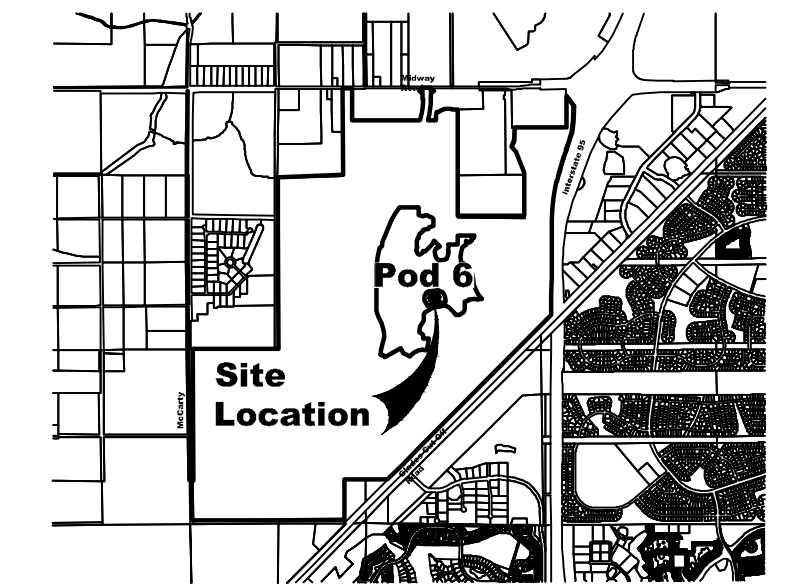

N.T.S.

Project Team:

**Client & Property Owner:** K. Hovanian  
 Southeast Florida Division, LLC  
 3601 Quantum Blvd.  
 Boynton Beach, Florida 33426

**Land Planner / Landscape Architect:** Lucido & Associates  
 701 East Ocean Boulevard  
 Stuart, Florida 34994

**Engineer:** Kimley Horn And Associates  
 445 24th Street, Suite 200  
 Vero Beach, FL 32960  
 772-794-4067

**Surveyor:** Kimley Horn And Associates  
 445 24th Street, Suite 200  
 Vero Beach, FL 32960  
 772-794-4067

**PLANT SCHEDULE AMENITY**

TREES	QTY	BOTANICAL NAME	COMMON NAME	CONTAINER	HEIGHT	WIDTH	NOTES	NATIVE	CALIPER
CE	24	Conocarpus erectus	Buttonwood	100G	12' HT	5' W	STD, F	Native	2.5" CAL
CS	15	Conocarpus erectus f. sericeus	Silver Buttonwood	100G	12' HT	5' SPR	STD, F, SP	Native	2.5" CAL
ED	10	Elaeocarpus decipiens	Japanese Blueberry Tree	100G	12' HT	4' SPR	F, SP	Non-native	2.5" CAL
HS	7	Hibiscus rosa-sinensis	Hibiscus	25G		6' HT x 3' SPD	3' CT, F, SP	Non-native	
IE2	14	Ilex x attenuata 'Eagleston'	Eagleston Holly	100G	14' HT	5' SPR	F, SP	Native	3"
LM	6	Lagerstroemia indica 'Muskogee'	Muskogee Crape Myrtle	FG	14' HT	7' W			
LN2	8	Lagerstroemia indica 'Natchez'	Natchez Crape Myrtle	FG	12' HT	6' SPR	ML, SP	Non-native	
PD	5	Phoenix dactylifera 'Medjool'	Medjool Date Palm	FG	16' CT		FH, SP, Straight, Classic Cut	Non-native	
PE	19	Pinus elliotti	Slash Pine	FG	12' HT	6' W			3" Cal
PT	19	Ptychosperma elegans	Alexander Palm	CG	8' CT				
QV	50	Quercus virginiana	Southern Live Oak	65G	14' HT	7' SPR	F, SP	Native	3" Cal
QV4	6	Quercus virginiana	Southern Live Oak	FG	16'-18' OA	8' SPR	SP, HO	Native	5" Cal
RO	30	Roystonea regia	Florida/Cuban Royal Palm	FG	12' GW		F, SP, No Scars	Native	
SP	75	Sabal palmetto	Sabal Palm	FG	10'-18' CT		HVY CAL, SP	Native	
DC	6	Senna polyphylla	Desert Cassia	45G	8' HT	4' SPR	F, SP	Native	
TC	4	Tabebuia caraiba	Yellow Tabebuia	45G	14' HT	7' W	F, SP	Non-native	3"
WB	36	Wodyetia bifurcata	Foxtail Palm	FG	16' - 18' HT. 6' GW		Full Head, Str, Specimen	Non-native	
WB3	4	Wodyetia bifurcata	Triple Foxtail Palm	FG	18' CT		Triple, Full Heads, SP		
SHRUBS	QTY	BOTANICAL NAME	COMMON NAME	CONTAINER	HEIGHT	WIDTH	NOTES	NATIVE	
AWB	73	Acalypha wilkesiana 'Louisiana Red'	Red Copperleaf	3G	24" HT	24"W	FTB, SP	Non-native	
ALI	11	Alcantarea imperialis	Imperial Bromeliad	7G	30" OA		SP	Non-native	
AOO	6	Alcantarea odorata	Giant Silver Bromeliad	7G	30" OA		SP	Non-native	
ABS	5	Androlepis skinneri	Big Red Bromeliad	7G	30" OA		SP	Non-native	
BH	162	Bougainvillea x 'Helen Johnson'	Helen Johnson Compact Bougainvillea	3G	18" OA	18"W	F		
CC	4	Chamaedorea cataractarum	Cat Palm	15G	5' OA		F	Non-native	
CHH	449	Chrysobalanus icaco 'Horizontalis'	Horizontal Coco Plum	3G	2' HT	2' W	F	Native	
CHR	518	Chrysobalanus icaco 'Red Tip'	Red Tip Cocoplum	3G	24" HT	18"W	FTB	Native	
CLU	303	Clusia guttifera	Small-Leaf Clusia	7G	3' HT	2' W	FTB		
CND	103	Clusia rosea 'Nana'	Dwarf Pitch Apple	3G	12" HT	12" W	F		
COD	62	Codiaeum variegatum 'Mammy'	Mammy Croton	3G	24" HT	18"W	FTB, SP	Non-native	
CES	100	Conocarpus erectus 'Sericeus'	Silver Buttonwood	3G	24" HT	24"W	F	Native	
CKF	7	Cordyline fruticosa 'Kiwi'	Kiwi Ti Plant	3G	24" OA		F		
FFV	33	Furcraea foetida 'Variegata'	Variegated False Agave	15G	30" OA		F		
GAG	60	Galphimia glauca	Thryalis	3G	24" HT	18"W	F	Non-native	
HAM	74	Hamelia patens 'Compacta'	Dwarf Firebush	3G	36" HT	30"W	FTB	Non-native	
IXN	213	Ixora coccinea 'Nora Grant'	Red Ixora	3G	24" OA		FTB	Non-native	
JAT	8	Jatropha integerrima	Jatropha	15G	4' HT	3' W	STD, SP	Non-native	
MFR	67	Myrcianthes fragrans	Simpson's Stopper	7G	4' HT	3' W	FTB, SP	Native	
NCR	11	Neoregelia cruenta rubra	Red Cruenta Bromeliad	2G	12" OA		F		
NBB	9	Neoregelia x 'Bossa Nova'	Bossa Nova Bromeliad	2G	12" OA		F		
PLI	67	Plumbago auriculata 'Imperial Blue'	Plumbago	3G	24" HT	24"W	F, SP	Non-native	
ROL	46	Rondeletia leucophylla	Panama Rose 'Pink'	3G	24" HT	24"W	FTB, SP	Non-native	
SAR	210	Schefflera arboricola	Green Schefflera	3G	24" HT	24"W	F	Non-native	
STU	61	Stachytarpheta jamaicensis	Blue Porterweed	3G	24" HT	18"W	F	Native	
GRASSES	QTY	BOTANICAL NAME	COMMON NAME	CONTAINER	HEIGHT	WIDTH	NOTES	NATIVE	
MUH	462	Muhlenbergia capillaris	Pink Muhly	3G	18" OA		F		24" o.c.
PSW	98	Pennisetum setaceum 'White'	White Fountain Grass	3G	24" OA		F	Non-native	36" o.c.
TRD	255	Tripsacum dactyloides	Fakahatchee Grass	3G	24" OA		Full	Native	48" o.c.
TDF	319	Tripsacum dactyloides nana	Dwarf Fakahatchee Grass	3G	18" OA				24" o.c.
GROUND COVERS	QTY	BOTANICAL NAME	COMMON NAME	CONTAINER	HEIGHT	WIDTH	NOTES	NATIVE	
ANN	376	Annuals sp	Seasonal Annuals	1G	12" OA		Full		12" o.c.
EBG	241	Evolvulus glomeratus 'Blue Daze'	Brazilian Dwarf Morning Glory	3G	8"-10" OA		F		12" o.c.
GIF	321	Ficus microcarpa 'Green Island'	Green Island Ficus	3G	12" HT	12" W	Full		24" o.c.
ILS	658	Ilex vomitoria 'Stokes Dwarf'	Dwarf Yaupon	3G	12" HT	12" W	Full	Native	18" o.c.
JUP	199	Juniperus chinensis 'Parsonii'	Parsoni Juniper	3G	10" HT	15" SPR	Full	Non-native	24" o.c.
LIB	329	Liriope muscari 'Big Blue'	Big Blue Lilyturf	3G	12" OA				18" o.c.
PMO	181	Podocarpus macrophyllus 'Dwarf Pringles'	Dwarf Podocarpus	3G	12" HT	12" W	FTB	Non-native	18" o.c.
TRA	820	Trachelospermum asiaticum	Asiatic Jasmine	FLAT	4"-6" ht x 6"-8" sprd			Native	12" o.c.

**Wylder**

**POD 6**

**Amenity Overall Plant Schedule**

Port St Lucie, Florida

P23-121  
 PSLUSD No. 11-642-09B

Date	By	Description
07.19.23	SAW	Initial Submittal
08.24.23	SAW	Re-Submittal
11.01.23	SAW	Re-Submittal
11.16.23	SJS	Re-Submittal

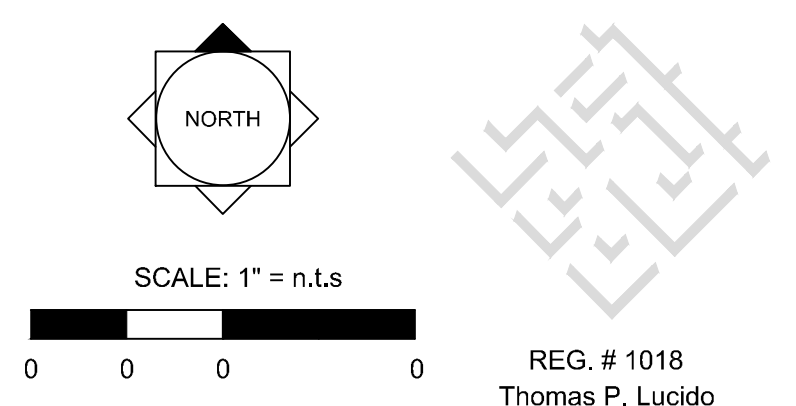

Designer: SJS  
 Manager: SG  
 Project Number: 22-471  
 Municipal Number: P23-121  
 Computer File: 22-471 - POD 6 - Amenity Landscape Plan - Revised Pool & Spa.

**LA 2**



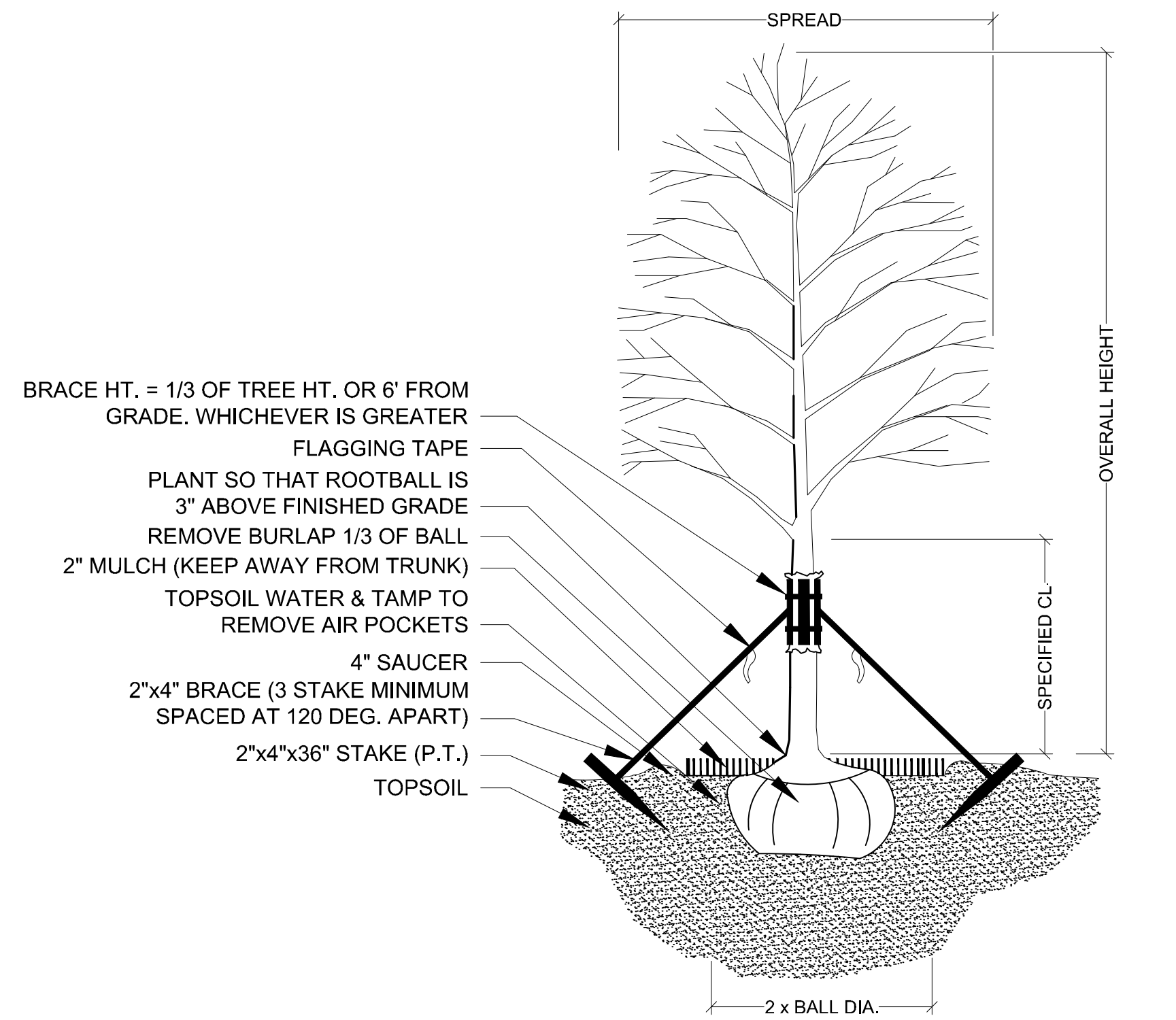

**TREE PLANTING & STAKING**  
NOT TO SCALE

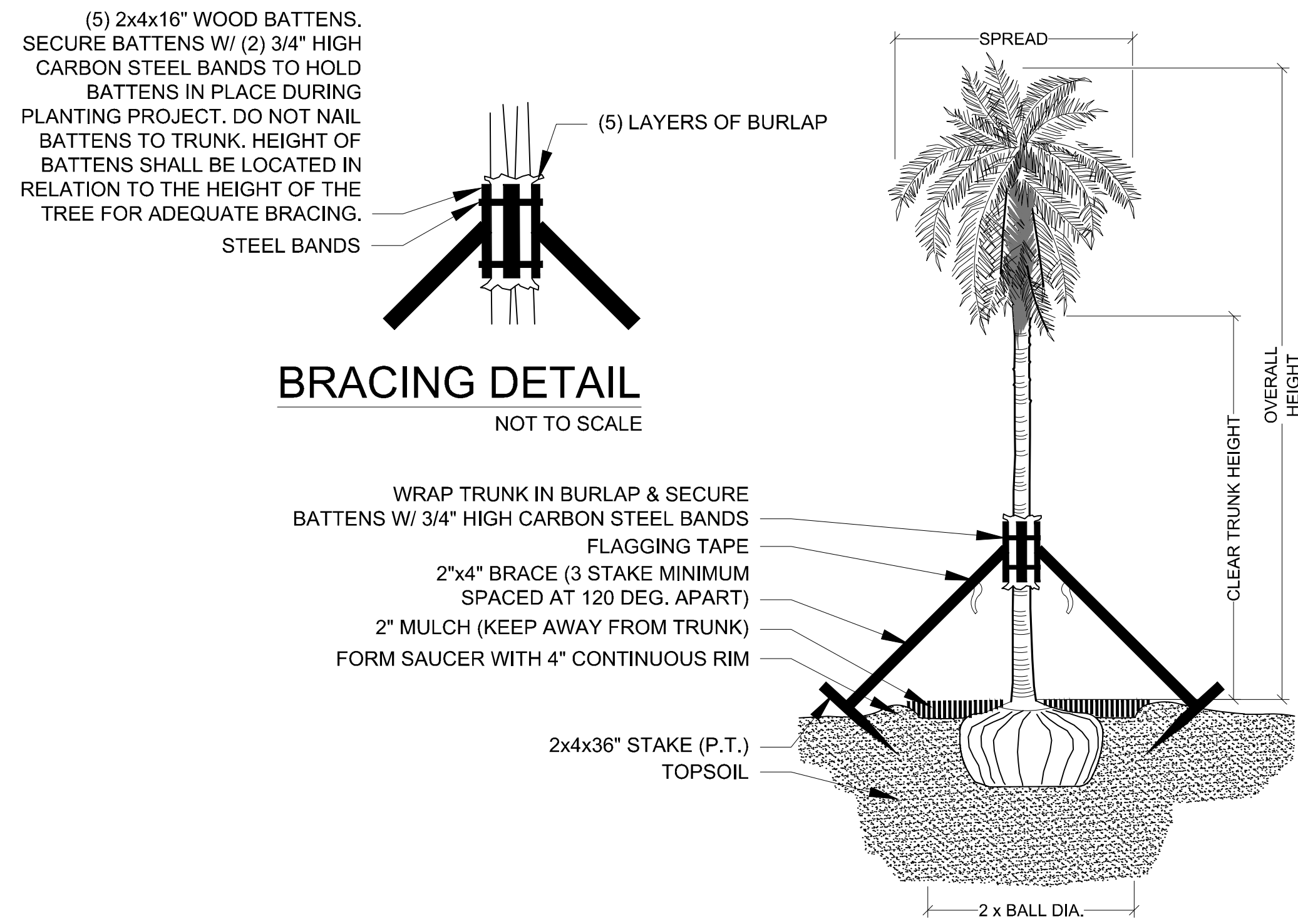

**PALM PLANTING - ANGLE STAKE**  
NOT TO SCALE

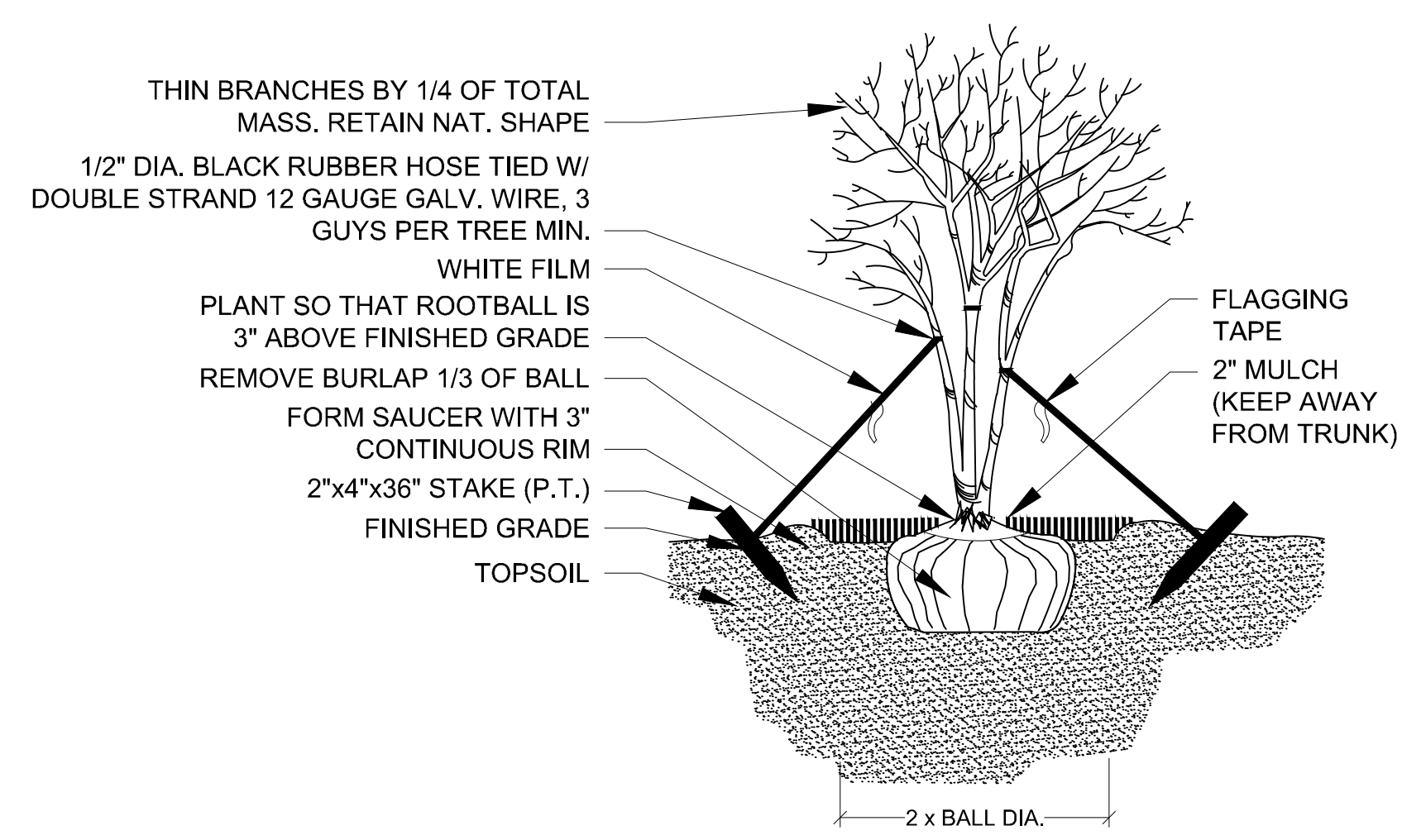

**MULTI-TRUNK PLANTING & GUYING**  
NOT TO SCALE

**Key / Location:**

N.T.S.

**Project Team:**

**Client & Property Owner:** K. Hovanian  
 Southeast Florida Division, LLC  
 3601 Quantum Blvd.  
 Boynton Beach, Florida 33426

**Land Planner / Landscape Architect:** Lucido & Associates  
 701 East Ocean Boulevard  
 Stuart, Florida 34994

**Engineer:** Kimley Horn And Associates  
 445 24th Street, Suite 200  
 Vero Beach, FL 32960  
 772-794-4067

**Surveyor:** Kimley Horn And Associates  
 445 24th Street, Suite 200  
 Vero Beach, FL 32960  
 772-794-4067

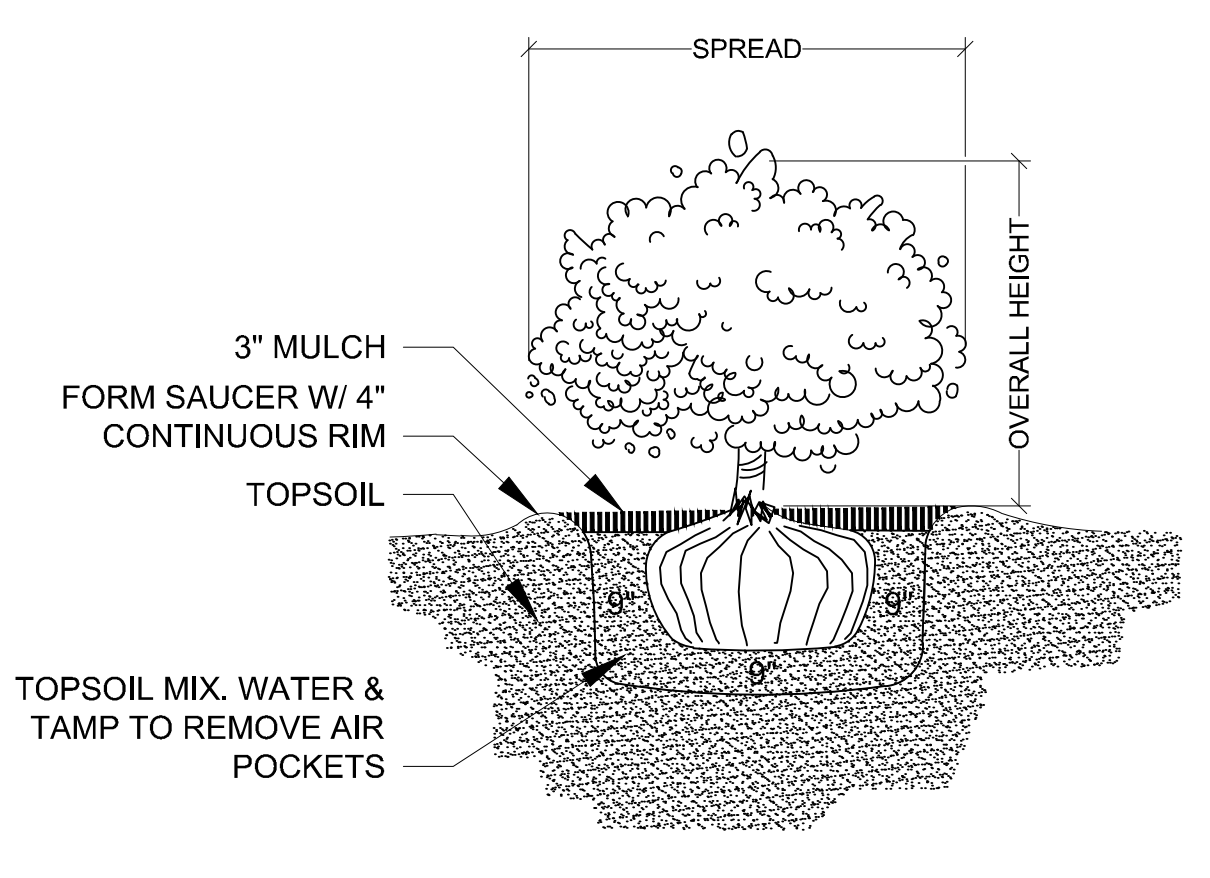

**SHRUB PLANTING**  
NOT TO SCALE

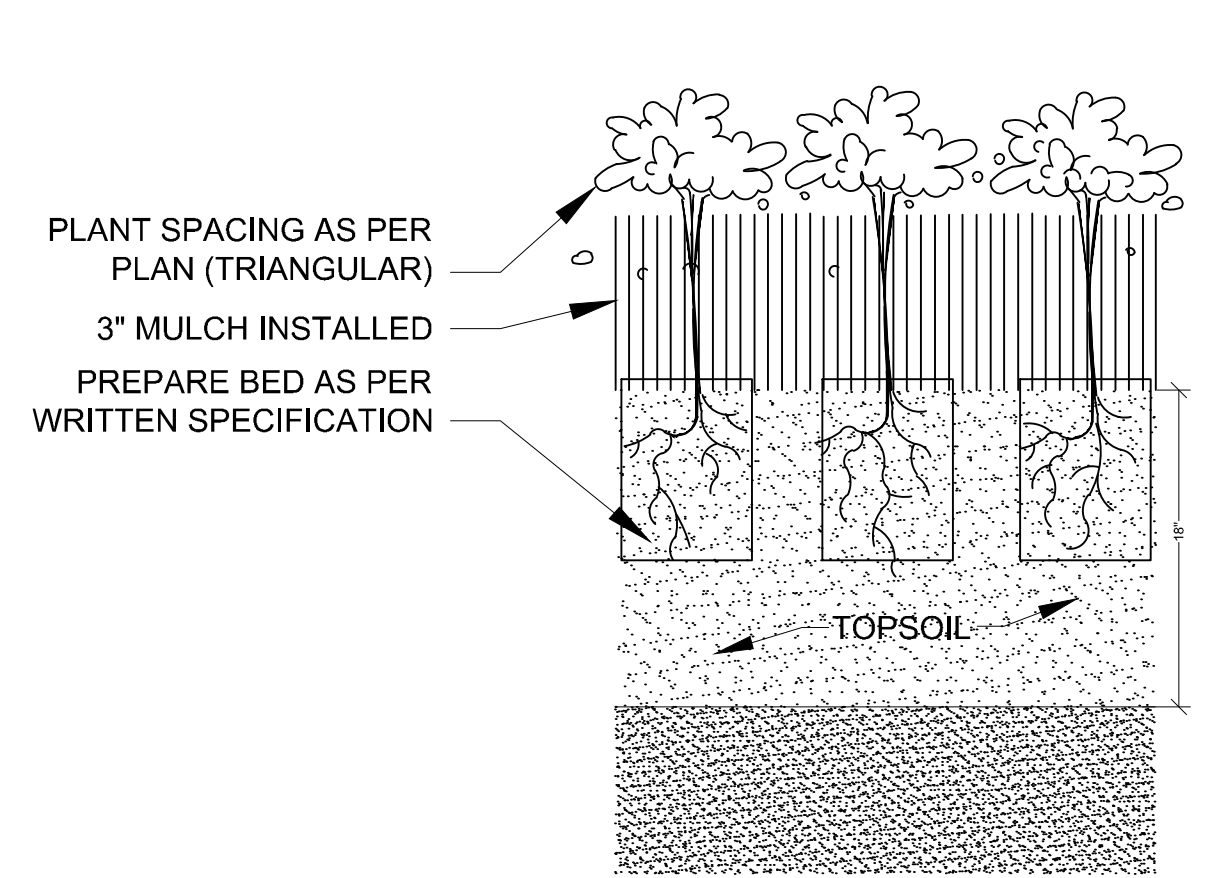

**GROUNDCOVER PLANTING DETAIL**  
NOT TO SCALE

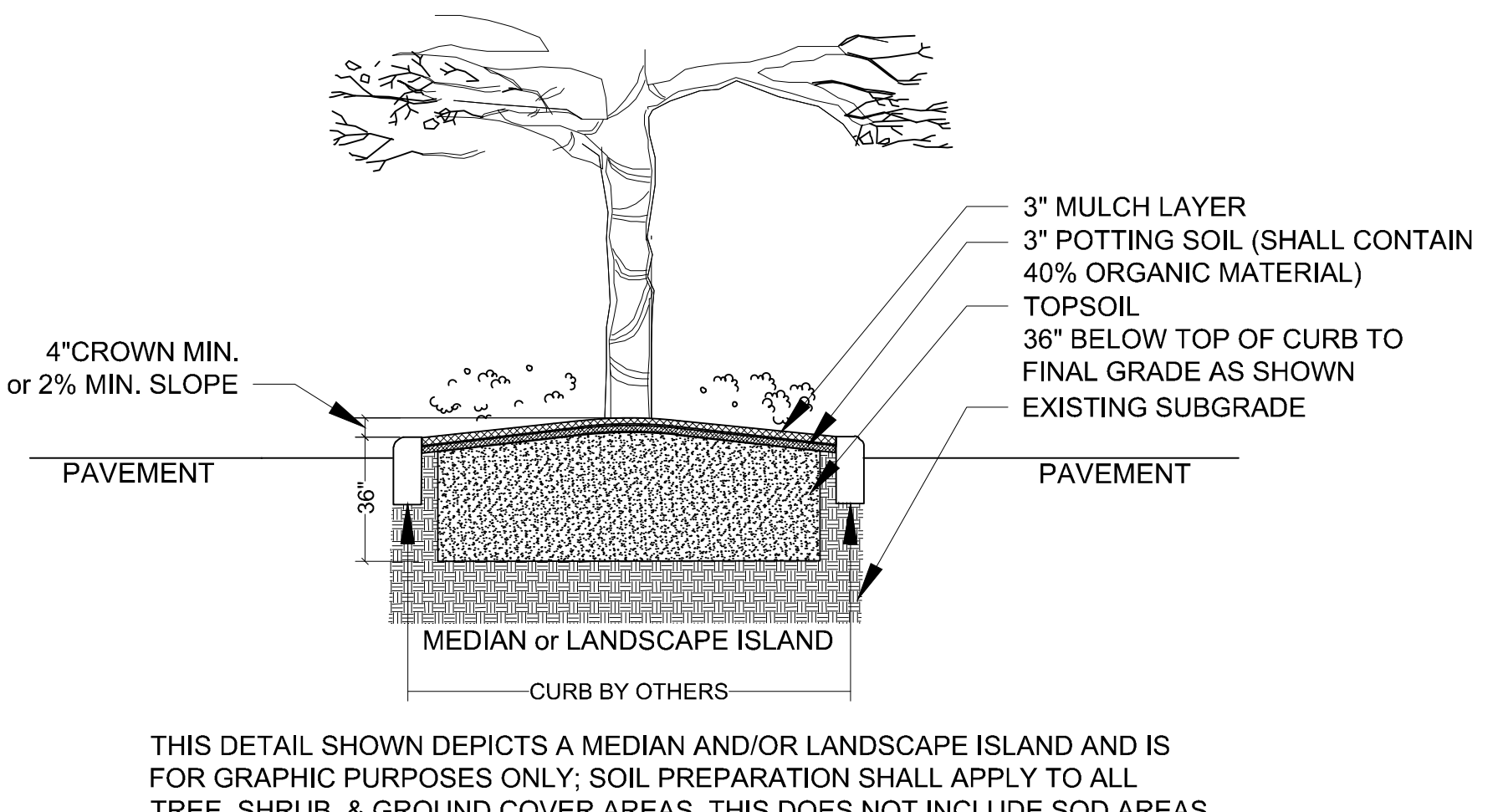

**LANDSCAPE AREA PREPARATION DETAIL**  
NOT TO SCALE

THIS DETAIL SHOWN DEPICTS A MEDIAN AND/OR LANDSCAPE ISLAND AND IS FOR GRAPHIC PURPOSES ONLY; SOIL PREPARATION SHALL APPLY TO ALL TREE, SHRUB, & GROUND COVER AREAS. THIS DOES NOT INCLUDE SOD AREAS

- \* TOPSOIL SHALL BE NATURAL, FRIABLE, FINE LOAMY SOIL POSSESSING CHARACTERISTICS OF REPRESENTATIVE TOPSOIL IN THE VICINITY OF THE PROJECT SITE THAT PRODUCES HEAVY GROWTH.
- \* TOPSOIL SHALL HAVE A PH RANGE OF 5.5-7.4, FREE FROM SUBSOIL, WEEDS, LITTER, SODS, CLAY, STONES, STUMPS, ROOTS, TRASH, HERBICIDES, TOXIC SUBSTANCES, OR ANY OTHER MATERIAL WHICH MAY BE HARMFUL TO PLANT GROWTH, OR HINDER PLANTING OPERATIONS.
- \* TOPSOIL SHALL CONTAIN A MINIMUM OF 3% ORGANIC MATERIAL.
- \* TOPSOIL MUST PERCOLATE WATER AT A RATE OF 1" PER HOUR (SEE ALSO DRAINAGE TESTING DETAIL FOR TREES)
- \* LANDSCAPE AREA SOILS SHALL BE APPROVED BY LANDSCAPE ARCHITECT/OWNER PRIOR TO PLANTING

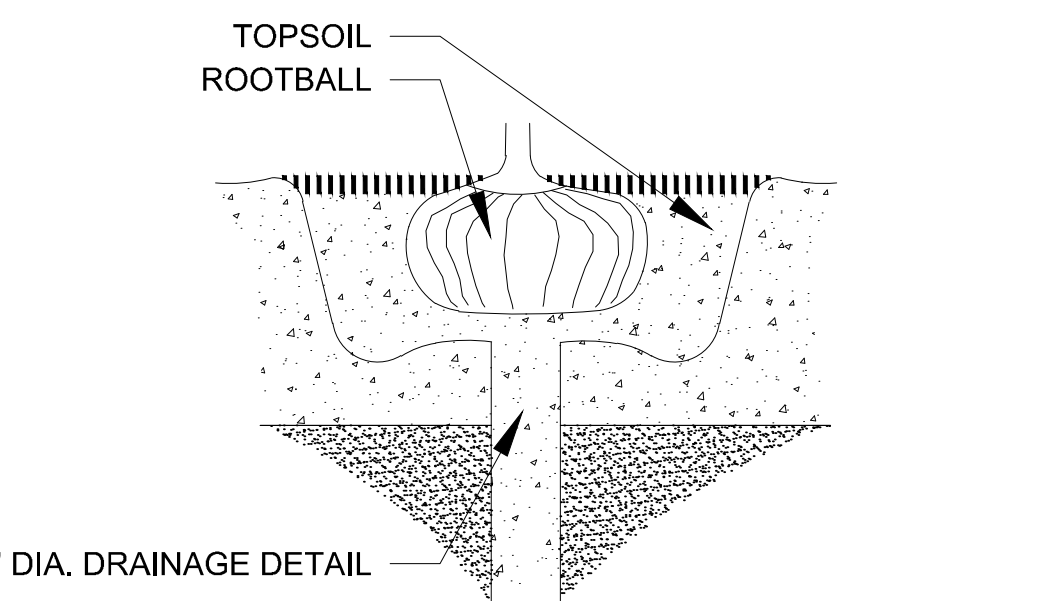

**DRAINAGE TESTING DETAIL**  
NOT TO SCALE

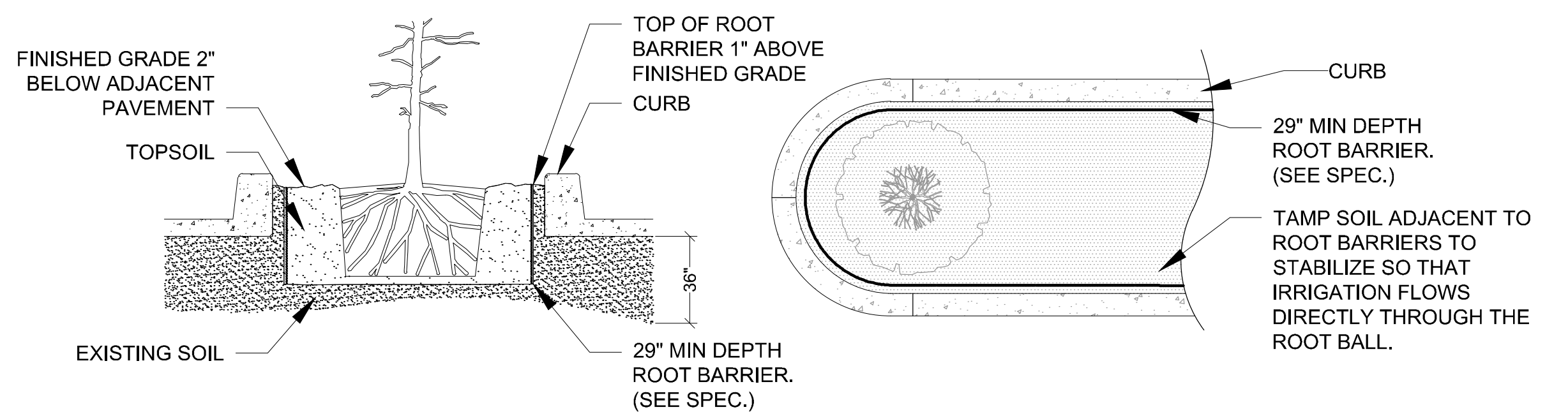

**SPECIAL APPLICATIONS ROOT BARRIER DETAIL**  
NOT TO SCALE

**NOTES:**  
 1- ROOT BARRIER SHALL BE INSTALLED WHEN ROOT BALL IS LOCATED WITHIN 8" OF PAVEMENT AND OR CURB.  
 2- ROOT BARRIER SHALL BE "BIO-BARRIER 29" DEPTH OR APPROVED EQUAL.  
 3- ROOT BARRIER SHALL BE INSTALLED PER MANUFACTURER'S SPECIFICATIONS AND RECOMMENDATIONS.

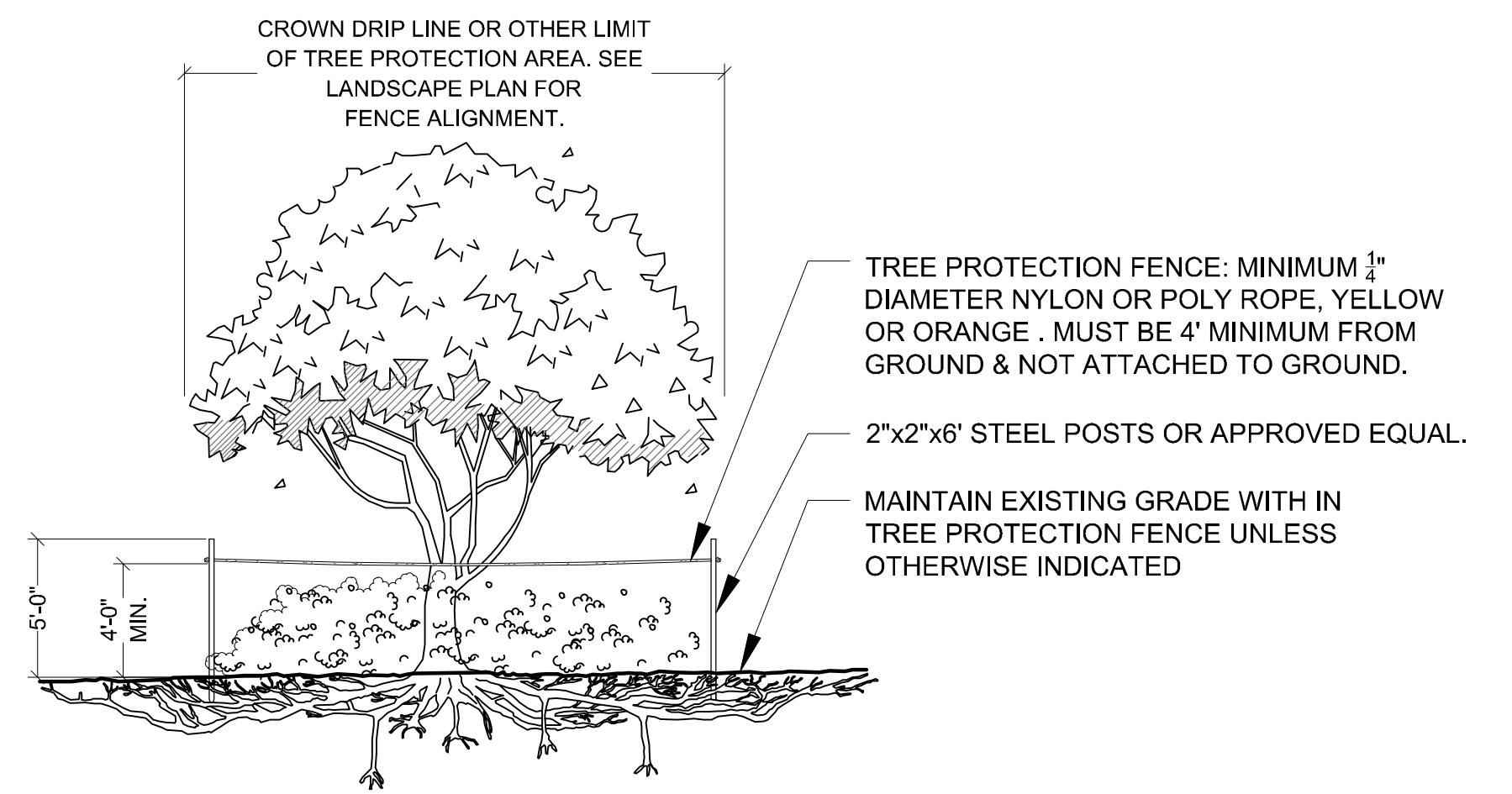

**TREE PROTECTION BARRICADE**  
NOT TO SCALE

**NOTES:**  
 1- SEE LANDSCAPE PLAN FOR FENCE ALIGNMENT.  
 2- NO PRUNING SHALL BE PERFORMED EXCEPT BY APPROVED ARBORIST.  
 4- NO EQUIPMENT SHALL OPERATE INSIDE THE PROTECTIVE FENCING INCLUDING DURING FENCE INSTALLATION AND REMOVAL.

**DRAINAGE TESTING/DRAINAGE CHANNEL REQUIREMENTS.**

PRIOR TO PLANTING, ALL PLANTING PITS SELECTED FOR TESTING SHALL BE TESTED IN THE FOLLOWING MANNER.

- DIG EACH PLANTING PIT TO THE MINIMUM SPECIFIED SIZE.
- FILL PLANTING PIT WITH TWELVE INCHES (12") OF WATER. IF THE WATER LEVEL DROPS FOUR (4") OR MORE WITHIN FOUR (4) HOURS, THE DRAINAGE IS SUFFICIENT AND A DRAINAGE CHANNEL IS NOT REQUIRED. IF THE WATER LEVEL DROPS LESS THAN FOUR INCHES (4") WITHIN THE FOUR (4) HOUR PERIOD, A DRAINAGE CHANNEL IS REQUIRED.
- WHERE REQUIRED, THE DRAINAGE CHANNEL MUST EXTEND DOWN THROUGH THE NON POROUS SOIL AND INTO POROUS SOIL. (SEE DETAIL)
- ALL MATERIAL REMOVED FROM THE DRAINAGE CHANNEL SHALL BE DISCARDED.
- WHEN BACKFILLING PLANTING PITS WITH NATIVE TOPSOIL, CARE MUST BE TAKEN TO KEEP THE CONSISTENCY OF THE SOIL MIX THE SAME THROUGHOUT THE PLANTING PIT AND DRAINAGE CHANNEL.

**Wylder**  
**POD 6**  
**Amenity Landscape Details**  
 Port St Lucie, Florida  
 P23-121  
 PSLUSD No. 11-642-09B

Date	By	Description
07.19.23	SAW	Initial Submittal
08.24.23	SAW	Re-Submittal
11.01.23	SAW	Re-Submittal
11.16.23	SJS	Re-Submittal

NORTH

SCALE: 1" = n.t.s

REG. # 1018  
 Thomas P. Lucido

Designer SJS  
 Manager SG  
 Project Number 22-471  
 Municipal Number P23-121  
 Computer File 22-471 - POD 6 - Amenity Landscape Plan - Revised Pool & Spa.

Sheet  
**LA 4**

