

Plotted By: Barrett, Kevin. Sheet: SCLANDINGS AT TRADITION - PH 2 - Layout: L1.00 - August 15, 2021. 09:31:25pm. K:\ARB-LOEVA\147098015 - Landings at Tradition Grocery\BY OTHERS\Landings at Tradition\Grocery\CAD\PlanSheets\L1.00 - LANDSCAPE PLAN.dwg  
 This document, together with the concepts and designs presented herein, is intended only for the specific purpose and client for which it was prepared. Reuse of and improper reliance on this document without written authorization and adaptation by Kimley-Horn and Associates, Inc. shall be without liability to Kimley-Horn and Associates, Inc.

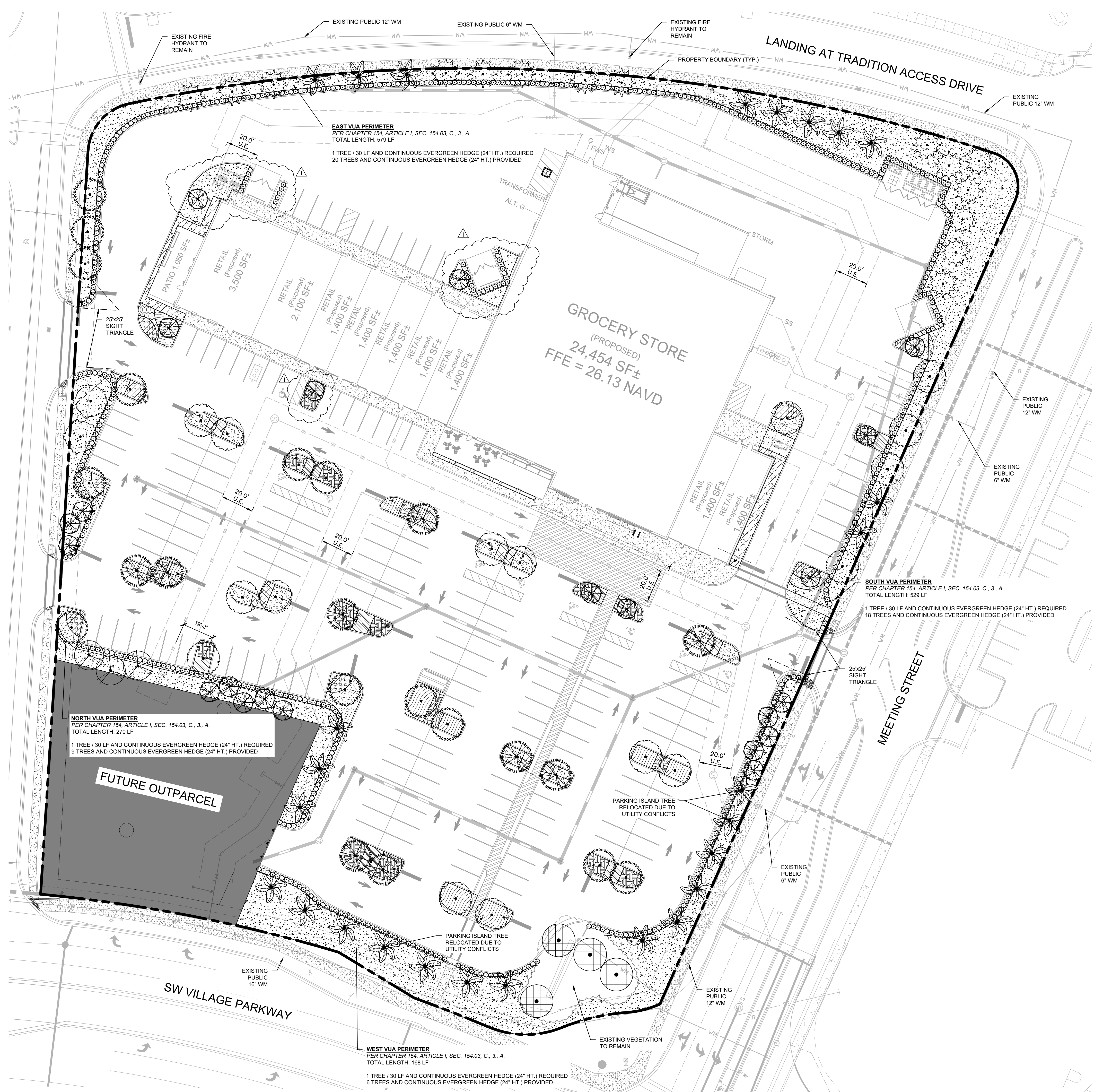

### PLANT SYMBOL KEY

TREES	CODE	BOTANICAL NAME	COMMON NAME
	CE	CONOCARPUS ERECTUS SINGLE LEADER, STRAIGHT, FL #1, FULL, NATIVE	GREEN BUTTONWOOD
	GL	BURSERA SIMARUBA SINGLE LEADER, STRAIGHT, FL #1, FULL, NATIVE	GUMBO LIMBO
	PE	PINUS ELLIOTTI SINGLE LEADER, STRAIGHT, FL #1, FULL, NATIVE	SLASH PINE
	OS	QUERCUS SHUMARDII SINGLE LEADER, STRAIGHT, FL #1, FULL, NATIVE	SHUMARD OAK
	QV	QUERCUS VIRGINIANA SINGLE LEADER, STRAIGHT, FL #1, FULL, NATIVE	SOUTHERN LIVE OAK
	UE	ULMUS PARVIFOLIA 'EMER II' TM SINGLE LEADER, STRAIGHT, FL #1, FULL, NON-NATIVE	ALLEE LACEBARK ELM
EXISTING	CODE	BOTANICAL NAME	COMMON NAME
	ST	EXISTING TREE TO REMAIN CONTRACTOR LIABLE FOR DAMAGES	
PALM TREES	CODE	BOTANICAL NAME	COMMON NAME
	RR	ROYSTONIA REGIA NATIVE	ROYAL PALM
UNDERSTORY TREES	CODE	BOTANICAL NAME	COMMON NAME
	LD	LAGERSTROEMIA INDICA 'NATCHEZ' SINGLE LEADER, STRAIGHT, FULL, FL#1, NON-NATIVE	NATCHEZ CRAPE MYRTLE
	PM	PODOCARPUS MACROPHYLLUS FULL, NON-NATIVE	YEW PINE
	VO	VIBURNUM ODORATISSIMUM FULL, NATIVE	SWEET VIBURNUM
SHRUB AREAS	CODE	BOTANICAL NAME	COMMON NAME
	BL	BUILDING FACADE LANDSCAPE SHRUB MATERIAL AREA, FULL, FL#1 PLANT MATERIAL, NATIVE	
	HC	HAMELIA PATENS 'COMPACTA' FULL, NATIVE	DWARF FIREBUSH
	ID	ILEX VOMITORIA 'SCHILLINGS DWARF' FULL, NATIVE	SCHILLINGS DWARF YAUPON HOLLY
	TF	TRIPSACUM FLORIDANUM FULL, NATIVE	FLORIDA GAMAGRASS
	ZI	ZAMIA INTEGRIFOLIA FULL, NATIVE	COONTIE
GROUND COVERS	CODE	BOTANICAL NAME	COMMON NAME
	AG	ARACHIS GLABRATA FULL, NON-NATIVE	PERENNIAL PEANUT
	BF	BULBINE FRUTESCENS FULL, NON-NATIVE	STALKED BULBINE
	EX	EVOLVULUS X 'USEV01201' TM FULL, NON-NATIVE	BLUE MY MIND DWARF MORNING GLORY
	JP	JUNIPERUS CHINENSIS 'PARSONI' FULL, NON-NATIVE	PARSONI JUNIPER
	LM	LIRIOPE MUSCARI FULL, NON-NATIVE	LILYTURF
	TM	TRACHELOSPERMUM ASIATICUM 'MINIMA' FULL, NON-NATIVE	MINIMA ASIATIC JASMINE
SOD	CODE	BOTANICAL NAME	COMMON NAME
	AB	PASPALUM NOTATUM 'ARGENTINE' ROLLED TIGHT, 100% DISEASE/WEED/INSECT/DEBRIS FREE	ARGENTINE BAHIA GRASS
MISC	QTY	BOTANICAL/COMMON NAME	
	TBD	EUCALYPTUS MULCH	

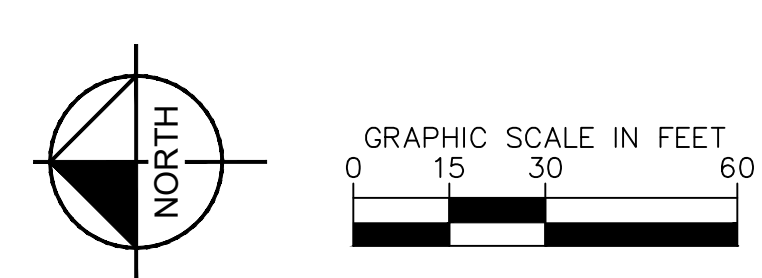

CALL 48 HOURS BEFORE YOU DIG  
 IT'S THE LAW! DIAL 811  
  
 Know what's below. Call before you dig.  
 SUNSHINE STATE ONE CALL OF FLORIDA, INC.

PSLUSD PROJECT #  
**11-342-48-06**

CITY OF PORT ST. LUCIE PROJECT #  
**P21 - 153**

SHEET NUMBER  
**L1.00**

NO.	REVISED PER CITY COMMENTS	REVISIONS	DATE	BY
1			08/18/21	KPE

© 2021 KIMLEY-HORN AND ASSOCIATES, INC.  
 116 SOUTH KENTUCKY AVENUE, LAKELAND, FL 33801  
 PHONE: 863-701-8702  
 WWW.KIMLEY-HORN.COM CA 00000696

LICENSED PROFESSIONAL	MATTHEW T. FRANKO, P.L.A. (P.L.A.)
KHA PROJECT	147098015
DATE	05/20/2021
SCALE AS SHOWN	DESIGNED BY KHA
DRAWN BY	KHA
CHECKED BY	MTF
	DATE: 8/18/2021

# LANDSCAPE PLAN

**LANDINGS AT TRADITION PH 2**  
 PREPARED FOR  
**KITE REALTY GROUP**  
 PORT ST. LUCIE, FL

Plotted By: Barrett, Kevin Sheet: LANDINGS AT TRADITION PH 2 Layout: L1.01 August 18, 2021 09:53:03pm K:\V\B-LOE\147098015 - Landings at Tradition GreentX\BY OTHERS\Landings CAD\PlanSheets\L1.01 - LANDSCAPE PLAN.dwg  
 This document, together with the concepts and designs presented herein, is intended only for the specific purpose and client for which it was prepared. Reuse of and improper reliance on this document without written authorization and adaptation by Kimley-Horn and Associates, Inc. shall be without liability to Kimley-Horn and Associates, Inc.

**PLANT SCHEDULE**

TREES	CODE	QTY	BOTANICAL NAME	COMMON NAME	METHOD	SIZE	CAL
	CE	2	CONOCARPUS ERECTUS SINGLE LEADER, STRAIGHT, FL #1, FULL, NATIVE	GREEN BUTTONWOOD	FG	3" CAL MIN	10' HT., 4' SPR.
	GL	9	BURSERA SIMARUBA SINGLE LEADER, STRAIGHT, FL #1, FULL, NATIVE	GUMBO LIMBO	FG	3" CAL MIN	10' HT., 4' SPR.
	PE	15	PINUS ELLIOTTI SINGLE LEADER, STRAIGHT, FL #1, FULL, NATIVE	SLASH PINE	FG	3" CAL MIN	10' HT., 4' SPR.
	QS	13	QUERCUS SHUMARDII SINGLE LEADER, STRAIGHT, FL #1, FULL, NATIVE	SHUMARD OAK	FG	3" CAL MIN	10' HT., 5' SPR.
	QV	16	QUERCUS VIRGINIANA SINGLE LEADER, STRAIGHT, FL #1, FULL, NATIVE	SOUTHERN LIVE OAK	FG	3" CAL MIN	10' HT., 5' SPR.
	UE	3	ULMUS PARVIFOLIA 'EMER II' TM SINGLE LEADER, STRAIGHT, FL #1, FULL, NON-NATIVE	ALLEE LACEBARK ELM	FG	3" CAL MIN	10' HT., 4' SPR.
UNDERSTORY TREES	CODE	QTY	BOTANICAL NAME	COMMON NAME	METHOD	SIZE	CAL
	LD	22	LAGERSTROEMIA INDICA 'NATCHEZ' SINGLE LEADER, STRAIGHT, FULL, FL#1, NON-NATIVE	NATCHEZ CRAPE MYRTLE	FG	2" CAL MIN	8' HT., 4' SPR.
EXISTING	CODE	QTY	BOTANICAL NAME	COMMON NAME	METHOD	SIZE	CAL
	ST	4	EXISTING TREE TO REMAIN CONTRACTOR LIABLE FOR DAMAGES	-	EXISTING	VARIES	VARIES
PALM TREES	CODE	QTY	BOTANICAL NAME	COMMON NAME	METHOD	SIZE	CAL
	RR	26	ROYSTONIA REGIA NATIVE	ROYAL PALM	FG	-	12' CT MIN
SHRUBS	CODE	QTY	BOTANICAL NAME	COMMON NAME	CONTAINER	SPACING	SIZE
	PM	79	PODOCARPUS MACROPHYLLUS FULL, NON-NATIVE	YEW PINE	7 GAL	36" OC	36" HT MIN
	VO	554	VIBURNUM ODORATISSIMUM FULL, NATIVE	SWEET VIBURNUM	7 GAL	36" OC	36" HT MIN
SHRUB AREAS	CODE	QTY	BOTANICAL NAME	COMMON NAME	CONT	SIZE	SPACING
	BL	266	BUILDING FACADE LANDSCAPE SHRUB MATERIAL AREA, FULL, FL#1 PLANT MATERIAL, NATIVE	-	3 GAL		
	HC	68	HAMELIA PATENS 'COMPACTA' FULL, NATIVE	DWARF FIREBUSH	3 GAL		
	ID	106	ILEX VOMITORIA 'SCHILLINGS DWARF' FULL, NATIVE	SCHILLINGS DWARF YAUPON HOLLY	3 GAL		
	TF	136	TRIPSACULUM FLORIDANUM FULL, NATIVE	FLORIDA GAMAGRASS	3 GAL		
	ZI	55	ZAMIA INTEGRIFOLIA FULL, NATIVE	COONTIE	3 GAL		
GROUND COVERS	CODE	QTY	BOTANICAL NAME	COMMON NAME	SIZE	SPACING	
	AG	568	ARACHIS GLABRATA FULL, NON-NATIVE	PERENNIAL PEANUT	1 GAL	10" FULL	
	BF	26	BULBINE FRUTESCENS FULL, NON-NATIVE	STALKED BULBINE	1 GAL	14" FULL	
	EX	240	EVOLVULUS X 'USEVO1201' TM FULL, NON-NATIVE	BLUE MY MIND DWARF MORNING GLORY	1 GAL	12" FULL	
	JP	39	JUNIPERUS CHINENSIS 'PARSONII' FULL, NON-NATIVE	PARSONI JUNIPER	3 GAL	20" SPRD.	
	LM	450	LIRIOPE MUSCARI FULL, NON-NATIVE	LILYTURF	1 GAL	12" FULL	
	TM	796	TRACHELOSPERMUM ASIATICUM 'MINIMA' FULL, NON-NATIVE	MINIMA ASIATIC JASMINE	1 GAL	12" SPRD MIN	
SOD	CODE	QTY	BOTANICAL NAME	COMMON NAME	SIZE	SPACING	
	AB	22,427 SF	PASPALLUM NOTATUM 'ARGENTINE' ROLLED TIGHT, 100% DISEASE/WEED/INSECT/DEBRIS FREE	ARGENTINE BAHIA GRASS	SOD	SOD	
MISC.	QTY	BOTANICAL/COMMON NAME	SPECIFICATIONS				
MULCH	TBD	EUCALYPTUS MULCH	3" DEPTH MINIMUM, SHREDDED, FREE OF WEEDS/INVASIVE PLANT MATERIAL				

LANDSCAPE CALCULATIONS		
PER CHAPTER 154, CITY OF PORT ST. LUCIE CODE OF ORDINANCES AND TRADITION REGIONAL BUSINESS PARK @ SOUTHERN GROVE MPUD		
	REQUIRED	PROVIDED
<b>VUA PERIMETER</b> CHAPTER 154, ARTICLE I, SEC. 154.03, C. 3, A. 1 TREE / 30 LF CONTINUOUS EVERGREEN HEDGE (24" HT.)	NORTH - 270 LF 270 / 30 = 9 TREES, CONTINUOUS EVERGREEN HEDGE EAST - 579 LF 579 / 30 = 19 TREES, CONTINUOUS EVERGREEN HEDGE SOUTH - 529 LF 529 / 30 = 18 TREES, CONTINUOUS EVERGREEN HEDGE WEST - 168 LF 168 / 30 = 6 TREES, CONTINUOUS EVERGREEN HEDGE	NORTH - 270 LF 9 TREES, CONTINUOUS EVERGREEN HEDGE EAST - 579 LF 579 / 30 = 20 TREES, CONTINUOUS EVERGREEN HEDGE SOUTH - 529 LF 529 / 30 = 18 TREES, CONTINUOUS EVERGREEN HEDGE WEST - 168 LF 168 / 30 = 6 TREES, CONTINUOUS EVERGREEN HEDGE
<b>VUA INTERIOR</b> CHAPTER 154, ARTICLE I, SEC. 154.03, D. 1. 1 TREE PER LANDSCAPE ISLAND W/ GROUND COVER, SHRUBS, AND MULCH	39 TOTAL LANDSCAPE ISLANDS = 39 REQUIRED TREES REMAINDER OF LANDSCAPE ISLAND TO CONTAIN GROUND COVER, SHRUBS, AND MULCH	39 TREES PROVIDED SHRUBS, GROUND COVER, AND MULCH PROVIDED IN LANDSCAPE ISLANDS
<b>BUILDING PERIMETER</b> CHAPTER 154, ARTICLE I, SEC. 154.03, C. 2. 5' WIDTH LANDSCAPE AREA 1 TREE OR PALM / 30 LF	561 LF / 30 LF = 19 TREES REQUIRED 561 LF / 2 LF = 281 SHRUBS	0 TREES 266 SHRUBS

- LANDSCAPE NOTES:**
- ALL LANDSCAPE MATERIAL TO BE FLORIDA GRADE #1 OR BETTER QUALITY
  - ALL LANDSCAPED AREAS ARE TO RECEIVE A MINIMUM OF 4" OF TOPSOIL.
  - ALL PLANT MATERIAL SHALL BE HEALTHY, VIGOROUS, AND FREE OF PESTS AND DISEASE.
  - ALL MATERIALS ARE SUBJECT TO THE APPROVAL OF THE LANDSCAPE ARCHITECT BEFORE, DURING, AND AFTER INSTALLATION.
  - ALL TREES MUST BE GUYED OR STAKED AS SHOWN IN THE DETAILS.
  - ALL PLANTING AREAS SHALL BE COMPLETELY MULCHED AS SPECIFIED.
  - PRIOR TO CONSTRUCTION, THE CONTRACTOR SHALL BE RESPONSIBLE FOR LOCATING ALL UNDERGROUND UTILITIES AND SHALL AVOID DAMAGE TO ALL UTILITIES DURING THE COURSE OF THE WORK. LOCATIONS OF EXISTING BURIED UTILITY LINES SHOWN ON THE PLANS ARE BASED UPON BEST AVAILABLE INFORMATION AND ARE TO BE CONSIDERED APPROXIMATE. IT SHALL BE THE RESPONSIBILITY OF THE CONTRACTOR 1) TO VERIFY THE LOCATIONS OF UTILITY LINES ADJACENT TO THE WORK AREA 2) TO PROTECT ALL UTILITY LINES DURING THE CONSTRUCTION PERIOD 3) TO REPAIR ANY AND ALL DAMAGE TO UTILITIES, STRUCTURES, SITE APPURTENANCES, ETC. WHICH OCCURS AS A RESULT OF THE CONSTRUCTION.
  - THE CONTRACTOR SHALL BE RESPONSIBLE FOR VERIFYING ALL QUANTITIES SHOWN ON THESE PLANS BEFORE PRICING THE WORK.
  - CONTRACTOR SHALL BE RESPONSIBLE FOR DELIVERY SCHEDULE AND PROTECTION BETWEEN DELIVERY AND PLANTING TO MAINTAIN HEALTHY PLANT CONDITIONS.
  - THE CONTRACTOR SHALL BE RESPONSIBLE FOR FULLY MAINTAINING (INCLUDING BUT NOT LIMITED TO: WATERING, SPRAYING, MULCHING, FERTILIZING, ETC.) ALL OF THE PLANT MATERIALS AND LAWN FOR THE WARRANTY PERIOD.
  - ANY PLANT MATERIAL WHICH IS DISEASED, DISTRESSED, DEAD, OR REJECTED (PRIOR TO SUBSTANTIAL COMPLETION) SHALL BE PROMPTLY REMOVED FROM THE SITE AND REPLACED WITH MATERIAL OF THE SAME SPECIES, QUANTITY, AND SIZE AND MEETING ALL PLANT LIST SPECIFICATIONS.
  - THE CONTRACTOR SHALL COMPLETELY GUARANTEE ALL PLANT MATERIAL FOR WARRANTY PERIOD. THE CONTRACTOR SHALL PROMPTLY MAKE ALL REPLACEMENTS DURING THE NORMAL PLANTING SEASON.
  - STANDARDS SET FORTH IN "AMERICAN STANDARD FOR NURSERY STOCK" REPRESENT GUIDELINE SPECIFICATIONS ONLY AND SHALL CONSTITUTE MINIMUM QUALITY REQUIREMENTS FOR PLANT MATERIAL.
  - ALL LANDSCAPING SHALL BE INSTALLED ACCORDING TO SOUND NURSERY PRACTICES, AND SHALL BE FLORIDA NO. 1 OR BETTER AS GIVEN IN "GRADES AND STANDARDS FOR NURSERY PLANTS, PARTS I AND II," STATE OF FLORIDA, DEPARTMENT OF AGRICULTURE.
  - ALL INVASIVE / EXOTIC SPECIES AND PROHIBITED TREE SPECIES SHALL BE REMOVED FROM SITE, INCLUDING ROOT BALLS TO THE EXTENT POSSIBLE WITH NO DAMAGE TO ADJACENT EXISTING TREES.
  - ALL LANDSCAPE AREAS WILL BE PROVIDED WITH PERMANENT AUTOMATIC IRRIGATION SYSTEM.
  - TREE SUPPORT MATERIALS ARE TO BE REMOVED FROM EACH TREE ONCE IT IS "ESTABLISHED" (AS APPROVED BY THE LANDSCAPE ARCHITECT).
  - ALL PLANT SPECIFICATIONS IN THE PLANT SCHEDULE SHALL BE CONSIDERED THE MINIMUM ALLOWABLE SPECIFICATIONS. CONTRACTOR SHALL PROCURE PLANT MATERIALS AND UPSIZE AS NECESSARY TO MEET THE MOST STRINGENT SPECIFICATION.

**CITY OF PORT ST. LUCIE LANDSCAPE NOTES:**

NO LANDSCAPING SHALL BE PLANTED IN A MANNER THAT WOULD ADVERSELY AFFECT UTILITY EASEMENTS. LANDSCAPING SHALL BE IN COMPLIANCE WITH CHAPTER 153 OF THE CITY OF PORT ST. LUCIE CODE OF ORDINANCES, PLSUSD TECHNICAL SPECIFICATIONS AND POLICIES.

ALL LANDSCAPING WITHIN CITY UTILITY EASEMENTS SHALL COMPLY WITH PLSUSD TECHNICAL SPECIFICATIONS, POLICIES, AND CODES.

ALL LANDSCAPING SHALL MEET THE LATEST PLSUSD LANDSCAPE POLICY AND SHALL NOT BE PLACED IN A MANNER THAT WOULD CREATE CONFLICTS WITH THE INTENDED OPERATION AND MAINTENANCE OF ANY EXISTING UTILITY.

TREES SHALL NOT BE PLANTED WITHIN TEN (10) FEET OF ANY PLSUSD UNDERGROUND INFRASTRUCTURE.

NO LANDSCAPING OTHER THAN SOD GRASSES SHALL BE LOCATED WITHIN 5' OF A PLSUSD APPURTENANCE SUCH AS A WATER METER ASSEMBLY, BACKFLOW DEVICE, FIRE HYDRANT OR SEWER CLEANOUT, ETC.

**NOTE:**

A MINIMUM OF 50 PERCENT OF ALL REQUIRED TREES ARE NATIVE SPECIES.  
TOTAL TREES PROVIDED: 110  
MINIMUM NUMBER OF TREES TO BE NATIVE SPECIES: 55  
TOTAL NUMBER OF TREES TO BE NATIVE SPECIES PROVIDED: 85

A MINIMUM OF 20 PERCENT OF THE REQUIRED TREES ARE FLOWERING TREES.  
TOTAL NUMBER OF TREES PROVIDED: 110  
MINIMUM NUMBER OF TREES TO BE FLOWERING: 22  
TOTAL NUMBER OF TREES TO BE FLOWERING PROVIDED: 22

A MINIMUM OF 25 PERCENT OF ALL REQUIRED SHRUBS ARE NATIVE SPECIES.  
TOTAL SHRUBS PROVIDED: 1,264  
MINIMUM NUMBER OF SHRUBS TO BE NATIVE SPECIES: 316  
TOTAL NUMBER OF SHRUBS TO BE NATIVE SPECIES PROVIDED: 1,185

NO MORE THAN 50 PERCENT OF LANDSCAPE AREA TO BE SOD  
TOTAL AMOUNT OF LANDSCAPE AREA: 59,309 SF  
MAXIMUM AMOUNT OF LANDSCAPE AREA TO BE SOD: 29,654 SF  
AMOUNT OF PROVIDED SOD: 22,427 SF

A MAXIMUM OF 80 PERCENT OF THE REQUIRED TREES MAY BE PALMS.  
TOTAL NUMBER OF TREES PROVIDED: 103  
MAXIMUM NUMBER OF PALMS TO BE PROVIDED: 88  
TOTAL NUMBER OF PALM TREES PROVIDED: 26

\*\*PER COORDINATION WITH THE CITY

NO.	REVISIONS	DATE
1	REVISED PER CITY COMMENTS	08/18/2021

**Kimley-Horn**  
 © 2021 KIMLEY-HORN AND ASSOCIATES, INC.  
 116 SOUTH KENTUCKY AVENUE, LAKELAND, FL 33801  
 PHONE: 863-701-8702  
 WWW.KIMLEY-HORN.COM CA 00000696

LICENSED PROFESSIONAL  
 MATTHEW T. FRANKO, P.L.A. (FLA)  
 FL LICENSE NUMBER  
 6667292  
 DATE: 8/18/2021

LANDSCAPE SCHEDULE AND CALCULATIONS

LANDINGS AT TRADITION PH 2  
 PREPARED FOR KITE REALTY GROUP  
 PORT ST. LUCIE, FL

CALL 48 HOURS BEFORE YOU DIG  
 IT'S THE LAW! DIAL 811  
 Know what's below. Call before you dig.  
 SUNSHINE STATE ONE CALL OF FLORIDA, INC.

PSLUSD PROJECT # 11-342-48-06  
 CITY OF PORT ST. LUCIE PROJECT # P21 - 153

SHEET NUMBER L1.01

Plotted By: Barrett, Kevin. Sheet: Set: LANDINGS AT TRADITION - PH 2 - Layout: L1.50 - August 15, 2021. 09:53:35am. K:\VRB\02\VA\147098015 - Landings at Tradition - Groceries\BY OTHERS\Landings CAD\PlanSheets\L1.50 - LANDSCAPE PLANNING.dwg  
 This document, together with the concepts and designs presented herein, is intended only for the specific purpose and client for which it was prepared. Reuse of and improper reliance on this document without written authorization and adaptation by Kimley-Horn and Associates, Inc. shall be without liability to Kimley-Horn and Associates, Inc.

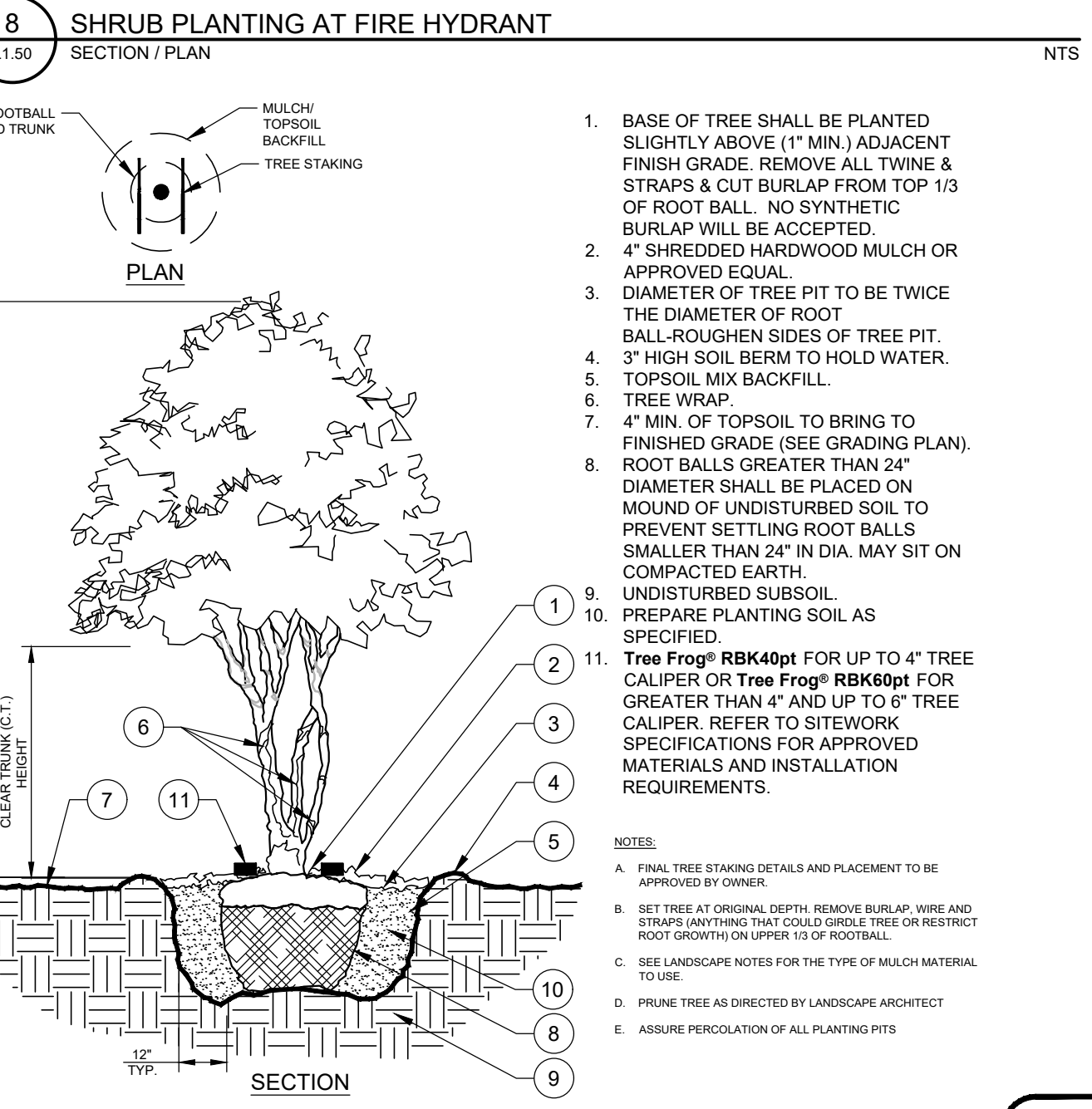
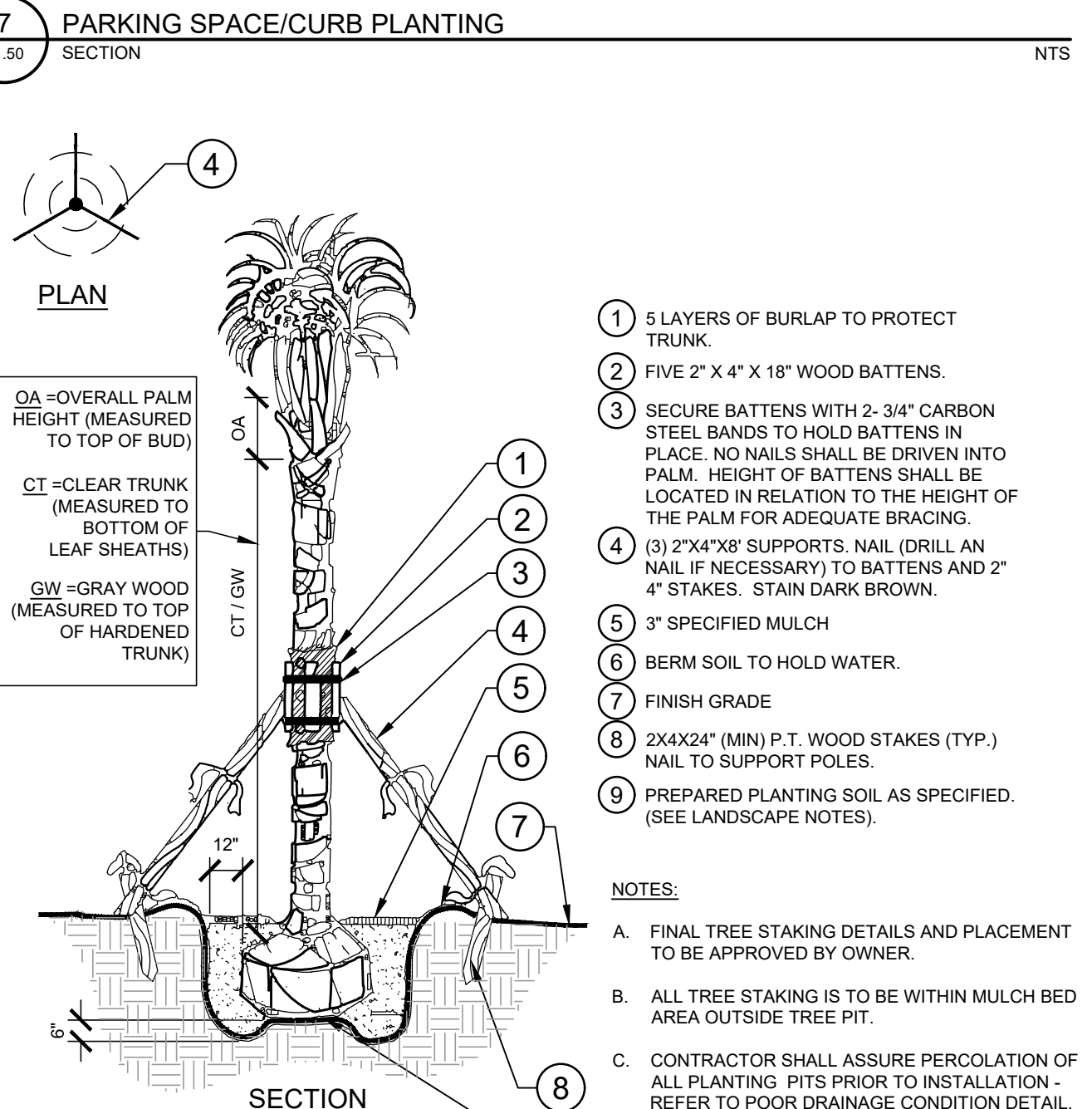
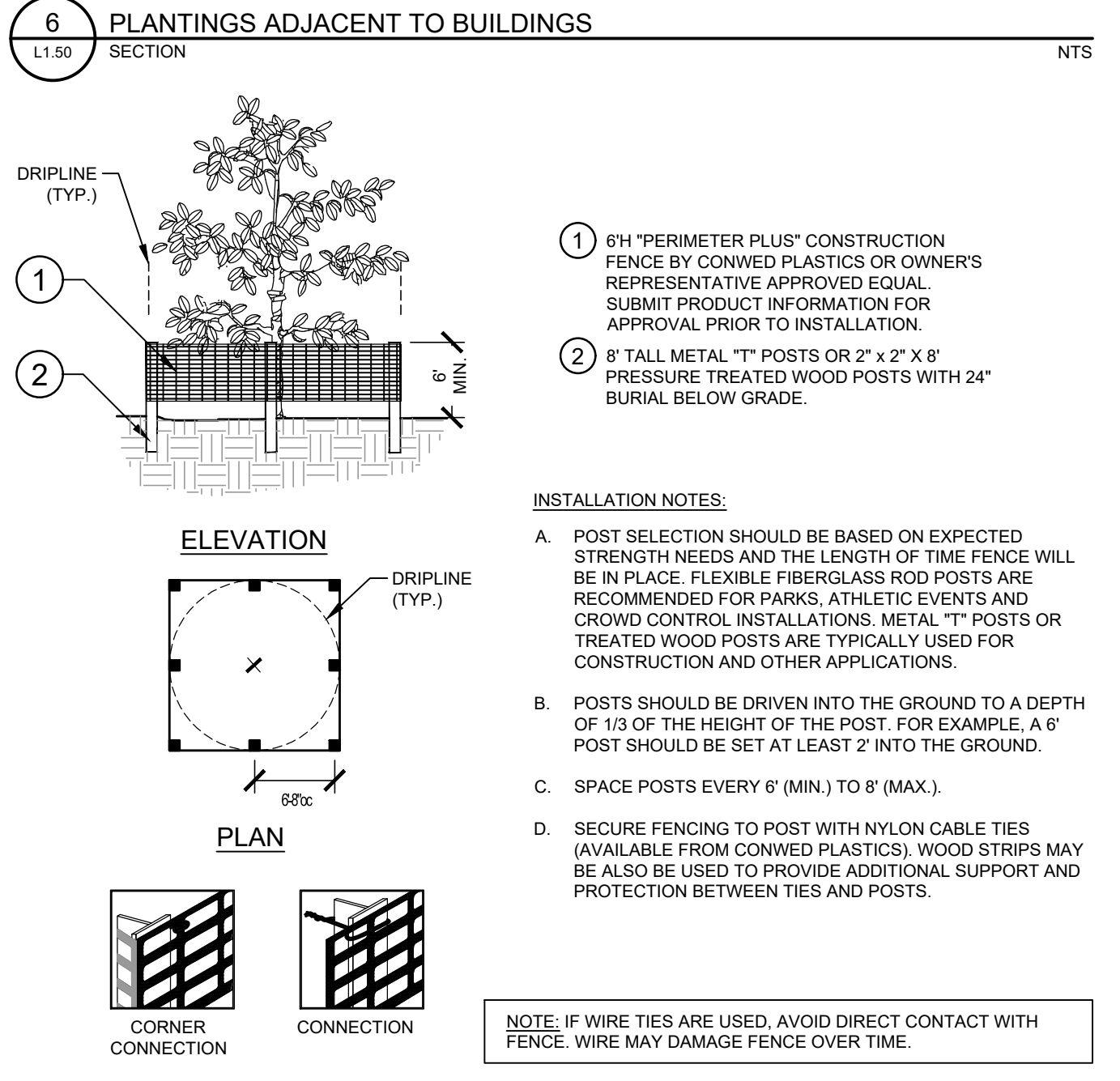
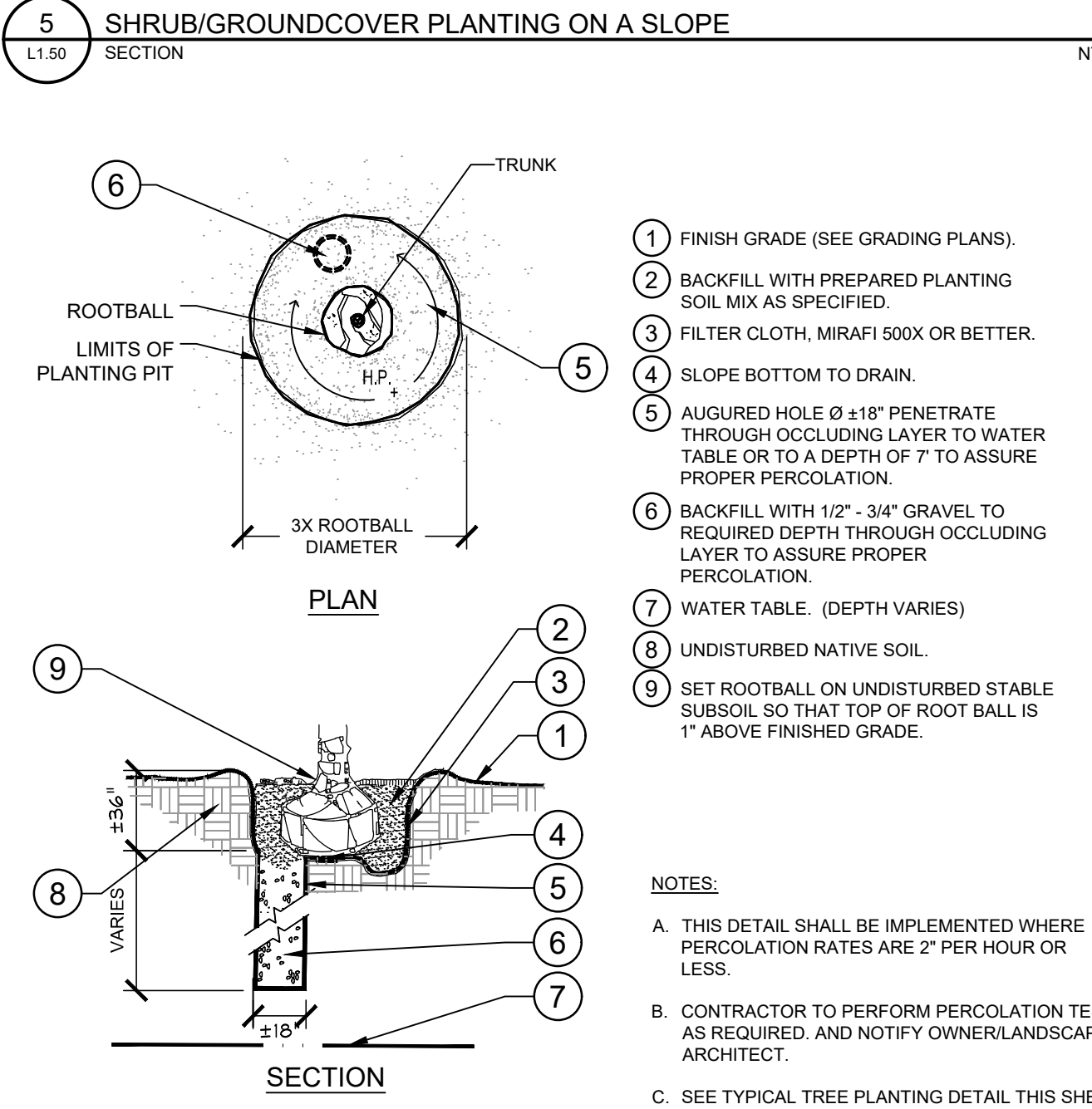
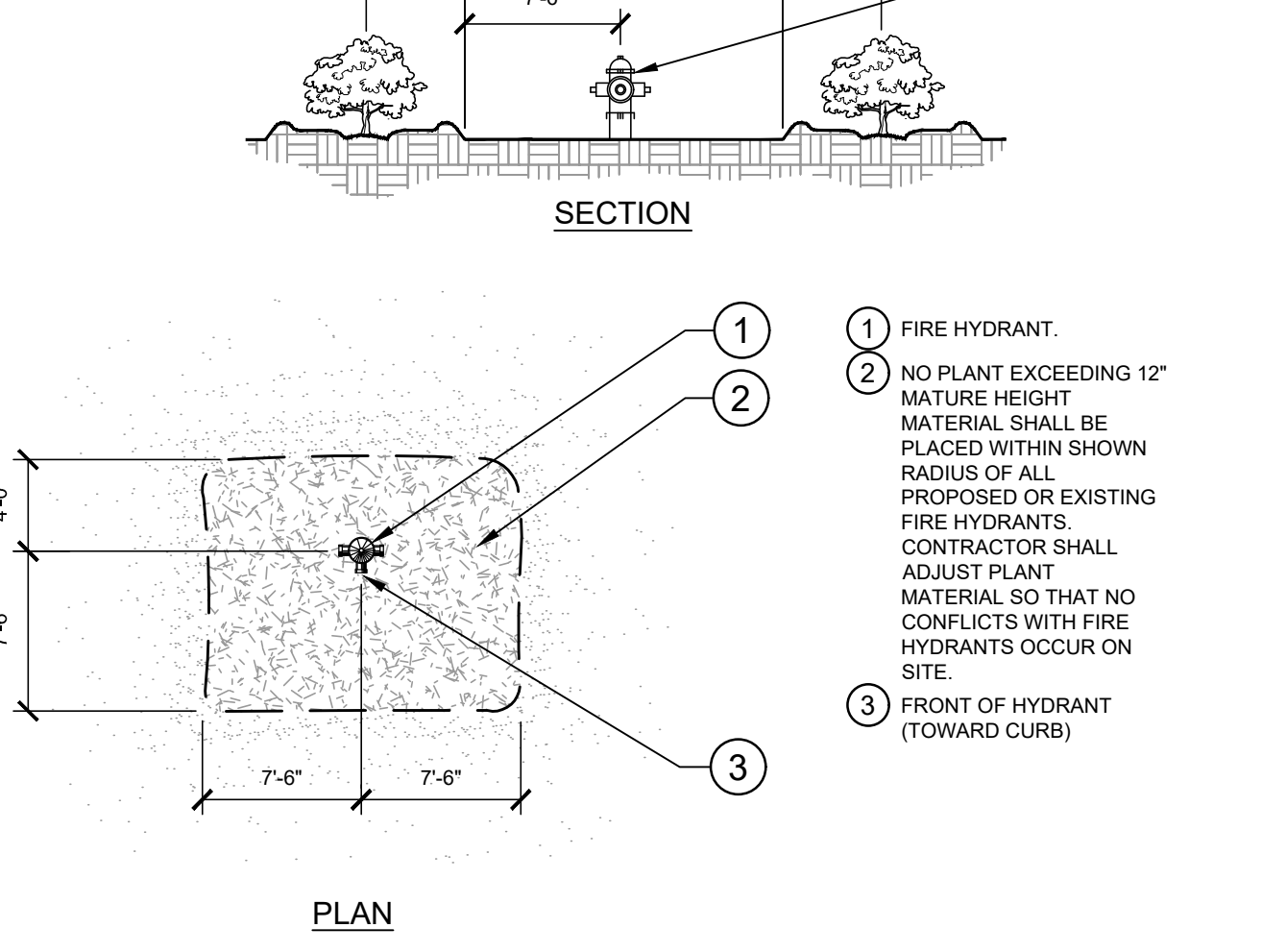
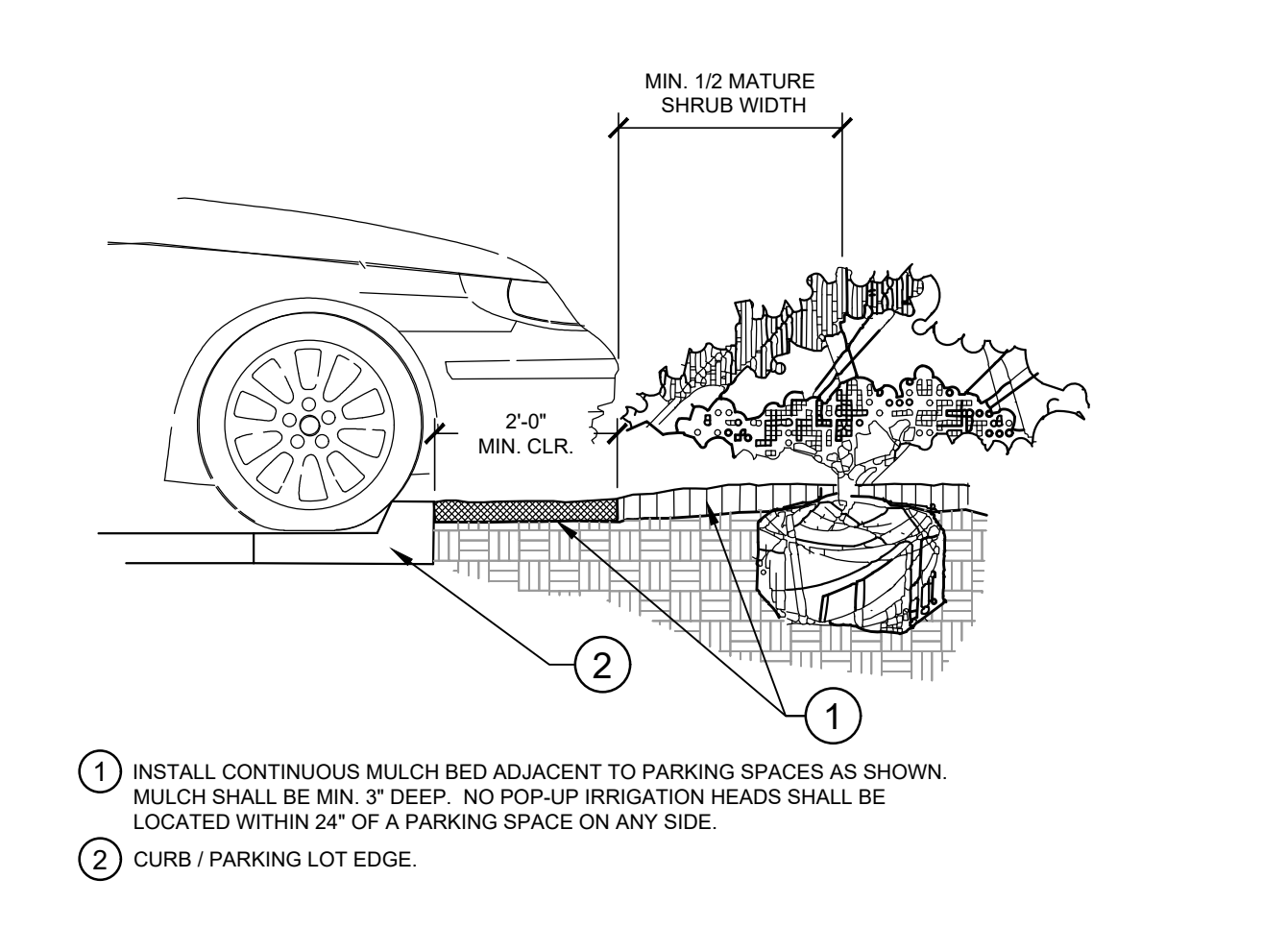
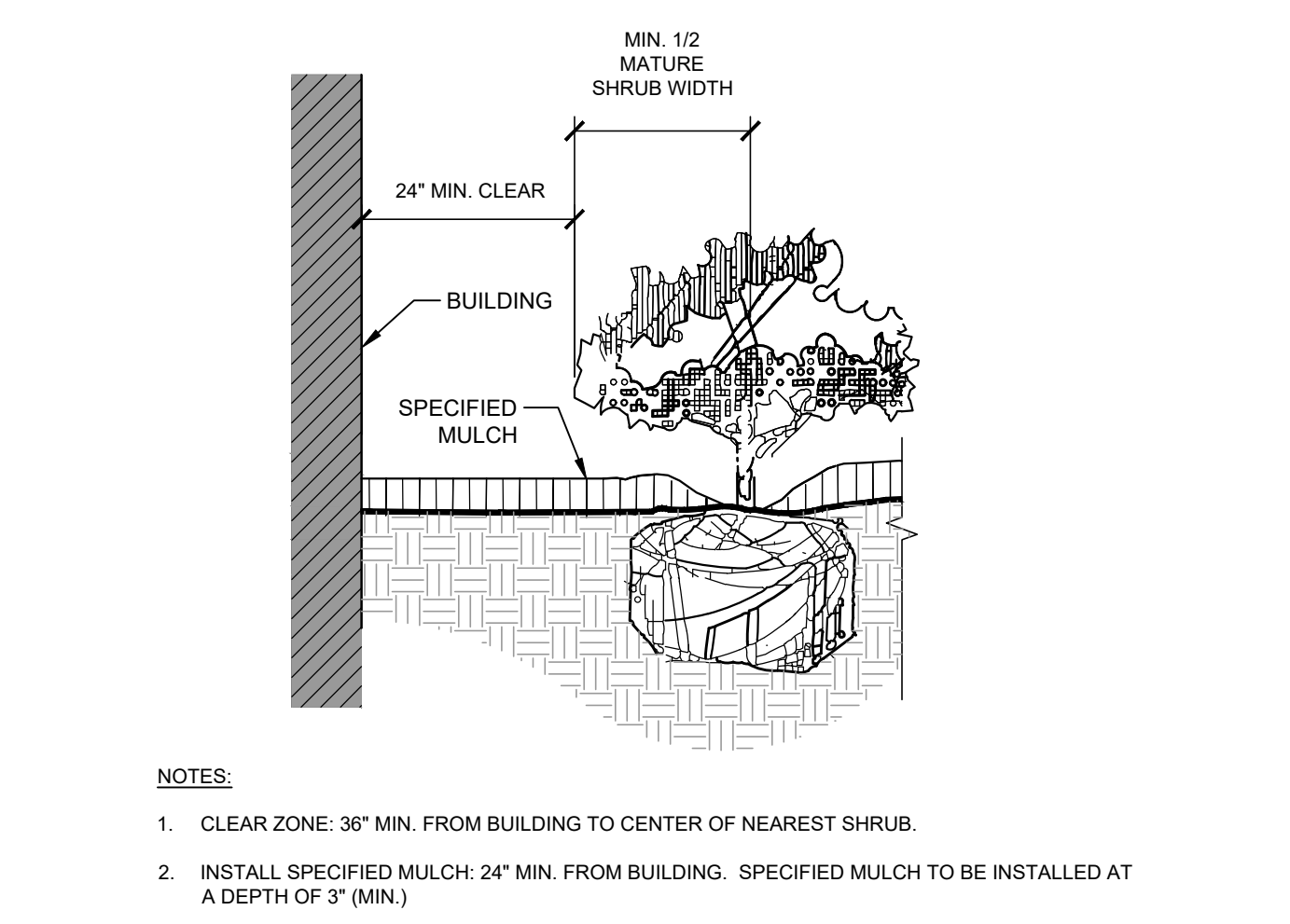
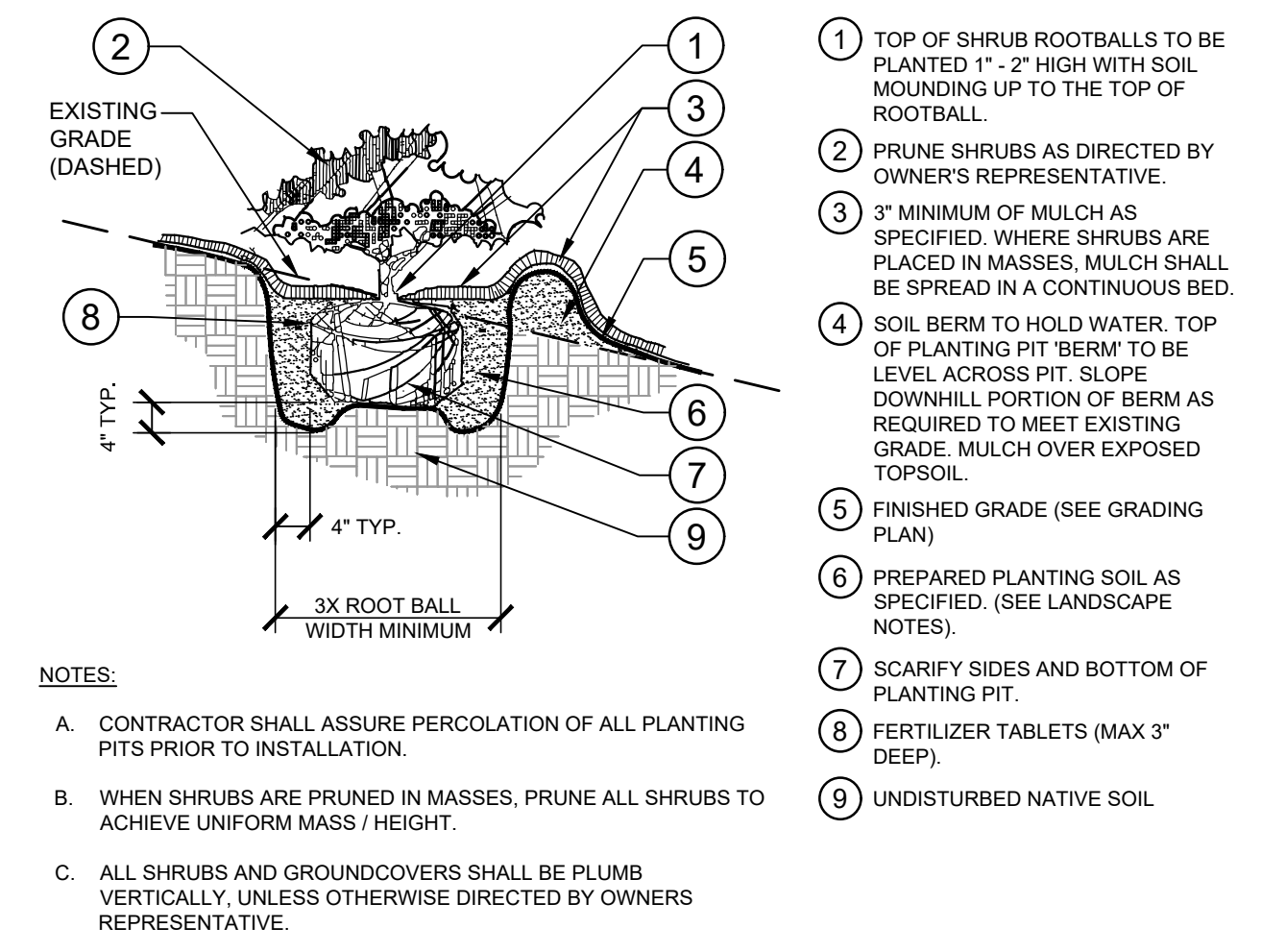
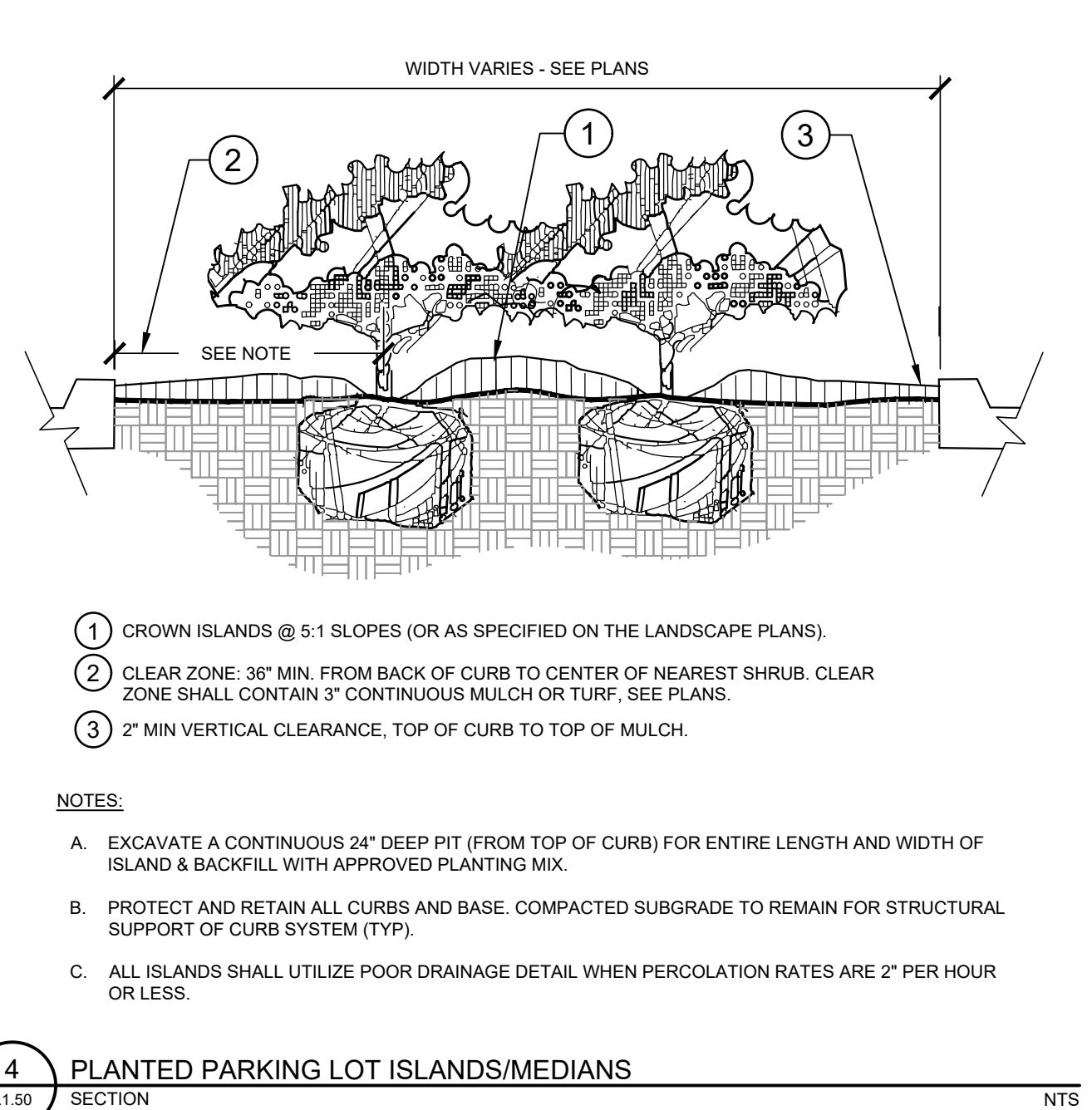
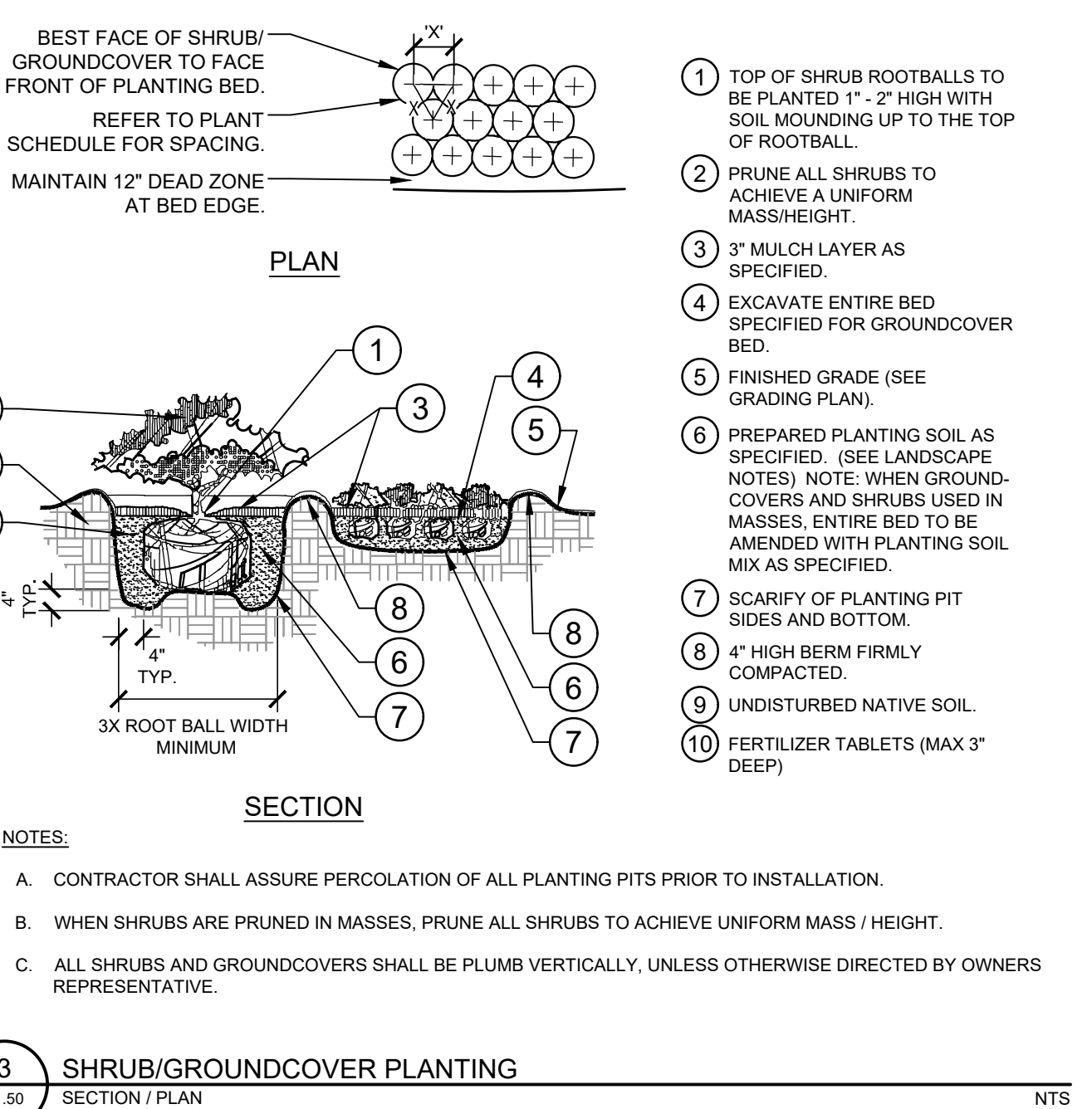
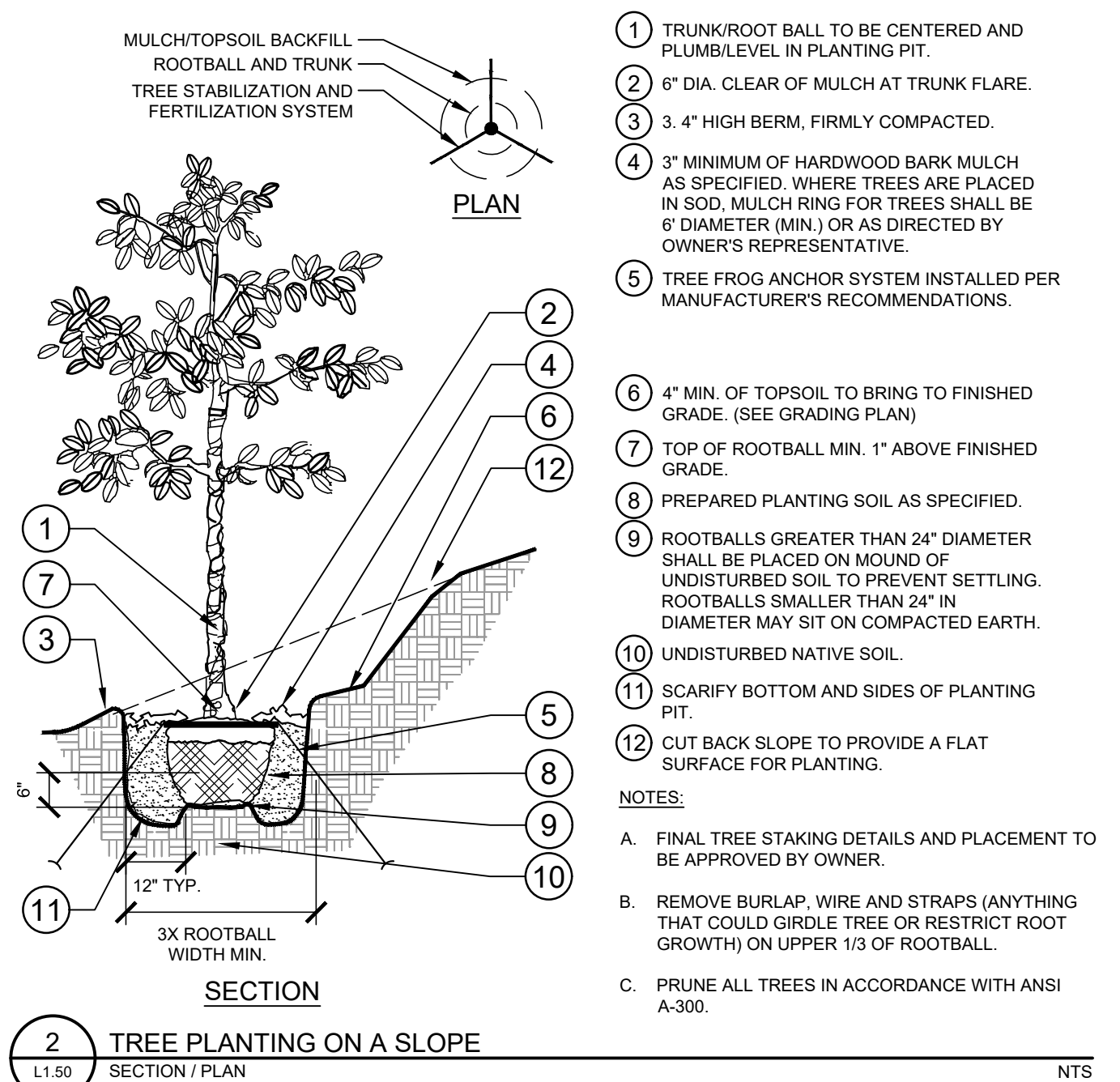
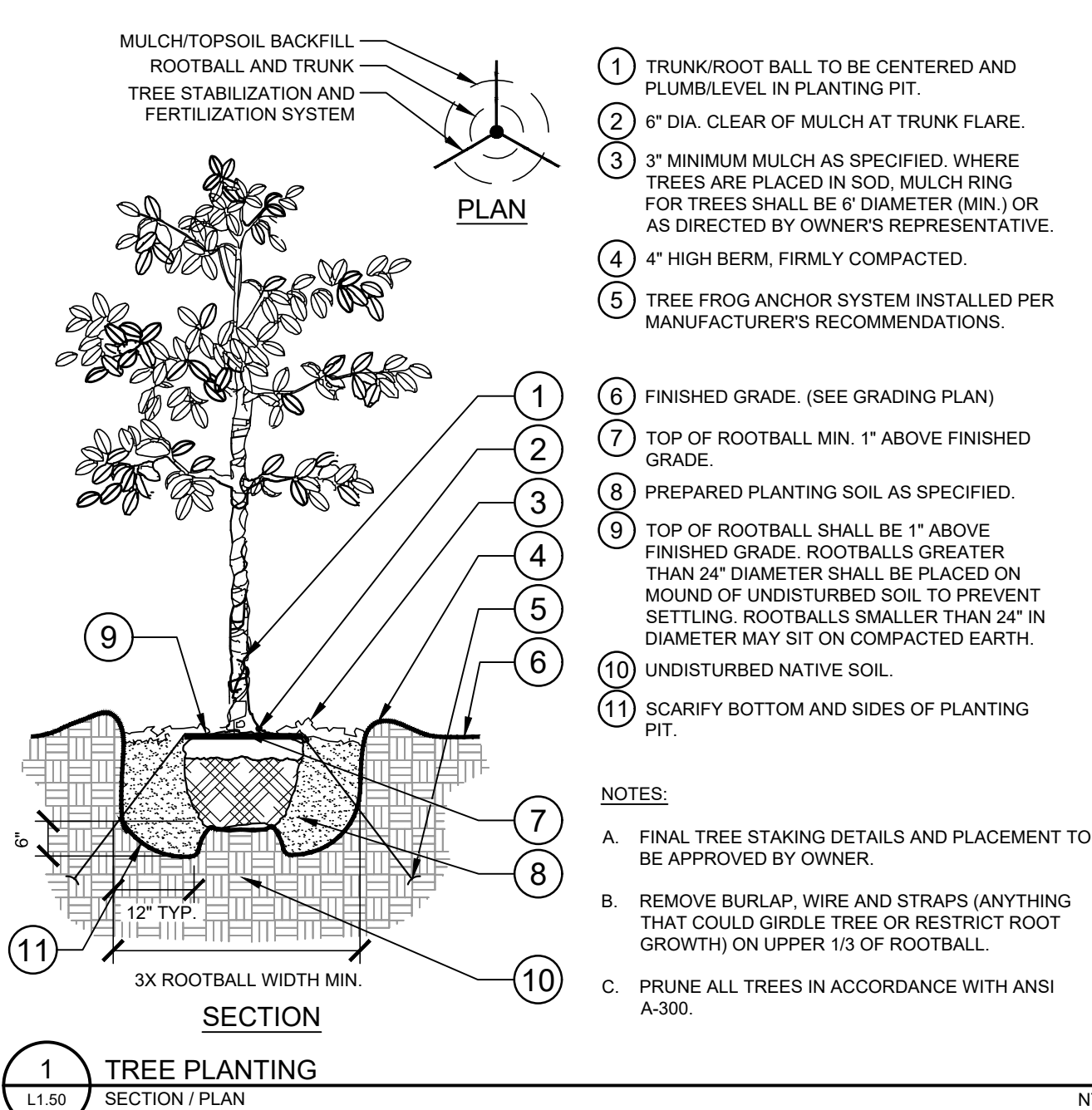

**LANDINGS AT TRADITION PH 2**  
 PREPARED FOR  
**KITE REALTY GROUP**  
 PORT ST LUCIE, FL

**LANDSCAPE DETAILS**

KIMLEY-HORN & ASSOCIATES, INC.  
 116 SOUTH KENTUCKY AVENUE, LAKELAND, FL 33801  
 PHONE: 863-701-8702  
 WWW.KIMLEY-HORN.COM CA 00000696

LICENSED PROFESSIONAL  
 MATTHEW T. FRANKO, P.L.A. (R.A.)  
 FL LICENSE NUMBER  
 6667292  
 DESIGNED BY KHA  
 DRAWN BY KHA  
 CHECKED BY MTF  
 DATE: 8/18/2021

KHA PROJECT  
 147098015  
 DATE  
 05/20/2021  
 SCALE AS SHOWN  
 DESIGNED BY KHA  
 DRAWN BY KHA  
 CHECKED BY MTF  
 DATE: 8/18/2021

REVISIONS  
 NO. DATE BY

1 REVISED PER CITY COMMENTS 06/18/21 KPE

CALL 48 HOURS BEFORE YOU DIG  
 IT'S THE LAW! DIAL 811  
 Know what's below. Call before you dig.  
 SUNSHINE STATE ONE CALL OF FLORIDA, INC.

PSLUSD PROJECT #  
**11-342-48-06**

CITY OF PORT ST. LUCIE PROJECT #  
**P21 - 153**

SHEET NUMBER  
**L1.50**

Plotted By: Barrett, Kevin. Sheet: Section: LANDINGS AT TRADITION --- PH 2. Layout: L1.51. August 18, 2021. 09:54:19am. K:\VRB\DEVA\147098015 - Landings at Tradition - Grades\BY OTHERS\Landscape\CAD\PlanSheets\L1.51 - LANDSCAPE PLAN.dwg  
 This document, together with the concepts and designs presented herein, as an instrument of service, is intended only for the specific purpose and client for which it was prepared. Reuse of any part of this document without written authorization and date/revision by Kimley-Horn and Associates, Inc. shall be without liability to Kimley-Horn and Associates, Inc.

**GENERAL LANDSCAPE SPECIFICATIONS AND NOTES**

- A. SCOPE OF WORK
1. THE WORK CONSISTS OF: FURNISHING ALL LABOR, MATERIALS, EQUIPMENT, TOOLS, TRANSPORTATION, AND ANY OTHER APPURTENANCES NECESSARY FOR THE COMPLETION OF THIS PROJECT AS SHOWN ON THE DRAWINGS, AS INCLUDED IN THE PLANT LIST, AND AS SPECIFIED HEREIN.
  2. WORK SHALL INCLUDE MAINTENANCE AND WATERING OF ALL CONTRACT PLANTING AREAS UNTIL CERTIFICATION OF ACCEPTANCE BY THE OWNER.
- B. PROTECTION OF EXISTING STRUCTURES
1. ALL EXISTING BUILDINGS, WALKS, WALLS, PAVING, PIPING, OTHER SITE CONSTRUCTION ITEMS, AND PLANTING ALREADY COMPLETED OR ESTABLISHED AND DESIGNATED TO REMAIN SHALL BE PROTECTED FROM DAMAGE BY THE CONTRACTOR UNLESS OTHERWISE SPECIFIED. ALL DAMAGE RESULTING FROM NEGLIGENCE SHALL BE REPAIRED OR REPLACED TO THE SATISFACTION OF THE OWNER, AT NO COST TO THE OWNER.
  2. THE CONTRACTOR SHALL BE RESPONSIBLE FOR MAINTAINING ALL NECESSARY BMP DEVICES ACCORDING TO ALL REGULATORY AGENCY'S STANDARDS THROUGHOUT THE DURATION OF ALL CONSTRUCTION ACTIVITIES.
  3. THE CONTRACTOR SHALL SUBMIT A DETAILED PROJECT SPECIFIC WORK ZONE TRAFFIC CONTROL PLAN UNLESS THE WORK REQUIRES NOTHING MORE THAN A DIRECT APPLICATION OF FDOT DESIGN STANDARDS, INDEX 600. IF A DIRECT APPLICATION OF INDEX 600 IS PROPOSED, THE CONTRACTOR SHALL SUBMIT IN WRITING A STATEMENT INDICATING THE STANDARD INDEX AND PAGE NUMBER NO LESS THAN 10 BUSINESS DAYS PRIOR TO START OF CONSTRUCTION. WHEN A DIRECT APPLICATION OF FDOT STANDARD INDEX 600 IS NOT ACCEPTABLE A PROJECT SPECIFIC WORK ZONE TRAFFIC CONTROL PLAN SHALL BE PREPARED BY A FLORIDA PROFESSIONAL ENGINEER WHO HAS SUCCESSFULLY COMPLETED ADVANCED TRAINING IN MAINTENANCE OF TRAFFIC, AS DEFINED BY FDOT FOR APPROVAL BY THE COUNTY ENGINEERS REPRESENTATIVE.
  4. THE CONTRACTOR SHALL BE RESPONSIBLE FOR LOCATING ALL UTILITIES, WHETHER PUBLIC OR PRIVATE, PRIOR TO EXCAVATION. THE INFORMATION AND DATA SHOWN WITH RESPECT TO EXISTING UNDERGROUND FACILITIES AT OR CONTIGUOUS TO THE SITE IS APPROXIMATE AND BASED ON INFORMATION FURNISHED BY THE OWNER OF SUCH UNDERGROUND FACILITIES OR ON PHYSICAL APPURTENANCES OBSERVED IN THE FIELD. THE OWNER AND DESIGN PROFESSIONAL SHALL NOT BE RESPONSIBLE FOR THE ACCURACY AND COMPLETENESS OF ANY SUCH INFORMATION OR DATA. THE CONTRACTOR SHALL HAVE FULL RESPONSIBILITY FOR REVIEWING AND CHECKING ALL SUCH INFORMATION AND DATA, LOCATING ALL UNDERGROUND FACILITIES DURING CONSTRUCTION, THE SAFETY AND PROTECTION THEREOF; REPAIRING ANY DAMAGE THERETO RESULTING FROM THE WORK. THE COST OF ALL WILL BE CONSIDERED AS HAVING BEEN INCLUDED IN THE CONTRACT PRICE. THE CONTRACTOR SHALL NOTIFY ANY AFFECTED UTILITY COMPANIES OR AGENCIES IN WRITING AT LEAST 48 HOURS PRIOR TO BEGINNING CONSTRUCTION.
- C. PROTECTION OF EXISTING PLANT MATERIALS
1. THE CONTRACTOR SHALL BE RESPONSIBLE FOR ALL UNAUTHORIZED CUTTING OR DAMAGE TO TREES AND SHRUBS EXISTING OR OTHERWISE CAUSED BY CARELESS EQUIPMENT OPERATION, MATERIAL STOCKPILING, ETC.. THIS SHALL INCLUDE COMPACTION BY DRIVING OR PARKING INSIDE THE DRIP LINE AND SPILLING OIL, GASOLINE, OR OTHER DELETERIOUS MATERIALS WITHIN THE DRIP LINE. NO MATERIALS SHALL BE BURNED ON SITE. EXISTING TREES KILLED OR DAMAGED SO THAT THEY ARE MISSHAPEN AND/OR UNSIGHTLY SHALL BE REPLACED AT THE COST TO THE CONTRACTOR OF THREE HUNDRED DOLLARS (\$300) PER CALIPER INCH ON AN ESCALATING SCALE WHICH ADDS AN ADDITIONAL TWENTY (20) PERCENT PER INCH OVER FOUR (4) INCHES CALIPER AS FIXED AND AGREED LIQUIDATED DAMAGES. CALIPER SHALL BE MEASURED SIX (6) INCHES ABOVE GROUND LEVEL FOR TREES UP TO AND INCLUDING FOUR (4) INCHES IN CALIPER AND TWELVE (12) INCHES ABOVE GROUND LEVEL FOR TREES OVER FOUR (4) INCHES IN CALIPER.
  2. SEE TREE MITIGATION PLAN AND NOTES, IF APPLICABLE.
- D. MATERIALS
1. GENERAL  
MATERIAL SAMPLES LISTED BELOW SHALL BE SUBMITTED FOR APPROVAL, ON SITE OR AS DETERMINED BY THE OWNER. UPON APPROVAL, DELIVERY OF MATERIALS MAY COMMENCE.  

MATERIAL	SAMPLE SIZE
MULCH	ONE (1) CUBIC FOOT
TOPSOIL MIX	ONE (1) CUBIC FOOT
PLANTS	ONE (1) OF EACH VARIETY (OR TAGGED IN NURSERY)
  2. PLANT MATERIALS
    - a. PLANT SPECIES AND SIZE SHALL CONFORM TO THOSE INDICATED ON THE DRAWINGS. ALL NURSERY STOCK SHALL BE IN ACCORDANCE WITH GRASSES AND STANDARDS FOR NURSERY PLANTS, LATEST EDITION, PUBLISHED BY THE FLORIDA DEPARTMENT OF AGRICULTURE AND CONSUMER SERVICES. ALL PLANTS SHALL BE FLORIDA GRADE (NO. 1 OR BETTER) AS DETERMINED BY THE FLORIDA DIVISION OF PLANT INDUSTRY. ALL PLANTS SHALL BE HEALTHY, VIGOROUS, SOUND, WELL-BRANCHED, AND FREE OF DISEASE AND INSECTS, INSECT EGGS AND LARVAE AND SHALL HAVE ADEQUATE ROOT SYSTEMS. TREES FOR PLANTING IN ROWS SHALL BE UNIFORM IN SIZE AND SHAPE. ALL MATERIALS SHALL BE SUBJECT TO APPROVAL BY THE OWNER. WHERE ANY REQUIREMENTS ARE OMITTED FROM THE PLANT LIST, THE PLANTS FURNISHED SHALL BE NORMAL FOR THE VARIETY. PLANTS SHALL BE PRUNED PRIOR TO DELIVERY ONLY WITH APPROVAL FROM OWNER OR OWNER'S REPRESENTATIVE. NO SUBSTITUTIONS SHALL BE MADE WITHOUT WRITTEN PERMISSION FROM THE OWNER'S REPRESENTATIVE.
    - b. MEASUREMENTS: THE HEIGHT AND/OR WIDTH OF TREES SHALL BE MEASURED FROM THE GROUND OR ACROSS THE NORMAL SPREAD OF BRANCHES WITH THE PLANTS IN THEIR NORMAL POSITION. THIS MEASUREMENT SHALL NOT INCLUDE THE IMMEDIATE TERMINAL GROWTH. PLANTS LARGER IN SIZE THAN THOSE SPECIFIED IN THE PLANT LIST MAY BE USED IF APPROVED BY THE OWNER. IF THE USE OF LARGER PLANTS IS APPROVED, THE BALL OF EARTH OR SPREAD OF ROOTS SHALL BE INCREASED IN PROPORTION TO THE SIZE OF THE PLANT.
    - c. INSPECTION: PLANTS SHALL BE SUBJECT TO INSPECTION AND APPROVAL AT THE PLACE OF GROWTH, OR UPON DELIVERY TO THE SITE, AS DETERMINED BY THE OWNER. FOR QUALITY, SIZE, AND VARIETY. SUCH APPROVAL SHALL NOT IMPAIR THE RIGHT OF INSPECTION AND REJECTION AT THE SITE DURING PROGRESS OF THE WORK OR AFTER COMPLETION FOR SIZE AND CONDITION OF ROOT BALLS OR ROOTS. LATENT DEFECTS OR INJURIES, REJECTED PLANTS SHALL BE REMOVED IMMEDIATELY FROM THE SITE. NOTICE REQUESTING INSPECTION SHALL BE SUBMITTED IN WRITING BY THE CONTRACTOR AT LEAST ONE (1) WEEK PRIOR TO ANTICIPATED DATE.
  3. SOIL MIXTURE (PLANTING MEDIUM, PLANTING MIX, TOPSOIL MIX)
    1. CONTRACTOR SHALL TEST EXISTING SOIL AND AMEND AS NECESSARY IN ACCORDANCE WITH THE GUIDELINES BELOW:
    2. SOIL MIXTURE (PLANTING MEDIUM FOR PLANT PITS) SHALL CONSIST OF TWO PARTS OF TOPSOIL AND ONE PART SAND, AS DESCRIBED BELOW. CONTRACTOR TO SUBMIT SAMPLES AND PH TESTING RESULTS OF SOIL MIXTURE FOR OWNER'S REPRESENTATIVE APPROVAL PRIOR TO PLANT INSTALLATION OPERATIONS COMMENCE.  
      - a. TOPSOIL FOR USE IN PREPARING SOIL MIXTURE FOR BACKFILLING PLANT PITS SHALL BE FERTILE, FRIABLE, AND OF A LOAMY CHARACTER, REASONABLY FREE OF SUBSOIL, CLAY LUMPS, BRUSH WEEDS AND OTHER LITTER; FREE OF ROOTS, STUMPS, STONES LARGER THAN 2" IN ANY DIRECTION, AND OTHER EXTRANEOUS OR TOXIC MATTER HARMFUL TO PLANT GROWTH. IT SHALL CONTAIN THREE (3) TO FIVE (5) PERCENT DECOMPOSED ORGANIC MATTER AND HAVE A PH BETWEEN 5.5 AND 7.0.
      - b. SAND SHALL BE COARSE, CLEAN, WELL-DRAINING, NATIVE SAND.
    3. TREES SHALL BE PLANTED IN THE EXISTING NATIVE SOIL ON SITE, UNLESS DETERMINED TO BE UNSUITABLE - AT WHICH POINT THE CONTRACTOR SHALL CONTACT OWNER'S REPRESENTATIVE TO DISCUSS ALTERNATE RECOMMENDATION PRIOR TO PLANTING.
  4. WATER
    1. WATER NECESSARY FOR PLANTING AND MAINTENANCE SHALL BE OF SATISFACTORY QUALITY TO SUSTAIN ADEQUATE PLANT GROWTH AND SHALL NOT CONTAIN HARMFUL, NATURAL OR MAN-MADE ELEMENTS DETRIMENTAL TO PLANTS. WATER MEETING THE ABOVE STANDARD SHALL BE OBTAINED ON THE SITE FROM THE OWNER, IF AVAILABLE, AND THE CONTRACTOR SHALL BE RESPONSIBLE TO MAKE ARRANGEMENTS FOR ITS USE BY HIS TANKS, HOSES, SPRINKLERS, ETC.. IF SUCH WATER IS NOT AVAILABLE AT THE SITE, THE CONTRACTOR SHALL PROVIDE SATISFACTORY WATER FROM SOURCES OFF THE SITE AT NO ADDITIONAL COST TO THE OWNER.  
 \* WATERING/IRRIGATION RESTRICTIONS MAY APPLY - REFER TO PROPERTY'S JURISDICTIONAL AUTHORITY.
    2. FERTILIZER  
CONTRACTOR SHALL PROVIDE FERTILIZER APPLICATION SCHEDULE TO OWNER, AS APPLICABLE TO SOIL TYPE, PLANT INSTALLATION TYPE, AND SITE'S PROPOSED USE. SUGGESTED FERTILIZER TYPES SHALL BE ORGANIC OR OTHERWISE NATURALLY-DERIVED.  
\* FERTILIZER RESTRICTIONS MAY APPLY - REFER TO PROPERTY'S JURISDICTIONAL AUTHORITY.
  5. MULCH
    1. MULCH MATERIAL SHALL BE MOISTENED AT THE TIME OF APPLICATION TO PREVENT WIND DISPLACEMENT, AND APPLIED AT A DEPTH OF THREE (3) INCHES. CLEAR MULCH FROM EACH PLANT'S CROWN (BASE). MULCH SHALL BE "FLORIMULCH," EUCALYPTUS MULCH, OR SIMILAR SUSTAINABLY HARVESTED MULCH UNLESS SPECIFIED OTHERWISE.
    2. PROVIDE A THREE (3) INCH MINIMUM LAYER OF SPECIFIED MULCH OVER THE ENTIRE AREA OF EACH SHRUB BED, GROUND COVER, VINE BED, AND TREE PIT (6" MINIMUM) PLANTED UNDER THIS CONTRACT.
  6. DIGGING AND HANDLING
    1. PROTECT ROOTS OR ROOT BALLS OF PLANTS AT ALL TIMES FROM SUN, DRYING WINDS, WATER AND FREEZING. AS NECESSARY UNTIL PLANTING. PLANT MATERIALS SHALL BE ADEQUATELY PACKED TO PREVENT DAMAGE DURING TRANSPORT. TREES TRANSPORTED MORE THAN TEN (10) MILES OR WHICH ARE NOT PLANTED WITHIN THREE (3) DAYS OF DELIVERY TO THE SITE SHALL BE SPRAYED WITH AN ANTITRANSPIRANT PRODUCT ("WILT-PRUF" OR EQUAL) TO MINIMIZE TRANSPIRATIONAL WATER LOSS.
    2. BALLED AND BURLAPPED (BBB), AND FIELD GROWN (FG) PLANTS SHALL BE DUG WITH FIRM, NATURAL BALLS OF SOIL OF SUFFICIENT SIZE TO ENCOMPASS THE FIBROUS AND FEEDING ROOTS OF THE PLANTS. NO PLANTS MOVED WITH A ROOT BALL SHALL BE PLANTED IF THE BALL IS CRACKED OR BROKEN. PLANTS SHALL NOT BE HANDLED BY STEMS.

3. PLANTS MARKED "BR" IN THE PLANT LIST SHALL BE DUG WITH BARE ROOTS. CARE SHALL BE EXERCISED THAT THE ROOTS DO NOT DRY OUT DURING TRANSPORTATION AND PRIOR TO PLANTING.
4. PROTECTION OF PALMS: ONLY A MINIMUM OF FRONDS SHALL BE REMOVED FROM THE CROWN OF THE PALM TREES TO FACILITATE MOVING AND HANDLING. CLEAR TRUNK (CT) SHALL BE AS SPECIFIED AFTER THE MINIMUM OF FRONDS HAVE BEEN REMOVED. ALL PALMS SHALL BE BRACED PER PALM PLANTING DETAIL.
5. EXCAVATION OF TREE PITS SHALL BE PERFORMED USING EXTREME CARE TO AVOID DAMAGE TO SURFACE AND SUBSURFACE ELEMENTS SUCH AS UTILITIES OR HARDSCAPE ELEMENTS, FOOTERS AND PREPARE SUB-BASES.
6. CONTAINER GROWN STOCK
  1. ALL CONTAINER GROWN MATERIAL SHALL BE HEALTHY, VIGOROUS, WELL-ROOTED PLANTS ESTABLISHED IN THE CONTAINER IN WHICH THEY ARE SOLD. THE PLANTS SHALL HAVE TOPS WHICH ARE OF GOOD QUALITY AND ARE IN A HEALTHY GROWING CONDITION.
  2. AN ESTABLISHED CONTAINER GROWN PLANT SHALL BE TRANSPLANTED INTO A CONTAINER AND GROWN IN THAT CONTAINER SUFFICIENTLY LONG ENOUGH FOR THE NEW FIBROUS ROOTS TO HAVE DEVELOPED SO THAT THE ROOT MASS WILL RETAIN ITS SHAPE AND HOLD TOGETHER WHEN REMOVED FROM THE CONTAINER. CONTAINER GROWN STOCK SHALL NOT BE HANDLED BY THEIR STEMS.
  3. ROOT BOUND PLANTS ARE NOT ACCEPTABLE AND WILL BE REJECTED.
  4. RFG- "ROOTS PLUS GROWER" CONTAINER PRODUCTS SHALL BE USED WHERE SPECIFIED.
7. COLLECTED STOCK
 

WHEN THE USE OF COLLECTED STOCK IS PERMITTED AS INDICATED BY THE OWNER OR OWNER'S REPRESENTATIVE, THE MINIMUM SIZES OF ROOTBALLS SHALL BE EQUAL TO THAT SPECIFIED FOR THE NEXT LARGER SIZE OF NURSERY GROWN STOCK OF THE SAME VARIETY.

  1. NATIVE STOCK  
PLANTS COLLECTED FROM WILD OR NATIVE STANDS SHALL BE CONSIDERED NURSERY GROWN WHEN THEY HAVE BEEN SUCCESSFULLY RE-ESTABLISHED IN A NURSERY ROW AND GROWN UNDER REGULAR NURSERY CULTURAL PRACTICES FOR A MINIMUM OF TWO (2) GROWING SEASONS AND HAVE ATTAINED ADEQUATE ROOT AND TOP GROWTH TO INDICATE FULL RECOVERY FROM TRANSPLANTING INTO THE NURSERY ROW.
  2. MATERIALS LIST  
QUANTITIES NECESSARY TO COMPLETE THE WORK ON THE DRAWINGS SHALL BE FURNISHED BY THE CONTRACTOR. QUANTITY ESTIMATES HAVE BEEN MADE CAREFULLY, BUT THE LANDSCAPE ARCHITECT OR OWNER ASSUMES NO LIABILITY FOR OMISSIONS OR ERRORS. SHOULD A DISCREPANCY OCCUR BETWEEN THE PLANS AND THE PLANT LIST QUANTITY, THE OWNER'S REPRESENTATIVE SHALL BE NOTIFIED FOR CLARIFICATION PRIOR TO BIDDING OR INSTALLATION. ALL DIMENSIONS AND/OR SIZES SPECIFIED SHALL BE THE MINIMUM ACCEPTABLE SIZE.
  3. FINE GRADING
    1. FINE GRADING UNDER THIS CONTRACT SHALL CONSIST OF FINAL FINISHED GRADING OF LAWN AND PLANTING AREAS THAT HAVE BEEN ROUGH GRADED BY OTHERS. BERMING AS SHOWN ON THE DRAWINGS SHALL BE THE RESPONSIBILITY OF THE CONTRACTOR, UNLESS OTHERWISE NOTED.
    2. THE CONTRACTOR SHALL FINE GRADE THE LAWN AND PLANTING AREAS TO BRING THE ROUGH GRADE UP TO FINAL FINISHED GRADE ALLOWING FOR THICKNESS OF SOD AND/OR MULCH DEPTH. CONTRACTOR SHALL FINE GRADE BY HAND AND/OR WITH ALL EQUIPMENT NECESSARY INCLUDING A GRADING TRACTOR WITH FRONT-END LOADER FOR TRANSPORTING SOIL WITHIN THE SITE.
    3. ALL PLANTING AREAS SHALL BE GRADED AND MAINTAINED FOR POSITIVE DRAINAGE TO SURFACE/SUBSURFACE STORM DRAIN SYSTEMS. AREAS ADJACENT TO BUILDINGS SHALL SLOPE AWAY FROM THE BUILDINGS. REFER TO CIVIL ENGINEER'S PLANS FOR FINAL GRADES, IF APPLICABLE.
  4. PLANTING PROCEDURES
    1. CLEANING UP BEFORE COMMENCING WORK: THE CONTRACTOR SHALL CLEAN WORK AND SURROUNDING AREAS OF ALL RUBBISH OR OBJECTIONABLE MATTER DAILY. ALL MORTAR, CEMENT, AND TOXIC MATERIAL SHALL BE REMOVED FROM THE SURFACE OF ALL PLANT BEDS. THESE MATERIALS SHALL NOT BE MIXED WITH THE SOIL. SHOULD THE CONTRACTOR FIND SUCH SOIL CONDITIONS BENEATH THE SOIL WHICH WILL IN ANY WAY ADVERSELY AFFECT THE PLANT GROWTH, HE SHALL IMMEDIATELY CALL IT TO THE ATTENTION OF THE OWNERS REPRESENTATIVE. FAILURE TO DO SO BEFORE PLANTING SHALL MAKE THE CORRECTIVE MEASURES THE RESPONSIBILITY OF THE CONTRACTOR.
    2. VERIFY LOCATIONS OF ALL UTILITIES, CONDUITS, SUPPLY LINES AND CABLES, INCLUDING BUT NOT LIMITED TO: ELECTRIC, GAS LINES AND TANKS), WATER, SANITARY SEWER, STORMWATER SYSTEMS, CABLE, AND TELEPHONE. PROPERLY MAINTAIN AND PROTECT EXISTING UTILITIES. CALL SUNSHINE STATE ONE CALL OF FLORIDA, INC. (811) TO LOCATE UTILITIES AT LEAST 48 HOURS PRIOR TO CONSTRUCTION.
    3. SUBGRADE EXCAVATION: CONTRACTOR IS RESPONSIBLE TO REMOVE ALL EXISTING AND IMPORTED LIMEROCK OR LIMEROCK SUB-BASE FROM ALL LANDSCAPE PLANTING AREAS TO A MINIMUM DEPTH OF 36" OR TO NATIVE SOIL. CONTRACTOR IS RESPONSIBLE TO BACKFILL THESE PLANTING AREAS TO ROUGH FINISHED GRADE WITH CLEAN TOPSOIL FROM AN ON-SITE SOURCE OR AN IMPORTED SOURCE. IF LIMEROCK OR OTHER ADVERSE CONDITIONS OCCUR IN PLANTED AREAS AFTER 36" DEEP EXCAVATION BY THE CONTRACTOR, AND POSITIVE DRAINAGE CAN NOT BE ACHIEVED, CONTRACTOR SHALL UTILIZE POOR DRAINAGE CONDITION PLANTING DETAIL.
    4. FURNISH NURSERY'S CERTIFICATE OF COMPLIANCE WITH ALL REQUIREMENTS AS SPECIFIED HEREIN. INSPECT AND SELECT PLANT MATERIALS BEFORE PLANTS ARE DUG AT NURSERY OR GROWING SITE.
    5. COMPLY WITH APPLICABLE FEDERAL, STATE, COUNTY, AND LOCAL REGULATIONS GOVERNING LANDSCAPE MATERIALS AND WORK. CONFORM TO ACCEPTED HORTICULTURAL PRACTICES AS USED IN THE TRADE. UPON ARRIVAL AT THE SITE, PLANTS SHALL BE THOROUGHLY WATERED AND PROPERLY MAINTAINED UNTIL PLANTED. PLANTS STORED ON SITE SHALL NOT REMAIN UNPLANTED OR APPROPRIATELY HEALED IN FOR A PERIOD EXCEEDING TWENTY-FOUR (24) HOURS. AT ALL TIMES WORKMANLIKE METHODS CUSTOMARY IN GOOD HORTICULTURAL PRACTICES SHALL BE EXERCISED.
    6. THE WORK SHALL BE COORDINATED WITH OTHER TRADES TO PREVENT CONFLICTS. COORDINATE PLANTING WITH IRRIGATION WORK TO ASSURE AVAILABILITY OF WATER AND PROPER LOCATION OF IRRIGATION APPURTENANCES AND PLANTS.
    7. ALL PLANTING PITS SHALL BE EXCAVATED TO SIZE AND DEPTH IN ACCORDANCE WITH THE USA STANDARD FOR NURSERY STOCK 260.1, UNLESS SHOWN OTHERWISE ON THE DRAWINGS, AND BACK FILLED WITH THE PREPARED PLANTING SOIL MIXTURE AS SPECIFIED IN SECTION E. TEST ALL TREE PITS WITH WATER BEFORE PLANTING TO ASSURE PROPER DRAINAGE PERCOLATION IS AVAILABLE. NO ALLOWANCE WILL BE MADE FOR LOST PLANTS DUE TO IMPROPER DRAINAGE. IF POOR DRAINAGE EXISTS, UTILIZE "POOR DRAINAGE CONDITION" PLANTING DETAIL. TREES SHALL BE SET PLUMB AND HELD IN POSITION UNTIL THE PLANTING MIXTURE HAS BEEN FLUSHED INTO PLACE WITH A SLOW, FULL HOSE STREAM. ALL PLANTING SHALL BE PERFORMED BY PERSONNEL FAMILIAR WITH PLANTING PROCEDURES AND UNDER THE SUPERVISION OF A QUALIFIED LANDSCAPE FOREMAN. PROPER "JETTING IN" SHALL BE ASSURED TO ELIMINATE AIR POCKETS AROUND THE ROOTS. "JET STICK" OR EQUAL IS RECOMMENDED.
    8. TAKE ALL NECESSARY PRECAUTIONS TO AVOID DAMAGE TO BUILDINGS AND BUILDING STRUCTURES WHILE INSTALLING TREES.
    9. SOIL MIXTURE SHALL BE AS SPECIFIED IN SECTION E OF THESE SPECIFICATIONS.
    10. TREES AND SHRUBS SHALL BE SET STRAIGHT AT AN ELEVATION THAT, AFTER SETTLEMENT, THE PLANT CROWN WILL STAND ONE (1) TO TWO (2) INCHES ABOVE GRADE. EACH PLANT SHALL BE SET IN THE CENTER OF THE PIT. PLANTING SOIL MIXTURE SHALL BE BACK FILLED, THOROUGHLY TAMPED AROUND THE BALL, AND SETTLED BY WATER (AFTER TAMPING).
    11. AMEND PINE AND OAK PLANT PITS WITH ECTOMYCORRHIZAL SOIL APPLICATION PER MANUFACTURER'S RECOMMENDATION. ALL OTHER PLANT PITS SHALL BE AMENDED WITH ENDOMYCORRHIZAL SOIL APPLICATION PER MANUFACTURER'S RECOMMENDATION. PROVIDE PRODUCT INFORMATION SUBMITTAL PRIOR TO INOCULATION.
    12. FILL HOLE WITH SOIL MIXTURE, MAKING CERTAIN ALL SOIL IS SATURATED. TO DO THIS, FILL HOLE WITH WATER AND ALLOW TO SOAK MINIMUM TWENTY (20) MINUTES. STIRRING IF NECESSARY TO GET SOIL THOROUGHLY WET. PACK LIGHTLY WITH FEET. ADD MORE WET SOIL MIXTURE. DO NOT COVER TOP OF BALL WITH SOIL MIXTURE. ALL BURLAP, ROPE, WIRES, BASKETS, ETC., SHALL BE REMOVED FROM THE SIDES AND TOPS OF BALLS, BUT NO BURLAP SHALL BE PULLED FROM UNDERNEATH.
    13. TREES SHALL BE PRUNED, AT THE DIRECTION OF THE OWNER OR OWNER'S REPRESENTATIVE, TO PRESERVE THE NATURAL CHARACTER OF THE PLANT. ALL SOFT WOOD OR SUCKER GROWTH AND ALL BROKEN OR BADLY DAMAGED BRANCHES SHALL BE REMOVED WITH A CLEAN CUT. ALL PRUNING TO BE PERFORMED BY CERTIFIED ARBORIST, IN ACCORDANCE WITH ANSI A-300.
    14. SHRUBS AND GROUND COVER PLANTS SHALL BE EVENLY SPACED IN ACCORDANCE WITH THE DRAWINGS AND AS INDICATED ON THE PLANT LIST. MATERIALS INSTALLED SHALL MEET MINIMUM SPECIFICATION REQUIREMENTS OR QUANTITIES SHOWN ON PLANS, WHICHEVER IS GREATER. CULTIVATE ALL PLANTING AREAS TO A MINIMUM DEPTH OF 6". REMOVE AND DISPOSE ALL DEBRIS. MIX TOP 4" THE PLANTING SOIL MIXTURE AS SPECIFIED IN SECTION E. THOROUGHLY WATER ALL PLANTS AFTER INSTALLATION.
    15. TREE GUYING AND BRACING SHALL BE INSTALLED BY THE CONTRACTOR IN ACCORDANCE WITH THE PLANS TO INSURE STABILITY AND MAINTAIN TREES IN AN UPRIGHT POSITION. IF THE CONTRACTOR AND OWNER DECIDE TO WAIVE THE TREE GUYING AND BRACING, THE OWNER SHALL NOTIFY THE PROJECT LANDSCAPE ARCHITECT IN WRITING AND AGREE TO INDEMNIFY AND HOLD HARMLESS THE PROJECT LANDSCAPE ARCHITECT IN THE EVENT UNSUPPORTED TREES PLANTED UNDER THIS CONTRACT FALL AND DAMAGE PERSON OR PROPERTY.
    16. ALL PLANT BEDS SHALL BE KEPT FREE OF NOXIOUS WEEDS UNTIL FINAL ACCEPTANCE OF WORK. IF DIRECTED BY THE OWNER, "ROUND-UP" SHALL BE APPLIED FOR WEED CONTROL TO ALL PLANTING AREAS IN SPOT APPLICATIONS PER MANUFACTURER'S PRECAUTIONS AND SPECIFICATIONS. PRIOR TO FINAL INSPECTION, TREAT ALL PLANTING BEDS WITH AN APPROVED PRE-EMERGENT HERBICIDE AT AN APPLICATION RATE RECOMMENDED BY THE MANUFACTURER. (AS ALLOWED BY JURISDICTIONAL AUTHORITY)

3. PREPARE LOOSE BED FOUR (4) INCHES DEEP. HAND RAKE UNTIL ALL BUMPS AND DEPRESSIONS ARE REMOVED. WET PREPARED AREA THOROUGHLY.
4. SODDING
  - a. THE CONTRACTOR SHALL SOD ALL AREAS THAT ARE NOT PAVED OR PLANTED AS DESIGNATED ON THE DRAWINGS WITHIN THE CONTRACT LIMITS, UNLESS SPECIFICALLY NOTED OTHERWISE.
  - b. THE SOD SHALL BE CERTIFIED TO MEET FLORIDA STATE PLANT BOARD SPECIFICATIONS, ABSOLUTELY TRUE TO VARIETAL TYPE, AND FREE FROM WEEDS, FUNGUS, INSECTS AND DISEASE OF ANY KIND.
  - c. SOD PANELS SHALL BE LAID TIGHTLY TOGETHER SO AS TO MAKE A SOLID SODDED LAWN AREA. SOD SHALL BE LAID UNIFORMLY AGAINST THE EDGES OF ALL CURBS AND OTHER HARDSCAPE ELEMENTS, PAVED AND PLANTED AREAS. ADJACENT TO BUILDINGS, A 24 INCH STONE MULCH STRIP SHALL BE PROVIDED. IMMEDIATELY FOLLOWING SOD LAYING, THE LAWN AREAS SHALL BE ROLLED WITH A LAWN ROLLER CUSTOMARILY USED FOR SUCH PURPOSES, AND THEN THOROUGHLY IRRIGATED. IF, IN THE OPINION OF THE OWNER, TOP-DRESSING IS NECESSARY AFTER ROLLING TO FILL THE VOIDS BETWEEN THE SOD PANELS AND TO EVEN OUT INCONSISTENCIES IN THE SOD, CLEAN SAND, AS APPROVED BY THE OWNER'S REPRESENTATIVE, SHALL BE UNIFORMLY SPREAD OVER THE ENTIRE SURFACE OF THE SOD AND THOROUGHLY WATERED IN. FERTILIZE INSTALLED SOD AS ALLOWED BY PROPERTY'S JURISDICTIONAL AUTHORITY.
  5. DURING DELIVERY, PRIOR TO, AND DURING THE PLANTING OF THE LAWN AREAS, THE SOD PANELS SHALL AT ALL TIMES BE PROTECTED FROM EXCESSIVE DRYING AND UNNECESSARY EXPOSURE OF THE ROOTS TO THE SUN. ALL SOD SHALL BE STACKED SO AS NOT TO BE DAMAGED BY SWEATING OR EXCESSIVE HEAT AND MOISTURE.
  6. LAWN MAINTENANCE
    - a. WITHIN THE CONTRACT LIMITS, THE CONTRACTOR SHALL PRODUCE A DENSE, WELL ESTABLISHED LAWN. THE CONTRACTOR SHALL BE RESPONSIBLE FOR THE REPAIR AND RE-SODDING OF ALL ERODED, SUNKEN OR BARE SPOTS (LARGER THAN 12"X12") UNTIL CERTIFICATION OF ACCEPTANCE BY THE OWNER'S REPRESENTATIVE. REPAIRED SODDING SHALL BE ACCOMPLISHED AS IN THE ORIGINAL WORK (INCLUDING REGRADE IF NECESSARY).
    - b. CONTRACTOR RESPONSIBLE FOR ESTABLISHING AND MAINTAINING SOD/LAWN UNTIL ACCEPTANCE BY THE OWNER'S REPRESENTATIVE. PRIOR TO AND UPON ACCEPTANCE, CONTRACTOR TO PROVIDE WATERING/IRRIGATION SCHEDULE TO OWNER. OBSERVE ALL APPLICABLE WATERING RESTRICTIONS AS SET FORTH BY THE PROPERTY'S JURISDICTIONAL AUTHORITY.
  7. CLEANUP  
UPON COMPLETION OF ALL PLANTING WORK AND BEFORE FINAL ACCEPTANCE, THE CONTRACTOR SHALL REMOVE ALL MATERIAL, EQUIPMENT, AND DEBRIS RESULTING FROM HIS WORK. ALL PAVED AREAS SHALL BE CLEANED AND THE SITE LEFT IN A NEAT AND ACCEPTABLE CONDITION AS APPROVED BY THE OWNER'S REPRESENTATIVE.
  8. PLANT MATERIAL MAINTENANCE  
ALL PLANTS AND PLANTING INCLUDED UNDER THIS CONTRACT SHALL BE MAINTAINED BY WATERING, CULTIVATING, SPRAYING, AND ALL OTHER OPERATIONS (SUCH AS RE-STAKING OR REPAIRING CUT SUPPORTS) NECESSARY TO INSURE A HEALTHY PLANT CONDITION BY THE CONTRACTOR UNTIL CERTIFICATION OF ACCEPTANCE BY THE OWNER'S REPRESENTATIVE.
  9. FINAL INSPECTION AND ACCEPTANCE OF WORK  
FINAL INSPECTION AT THE END OF THE WARRANTY PERIOD SHALL BE ON PLANTING, CONSTRUCTION AND ALL OTHER INCIDENTAL WORK PERTAINING TO THIS CONTRACT. ANY REPLACEMENT AT THIS TIME SHALL BE SUBJECT TO THE SAME ONE (1) YEAR WARRANTY (OR AS SPECIFIED BY THE LANDSCAPE ARCHITECT OR OWNER IN WRITING) BEGINNING WITH THE TIME OF REPLACEMENT AND ENDING WITH THE SAME INSPECTION AND ACCEPTANCE HEREIN DESCRIBED.
  10. WARRANTY
    1. THE LIFE AND SATISFACTORY CONDITION OF ALL PLANT MATERIAL INSTALLED (INCLUDING SOD) BY THE LANDSCAPE CONTRACTOR SHALL BE WARRANTED BY THE CONTRACTOR FOR A MINIMUM OF ONE (1) CALENDAR YEAR COMMENCING AT THE TIME OF CERTIFICATION OF ACCEPTANCE BY THE OWNER'S REPRESENTATIVE.
    2. ANY PLANT NOT FOUND IN A HEALTHY GROWING CONDITION AT THE END OF THE WARRANTY PERIOD SHALL BE REMOVED FROM THE SITE AND REPLACED AS SOON AS WEATHER CONDITIONS PERMIT. ALL REPLACEMENTS SHALL BE PLANTS OF THE SAME KIND AND SIZE AS SPECIFIED IN THE PLANT LIST. THEY SHALL BE FURNISHED PLANTED AND MULCHED AS SPECIFIED AT NO ADDITIONAL COST TO THE OWNER.
    3. IN THE EVENT THE OWNER DOES NOT CONTRACT WITH THE CONTRACTOR FOR LANDSCAPE AND IRRIGATION MAINTENANCE, THE CONTRACTOR SHOULD VISIT THE PROJECT SITE PERIODICALLY DURING THE ONE (1) YEAR WARRANTY PERIOD TO EVALUATE MAINTENANCE PROCEDURES BEING PERFORMED BY THE OWNER. CONTRACTOR SHALL NOTIFY THE OWNER IN WRITING OF MAINTENANCE PROCEDURES OR CONDITIONS WHICH THREATEN VIGOROUS AND HEALTHY PLANT GROWTH. SITE VISITS SHALL BE CONDUCTED A MINIMUM OF ONCE PER MONTH FOR A PERIOD OF TWELVE (12) MONTHS FROM THE DATE OF ACCEPTANCE.

PSLUSD PROJECT # **11-342-48-06**  
 CITY OF PORT ST. LUCIE PROJECT # **P21 - 153**

**CALL 48 HOURS BEFORE YOU DIG**  
**IT'S THE LAW! DIAL 811**   
 Know what's below. Call before you dig.  
SUNSHINE STATE ONE CALL OF FLORIDA, INC.

LANDINGS AT TRADITION PH 2 PREPARED FOR KITE REALTY GROUP  
 PORT ST. LUCIE, FL

KHA PROJECT 147098015  
 DATE 05/20/2021  
 SCALE AS SHOWN  
 DESIGNED BY KHA  
 DRAWN BY KHA  
 CHECKED BY MTF  
 DATE: 8/18/2021

LICENSED PROFESSIONAL  
 MATTHEW T. FRANKO, P.E. (R.L.A.)  
 FL LICENSE NUMBER 6667292

SHEET NUMBER **L1.51**

NO.	REVISIONS	DATE
1	REVISED PER CITY COMMENTS	06/08/21/KPBE

**Kimley >>> Horn**  
 © 2021 KIMLEY-HORN AND ASSOCIATES, INC.  
 116 SOUTH KENTUCKY AVENUE, LAKELAND, FL 33801  
 PHONE: 863-701-8702  
 WWW.KIMLEY-HORN.COM CA 0000696