

Landscape Data

(City of PSL Requirements)

Perimeter Landscaping Adjacent to Road Right-of-way- North Buffer (730')

Trees
Required - (1 Tree/30 I.F.)- 730 I.F./30 = 25 Trees
Provided - 25 Trees

Shrubs
Required - Continuous Hedge 2' O.C. = 365 Shrubs
Provided - 365 Shrubs

Perimeter Landscaping Adjacent to Road Right-of-way- West Buffer (1,220')

Trees
Required - (1 Tree/30 I.F.)- 1,220 I.F./30 = 41 Trees
Provided - 41 Trees

Shrubs
Required - Continuous Hedge 2' O.C. = 610 Shrubs
Provided - 610 Shrubs

Perimeter Landscaping Adjacent to Another Property - East Buffer (1,280')

Trees
Required - (1 Tree/30 I.F.)- 1,280 I.F./30 = 43 Trees
Provided - 43 Trees

Shrubs
Required - Continuous Hedge 2' O.C. = 640 Shrubs
Provided - 640 Shrubs

Perimeter Landscaping Adjacent to Another Property - South Buffer (512')

Trees
Required: (1 Tree/30 I.F.) - 512 I.F./30 = 17 Trees
Provided: 17 Trees

Shrubs
Required: Continuous Hedge 2' O.C. = 256 Shrubs
Provided: 256 Shrubs

Parking Area Interior Landscaping

Required Terminal/Interior Island Trees - 1 Tree per
Terminal/Interior Island = 96 Trees
* Total Terminal/Interior Island Trees Provided = 96 Trees

Palm Requirements

Required - No more than 25% of required trees may be palms
Total Trees = 410
Total Palms = 16 @ 2:1 = 8 Trees
Provided: Palms = 8 = 4%

154.c.4 = Building facade palms are excluded from Palm requirement

Building Facades

Building Type 1 - Clubhouse

Trees
Required - 1 Tree / 30 I.F. of Building Perimeter
368 I.F. of Building Perimeter / 30 I.F. = 12 Trees
* Provided - 12

Shrubs
Require - 1 Shrub / 2 I.F. of Building Perimeter
368 I.F. / 2 = 184 Shrubs
Provided - 184 Shrubs

Building Type 2 - 8 Buildings

Trees
Required - 1 Tree / 30 I.F. of Building Perimeter
542 I.F. of Building Perimeter / 30 I.F. = 18 Trees
* Provided - 18

Shrubs
Require - 1 Shrub / 2 I.F. of Building Perimeter
542 I.F. / 2 = 271 Shrubs
Provided - 271 Shrubs

Total Trees
Required - 18 Tree x 8 Buildings = 144
* Provided - 144

Total Shrubs
Required - 271 Shrubs x 8 Buildings = 2,168
Provided - 2,168

Building Type 3 - 2 Buildings

Trees
Required - 1 Tree / 30 I.F. of Building Perimeter
488 I.F. of Building Perimeter / 30 I.F. = 16 Trees
* Provided - 16

Shrubs
Require - 1 Shrub / 2 I.F. of Building Perimeter
488 I.F. / 2 = 244 Shrubs
Provided - 244 Shrubs

Total Trees
Required - 16 Tree x 2 Buildings = 32
* Provided - 32

Total Shrubs
Required - 244 Shrubs x 2 Buildings = 488
Provided - 488

All Buildings

Total Trees
Required = 188
* Provided = 188

Total Shrubs
Required = 2,840
Provided = 2,840

Native Plants

Trees:
Required: 50% of all required trees shall be native
Total Trees = 410 (205 = 50%)
Provided: Native Trees = 262 / 410 = 64%

Shrubs:
Required: 25% of all required shrubs shall be native
Total Shrubs = 15,811 (3,953 Minimum)
Provided: Native Shrubs = 3,953 = 25%

Flowering Trees

Required: 20% of all required trees shall be flowering
Total Trees = 410 (Not Including Palms) x 20% = 82
Provided: Flowering Trees = 87 = 21%

Landscape Island Evergreen Shade Trees

Required: 75% of all required trees located within landscape islands shall be evergreen shade trees
Total Landscape Islands = 96 x 75% = 72 Trees
Provided: Landscape Islands with Evergreen Shade Trees = 72 = 75%

Tree Species Mix

Required: When 41+ trees are required the minimum species mix = 5
Provided: 9

Total Trees:
Total Trees Required: 410
Total Trees Provided: 410
319 Trees + 200 Palms @ 2:1 = 100 Trees = 419 Trees

Total Shrubs:
Total Shrubs Required: 15,811
Total Shrubs Provided: 15,811

Note:
* Some trees share perimeter buffer areas due to building facade planting areas and landscape buffers overlapping.
(154.03.D allows for combined landscape strips. Landscape Strips Combined. Where the edges of required landscape strips are spaced apart 20 feet or less, a single landscape strip may be utilized, and the landscaping may be distributed over the entire width of the combined landscape strips. However, requirements for landscape buffer strips shall not be modified. Where a landscape buffer strip and a landscape strip are spaced apart 20 feet or less, only a landscape buffer strip shall be required. Where requirements for a landscape strip differ, the more stringent requirements shall take precedence.)

Some trees relocated due to site constraints such as utilities, etc.

Sheet 2

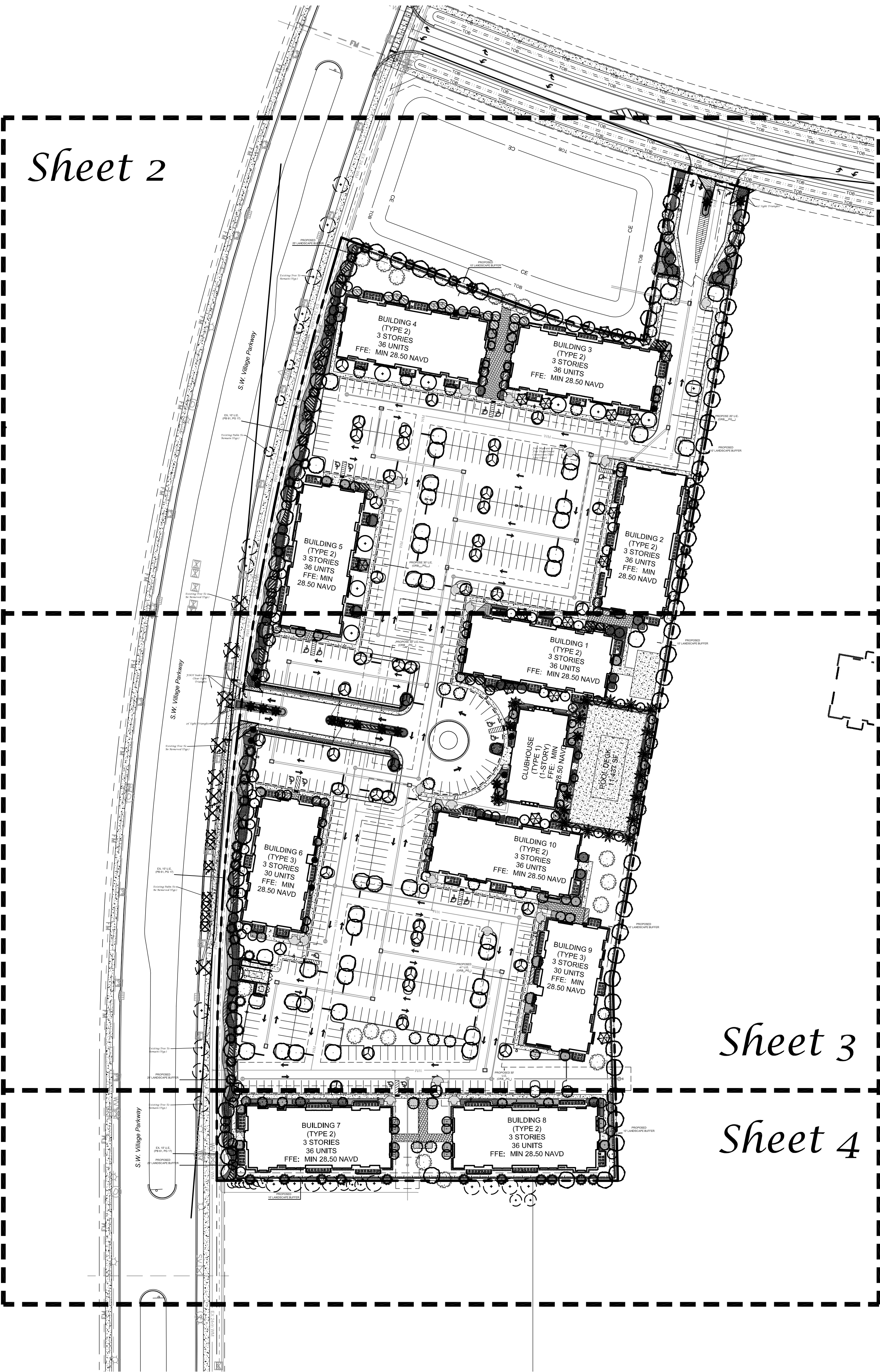

Sheet 3

Sheet 4

Plant List

QTY	SYM	SPECIES	COMMON NAME/DESCRIPTION	SIZE	SPACING	REMARKS	DROUGHT TOLERANCE
CANOPY / ORNAMENTAL TREES							
18	DR	DELOINX REGIA	ROYAL POINCIANA	14' x 6', 2.5' CAL.	A.S.	FULL CANOPY, 4' C.T. MIN.	HIGH
51	IE*	ILEX x ATTENUATA 'EAGLESTON'	EAGLESTON HOLLY	14' x 6', 2.5' CAL.	A.S.	FULL CANOPY, 4' C.T. MIN.	HIGH
14	LJ	LIGUSTRUM JAPONICUM	LIGUSTRUM TREE FORM	14' x 8'	A.S.	FULL CANOPY, 4' C.T. MIN.	HIGH
41	LS	LAGERSTROEMIA SPECIOSA	QUEEN'S CREPE MYRTLE	14' x 6', 2.5' CAL.	A.S.	FULL CANOPY, 4' C.T. MIN.	HIGH
11	MG*	MAGNOLIA GRANDIFLORA	LITTLE GEM MAGNOLIA	14' x 6', 2.5' CAL.	A.S.	FULL CANOPY, 4' C.T. MIN.	HIGH
19	MG-1*	MAGNOLIA GRANDIFLORA	SOUTHERN MAGNOLIA D.D. BLANCHARD	14' x 6', 2.5' CAL.	A.S.	FULL CANOPY, 4' C.T. MIN.	HIGH
46	PE*	PINUS ELLIOTTI Densa	SOUTH FLORIDA SLASH PINE	14' x 6', 2.5' CAL.	A.S.	FULL CANOPY, 4' C.T. MIN.	HIGH
12	QL*	QUERCUS LAURIFOLIA	LAUREL OAK	14' x 6', 2.5' CAL.	A.S.	FULL CANOPY, 4' C.T. MIN.	HIGH
124	QV*	QUERCUS VIRGINIANA	LIVE OAK	14' x 6', 2.5' CAL.	A.S.	FULL CANOPY, 4' C.T. MIN.	HIGH
PALMS							
15	BN	BISMARCKIA NOBILIS	BISMARCK PALM	8' C.T.	A.S.	FULL HEAD, FAT TRUNKS, SYMMETRICAL, MATCHED	HIGH
23	PT	PTYCHOSPERMA ELEGANS	ALEXANDER PALM	12' O.A.	A.S.	FULL, DOUBLE TRUNKS, SYMMETRICAL	HIGH
17	RE*	ROYSTONEA ELATA	ROYAL PALM	12' C.T.	A.S.	FULL HEAD, FAT TRUNKS, SYMMETRICAL, MATCHED	HIGH
134	SP*	SABAL PALMETTO	SABAL PALM	12' - 15' C.T.	A.S.	SLICK TRUNKS,	HIGH
11	CH	CHAMAEROPS HUMILIS	EUROPEAN FAN PALM	8' O.A.	A.S.	FULL TO BASE, MULTI-STEM, SPECIMEN	HIGH
SHRUBS / GROUNDCOVERS / ACCENTS							
1,000	CES*	CONOCARPUS ERECTUS VAR. SERICEUS	SILVER BUTTWOOD	2' x 2'	3' O.C.	FULL & THICK	HIGH
2,150	CH*	CHRYSOALANUS ICAGO	COCOPALM	2' x 2'	2' O.C.	FULL & THICK	HIGH
200	VIS	VIBURNUM SUSPENSUM	SANDANKWA VIBURNUM	2' x 2'	2' O.C.	FULL & THICK	HIGH
25	MYR*	MYRICANTHES FRAGRANS	SIMPSON STOPPER	2' x 2'	2' O.C.	FULL & THICK	HIGH
1,200	MYR-1*	MYRICANTHES FRAGRANS	SIMPSON STOPPER	3' x 2'	2' O.C.	FULL & THICK	HIGH
1,000	HAP*	HAMELIA PATENS	FIREBUSH	24" x 24"	3' O.C.	FULL & THICK	HIGH
1,000	HR*	HIBISCUS ROSA SINENSIS	PINK HIBISCUS	24" x 24"	3' O.C.	FULL & THICK	HIGH
1,000	IKO*	IKORA 'NORA GRANT'	IKORA 'NORA GRANT'	24" x 24"	3' O.C.	FULL & THICK	HIGH
125	MUC*	MUHLENBERGIA CAPILLARIS	MUHLY GRASS	24" x 24"	3' O.C.	FULL & THICK	HIGH
300	SER*	SERENOA REPENS	SAVI PALMETTO	12" x 12"	3' O.C.	FULL & THICK	HIGH
1,650	BOD	BOUGAINVILLEA 'DWARF' HELEN JOHNSON	DWARF BOUGAINVILLEA	12" x 12"	2' O.C.	FULL & THICK	HIGH
1,650	FGI	FICUS MICROCARPA 'GREEN ISLAND'	GREEN ISLAND FICUS	12" x 12"	2' O.C.	FULL & THICK	HIGH
1,650	ILY*	ILEX YOMITORIA	DWARF YALPON HOLLY	12" x 12"	2' O.C.	FULL & THICK	HIGH
1,350	JUP	JUNIPERUS PARSONII	PARSONS JUNIPER	12" x 12"	2' O.C.	FULL & THICK	HIGH
51	LAM	LANTANA MONTEVIDENSIS	PURPLE LANTANA	12" x 12"	2' O.C.	FULL & THICK	HIGH
1,350	PHX	PHILODENDRON 'XANADU'	PHILODENDRON - XANADU	12" x 12"	2' O.C.	FULL & THICK	HIGH
50	PTW	PITTOSPORUM 'WHEELER'	WHEELERS PITTOSPORUM	12" x 12"	2' O.C.	FULL & THICK	HIGH
10	ZAF*	ZAMIA FLORIDIANA - COONTIE	FLORIDA ZAMIA	12" x 12"	2' O.C.	FULL & THICK	HIGH
25	CRA	CRinum ASIATICUM	CRinum LILY	2' x 3'	A.S.	FULL & THICK	HIGH
25	CYR	CYCAS REVOLUTA	KING SAGO	2' x 3'	A.S.	FULL & THICK	HIGH
25	STR	STRELTZIA REGINIA	ORANGE BIRD OF PARADISE	2' x 3'	A.S.	FULL & THICK	HIGH
25	ZAM	ZAMIA FURFURACEA	MEXICAN ZAMIA	2' x 3'	A.S.	FULL & THICK	HIGH
SOD-1		PASPALUM NOTATUM	BAHIA SOD	SEE SPECS			HIGH
SOD		STENOTAPHRUM SECUNDATUS	ST. AUGUSTINE SOD	SEE SPECS			LOW - MEDIUM
* = FLORIDA NATIVE							

Conceptual
Design
Group. Inc.

Landscape Architecture - Site Planning

900 East Ocean Boulevard, Suite 130d
Stuart, Florida 34994
(772) 344-2340
LA: 0001635

St. Matilda

Tradition
City of Port St. Lucie, Florida

Jeffrey W. Smith, RLA
Florida Registration Number:
LA 0001635

Job No. 24-0601
Drawn By JWS
Submittal Dates 6-17-2024
10-8-2024
12-17-2024

Revision Dates
New Base 10-8-2024
City & Tradition Com. 12-17-2024

These drawings are the property of the
landscape architect and are not to be
used for other projects except by written
permission from the landscape architect.
Report any discrepancies immediately
to the landscape architect.

CL-1 4
Sheet of
City Project Numbers: P24-090

Conceptual Landscape Plan

Not For Construction



North

Scale: 1" = 80'

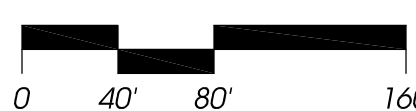

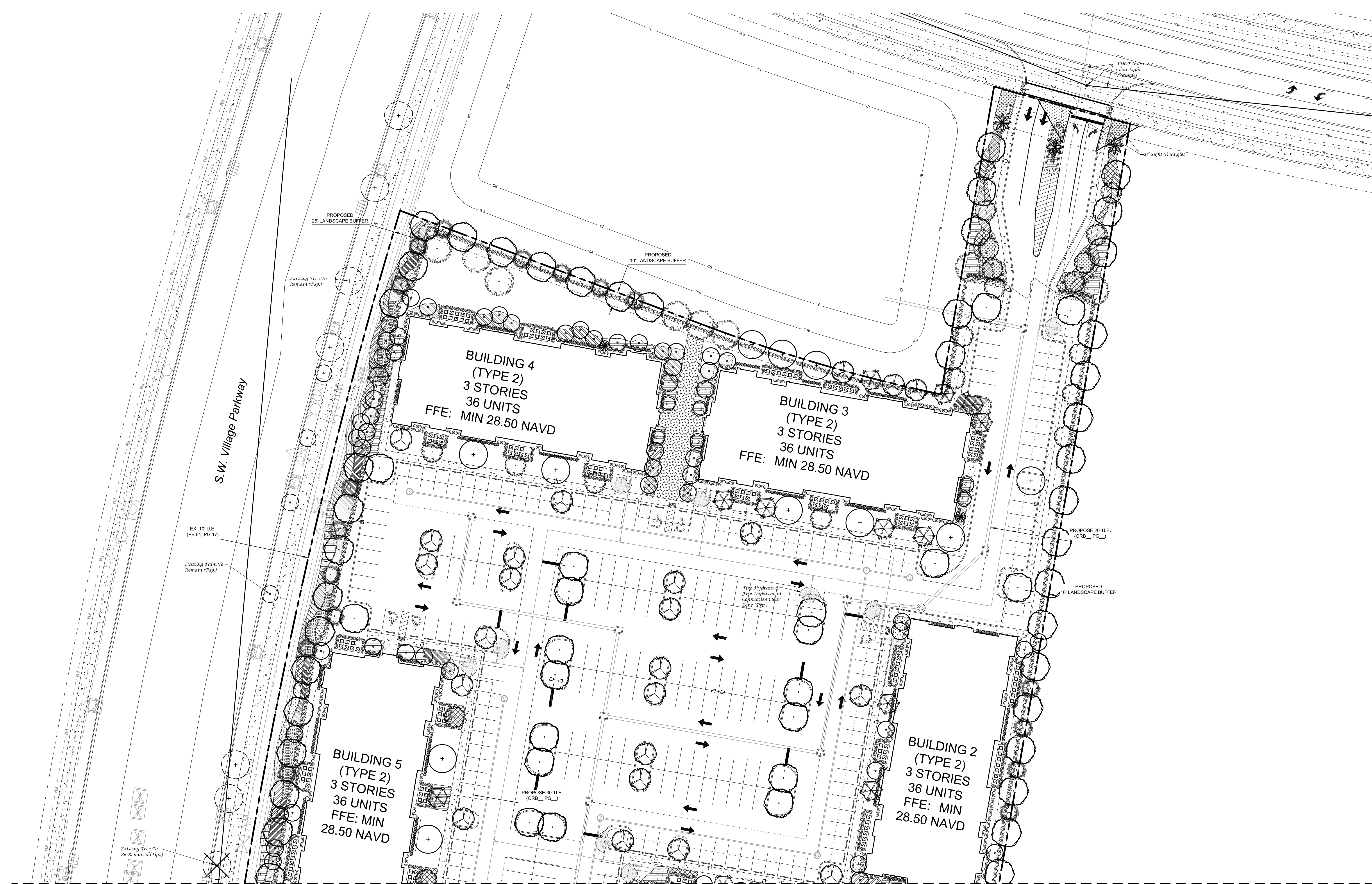

PSLUSD #11-962-00



Scale: 1" = 30'

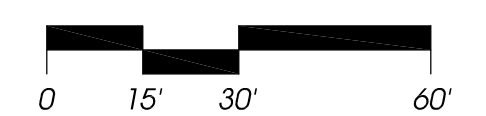

Conceptual Landscape Plan

Not For Construction

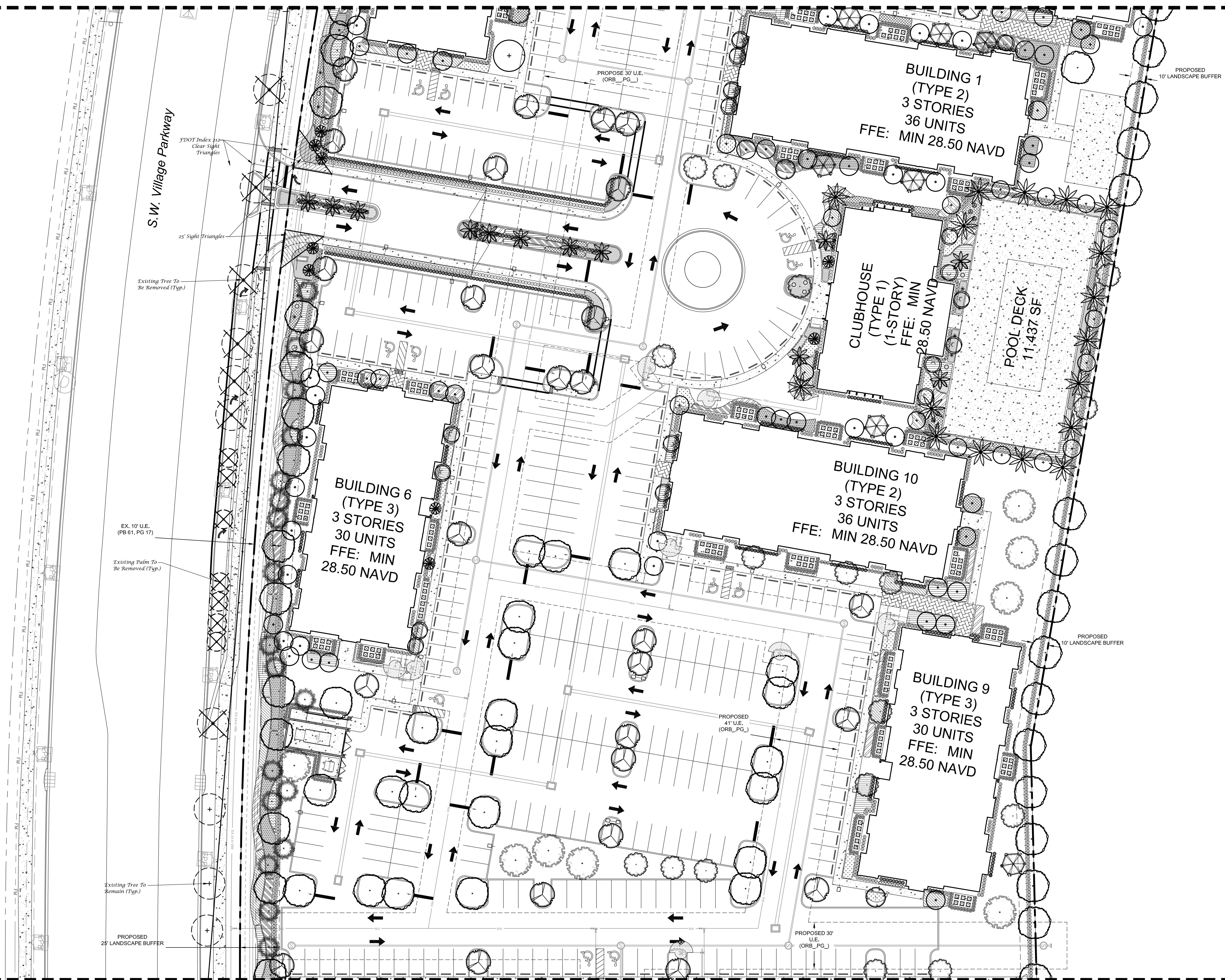

Conceptual Landscape Plan

Not For Construction

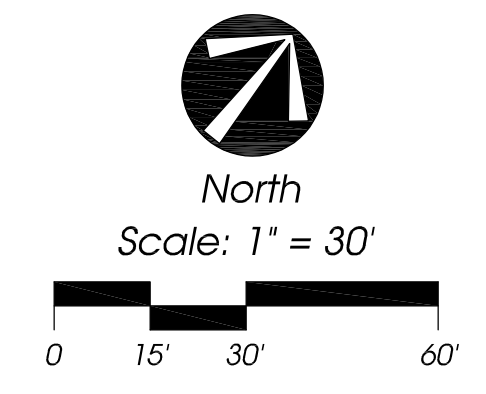

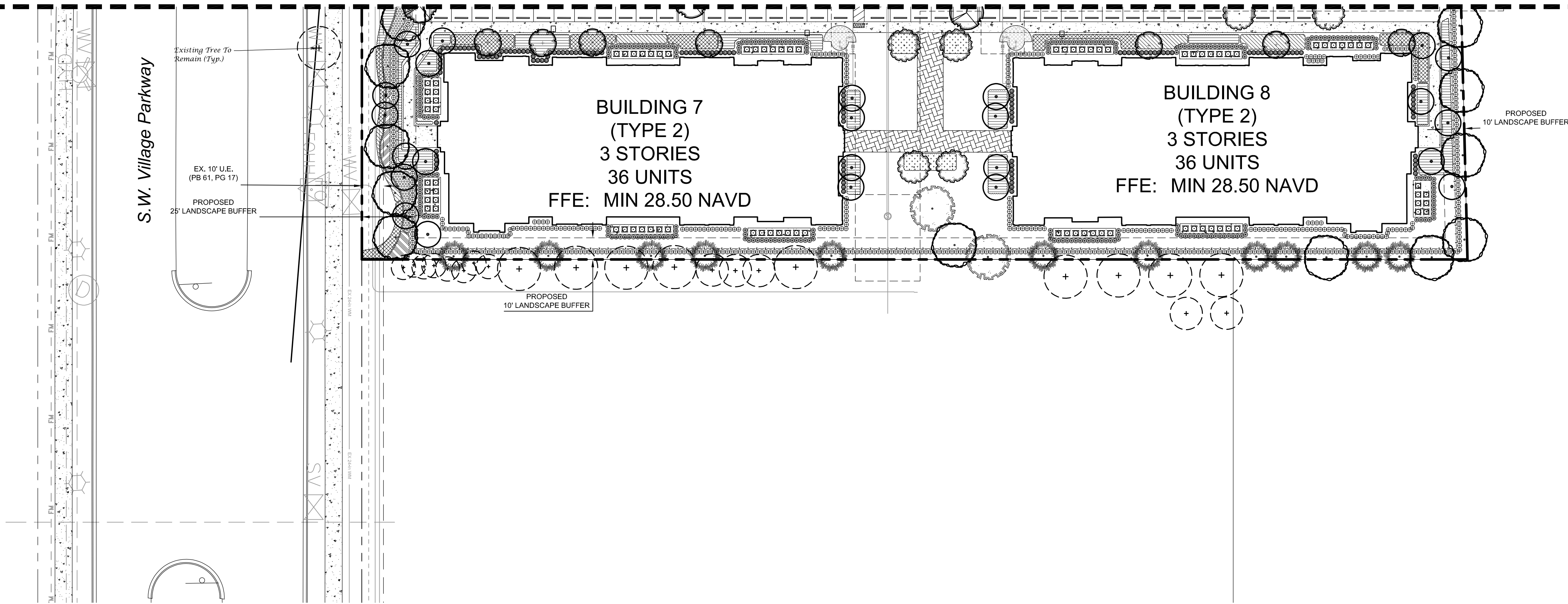

Port St. Lucie Utility Systems Department Notes

- 1. No landscaping shall be planted in a manner that would adversely affect utility easements. Landscaping shall be in compliance with Chapter 154 of the City of Port St. Lucie Code of Ordinances, PSLUSD technical specifications and policies.
- 2. All landscaping within City utility easements shall comply with PSLUSD technical specifications, policies, and codes.
- 3. All landscaping shall meet the latest PSLUSD Landscape Policy and shall not be placed in a manner that would create conflicts with the intended operation and maintenance of any existing utility.
- 4. Trees shall not be planted within ten (10) feet of any PSLUSD underground infrastructure.
- 5. No landscaping other than sod grasses shall be located within 5' of a PSLUSD appurtenance such as a water meter assembly, backflow device, fire hydrant or sewer cleanout, etc.

Port St. Lucie Engineering Department Notes

- 1. The landscape plans meet the City's sight distance and clear zone requirements from Section 158.204 of the Code for 10' requirements.

General Notes

- 1. No plant substitutions can be made without the City of Port St. Lucie's approval.
- 2. All required landscape improvements must be inspected and approved by the City of Port St. Lucie prior to the issuance of a Certificate of Occupancy.
- 3. Any existing landscaping, sod, or irrigation damaged or destroyed during the construction shall be replaced prior to the final inspection.
- 4. All prohibited, exotic and invasive species shall be removed from the entire site prior to issuance of certificate of occupancy.
- 5. Planting adjacent to fire hydrants is to have a minimum clear radius of 7.5' as required by the NFPA Uniform Fire Code Florida Edition 18.3.4.1 Hydrants. All fire hydrants and fire check valves shall have a minimum of 7.5' from the front and sides with 4' from the rear to all landscape material per the Florida Fire Prevention Code.

Conceptual
Design
Group, Inc.

Landscape Architecture - Site Planning

900 East Ocean Boulevard, Suite 130d
Stuart, Florida 34994
(772) 344-2340
LA: 0001635

St. Matilda

Tradition

City of Port St. Lucie, Florida

Jeffrey W. Smith, RLA
Florida Registration Number:
LA 0001635

Job No. 24-0601
Drawn By JWS
Submittal Dates 6-17-2024
10-8-2024
12-17-2024

Revision Dates
New Base 10-8-2024
City & Tradition Com.12-17-2024

These drawings are the property of the landscape architect and are not to be used for other projects except by written permission from the landscape architect. Report any discrepancies immediately to the landscape architect.

PSLUSD Project Number:
CL-4 4
Sheet of
City Project Numbers: P24-090

PSLUSD #11-962-00

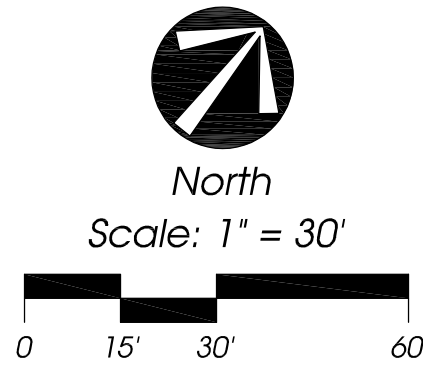

Conceptual Landscape Plan

Not For Construction