

Floresta Oval-about Public Art Project Port St. Lucie, FL

My goal is to create a truly monumental dolphin family sculpture for the Floresta Oval-about in the City of Port St. Lucie. ***Dolphin Harmony*** on the south end of the oval a family pod of dolphins will seemingly swim and jump in water. On the opposite end of the oval-about ***Cresting Wave***, will swirl a visually supportive wave sculpture.

Narrative

I will begin by crafting a visual representation of my sculpture installation on the Floresta Drive northbound approach to the oval-about. The imagery of a lively dolphin pod and underwater theme create a dynamic scene when approaching the Floresta Elementary School and neighborhood. At a height of 17 feet, the installation showcases bright lustrous steel complemented by radiant colored glass. This soaring and inspiring composition is strategically placed above the landscaping, offering a captivating view for pedestrians and motorists.

Polished curves of stainless steel arc upward toward 3 spirited dolphins. The ocean swells depicted in arched steel convey the underwater darting motion of these elegant sea creatures. The portrayal of a mother dolphin and calf with the protective father swimming above, enhances the emotional impact of the sculpture. Placing the undulating wave sculpture at the opposite end of the oval-about ensures a balanced and harmonious composition.

The playful and intelligent dolphins carry symbolic meaning related to the Floresta Elementary School mascot and local marine environment. Given that water symbolizes life and transformation, its presence is a fitting location for a house of worship and a funeral home as well. The sculpture installation contributes to the aesthetic value of the surroundings, gives symbolic depth and pause for reflection to its viewers.



1" thick cast slab glass

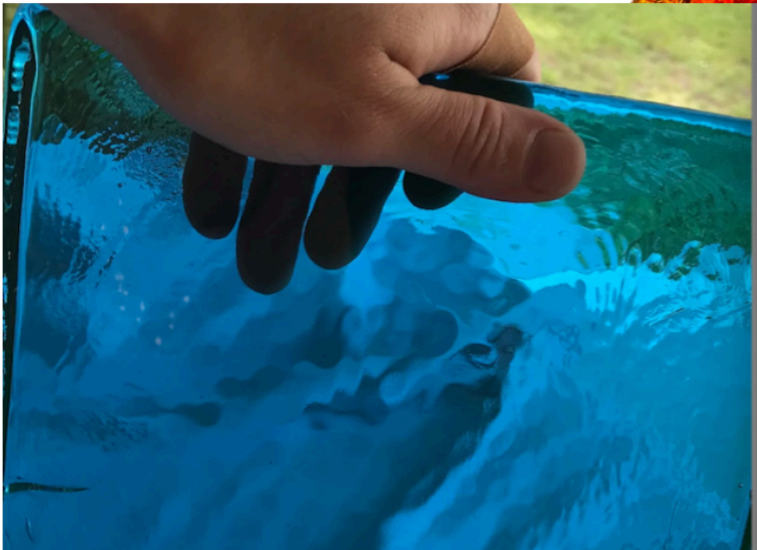
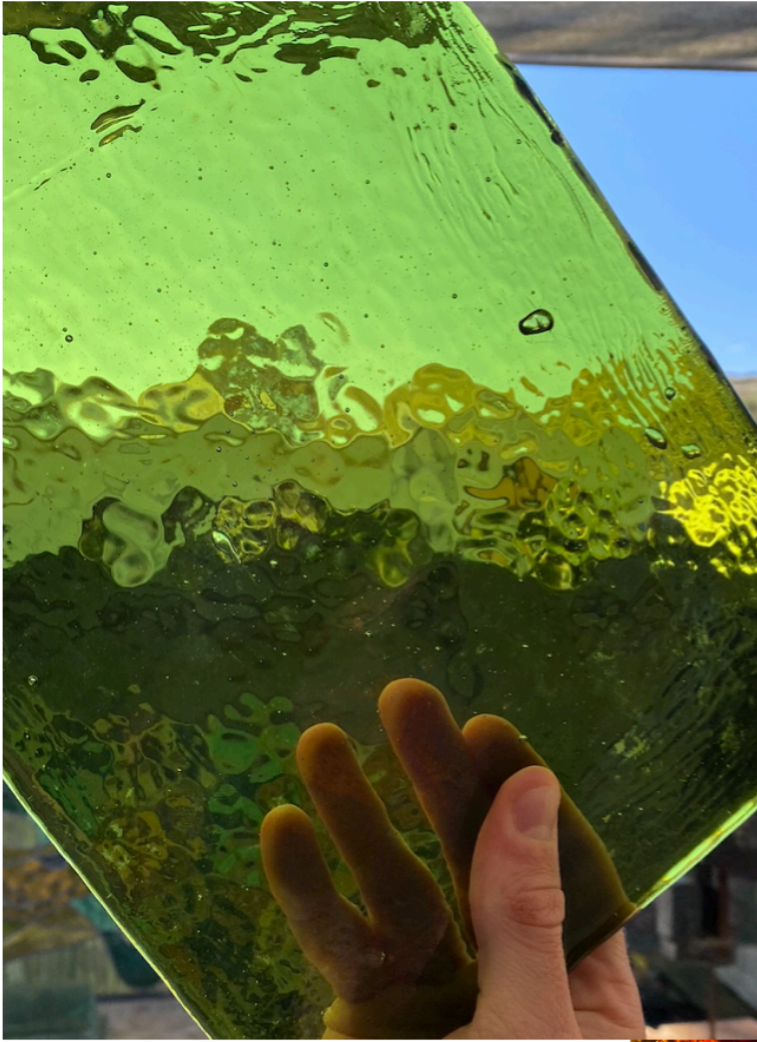



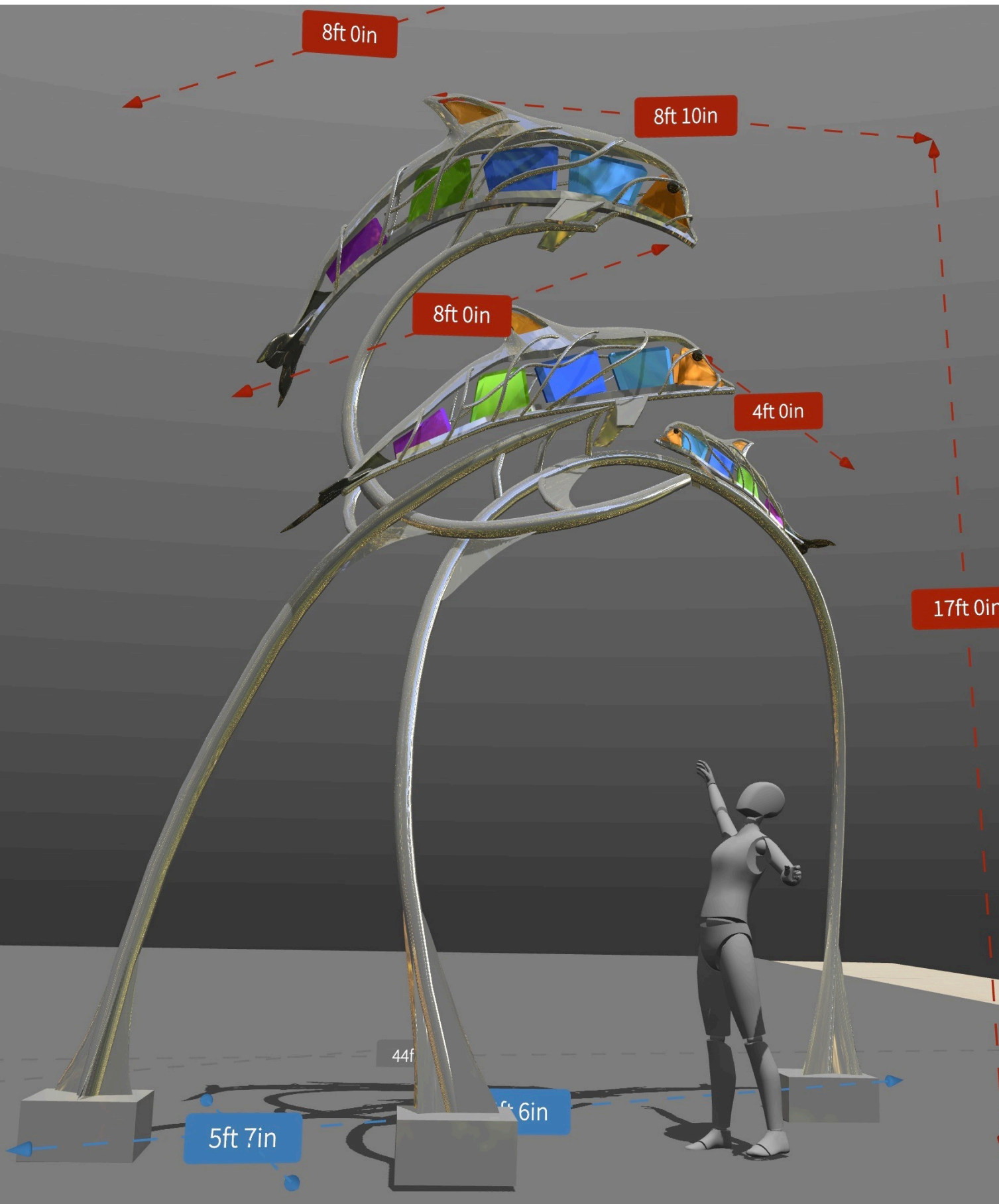



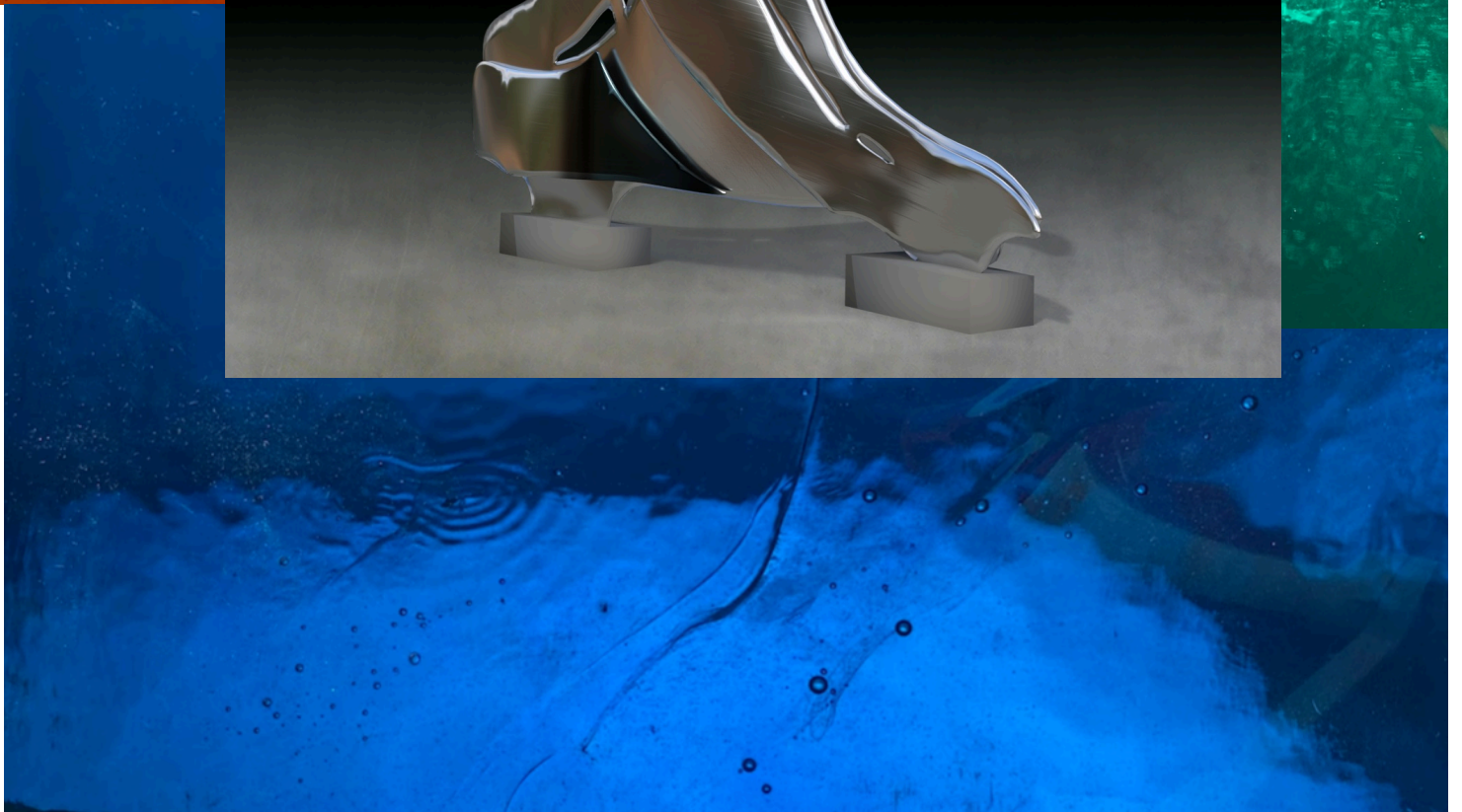



Material

Stainless steel plates, tubes and pipes - artist hand fabricated and machine bending.
One inch thick cast slab glass. Hurricane building code is 120 -130 mph.
Tests show 130 mph = 34 to 47 pounds per square foot of wind pressure. This glass is rated at above 50 pounds per square foot.
Five concrete below ground foundations at two feet high above ground level.
Three light fixtures on the north end and three fixtures on south end of the oval-about.
Lighting provided by sourcing electric power or possible solar panels - breaker panels with timers. Appropriate flood or spot lights.

Maintenance

High grade stainless steel and cast slab glass (non-fading) are two of the most enduring materials ever created. Occasional cleaning with soap and water as needed.

Timeline

February and March, Meet with landscape architect, project team entities to share concept drawings. Detailed underground infrastructure - dimensions - location - soil material make up for structural engineer - pipes and electrical system layout. Establish a time frame before ground works begin. Based on these findings detailed layout can be established. Structural engineer's drawings. Foundation drawings.

Refine renderings in specific dimensions, shop drawings, Cad programs for stainless steel water jet cutting and stainless pipe bending.

April and May, Start procuring material for structural heavy curved pipe construction, 5 concrete foundations, electrical system,

June and July Underground electric, concrete foundations stainless steel installed.

August and September, 3 dolphins constructed

October, Wave constructed

November, 4 sculptures Installed (3 dolphins and wave), lighting adjustments.

Completion Date

Jon Seeman Sculpture (full time resident)

12461 Palatka Drive

Venice, FL 34293

949.633.7502

Email - seemanjon@yahoo.com

Website - jonseeman.com

BUDGET		P.1 of 2
5,700	Travel 2 34 hrs. x 2 x 8 = 44 hrs. x 100/hr = 4,400 151 mi. x 2 x 8 = 2,400 mi. x .54 = 1,300	
7,700	Engineering 3 Dolphins x 1,400, pipe structural = 2,200 Foundations - 5 x 600 = 3,000 Wave = 2,500	
800	Insurance I carry a 2,000,000 policy in FL Extra installation policy = 800.	
1,500	Studio Space rental 10' x 20', 150. mo. x 10 mo.	
12,400	Design Fees Extra design hours in excess of 2,000 = 3,000 Working shop drawings = 1,100 P.H. CAD Programs = 2,400 Programmer = 800. Structural drawings for engineer = 1,600 3D modeling = 3,500	
2,200	Sub Consultant = 1,700 Pipe Bending Layout and testing 500.	
3,600	Lighting Port St Lucie contractor + installation Elect. boxes, power source, fixtures, permits	
12,200	Concrete foundations - 5 Sub contract - Footings, Forms, rebar concrete pump, J bolts as per structural drawings 3 x 2,700, 2 x 1,800 = 11,700 misc. 500.	

Fabrication		P.2 of 2
74,000	Dolphins - cut, bend forms by roller, clamp, heat, pressure. Tig weld assembly joints, bracing gussets, Reinforced glass support channels, cross bracing, flanges for assembly. Glass embedded in supports. Father dolphin 30,000 extreme arc Mother " 26,000 Baby " 9,000	
24,500	Materials 4 - 1/4" Wall x 4" d x 20' 304L 1,400 x 4 = 5,600 Form bending 3 long 9,000 - 11,000 6 - 1/4" wall x 3" d x 10' 304L x 160 = 960. 3/8" plate 2 - 4' x 8' + wave 3 - 4' x 10' = 3,000 Cast Glass 8' x 12" x 23 pcs. w cutting, casting, shipping 170. each = 3,900 incl. Wave	
4,000	Structural engineer changes - boosting material and fab. costs 4,000	
33,200	Installation and Assembly delivery 3,800 - Pipe, 3 Dolphins, wave Crane 2 days 2,000, boom 11' ft 4 days 2,500 gusset plates + dolphin weld 3,700, main assembly 16,000, note 1 5 x 200 = 1,000, final edge softening, sand, cleaning, equip. return 4,000	
191,800	TOTAL	8,200 Buffer

Dimensions of Key Elements

Overall size **Dolphin Harmony** sculpture - 17' high x 15' wide x 9' deep

Dolphins to life size scale:

Father at top 8' 5" long

Mother in the middle 8' long

Calf at bottom 4' long

Cresting Wave sculpture - 7' high x 8'8" width x 2' depth

Jon Seeman Sculpture

① LIGHTING 9'-17" 3 LIGHT'S SPOTS
② " 2'-7" " " FLOODS

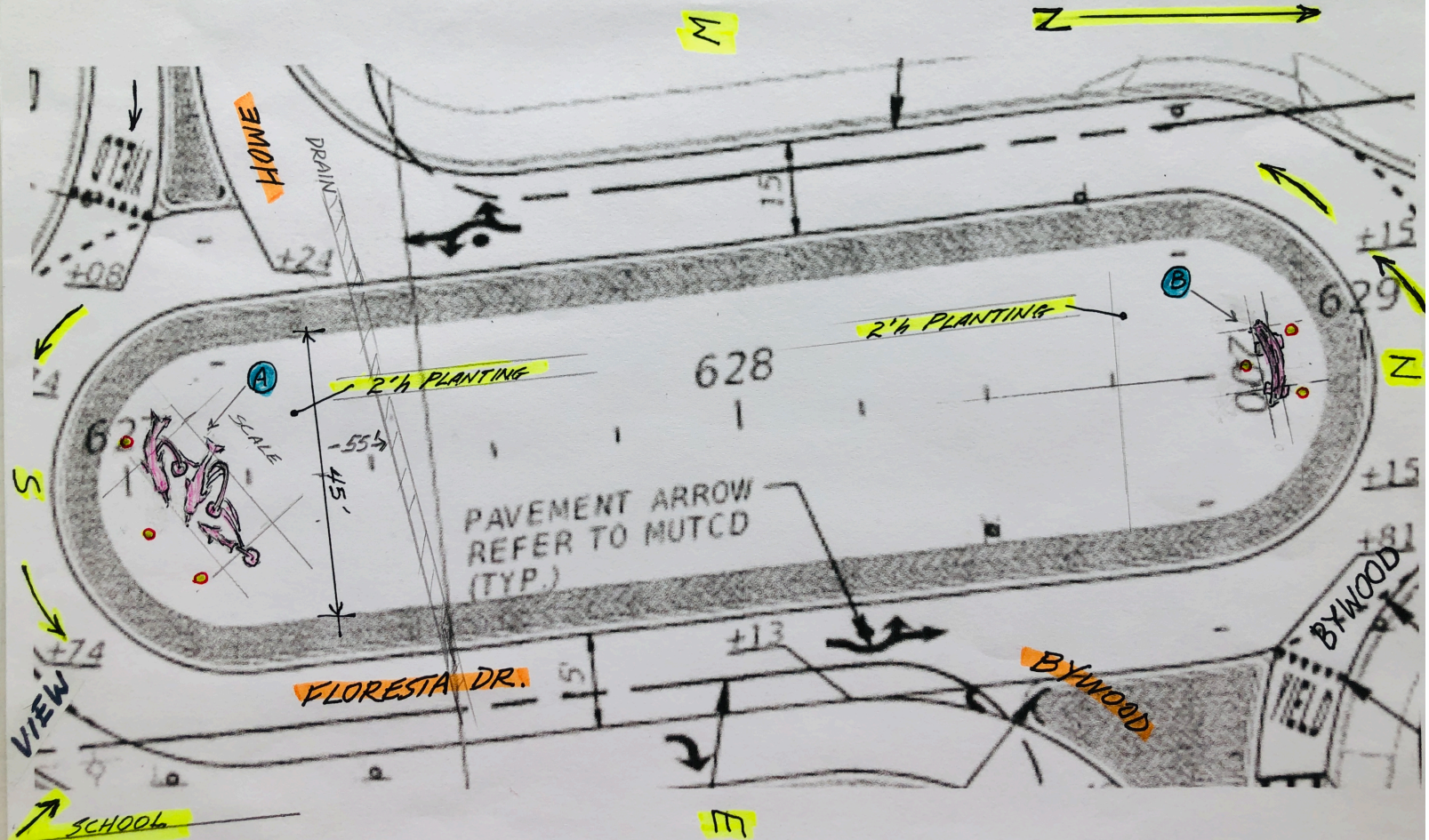

DOLPHINS
A 17' h x 15' w x 9' d

WAVE
B 6' 8" h x 8' 8" w x 2' d

