

# Discovery Way @ Riverland Parcel C

PRELIMINARY AND FINAL SUBDIVISION PLAT  
APPLICATION WITH CONSTRUCTION PLANS

(P21-014)

City Council Meeting April 26, 2021

INCORPORATED

[CityofPSL.com](http://CityofPSL.com)



# Subject property

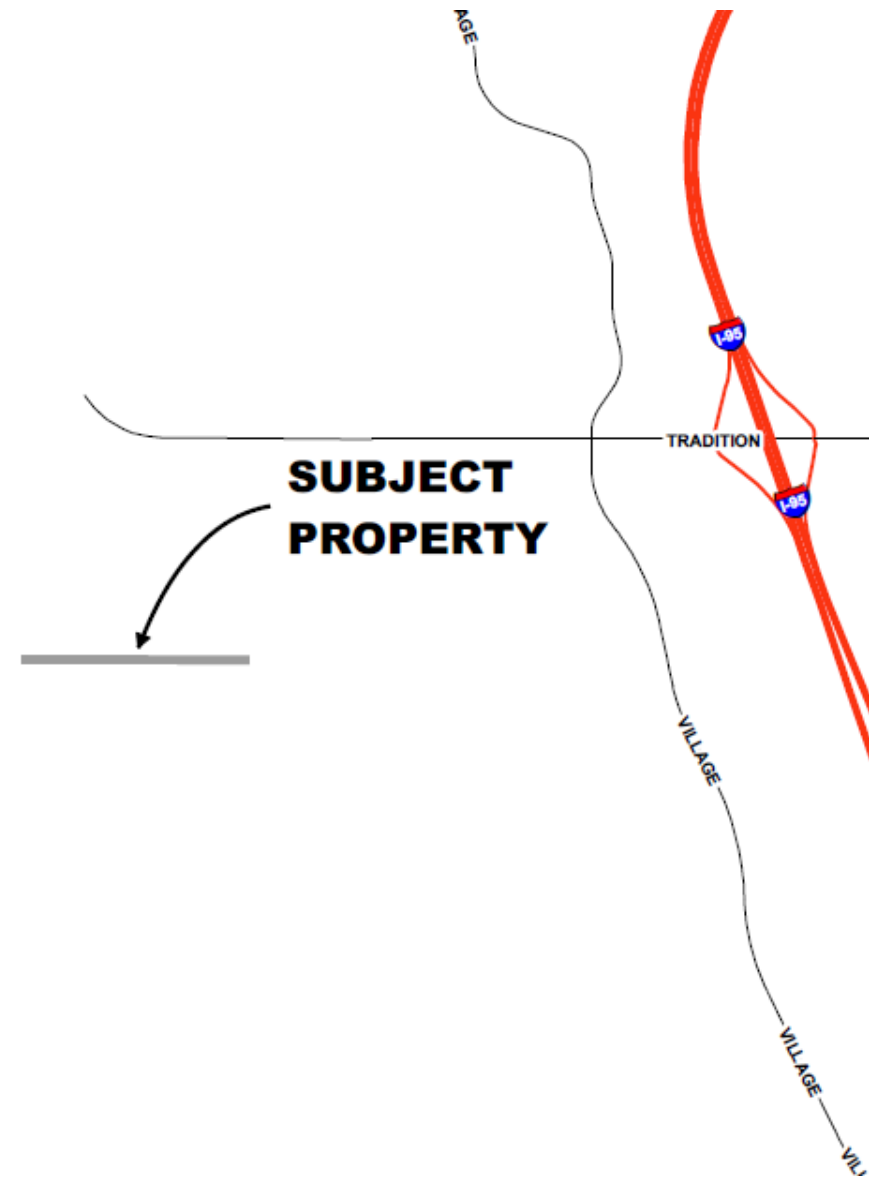

# Aerial



# Land Use

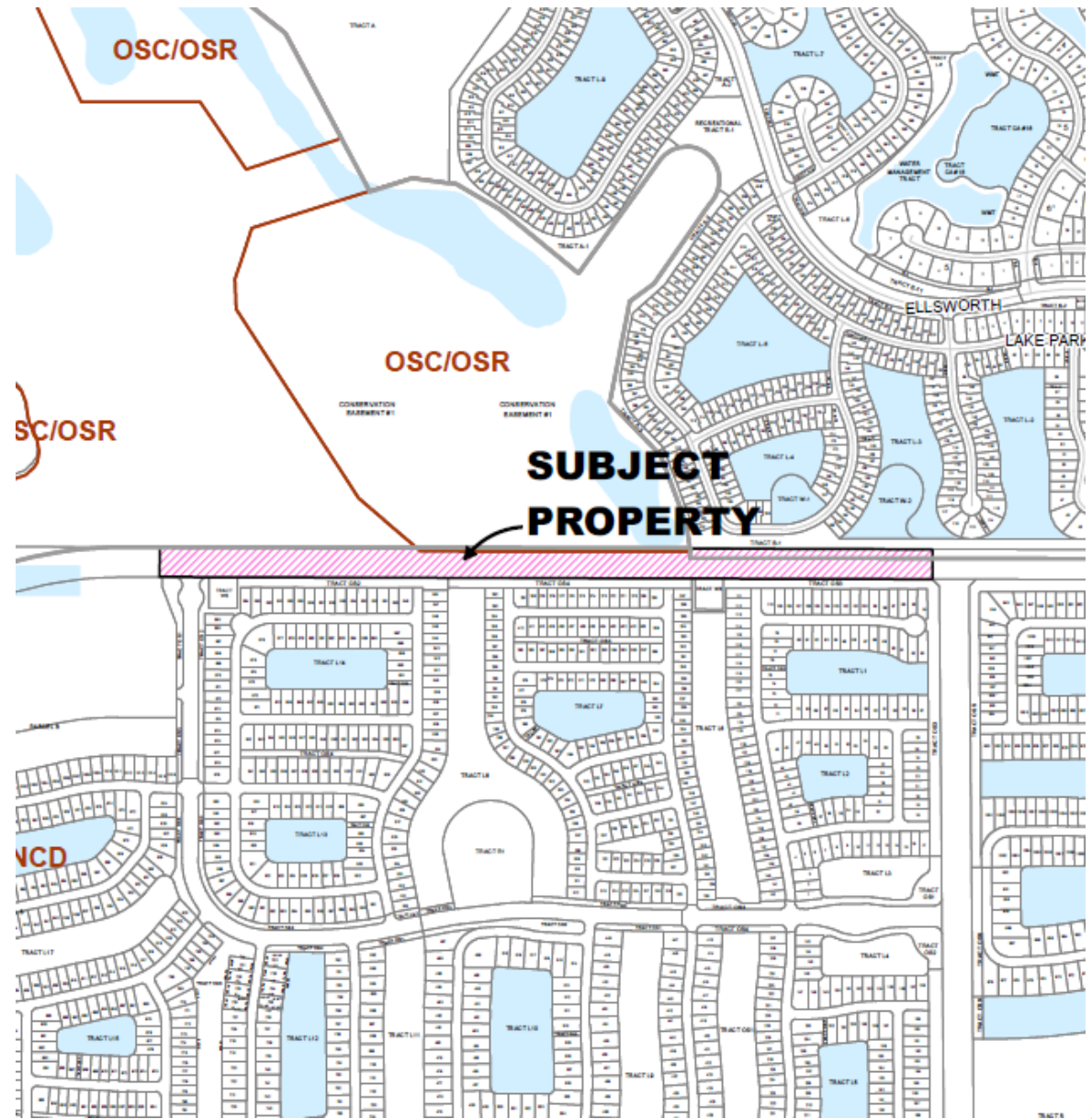





S.R. 609 (RANGE LINE RD)

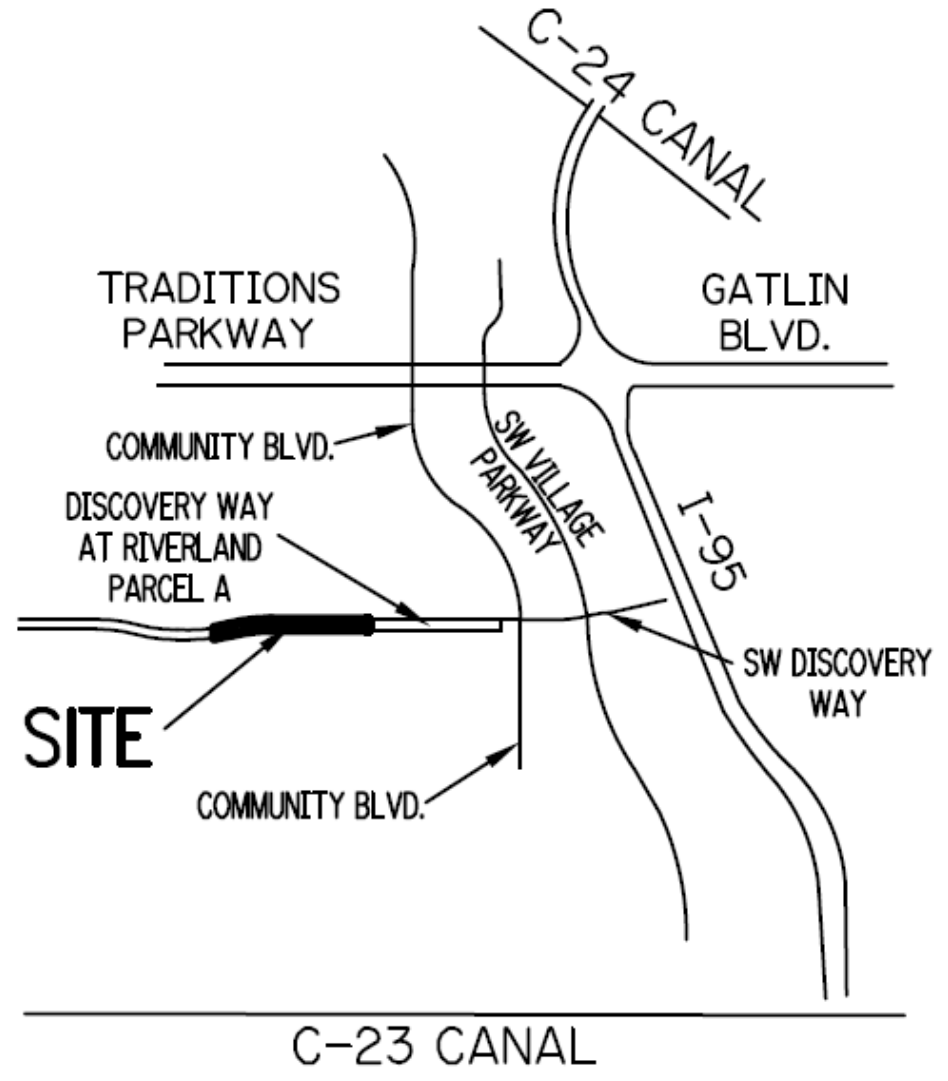

# Concurrency Review

The project has been reviewed for compliance with Riverland/Kennedy Development of Regional Impact development order regarding provision of adequate public facilities.

The Public Works Department found the transportation elements of the project to be in compliance with the adopted level of service and requirements of Chapter 156 of City Code, Public Works Policy 19-01pwd and the latest Development Order for the referenced project.



# Recommendation

Site Plan Review Committee recommended approval at their meeting of February 10, 2021.

