

SECTION: 94813000
COUNTY: ST. LUCIE
PROJECT: 444336-1-52-01
STATE ROAD: SR 9

**AMENDMENT NUMBER THREE (3) TO
FLORIDA DEPARTMENT OF TRANSPORTATION, DISTRICT FOUR (4)
INCLUSIVE LANDSCAPE MAINTENANCE MEMORANDUM OF AGREEMENT**

THIS AMENDMENT Number Three (3) to the Agreement dated November 28, 2017, was made and entered into this _____ day of _____ 20____ by and between the **FLORIDA DEPARTMENT OF TRANSPORTATION**, a component agency of the State of Florida, hereinafter called the **DEPARTMENT**, and the **CITY OF PORT ST. LUCIE**, a municipal corporation of the State of Florida, hereinafter called the **AGENCY**.

W I T N E S S E T H

WHEREAS, the parties entered into the Inclusive Landscape Maintenance Memorandum of Agreement dated November 28, 2017 (Original Agreement), and as amended, for the purpose of the **AGENCY** maintaining landscape improvements on various roads within the Agency limits, including State Road 9 (I-95); and,

WHEREAS, the **DEPARTMENT** and the **AGENCY** have agreed to add additional landscape on State Road 9 (I-95) at St. Lucie West Boulevard, in accordance with the above referenced Original Agreement; and,

WHEREAS, the **AGENCY** by Resolution No. _____ dated _____, attached hereto as **Exhibit "D"** and by this reference made a part hereof, desires to enter into this Agreement and authorized its officers to do so.

NOW THEREFORE, for and in consideration of mutual benefits that flow each to the other, the parties covenant and agree as follows:

1. Pursuant to paragraph 6, page 6 of the Original Agreement, the **DEPARTMENT** may construct additional landscape improvements or modify an improvement as shown in **Exhibit "A"**, in accordance with the plans attached as **Exhibit "B"**.
2. The **DEPARTMENT** agrees to enter into a contract for the installation of the landscape improvements with an estimated amount of **\$27,435.00**, as referenced in **Exhibit "C"**. These improvements may be reduced or eliminated at the sole discretion of the **DEPARTMENT** or due to budgetary constraints of the **DEPARTMENT**.
3. The **AGENCY** agrees to maintain the additional landscape improvements, installed by the **DEPARTMENT**, in accordance with Part I of Exhibit "E" Maintenance Plan of the Original Agreement, and as follows:

Part II. Specific Project Site Maintenance Requirements and Recommendations:

- a) The St. Lucie West medians include shrub and ground cover plantings, as well as canopy and flowering trees, and frangible, accent, and large palms. These medians also include irrigation.
- b) The irrigation system will cover all plantings within the medians east of I-95. The proposed irrigation will be a modification of the existing system on St. Lucie West. The controller and water source are existing and fall outside of the project limits to the east on St Lucie West Blvd.
- c) All trees are intended to be maintained at a mature height and spread and do not need pruning to control their overall height. The only pruning required will be as described above for safety, sightline visibility, to remove dead or damaged branches, to remove sucker growth, or to improve structure.
- d) To maintain the intended appearance of all palms, apply the latest fertilizer recommended by the University of Florida IFAS Extension per the manufacturer's specifications ('palm special' fertilizer blend with an 8-2-12 +4 Mg). This may be used for shrubs or turf grasses, however, do not use general-purpose fertilizers within 40' of any palm species.
- e) To maintain the intended appearance of all shrubs or turf grass, apply the latest fertilizer recommended by the University of Florida IFAS Extension per the manufacturer's specifications and in accordance with the City of Port Saint Lucie fertilizer restrictions.
- f) Do not remove fronds from self-cleaning palms, unless damaged. Palms with persistent fronds shall only have dead fronds removed, do not remove any green fronds. If it is deemed necessary to prune a palm's fronds, no fronds shall be trimmed above 3 o'clock and 9 o'clock on the horizontal plane.
- g) Groundcover and shrub horizontal growth shall be maintained to prevent foliage from growing beyond the limits of the planting areas shown on the plans. Maintain a 12" setback from the edge of the curb, pavement, sidewalk, and other hardscape improvements as shown in the plans. Inspect groundcovers and shrubs on a monthly basis to maintain full ground coverage.
- h) Control the overall height of all shrubs in accordance with the list provided below. Native ornamental grasses should never be pruned to control their overall height and instead will be allowed to grow to their Natural Form (NF). Ornamental grasses can be cut back to within 6" from grade as needed to limit biomass and regenerate them. This is typically required every one to two years at most.

Maintain the vertical height of all shrubs in accordance with the below list:

- Muhlenbergia capillaris/Muhly Grass: NF (about 3ft, full to ground)
- Ilex vomitoria / Dwarf Holly: maintain at 3ft high
- Hamelia patens / Fire Bush: maintain at 4.5ft high
- Ruellia / Mexican Petunia: NF, do not trim
- Schefflera arboricola "Trinette" / Variegated Schefflera: maintain at 3.5ft high

- i) Evaluate plant material on a monthly basis for pests, diseases, drought stress, or general decline. If required, follow the integrated pest management program established by the Agency to ensure healthy plants.
 - j) Inspect the irrigation system performance on a quarterly basis to ensure the system is providing 100% coverage, does not have sections of low pressure, heads and valves are clean and clear of debris and any damaged irrigation components (i.e., spray nozzles, spray heads, valve boxes, etc.) are repaired or replaced.
4. The **DEPARTMENT** and **AGENCY** agree to modify the Original Agreement by adding the following section:

DEPARTMENT ACCESS TO FACILITIES

The DEPARTMENT will periodically need access to various features within the limits of this Agreement. Upon request of the DEPARTMENT, the AGENCY will have 14 calendar days to provide access to the items noted by the DEPARTMENT. This may require temporary or permanent removal of improvements such as hardscape, landscape or other items conflicting with the items to which the Department needs access.

Should the Agency fail to remove or relocate items as requested, the Department may:

- a. Remove conflicting improvements or any portion thereof.
- b. Restore the area with any material meeting Department standards.
- c. Restore the improvements at the request and funding of the AGENCY.

Except as modified by this Amendment, all terms and conditions of the Original Agreement and all Amendments thereto shall remain in full force and effect.

LIST OF EXHIBITS:

- Exhibit A: Project Location and Maintenance Boundaries
- Exhibit B: Landscape Improvement Plans
- Exhibit C: Approximate Cost for Landscape Improvements
- Exhibit D: Resolution

In Witness whereof, the parties hereto have executed with this Amendment effective the day and year written and approved.

CITY OF PORT ST. LUCIE

By: _____
Chairperson / Mayor / Manager

Date: _____

Attest: _____
City Clerk

(SEAL)

Legal Approval: _____

**STATE OF FLORIDA
DEPARTMENT OF TRANSPORTATION**

By: _____
Transportation Development Director

Date: _____

Attest: _____
Executive Secretary

(SEAL)

Legal Review: _____
Office of the District General Counsel

SECTION: 94813000
COUNTY: ST. LUCIE
PROJECT: 444336-1-52-01
STATE ROAD: SR 9

EXHIBIT A

PROJECT LOCATION AND MAINTENANCE BOUNDARIES

I. LANDSCAPE PROJECT LOCATION:

State Road 9 (I-95) at St. Lucie West Blvd Interchange

II. LIMITS OF MAINTENANCE FOR AMENDMENT #3:

Section 94813000 - St. Lucie West Blvd
Medians from East of I-95 to west of Peacock Blvd (M.P. 0.312 to M.P. 0.695)

III. LANDSCAPE IMPROVEMENTS MAINTENANCE RESPONSIBILITIES MAP:

See Attached Map

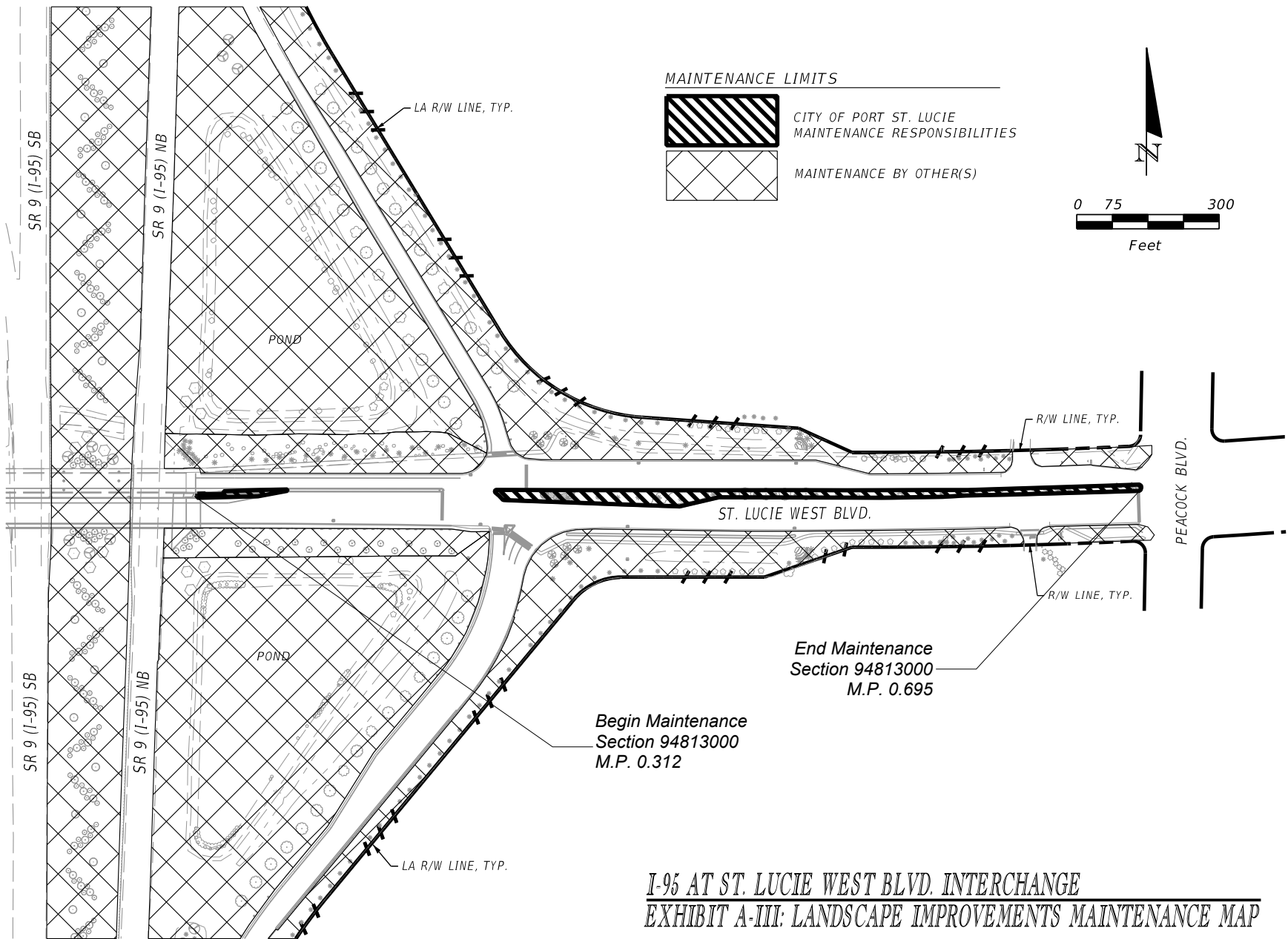

MAINTENANCE LIMITS

 CITY OF PORT ST. LUCIE
MAINTENANCE RESPONSIBILITIES

 MAINTENANCE BY OTHER(S)

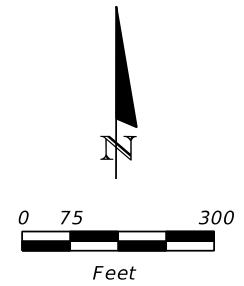

End Maintenance
Section 94813000
M.P. 0.695

Begin Maintenance
Section 94813000
M.P. 0.312

I-95 AT ST. LUCIE WEST BLVD. INTERCHANGE
EXHIBIT A-III: LANDSCAPE IMPROVEMENTS MAINTENANCE MAP

FPID NO. 444336-1-52-01

SECTION: 94813000
COUNTY: ST. LUCIE
PROJECT: 444336-1-52-01
STATE ROAD: SR 9

EXHIBIT B

LANDSCAPE IMPROVEMENT PLANS

The DEPARTMENT agrees to install the landscape improvements in accordance with the plans and specifications attached hereto and incorporated herein.

Please see attached plans prepared by: Cotleur & Hearing
Robert Cotleur, RLA

Date: 08/16/2024

Sheets: 1-5, 11-15, DET1

CONTRACT PLANS COMPONENTS

LANDSCAPE

**STATE OF FLORIDA
DEPARTMENT OF TRANSPORTATION**

LANDSCAPE PLANS

FINANCIAL PROJECT ID 444336-1-52-01

ST. LUCIE COUNTY (94001)

STATE ROAD NO. 9 (I-95)
LANDSCAPING AT ST. LUCIE WEST BLVD

INDEX OF LANDSCAPE PLANS

| SHEET NO. | SHEET DESCRIPTION |
|----------------|---|
| LD-1 | KEY SHEET |
| LD-2 | SIGNATURE SHEET |
| LD-3 | GENERAL NOTES |
| LD-4 | LEGEND |
| LD-5 | PROJECT LAYOUT |
| LD-6 TO LD-12 | PLANTING PLAN |
| LD-13 | PLANTING DETAILS |
| LD-14 | IRRIGATION PLAN |
| LD-15 | IRRIGATION DETAILS |
| LD-16 | SELECTIVE CLEARING AND GRUBBING DETAILS |
| LD-17 TO LD-18 | TEMPORARY TRAFFIC CONTROL PLAN |
| DET-1 | CITY OF PSL - IRRIGATION INSTALLATION DETAILS |

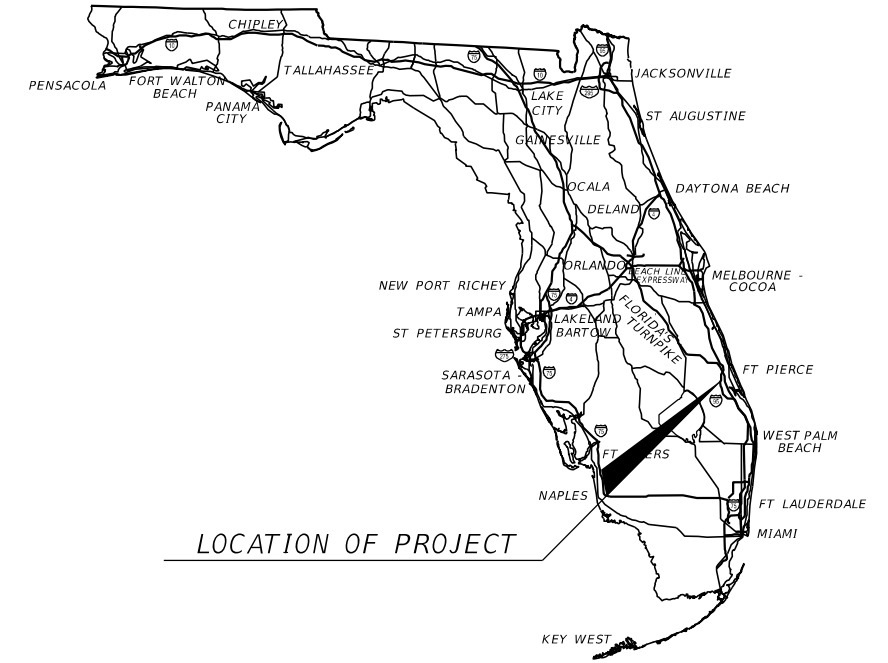

LOCATION OF PROJECT

| | |
|-----------------------|---|
| PROJECT LOCATION URL: | https://tinyurl.com/444336 |
| PROJECT LIMITS: | BEGIN MP 7.3 - END MP 8.2 (94001000) BEGIN MP 0.0 - END MP 0.52 (94813000) |
| EXCEPTIONS: | NONE |
| BRIDGE LIMITS: | BR#940233 MP 7.460 - MP 7.472 BR#940133 MP 7.472 - MP 7.484 |
| RAILROAD CROSSING: | NONE |

GOVERNING STANDARD PLANS:

Florida Department of Transportation, FY2024-25 Standard Plans for Road and Bridge Construction and applicable Interim Revisions (IRs).

Standard Plans for Road Construction and associated IRs are available at the following website: <http://www.fdot.gov/design/standardplans>

APPLICABLE IRs: N/A

GOVERNING STANDARD SPECIFICATIONS:

Florida Department of Transportation, FY2024-25 Standard Specifications for Road and Bridge Construction at the following website: <http://www.fdot.gov/programmanagement/Implemented/SpecBooks>

**PRODUCTION SUBMITTAL
SEPTEMBER 2024**

LANDSCAPE PLANS

PROFESSIONAL OF RECORD:

ROBERT J. COTLEUR, R.L.A.
R.L.A. NO.: 1067
COTLEUR & HEARING, INC.
1934 Commerce Lane Suite 1
Jupiter, Florida 33458
561-747-6336 Fax 561-747-1377
Vendor No. F471877271001
CONTRACT No. CAH36

FDOT PROJECT MANAGER:

JAMIE POLIDORA, P.E.

| CONSTRUCTION CONTRACT NO. | FISCAL YEAR | SHEET NO. |
|---------------------------|-------------|-----------|
| E4X58 | 25 | LD-1 |

THE OFFICIAL RECORD OF THIS SHEET IS THE ELECTRONIC FILE DIGITALLY SIGNED AND SEALED UNDER RULE 61G10-11.001, F.A.C.

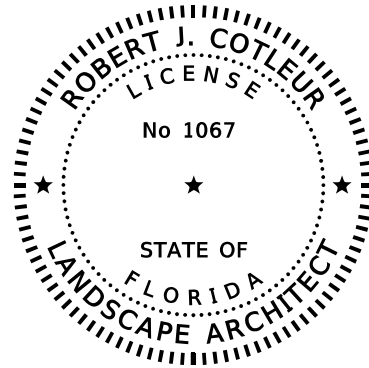

THIS ITEM HAS BEEN DIGITALLY
SIGNED AND SEALED BY

ON THE DATE ADJACENT TO THE SEAL

PRINTED COPIES OF THIS DOCUMENT ARE
NOT CONSIDERED SIGNED AND SEALED
AND THE SIGNATURE MUST BE VERIFIED
ON ANY ELECTRONIC COPIES.

COTLEUR & HEARING, INC.
1934 COMMERCE LANE, SUITE 1
JUPITER, FL 33458
ROBERT J. COTLEUR, R.L.A. NO. 1067

THE ABOVE NAMED PROFESSIONAL LANDSCAPE ARCHITECT SHALL BE RESPONSIBLE
FOR THE FOLLOWING SHEETS IN ACCORDANCE WITH RULE 61G10-11.011, F.A.C.

| <u>SHEET NO.</u> | <u>SHEET DESCRIPTION</u> |
|------------------|---|
| LD-1 | KEY SHEET |
| LD-2 | SIGNATURE SHEET |
| LD-3 | GENERAL NOTES |
| LD-4 | LEGEND |
| LD-5 | PROJECT LAYOUT |
| LD-6 TO LD-12 | PLANTING PLAN |
| LD-13 | PLANTING DETAILS |
| LD-14 | IRRIGATION PLAN |
| LD-15 | IRRIGATION DETAILS |
| LD-16 | SELECTIVE CLEARING AND GRUBBING DETAILS |
| DET-1 | CITY OF PSL - IRRIGATION INSTALLATION DETAILS |

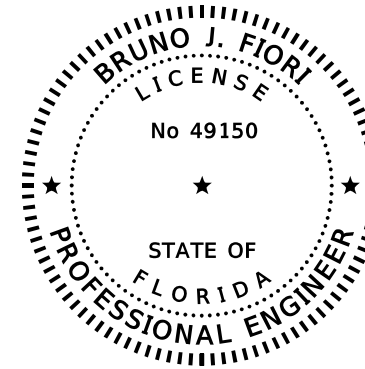

THIS ITEM HAS BEEN DIGITALLY
SIGNED AND SEALED BY

ON THE DATE ADJACENT TO THE SEAL

PRINTED COPIES OF THIS DOCUMENT ARE
NOT CONSIDERED SIGNED AND SEALED
AND THE SIGNATURE MUST BE VERIFIED
ON ANY ELECTRONIC COPIES.

AECOM TECHNICAL SERVICES, INC.
7650 WEST COURTNEY CAMPBELL CAUSEWAY
TAMPA, FL 33607
BRUNO J. FIORI, P.E. NO. 49150

THE ABOVE NAMED PROFESSIONAL ENGINEER SHALL BE RESPONSIBLE FOR THE
FOLLOWING SHEETS IN ACCORDANCE WITH RULE 61G15-23.004, F.A.C.

| <u>SHEET NO.</u> | <u>SHEET DESCRIPTION</u> |
|------------------|--------------------------------|
| LD-2 | SIGNATURE SHEET |
| LD-17 TO LD-18 | TEMPORARY TRAFFIC CONTROL PLAN |

| REVISIONS | | | | Landscape Architect Of Record: Robert J. Cotleur, RLA: #1067 COTLEUR & HEARING, INC. 1934 Commerce Lane Suite 1 Jupiter, Florida 33458 561-747-6336 Fax 561-747-1377 | STATE OF FLORIDA DEPARTMENT OF TRANSPORTATION | | | SHEET NO. LD-2 |
|-----------|-------------|------|-------------|--|--|-----------|----------------------|--------------------------|
| DATE | DESCRIPTION | DATE | DESCRIPTION | | ROAD NO. | COUNTY | FINANCIAL PROJECT ID | |
| | | | | | SR 9 | ST. LUCIE | 444336-1-52-01 | |

SIGNATURE SHEET

GENERAL PROJECT NOTES

1. COORDINATE WITH THE FDOT TREASURE COAST OPERATIONS AND THE DEPARTMENT'S ASSET MAINTENANCE CONTRACTOR (JORGENSEN CONTRACT SERVICES) AT LEAST TWO WEEKS PRIOR TO BEGINNING CONSTRUCTION IN ORDER TO DOCUMENT THE EXISTING SITE CONDITIONS AND TO ALLOW FOR ANY REQUIRED REMEDIAL WORK TO BE COMPLETED PRIOR TO CONSTRUCTION HANDOFF. CONTACT INFORMATION FOR TREASURE COAST OPERATIONS AND THE ASSET MAINTENANCE CONTRACTOR PROVIDED BELOW:

COMPANY: TREASURE COAST OPERATIONS CENTER
 CONTACT: KRIS KEHRES, P.E.
 EMAIL: KRISTOPHER.KEHRES@DOT.STATE.FL.US
 PHONE: 772-429-4885

2. MAINTENANCE RESPONSIBILITIES WILL BE ASSUMED BY THE CITY OF PORT ST. LUCIE FOLLOWING THE COMPLETION OF THIS STAND-ALONE LANDSCAPE PROJECT. NOTIFY THE CITY TO ALLOW CITY REPRESENTATIVE ATTENDANCE AT ALL ESTABLISHMENT PERIOD INSPECTIONS AND FOR MAINTENANCE HANDOFF AT THE FINAL PROJECT ACCEPTANCE.

CONTACT: JOHN DUNTON (PUBLIC WORKS DIRECTOR)
 EMAIL: JDUNTON@CITYOFPSL.COM
 PHONE: 772-344-4035

3. BEFORE THE PRECONSTRUCTION MEETING, SUBMIT:
 - a. UNIT COST BREAKDOWN FOR EACH ITEM OF WORK (SCHEDULE OF VALUES)
 - b. WEED CONTROL PRODUCT INFORMATION AND APPLICATION PROCEDURES
 - c. LANDSCAPE SOIL PRODUCT INFORMATION
 - d. WATERING APPLICATION PROCEDURES
 - e. FERTILIZER & PRE-EMERGENT HERBICIDE PRODUCT INFORMATION AND APPLICATION PROCEDURES
 - f. MULCH PRODUCT INFORMATION
 - g. STORM WATER POLLUTION PREVENTION PLAN
4. SIGHT TRIANGLES SHOWN ON THESE PLANS ARE BASED ON FLORIDA DESIGN MANUAL (FDM) STANDARDS FOR A 4-LANE DIVIDED, 40 MPH DESIGN SPEED INTERSECTION. THE INTERSECTION SIGHT DISTANCE FOR MEDIAN WIDTHS OF 22' OR LESS IS 525'. THE INTERSECTION SIGHT DISTANCE FOR MEDIAN WIDTHS OF 25' TO 64' IS 470'.
5. THE LOCATIONS OF THE UTILITIES SHOWN IN THE PLANS ARE BASED ON LIMITED INVESTIGATION TECHNIQUES AND SHOULD BE CONSIDERED APPROXIMATE ONLY. VERIFY ALL UTILITIES PRIOR TO COMMENCING WORK. CONTACT SUNSHINE 811 A MINIMUM OF 72 HOURS PRIOR TO ANY EXCAVATION WORK. REFER TO THE UTILITY PROVIDER LIST.

| | | |
|--|------------------|-------------------------|
| 6. UTILITY/AGENCY OWNERS: | | |
| COMPANY | CONTACT | TELEPHONE NUMBER |
| ADVANCED CABLE - BLUE STREAM | CHRISTIAN MORGAN | (772) 353-0122 |
| AT&T | MARK LINSOTT | (321) 419-9875 |
| CITY OF PORT ST LUCIE LIGHTING/SIGNALS | PAUL JOHNSON | (772) 871-5182 |
| COMCAST - PALM BEACH | DANIEL TIBURCIO | (561) 815-6659 |
| CROWN CASTLE FIBER | CHRIS PERKINS | (813) 947-6009 |
| FLORIDA CITY GAS COMPANY | MICHAEL TERMINI | (321) 288-1126 |
| FLORIDA POWER & LIGHT - TRANSMISSION | THOMAS COLUCCI | (315) 219-7458 |
| RESERVE COMMUNITY DEVELOPMENT | TINA PERKINS | (772) 468-4604 |
| ST. LUCIE WEST SERVICES DISTRICT | RANDY GARREN | (772) 340-0220 EXT. 117 |

7. LANDSCAPE MAINTENANCE INCLUDING FERTILIZATION, WEED CONTROL, MULCHING, AND PEST MANAGEMENT WILL INCLUDE ALL PROPOSED VEGETATION AS WELL AS ALL EXISTING CANOPY TREES AND PALMS. THE MAINTENANCE OF EXISTING TREES AND PALMS WILL NOT INCLUDE HAND WATERING OR WARRANTY REPLACEMENT. IF ANY EXISTING TREES OR PALMS DIE WITHIN THE ESTABLISHMENT PERIOD THEY WILL BE REMOVED AND THE SURROUNDING AREA WILL BE RESTORED WITH SOD OR MULCH AS APPLICABLE BY THE CONTRACTOR.
8. A STORMWATER POLLUTION PREVENTION PLAN (SWPPP) FOR EROSION AND SEDIMENT CONTROL IS TO BE PREPARED AND SUBMITTED TO THE DEPARTMENT BEFORE THE COMMENCEMENT OF CONSTRUCTION PER STANDARD SPECIFICATIONS FOR ROAD AND BRIDGE CONSTRUCTION, SECTION 104, 'PREVENTION, CONTROL, AND ABATEMENT OF EROSION AND WATER POLLUTION'. DEVELOP AN EROSION CONTROL PLAN THAT PROVIDES A DETAILED DESCRIPTION OF ALL EROSION AND SEDIMENT CONTROLS, BEST MANAGEMENT PRACTICES, AND MEASURES THAT WILL BE IMPLEMENTED AT THE CONSTRUCTION SITE FOR EACH SOIL DISTURBING ACTIVITY. PROVIDE TIMEFRAMES IN WHICH THE CONTROLS WILL BE IMPLEMENTED, MAINTAINED, AND REMOVED. DESCRIBE THE PROPOSED STRUCTURAL PRACTICES TO CONTROL OR TRAP SEDIMENT AND OTHERWISE PREVENT THE DISCHARGE OF POLLUTANTS FROM EXPOSED AREAS OF THE SITE. SEDIMENT CONTROLS SHALL BE IN PLACE BEFORE DISTURBING THE SOIL UPSTREAM OF THE CONTROL. THE BEST MANAGEMENT PRACTICES SHALL INCLUDE BUT ARE NOT LIMITED TO THE FOLLOWING.
 - a. SEDIMENT BARRIERS.
 - b. INLET PROTECTION.
 - c. SEDIMENT CONTAINMENT SYSTEM: THE EXISTING SWALES AND STORMWATER PONDS SHALL BE PROTECTED WITH TURBIDITY MEASURES AS REQUIRED IN SPECIFICATION SECTION 104.
 - d. ENSURE PROTECTION OF POTENTIAL WOOD STORK FORAGING HABITAT.

LANDSCAPE PROJECT NOTES:

4. PLANT INSTALLATION AND ESTABLISHMENT:
 - a. WATERING: MAINTAIN THE SOIL MOISTURE AT FIELD CAPACITY. FIELD CAPACITY WILL BE DETERMINED FROM A 4-INCH-DEEP EXCAVATION WHERE THE SOIL MUST HOLD TOGETHER AND FORM A HAND CLUMP.
 - b. FERTILIZATION: APPLY AN 8-2-12+4 MG FERTILIZER, PLUS WATER-SOLUBLE MICRONUTRIENTS. 100 PERCENT OF THE (N) NITROGEN, (K) POTASSIUM, (MG) MAGNESIUM, AND (8) BORON MUST BE IN CONTROLLED RELEASE FORM. APPLICATION RATE PER MANUFACTURER'S RECOMMENDATIONS. BEGIN FERTILIZATION DURING INSTALLATION AND REPEAT EVERY 3 MONTHS.
5. HAND WATERING IS REQUIRED FOR THE SUCCESSFUL ESTABLISHMENT OF THE PROPOSED PLANTINGS. DETERMINE THE WATER SCHEDULE AND RATE TO ENSURE THE HEALTHY ESTABLISHMENT OF ALL PLANTS THROUGHOUT THE CONSTRUCTION AND ESTABLISHMENT PERIODS. WATER SUPPLIED BY A WATER TRUCK MUST NOT BE APPLIED IN A MANNER THAT WOULD DAMAGE PLANTS, NOR IN A MANNER THAT WOULD REMOVE SOIL SAUCER RINGS OR MULCH AROUND EACH PLANT.
6. ALL PROPOSED TREES SHALL RECEIVE A MINIMUM 5' DIAMETER, UNIFORMLY APPLIED, MULCH RING, MULCH TYPE TO BE RECYCLED ECO-MULCH MADE FROM VIRGIN ROUNDWOODS INCLUDING SLASH PINE, BLACK OLIVE, AND OAK. IT SHALL NOT INCLUDE ANY CYPRESS, MELALEUCA, CONSTRUCTION (C&D) WOOD, OR ANY MATERIAL CONTAINING ARSENIC OR COLOR DYES. APPLY A PRE-EMERGENT HERBICIDE WITHIN ALL TREE RINGS IN CONJUNCTION WITH THE MULCHING OPERATIONS. FOLLOW MANUFACTURER'S RECOMMENDATIONS FOR RATES AND APPLICATION METHODS.
7. PLANTS SHALL MEET PLAN REQUIREMENTS UNLESS OTHERWISE APPROVED. IF PLANTS SATISFYING PLAN REQUIREMENTS CANNOT BE LOCATED, PROVIDE WRITTEN SEARCH NOTIFICATION DETAILING PLAN REQUIREMENTS THAT COULD NOT BE MET AND SUPPLIERS THAT WERE SEARCHED. IF THE ENGINEER, IN CONJUNCTION WITH THE LANDSCAPE ARCHITECT, IS UNABLE TO LOCATE PLANTINGS THAT SATISFY PLAN REQUIREMENTS WITHIN THREE WEEKS OF SEARCH NOTIFICATION, THEN PLANTINGS THAT DO NOT MEET, OR THAT EXCEED, PLANS REQUIREMENTS WILL BE ACCEPTABLE IF APPROVED IN WRITING PRIOR TO PURCHASING. IF THE ENGINEER, IN CONJUNCTION WITH THE LANDSCAPE ARCHITECT, IS ABLE TO LOCATE PLANTS THAT MEET THE PLAN REQUIREMENTS, THEN THE CONTRACTOR WILL BE OBLIGATED TO PROCURE THEM.

IRRIGATION PROJECT NOTES:

1. IRRIGATION DESIGN BASED ON COORDINATION WITH THE CITY OF PORT ST. LUCIE. SEE THE PROPRIETARY PRODUCT CERTIFICATION LETTER FOR APPROVED COMPONENT BRAND NAMES AND MODEL NUMBERS.
2. IRRIGATION WATER SOURCE AND CONTROLLER ARE EXISTING AND ARE LOCATED OUTSIDE OF THE PROJECT LIMITS.
3. REMOVE EXISTING IRRIGATION COMPONENTS IN CONFLICT WITH THE PROPOSED IRRIGATION COMPONENTS. BELOW-GRADE MATERIALS MAY BE CAPPED AND ABANDONED.
4. LOCATE AND RESTORE THE CONNECTION TO ALL EXISTING LATERAL LINES OR MAIN LINES AS NEEDED TO ACCOMMODATE NEW LOCATIONS OF REPLACEMENT HEADS FOR THE IRRIGATION RESTORATION WORK. UTILIZE THE LATEST EDITION OF THE FLORIDA BUILDING CODE APPENDIX F AND THE CITY OF PORT ST LUCIE PUBLIC WORKS IRRIGATION SPECIFICATIONS FOR ALL INSTALLATION CRITERIA. ENSURE ALL PROPOSED REPLACEMENT HEADS MATCH THE EXISTING MANUFACTURER, TYPE, SIZE, AND PRESSURE OF THE EXISTING HEADS TO BE REMOVED TO ENSURE COMPATABILITY AND SYNCHRONIZATION WITH THE EXISTING SYSTEM TO REMAIN. THE RADIUS AND PATTERN OF THE PROPOSED SPRAY HEADS ARE SHOWN IN THE PLANS.
5. THE IRRIGATION SYSTEM MUST BE INSTALLED AND OPERATIONAL WITHIN 5 DAYS OF INSTALLING ANY PLANT MATERIALS THAT FALL WITHIN THE IRRIGATION SYSTEM LIMITS.
6. THE LAYOUT OF THE IRRIGATION COMPONENTS IS DIAGRAMMATICALLY SHOWN AND SHALL BE ROUTED TO AVOID TREES/PALMS, ROADWAY FEATURES, AND UTILITIES.
7. THE EXISTING COMPONENTS TO REMAIN ARE NOT SHOWN ON THESE PLANS. ENSURE THE REMAINDER OF EACH ZONE AND SYSTEM ALWAYS REMAIN OPERATIONAL. CAP PIPE IN LOCATIONS WHERE THE LATERAL WAS REMOVED IF THE SYSTEM CAN NOT BE RESTORED IMMEDIATELY. PROVIDE SUPPLEMENTAL WATER VIA A WATER TRUCK AS NEEDED TO ENSURE THE EXISTING LANDSCAPE REMAINS IN GOOD CONDITION PRIOR TO THE IRRIGATION SYSTEM RESTORATION IS COMPLETE.
8. SUBMIT AS-BUILT PLANS TO THE DEPARTMENT AT FINAL ACCEPTANCE.

| REVISIONS | | | | Landscape Architect Of Record: Robert J. Cotleur, RLA: #1067 COTLEUR & HEARING, INC. 1934 Commerce Lane Suite 1 Jupiter, Florida 33458 561-747-6336 Fax 561-747-1377 | STATE OF FLORIDA DEPARTMENT OF TRANSPORTATION | | | SHEET NO. LD-3 |
|-----------|-------------|------|-------------|--|--|-----------|----------------------|--------------------------|
| DATE | DESCRIPTION | DATE | DESCRIPTION | | ROAD NO. | COUNTY | FINANCIAL PROJECT ID | |
| | | | | | SR 9 | ST. LUCIE | 444336-1-52-01 | |

PROPOSED LANDSCAPE LEGEND

| SYMBOL | ABBR. | BOTANICAL NAME / COMMON NAME SIZE | QTY |
|--------|-------|---|-----|
| | BN | BISMARCKIA NOBILIS 'SILVER' - SILVER BISMARCK PALM 8' CT, MIN 5'x5' RB, RP, FF, MIN 7' LC. | 15 |
| | DR | DELONIX REGIA - ROYAL POINCIANA 14'x8', 5" CAL | 18 |
| | LI | LAGERSTROEMIA INDICA 'TUSKEGEE' - RED CREPE MYRTLE 12' OA x 6' SPRD, MULTI, LIMB UP 5' | 6 |
| | LS | LAGERSTROEMIA SPECIOSA - QUEEN'S CREPE MYRTLE 12' OA x 5' SPRD, 2.5" CAL | 21 |
| | PE1 | PINUS ELLIOTTII Densa - SO FLORIDA SLASH PINE 10' OA, 3" CAL | 130 |
| | PE2 | PINUS ELLIOTTII Densa - SO FLORIDA SLASH PINE 14' OA, 4.5" CAL | 58 |
| | PEA | PTYCHOSPERMA ELEGANS - SOLITAIRE PALM MIN 10' CT, SINGLE | 17 |
| | QV | QUERCUS VIRGINIANA - LIVE OAK 16' OA x 7' SPRD, 4" CAL | 75 |
| | RE | ROYSTONEA REGIA - ROYAL PALM MIN. 10' GW, MIN. 10' LC | 20 |
| | SP | SABAL PALMETTO - SABAL PALM 18' CT, (17'-19' RANGE), SLICK | 103 |
| | WR | WASHINGTONIA ROBUSTA - WASHINGTON PALM 24' OA, SL | 69 |
| | MUH | MUHLENBERGIA CAPILLARIS - MUHLY GRASS #1 GAL, 1.5'x2', 2.5' OC | 160 |

EXISTING LANDSCAPE LEGEND

| | |
|--|---|
| | SABAL PALMETTO CABBAGE PALM |
| | WASHINGTONIA ROBUSTA WASHINGTON PALM |
| | WODYETIA BIFURCATA OR ROYSTONEA REGIA FOXTAIL PALM ROYAL PALM |
| | PHOENIX DACTYLIFERA 'MEDJOOOL' MEDJOOOL DATE PALM |
| | LAGERSTROEMIA INDICA CREPE MYRTLE |
| | PINUS ELLIOTTII Densa SOUTH FL SLASH PINE |
| | QUERCUS VIRGINIANA LIVE OAK |
| | MISC. TREES (OAK, PINE, MYRTLE, CYPRESS) |
| | MISC. SHRUBS (HOLLY, FIREBUSH, FLAX LILY, FICUS, RUELLIA, SILVERTHORNE, PODOCARPUS, SCHEFFLERA) |

| REVISIONS | | | | Landscape Architect Of Record: Robert J. Cotleur, RLA: #1067 COTLEUR & HEARING, INC. 1934 Commerce Lane Suite 1 Jupiter, Florida 33458 561-747-6336 Fax 561-747-1377 | STATE OF FLORIDA DEPARTMENT OF TRANSPORTATION | | | SHEET NO. LD-4 |
|-----------|-------------|------|-------------|--|--|-----------|----------------------|--------------------------|
| DATE | DESCRIPTION | DATE | DESCRIPTION | | ROAD NO. | COUNTY | FINANCIAL PROJECT ID | |
| | | | | | SR 9 | ST. LUCIE | 444336-1-52-01 | |

LEGEND

THE OFFICIAL RECORD OF THIS SHEET IS THE ELECTRONIC FILE DIGITALLY SIGNED AND SEALED UNDER RULE 61G10-11.001, F.A.C.

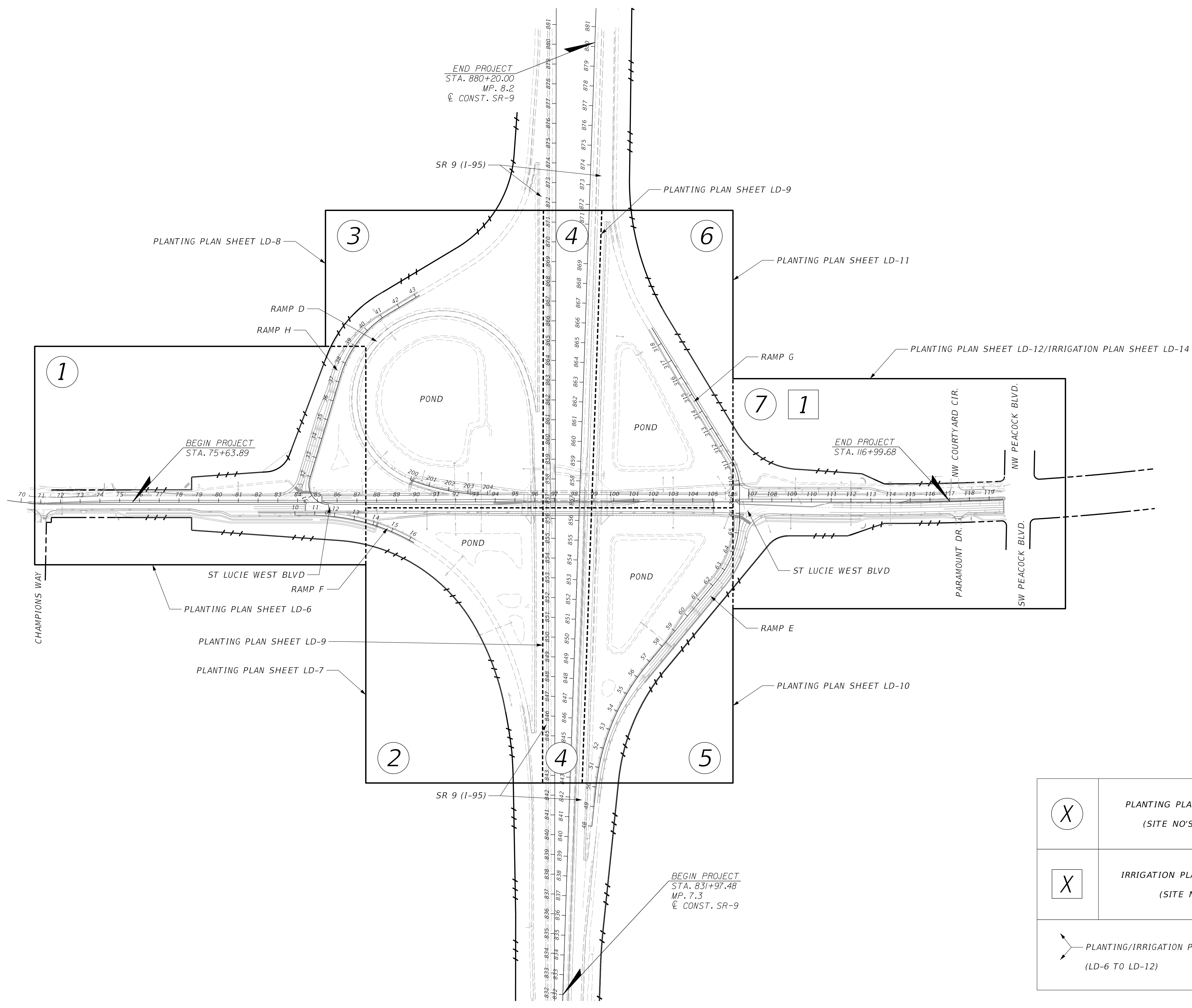
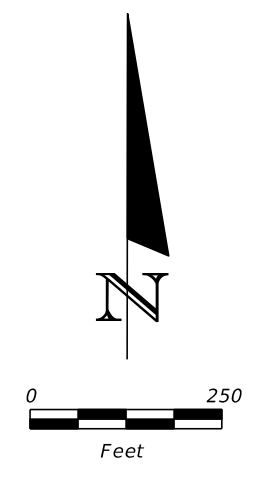

| | |
|---|---|
| X | PLANTING PLAN/SITE NO'S (SITE NO'S 1 TO 7) |
| X | IRRIGATION PLAN/SITE NO'S (SITE NO. 1) |
| PLANTING/IRRIGATION PLAN SHEET NO. (LD-6 TO LD-12) | |

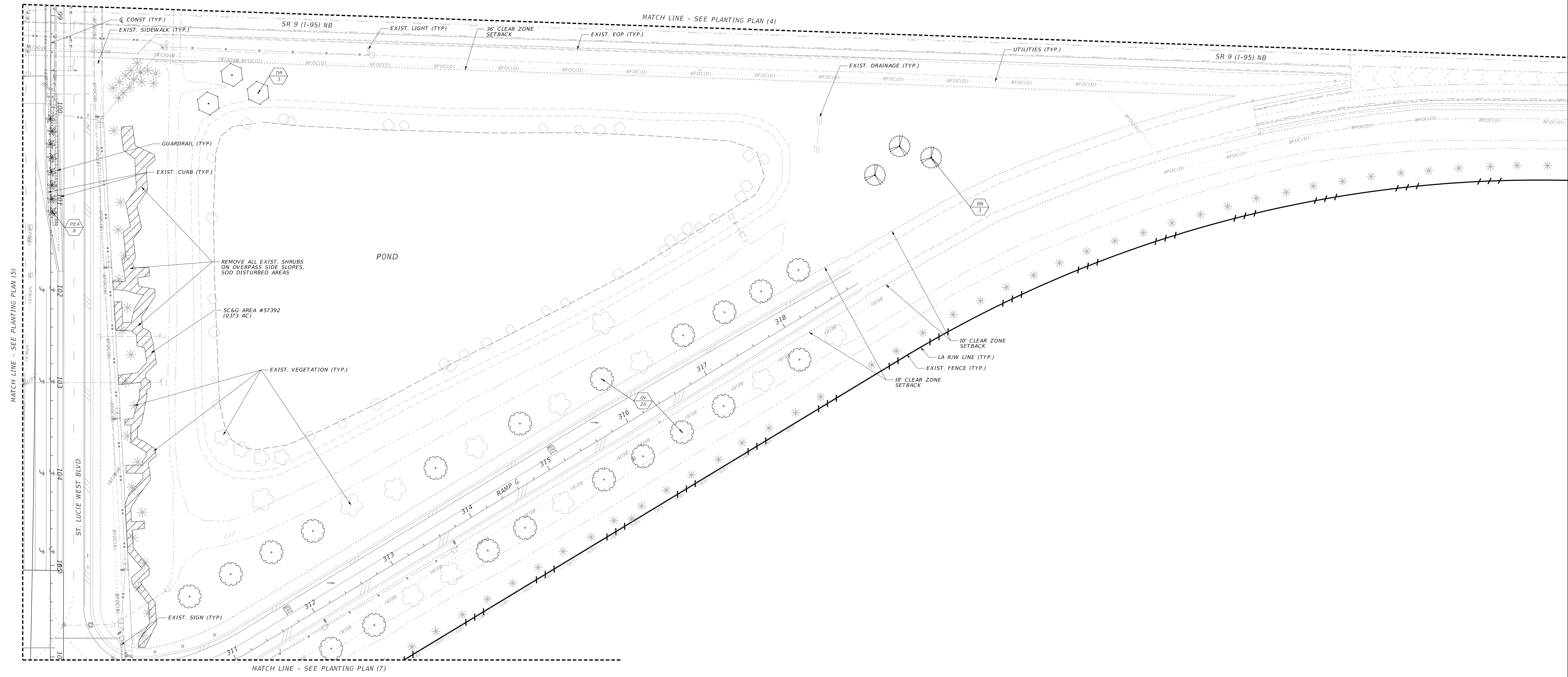
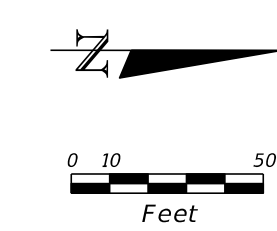

PLANT SCHEDULE AND LEGEND

| SYMBOL | ABBR. | BOTANICAL NAME / COMMON NAME SIZE | QTY |
|--------|-------|--|-----|
| | BN | BISMARCKIA NOBILIS 'SILVER' - SILVER BISMARCK PALM 8' CT, MIN 5'x5' RB, RP, FF, MIN 7' LC | 3 |
| | DR | DELONIX REGIA - ROYAL POINCIANA 14'x8', 5' CAL | 3 |
| | PEA | PTYCHOSPHERA ELEGANS - SOLITAIRE PALM MIN 10' CT, SINGLE | 8 |
| | OV | QUERCUS VIRGINIANA - LIVE OAK 16' DA x 7' SPRD, 4' CAL | 20 |

PLANT SCHEDULE AND LEGEND

| SYMBOL | ABBR | BOTANICAL NAME / COMMON NAME SIZE | QTY |
|--------|------|---|-----|
| | LI | LAGERSTROEMIA INDICA 'TUSKEGEE' - RED CREPE MYRTLE 12' DA x 6' SPRD, MULTI, LIMB UP 3' | 6 |
| | LS | LAGERSTROEMIA SPECIOSA - QUEEN'S CREPE MYRTLE 12' DA x 5' SPRD, 2.5' CAL | 15 |
| | QV | QUERCUS VIRGINIANA - LIVE OAK 16' DA x 7' SPRD, 4" CAL | 7 |
| | MUH | MUHLENBERGIA CAPILLARIS - MUHLY GRASS #1 GAL, 1.5'x2', 2.5' OC | 160 |

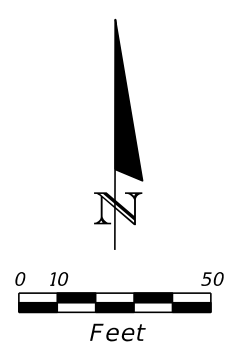

MATCH LINE - SEE PLANTING PLAN (6)

MATCH LINE - SEE PLANTING PLAN (5)

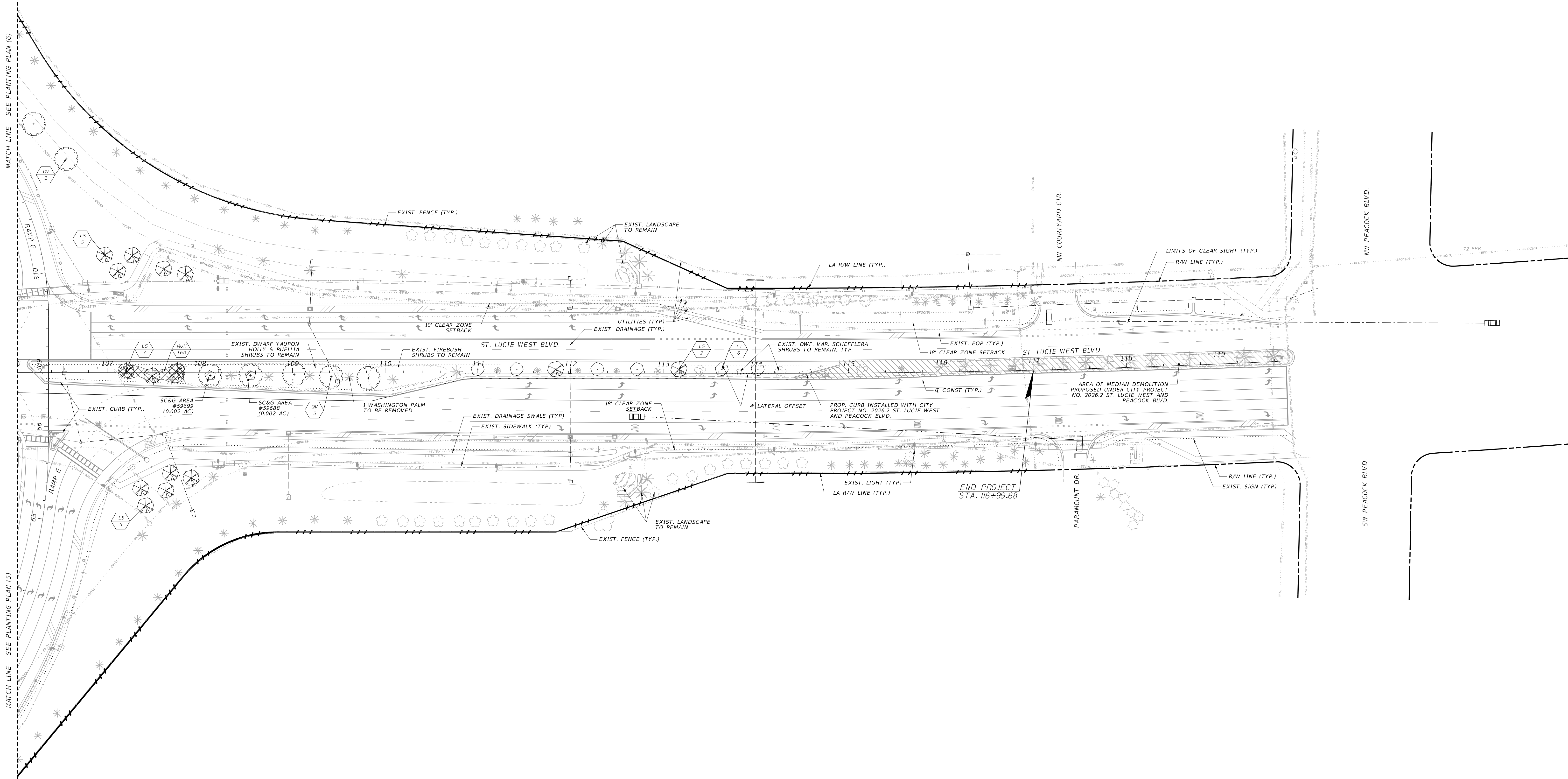

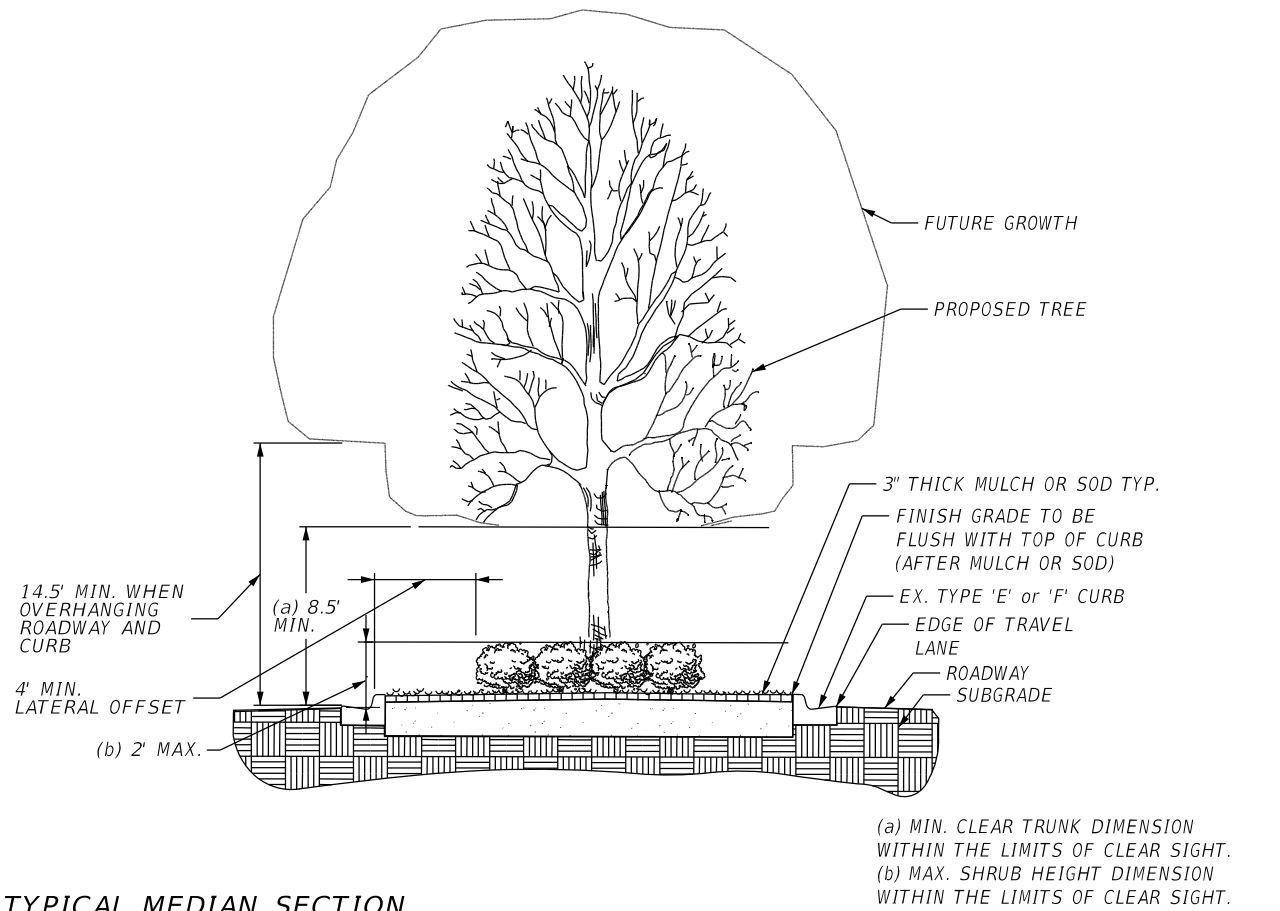

TYPICAL MEDIAN SECTION

NOT TO SCALE

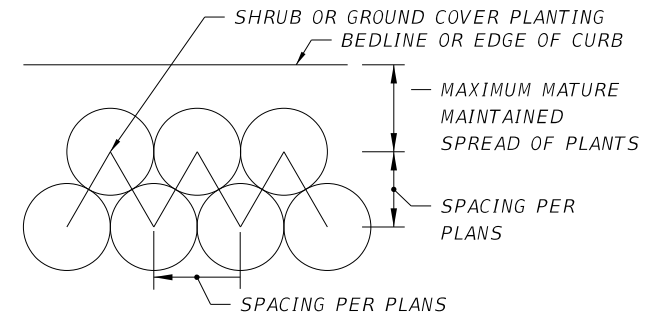

GROUND COVER/SHRUB LAYOUT DETAIL

NOT TO SCALE

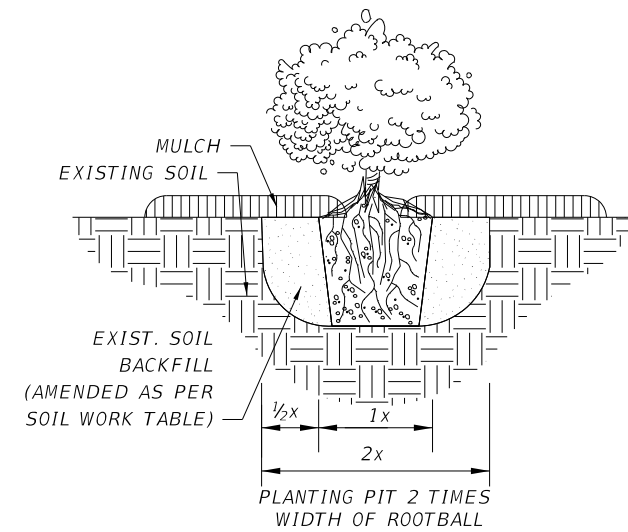

GROUND COVER/SHRUB PLANTING DETAIL

NOT TO SCALE

| REVISIONS | | | | Landscape Architect Of Record: Robert J. Cotleur, RLA: #1067 COTLEUR & HEARING, INC. 1934 Commerce Lane Suite 1 Jupiter, Florida 33458 561-747-6336 Fax 561-747-1377 | STATE OF FLORIDA DEPARTMENT OF TRANSPORTATION | | | SHEET NO. LD-13 |
|-----------|-------------|------|-------------|--|--|-----------|----------------------|------------------------|
| DATE | DESCRIPTION | DATE | DESCRIPTION | | ROAD NO. | COUNTY | FINANCIAL PROJECT ID | |
| | | | | | SR 9 | ST. LUCIE | 444336-1-52-01 | |

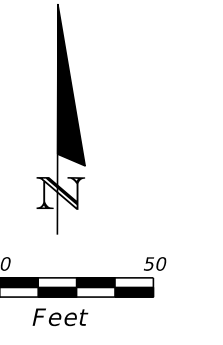





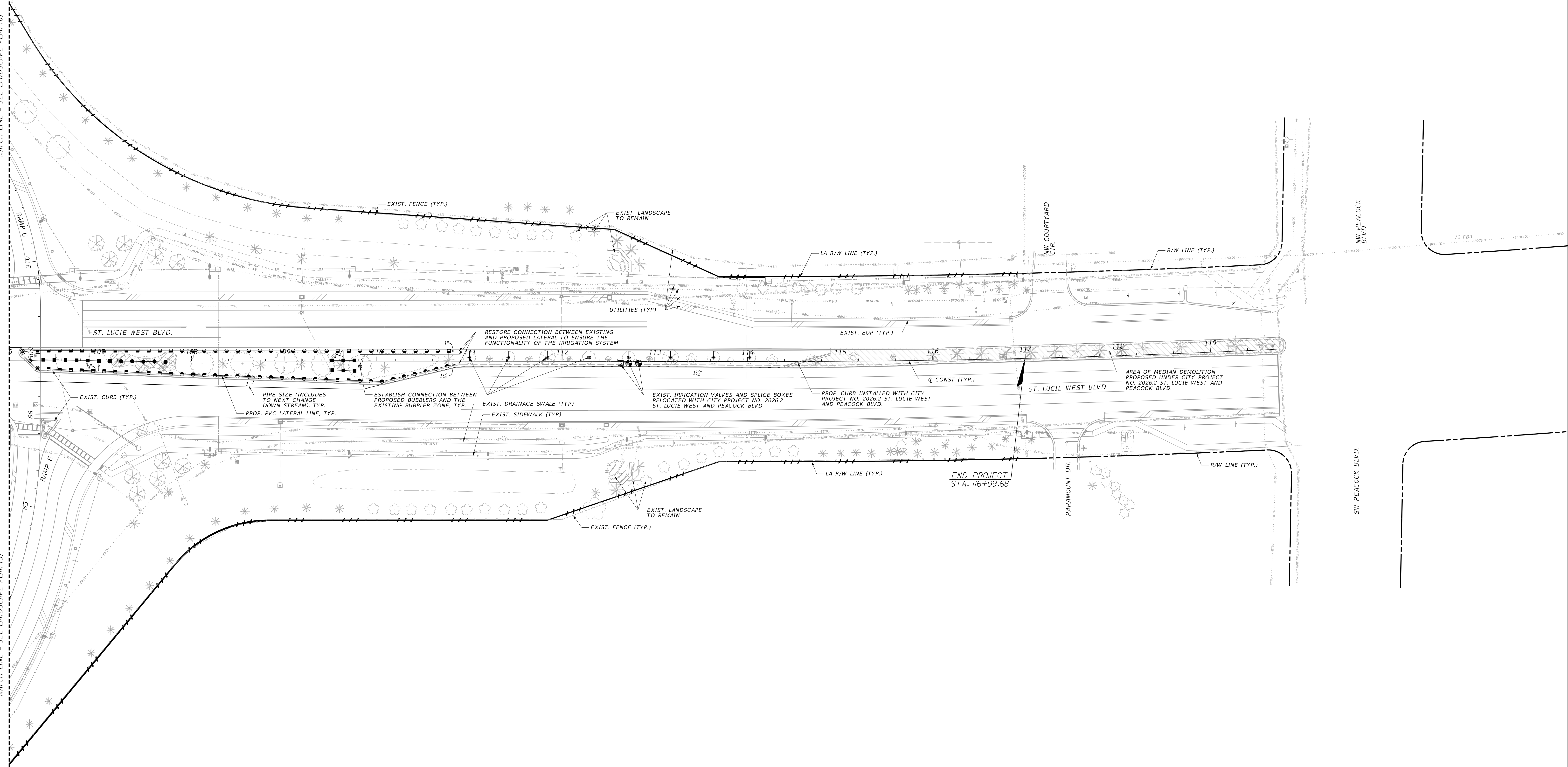



MATCH LINE - SEE LANDSCAPE PLAN (6)

MATCH LINE - SEE LANDSCAPE PLAN (5)

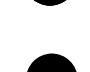

IRRIGATION LEGEND

-  TWO (2) RAIN BIRD 1804-SAM W/ PA-80 ADAPTOR W/ 1401 BUBBLER (0.25 GPM PER BUBBLER, MODEL NO. #1401)
-  RAIN BIRD 1806-SAM-PRS WITH HUNTER MP ROTATOR NOZZLE; 6" POP-UP, 12' RADIUS, 45°-105° (0.17-0.39 GPM; MODEL NO. MP CORNER, TURQUOISE)
-  RAIN BIRD 1806-SAM-PRS WITH HUNTER MP ROTATOR NOZZLE; 6" POP-UP, 12' RADIUS, HALF (0.34 GPM; MODEL NO. MP1000, MAROON)
-  RAIN BIRD 1806-SAM-PRS WITH HUNTER MP ROTATOR NOZZLE; 6" POP-UP, 12' RADIUS, FULL (0.69 GPM; MODEL NO. MP1000, OLIVE)
-  RAIN BIRD 1812-SAM-PRS WITH HUNTER MP ROTATOR NOZZLE; 12" POP-UP, 12' RADIUS, HALF (0.34 GPM; MODEL NO. MP1000, MAROON)
-  RAIN BIRD 1812-SAM-PRS WITH HUNTER MP ROTATOR NOZZLE; 12" POP-UP, 12' RADIUS, FULL (0.69 GPM; MODEL NO. MP1000, OLIVE)
-  CL 200 PVC LATERAL LINE W/ SCH 40 PVC FITTINGS
-  EXISTING CONTROL VALVE TO REMAIN
-  EXIST. SPLICE BOX TO REMAIN

SYSTEM DESIGN CRITERIA FOR LATERAL PIPE SIZES

| | | |
|--------|---------|-----|
| 3/4" | 0 - 8 | GPM |
| 1" | 8 - 15 | GPM |
| 1-1/4" | 15 - 22 | GPM |
| 1-1/2" | 22 - 32 | GPM |
| 2" | 32 - 50 | GPM |
| 3" | 50 - 68 | GPM |

*ALL SLEEVING IS TO BE AT LEAST TWICE THE SIZE OF PIPE TRAVELING THROUGH

*ALL PIPE SHALL BE SIZED IN ACCORDANCE WITH THE PLANS, ABOVE CRITERIA PROVIDED FOR REFERENCE ONLY.

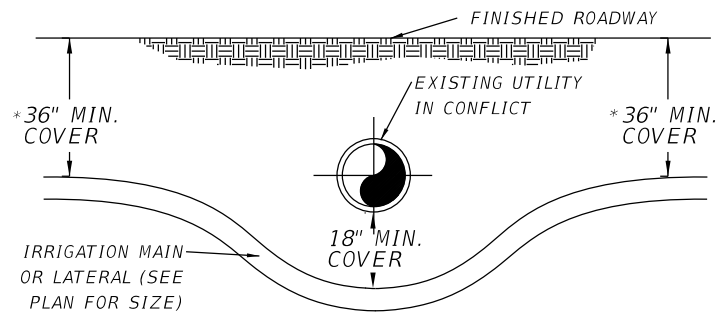

NOTE: IRRIGATION MAIN LINES OR LATERAL LINES THAT ARE SHOWN AS PVC PIPES IN SLEEVES MAY NEED TO BE SUBSTITUTED WITH H.D.P.E. PIPE AND DIRECTIONALLY DRILLED WHERE EXISTING UTILITIES CAN NOT BE CROSSED WITHOUT EXCESSIVE EXCAVATION. COORDINATE ALL CHANGES WITH ENGINEER.
*WHERE PIPES ARE INSTALLED VIA DIRECTIONAL DRILLING THE MINIMUM COVER DIMENSION WILL BE IN ACCORDANCE WITH THE FDOT UTILITY ACCOMMODATION MANUAL.

TYPICAL CONFLICT DETAIL

NOT TO SCALE

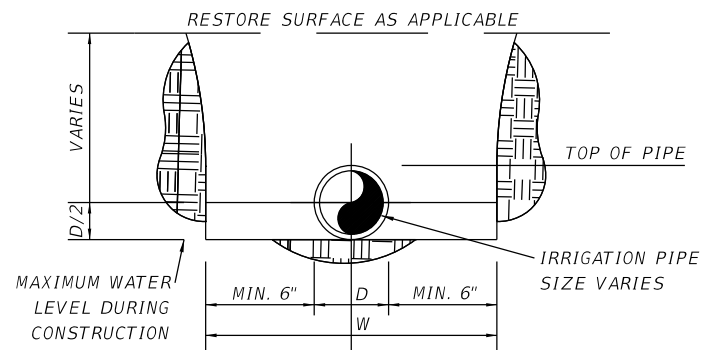

NOTES:

BEDDING FOR TYPICAL IRRIGATION MAIN OR LATERAL INSTALLATION SHALL BE TYPE C. BEDDING SHALL BE COMPACTED TO 95% OF THE MATERIALS MAXIMUM DENSITY AS DETERMINED IN ASTM D-1557 (AASHTO T-180). TYPE C BEDDING SHALL BE DEFINED AS: SAND WITH 100 PERCENT PASSING A 9.75 SIEVE, AT LEAST 90 PERCENT PASSING A NUMBER 4 SIEVE AND A SAND EQUIVALENT VALUE NOT LESS THAN 30.

* FOR LOCATIONS WITHIN 3' OF CURB OR ROADWAY PAVEMENT AND OVER 18" DEEP. FOR LOCATIONS OUTSIDE OF 3' FROM THE CURB OR LESS THAN 18" DEEP, THE BACKFILL CAN BE EXISTING CLEAN SOIL AND IT DOES NOT NEED TO BE COMPACTED.

*** TYPICAL TRENCH DETAIL**

NOT TO SCALE

| | | | | | | | | | |
|-----------|-------------|------|-------------|--|--|-----------|----------------------|---------------------------|-----------|
| REVISIONS | | | | Landscape Architect Of Record: Robert J. Cotleur, RLA: #1067 COTLEUR & HEARING, INC. 1934 Commerce Lane Suite 1 Jupiter, Florida 33458 561-747-6336 Fax 561-747-1377 | STATE OF FLORIDA DEPARTMENT OF TRANSPORTATION | | | IRRIGATION DETAILS | SHEET NO. |
| DATE | DESCRIPTION | DATE | DESCRIPTION | | ROAD NO. | COUNTY | FINANCIAL PROJECT ID | | LD-15 |
| | | | | | SR 9 | ST. LUCIE | 444336-1-52-01 | | |

Tree Bubbler

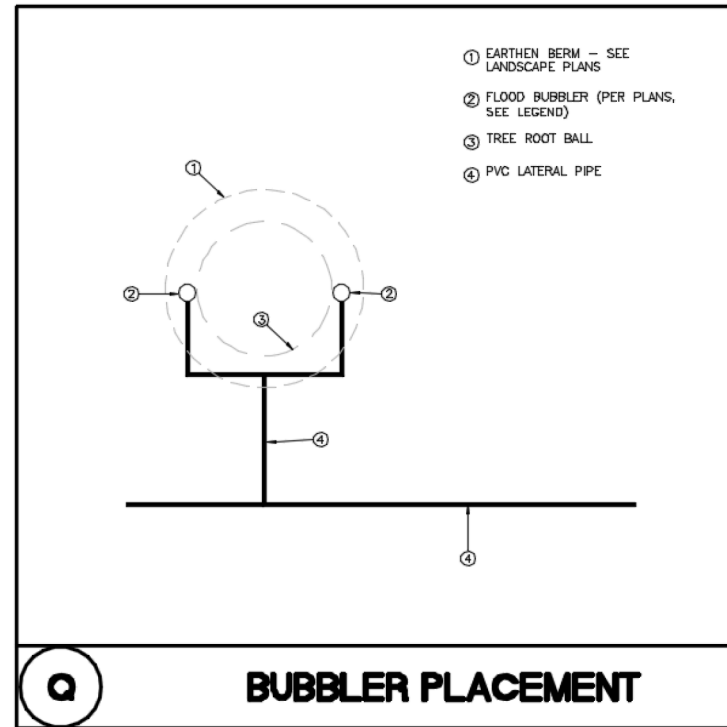
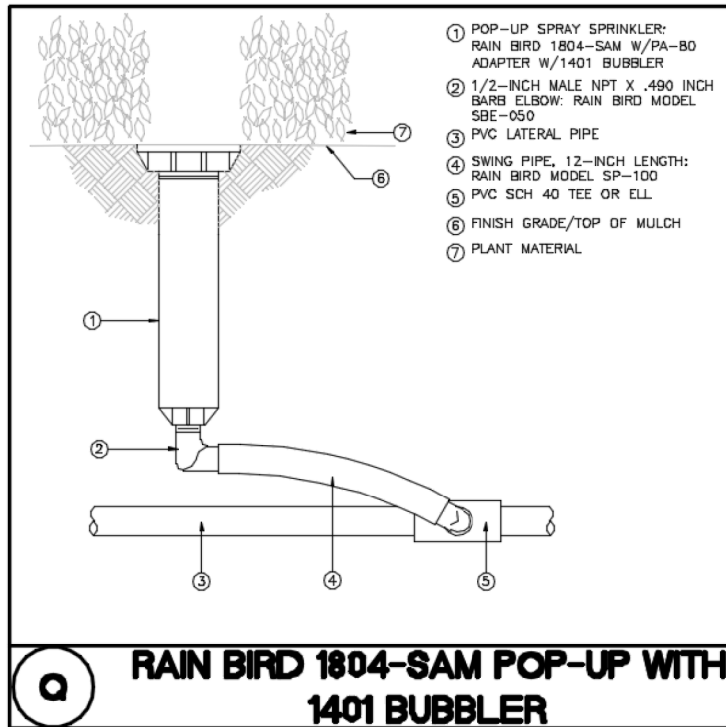

Spray heads

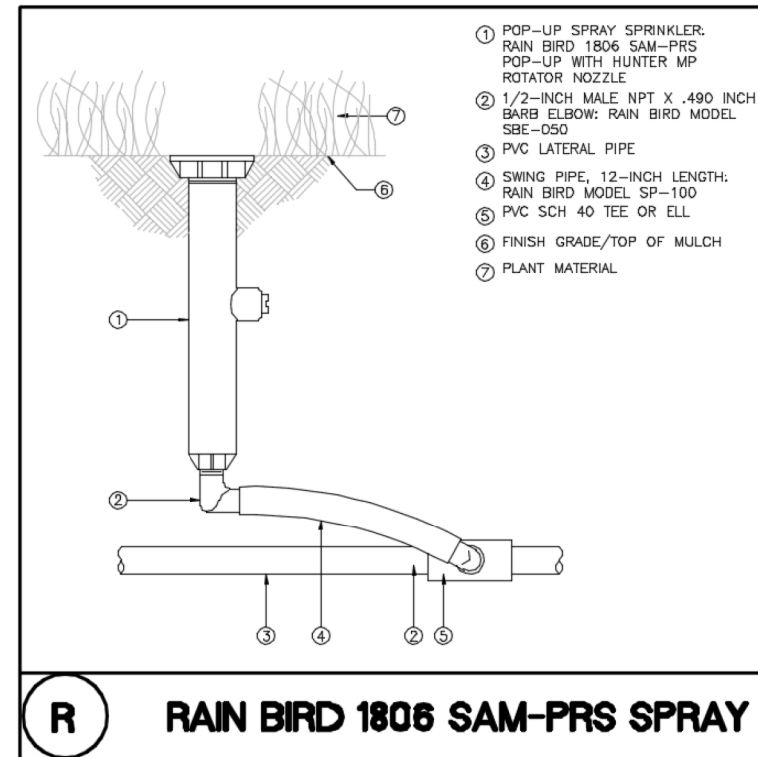

Remote Control Valve

NOTE: REFER TO PRODUCT LITERATURE FOR ADDITIONAL INSTALLATION AND ADJUSTMENT INFORMATION.

ALL SCH 80 NIPPLES ARE TO BE CONTINUOUS AND THREADED ON BOTH SIDES

THE INTENT OF THE FABRIC IS TO KEEP THE VALVE BOX FREE OF DIRT/DEBRIS. FILTER FABRIC SHOULD SPAN BASE OF VALVE BOX AND BE SECURED A MINIMUM OF 6" UP FROM BASE VIA DUCT TAPE AROUND SIDES OF VALVE BOX. FABRIC SHOULD CONTAIN NO HOLES EXCEPT FOR WIRE/PIPES AS APPLICABLE.

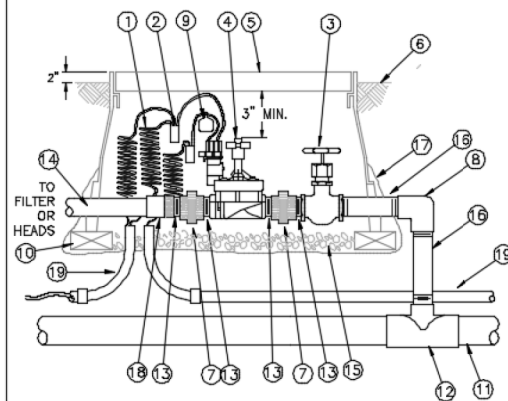

RAIN BIRD RCV W/GATE VALVE

Control Wire and Waterproof connector

NOTES:

1. FILTER FABRIC SHOULD SPAN BASE OF VALVE BOX AND BE SECURED A MINIMUM OF 6" UP FROM BASE VIA DUCT TAPE AROUND SIDES OF VALVE BOX. FABRIC SHOULD CONTAIN NO HOLES EXCEPT FOR WIRE AND PIPES (IF APPLICABLE) AS SHOWN.
2. CONDUIT ENDS SHALL BE A MINIMUM OF 6" ABOVE GRAVEL TO PREVENT DEBRIS ENTERING CONDUITS
3. CONDUIT ENDS SHALL BE 2" BELOW UNDERSIDE OF LID

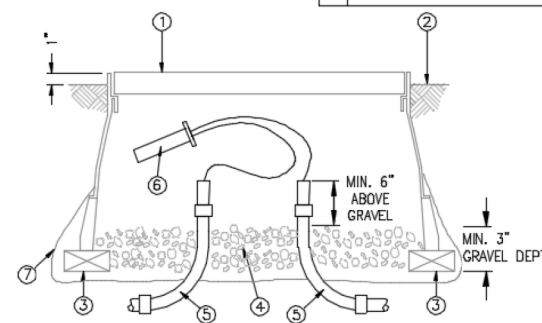

WIRE SPLICE

NOTE: IRRIGATION DETAILS PROVIDED ON SHEET DET-1 ARE FROM THE "SECTION 328400 PLANTING IRRIGATION, SUPPLEMENTAL SPECIFICATION 'A', CITY OF PORT ST. LUCIE PUBLIC WORKS IRRIGATION PACKAGE" DATED 11-07-2023.

| REVISIONS | | | |
|-----------|-------------|------|-------------|
| DATE | DESCRIPTION | DATE | DESCRIPTION |
| | | | |

Landscape Architect Of Record: Robert J. Cotleur, RLA: #1067
 COTLEUR & HEARING, INC.
 1934 Commerce Lane Suite 1
 Jupiter, Florida 33458
 561-747-6336 Fax 561-747-1377

| | | |
|--|-----------|----------------------|
| STATE OF FLORIDA DEPARTMENT OF TRANSPORTATION | | |
| ROAD NO. | COUNTY | FINANCIAL PROJECT ID |
| SR 9 | ST. LUCIE | 444336-1-52-01 |

**CITY OF PSL - IRRIGATION
INSTALLATION DETAILS**

SHEET NO.
DET-1

SECTION: 94813000
COUNTY: ST. LUCIE
PROJECT: 444336-1-52-01
STATE ROAD: SR 9

EXHIBIT C

APPROXIMATE COST FOR LANDSCAPE IMPROVEMENTS

This Exhibit forms an integral part of the Landscape Maintenance Memorandum of Agreement between the FLORIDA DEPARTMENT OF TRANSPORTATION and the AGENCY.

Per attached Cost Breakdown: \$27,435.00

I -95/ST LUCIE WEST BLVD INTERCHANGE - LANDSCAPE COST ESTIMATE (PSL MMOA LIMITS ONLY)

CITY OF PORT ST. LUCIE

FPI# 444336-1-52-01, CH# 22-0121 BG21

8/16/2024

| SYMBOL | DESCRIPTION | NATIVE | MAX. MAINT. SIZE | UNIT | TOTAL | UNIT COST | SUB-TOTAL |
|---------------------------|---|--------|------------------|------|-------|-----------|------------------|
| | LUMP SUM CONTRACT | | | LS | | | \$ 815,801.00 |
| | LANDSCAPE COMPLETE - SMALL PLANTS | | | LS | 1 | | \$ 1,920.00 |
| MUH | MUHLENBERGIA CAPILLARIS, MUHLY GRASS, #1 GAL, 1.5'x 2', 2.5' OC | Y | 3' | EA | 160 | \$ 12.00 | \$ 1,920.00 |
| | LANDSCAPE COMPLETE - LARGE PLANTS | | | LS | 1 | | \$ 15,530.00 |
| LI | LAGERSTROEMIA INDICA 'TUSKEGEE', RED CREPE MYRTLE, 12' OA x 6' SPRD, MULTI, LIMB UP 5' | N | 25' | EA | 6 | \$ 580.00 | \$ 3,480.00 |
| LS | LAGERSTROEMIA SPECIOSA, QUEEN'S CREPE MYRTLE, 12' OA x 5' SPRD, 2.5" CAL | N | 35' (NF) | EA | 5 | \$ 900.00 | \$ 4,500.00 |
| PEA | PTYCHOSPERMA ELEGANS, SOLITAIRE PALM, MIN 10' CT, SINGLE | N | 25' | EA | 8 | \$ 475.00 | \$ 3,800.00 |
| QV | QUERCUS VIRGINIANA, LIVE OAK, 16' OA x 7' SPRD, 4" CAL | Y | 50' (NF) | EA | 5 | \$ 750.00 | \$ 3,750.00 |
| | IRRIGATION SYSTEM | | | LS | 1 | | \$ 9,985.00 |
| | RAIN BIRD #1804-SAM WITH #1401 BUBBLER ON PA-80 ADAPTOR, 4" POP-UP, FLOOD BUBBLER | | | EA | 18 | \$ 42.00 | \$ 756.00 |
| | RAIN BIRD #1806-SAM-PRS WITH HUNTER MP CORNER 'TURQUOISE' ROTATOR NOZZLE, 6" POP-UP, 12' RADIUS, 45°-105° | | | EA | 2 | \$ 50.00 | \$ 100.00 |
| | RAIN BIRD #1806-SAM-PRS WITH HUNTER MP1000 'MAROON' ROTATOR NOZZLE, 6" POP-UP, 12' RADIUS, HALF | | | EA | 31 | \$ 50.00 | \$ 1,550.00 |
| | RAIN BIRD #1806-SAM-PRS WITH HUNTER MP1000 'OLIVE' ROTATOR NOZZLE, 6" POP-UP, 12' RADIUS, FULL | | | EA | 13 | \$ 50.00 | \$ 650.00 |
| | RAIN BIRD #1812-SAM-PRS WITH HUNTER MP1000 'MAROON' ROTATOR NOZZLE, 12" POP-UP, 12' RADIUS, HALF | | | EA | 47 | \$ 50.00 | \$ 2,350.00 |
| | RAIN BIRD #1812-SAM-PRS WITH HUNTER MP1000 'OLIVE' ROTATOR NOZZLE, 12" POP-UP, 12' RADIUS, FULL | | | EA | 5 | \$ 50.00 | \$ 250.00 |
| | CLASS 200 LATERAL LINE (SIZE NOTED ON PLANS) | | | LF | 1,332 | \$ 3.25 | \$ 4,329.00 |
| TOTAL PROJECT COST | | | | | | \$ | 27,435.00 |

ABBREVIATION KEY: CAL=CALIPER, CT=CLEAR TRUNK, EA=EACH, GAL=GALLON, LF=LINEAR FOOT, LS=LUMP SUM, MAINT.=MAINTAINED, MAX.=MAXIMUM, MIN=MINIMUM, NF=NATURAL FORM, N=NO, OA=OVERALL, OC=ON CENTER, SPRD=SPREAD, Y=YES

SECTION: 94813000
COUNTY: ST. LUCIE
PROJECT: 444336-1-52-01
STATE ROAD: SR 9

EXHIBIT D

RESOLUTION

This Exhibit forms an integral part of the Landscape Maintenance Memorandum of Agreement between the FLORIDA DEPARTMENT OF TRANSPORTATION and the AGENCY.

Please see attached

(Will be provided by City)