

Project Team:
 Client & Property Owner: Mattamy Homes, LLC. 1500 Gateway Blvd, Suite 220 Boynton Beach, FL 33426
 Land Planner / Landscape Architect: Lucido & Associates 701 E Ocean Boulevard Stuart, FL 34994
 Engineer: Kimley Horn 445 24th Street, Suite 200 Vero Beach, FL 32960
 Surveyor: Caulfield & Wheeler Inc. 410 S.E. Port St. Lucie Blvd. Port St. Lucie, Florida 34984

Landscape Data

	Required Tree Credits:	Provided Tree Credits:
Street Tree: (1,142' / 40')	28	28
Total:	28	28

*All tree credits are counted 1:1 & 2:1 per Appendix C Table 1
 *Approved Trees & Shrubs in the PSL Landscape Code .

Notes:
 Alternate Species may be used to satisfy Street Tree requirements depending on planting space & species availability. Alternates are as follows:

- Quercus virginiana- Live Oak
- Swietenia mahagoni- Mahogany
- Southern Magnolia- Magnolia grandiflora
- *Bauhinia x blakeana- Hong Kong Orchid Tree
- *Elaeocarpus decipiens- Japanese Blueberry
- *Ilex x attenuata 'Eagleston' Eagleston Holly
- *Lagerstroemea indica - Crape Myrtle

*If medium or small canopy trees are used as alternates, planting intervals will follow guidelines in the Street Tree Planting section 156.121

If Cul-De-Sac areas do not allow for Street Tree Planting due to space constraints, required tree quantities will be added to the common green spaces throughout the community.

*Location of street trees may vary due to the location of driveways

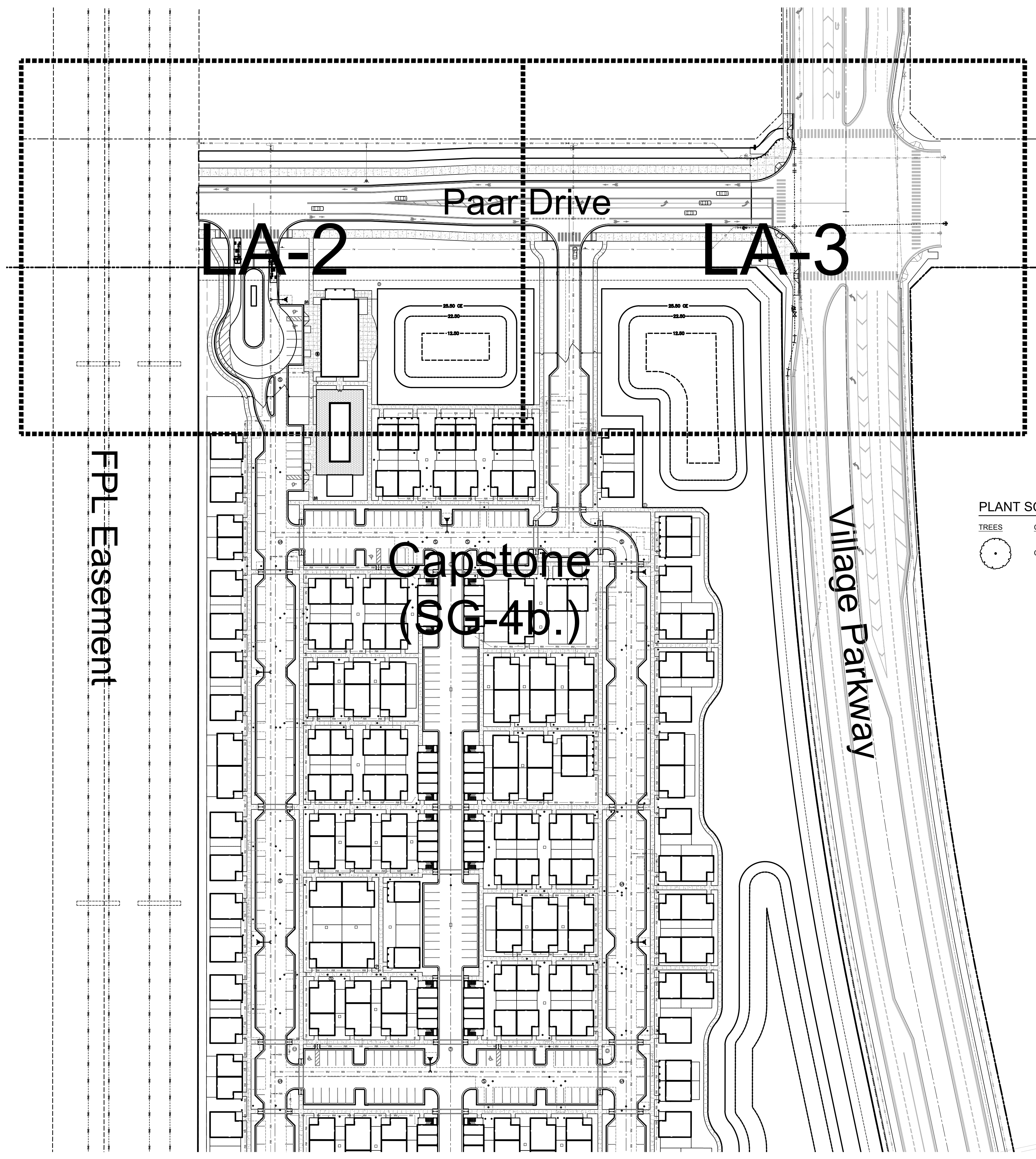

PLANT SCHEDULE PAAR ROAD STREET TREES

TREES	CODE	QTY	BOTANICAL NAME	COMMON NAME	CONTAINER	HEIGHT	WIDTH	NOTES	NATIVE	CALIPER
	QV	28	Quercus virginiana	Southern Live Oak	65G	14' HT	7' SPR	F, SP	Native	3" Caliper

- GENERAL LANDSCAPE NOTES:**
- At least 50% of all required trees shall be of a native species.
 - All plant material to be Florida No. 1 or better.
 - All landscape & sod areas to be irrigated by an automated system that provides 100% coverage with 100% overlap with a minimum d.u. of .70.
 - All landscaping at intersection and corners complies with Section 158.204 of the Port St Lucie Code of Ordinances to provide a clear sight zone between 2' - 6' above the final road crown elevation. All hedges and shrubs with in the 25' sight triangle will be maintained at a height no higher than 2' above the crown elevation of the road. In addition, the foliage line any tree within the 25' sight triangle will maintained at a height of no less than 6' above the road crown.
 - Street tree locations will occur within 5' Landscape Easement as shown on civil engineering plans and can be adjusted based on final utility, sidewalk and driveway locations.
 - Root barriers are required for trees located within 5 feet of sidewalk, curb or pavement. Where applicable, street trees requiring root barriers shall be installed with Biobarrier Root Control Fabric or approved equal. Install per manufacturer specifications.
 - Berm landscape to be field adjusted according to final grading and top of berm locations. The viburnum hedge will be planted along each side of the boundary fence or wall, following the top of berm.
 - The boundary feature will be either a Black Vinyl Covered Chain Link (6') in height or Opaque Concrete Wall (6') in height.
 - Fence other than the chain link boundary fence will be a Decorative Aluminum fence (6') in height.
 - The street trees may be located within the home landscape beds, or as a stand-alone specimen in sod.
 - All proposed landscaping meets FDOT specifications.

PSLUSD NOTES FOR LANDSCAPE PLANS

- All new landscaping within utility easements and within ten (10) feet of underground utility infrastructure shall comply with PSLUSD technical specifications, policies, and codes.
- No landscaping other than sod grasses may be planted within a 5' radius maintenance area of any utility appurtenances such as water meters, backflow devices, fire hydrants, sanitary sewer cleanouts, and manholes, air release valves, etc. Trees shall not be planted within ten (10) feet of any underground infrastructure.
- No landscaping shall be planted in such a manner as to adversely affect utility installation, operation and maintenance.
- Street Trees are not consistently spaced at 40' O.C. max. due to insufficient separation between existing utility locations and back of curb, FPL Easements with Overhead Power Lines, and Vehicular Sight Distance requirements.

**Paar Drive
 Street Tree Plans**

City of Port St. Lucie P#21-007
 PSLUSD No. 5399

Date	By	Description
01.05.21	RM	Initial Submittal
01.28.21	RM	Response to Comments
02.11.21	RM	Response to Comments
03.18.21	MY	Update Paar to include left turn lane

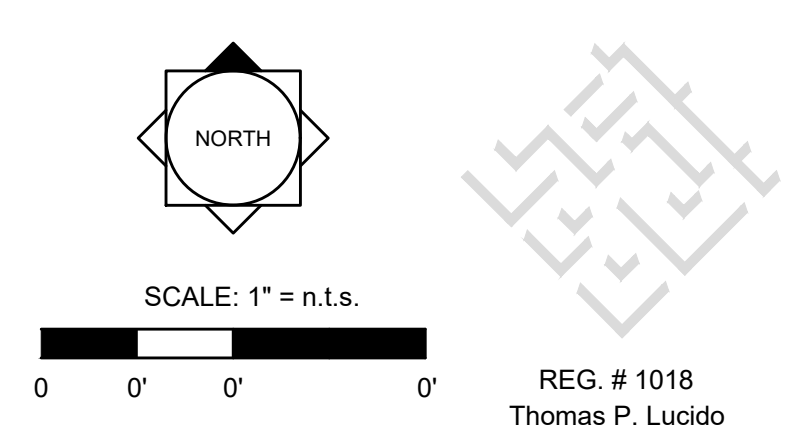

REG. # 1018
 Thomas P. Lucido

Designer: RM
 Manager: MY
 Project Number: 20-370
 Municipal Number: P21-007
 Computer File: _____

Index of Drawings:

Plant List	CV
Landscape Plans	LA-2 - LA-3
Details & Specifications	LA-4 - LA-5

Sheet LA-2

Key / Location:

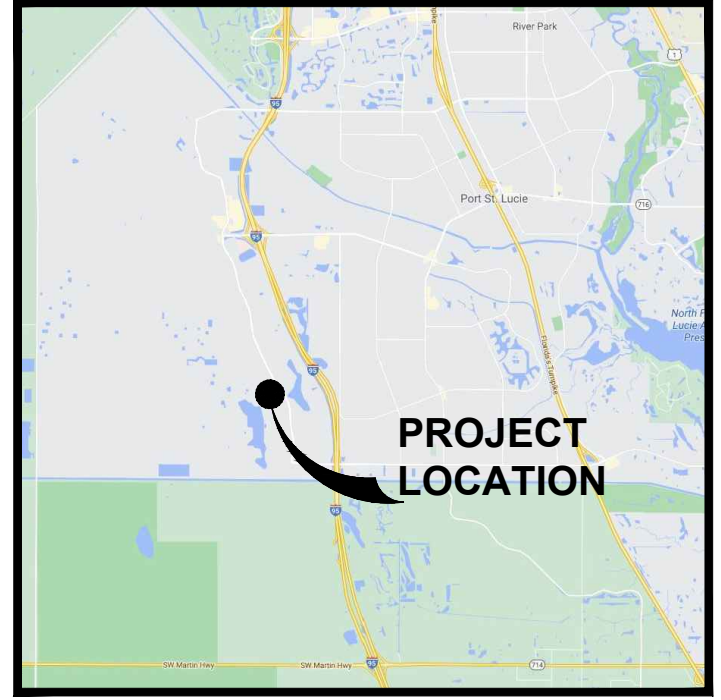

Project Team:

Client & Property Owner: Mattamy Homes, LLC.
1500 Gateway Blvd., Suite 220
 Boynton Beach, FL 33426

Land Planner / Landscape Architect: Lucido & Associates
701 E Ocean Boulevard
 Stuart, FL 34994

Engineer: Kimley Horn
445 24th Street, Suite 200
 Vero Beach, FL 32960

Surveyor: Caulfield & Wheeler Inc.
410 S.E. Port St. Lucie Blvd.
 Port St. Lucie, Florida 34984

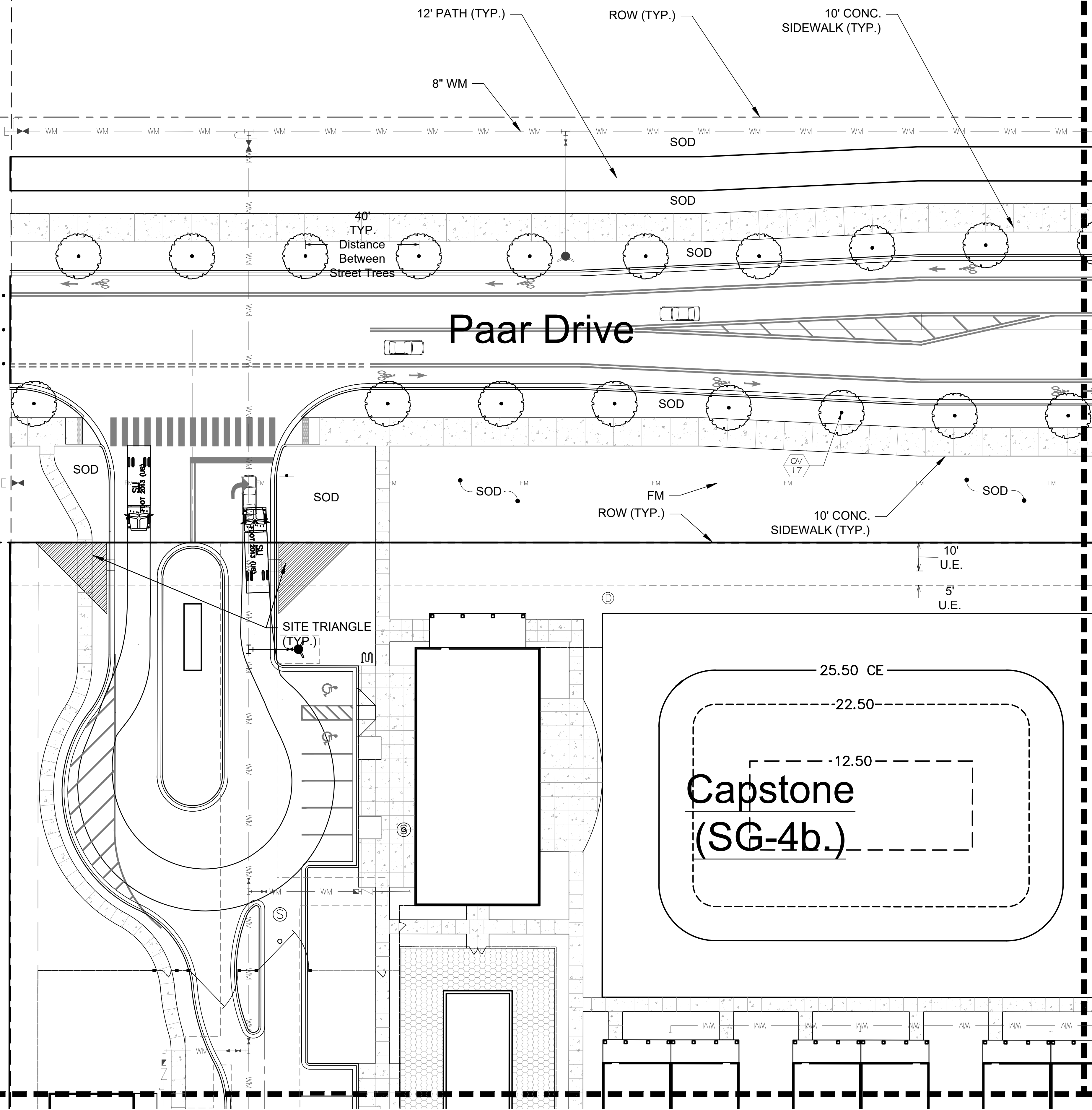

Paar Drive

Port St. Lucie, FL

Street Tree Plans

City of Port St. Lucie P#21-007
 PSLUSD No. 5399

Date	By	Description
01.05.21	RM	Initial Submittal
01.28.21	RM	Response to Comments
02.11.21	RM	Response to Comments
03.18.21	MY	Update Paar to include left turn lane

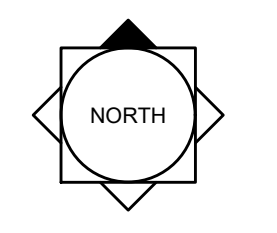

SCALE: 1" = 20'



 REG. # 1018
 Thomas P. Lucido

Designer: RM
 Manager: MY
 Project Number: 20-370
 Municipal Number: ---
 Computer File: _____

LA-2

Sheet LA-3

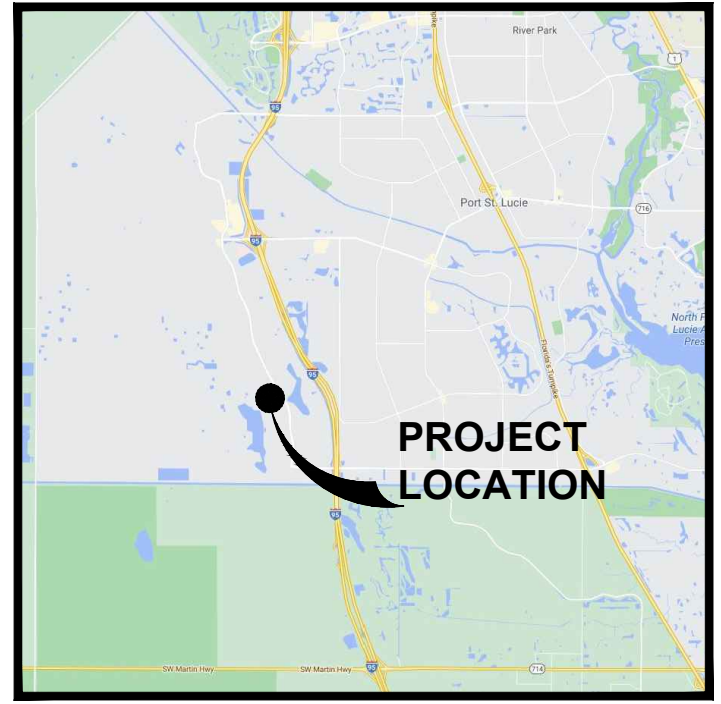
Key / Location:



N.T.S.

Project Team:

- Client & Property Owner:** Mattamy Homes, LLC.
1500 Gateway Blvd., Suite 220
Boynton Beach, FL 33426
- Land Planner / Landscape Architect:** Lucido & Associates
701 E Ocean Boulevard
Stuart, FL 34994
- Engineer:** Kimley Horn
445 24th Street, Suite 200
Vero Beach, FL 32960
- Surveyor:** Caulfield & Wheeler Inc.
410 S.E. Port St. Lucie Blvd.
Port St. Lucie, Florida 34984

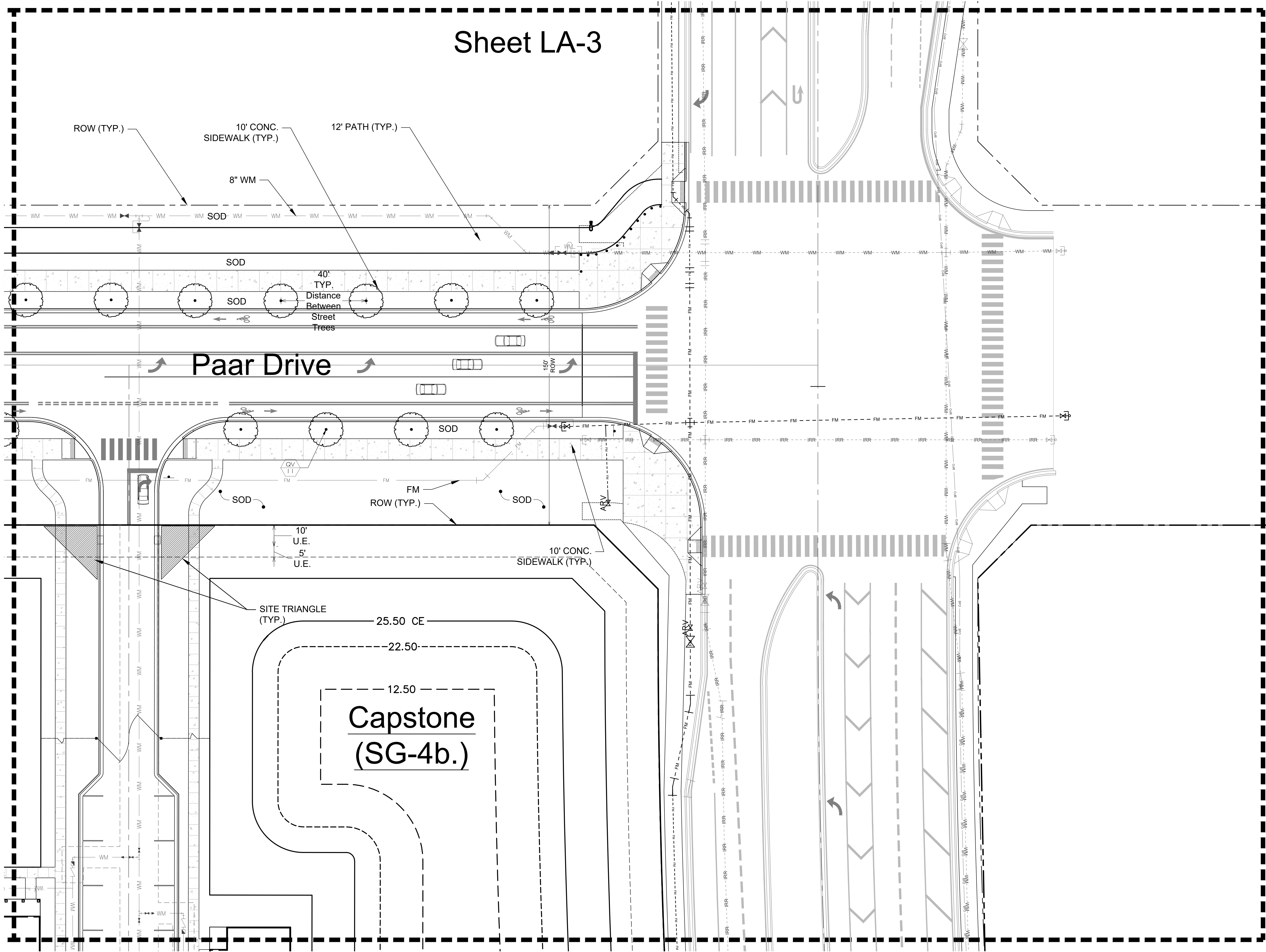

Paar Drive Port St. Lucie, FL Street Tree Plans

City of Port St. Lucie P#21-007
PSLUSD No. 5399

Date	By	Description
01.05.21	RM	Initial Submittal
01.28.21	RM	Response to Comments
02.11.21	RM	Response to Comments
03.18.21	MY	Update Paar to include left turn lane

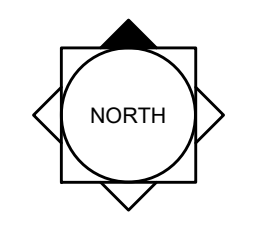

SCALE: 1" = 20'
0 10' 20' 40'



Designer	RM	Sheet
Manager	MY	LA-3
Project Number	20-370	
Municipal Number	---	
Computer File		

© Copyright Lucido & Associates. These documents and their contents are the property of Lucido & Associates. Any reproductions, revisions, modifications or use of these documents without the express written consent of Lucido & Associates is prohibited by law.

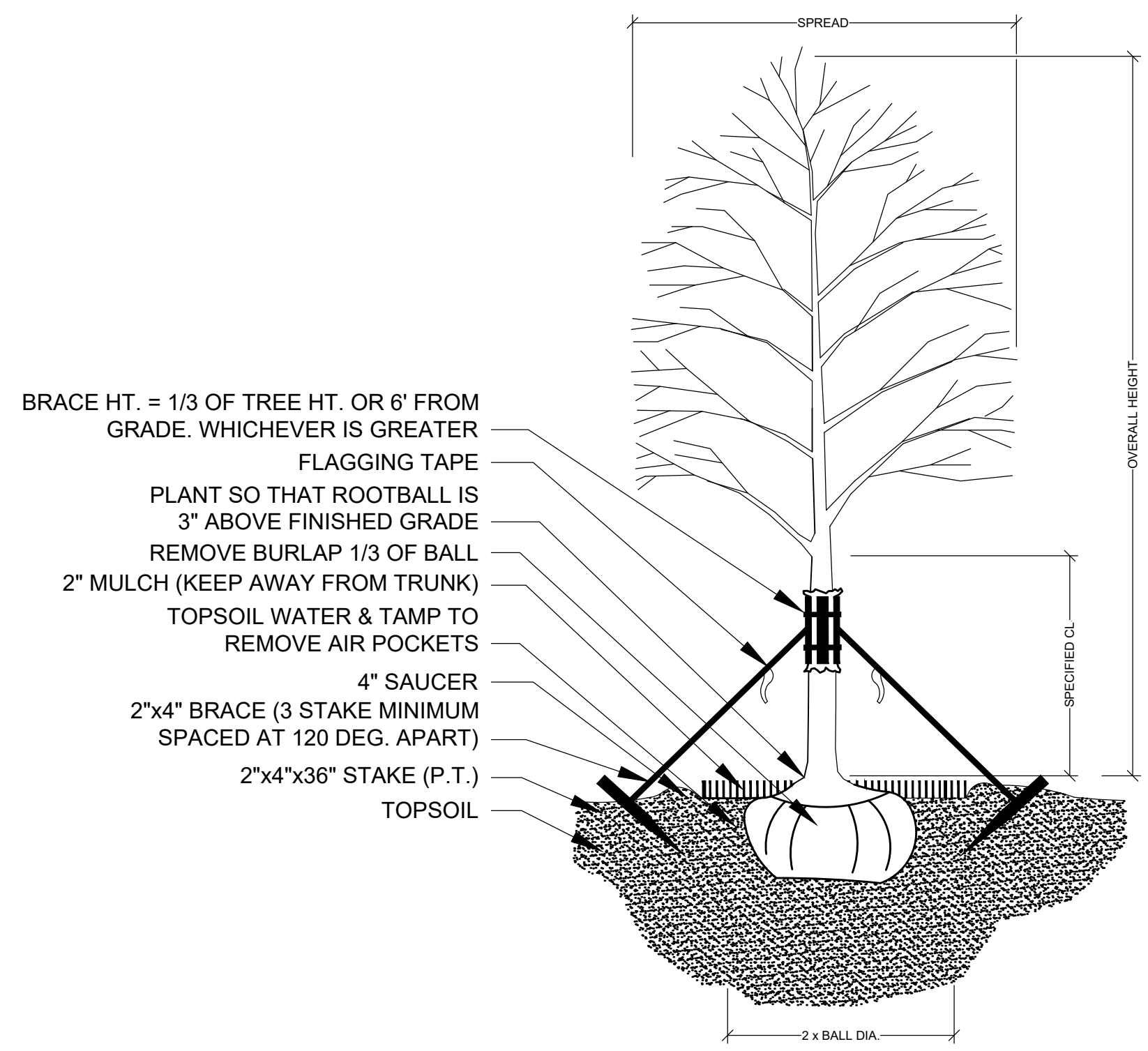

TREE PLANTING & STAKING
 NOT TO SCALE

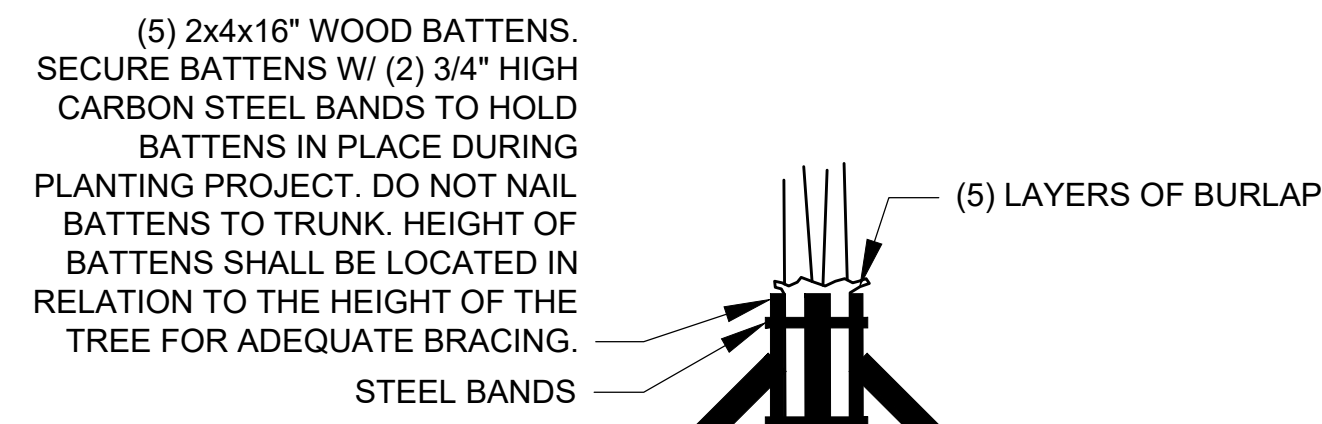

BRACING DETAIL
 NOT TO SCALE

WRAP TRUNK IN BURLAP & SECURE BATTENS W/ 3/4" HIGH CARBON STEEL BANDS
 FLAGGING TAPE
 2"x4" BRACE (3 STAKE MINIMUM SPACED AT 120 DEG. APART)
 2" MULCH (KEEP AWAY FROM TRUNK)
 FORM SAUCER WITH 4" CONTINUOUS RIM

2x4x36" STAKE (P.T.)
 TOPSOIL

PALM PLANTING - ANGLE STAKE
 NOT TO SCALE

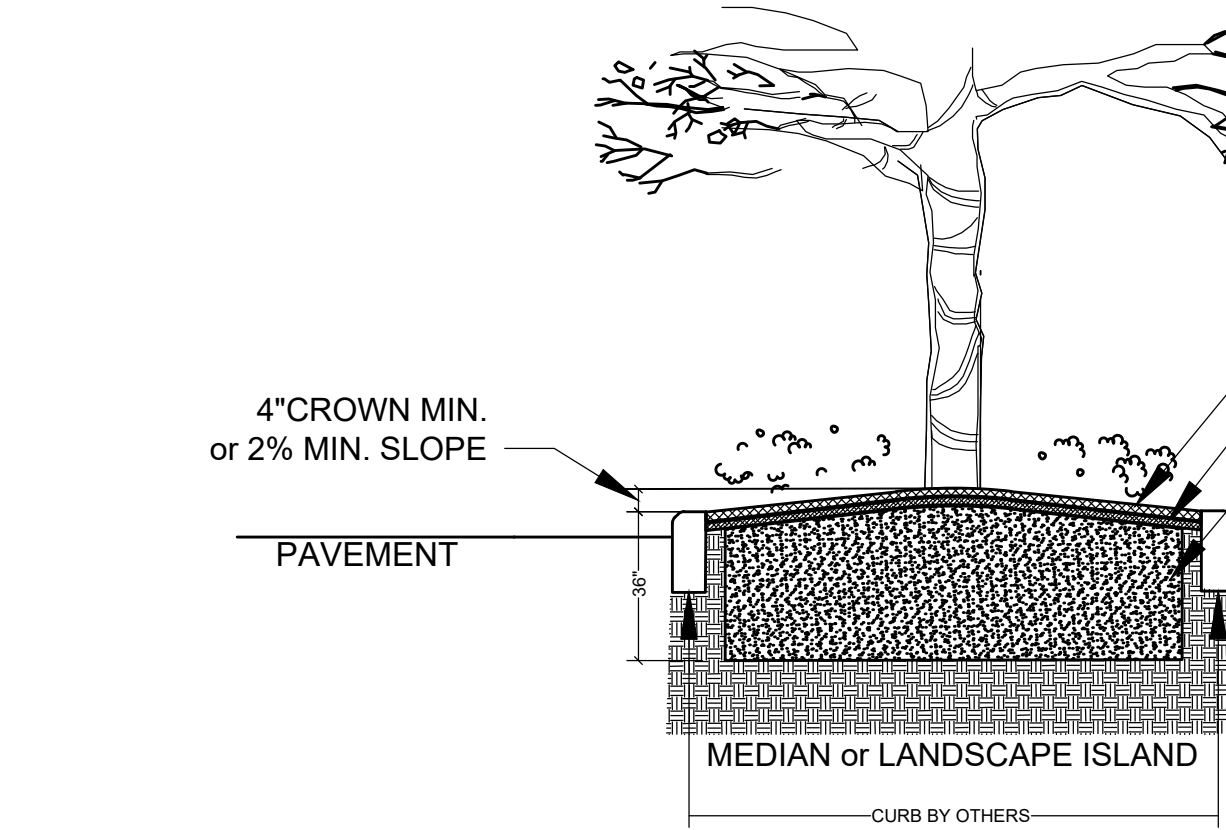

MULTI-TRUNK PLANTING & GUYING
 NOT TO SCALE

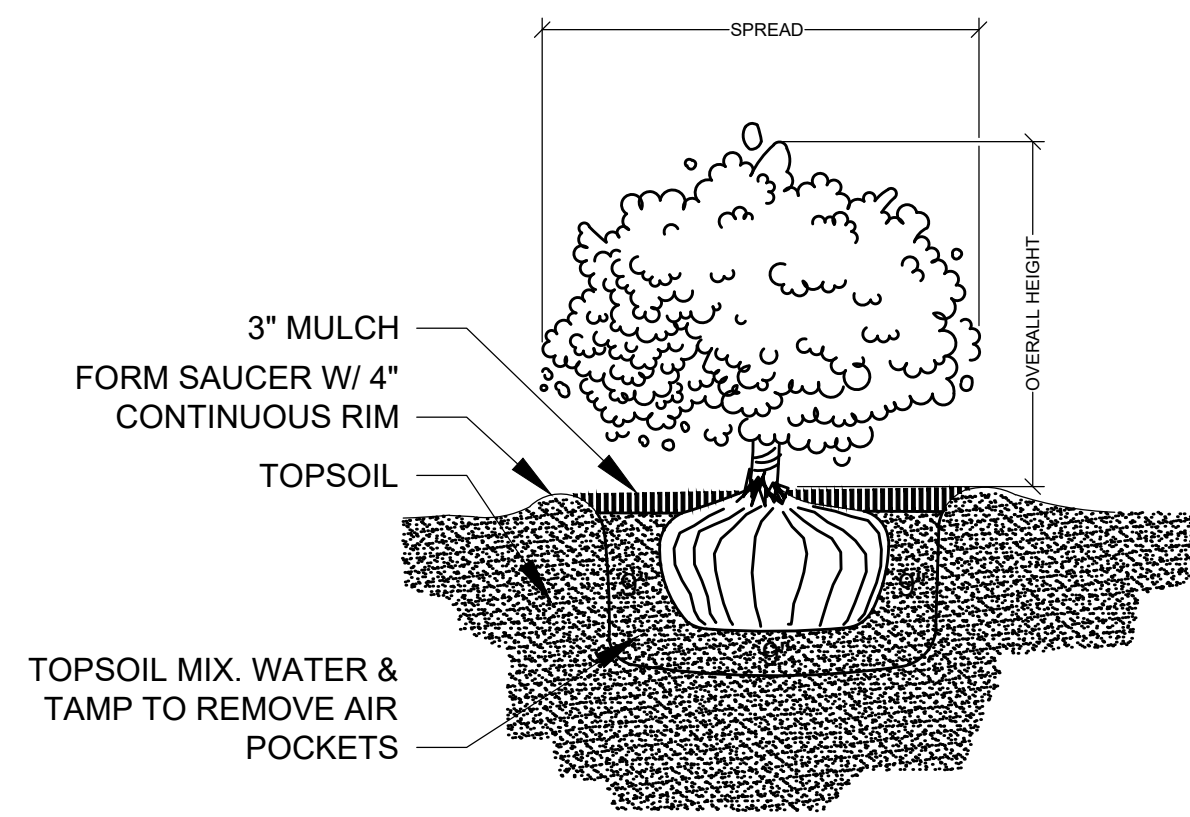

SHRUB PLANTING
 NOT TO SCALE

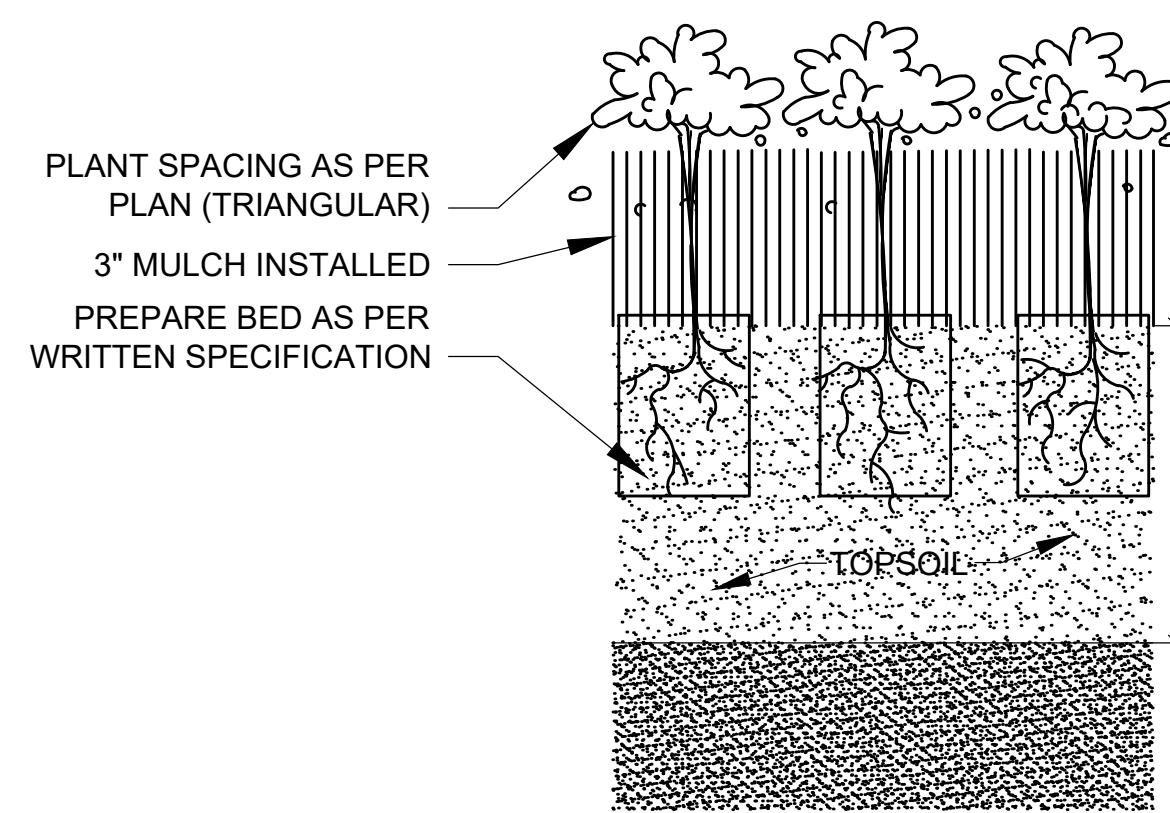

GROUNDCOVER PLANTING DETAIL
 NOT TO SCALE

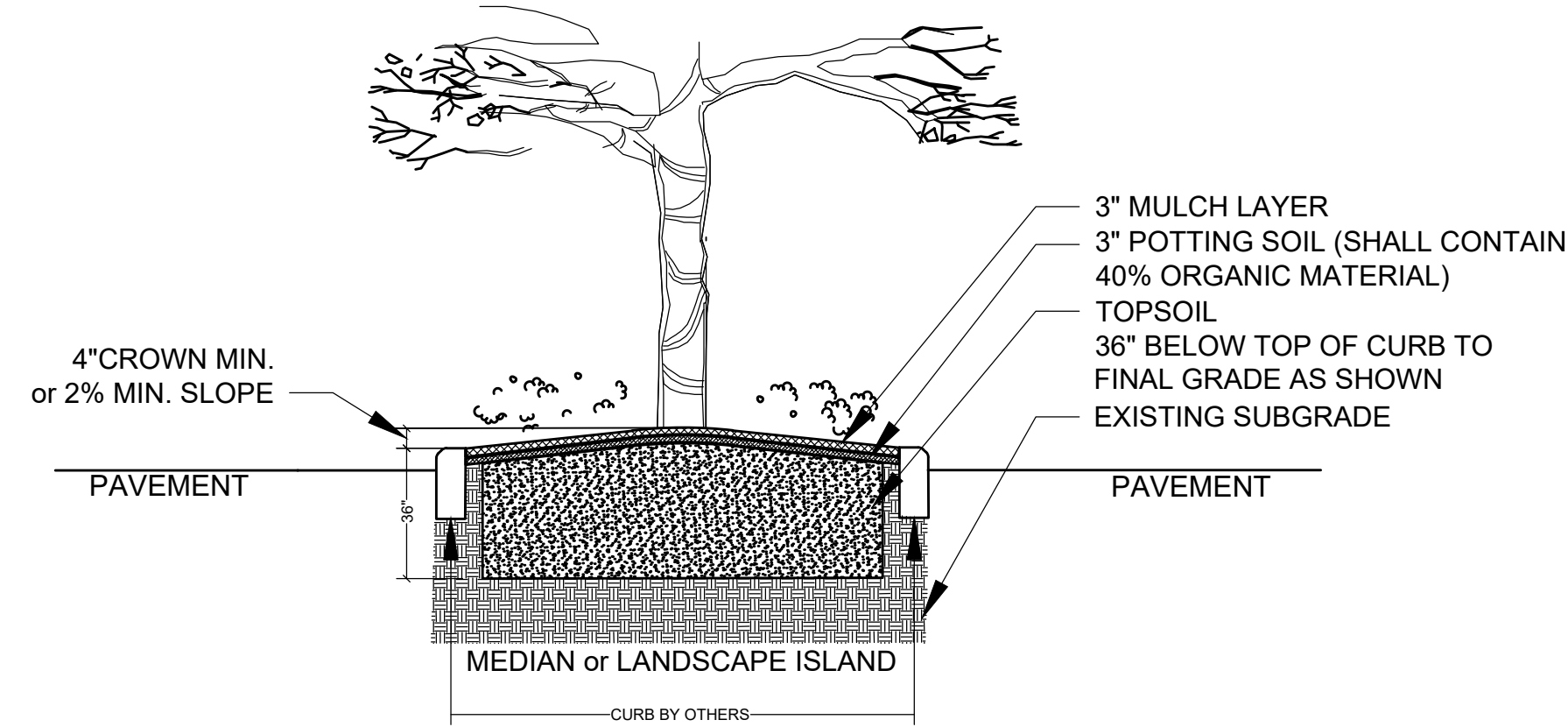

THIS DETAIL SHOWN DEPICTS A MEDIAN AND/OR LANDSCAPE ISLAND AND IS FOR GRAPHIC PURPOSES ONLY; SOIL PREPARATION SHALL APPLY TO ALL TREE, SHRUB, & GROUND COVER AREAS. THIS DOES NOT INCLUDE SOD AREAS

LANDSCAPE AREA PREPARATION DETAIL
 NOT TO SCALE

- TOPSOIL SHALL BE NATURAL, FRIABLE, FINE LOAMY SOIL POSSESSING CHARACTERISTICS OF REPRESENTATIVE TOPSOIL IN THE VICINITY OF THE PROJECT SITE THAT PRODUCES HEAVY GROWTH.
- TOPSOIL SHALL HAVE A PH RANGE OF 5.5-7.4, FREE FROM SUBSOIL, WEEDS, LITTER, SODS, CLAY, STONES, STUMPS, ROOTS, TRASH, HERBICIDES, TOXIC SUBSTANCES, OR ANY OTHER MATERIAL WHICH MAY BE HARMFUL TO PLANT GROWTH, OR HINDER PLANTING OPERATIONS.
- TOPSOIL SHALL CONTAIN A MINIMUM OF 3% ORGANIC MATERIAL.
- TOPSOIL MUST PERCOLATE WATER AT A RATE OF 1" PER HOUR (SEE ALSO DRAINAGE TESTING DETAIL FOR TREES)
- LANDSCAPE AREA SOILS SHALL BE APPROVED BY LANDSCAPE ARCHITECT/OWNER PRIOR TO PLANTING

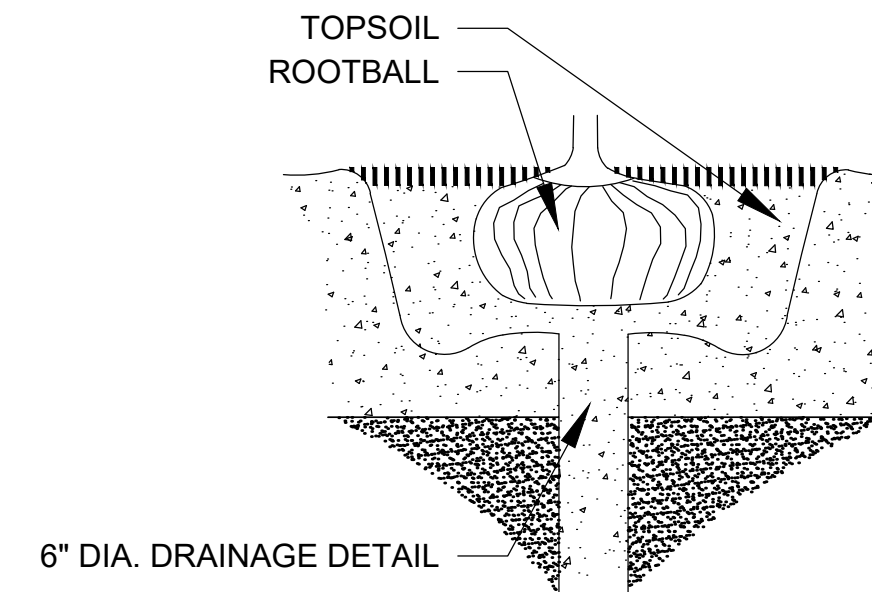

DRAINAGE TESTING DETAIL
 NOT TO SCALE

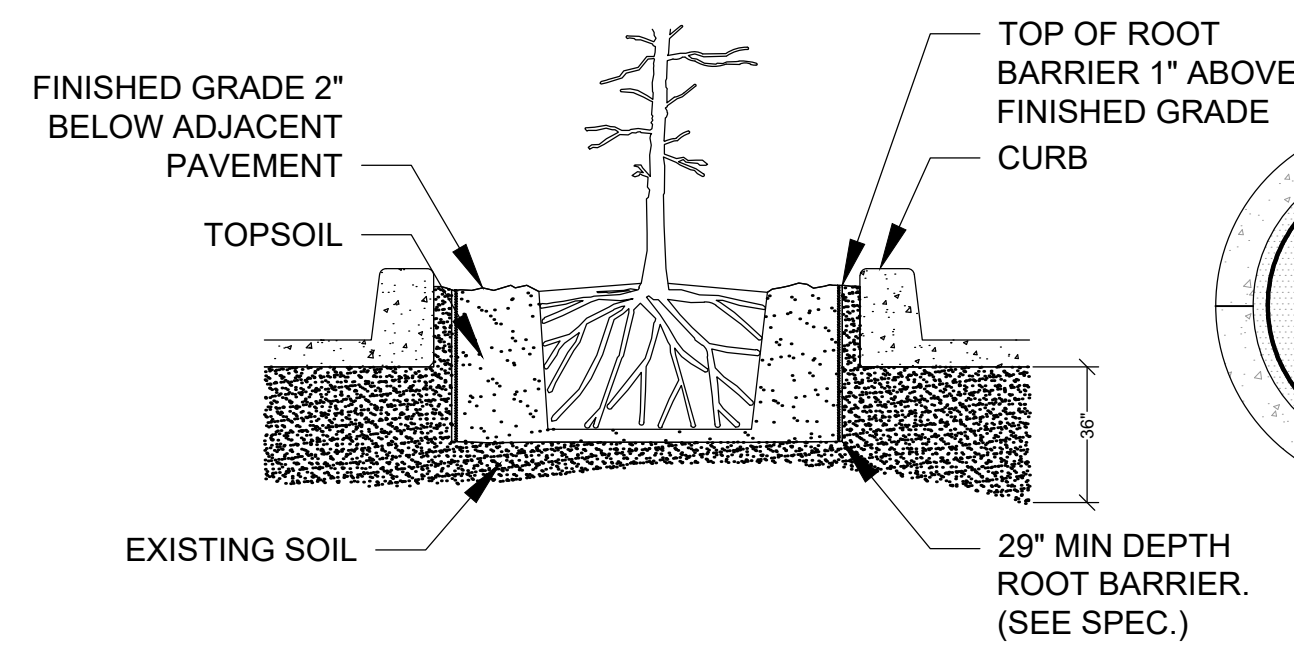

SPECIAL APPLICATIONS ROOT BARRIER DETAIL
 NOT TO SCALE

- NOTES:
 1- ROOT BARRIER SHALL BE "BIO-BARRIER 29" DEPTH OR APPROVED EQUAL.
 2- ROOT BARRIER SHALL BE INSTALLED PER MANUFACTURER'S SPECIFICATIONS AND RECOMMENDATIONS.

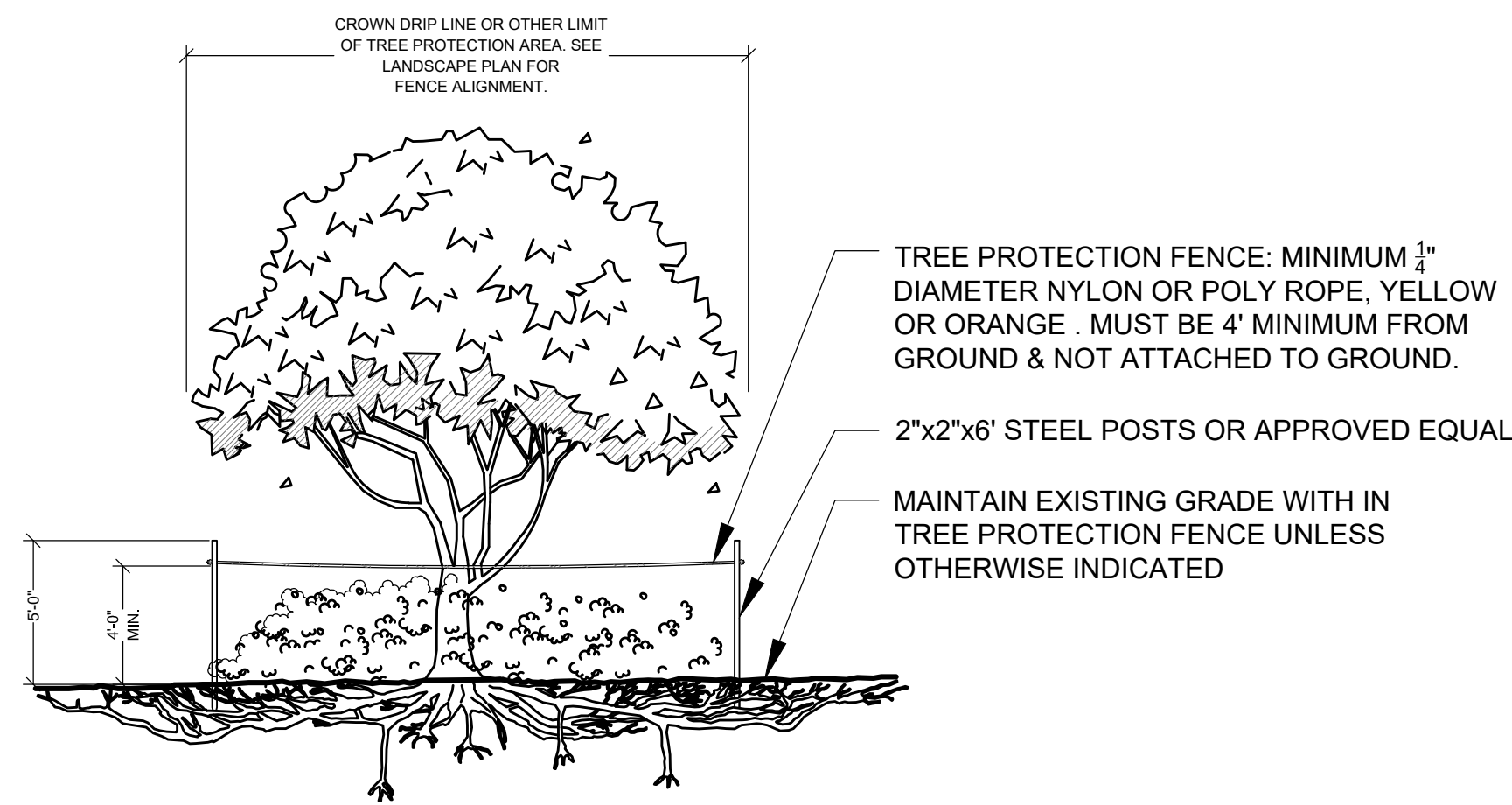

TREE PROTECTION BARRICADE
 NOT TO SCALE

- NOTES:
 1- SEE LANDSCAPE PLAN FOR FENCE ALIGNMENT.
 3- NO PRUNING SHALL BE PERFORMED EXCEPT BY APPROVED ARBORIST.
 4- NO EQUIPMENT SHALL OPERATE INSIDE THE PROTECTIVE FENCING INCLUDING DURING FENCE INSTALLATION AND REMOVAL.

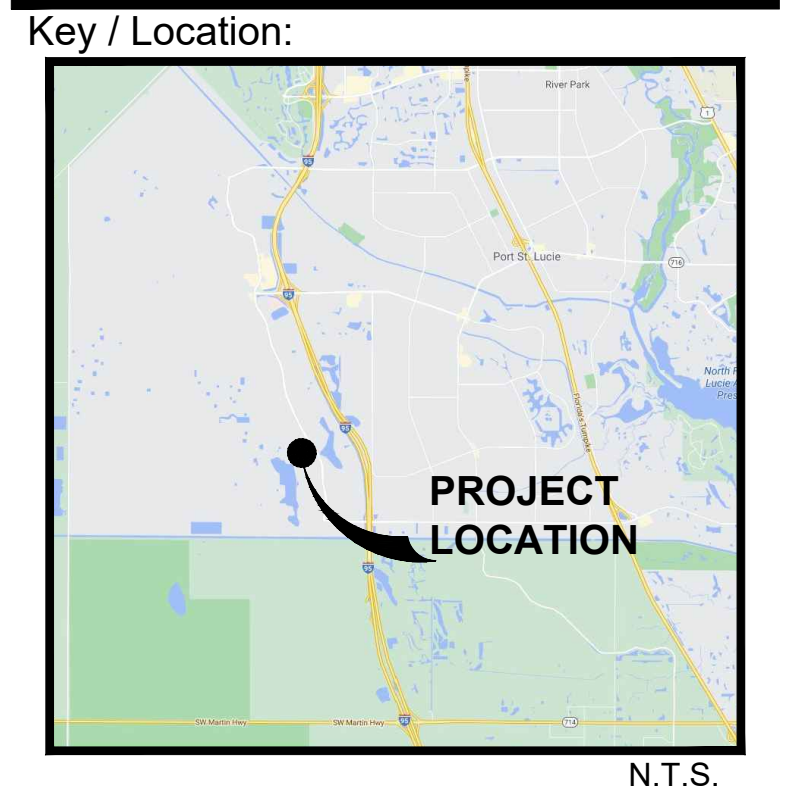

Project Team:
 Client & Property Owner: Mattamy Homes, LLC, 1500 Gateway Blvd., Suite 220, Boynton Beach, FL 33426
 Land Planner / Landscape Architect: Lucido & Associates, 701 E Ocean Boulevard, Stuart, FL 34994
 Engineer: Kimley Horn, 445 24th Street, Suite 200, Vero Beach, FL 32960
 Surveyor: Caulfield & Wheeler Inc., 410 S.E. Port St. Lucie Blvd., Port St. Lucie, Florida 34984

Paar Drive
 Port St. Lucie, FL
Street Tree Plans

City of Port St. Lucie P#21-007
 PSLUSD No. 5399

Date	By	Description
01.05.21	RM	Initial Submittal
01.28.21	RM	Response to Comments
02.11.21	RM	Response to Comments

DRAINAGE TESTING/DRAINAGE CHANNEL REQUIREMENTS.

PRIOR TO PLANTING, ALL PLANTING PITS SELECTED FOR TESTING SHALL BE TESTED IN THE FOLLOWING MANNER.

- DIG EACH PLANTING PIT TO THE MINIMUM SPECIFIED SIZE.
- FILL PLANTING PIT WITH TWELVE INCHES (12") OF WATER. IF THE WATER LEVEL DROPS FOUR (4") OR MORE WITHIN FOUR (4) HOURS, THE DRAINAGE IS SUFFICIENT AND A DRAINAGE CHANNEL IS NOT REQUIRED. IF THE WATER LEVEL DROPS LESS THAN FOUR INCHES (4") WITHIN THE FOUR (4) HOUR PERIOD, A DRAINAGE CHANNEL IS REQUIRED.
- WHERE REQUIRED, THE DRAINAGE CHANNEL MUST EXTEND DOWN THROUGH THE NON POROUS SOIL AND INTO POROUS SOIL. (SEE DETAIL)
- ALL MATERIAL REMOVED FROM THE DRAINAGE CHANNEL SHALL BE DISCARDED.
- WHEN BACKFILLING PLANTING PITS WITH NATIVE TOPSOIL, CARE MUST BE TAKEN TO KEEP THE CONSISTENCY OF THE SOIL MIX THE SAME THROUGHOUT THE PLANTING PIT AND DRAINAGE CHANNEL.

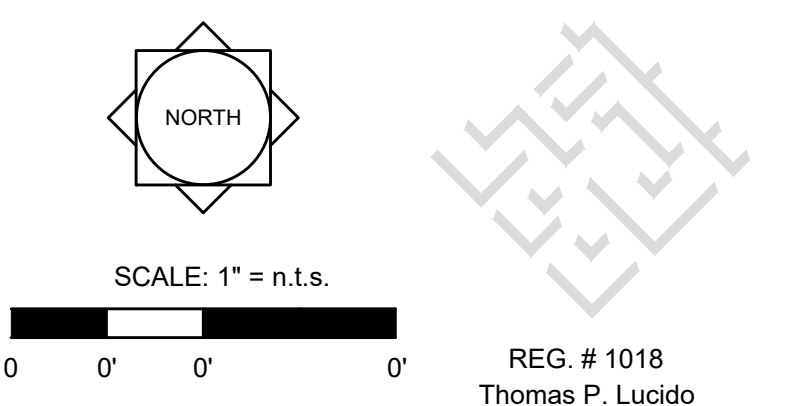

Designer RM Sheet
 Manager MY
 Project Number 20-370
 Municipal Number ---
 Computer File
LA-4

