

CURVE TABLE		
RADIUS	LENGTH	DELTA
C1	50.00'	29.37'
C2	185.00'	108.66'
		33°39'10"

LEGAL DESCRIPTION
 LOT 8, BLOCK 5, ST. LUCIE WEST NO 71 FIRST REPLAT AT LAKE CHARLES, ACCORDING TO THE PLAT THEREOF, RECORDED IN PLAT BOOK 34, PAGE 37, 37A THROUGH 37D, OF THE PUBLIC RECORDS OF ST. LUCIE COUNTY, FLORIDA.

FLOOD ZONE: X
 COMMUNITY NUMBER: 120287
 PANEL: 12111C0275
 SUFFIX: J
 BASE FLOOD ELEVATION: N/A
 FIRM DATE: 02/16/2012

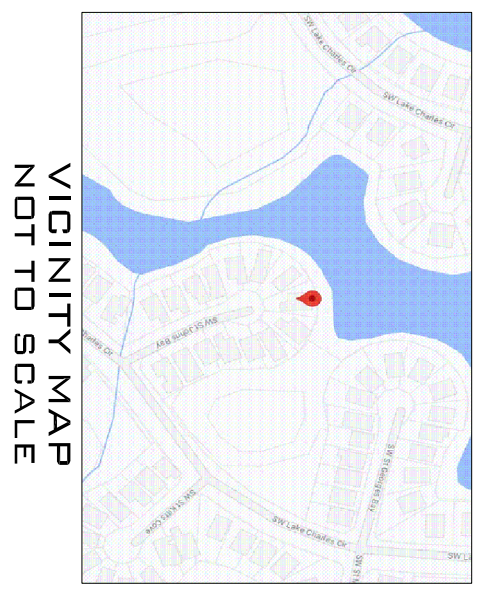
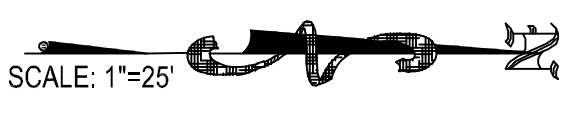

VICINITY MAP
 NOT TO SCALE

LEGEND

- A/C AIR CONDITIONER
- B.F.P. BACKFLOW PREVENTER
- C.B.S. CONCRETE BLOCK STRUCTURE
- E.E. ELEVATION
- F.F. FINISHED FLOOR
- I.D. IDENTIFICATION
- L. LENGTH
- L.B. LICENSED BUSINESS
- M. MEASURED
- NA.V.D. NORTH AMERICAN VERTICAL DATUM
- NG.V.D. NATIONAL GEODETIC VERTICAL DATUM
- O.R.B. OFFICIAL RECORDS BOOK
- P. PLAT
- PSM PROFESSIONAL SURVEYOR AND MAPPER
- P.R.M. PERMANENT REFERENCE MONUMENT
- P.G. PAGE
- P.B. PLAT BOOK
- PK PARKER KYLON NAIL
- R. RADIUS
- Q. CENTERLINE
- C. CENTERLINE
- # AND NUMBER
- Δ DELTA OR CENTRAL ANGLE
- CONCRETE
- CHAIN LINK FENCE
- WOOD FENCE
- MISCELLANEOUS FENCE
- P.D.E. = PRIVATE DRAINAGE EASEMENT.
- P.U.E. = PRIVATE UTILITY EASEMENT.

- NOTES:**
1. LEGAL DESCRIPTION PROVIDED BY CLIENT
 2. NO SEARCH OF THE PUBLIC RECORD FOR THE PURPOSE OF ABSTRACTING TITLE WAS PERFORMED BY THIS OFFICE
 3. NO SUBSURFACE IMPROVEMENTS WERE LOCATED AS PART OF THIS SURVEY
 4. ALL ANGLES OR BEARINGS AND DISTANCES SHOWN HEREON ARE BOTH RECORD AND MEASURED UNLESS OTHERWISE NOTED
 5. SOME FEATURES MAY NOT BE AT SCALE IN ORDER TO SHOW DETAIL.
 6. THE BEARINGS SHOWN HEREON ARE BASED UPON THE WESTERLY, HAVING A BEARING OF S 08°24'48"W.

- REVISIONS:**
1. ADDED SITE PLAN: 10/31/2023
 2. REVISED SITE PLAN: 05/22/2024
- DATE OF FIELD WORK: 08/16/2023
 DATE OF MAP: 08/17/2023

SURVEYORS CERTIFICATE:
 I HEREBY CERTIFY THAT THIS BOUNDARY SURVEY IS A TRUE AND CORRECT REPRESENTATION OF A SURVEY PREPARED UNDER MY DIRECTION, NOT VALID WITHOUT A RAISED EMBOSSED SEAL AND SIGNATURE.

(SIGNED)

KENNETH J. OSBORNE
 PROFESSIONAL SURVEYOR AND MAPPER #6415

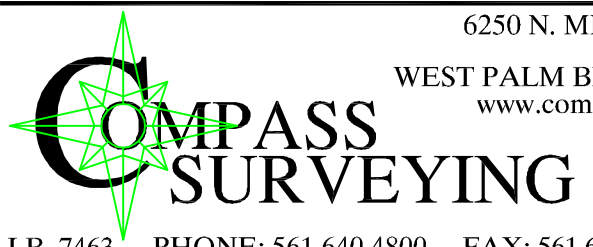

6250 N. MILITARY TRAIL
 SUITE 102
 WEST PALM BEACH, FL 33407
 www.compassurveying.net

LB. 7463 PHONE: 561.640.4800 FAX: 561.640.0576

Project	C-600229	Sheet	1 of 1
Date	08-17-2019		
Scale	1"=25'		

BOUNDARY SURVEY WITH SITE PLAN OF
 595 S.W. SAINT JOHNS BAY,
 PORT ST. LUCIE, FL. 34986
 PREPARED FOR
 DARLENE MCNEAL