

Lulfs Grove Business Park Area

Figure 4. Proposed Future Land Use Map.

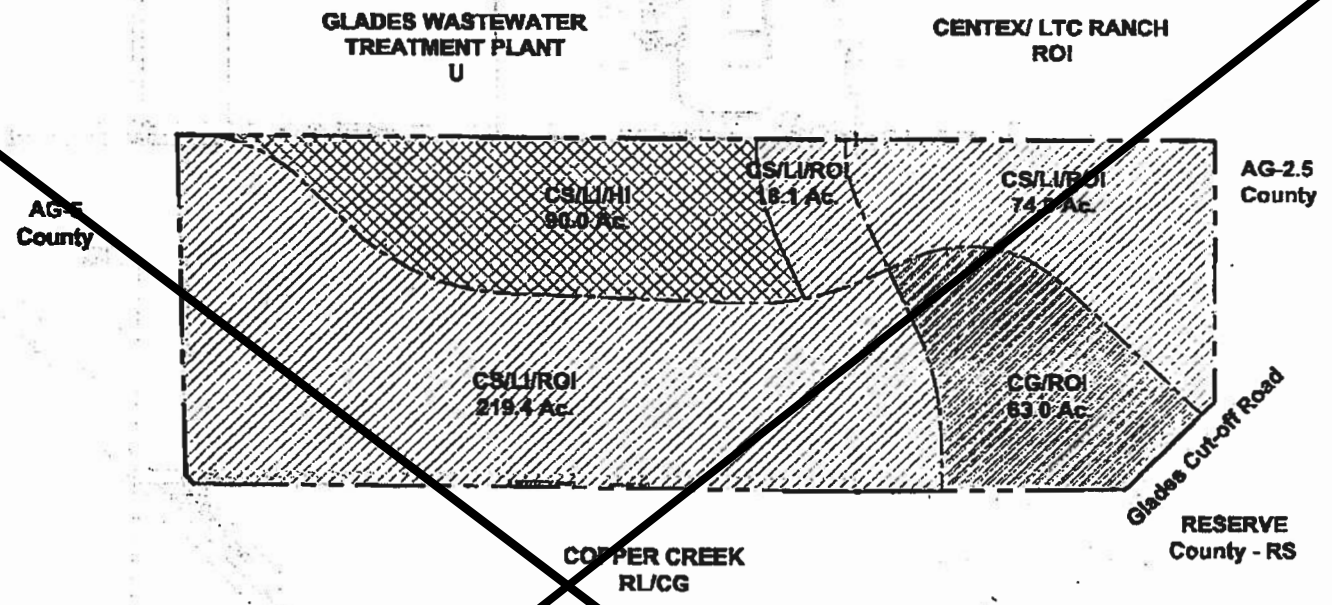

Site Data

Total Site Area	464.9 AC.
-----------------	-----------

Proposed Land Uses

CS/LI/RO1	Service Commercial Light Industrial Residential / Office / Institutional	311.5 AC.
CS/LI/RO1	Service Commercial Light Industrial Heavy Industrial	90.0 AC.
CG/RO1	General Commercial Residential / Office / Institutional	63.0 AC.

Legend

	CS/LI/RO1
	CS/LI/RO1
	CG/RO1

Proposed Future Land Use

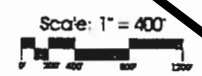



lucido & associates



701 SE Ocean Blvd., Stuart, Florida 34994

(772) 220-2100, Fax (772) 223-0220

Exhibit B: Lulfs Groves Future Land Use Map

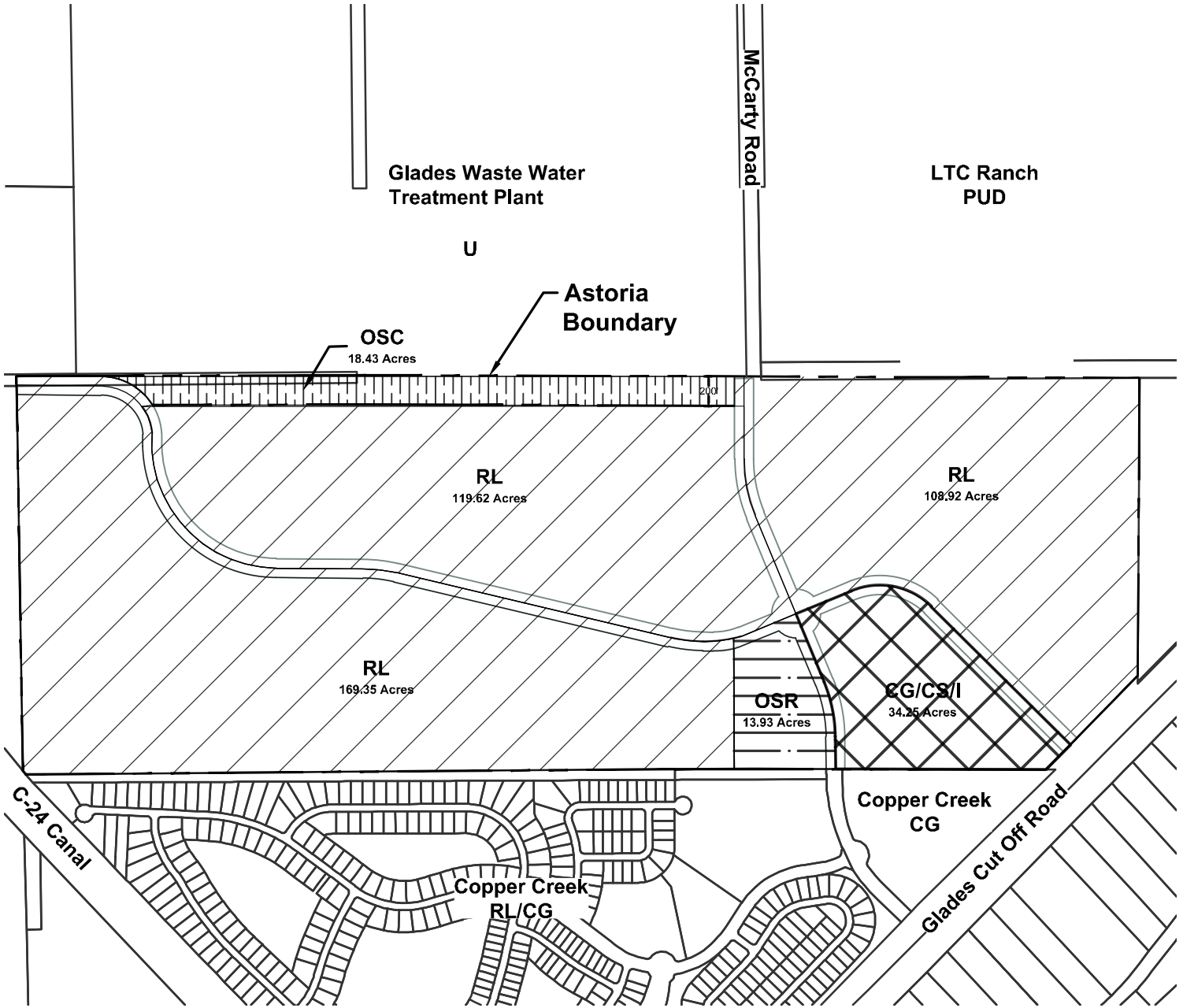
Proposed - Future Land Use Map

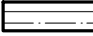

-  OSC - Conservation Open Space
-  OSR - Recreation Open Space
-  RL - Low Density Residential
-  CG/CS/I - General Commercial, Service Commercial, Institutional

Site Data

Total Site Area = 464.50 acres

Proposed Land Use

OSC = 18.43 acres
 OSR = 13.93 acres
 RL = 397.89 acres
 CG/CS/I = 34.25 acres



Scale: nts

Date: December 21, 2023

Astoria
City of Port St. Lucie